

Miter Saw Stand

Assembly Instructions



Video
instructions



Safety Disclaimer

Depending on what you load into your multicart, you could introduce the risk of it being a tipping hazard. I have included wall anchor hardware with your product so that you can safely secure the cabinet to a wall to prevent this from happening. I recommend storing heavier items at the bottom. Unload the cabinet before rolling it, especially on an incline/decline or rough surface and only open 1 drawer/tray at a time.

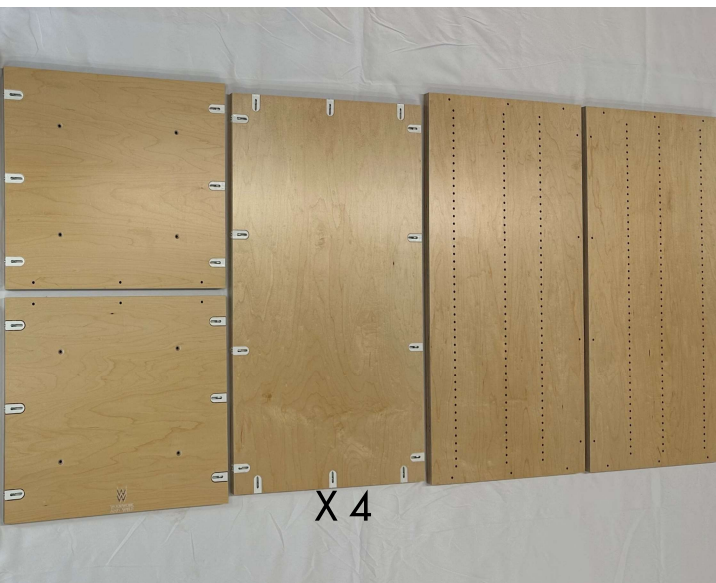

Parts List

- 2 Double cabinet tops, 2 Double bottoms with threaded inserts, Base stitchplate, 4 shelf supports and the miter saw shelf
- Cabineo tool (4mm ball end bit) to tighten Cabineos
- Qty 4 Cabinet kits
- Qty 104 Cabineo caps to cover the fasteners
- 4 locking/swivel casters
- Qty 16 of #14x3/4" truss head screws to secure casters to base
- Qty 40 of #8x1.25" Phillips flat head screws to hold the 4 cabinets to the base/top and to hold down the miter saw shelf
- Qty 1 5mm drill bit to drill shelf supports
- Qty 4 10-32x3in bolts for shelf supports
- Qty 10 1/4-20x1.5in Flat Head bolts for stitchplate
- Qty 10 1/4-20 T-Nut threaded inserts (pre-installed) for base
- Systainer trays, power modules, and cabling supplies are not included, but are available from multiple vendors. Information for these are at the end of the instructions.

Chuck Cabineo tool into your drill and set the torque to a really low setting.



Locate one of the sides



Grab the carcass bottom which should have the WW&W logo on it. Align the 3 Cabineo screws with the 5mm holes on the cabinet side.



Screw the middle Cabineo in a little so that it holds the part loosely. You will tighten it later. Double check the holes to accept the back are on the same side.



Tightening Cabineos

Do not to overtighten the hardware or it will strip out. Tighten until you feel the Cabineo bear down slightly and the gap goes away. It is also a little tricky to get the hex bit to release after tightening. Twisting the drill a little in a counter-clockwise direction helps removal. Worst case you can separate the bit from the drill and twist/wobble it a little to break it free.

Before Tightening



After Tightening



Twist/Wobble To Break Bit Free

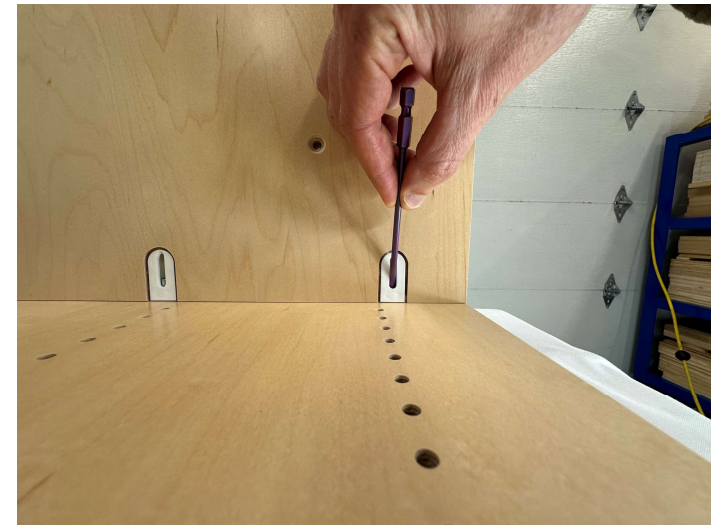

Cabinet Assembly

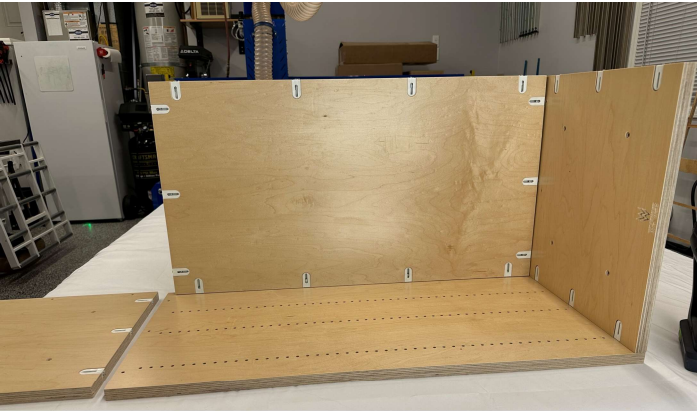

1. Set the cabinet back in position and tighten Cabineo screws loosely.

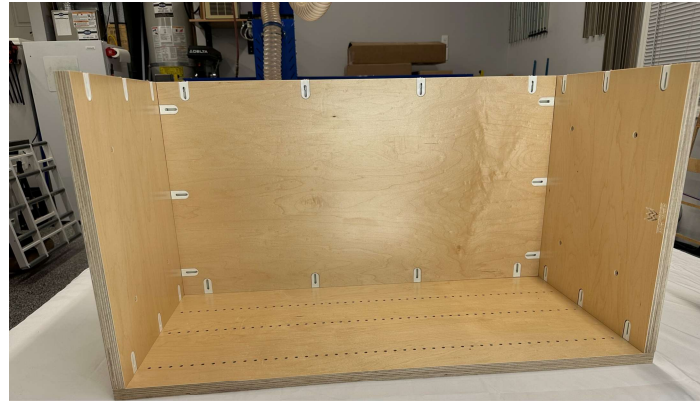

2. Loosely secure the top. Once all loosely set, tighten all Cabineo screws carefully until the gaps disappear (**don't over-torque!**).

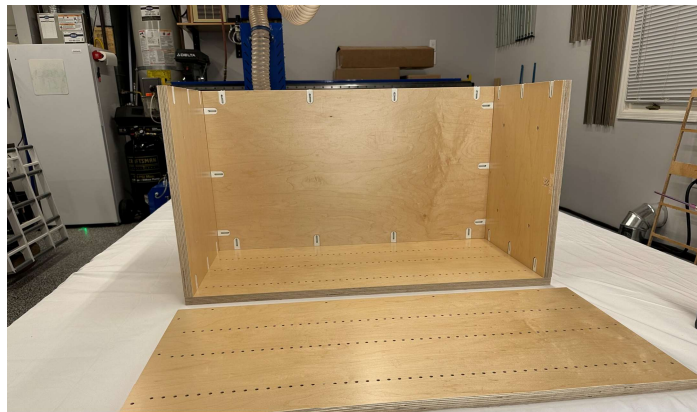

3. Orient the remaining side with the front facing you and flip the cabinet over onto it.



4. Loosely secure the remaining Cabineos and then do the final tightening just like step 2. Repeat the same steps for the other 3 cases

Put the back in and loosely secure the Cabineos. Once the back, bottom and top Cabineos are all in, secure them all to final tightness.

- Flip over the partially assembled cabinet onto the last side so that gravity can work in your favor. Align and loosely set the Cabineos as you did previously
- Tighten all the Cabineos from the last side

Cabineo Caps

The Cabineo caps can be installed to provide a finished appearance. Slide the flat end of the cap up against the adjacent wall and press down.



Base Assembly

The two longest pieces are each side of your base and they will have 1/4-20 T-Nuts in them (threaded fasteners). You will use the stitchplate (short board with 10 countersunk holes with flat head 1.5in bolts to attach the two side pieces together to create one unit.



Flip the base over and use the 16 #14 x 3/4" stainless truss head screws to secure 4 casters to the base.

Put the base on the ground and find a 4" thick block to support the center for now. Don't worry, once all bolted up this will be like a box beam with plenty of strength.

Set the first assembled cabinet on on the base while pushing it up against the stich plate and making sure there is .75" reveal in the front and back (I use a measurement block for this)

Use a light under the cabinet to make sure the 4 holes in the base align with the case holes and secure with the #8 x 1.25" screws

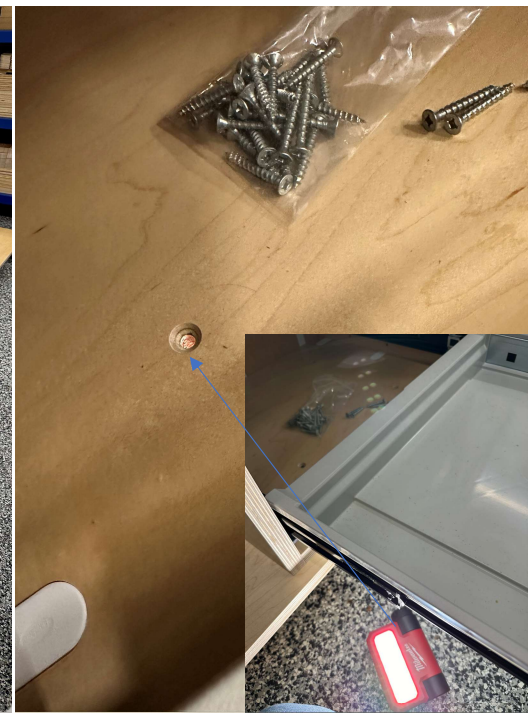

First cart shown screwed to the base.

Place your second and 3rd cabinet. Measure and secure those and the 4th cabinet as you did in the previous steps.

Place the tops on and check your measurements for the .75" reveal all the way around

Secure the top in all the cabinets with the #8 x 1.25" screws



4 Cabinets attached with
Locate the miter saw shelf
parts

Measure the height of your
miter saw surface.

Transfer the height
measurement to the miter
saw stand using the shelf
supports as shown below



Clamp the shelf support to the side of the cabinet (making sure it is aligned with the cabinet side) and mark a line for quick reference later. Make sure your clamp is clear of the 5mm holes on the inside of the cabinet

Follow the same process for the back

Using the provided 5mm drill bit, drill a hole through one of the pre-drilled holes where it aligns with your shelf support.

Do the same for the back set of holes (skipping the middle)



Below shows the drilled holes. You can do the same on the other side or follow the next steps to do them in a group.

Align all 4 shelf supports and tape them together with the one you already drilled on top.

Preferably using a drillpress, or a hand drill making sure you are perpendicular, use your already drilled holes as a guide to drill the other 3.

Note: I had to use my hand drill at the end because my drill press did not go deep enough

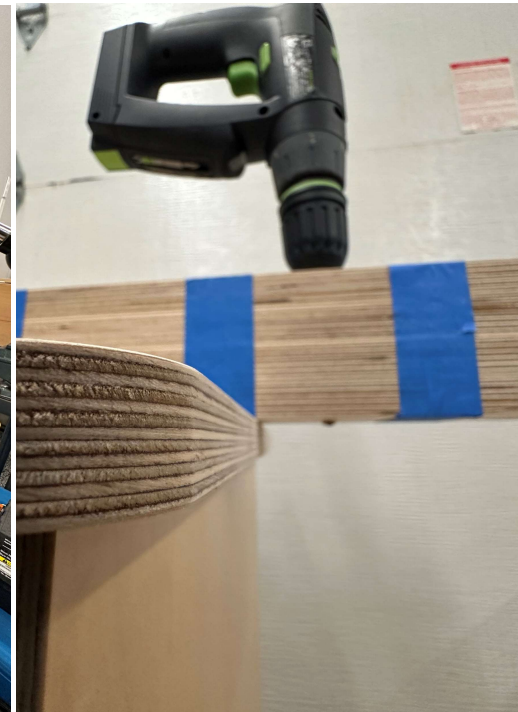
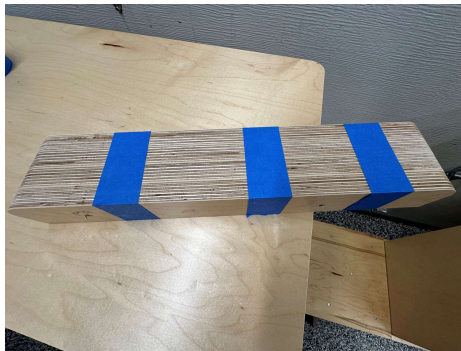
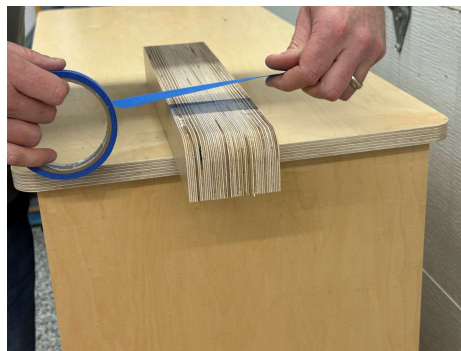

Make sure your drilled shelf supports are aligned the same way as shown below

Using 10-32x3" bolts, secure the 2 shelf supports using the 5mm holes you drilled earlier

Install the washers and nuts on all 4 and tighten



Place the miter saw shelf on the supports and align, then secure it with the six #8x1.25" screws.

Place your miter saw on the stand and check fitment. Secure it with bolts through the shelf (not included)

Fill in with Tools/Accessories

You're Done!



Options To Consider

Here are a few of the products I used to accessorize my Miter Station

Amazon- 3 inch Desktop Power Grommet, Max 65W USB C Charger, 2 Outlets, 3 USB Ports, Flush Mount Desk Hole Round Power Outlet, High-Speed Charging Station, Recessed Power Strip, 6ft Cord Flat Plug



Amazon- Power Strip with 6 Outlets 14AWG Cord Straight Plug for Commercial, Industrial, School and Home, 15A 125V 1875W, ETL Approved and Listed, Black (10 FT)



Build the Shop of Your Dreams with the Multi-Cart System

THANK YOU FOR SUPPORTING MY SMALL BUSINESS!

ALL MULTI-CART PIECES WORK TOGETHER TO CREATE COHESIVE AND CLEAN ORGANIZATION.

ALL ACCESSORIES AND CARTS ARE AVAILABLE (OR WILL BE SOON) ON WOODWORKANDWELD.COM

TOOL STACK CART



PULL OUT TRAY



DRAWER CART



FASTENER CART

