

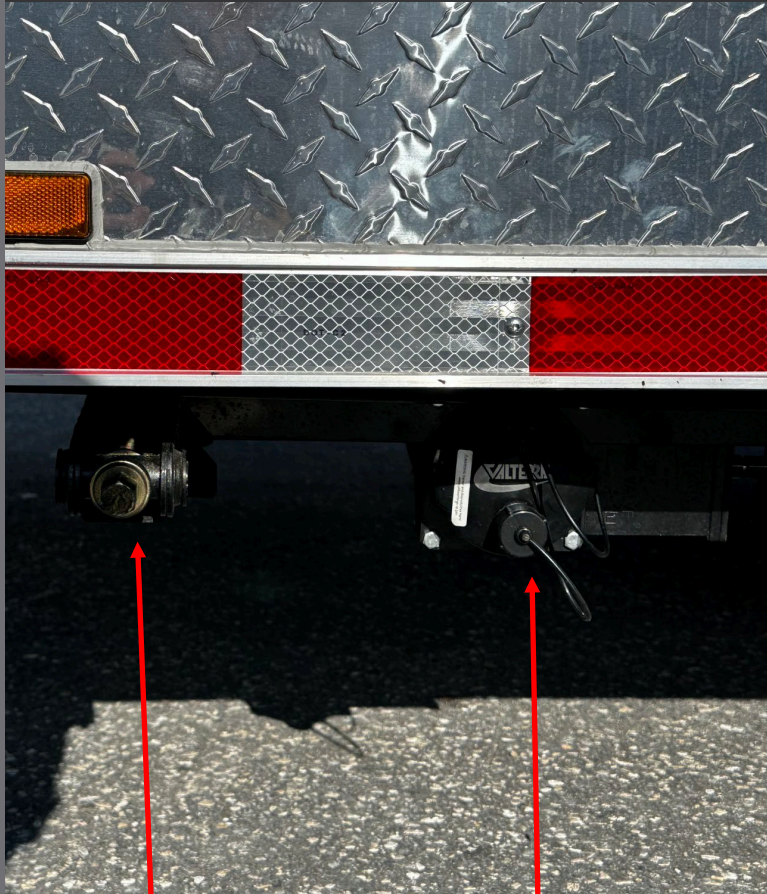

28ft Mobile Kitchen Trailer

2025 Units



$\frac{3}{4}$ " Fresh Water 45PSI
Front Bottom Driver Side

2-3" Gate Waste Point
Front Bottom Driver Side



$\frac{1}{2}$ "- $\frac{3}{4}$ " Gas Pipe Connection
Front Tongue Driver Side



Electric Box Inside,
Connection After door
bottom, Passenger Side

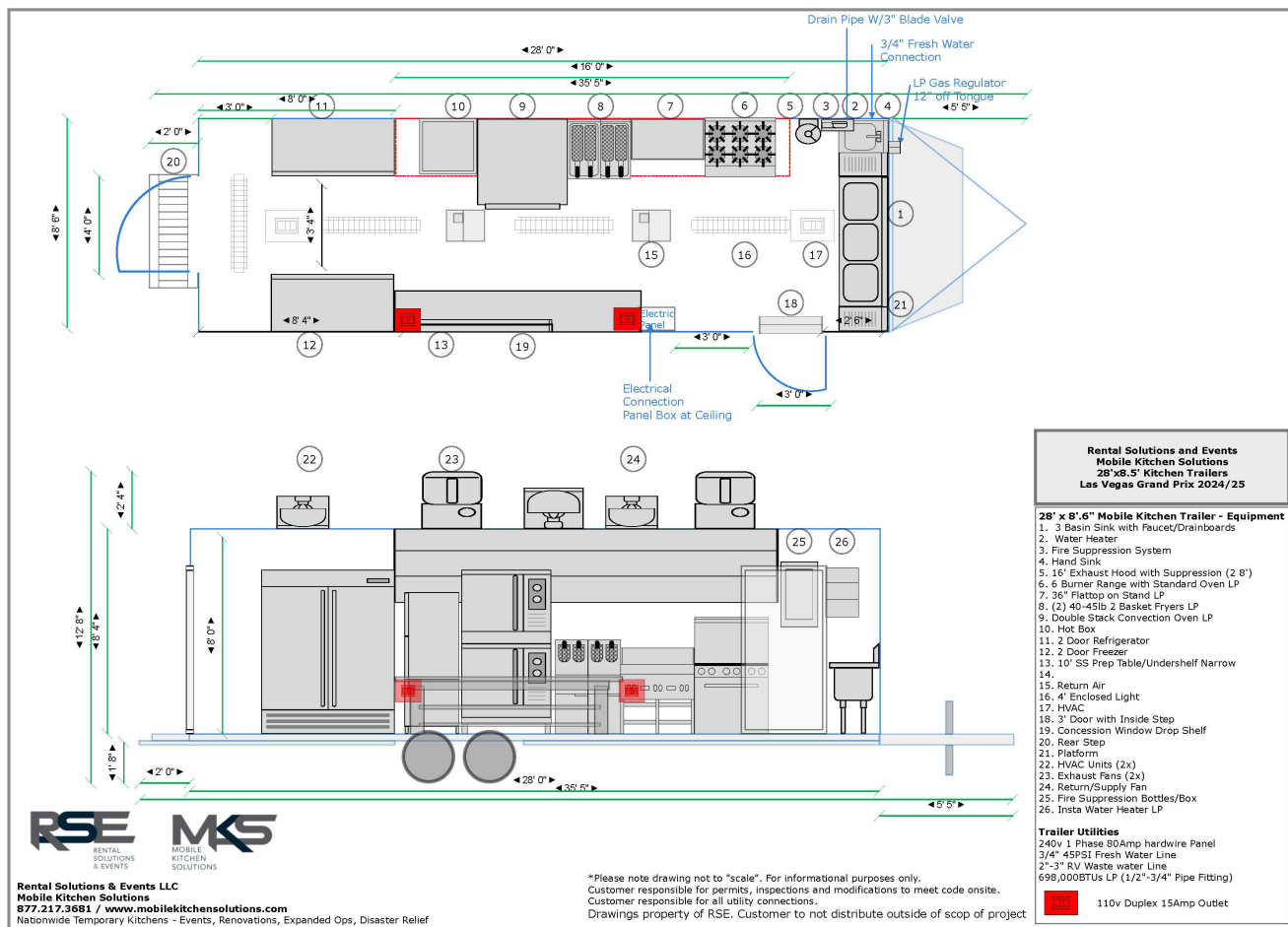

28'x8.5' Kitchen Trailer

Side Door/Rear Door
Enclosed Lighting
Rooftop HVAC
Fresh Air Supply
16' Exhaust Hood
Fire Suppression System with Pull
3 Basin Sink with Drainboards
Hand Sink
On Demand LP Water Heater
10' SS Narrow Table with Undershelf
(3) 110v 15A Courtesy Outlets inside
(1) 110v 15A Courtesy Outlets outside
6 Burner Range with Oven LP
36" Flattop on Stand LP
Double Stack Convection Oven LP
Hot Box
2 Door Refrigerator
2 Door Freezer
Concession Window



Interior Inside | Front of Trailer

Fire Suppression System / 3 Basin Sink / Hand Sink
On Demand Water Heater / Pull station / Fan Controls



Inside Front through Back

Enclosed Lighting / Electrical Box / Gas Stub Outs / Concession Window / Side and Rear Doors



Driver Side View



Passenger Side View

Layout/Adjustment Equipment Phase

Nothing Installed/working with staff on finalizing exact locations for
maximum efficiency



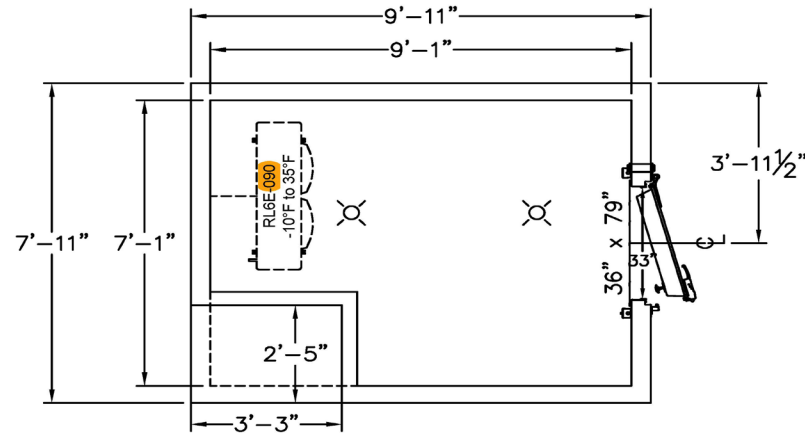

PLAN VIEW

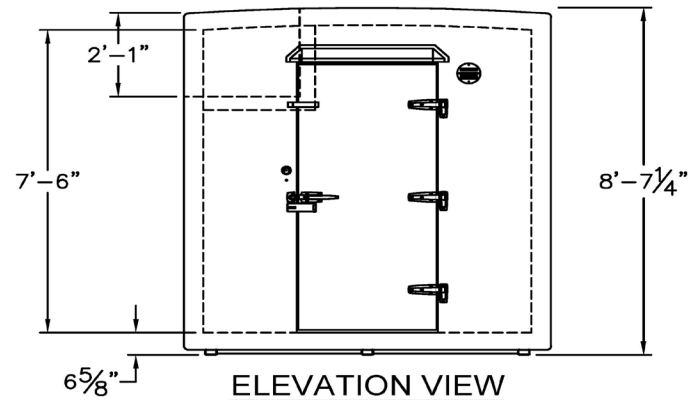

ELEVATION VIEW

ROOM TEMP.:
-10°F to 35°F
INTERIOR AREA:
64 sq. ft.
HORSEPOWER:
2.5 hp.
REFRIGERANT:
R-448A
ELEC. SUPPLY
115/208-230
PHASE:
Single
CYCLE:
60 hz.
AMPERAGE:
31.2 MCA

FFAL-A26Z-CFV

5" WALLS
5" CROWNED ROOF
3/4" KEG DUTY FLOOR
STRIP CURTAINS
SPRING HINGES
RECESSED REFRIGERATION

DRAWING APPROVAL

PLEASE INDICATE YOUR APPROVAL OF THIS DESIGN, THE DIMENSIONS, DOOR LOCATION/SWING, ELECTRICAL REQUIREMENTS, AND EQUIPMENT LOCATIONS BY SIGNING BELOW AND RETURNING TO POLAR KING.

DATE:

BY:

Rental Solutions and Events LLC

Mobile Kitchen Solutions

DRAWN BY:

RLM

MODEL NO.:

DT810

SCALE:

1/4" = 1'

DATE:

10/14/21

DRAWING NAME:

Rental Solutions DT810 Sykesville MD B

RSE

MKS

THE REFRIGERATION SYSTEM SHOWN IS DESIGNED TO MAINTAIN INDICATED TEMPERATURE IF PRODUCT ENTERS WITHIN 10°F OF FINAL HOLDING TEMPERATURE. PLEASE CONTACT YOUR SALES REP IF INCOMING PRODUCT WILL BE ENTERING AT HIGHER TEMPERATURES. REFRIGERATION DESIGN IS SUBJECT TO CHANGE FOR IMPROVEMENTS. ALL DIMENSIONS ARE NOMINAL. FINAL DIMENSIONS WILL BE ±1 INCH OF DRAWING DIMENSIONS. CONTACT YOUR SALES REP IF TIGHTER TOLERANCES ARE REQUIRED.

8'x10' Portable Dual Climate Walk in Refrigeration

Interior Light / Dual Climate / Air Curtains / Lockable

