



*Aloha*

*Test your creations,  
test our kitchen*

*You've got the vision and a plan --  
your documents and certifications are all squared  
away and now all you need is a commercial  
kitchen space to bring your culinary,  
bakery or consumable goods business to life.*

*E Komo Mai... the TEST KITCHEN;  
we are centrally located within  
McCully Shopping Center;  
up-to-date equipment; rustic look, spacious  
and fair priced commissary kitchen in  
HONOLULU, HI.*

*Welcome to our Test Kitchen!*



THE  
TEST  KITCHEN  
EST. 2020

**Hours of Operation**  
5:30am - 9:00pm  
8:30pm Doors Close



**McCULLY**  
SHOPPING CENTER

[www.mccullyshoppingcenter.com](http://www.mccullyshoppingcenter.com)

START - DEVELOP - SUSTAIN



THE  
**TEST**  
KITCHEN  
*The Aloha State*



1960 Kapiolani Blvd., Suite 210-212  
Honolulu, Hawaii 96826

[testkitchen@mccullyshoppingcenter.com](mailto:testkitchen@mccullyshoppingcenter.com)

## What we look for in an applicant...

There's no magical formula for what businesses we accept, but we have found that entrepreneurs that closely match these criteria are a good fit for the Test Kitchen.

You have a strong entrepreneurial spirit.

You have an interest and willingness to learn.

You have a clear vision for your business.

You produce a product that is currently popular or has a market and you are ready.

## Timeline

### Step 1

Visit [www.thefoodcorridor.com](http://www.thefoodcorridor.com) locate the Test Kitchen, sign-up with your business. You will not be charged anything until you have been accepted and all documents have been completed and uploaded into the system.

### Step 2

We accept you as a possible member. Now you will need to schedule a walk through orientation and start uploading your documents into your account on The Food Corridor.

### Step 3

If your business is selected to become a member of the the Test Kitchen, and you have done your walk through, your orientation and all paperwork is in. Now you will receive an invoice for your set-up fee, your annual membership dues and your deposit.

### Step 4

You are now welcome to start booking/scheduling your kitchen time.

# MEMBERSHIP

## Initial Cost and Fees

\$60 Set-Up Fee

\$240 Annual Membership

\$500 Deposit



### Sterling Silver

(Non-Member)

0-4 hrs. \$52.50 an hour

5-12 hrs. \$46.80 an hour

13+ hrs. \$45.60 an hour

### Select Member

Min. 4 hrs. \$42.00 an hour

5-12 hrs. \$40.80 an hour

13+ hrs. \$39.60 an hour



### Choice Member

Min. 16 hrs. \$39.00 an hour

17 -24 hrs. \$37.80 an hour

25+ hrs. \$36.60 an hour



### Prime Member

Min. 24 hrs. \$36.00 an hour

25 -32 hrs. \$34.80 an hour

35+ hrs. \$33.90 an hour



### Wagyu Member

Min. 32 hrs. \$30.00 an hour

33+ hrs. \$28.50 an hour

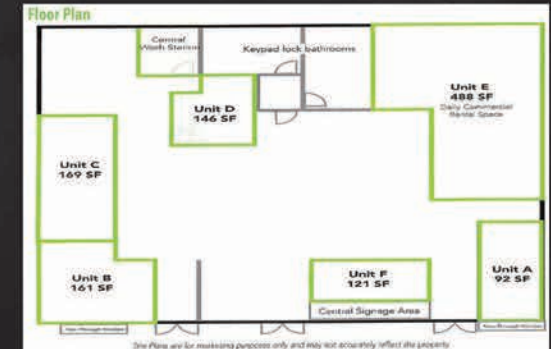

## Test Kitchen Kiosk

For Retail Space Within the Test Kitchen

Please Contact:

Nora Bland, (S)

Senior Vice President

(808) 522-5999

[nbland@sofosrealty.com](mailto:nbland@sofosrealty.com)

