

# GHOSTUD®

SO STRONG, YOU'LL BET IT'S IN A STUD

## THE REVOLUTIONARY DRYWALL ANCHOR

Designed with maximum versatility and holding strength; it's the last drywall anchor you'll ever need.

Perfect for homeowners and contractors.

### WHY CHOOSE GHOSTUD ?

- UNMATCHED HOLDING STRENGTH FOR HEAVY ITEMS
- TWO SIZES AVAILABLE:  
GS1 (1 INCH) AND GS2 (2 INCH)
- EASY INSTALLATION WITH STEP-BY-STEP GUIDES
- ENVIRONMENTALLY FRIENDLY, MADE WITH RECYCLED PLASTICS
- IDEAL FOR TVS, SHELVING, CABINETS, TOWEL HOLDERS, PICTURE FRAMES, AND MORE

### AUTHORIZED DEALER

**KLS, INC.**  
**Brent Barnes**  
**[Brentbarnes.kls@gmail.com](mailto:Brentbarnes.kls@gmail.com)**  
**931-548-9320**

# GHOSTUD®



Ghostud® 2" Model



Ghostud® 1" Model

# GHOSTUD®



Ghostud® 1" Model

Perfect For:



SMALL TO MEDIUM  
SIZED WALL ART



TOILET PAPER  
HOLDERS



CURTAIN RODS



TOWEL BARS



# GHOSTUD®



**Ghostud® 2" Model**

**Perfect For:**



**SHELVING**



**CABINETS**



**TV'S**



**OTHER DECORATIVE  
ITEMS**



## Easy DIY Installation Process

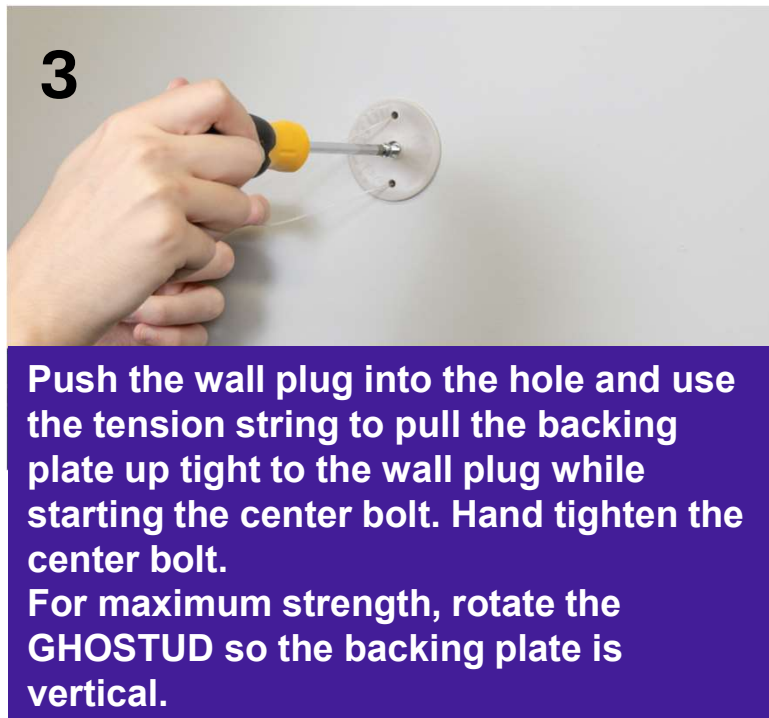

**\*If your GHOSTUD is no longer needed, it can be easily joint compounded over to hide.**



## Ways to Mount an Object Using a GHOSTUD®



1



Mount object utilizing the center connecting screw.

2

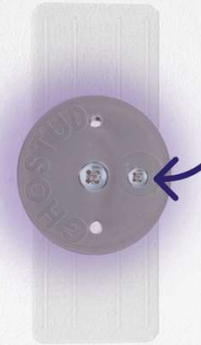

Mount object by screwing directly into the wall plug.

3



Mount object by screwing through drywall into the backplate.

4



Mount object by screwing through drywall into the backplate.

**\*We recommend drilling a pilot hole prior to screwing into GHOSTUD**