

2023 PRODUCT CATALOG

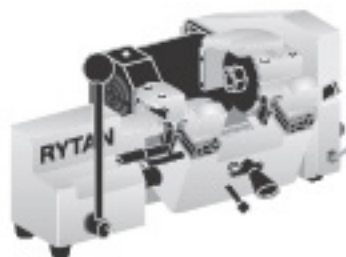

1648 W 134th St, Gardena CA 90249
P: (800)447-9826 | (310)328-6553
WWW.RYTAN.COM

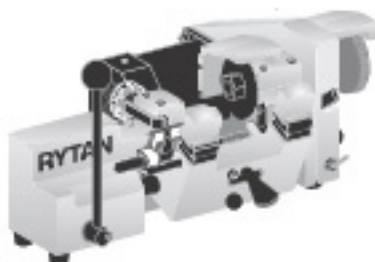

CUSTOMER_SERVICE@RYTAN.COM
SHOP ONLINE AT WWW.RYTAN.COM



HIGH SPEED KITS

Great if you cut a lot of keys, and/or silver nickel key blanks. These kits come with our RY225 Carbide Cutter, and can be installed to upgrade your RY100 or RY200



For your RY100: RY104 Kit

includes all hardware plus
 RY225 Carbide Cutter
 High Speed Pulleys
 RY9039 Belt
 RY20028 Stylus
MSRP \$568.09

For your RY200: RY103 Kit

includes all hardware plus
 RY225 Carbide Cutter
 High Speed Pulleys
 RY9039 Belt
MSRP \$511.09

RY215 CLEAR CUTTER SHIELD

Can be installed on your
 RY100 or RY200 Key
 Duplicating Machine
 MSRP \$22.86

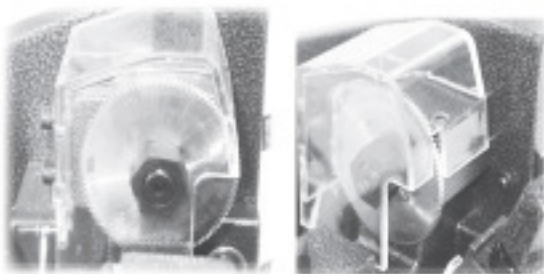
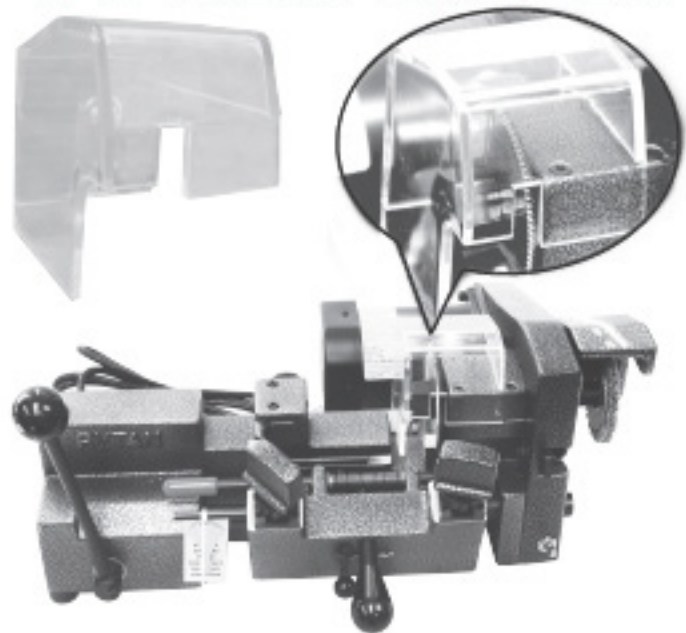

We repair and refurbish ALL machine models!

RY45 | RY100 | RY200 | RY256 | RY456 | RY2000

HOW IT WORKS Package your machine VERY securely and send it to our warehouse at 1648 W 134th Street, Gardena CA 90249. Include a note with your name, contact info, and the issue you are having. Once we receive the machine, our tech will provide the office staff with a repair write-up, including all the parts needed for repair. Our office staff will use that to generate a quote and give you a call!



TURNAROUND TIME Our typical turnaround time is 24-48 hours, provided all parts are in stock. This does not include time for transit.

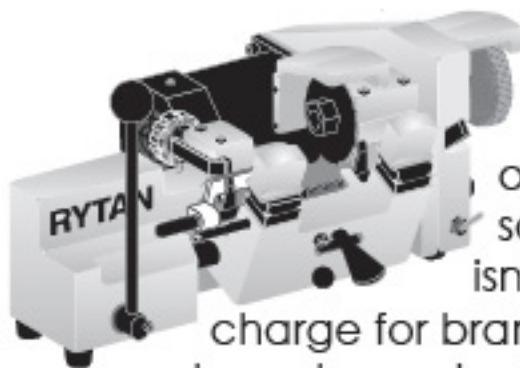

THE COST We can't quote a repair without first seeing the machine. Parts are charged the same price you will find on our website, plus labor and shipping, and sales tax where applicable. If your machine isn't sent to us securely, there is a \$15.99 charge for brand new secure packaging. Labor rates vary and are dependent upon the repairs that need to be made and the overall size of the job. Call for more information!

NEED TO UPGRADE? If your machine is fine but you want to upgrade it, we can do that for you too! See page 8 for more information on machine conversions and upgrades. Much like repairs, parts are charged the same price you will find on our website, plus labor and shipping, and sales tax where applicable. We can install any and all new accessories on your machine that you would like!

RY100

HIGH SPEED

Universal, Semi-Automatic Key-Duplicating Machine

DESIGNED & MANUFACTURED
IN THE U.S.A.

Ryтан 4
INCORPORATED

115V, 60hz AC Motor
OR
12V DC Motor

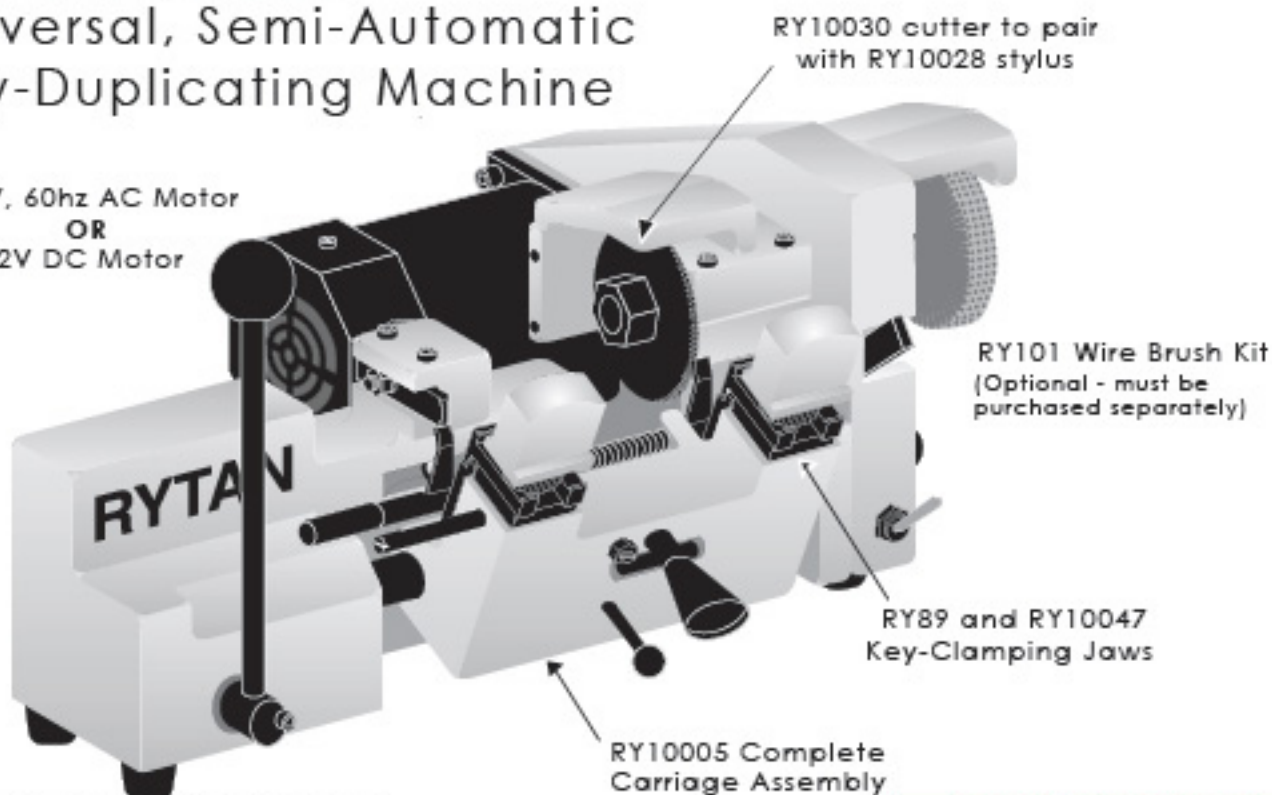

SUGGESTED RETAIL PRICE

RY100	Standard, AC Motor	\$1,217.30
RY100DC	Standard, DC Motor	\$1,289.30
RY100SL	Slotter, AC Motor	\$1,477.49
RY100DCSL	Slotter, DC Motor	\$1,549.49
RY100HS	Carbide Cutter	\$1,530.98

MACHINE SPECS

Machine Weight 32lbs
Shipping Weight 39 lbs
Width 16 in.
Depth 13 in.
Height 8 in.

Fast and Accurate. High-speed "stick shift" key cutting action works faster, smoother, and more accurately than any other machine on the market.

Premium Quality. Precision machined parts made in Ryтан's SoCal factory assure you of a top quality machine with accurate and precise key copying.

Advanced Features. Unique full-function key gauging. Built in cutter shaft lock. Heavy-duty ball bearing motor. Wide spaced vise jaws to hold large headed keys, and flip for deep cuts.

Affordably Priced. A premium, high-value key machine guaranteed to hold value.

Built to Last. The RY100's heavy-duty construction is built to take the most demanding use in the toughest work environment.

Factory Support. When you call the Ryтан factory, you are talking to the team that makes and understands the products we sell.

Shop or Van Use. The RY100's powerful 115V AC Motor for your shop is also Redi-Line® compatible for the mobile locksmith. No Redi-Line®? Order the RY100DC.

Room to add. Check out our various accessories, like a lamp kit, brush kit, and more.

RY200

HIGH SPEED

Universal, Semi-Automatic
Key-Duplicating Machine with
4-way Jaws

DESIGNED & MANUFACTURED
IN THE U.S.A.

RyTan 5
INCORPORATED

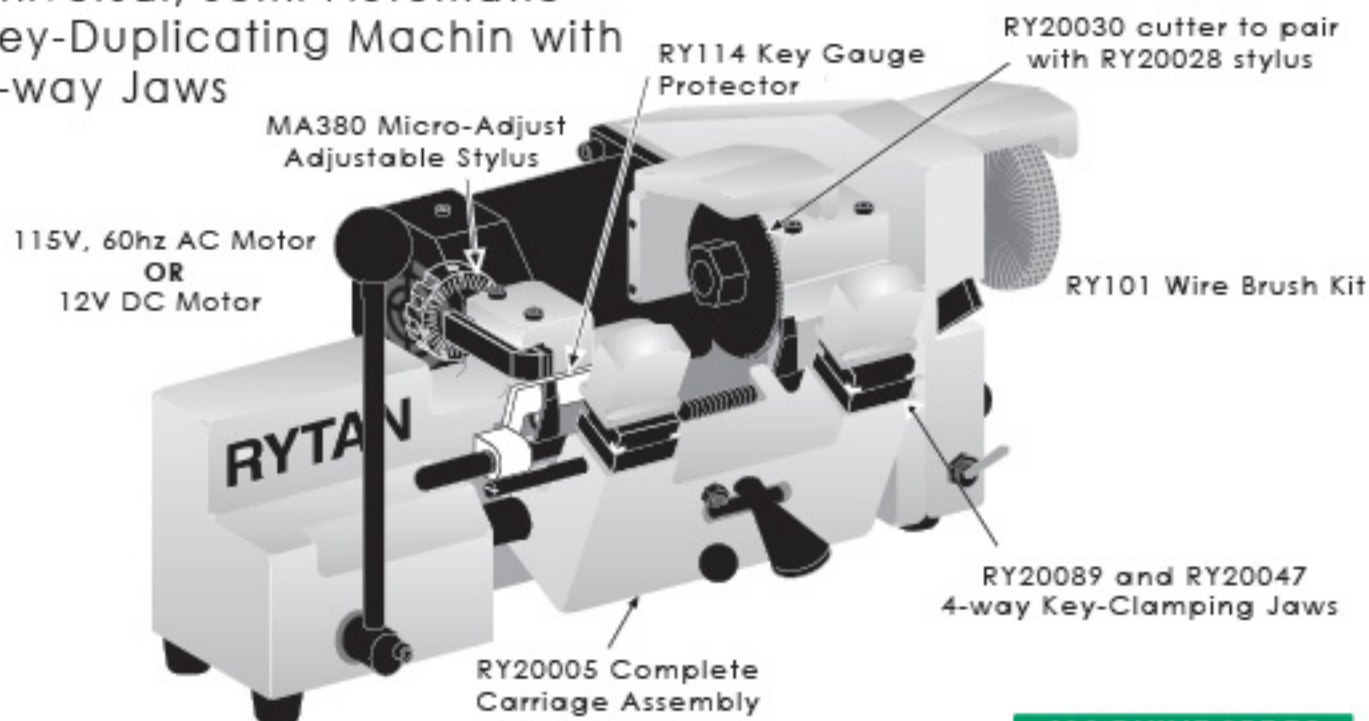

SUGGESTED RETAIL PRICE

RY200	Standard, AC Motor	\$1,487.77
RY200DC	Standard, DC Motor	\$1,559.77
RY200SL	Slotter, AC Motor	\$1,694.08
RY200HS	Carbide Cutter	\$1,790.63

MACHINE SPECS

Machine Weight 32 lbs
Shipping Weight 40 lbs
Width 16 in.
Depth 13 in.
Height 8 in.

Our RY100 with increased key-cutting capabilities and accessories included for ease of use!

RY20005 - Complete carriage assembly with 4-WAY vise jaws to accommodate more keyways | **RY114** - Key Gauge Protector to prevent gauge and cutter contact | **MA380** - Adjustable stylus to control depth of cuts with a simple dial turn | **RY101** - Wire brush kit for instant key deburring

Fast and Accurate. High-speed "stick shift" key cutting action works faster, smoother, and more accurately than any other machine on the market.

Premium Quality. Precision machined parts made in RyTan's SoCal factory assure you of a top quality machine with accurate and precise key copying.

Advanced Features. Unique full-function key gauging. Built in cutter shaft lock. Heavy-duty ball bearing motor. Wide spaced vise jaws to hold large headed keys, and rotate to accommodate more keyways.

Affordably Priced. A premium, high-value key machine guaranteed to hold value.

RY256

HIGH SPEED

Universal, Semi-Automatic
Key-Duplicating Machine
with Medeco Capabilities

DESIGNED & MANUFACTURED
IN THE U.S.A.

Ryтан 6
INCORPORATED

115V, 60hz AC Motor
OR
12V DC Motor

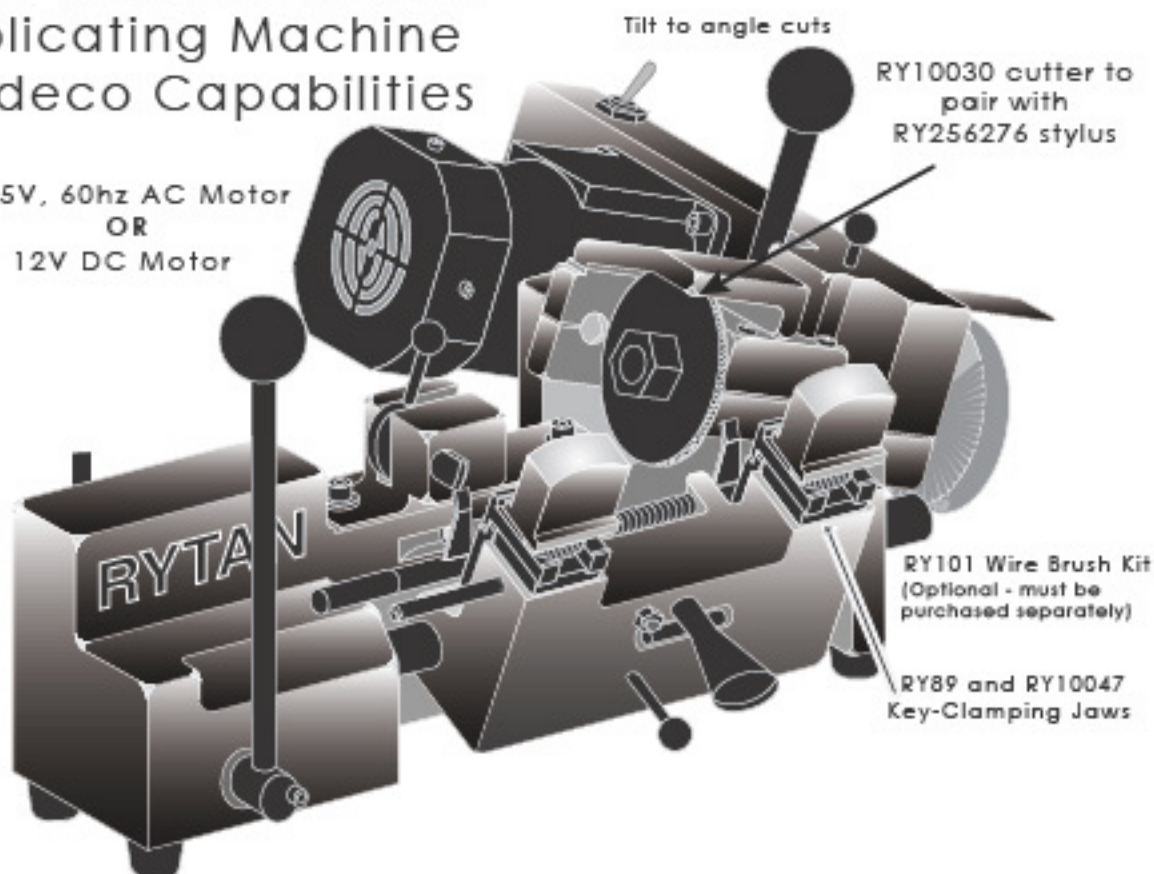

SUGGESTED RETAIL PRICE

RY256	AC Motor	\$1,694.59
RY256DC	DC Motor	\$1,766.59

Duplicate Medeco. Duplicate standard cylinder keys, automotive keys AND Medeco keys on this versatile machine with a tilting stylus and cutter head.

Fast and Accurate. High-speed "stick shift" key cutting action works faster, smoother, and more accurately than any other machine on the market.

Premium Quality. Precision machined parts made in Ryтан's SoCal factory assure you of a top quality machine with accurate and precise key copying.

Advanced Features. Unique full-function key gauging. Built in cutter shaft lock. Heavy-duty ball bearing motor. Wide spaced vise jaws to hold large headed keys, and flip for deep cuts.

Affordably Priced. A premium, high-value key machine guaranteed to hold value.

Built to Last. The RY256's heavy-duty construction is built to take the most demanding use in the toughest work environment.

Factory Support. When you call the Ryтан factory, you are talking to the team that makes and understands the products we sell.

Shop or Van Use. The RY256's powerful 115V AC Motor for your shop is also Redi-Line® compatible for the mobile locksmith. No Redi-Line®? Order the RY256DC

RY456

HIGH SPEED

Universal, Semi-Automatic Key-Duplicating Machine with 4-way jaws and Medeco Capabilities

DESIGNED & MANUFACTURED
IN THE U.S.A.

Tilt to angle cuts

115V, 60hz AC Motor
OR
12V DC Motor

RY20030 cutter to pair with
RY456276 stylus

MA380 Micro-Adjust
Adjustable Stylus

RY114 Key Gauge
Protector

RY101 Wire
Brush Kit

RY20089 and RY20047
4-way Key-Clamping Jaws

RY20005 Complete
Carriage Assembly

MACHINE SPECS

Machine Weight 37 lbs
Shipping Weight 45 lbs
Width 16 in.
Depth 13 in.
Height 12 in.

SUGGESTED RETAIL PRICE

RY456	AC Motor	\$1,964.99
RY456DC	DC Motor	\$2,036.99

Our RY256 with increased key-cutting capabilities and accessories included for ease of use!

RY20005 - Complete carriage assembly with 4-WAY vise jaws to accommodate more keyways as well as Medeco | **RY114** - Key Gauge Protector to prevent gauge and cutter contact | **MA380** - Adjustable stylus to control depth of cuts with a simple dial turn | **RY101** - Wire brush kit for instant key deburring

Fast and Accurate. High-speed "stick shift" key cutting action works faster, smoother, and more accurately than any other machine on the market.

Premium Quality. Precision machined parts made in Rytan's SoCal factory assure you of a top quality machine with accurate and precise key copying.

Advanced Features. Unique full-function key gauging. Built in cutter shaft lock. Heavy-duty ball bearing motor. Wide spaced vise jaws to hold large headed keys, and rotate to accommodate more keyways.

Affordably Priced. A premium, high-value key machine guaranteed to hold value.

CONVERT YOUR MACHINE!

Upgrade your RY100 to a RY200, or your RY256 to a RY456

Add an adjustable stylus to control depth of cuts with the simple turn of a dial (see below)

RY114 \$41.79 MSRP

Add the KEY GAUGE PROTECTOR to prevent cutter and key gauge contact

Upgrade your cutter and stylus combination for a complete conversion (see below)

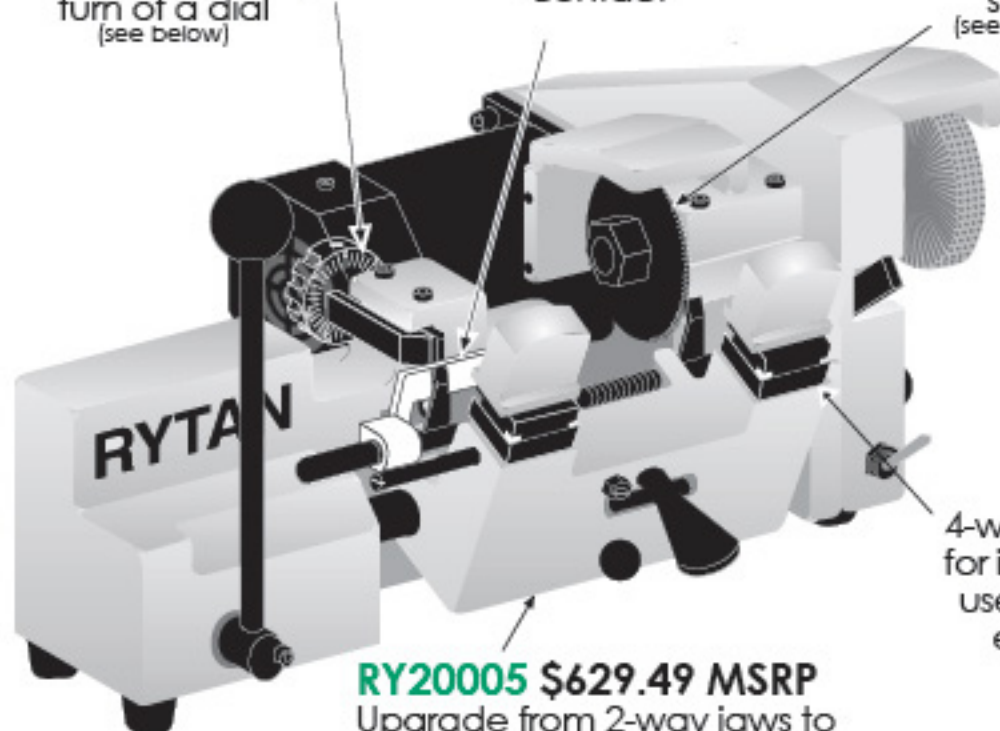

RY101 \$61.78 MSRP

Add the BRUSH KIT for easy and instant key deburring!

4-way vise jaws allow for increased ease of use for a wider variety of keyways!

RY20005 \$629.49 MSRP

Upgrade from 2-way jaws to 4-way with this COMPLETE carriage assembly - just pop onto your machine right out of the box!

CUTTER/STYLUS CONVERSION

RY100 to RY200: Purchase the **RY20030** Cutter (MSRP \$178.03) and the **RY20028** Stylus (MSRP \$61.24) RY10030/10028 and RY20030/20028 must always be paired for accurate cutting

RY256 to RY456: Purchase the **RY20030** Cutter (MSRP \$178.03) and the **RY456276** Stylus (MSRP \$61.24) RY10030/256276 and RY20030/456276 must always be paired for accurate cutting

MICROADJUST ADD-ON

RY100/RY200: Purchase the **MA380** (MSRP \$83.50) to install with your existing stylus.

RY256/RY456: Purchase the **MA480** (MSRP \$83.50) to install with your existing stylus.

MicroAdjust

ADJUSTABLE STYLUS

Adjust to better than 1/2 Thousandth (.0005") | Easy to install | Easy to calibrate and adjust | Works on RY100, RY200, RY256, and RY456

Use the MicroAdjust Adjustable stylus whenever you need to make a temporary adjustment, such as cutting worn keys. When you're finished, simply turn the dial back to "0" - it really is THAT easy

Can be ordered WITH a new stylus, or added to your existing stylus

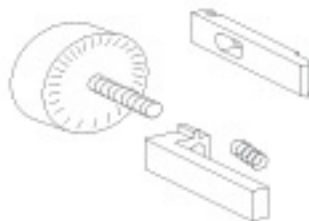

MA380 Micro-Adjust Adjustable Stylus

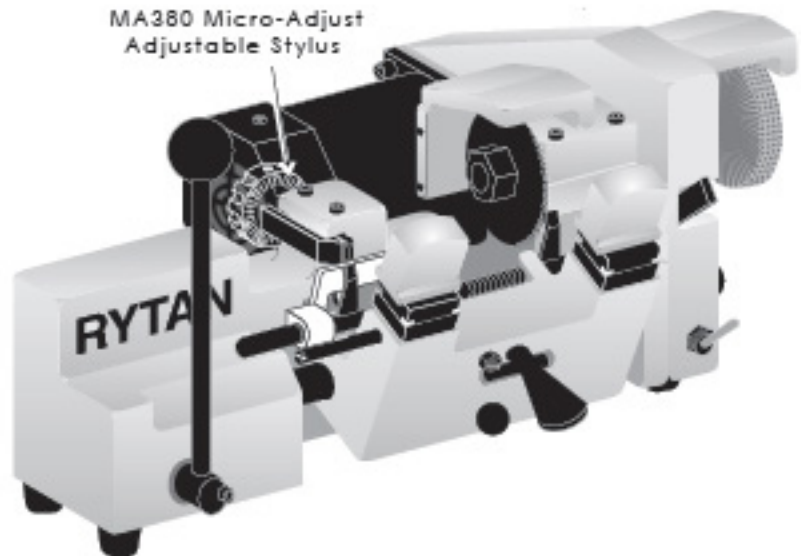

If you want a new stylus with your MicroAdjust
MSRP \$128.01

MA375 - For use on RY100 with your RY10030 cutter. Comes with MicroAdjust and new RY10028 Stylus

RY200375 - For use on RY200 with your RY20030 cutter. Comes with MicroAdjust and new RY20028 Stylus.

MA475 - For use on RY256 with your RY10030 cutter. Comes with MicroAdjust and new RY256276 Stylus

RY456375 - For use on RY456 with your RY20030 cutter. Comes with MicroAdjust and new RY456276 Stylus

If you want to add a MicroAdjust to your existing stylus
MSRP \$83.50

MA380 - use on your RY100 or RY200 with your RY10028 or RY20028 stylus.

MA480 - use on your RY256 or RY456 with your RY256276 or RY456276 stylus

RY114 KEY GAUGE PROTECTOR

FITS MACHINE MODELS RY100, RY200, RY256, RY456



The RY114 Key Gauge Protector protects your machine's key gauge from being accidentally cut into. It prevents contact between the key gauge and the blade when the key gauges are flipped up. A worthy investment for busy shops with multiple employees.

MSRP
\$41.79



RY9074 DEBURRING BRUSH MSRP \$19.54

FITS ALL MACHINE MODELS

This soft Nylon wire brush is the safest wire brush you can use on your Rytan Key Machine. The soft Nylon bristles help prevent pulling the key into the brush while deburring the key. Use with the RY101 Wire Brush Kit.

REPLACEMENT STANDARD STYLUS FOR RY100 & RY200 KEY MACHINES MSRP \$ 61.24

This is an exact replacement for the precision machined, heat treated tool steel stylus on your RY100 or RY200. Periodically check the tip of your stylus for wear - it should always be nearly sharp. A dull stylus will cause your duplicate keys to have narrower pin seats and depths will vary.



Order RY10028 for your RY100

Order RY20028 for your RY200



RY9039 REPLACEMENT BELT MSRP \$ 23.52

FITS MACHINE MODELS RY100, RY200

This is an exact replacement for the fiber reinforced 60° V-belt that came with your machine. NOTE: DO NOT FORCE THE BELT OVER THE PULLEYS WHEN INSTALLING THE BELT. Always loosen the motor mounting screws then slip on the belt. Then tighten the belt tension with the motor and then tighten the motor mounting screws.

RY9040 POWER CORD MSRP \$16.68

FITS ALL MACHINE MODELS WITH AC MOTOR

This is an exact replacement power cord for your 115 Volt A.C. Rytan key machine.



RY9041 POWER SWITCH MSRP \$16.42

FITS ALL MACHINE MODELS

An exact replacement for the switch in your motorized Rytan key machine. Works on both 115 Volt A.C. & 12 Volt D.C. machines

RY39 AUXILLARY LAMP KIT MSRP \$ 125.68

FITS RY100, RY200, RY256, RY456

For increased visibility and safety. Is fully adjustable with its own on/off switch and power cord. Comes with hardware to mount on your Ryтан Key Machine. Use 40 watt, 115 volt A.C. bulb (not included)

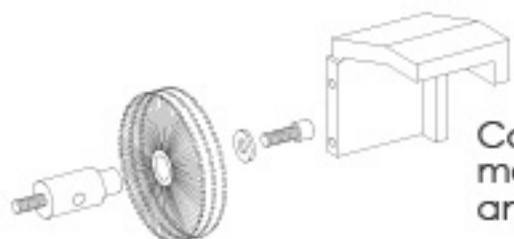

RY101 BRUSH KIT MSRP \$ 61.78

FITS ALL MODELS

Complete kit to attach to the outside of your key machine. Brush will spin as machine is turned on and cutter spins. Easily deburr freshly cut keys.

RY89 QUICK-CHANGE REVERSIBLE TOP JAW

MSRP \$ 45.12

FITS RY100, RY256



Precision machined from milled steel PM material, vise jaws are critical to maintaining your key machine's accuracy. Periodically inspect for signs of wear, mushroom, or damage from the cutting wheel.

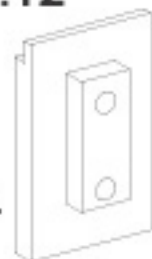

RY10047 BOTTOM VISE JAW MSRP \$ 45.12

RY2006 VISE JAW CARTRIDGE MSRP \$ 212.04

FITS RY200, RY456

Replaceable cartridge with all parts shown, including new top vise jaw and bottom vise jaw

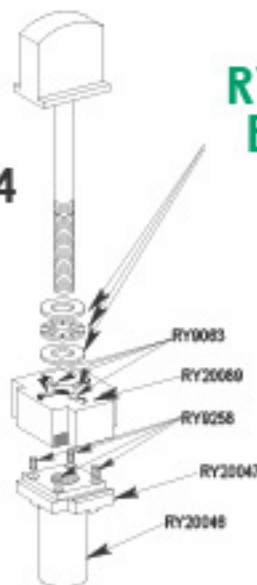

RY82 KEY VISE THRUST BEARING ASSEMBLY

MSRP \$ 9.59

FITS ALL MODELS

These thrust bearings are important to maintain the integrity of your Ryтан Machine's key clamping.

RY83 CARRIAGE DRIVE LINKAGE SET MSRP \$ 40.05

FITS ALL MODELS



Use this kit to restore the original feel of your machine's high-speed stick-shift carriage drive mechanism.

RY9059 DRIVE LINKAGE SHOULDER SCREW

MSRP \$ 6.12

FITS ALL MODELS

Replacement for a broken drive linkage shoulder screw only. Reduce the chance of breakage in mobile units by releasing and securing your carriage against a piece of cardboard placed between the carriage vises and the cutter/stylus when driving.

REPLACING YOUR CUTTER

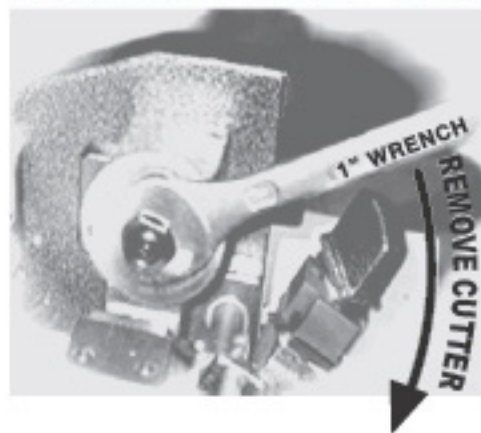

WHILE TURNING THE CUTTER BY HAND:
RY100, RY200, RY45: Press **DOWN** on the cutter shaft lock and **HOLD** until cutter **CLICKS** and stops. Continue holding the cutter shaft lock **DOWN** and remove cutter nut as illustrated.

RY256, RY456: Press **DOWN** on the small round black knob until the cutter **CLICKS** and stops.



RY10030 STANDARD REPLACEMENT CUTTER

MSRP \$178.03

COMES STANDARD ON RY100, RY256, RY45

Our standard key duplicating machine cutter, used to cut standard cylinder keys and Medeco. Comes on the RY100, RY256, and RY45. Can fit any machine - Must be used with RY10028 or RY256276 stylus.

RY20030 STANDARD REPLACEMENT CUTTER

MSRP \$178.03

COMES STANDARD ON RY200, RY456, RY65

With this cutter you can cut keys like GM and Kwikset Titans First cut with one side straight, in addition to standard cylinder keys and Medeco. Comes on the RY200, RY456, and RY65. Can fit any machine - Must be used with RY20028 or RY456276 stylus.



RY115 REPLACEMENT SLOTTER CUTTER

STANDARD ON RY100SL,
RY200SL, RY45SL.

MSRP \$233.67



Cutter width is .045". Cutter material is solid carbide for maximum cutter life. The RY115 CANNOT be used for side milling. Wide cuts must be made by using a series of plunge cuts next to each other.

RY84 BALL BEARING ASSEMBLY

RyTan 13
INCORPORATED

FITS MACHINE MODELS RY100,
RY200, RY256, RY456

MSRP \$96.55

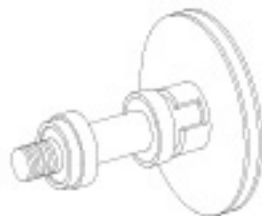

This precision ball bearing spindle assembly is pressed at our factory with 12k pounds of pressure. This spindle is made from a solid billet of steel, heat treated and precision ground, and spins on wide spaced, oversized sealed ball bearings. Order RY42 for your RY45/RY65.

RY85 CARRIAGE SPRING ASSEMBLY MSRP \$14.05

FITS MACHINE MODELS RY100, RY200, RY256, RY456

Replace weak or broken carriage spring and lost or worn pins as an assembly to restore your machine's semi-automatic stick-shift speed and versatility. Purchase just the spring, RY10025 at \$6.74 MSRP.



RY86 CARRIAGE RELEASE ASSEMBLY MSRP \$22.99

FITS MACHINE MODELS RY100, RY200, RY256, RY456



Replace worn carriage release assembly. Requires removal of the machine's drive linkage and carriage shaft.

RY81 KEY GAUGE ASSEMBLY MSRP \$75.75

FITS MACHINE MODELS RY100, RY200, RY256, RY456

Everything you need to replace a worn or cut up key gauge assembly. Comes ready to install on your RyTan key duplicating machine.

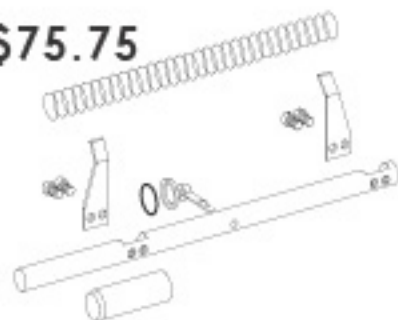

RY88 12 VOLT D.C. MOTOR MSRP \$312.79

FITS ALL MODELS

Use this motor to convert your 115 volt A.C. key machine to a 12 volt D.C. machine for your service van. Use the RY99 wiring kit (not included) to connect to your battery.



RY99 12 VOLT D.C. MOTOR WIRING KIT MSRP \$45.64

FITS ALL MODELS

Kit includes a 12 amp Slo-Blo fuse



SLOTTER KIT FOR RY100 & RY200 KEY MACHINES
FITS MACHINE MODELS RY100 & RY200

This is a quick change slotter kit with built-in depth adjustment. Use this kit to convert your standard RY100 key duplicator or RY200 duplicator with 4-way jaws, to a heavy-duty slotter key duplicator. NOTE: You can switch back to a semiautomatic cylindrical key duplicator with the quick-change standard stylus included.

MSRP \$ 446.99

Order RY111 to add to your RY100

Order RY222 to add to your RY200

QUICK-CHANGE STYLUS KIT FOR SLOTTER KEY MACHINES MSRP \$ 278.19

FITS MACHINE MODELS RY100SL & RY200SL

This is a quick-change standard stylus kit with built in depth adjustment and standard Rytan cutter. Use this to kit to convert your RY100SL or RY200SL to a heavy-duty cylindrical key duplicator.

Order RY120 to add to your RY100SL

Order RY220 to add to your RY200SL



QUICK-CHANGE STANDARD STYLUS MSRP \$ 278.19

FITS MACHINE MODELS RY100SL & RY200SL

Replacement quick-change standard stylus. Has built in depth adjustment.

Use with your standard cutter and RY111 Slotter Kit.

Order RY118 to replace on your RY100SL with RY10030 Cutter

Order RY218 to replace on your RY200SL with RY20030 Cutter



RY9085 REPLACEMENT BELT MSRP \$ 23.52

FITS MACHINE MODELS RY256, RY456, RY45, RY65

This is an exact replacement for the fiber reinforced 60° V-belt that came with your machine. NOTE: DO NOT FORCE THE BELT OVER THE PULLEYS DURING INSTALLATION. When installing a belt on the RY45/Ry65 always loosen the motor mounting screws, then slip on the belt and tighten the belt tension with the motor and then tighten the motor mounting screws. On the RY256/Ry456 loosen the idler bearing then slip on the belt and tighten the idler bearing socket head cap screws.

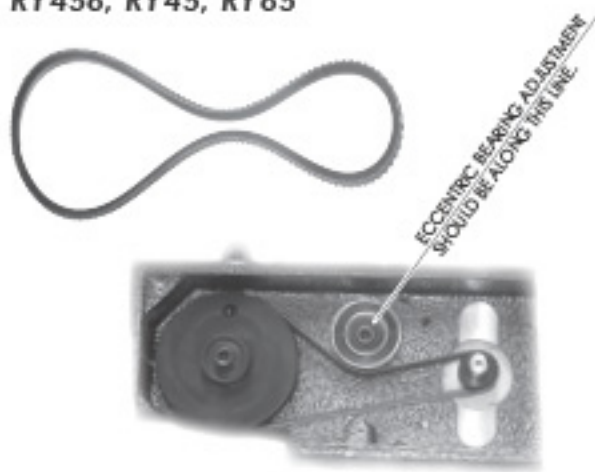

RY49 TOP VISE JAW ASSEMBLY

FITS RY45 & RY65 | MSRP \$61.24 each

Precision machined from milled steel, these vise jaw assemblies are critical to maintaining your key machine's accuracy. Periodically inspect all jaws for signs of wear or mushrooming of the clamping surfaces which can occur if you cut a lot of double sided steel foreign automotive keys.



RY4507 NARROW BOTTOM VISE JAW

FITS RY45 & RY65
MSRP \$30.04 each



RY4507 STANDARD BOTTOM VISE JAW

FITS RY45 & RY65
MSRP \$30.04 each

REPLACEMENT STANDARD STYLUS FOR RY45, RY65, RY256 AND RY456 KEY MACHINES MSRP \$ 61.24

Use this standard cylindrical key and Medeco® stylus to restore your key machine to original key duplication accuracy. Periodically check the tip of your stylus for wear - it should always be nearly sharp. A dull stylus will cause your duplicate keys to have narrower pin seats and depths will vary.

Order RY256276 for your RY45/RY256 with RY10030 Cutter

Order RY456276 for your RY65/RY456 with RY20030 Cutter



RY47 SLOTTER KIT MSRP \$ 328.31

FITS RY45

Use this kit to convert your RY45 cylindrical key duplicator to a manual flat key duplicator. Cutter width is .045". Cutter material is solid carbide for maximum cutter life. The RY115 solid carbide cutter is used for making plunge cuts ONLY and CAN NOT BE USED FOR SIDE MILLING. Wide cuts must be made by using a series of plunge cuts next to each other.



R~~Y~~2000 Part List

- | | |
|-----------------------------------|---|
| 1) RY2001 Machine Base | 40) RY2040 RH Upright |
| 2) RY2002 Drive Cam | 40) RY2040 LH Upright |
| 3) RY2003 Punch Drive Cam | 41) RY2041 Dowel Pin |
| 4) RY2004 Lever | 42) RY2042 B.H. Screw |
| 5) RY2005 Lever Handle | 43) RY2043 Pillow Block |
| 6) RY2006 Vise Base | 44) RY2044 Cap Screw |
| 7) RY2007 Top Jaw | 45) RY2045 Secondary Pin |
| 8) RY40__SB Space Bar | 46) RY2046 Dowel Pin |
| 9) RY60__PD Punch & Die | 47) RY2047 Escapement Cover |
| 10) RY60__PD Punch & Die | 48) RY2048 Index Pin |
| 11) RY2011 Punch Driver | 49) RY2049 Lamina Spring |
| 12) RY2012 Spring Pin | 51) RY2051 Dowel Pin |
| 13) RY9104 Screw Knob | 52) RY2052 Rubber Foot |
| 14) RY2014 Pin | 53) RY2053 Dowel Pin |
| 15) RY2015 Tip Stop (I-Core only) | 54) RY2054 Drive Shaft |
| 16) RY2016 Key Clamp Knob | 56) RY2056 Stop (for Dual Machines) |
| 17) RY2017 Key Clamp Bearing | 57) RY2057 Screw Knob |
| 18) RY2018 Spring | 58) RY2058 Philister Screw |
| 19) RY2019 Key Clamp Stud | 59) RY2059 Roll Pin |
| 20) RY2020 Dowel Pin | 60) RY2060 Cap Screw |
| 21) RY2021 Dowel Pin | 61) RY2061 Set Screw |
| 22) RY9088 Steel Ball | 62) RY2062 Nylon Ball |
| 23) RY50__DS Depth Selector | 63) RY2063 Set Screw |
| 24) RY9081 Bar Spring | 64) RY2064 Nylon Retaining Ring |
| 25) RY2025 Depth Adj. Block | 66) RY2066 Cap Screw |
| 26) RY2026RH Depth Driver | 67) RY2067 Cap Screw |
| RY2026LH Depth Driver | 68) RY2068 Set Screw |
| 27) RY2027 Depth Bar Spring | 69) RY2069 Cap Screw |
| 28) RY2028 Ball Bearing Assembly | 70) RY2070 Cap Screw |
| 29) RY2029 Punch & Die Spring | 72) RY2072 Dowel Pin |
| 30) RY2030 Carriage Spring | 73) RY2073 Truarc Ret. Ring |
| 31) RY2031 Escapement | 74) RY2074 Set Screw |
| 32) RY2032 Escapement Spring | 75) RY2075 Top Shoulder Stop |
| 33) RY2033 Set Screw | 76) RY2076 Bellville Disk Spring Washer |
| 34) RY2034 Extension Spring | 79) RY2079 Cap Screw |
| 35) RY2035 Lever Spring | 80) RY2080 Black Locking Button Head
Screw |
| 36) RY10027 Retaining Pin | 81) RY2081 Set Screw |
| 37) RY2037 Main Shaft | 90) RY2090 Truarc Ret. Ring |
| 38) RY2038 Depth Selector Label | 91) RY2091 Tension Spring |
| 39) RY9241 Roll Pin | |

FOR TECHNICAL HELP CALL TOLL FREE • (800) • 447 • 9826

RY2000 PUNCH MACHINE

EXPLODED VIEW

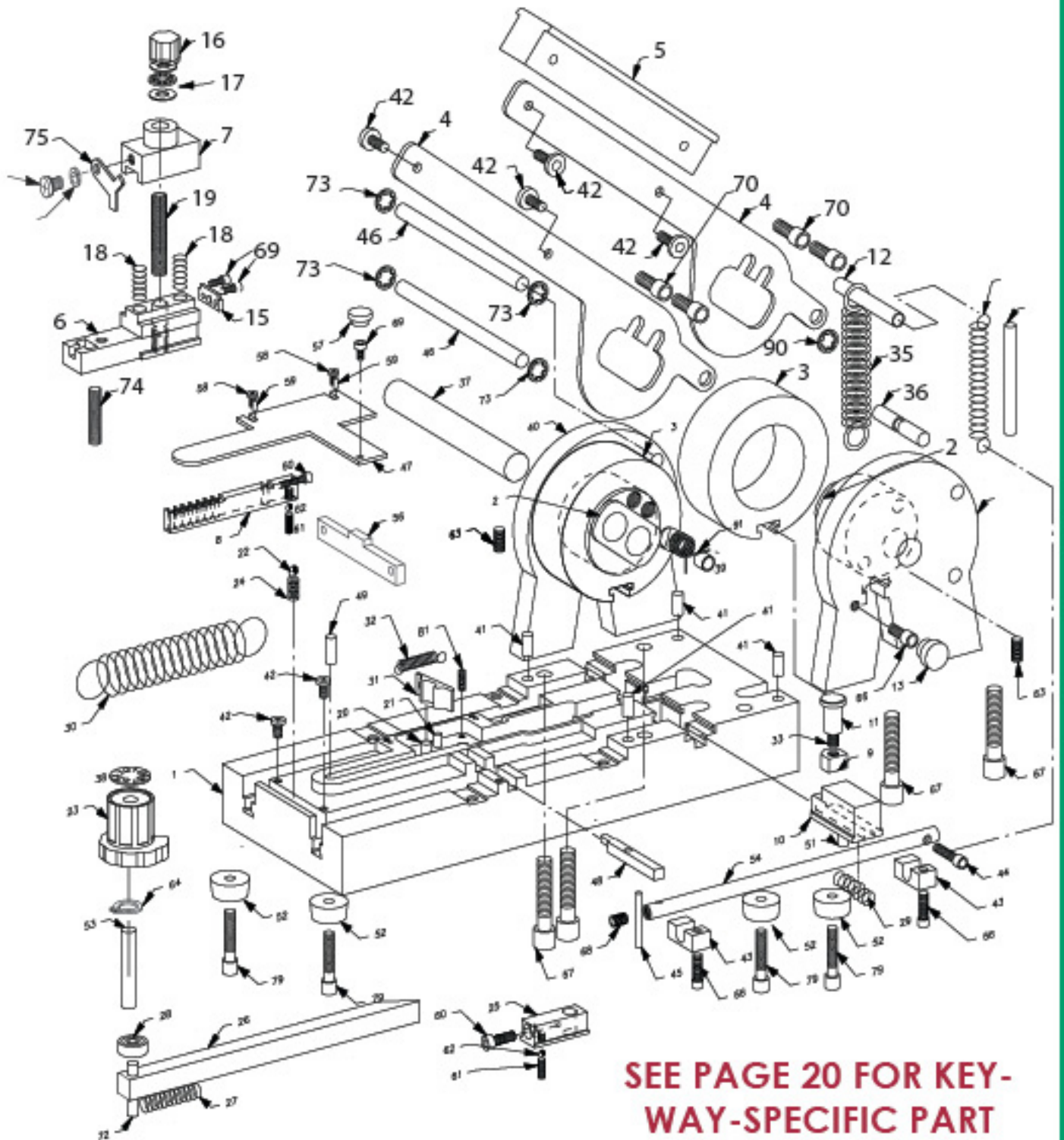

**SEE PAGE 20 FOR KEY-
WAY-SPECIFIC PART
NUMBERS**

PRICES ARE SUBJECT TO CHANGE WITHOUT NOTICE***SEE TERMS AND CONDITIONS

Call for an Appointment to tour our SoCal Factory!

RY45 & RY65 Part List

- 2 - RY9069 Cap Screw
- 3- RY10038 A.C. Motor
- 7- RY9048 Set Screw
- 8- RY10037 Motor Pulley
- 11-RY115 Slotter Cutter (optional)
- 12-RY9046 Philips Screw
- 15-RY101 Wire Brush Kit (optional)
- 16-RY9074 Wire Brush
- 17-RY10101 Arbor
- 18-RY10030 Cutter for RY45
RY20030 Cutter for RY65
- 19-RY10036 Cutter Hex Nut (Left Hand)
- 23-RY9053 Strain Relief
- 25-RY10013 Guard
- 34-RY9145 Rubber Foot
- 35-RY9058 Cap Screw
- 36-RY9024 Bronze Oilite™ Bearing
- 41-RY9055 Hex Jam Nut
- 42-RY9041 Switch
- 44-RY10035 Cutter Shaft Lock
- 48-RY42 Ball Bearing Cutter Shaft Assembly
- 50-RY82 3-Piece Thrust Bearing Assembly
- 58-RY9107 Slot Head Screw
- 62- RY9061 Cap Screw
- 69- RY9003 Set Screw
- 89- RY9278 Vinyl Cap
- 87- RY10087 Carriage Over Travel Adjustment
- 104-RY9085 Drive Belt
- 114-RY256276 Stylus for RY45
RY456276 Stylus for RY65
- 115-RY9073 Steel Flat Washer
- 120-RY10039 Capacitor
- 121-RY10044 Capacitor Bracket
- 123-RY9087 Switch Plate
- 126-RY9083 Steel Ball
- 127-RY9089 Compression Spring
- 131-RY9042 Cap Screw
- 150-RY4501 Machine Base
- 151-RY4502 Carriage
- 152-RY49 Top Vise Jaw Assembly
- 153-RY4507 Standard Bottom Vise Jaw
- 154-RY4508 Narrow Bottom Vise Jaw
- 155-RY9035 Compression Spring
- 156-RY4527 Carriage Locking Screw Assembly
- 157-RY4506 Carriage Shaft
- 158-RY4512 Key Gauge Shaft
- 159-RY4515 Key Gauge L.H.
- 160-RY4513 Key Gauge R.H.
- 161-RY4503 Plate
- 162-RY4522 Stylus Plunger
- 163-RY4524 Compression Spring
- 164-RY4523 Locking Stud
- 165-RY4516 Depth Adj. Screw Assy.
- 167-RY4518 Stylus Lock
- 168-RY4517 Vise Jaw Clamp Screw Assembly
- 169-RY47 Slotter Kit (optional)
- 170-RY4521 Dual Stylus for RY45
RY6521 Dual Stylus for RY65

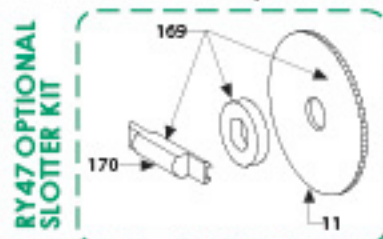

RYTAN RESERVES THE RIGHT TO MAKE CHANGES AT ANYTIME.

RY45 & RY65 MANUAL KEY MACHINE

EXPLODED VIEW

RYTAN RESERVES THE RIGHT TO
MAKE CHANGES AT ANYTIME.

RY101 - STANDARD ON RY65
OPTIONAL ADD-ON FOR RY45

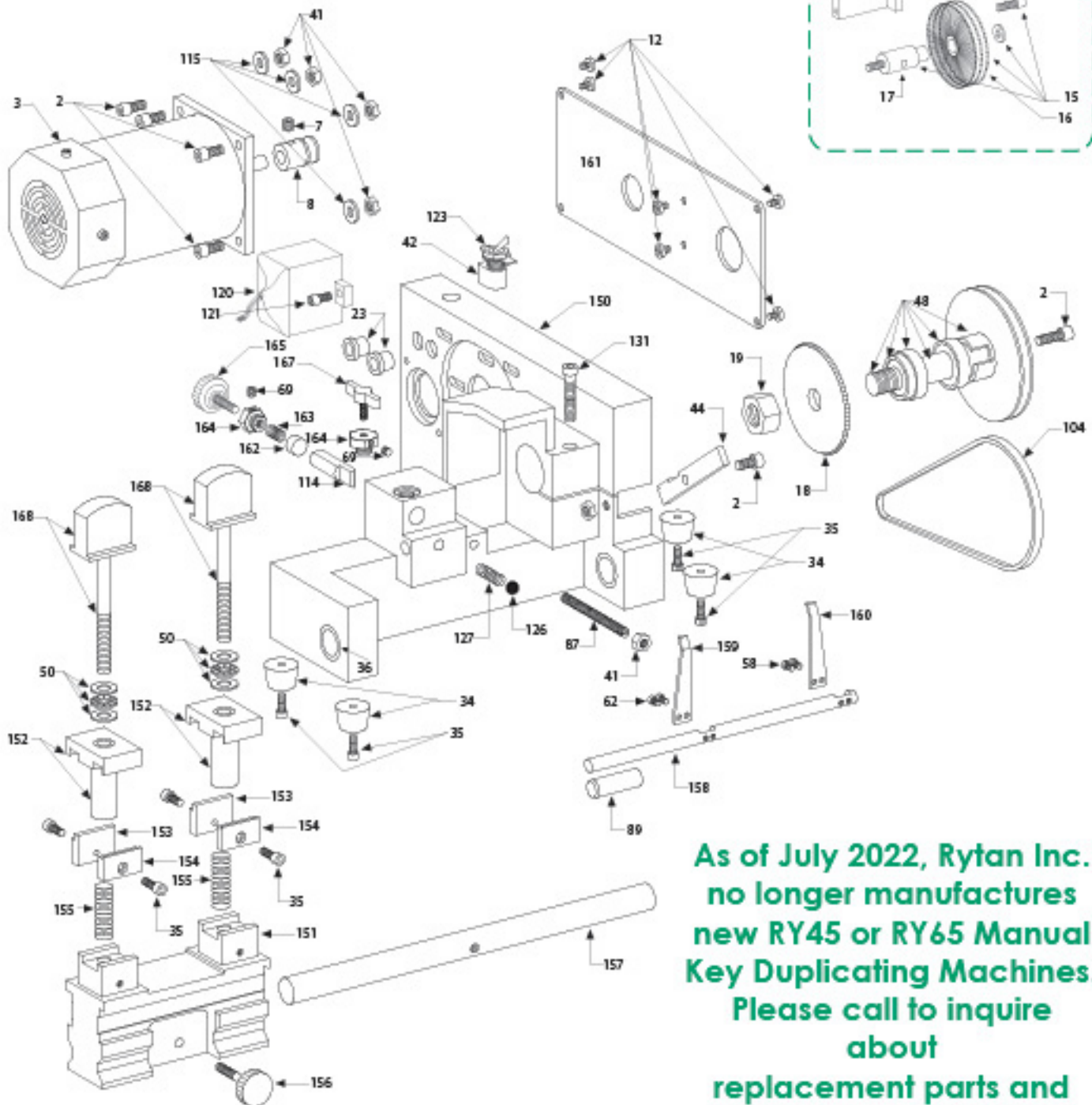
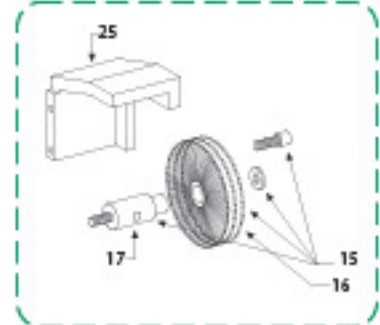

**As of July 2022, Rydan Inc.
no longer manufactures
new RY45 or RY65 Manual
Key Duplicating Machines.
Please call to inquire
about
replacement parts and
machine servicing.**

RY100 & RY200 Part List



EXPLODED VIEW & PART LIST

- 1- RY39 Lamp Kit (Optional)
- 2- RY9069 Cap Screw
- 3- RY10038 A.C. Motor
- 4- RY10033 Motor Mounting Plate
- 5- RY111 Slotter Kit for RY100 (Optional)
RY222 Slotter Kit for RY200 (Optional)
- 6- RY118 QC Stylus for RY100 (Optional)
RY218 QC Stylus for RY200 (Optional)
- 7- RY9048 Set Screw
- 8- RY10037 Motor Pulley
- 9- RY9039 Drive Belt
- 10-RY118
RY218 Slotter Stylus (optional)
- 11-RY115 Slotter Cutter (optional)
- 12-RY9046 Phillips Screw
- 13-RY10016 Belt Guard
- 14-RY9045 Set Screw for Arbor
- 15-RY101 Wire Brush Kit (optional)
- 16-RY9074 Replacement Wire Brush
- 17-RY10101 Arbor
- 18-RY10030 Cutter for RY100
RY20030 Cutter for RY200
- 19-RY10036 Cutter Hex Nut (Left Hand)
- 21-RY9054 Flat Head Screw
- 22-RY10012 Motor Bracket
- 23- RY9053 Strain Relief
- 24-RY9052 Bushing
- 25-RY10013 Guard
- 26-RY200375 Adjustable Stylus (optional)
- 28-RY9042 Cap Screw
- 29-RY9029 Set Screw
- 30-RY10029 Stylus Adjustment Knob
- 31-RY9056 Nylon Lock Nut
- 32-RY10028 Stylus for RY100
RY20028 Stylus for RY200
- 33-RY9057 Cap Screw
- 34-RY9145 Rubber Foot
- 35-RY9058 Cap Screw
- 36-RY9024 Bronze Oilite™ Bearing
- 37-RY10010 Machine Base
- 38-RY9044 Cap Screw
- 39-RY10039 Capacitor Assembly
- 40-RY9065 Cap Screw
- 41-RY9055 Hex Jam Nut
- 42-RY9041 Switch
- 44-RY10035 Cutter Shaft Lock
- 45-RY10017 Access Plate
- 48-RY84 Ball Bearing Spindle Assembly
- 49-RY80 Key Vise Knob & Stud
- 50-RY82 3-Piece Thrust Bearing Assy.
- 51-RY10041 Top Jaw Clamp Knob
- 52-RY89 Top Jaw for RY100
RY20089 Top Jaw for RY200
- 53-RY9063 Cap Screw
- 54-RY10045 Top Plate
- 55-RY10046 Vise Plunger for RY100
RY20046 Vise Plunger for RY200
- 56-RY9062 Cap Screw
- 57-RY10047 Bottom Jaw for RY100
RY20047 Bottom Jaw for RY200
- 58-RY9107 Slot Head Screw
- 59-RY10048 Key Gauge R.H.
- 60-RY9108 O-Ring
- 61-RY9279 Cotter Pin
- 62-RY9061 Cap Screw
- 63-RY10050 Key Gauge L.H.
- 64-RY10061 Key Gauge Spring
- 65-RY10049 Key Gauge Shaft
- 66-RY9027 Lever Knob
- 67-RY10018 Lever Shaft
- 68-RY114 Key Gauge Protector (RY200)
- 69-RY9003 Set Screw
- 70-RY9059 Shoulder Screw
- 71-RY10020 Drive Link
- 72-RY10019 Drive Shaft
- 75-RY10022 Carriage Shaft
- 76-RY10021 Shaft Link
- 77-RY10026 Carriage Shaft Spring Pin
- 78-RY10025 Carriage Extension Spring
- 79-RY9200 Retaining Pin
- 80-RY10056 Key Ring Stud
- 81-RY10023 Carriage Release Stud
- 82-RY9025 Carriage Release Spring
- 83-RY9038 Carriage Release Knob
- 84-RY9028 Carriage Knob
- 85-RY10086 Threaded Stud
- 86-RY10060 Knob Spacer
- 87-RY10087 Carriage Over-Travel
- 88-RY10011 Carriage for RY100
RY20011 Carriage for RY200
- 89-RY9278 Vinyl Cap
- 90-RY10067 Flat Washer
- 91-RY9047 Cap Screw
- 92-RY9273 Plastic Small Washer

RY39 - OPTIONAL LAMP KIT

**RY118 (100) or RY218 (200)
OPTIONAL QUICK-CHANGE
STYLUS**

**RY101 - STANDARD ON RY200
OPTIONAL ADD-ON FOR RY100**

**RY20075 - STANDARD ON RY200
OPTIONAL ADD-ON FOR RY100**

**NO ADD TO YOUR RY100!
MA375 - Includes new
RY10008 stylus
MA350 - knob, body and
spring to use with your
existing stylus**

**RY81 KEY
GAUGE ASSEMBLY**

**RY20005 - STANDARD ON RY200
ORDER TO CONVERT YOUR RY100**

**RY85 CARRIAGE
SPRING ASSEMBLY**

**RY86 CARRIAGE
RELEASE ASSEMBLY**

**RY83 CARRIAGE DRIVE
LINKAGE ASSEMBLY**

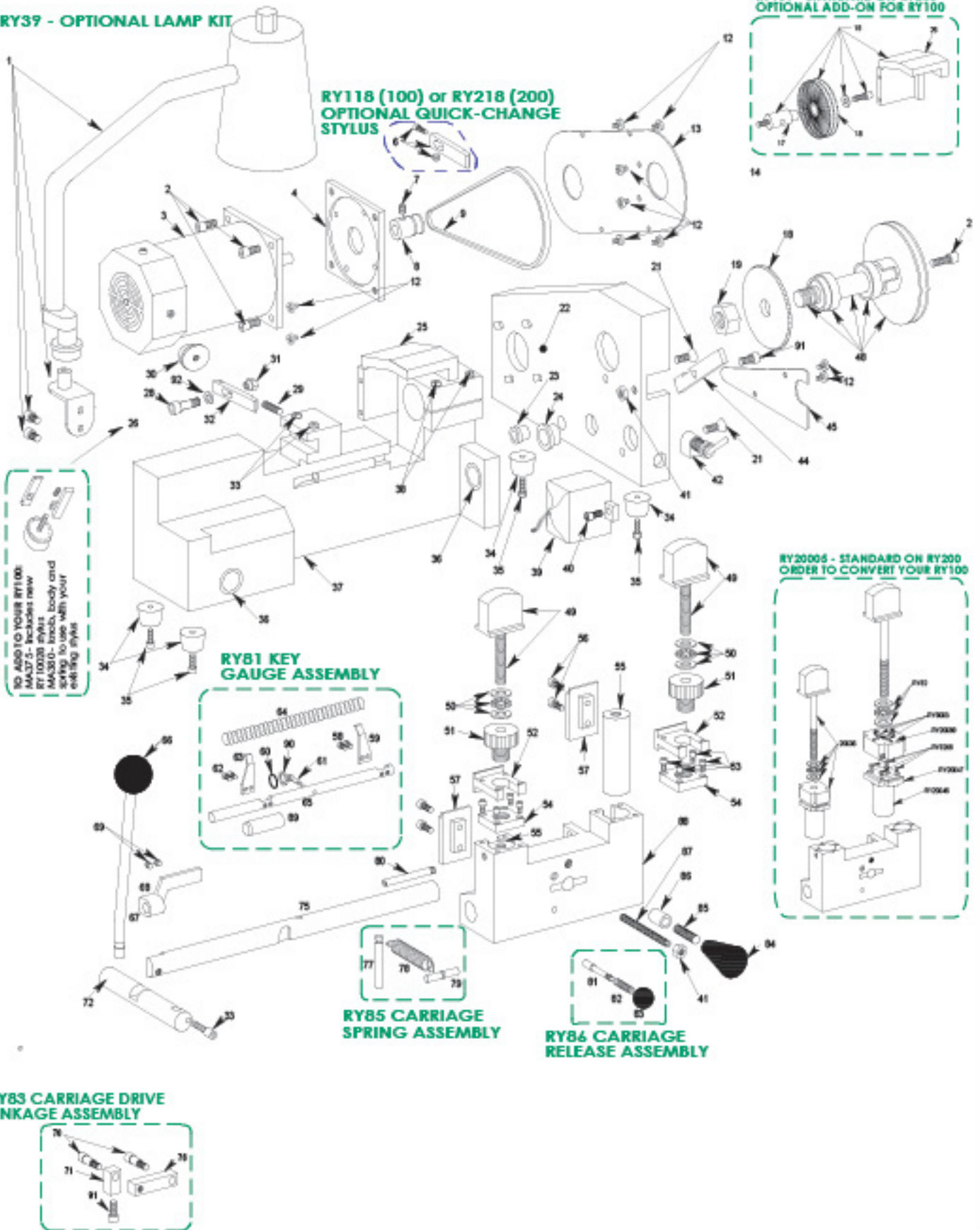

RY256 & RY456 Part List



- 1- RY39 Lamp Kit (optional)
- 2- RY9069 Cap Screw
- 3- RY10038 A.C. Motor
- 7- RY9048 Set Screw
- 8- RY10037 Motor Pulley
- 12- RY9046 Philips Screw
- 15- RY101 Wire Brush Kit (optional)
- 16- RY9074 Replacement Wire Brush
- 17- RY10101 Arbor
- 18- RY10030 Cutter for RY256
RY20030 Cutter for RY456
- 19- RY10036 Cutter Hex Nut (Left Hand)
- 20- RY9037 Ball Bearing Assembly
- 23- RY9053 Strain Relief
- 25- RY10013 Guard.
- 34- RY9145 Rubber Foot
- 35- RY9058 Cap Screw
- 36- RY9024 Bronze Oilite™ Bearing
- 41- RY9055 Hex Jam Nut
- 42- RY9041 Switch
- 48- RY84 Ball Bearing Spindle Assembly
- 49- RY80 Key Vise Knob & Stud
- 50- RY82 3-Piece Thrust Bearing Assy.
- 51- RY10041 Top Jaw Clamp Knob
- 52- RY89 Top Jaw for RY256
RY20089 Top Jaw for RY456
- 53- RY9063 Cap Screw
- 54- RY10045 Top Plate
- 55- RY10046 Vise Plunger for RY256
RY20046 Vise Plunger for RY456
- 56- RY9062 Cap Screw
- 57- RY10047 Bottom Jaw for RY256
RY20047 Bottom Jaw for RY456
- 58- RY9107 Slot Head Screw
- 59- RY10048 Key Gauge R.H.
- 60- RY9108 O-Ring
- 61- RY9279 Cotter Pin
- 62- RY9061 Cap Screw
- 63- RY10050 Key Gauge L.H.
- 64- RY10061 Key Gauge Spring
- 65- RY10049 Key Gauge Shaft
- 66- RY9027 Lever Knob
- 67- RY10018 Lever Shaft
- 68- RY114 Key Gauge Protector (optional)
- 69- RY9003 Set Screw
- 70- RY9059 Shoulder Screw
- 71- RY10020 Drive Link
- 72- RY10019 Drive Shaft
- 75- RY10022 Carriage Shaft
- 76- RY10021 Shaft Link
- 77- RY10026 Carriage Shaft Spring Pin
- 78- RY10025 Carriage Extension Spring
- 79- RY9200 Retaining Pin
- 80- RY10056 Key Ring Stud
- 81- RY10023 Carriage Release Stud
- 82- RY9025 Carriage Release Spring
- 83- RY9038 Carriage Release Knob
- 84- RY9028 Carriage Knob
- 85- RY10086 Threaded Stud
- 86- RY10060 Knob Spacer
- 87- RY10087 Carriage Over-Travel
- 88- RY10011 Carriage for RY256
RY20011 Carriage for RY456
- 89- RY9278 Vinyl Cap
- 90- RY10067 Flat Washer
- 91- RY9047 Cap Screw
- 100-RY256266 Machine Housing
- 101-RY256267 Access Plate
- 102-RY256262 Base
- 103-RY256261 Motor Bracket
- 104-RY9085 Drive Belt
- 105-RY256265 Cutter Guard
- 106-RY256274 Head Release
- 107-RY256270 Threaded Stud
- 108-RY256271 Shaft Lock
- 109-RY256273 Idler Eccentric
- 110-RY256272 Eccentric Stop
- 111-RY256263 Stylus Holder
- 112-RY256282 Pivot Stud
- 113-RY256277 Stylus Detent Plate
- 114-RY256276 or RY456276 Stylus
- 115-RY9106 Flat Washer
- 117-RY9084 Cap Screw
- 118-RY9060 Set Screw
- 119-RY9097 Hex Jam Nut
- 120-RY10039 Capacitor
- 121-RY10044 Capacitor Bracket
- 123-RY9087 Switch Plate
- 125-RY9069 Cap Screw
- 126-RY9083 Steel Ball
- 127-RY9089 Compression Spring
- 128-RY9081 Compression Spring
- 129-RY9088 Steel Ball
- 131-RY9042 Cap Screw
- 132-RY9047 Cap Screw
- 133-RY9265 Dowel Pin
- 134-RY9102 Cap Screw
- 136-RY9001 Compression Spring
- 137-RY9045 Set Screw
- 138-RY9106 Washer
- 139-RY9069 Screw

RYTAN RESERVES THE RIGHT TO MAKE CHANGES AT ANYTIME.

RY256 & RY456 KEY MACHINE

EXPLODED VIEW

**RY101 - STANDARD ON RY456
OPTIONAL ADD-ON FOR RY256**

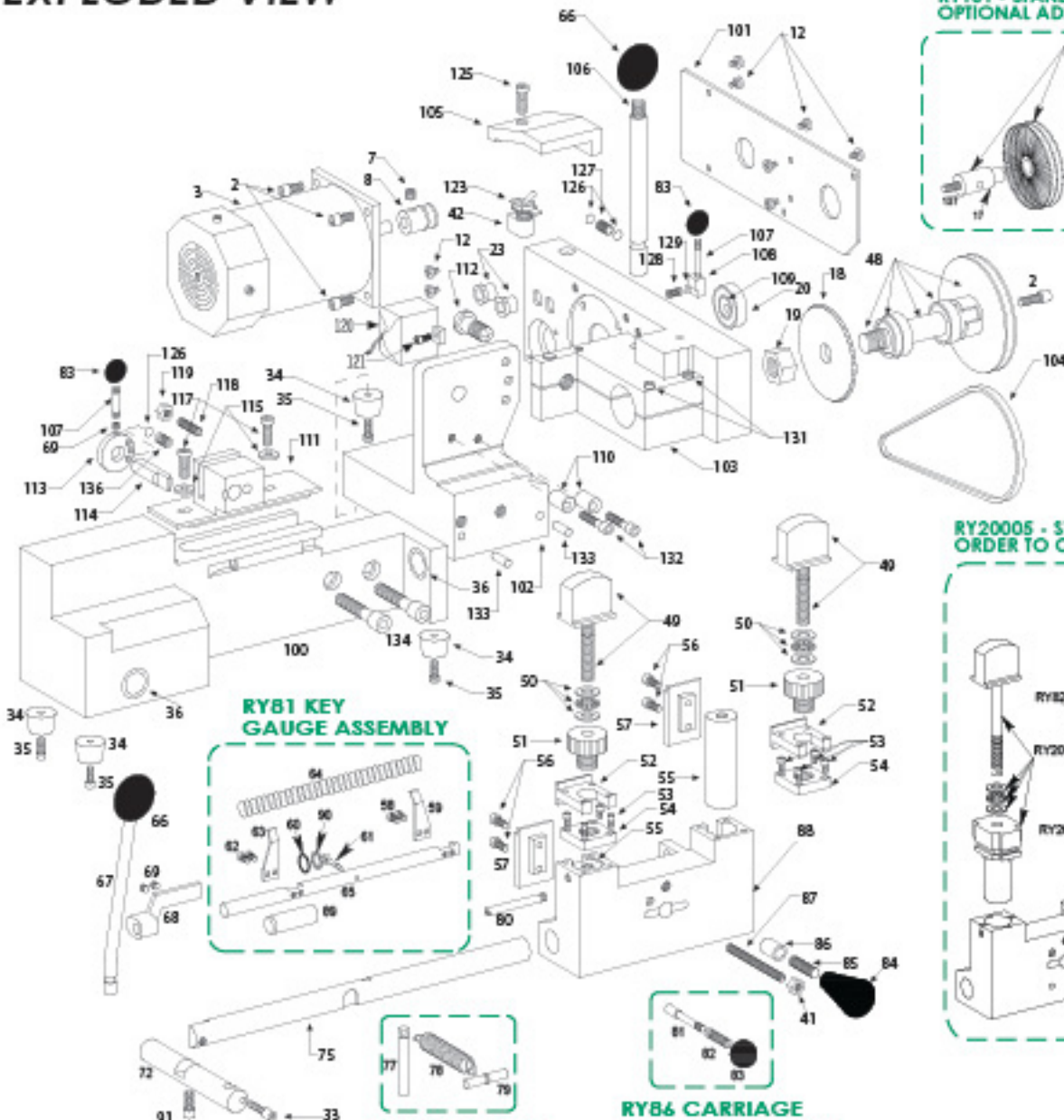
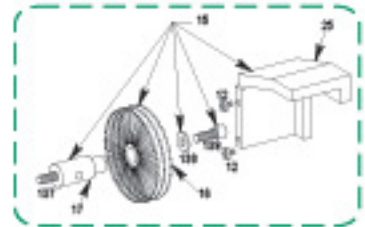

**RY81 KEY
GAUGE ASSEMBLY**

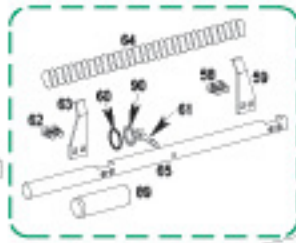

**RY20005 - STANDARD ON RY456
ORDER TO CONVERT YOUR RY256**

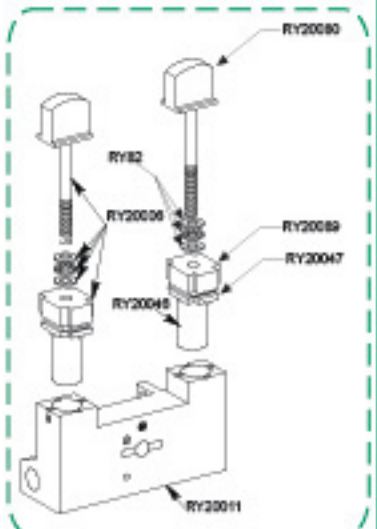

**RY85 CARRIAGE
SPRING ASSEMBLY**



**RY86 CARRIAGE
RELEASE ASSEMBLY**



**RY83 CARRIAGE DRIVE
LINKAGE ASSEMBLY**

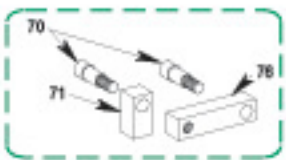

**RY456375 - STANDARD ON RY456
OPTIONAL ADD-ON FOR RY256**

TO ADD TO YOUR RY256:
MA475 - includes new
RY256276 stylus
MA480 - knob, body and
spring to use with your
existing stylus



RYTAN RESERVES THE RIGHT TO MAKE CHANGES AT ANYTIME.

RY2000 PUNCH MACHINE QUICK KITS AND ORDERING EXAMPLES

KEYWAY	DEPTH SELECTOR ASSEMBLY	SPACE BAR ASSEMBLY	PUNCH & DIE ASSEMBLY	DEPTH DRIVER (RH or LH)	TIP STOP ASSEMBLY	TOP SHOULDER STOP ASSEMBLY	TOP VISE JAW
RY2000ARW ARROW	RY5070DS	RY4070SB	RY6070PD	RY2026LH		RY2075TSS	RY2007AF
RY2000CO70 CORBIN	RY5073DS	RY4073SB	RY6073PD	RY2026LH		RY2075TSS	RY2007
RY2000DEX DEXTER	RY5074DS	RY4074SB	RY6074PD	RY2026LH		RY2075TSS	RY2007
RY2000A2/A3/A4 BEST/I-CORE	RY5076DS RY5077DS RY5078DS	RY4078SB	RY6078PD	RY2026LH	RY2015TS		RY2007B
RY2000KW KWIKSET	RY5079DS	RY4079SB	RY6079PD	RY2026LH			RY2007
RY2000SCH SCHLAGE CLASSIC, REVERSE, AND EVEREST	RY5090DS	RY4090SB	RY6090PD	RY2026RH (LH for reverse)			RY2007
RY2000WEI WEISER	RY5094DS	RY4094SB	RY6094PD	RY2026LH		RY2075TSS	RY2007
RY2000WES WESLOCK	RY5095DS	RY4095SB	RY6095PD	RY2026LH		RY2075TSS	RY2007
MSRP	\$106.90	\$74.55	\$149.74	\$59.06	\$22.24	\$51.26	\$51.26

ALL ASSEMBLIES COME WITH HARDWARE NECESSARY FOR INSTALLATION

CONTACT US for more information on Medeco and Master keyways in development, and to inquire about unlisted keyways!

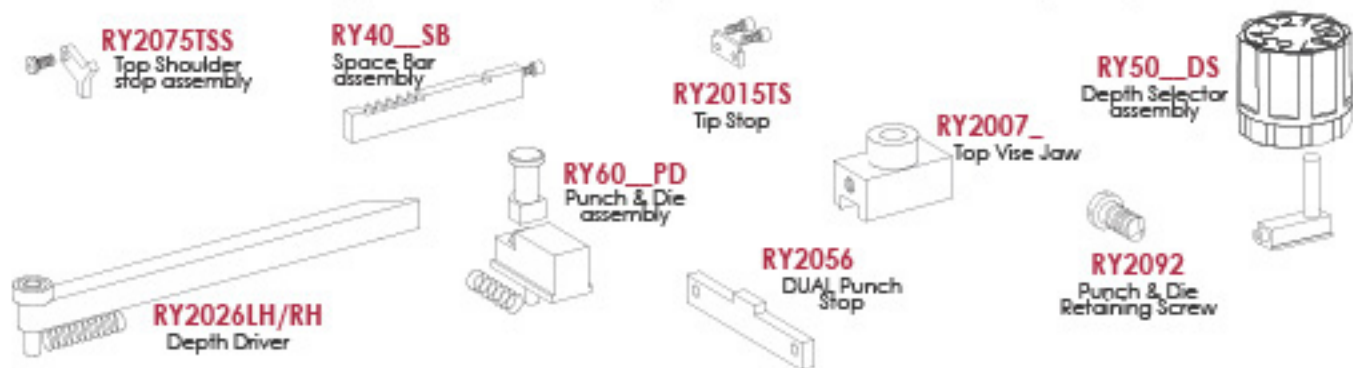

ORDERING EXAMPLE: You have a single punch machine with Schlage capabilities. You want to be able to punch the Kwikset keyway. Order everything in the **RY2000KW** row, EXCEPT the RY2007 vise jaw. Your machine already has the RY2007 since you have the parts that correspond with Schlage. You will keep Schlage set up on the right side of your RY2000, and Kwikset set up on the left. When switching between the keyways, you will only need to swap out the space bar! Same goes with the RH or LH Depth driver - no need to purchase duplicates.

RY2000

Extreme Code Cutting Key Punch Machine

with Dual Capabilities

MSRP \$934.19

Turn your single punch into a dual punch by ordering quick-kits and adding more keyways! Simply swap out a few parts and FULLY equip your RY2000 Punch Machine!
(See page 20 for ordering examples)

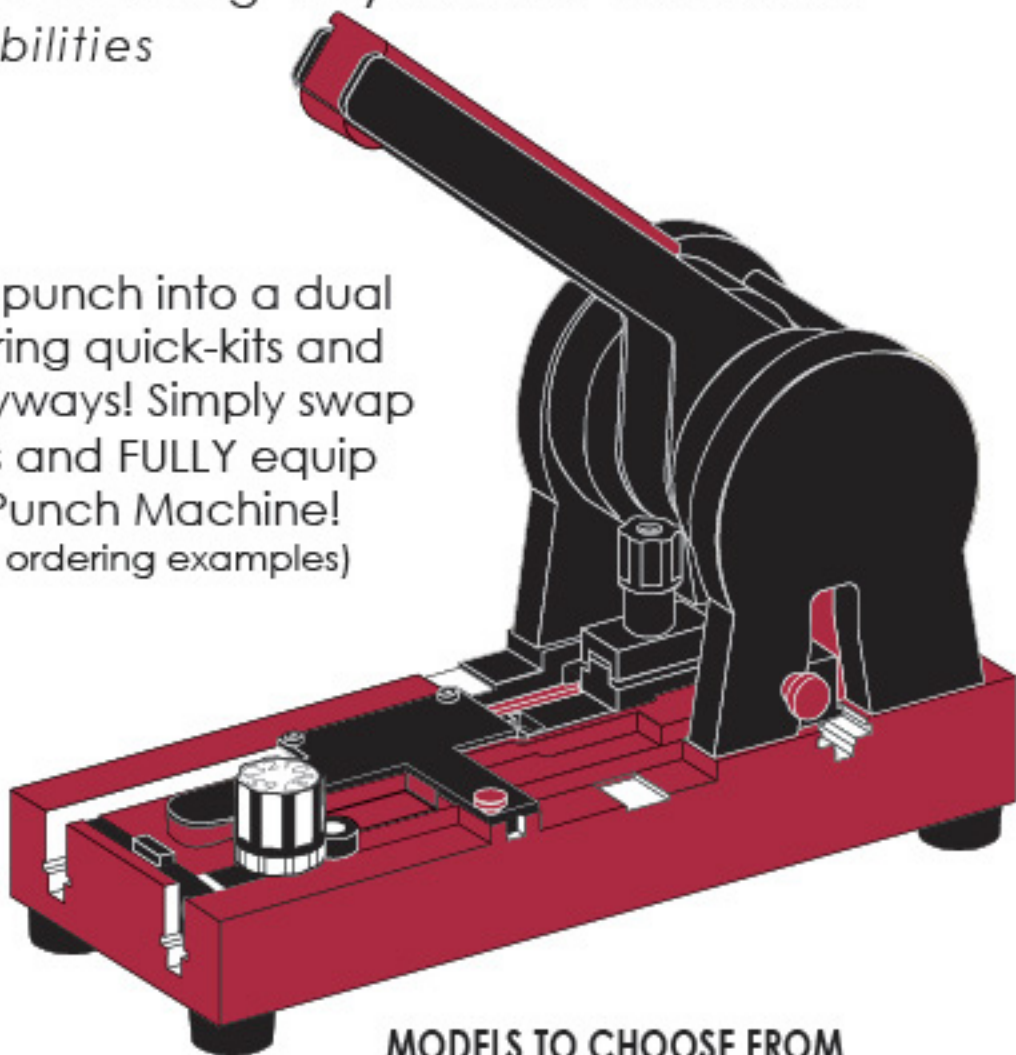

RY2000Case

MSRP \$94.95



Our NEW Punch Machine Carrying Case is made from durable Cordura fabric with foam padding for machine safety. Complete with rubber feet, an adjustable strap, and inside pockets for storage!
MADE IN AMERICA

MODELS TO CHOOSE FROM

RY2000SCH	SCHLAGE CLASSIC, EVEREST
RY2000SCR	SCHLAGE, REVERSE
RY2000A2	BEST I-Core (cuts from Bow-to-Tip)
RY2000A3	BEST I-Core (cuts from Bow-to-Tip)
RY2000A4	BEST I-Core (cuts from Bow-to-Tip)
RY2000ARWF	ARROW FLEXCORE
RY2000ARW	ARROW
RY2000DEX	DEXTER
RY2000KW	KWIKSET
RY2000WES	WESLOCK
RY2000WEI	WEISER
RY2000C070	CORBIN

Don't see the keyway you need? CALL US!
Parts for it may already be in development!

CONTACT US for more information on Medeco and Master keyways in development, and to inquire about unlisted keyways!

RY2000

Extreme Code Cutting **Dual** Punch Machine
MSRP \$1,342.19

Ordering a **DUAL PUNCH** is
like getting two machines
for the price of one!

With Schlage on the right side, you can add any keyway from our wide variety of options for cutting on the left. Easily bounce between keyways with a simple change of the spacebar! Build the dual machine how you like with plenty of options. See page 20 for quick-change parts list and ordering examples to FULLY equip your RY2000 Dual Punch Machine.

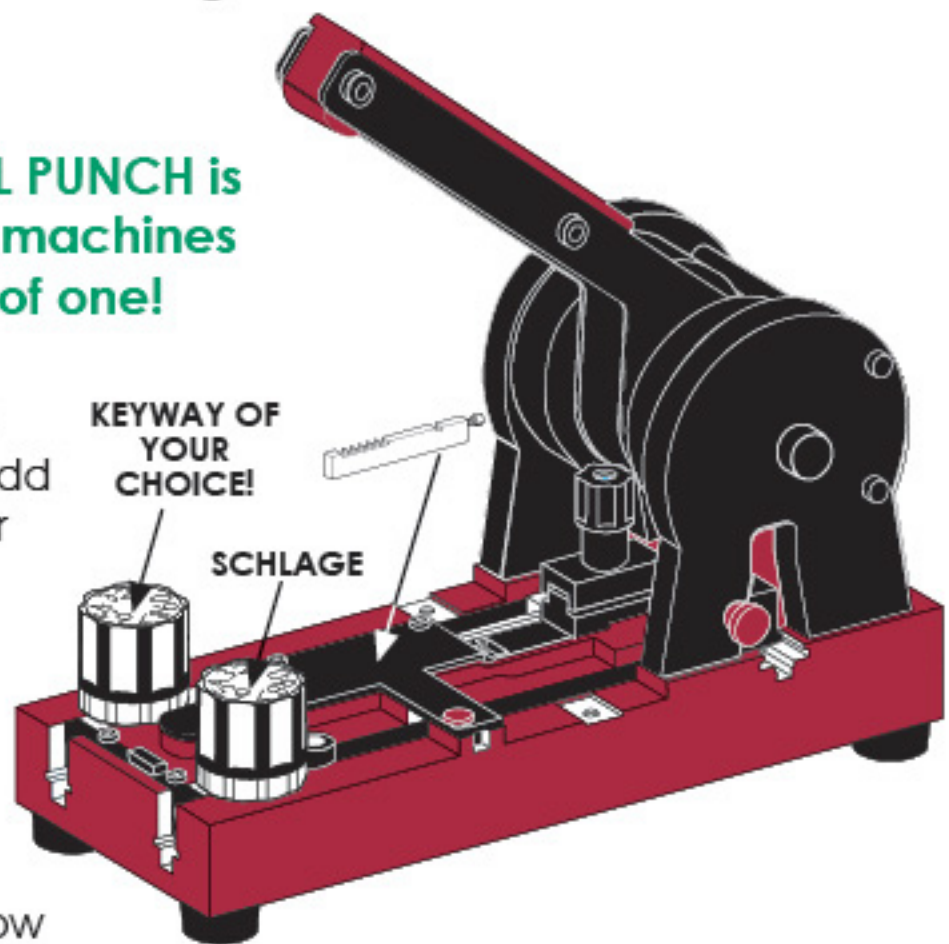

DUAL MACHINES YOU CAN BUILD WITH OUR VARIETY OF QUICK-KITS (SEE PG. 20)

Schlage/Kwikset
Schlage/Schlage Reverse
Schlage/Arrow
Schlage/Arrow Flexcore
Schlage/Dexter
Schlage/Weiser
Schlage/Weslock
Schlage/I-Core A2

Schlage/I-Core A3
Schlage/I-Core A4
Corbin CO70/I-Core Reverse
I-Core/I-Core Reverse
Schlage Reverse/Corbin CO70

CONTACT US for more information on Medeco and Master keyways in development, and to inquire about unlisted keyways!

Don't see a keyway you need? CALL US! We may be in development for the keyway you need!

RY57 PLUG SPINNER \$33.68 MSRP

For use when a lock will resist picking open but will pick in the opposite direction. The RY57 will spin the plug back past the shear line and over to the other side.

Hold the tool steady by the push button knob assembly only and push the black push button with your thumb. After proper use, the locks plug will be in the proper "picked open" position.

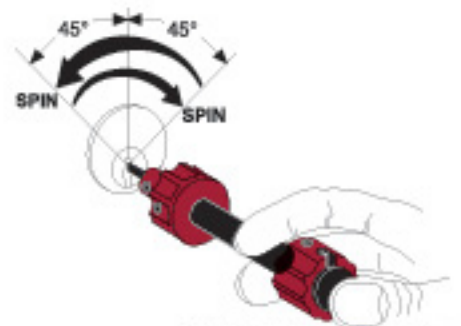

PUSH BUTTON

Rytan invented push-button plug spinner technology in 1985.



RY57RB - 5-pack MSRP \$13.92

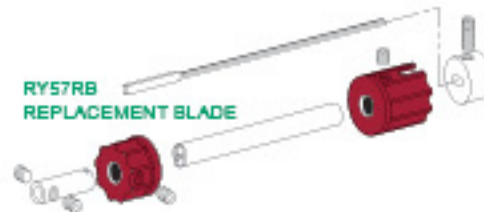

RY57RB REPLACEMENT BLADE

RY5798 COMPACT PLUG SPINNER \$13.92 MSRP

Same original **PUSH BUTTON** technology as our RY57



Lightweight plastic that fits in your pocket, but packs even **MORE** power than the original RY57 Plug Spinner



RY5704 - Replacement tip kit MSRP \$8.62



RY5701 - Replacement Body MSRP \$5.29

RY36 KWIKSET CYLINDER TOOL \$35.14 MSRP

The RY36 Kwikset Cylinder Removal tool pops cylinders out of popular "400" series knob locks with a simple push and twist.

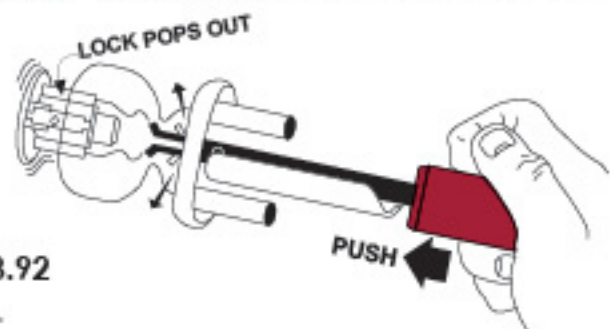

RY36RB - 5-pack MSRP \$13.92
REPLACEMENT BLADES

RYTAN EXCLUSIVE

"Mini-Red"[™] & "Mini-Blue"[™] plus Full Size Picks

"Mini" picks have 20% smaller pick blade tips. Full size picks have standard size pick blade tips.

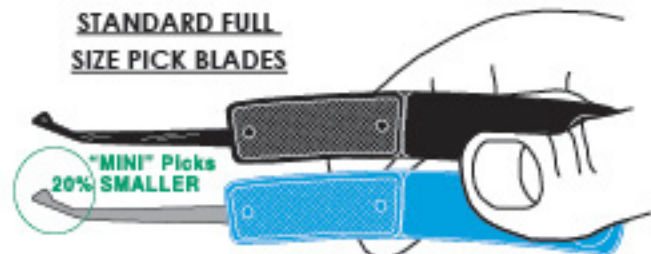
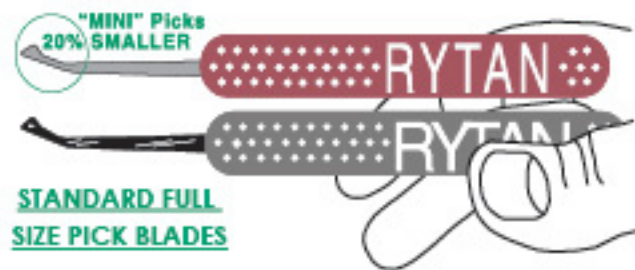

Lock Pick Instruments With Traditional Smooth Straight Slender Handles.

Lock Pick Instruments With Famous Curved Ergonomic Handles.

MUST BE PURCHASED FROM YOUR DISTRIBUTOR

\$1.74 MSRP

SLB-5 RYTAN

SLB-7 RYTAN

SLB-51 RYTAN

SLP-10 RYTAN

SLP-11 RYTAN

SLP-12 RYTAN

SLP-14 RYTAN

SLP-15 RYTAN

SLP-16 RYTAN

SLP-17 RYTAN

SLP-18 RYTAN

Full Single Large Ball

Full Double Ball

Rytan Full Triple Ball

1/2 Double Ball

Standard Diamond

Standard Full Rake

Standard Hook

Rytan Diamond-Hook

Standard 3/4 Rake

Standard 1/2 Rake

Rytan HI-LO Modified Full Rake

Rytan Riffle Rake

RBPX-4

RBPX-5

RBPX-7

RBPX-51

RLPX-10

RLPX-11

RLPX-12

RLPX-14

RLPX-15

RLPX-16

RLPX-17

RLPX-18

MINIATURE TIP PICKS (20% smaller tip)

MSLB-5 RYTAN

MSLP-10 RYTAN

MSLP-11 RYTAN

MSLP-12 RYTAN

MSLP-14 RYTAN

Rytan Miniature Full Double Ball

Rytan Miniature Diamond

Rytan Miniature Full Rake

Rytan Miniature Hook

Rytan Miniature Diamond-Hook

MBPX-5

MLPX-10

MLPX-11

MLPX-12

MLPX-14

LOCK PICK ACCESSORIES

BROKEN KEY EXTRACTORS

TENSION WRENCHES

INSTRUMENT CASES

Suggested Dealer Price ea.

\$2.95

RP-14



Rake/Double Ball Comb. Pick, Stainless Steel

\$2.95

RP-15



Diamond/Hook Comb. Pick, Stainless Steel

\$2.95

REZ-2



Broken Key Extractor, Single Barb, Stainless Steel

\$3.17

REZ-7



Broken Key Extractor, Triple Barb, Stainless Steel

\$4.93

REZ-5

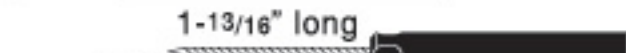

Spiral Key Extractor, 1-13/16" blade

\$5.26

REZ-5XL



Spiral Key Extractor, 2-13/16" blade

HARDENED SPIRAL BLADES ARE MECHANICALLY CRIMPED ONTO MACHINED ALUMINUM HANDLES TO CREATE THE BEST KEY EXTRACTORS AVAILABLE.

\$4.27

RSTW-3



Adjustable Tweezer Tension Wrench, Clock Steel

\$6.36

RTEN-7



"U" Shape Tension Wrench Narrow, Clock Steel

\$7.02

RTEN-9



"U" Shape Tension Wrench Wide, Clock Steel

\$2.95

RTR-5



Rigid Tension Wrench Short, Stainless Steel

\$2.95

RTR-11



Light Tension Wrench Short, Stainless Steel

\$2.95

RTR-12



Light Tension Wrench Long, Stainless Steel

\$2.95

RTR-13



Medium Tension Wrench Short, Stainless Steel

\$2.95

RTR-14



Medium Tension Wrench Long, Stainless Steel



\$34.79 CASE SLIM-2
Large Zipper Pick Case

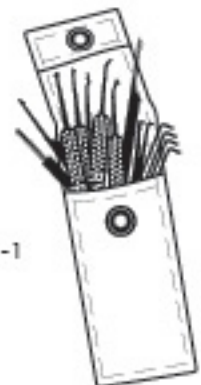

\$19.99 CASE SLIM-1
Small Pick Case

SLPK - 13

13 Piece Lock Pick Set with "Mini-Red"™ Picks.

\$49.59 Suggested Retail Price
MUST BE PURCHASED FROM YOUR DISTRIBUTOR

The miniature Rydan "Mini-Red" lock picking instruments found in this special set are a new concept in picking tools! The pick blades are scaled down by 20% compared to traditional sized picks - making them ideal for opening locks with small keyways. Great for groovings that confine the movement of regular tools. Includes our small pick case.

RYTAN EXCLUSIVE

"Mini-Red"™ picks with 20% smaller pick blade tips

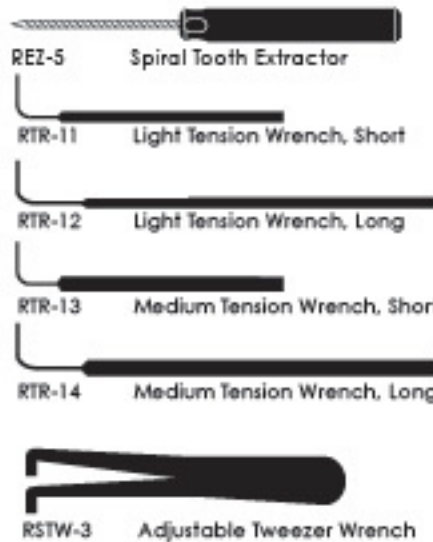
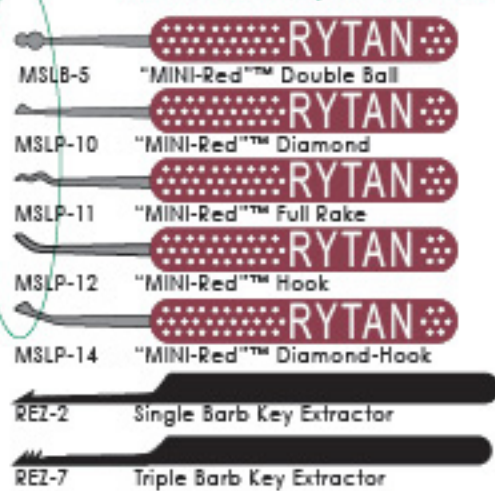

CASE SLIM - 1

SLPK - 8

8 Piece Lock Pick Set with Traditional Tipped Picks.

\$36.28 Suggested Retail Price
MUST BE PURCHASED FROM YOUR DISTRIBUTOR

Rydan's most economical Slim-Line pick set. Includes 8 popular instruments. This down-sized pick set is ideal for the beginner, as it contains a traditional rake, diamond-hook, and raffle rake pics styles, PLUS basic tension wrenches and broken key extractors. Everything needed to practice the fundamentals and perfect your skills. Includes our small pick case.

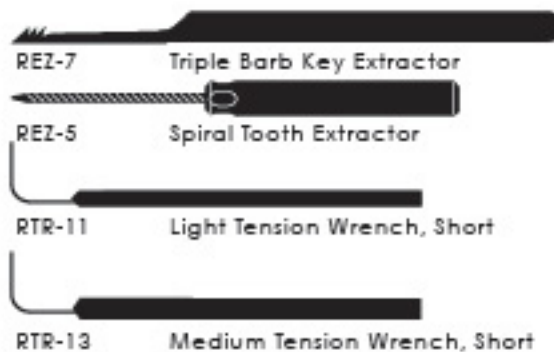

SLPK - 18

18 Piece Lock Pick Set with Traditional Tipped Picks.

\$69.14 Suggested Retail Price
MUST BE PURCHASED FROM YOUR DISTRIBUTOR

Rydan's medium size pick set with 18 time-proven instruments. Included are popular traditional diamond, 3 rakes, hook, diamond-hook and raffle pick PLUS key extractors and tension wrenches. A very well selected pick set at an affordable price. Includes our large zipper case.

Rydan's exclusive highly break resistant Stainless Steel pick blades with injection molded "fused" handles that transmit just the right "tactile" feel when you pick open a lock, have been RYTAN exclusives since 1984!

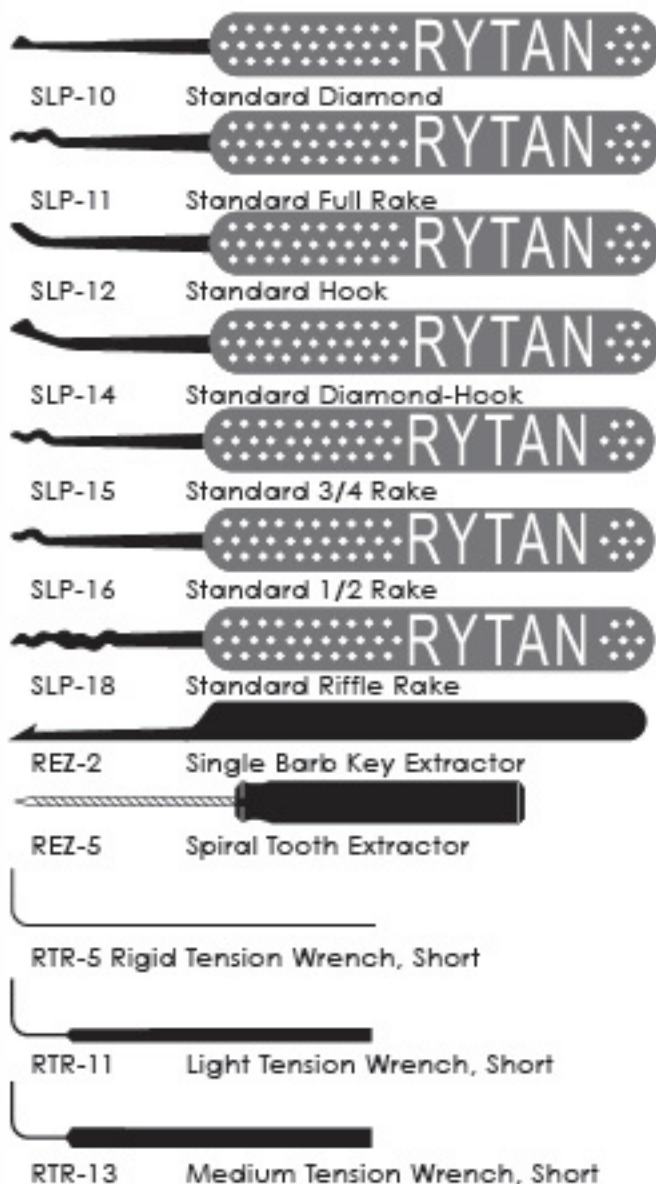

CASE SLIM-2

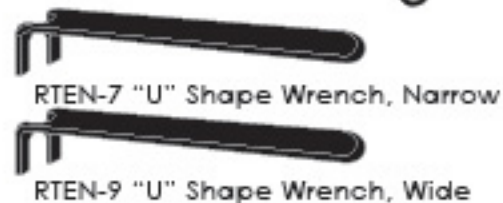







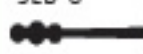
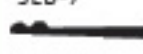
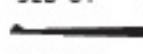

SLPK - 27

27 Piece Lock Pick Set with "MINI-Red"[™] Picks and Standard Tipped Picks.

\$103.36 Suggested Retail Price
MUST BE PURCHASED FROM YOUR DISTRIBUTOR

Rytan's largest "Slim-Line"[™] pick set with every "Slim-Line"[™] pick we make. Perfect for the professional locksmith who cares about quality instruments. Includes our large zipper case.

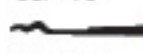
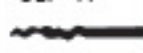
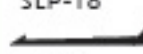
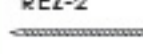
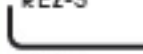
Rytan's exclusive highly break resistant Stainless Steel pick blades with injection molded "fused" handles that transmit just the right "tactile" feel when you pick open a lock, have been a RYTAN exclusive since 1984!

-  **RYTAN**
SLB-5 Standard Full Double Ball
-  **RYTAN**
SLB-7 Standard Full Triple Ball
-  **RYTAN**
SLB-51 Standard 1/2 Double Ball
-  **RYTAN**
SLP-10 Standard Diamond
-  **RYTAN**
SLP-11 Standard Full Rake
-  **RYTAN**
SLP-12 Standard Hook
-  **RYTAN**
SLP-14 Standard Diamond-Hook
-  **RYTAN**
SLP-15 Standard 3/4 Rake
-  **RYTAN**
SLP-16 Standard 1/2 Rake
-  **RYTAN**
SLP-17 Standard HI-LO Modified Full Rake
-  **RYTAN**
SLP-18 Standard Riffle Rake
-  **REZ-2**
REZ-2 Single Barb Key Extractor
-  **REZ-5**
REZ-5 Spiral Tooth Extractor
-  **RTR-5**
RTR-5 Rigid Tension Wrench, Short
-  **RTR-11**
RTR-11 Light Tension Wrench, Short
-  **RTR-13**
RTR-13 Medium Tension Wrench, Short

CASE SLIM-2



RYTAN EXCLUSIVE
"MINI-Red"[™] Picks
are 20% smaller

-  **RYTAN**
MSLB-5 "MINI-Red"[™] Double Ball
-  **RYTAN**
MSLP-10 "MINI-Red"[™] Diamond
-  **RYTAN**
MSLP-11 "MINI-Red"[™] Full Rake
-  **RYTAN**
MSLP-12 "MINI-Red"[™] Hook
-  **RYTAN**
MSLP-14 "MINI-Red"[™] Diamond-Hook
-  **RTEN-7**
RTEN-7 "U" Shape Wrench, Narrow
-  **RTEN-9**
RTEN-9 "U" Shape Wrench, Wide
-  **REZ-7**
REZ-7 Triple Barb Key Extractor
-  **RTR-12**
RTR-12 Light Tension Wrench, Long
-  **RSTW-3**
RSTW-3 Adjustable Tweezer Wrench

RYP-15, TYPE 1

9 Piece Lock Pick Set with Traditional Tipped Picks

\$35.97 Suggested Retail Price
MUST BE PURCHASED FROM YOUR DISTRIBUTOR

Rydan's most economical ergonomic pick set. Includes 9 popular instruments. This pick set is ideal for the beginner, as it contains traditional rake, hook, and diamond style picks. Also included are basic tension wrenches, broken key extractors and double-ended combination instruments. This pick set is perfect to practice the fundamentals and perfect your skills. Includes our small pick case.

Rydan's exclusive highly break resistant Stainless Steel pick blades with injection molded "fused" handles that transmit just the right "tactile" feel when you pick open a lock, have been a RYTAN exclusive since 1984!



CASE SLIM-1



RYP-13, TYPE 2

11 Piece Lock Pick Set with Traditional Tipped Picks

\$38.98 Suggested Retail Price
MUST BE PURCHASED FROM YOUR DISTRIBUTOR

A popular set of 11 instruments at an affordable price. This pick set includes an assortment of traditional sized tools in popular styles with ergonomic handles and traditional tips. This set includes broken key extractors, L-shaped tension wrenches, adjustable tweezer tension wrench, and our small pick case.

Rytan's exclusive highly break resistant Stainless Steel pick blades with injection molded "fused" handles that transmit just the right "tactile" feel when you pick open a lock, have been a RYTAN exclusive since 1984!



RBPX-5 Standard Full Double Ball



RLPX-10 Standard Diamond



RLPX-11 Standard Full Rake



RLPX-12 Standard Hook



RLPX-14 Standard Diamond-Hook



REZ-2 Single Barb Key Extractor



REZ-7 Triple Barb Key Extractor

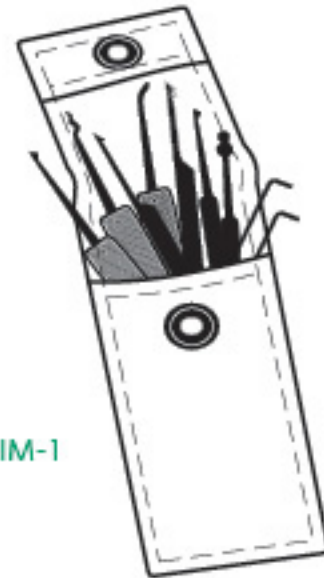

CASE SLIM-1



RP-14 Combination Full Rake - Double Ball



RTR-11 Light Tension Wrench, Short



RTR-13 Medium Tension Wrench, Short



RSTW-3 Adjustable Tweezer Tension Wrench

MRPK-10, TYPE 3

10 Piece Lock Pick Set with "MINI-Blue"™ Miniature Tipped Picks.

\$40.34 Suggested Retail Price
MUST BE PURCHASED FROM YOUR DISTRIBUTOR

The miniature Rydan "Mini-Blue"™ lock picking instruments found in this special set are a new concept in picking tools! The pick blades are scaled down by 20% compared to traditional size picks — making them ideal for opening locks with small keyways. Great for keyway grooves that restrict the movement of regular tools. Includes our small pick case.

Rydan's exclusive highly break resistant Stainless Steel pick blades with injection molded "fused" handles that transmit just the right "tactile" feel when you pick open a lock, have been a RYTAN exclusive since 1984!

RYTAN EXCLUSIVE

"Mini-Blue"™ picks with 20% smaller pick blade tips

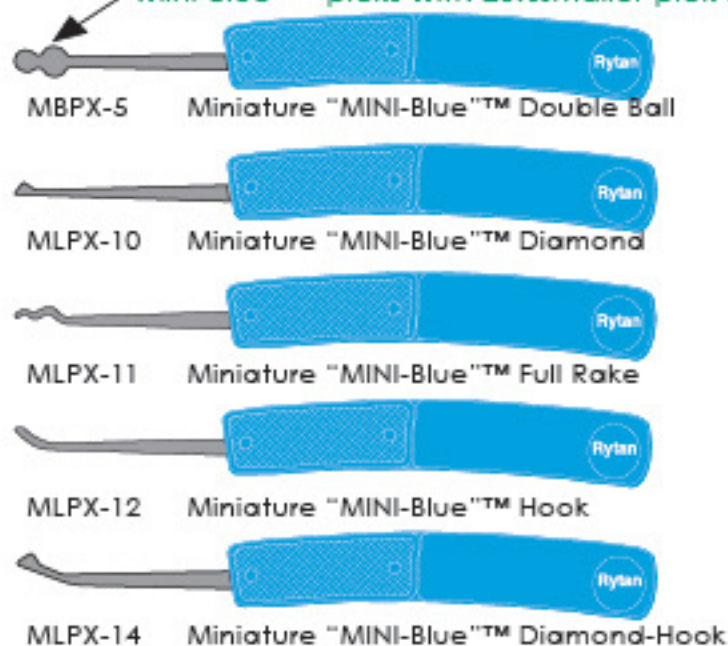

CASE SLIM-1

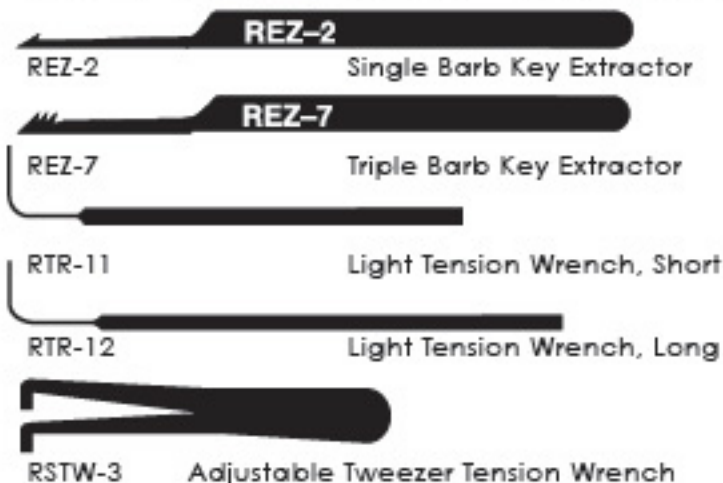

RYPK, TYPE 4

16 Piece Lock Pick Set with Traditional Tipped Picks.

\$69.04 Suggested Retail Price
MUST BE PURCHASED FROM YOUR DISTRIBUTOR

A medium size pick set containing 16 assorted Rytan lock picking instruments. Included are popular traditional size ball, hook, rake and diamond styles PLUS our Tri-Ball, Diamond-Hook and Riffle designs. Double ended combination instruments for flexibility of picking methods as well as an assortment of popular tension wrenches and broken key extractors fill out this popular moderately priced set. Includes our large pick case.

Rytan's exclusive highly break resistant Stainless Steel pick blades with injection molded "fused" handles that transmit just the right "tactile" feel when you pick open a lock, have been a RYTAN exclusive since 1984!



RBPX-5 Standard Double Ball



RBPX-7 Standard Rytan Full Triple Ball



RLPX-10 Standard Diamond



RLPX-11 Standard Full Rake



RLPX-12 Standard Hook



RLPX-14 Rytan Diamond-Hook



RLPX-18 Rytan Riffle Rake



RP-14 Combination Full Rake - Double Ball

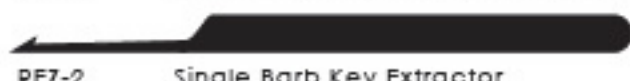

REZ-2 Single Barb Key Extractor



RTR-11 Light Tension Wrench, Short



RTR-13 Medium Tension Wrench, Short

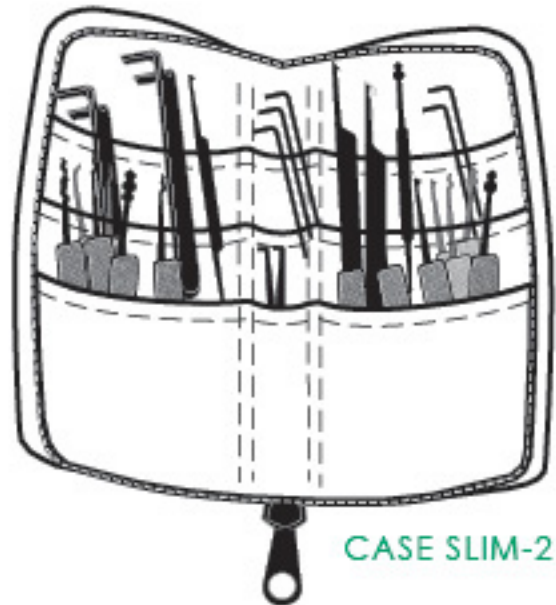

CASE SLIM-2



RP-15 Combination Diamond - Hook



REZ-7 Triple Barb Key Extractor



RTEN-7 "U" Shape Tension Wrench, Narrow



RTEN-9 "U" Shape Tension Wrench, Wide



RSTW-3 Adj. Tweezer Tension Wrench

RYPK-32, TYPE 5

32 Piece Lock Pick Set with Traditional Tipped Picks.

\$119.06 Suggested Retail Price
MUST BE PURCHASED FROM YOUR DISTRIBUTOR

This large pick set contains all of our full size picking instruments PLUS a large selection of tension wrenches and broken key extractors. You're sure to find a new "favorite" in this assortment. Includes a large pick case.

Rytan's exclusive highly break resistant Stainless Steel pick blades with injection molded "fused" handles that transmit just the right "tactile" feel when you pick open a lock, have been a RYTAN exclusive since 1984!

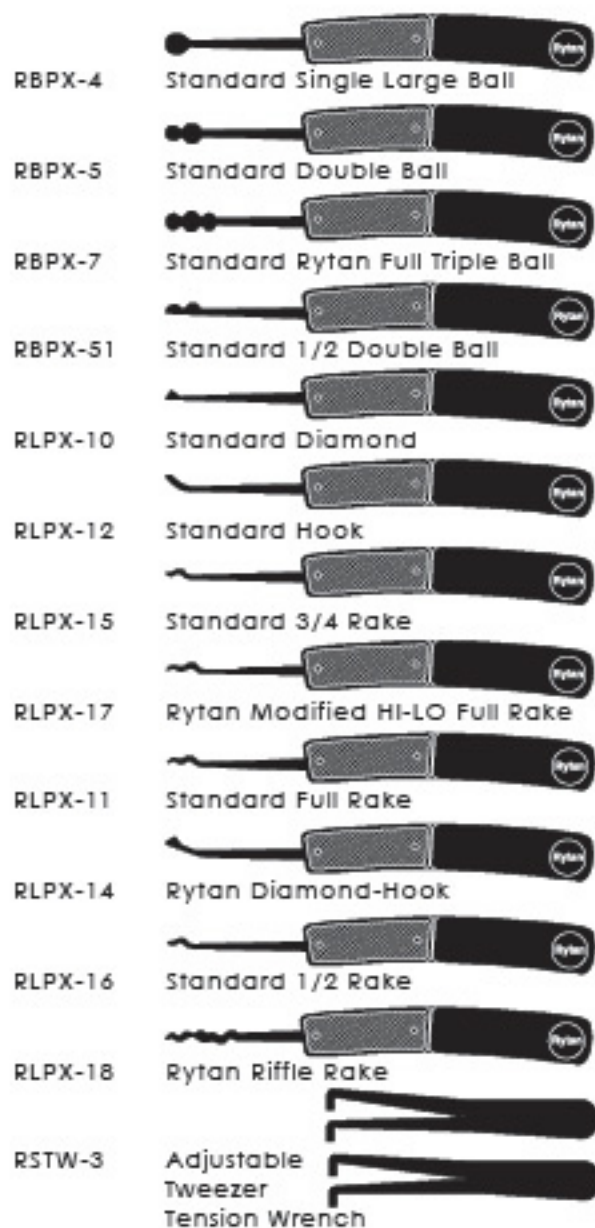

CASE SLIM-2

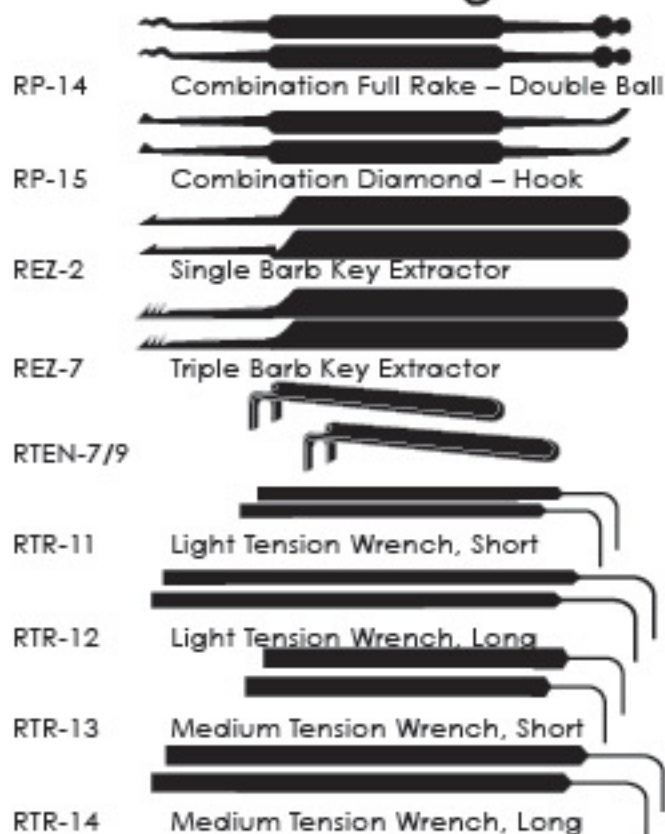

RYPK-50, TYPE 6

50 Piece Lock Pick Set with Traditional Tipped Picks and "MINI-Blue"™ Picks.

\$144.75 Suggested Retail Price
MUST BE PURCHASED FROM YOUR DISTRIBUTOR

Our largest lock pick set contains 50 popular Rydan instruments. Includes the popular "Mini-Blue"™ miniature tipped picks. They're the ones with 20% smaller tips than traditional pick blades. All styles of Rake, Diamond-Hook, Ball, Hook, Diamond, Riffle and double-ended combination instrument picks are included. These are complemented by an array of broken key extractors and tension wrenches. Includes a large pick case.

Rydan's exclusive highly break resistant Stainless Steel pick blades with injection molded "fused" handles that transmit just the right "tactile" feel when you pick open a lock, have been a RYTAN exclusive since 1984!



CASE SLIM-2

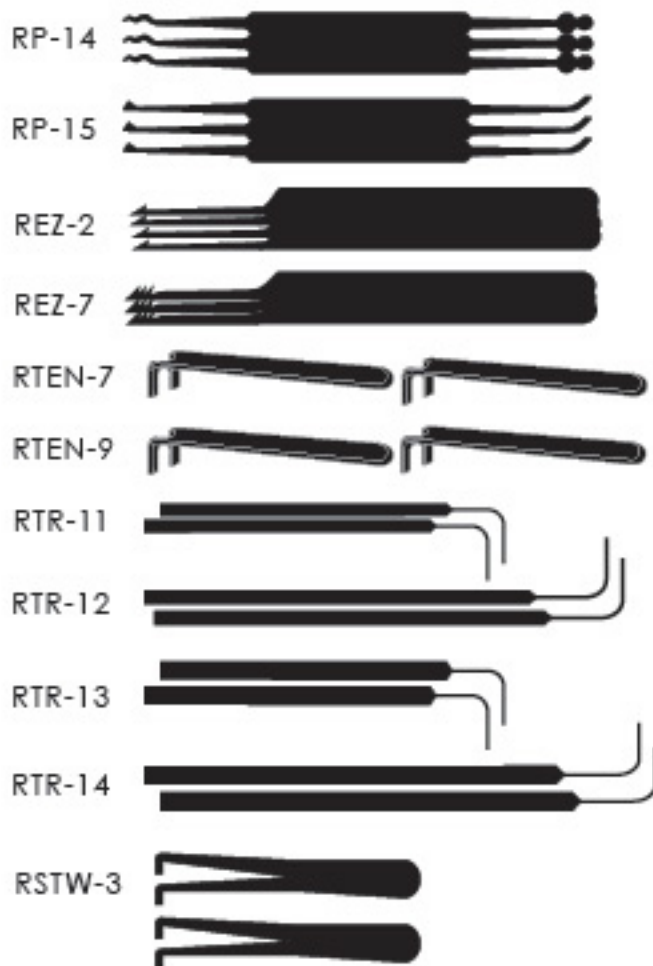
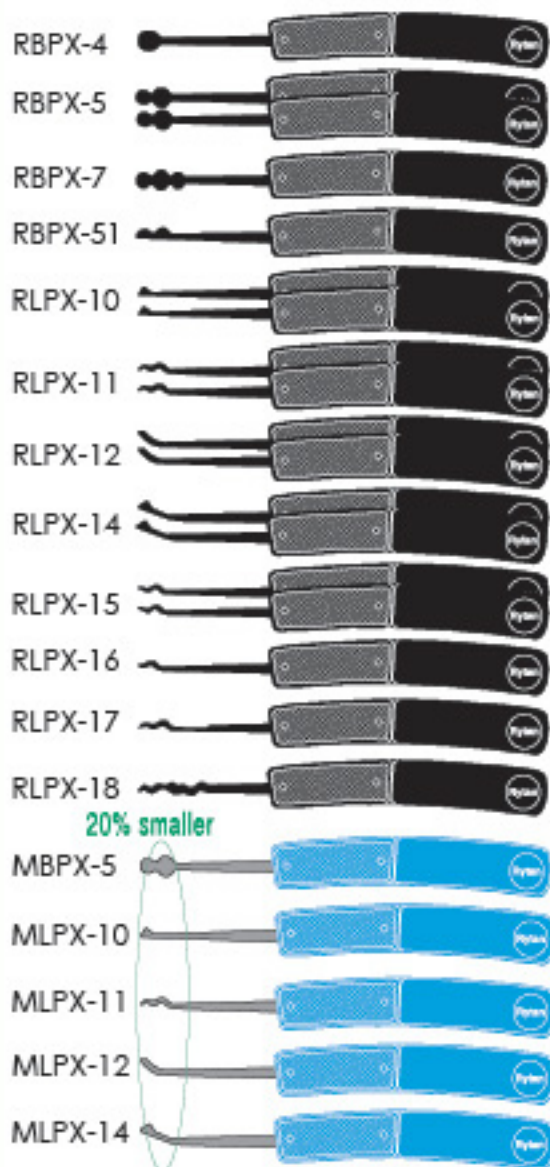

RMP, TYPE 7

25 Piece Lock Pick Set with Traditional Tipped Picks and "MINI-Blue"™ Picks.

\$101.28 Suggested Retail Price
MUST BE PURCHASED FROM YOUR DISTRIBUTOR

Rydan's premium lock pick set. Contains the most popular traditional pick styles PLUS all the famous "MINI-Blue"™ miniature pick blade instruments. "MINI-Blue"™ picks are the ones with 20% smaller tips than traditional pick blades. Rake, Ball, Hook, Diamond, Diamond-Hook, Riffle and double-ended combination instrument picks are included. The wide assortment of picking instruments is complimented by an array of broken key extractors and tension wrenches. Includes a large pick case.

Rydan's exclusive highly break resistant Stainless Steel pick blades with injection molded "fused" handles that transmit just the right "tactile" feel when you pick open a lock, have been a RYTAN exclusive since 1984!

