

WATER LINE & SEWER LINE EASEMENT		
LINE	BEARING	DISTANCE
L13	S 74°56'00" W	16.73'
L18	N 13°16'17" W	58.39'
L19	N 07°57'58" W	226.39'
L20	S 82°17'20" W	22.86'
L21	N 15°04'54" W	20.17'
L22	N 82°17'20" E	25.36'
L23	N 07°57'58" W	95.48'
L24	S 56°22'00" E	29.42'
L25	S 07°57'58" E	378.41'
TOTAL 0.204 ACRES		

THE TOWNSHIP OF SOMERSET  
R.B.V 2369 PAGE 709  
TRACT 1  
9.16 ACRES

**LEGEND**

- PROPERTY LINE
- WATER/SEWER EASEMENT
- PROPERTY CORNER FND.
- W — WATER LINE
- G — GAS LINE
- SS — SANITARY SEWER LINE
- O/E — OVERHEAD ELECTRIC
- EDGE ROAD
- PROPOSED BUILDING CLEANOUT

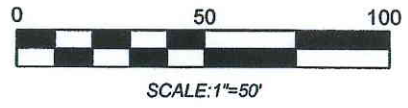

SOMERSET HOTELS, LLC  
R.B.V 2541 PAGE 196  
3.693 ACRES  
MAP NO. S42-007-093-07

VARIABLE WIDTH PERMANENT EASEMENT AND 5' WIDE TEMPORARY CONSTRUCTION EASEMENT FOR WATER LINE AND SEWER LINE TO SOMERSET TOWNSHIP MUNICIPAL AUTHORITY THROUGH LANDS OF SOMERSET HOTELS, LLC

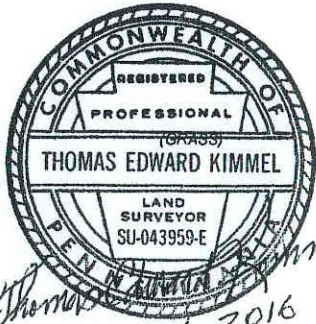

COTTAGE REAL ESTATE LLC  
R.B.V 2496 PAGE 200  
3.148 ACRES  
MAP NO. S42-007-093-09

Drawn By:	TEK
Checked By:	JWL
Date:	03-08-2016
Scale:	1" = 50'
Project No.:	0920-S013
File Name:	Water & Sewer Easement.dwg
Drawing:	1 of 1

**CME**  
ENGINEERING  
CME ENGINEERING LP  
165 East Union Street, Suite 100, Somerset, PA 15501  
814-443-3344 FAX: 814-444-0365

**EXHIBIT A**  
**WATER LINE & SEWER LINE EASEMENT**  
**THROUGH LANDS OF SOMERSET HOTELS, LLC**  
**FOR**  
**SOMERSET TOWNSHIP MUNICIPAL AUTHORITY**

Situate in  
Somerset Township, Somerset County, Pennsylvania