

# INSTRUCTIONS FOR USE



**IMPORTANT**

Please read all instructions before use. The removal procedure shall be performed using sterile gloves, under local anesthesia and using aseptic technique.

**Manufacturer**  
RemovAid AS  
Gautstaddalleen 21  
NO-0349 Oslo  
Norway

Instructions for the medical device: the RemovAid™

## The manual

This manual describes use of the RemovAid™. Users must read this manual carefully prior to using the RemovAid™ for the first time so that all features are thoroughly understood. Please keep this manual for future reference.

Symbol	Meaning
	Failure to follow the instructions may endanger the patient and/or the operator.

## Intended use

### Intended users

The intended user is the RemovAid™ operator: a health care provider with sufficient training, skills and authorization to remove single-rod contraceptive implants, that has been specifically trained on this device and possesses the skills required to understand the functions and operating parameters to successfully use the RemovAid™ device.

### Intended use

The device is intended to facilitate removal of completely and easily palpable and pinchable single-rod contraceptive implants only (i.e. Implanon/Mexplanon). The device is for single use.

### Indications for use

- Client at least 18 years old
- Client desires removal of one-rod contraceptive implant
- Implant is "pinchable" – i.e. it can be gripped by the operator, and the grip can be maintained while gently rolling the implant between the thumb and forefinger.
- Implant is completely and easily palpable

### Contraindications

- Skin overlying the implant shows signs of current infection, rash or remains visibly dirty after cleaning the area.
- Possible or confirmed nerve pain near implant site.
- Implant is impalpable, partially impalpable or non-pinchable.
- Implant appears to be broken in situ.
- Client has a known allergy to the antiseptic and/or anesthetic to be used.

### Environmental and handling conditions

Operation temperature range	Room temperature
Storage temperature range	-25 to +55° Celsius
Maximum relative humidity for storage	85% RH
Drop/Free fall (in package)	max 80 cm

### Specifications

The RemovAid™ is sterilized by irradiation (E-beam).

### Classification

The RemovAid™ is classified as Class IIa according to the Medical Devices Regulation (MDR 2017/745).

**RemovAid only accepts responsibility for the equipment's safety, usability and performance if:**

- the equipment is used in accordance with its intended use, and
- the equipment is used in accordance with the product documentation.

## Description of RemovAid™

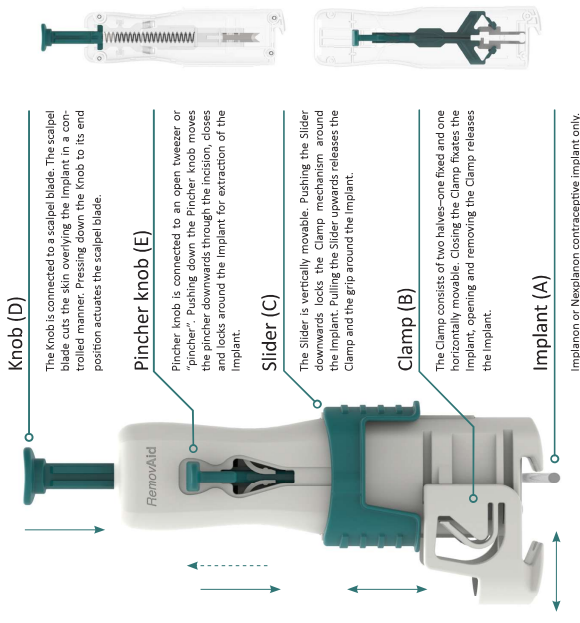

**Knob (D)**

The knob is connected to a scalpel blade. The scalpel blade cuts the skin overlying the implant in a controlled manner. Pressing down the knob to its end position actuates the scalpel blade.

**Pincher knob (E)**

Pincher knob is connected to an open tweezers or pincher. Pushing down the pincher knob moves the pincher downwards through the incision, closes and locks around the implant for extraction of the implant.

**Slider (C)**

The slider is vertically movable. Pushing the slider downwards locks the clamp mechanism around the implant. Pulling the slider upwards releases the clamp and the grip around the implant.

**Clamp (B)**

The clamp consists of two halves—one fixed and one horizontally movable. Closing the clamp fixes the implant, opening and removing the clamp releases the implant.

**Implant (A)**

Implanon or Nexplanon contraceptive implant only.

## Package and device inspection

### Visual inspection

The operator is required to:

- Ensure packaging is intact.
- Ensure that the RemovAid™ is within its expiration date.
- Visually inspect the RemovAid™ for any signs of damages and/or exposed metal components at the base of the device after removal from sterile packaging. Do not use the RemovAid™ if it appears to be damaged.
- Take care not to put pressure on the knob or pincher knob while handling the RemovAid™ prior to intended operation.

## Operational safety

**Warning:** The RemovAid™ should only be operated by medical personnel with training in removal of subdermal contraceptive implants. Such personnel is referred to as the operator throughout this manual.

## Patient safety

**Warning:** The RemovAid™ is for single-use. Attempting to use the same RemovAid™ for multiple patients can potentially injure patients.

**Warning:** Usage of the RemovAid™ in a way that contradicts the intended use could result in injury to the patient and/or the operator.

## Procedure

### #1 Local anesthesia

Locate the implant by palpation. Mark both implant ends with a suitable marker (A). Clean the overlying skin with an antiseptic and allow to completely dry. Anesthetize the removal area.

*Topical anesthetic is the method recommended by the manufacturer as there may be the risk that the injection may interfere with the performance of the device.*

Topical anesthetic patch / cream  
 Ensure the anesthetic is placed so as to sufficiently anesthetize between the two marks (A) on the skin. Allow 120 minutes for the anesthetic to work prior to continuing with the procedure.

### Injected anesthetic

If using this method, insert a needle of appropriate length and gauge at one implant mark (A), advance it underneath the implant to the other mark (A). Inject no more than 1 ml of local anesthetic agent carefully and evenly as the needle is retracted. Injecting more than 1 ml may obscure the implant and make it impossible to locate. If, after injection of the anesthetic agent, the implant is no longer palpable and/or pinprickable, do not proceed with the removal and revert to the standard method. Allow at least 5 minutes for the anesthetic to work before continuing with the procedure.

**⚠️** Avoid placing pressure on the Knob or Pincher knob while handling the device prior to their intended activation.

### #2 Prepare and locate

Position the client on an examination table with the arm flexed 90 degrees at the elbow. Clean with antiseptic agent and allow to completely dry. Prepare the required equipment prior to initiating the removal procedure, and put on sterile gloves.

### #3 Fixate the implant

Place the Clamp (B) of the RemovAid™ between the 2 marks and attempt to capture the implant (A) by pinching a skinfold containing the implant (A) up with your fingers and then pressing the Clamp (B) together manually (1-3). Lock the Clamp (B) by pulling down (L) the Slider (C). This should create a skin bulge containing the implant (A).

### #4 Ensure correct fixation of the implant

Once the Clamp (B) is locked, lift and rotate the RemovAid™ to ensure the implant is securely engaged. Visualize the implant tips move under the surface of the skin on both sides of the Clamp. The implant contours should be visible/palpable on both sides.

If the implant appears not to be securely engaged, release the clamp and repeat step 3 above until the implant is successfully fixated. It is the responsibility of the operator to continually assess whether the client tolerates additional fixation attempts. If the implant fails to be successfully fixated after three attempts, it is the manufacturer's recommendation that the operator use a standard technique for implant removal.

**⚠️** Do not proceed unless the implant is successfully fixated. Any RemovAid™ used for unsuccessful fixation shall be disposed.

Ensure the client is not experiencing any shooting or radiating pain distal to the Clamp, as this may indicate a trapped nerve. If the client is experiencing radiating pain, detach the Clamp and refer the client for ultrasound-guided removal.

## Additional accessories required

- Examination table for client to lie on
  - Suitable marker
  - Sterile gloves
  - Local anesthetic agent
  - Syringe and needle (if using injected anesthetic only)
  - Skin disinfectant, sterile swabs for application
  - Wound closure strips, sterile wound dressing
- May also require:
- Scalpel
  - Forceps

### #5 Release incision mechanism

While maintaining a firm downward pressure on the RemovAid™, push the Knob (D) on the top of the RemovAid™ down (L) to its end position until a clear "CLICK" is heard and felt. This will release the incision mechanism of the RemovAid™.

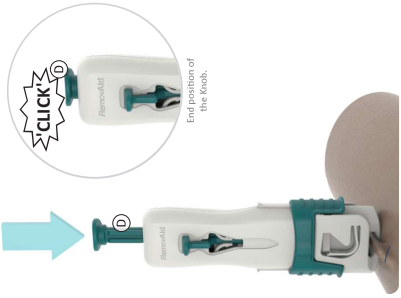

### #6 Push the Pincher knob downwards

While holding the RemovAid™ steady, push the Pincher knob (E) on the front of the RemovAid™ downwards (L) to its end position. This will actuate the Pincher of the RemovAid™.

Visualize that the Pincher knob is in its end position before proceeding.

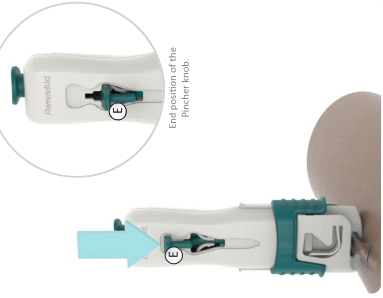

### #7 Release and remove the clamp

Pull the Slider (C) upwards (↑) to release the Clamp (B). Remove the Clamp (B) to increase visibility.

Avoid accidentally pushing the Pincher knob back up as this will retract the Pincher's hold on the implant.



### #8 Extract the implant

Angle the device 90+ degrees with the removed Clamp (B) side down. Apply normal manual force and steadily pull the RemovAid™ straight upwards (↑) to release the implant from surrounding tissue and extract it through the incision. Make sure not to press the skin above the implant downward during extraction, as this may disengage the implant from the Pincher.

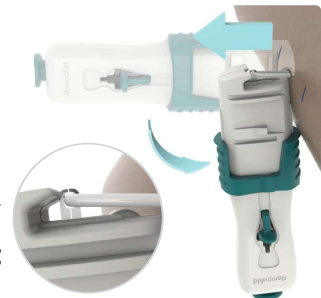

### #9 Inspect the result of the extraction

Inspect that the entire implant is extracted.

**⚠️** If the implant (or part of the implant) failed to be successfully extracted by the RemovAid™, the user may proceed to remove the piece(s) manually through the existing incision. If the incision is insufficient, the operator should revert to the standard removal technique assuming the operator is familiar with standard implant removal techniques and has equipment available. Then continue to step 10 (Close and cover the wound).

### #10 Close and cover the wound

Close the wound by pushing the two wound edges slightly together and plaster with wound closure strips. Cover with a sterile adhesive wound dressing.

### #11 Dispose of the device

Dispose of the RemovAid™ as a sharp, in accordance with local regulations for the handling of biohazardous waste. Do not attempt to clean the Clamp or to remove the implant from the Pincher before disposal. The RemovAid™ is for single use only, not for re-use.

**⚠️** In the unlikely event of a sharps injury to the operator during handling or disposal of the RemovAid™, follow local sharps injury recommendations at your centre.

**⚠️** In the unlikely event of a suspected nerve injury following the removal procedure, the client should be urgently referred for microsurgical repair to avoid permanent nerve damage.

**⚠️** Other potential adverse events may include bleeding, bruising/hematoma or superficial incisions.

**⚠️** Always inspect the implant after removal to ensure the complete implant is removed. If part of the implant remains in situ following the procedure, there may be residual contraceptive function. Additional removal work may be required.

## Safety release procedure

If, for any reason, the operator needs to release the Pincher's grip during or after the operation, follow the safety release procedure as outlined below.

- Make sure the Slider (C) and Clamp (B) are locked so the only part gripping the skin is the Pincher.
- Change your grip on the Pincher knob (E) to hold with your thumb and forefinger as shown in the picture below.
- Holding the RemovAid™ steady, pull the Pincher knob outwards (→) and upwards (↑) to release the Pincher's grip.
- Procedure completed, Pincher grip is released.

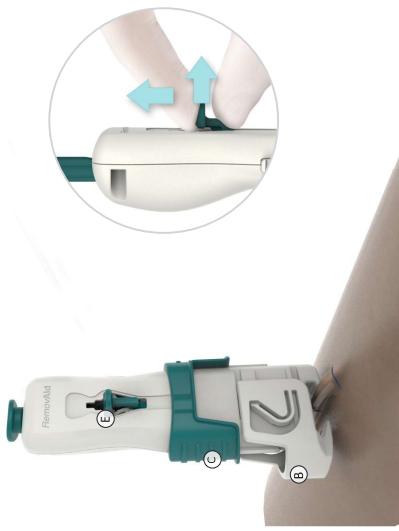

## Symbols used on labels

The RemovAid™ has been labeled with the following symbols:

Symbol	Meaning	Symbol	Meaning
	Name and address of manufacturer		Catalogue number
	Do not reuse		Lot number
	Last use date		Do not use if package is broken
	Sterile component		Consult instructions for use
	Recommended temperature for storage		Recommended relative humidity for storage
	Caution: contains sharps		

## Contact information

**RemovAid AS**  
 Gaustadalleen 21  
 NO-0349 Oslo  
 Norway

If you have questions or concerns related to this manual or the RemovAid™ device, contact us at support@removaid.com.