

MASTER PLAN

HURON TOWNSHIP
HURON COUNTY, MICHIGAN

Huron Township is located in the northeast section of the Tip of the Thumb of Huron County in Michigan. The township is primarily agricultural with a population of approximately 423 residents (as of 2000 U.S. Census). New and long term residents of Huron Township of all ages feel the importance of maintaining the township as an agricultural, residential, and recreational area that is economically viable and people friendly.

Our intent in this Master Plan is: to control growth, to maintain agricultural areas as primary use, to limit conflict, and to protect the rights of property owners.

The general goals of this Master Plan are: to ensure stability and balance of land uses to serve human needs — residential areas, agricultural land, natural and recreational areas, cultural activities, adequate public services, access to shopping, health services, and places of employment; to create an optimum human environment for the present and future residents of Huron Township, an environment that will not only solve their physical needs but will fulfill their aspirations as well; to relate land use primarily to the natural characteristics of the land and the long term needs of the community, rather than to short term private economic gain; to preserve aesthetic values of natural environments and historical locations by means such as parks, scenic open spaces, regulation of development, reforestation, and architectural control ordinances.

Specifically, the Master Plan looks to: preserve the agricultural areas of the township; prevent conflicts between conforming uses; preserve or utilize the natural resources to benefit the whole township; provide diversification of housing types to meet the needs of all residents, present and future; provide for passive and active recreation in keeping with the desires of the residents and the natural resources of the township; provide for the amenities which will retain and/or add to the attractiveness of the township; preserve historical features for their heritage and cultural value; provide for cultural facilities such as nature and historical museums, and parks; provide a transportation network system which will promote easy circulation within the township, and efficient travel across the township; provide for orderly controlled growth of the township; provide the opportunity for industrial sites that will be harmonious with the residential and agricultural areas of the township and with the environment; provide for harmonious blend of agricultural land use with residential use; provide for future uses as best we can see fit.

The following Master Plan is presented in an easy to read manner listing the section, boundaries, any special features, current zoning, and existing and non-conforming uses along with proposed future use.



PORT AUSTIN TOWNSHIP
T19N-R14E
(SEE SHEET No. 20)

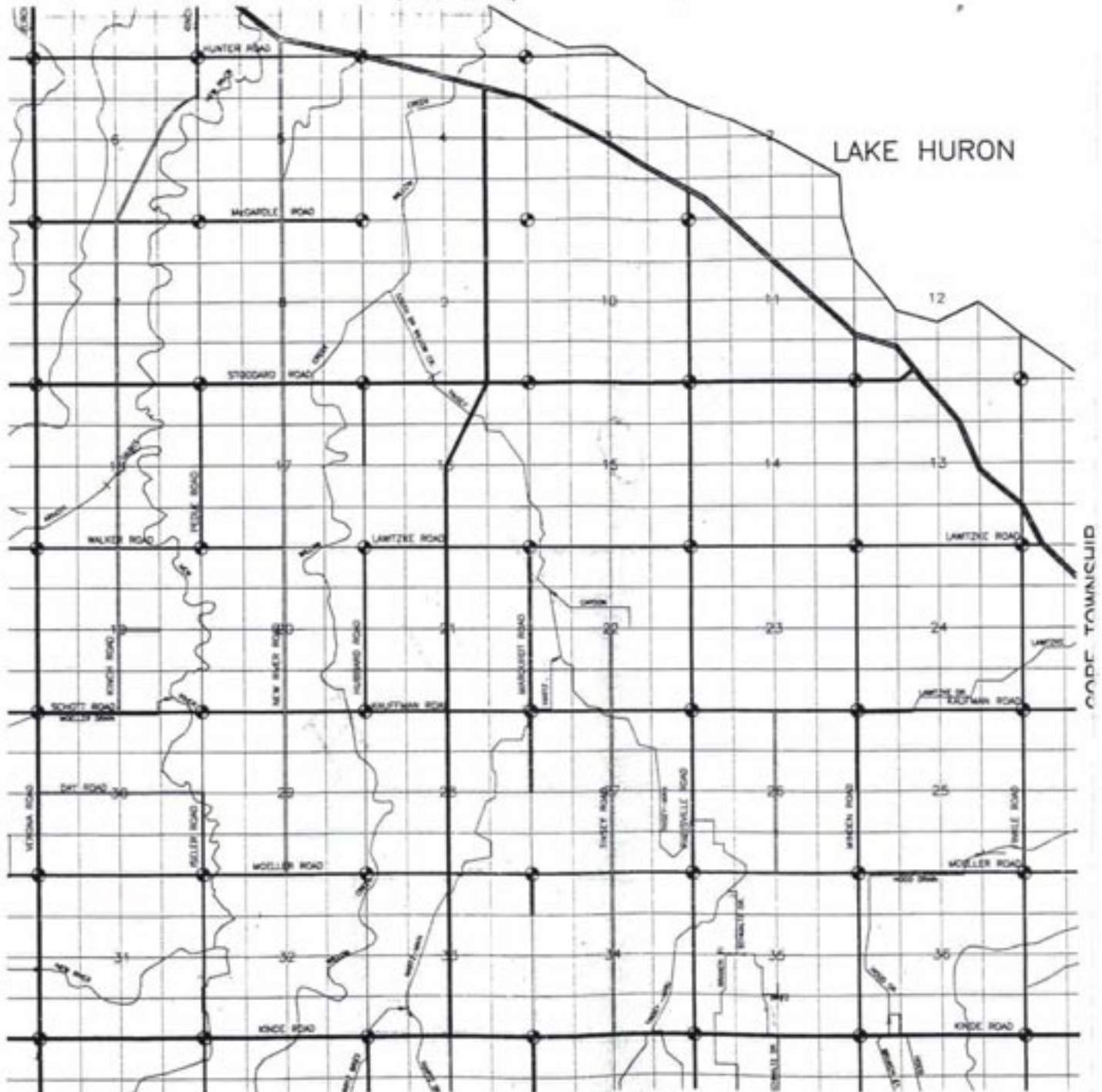

BLOOMFIELD TOWNSHIP
T17N-R14E
(SEE SHEET No. 3)

CODE TOWNSHIP

Wind towers

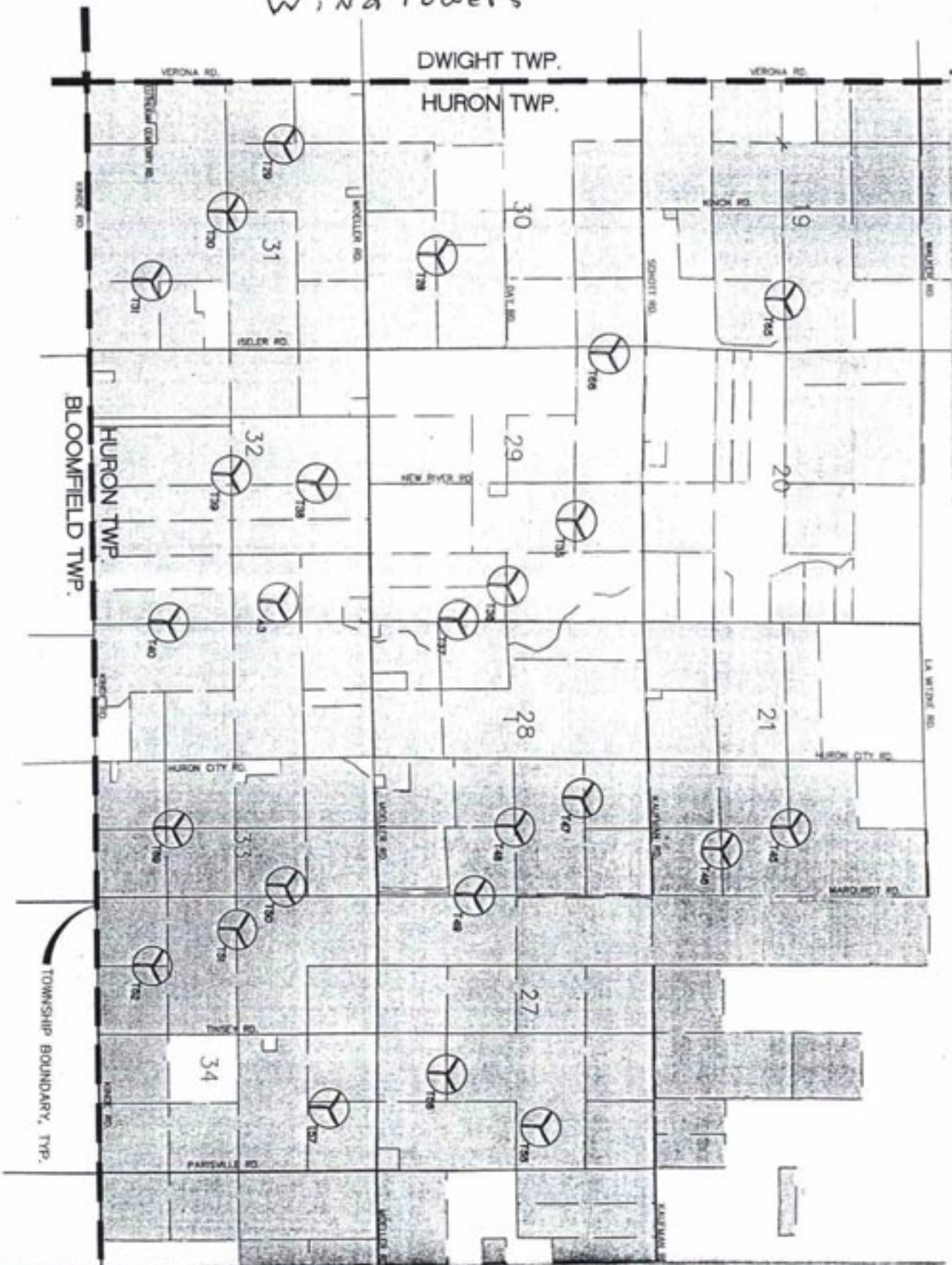

OVERALL TOWNSHIP - HURON

KEY

ROADS

Paved Class A

Paved Class B

Unimproved

Rivers

Drains

Lake Huron



ZONES

R-1

R-2

Commercial

Agricultural

Future Use

River Front and/or Recreational

Wind Tower

Communication



Four Inches = One Mile

Huron Township
MASTER PLAN
SECTION 1

ROADS:

None

CURRENT ZONING:

FEATURES: _____

OTHER INFORMATION: _____

EXISTING NON-CONFORMING USE: _____

FUTURE USE: _____

Huron Township MASTER PLAN SECTION 2



ROADS:

- Lighthouse
(Black Top – C. Primary)
- M25 (Class A / Limits)

CURRENT ZONING:

- R-1
- R-2
- Riverfront and/or Recreational

FEATURES:	Lighthouse Museum	Picnic Area	Campground
	Nature Trail	Beach	
	Edison Grid	Water Line	
	Deer Park Subdivision	Bald Eagle Point Subdivision	

OTHER INFORMATION: _____

EXISTING NON-CONFORMING USE: Light Keepers Inn Lighthouse County Park

FUTURE USE: R-1 R-2 Historical & Recreational

Huron Township MASTER PLAN SECTION 3

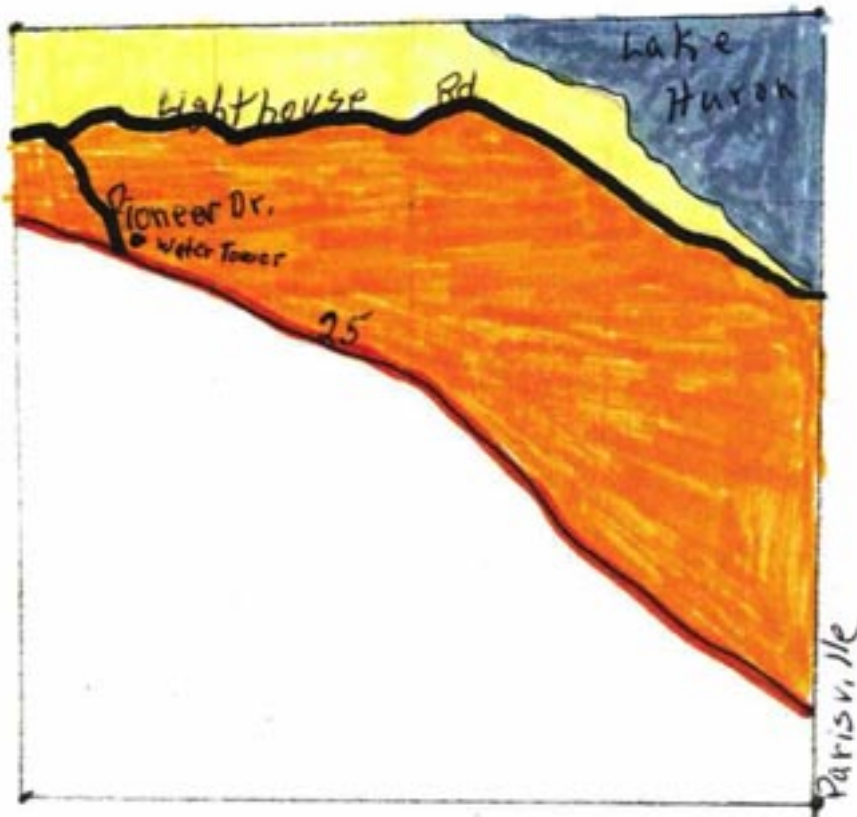

ROADS:

- Lighthouse
(Black Top - C. Primary)
- M25 (Class A / Limits)

CURRENT ZONING:

- R-1
- R-2
- Ag

FEATURES: Water Tower Water Line

Edison Grid

Huron City Hunt Club Bald Eagle Point Subdivision

OTHER INFORMATION:

EXISTING NON-CONFORMING USE:

FUTURE USE: R-1 R-2 Ag

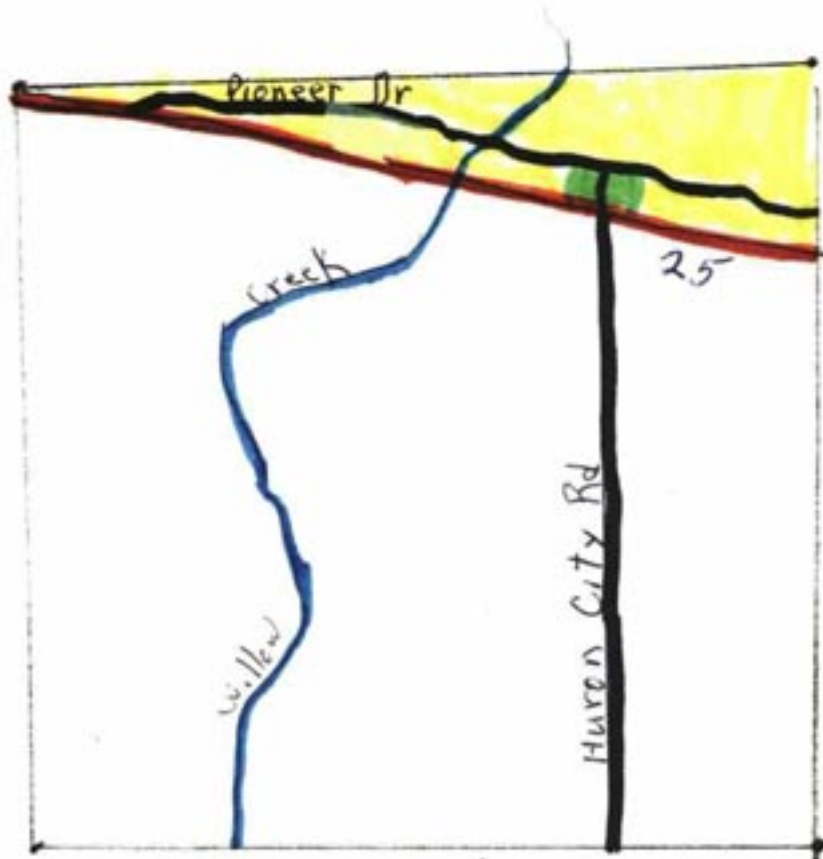

Huron Township MASTER PLAN SECTION 4

ROADS:

- Pioneer Drive (Black Top)
- M25 (Class A / Limits)
- Huron City (Black Top – C. Primary)

CURRENT ZONING:

- R-1
- River Front and/or Recreational
- Ag

FEATURES: Huron City Museum with Church Water Authority Facilities
Township Offices Water Line
Willow Creek
Edison Grid Telephone Exchange

OTHER INFORMATION: _____

EXISTING NON-CONFORMING USE: Huron City Museum

FUTURE USE: Historical and Recreational

R-1 Ag River Front Zone

Huron Township MASTER PLAN SECTION 5

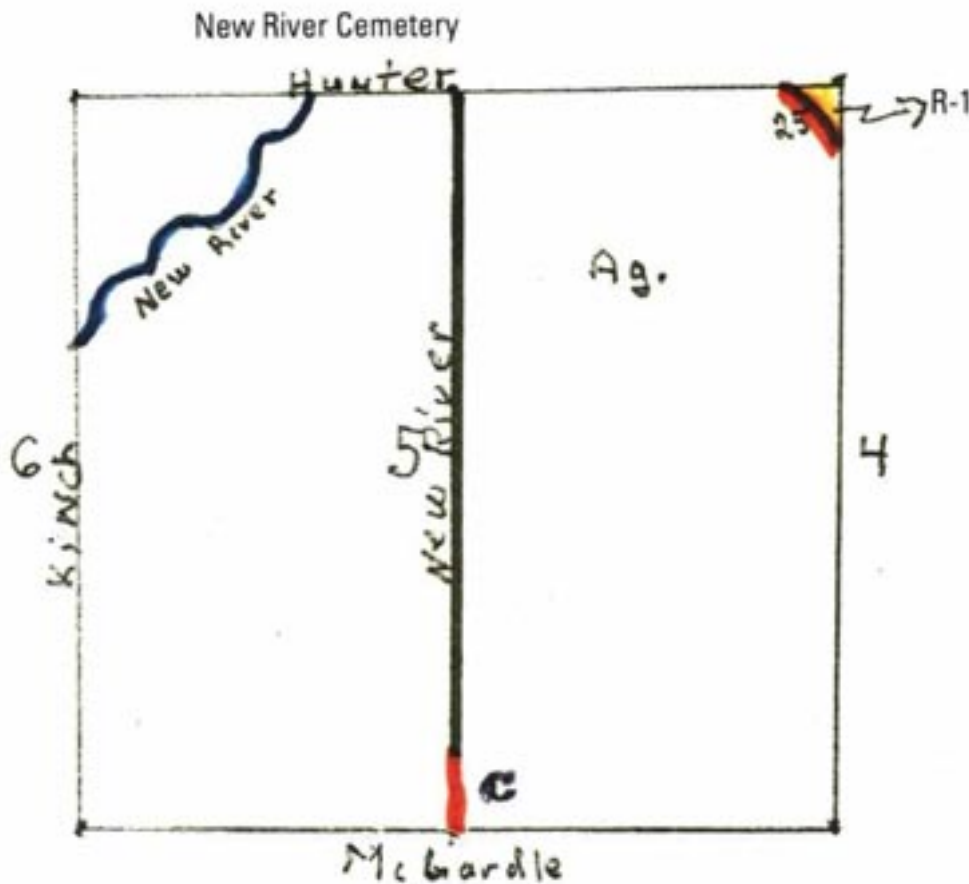

ROADS:

- Kinch (N 1/4)
- Hunter (W 1/2)
- McGardle
- New River
(Township – Black Top)

CURRENT ZONING:

● R-1

○ Ag

FEATURES: New River Cemetery owned by Huron Township

New River

Edison Grid

Propane Transfer Station

Communication Tower

Hunter Road Bridge Out

OTHER INFORMATION: _____

EXISTING NON-CONFORMING USE: _____

FUTURE USE: Ag

River Front Zone

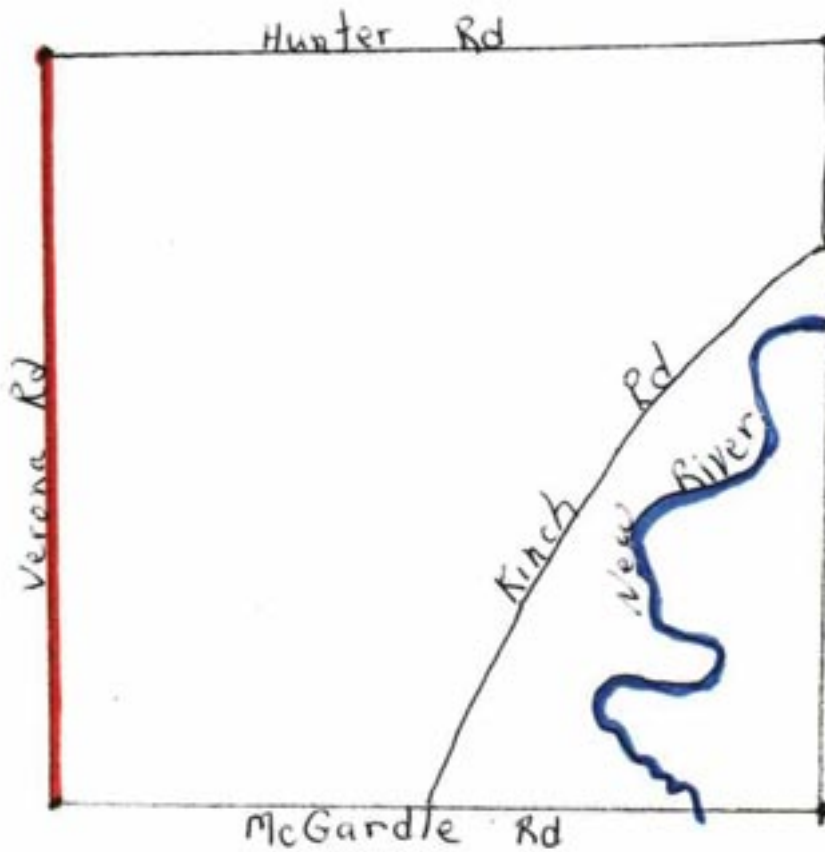

Huron Township MASTER PLAN SECTION 6

ROADS:

- Kinch (N 1/4)
- Verona
(Class A Black Top,
C Primary)
- Hunter
- McGardle
(Township – Black Top)
- Kinch (NE / SW)

CURRENT ZONING:

- Ag
- ~ River Front Zone

FEATURES: New River Edison Grid

OTHER INFORMATION: _____

EXISTING NON-CONFORMING USE: _____

FUTURE USE: Ag River Front Zone

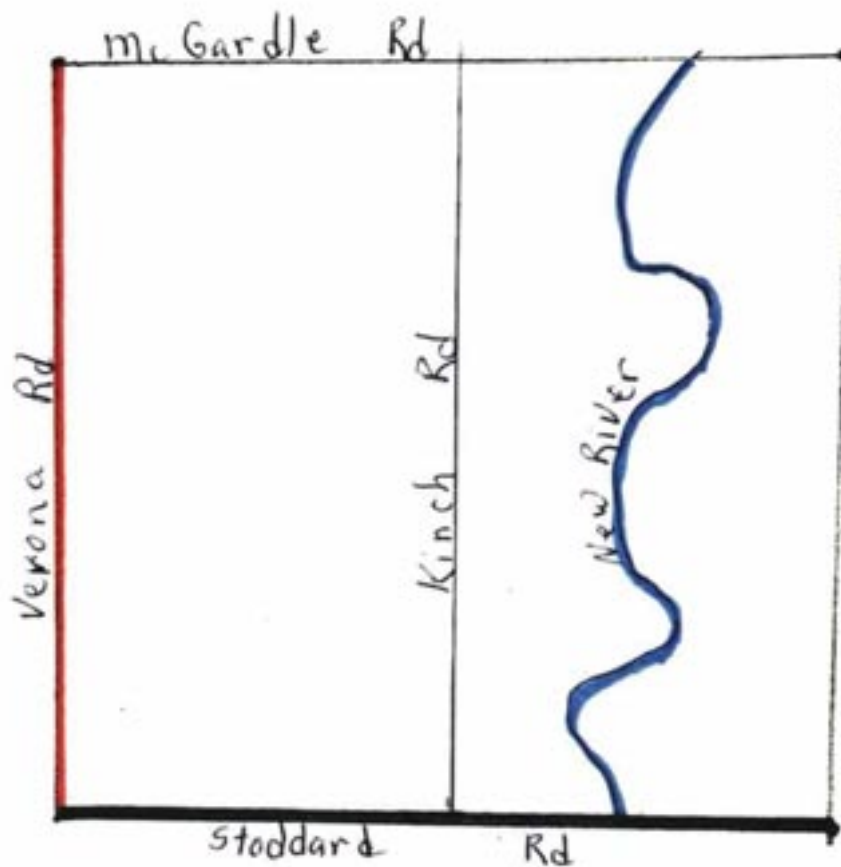

Huron Township **MASTER PLAN** **SECTION 7**

ROADS:

- Verona
(Class A Black Top, C. Primary)
- McGardle
- Stoddard
(Black Top, C. Primary)
- Kinch *(Center N/S)*

CURRENT ZONING:

- Ag
- ~ River Front Zone

FEATURES: New River

OTHER INFORMATION: _____

EXISTING NON-CONFORMING USE: _____

FUTURE USE: Ag River Front Zone

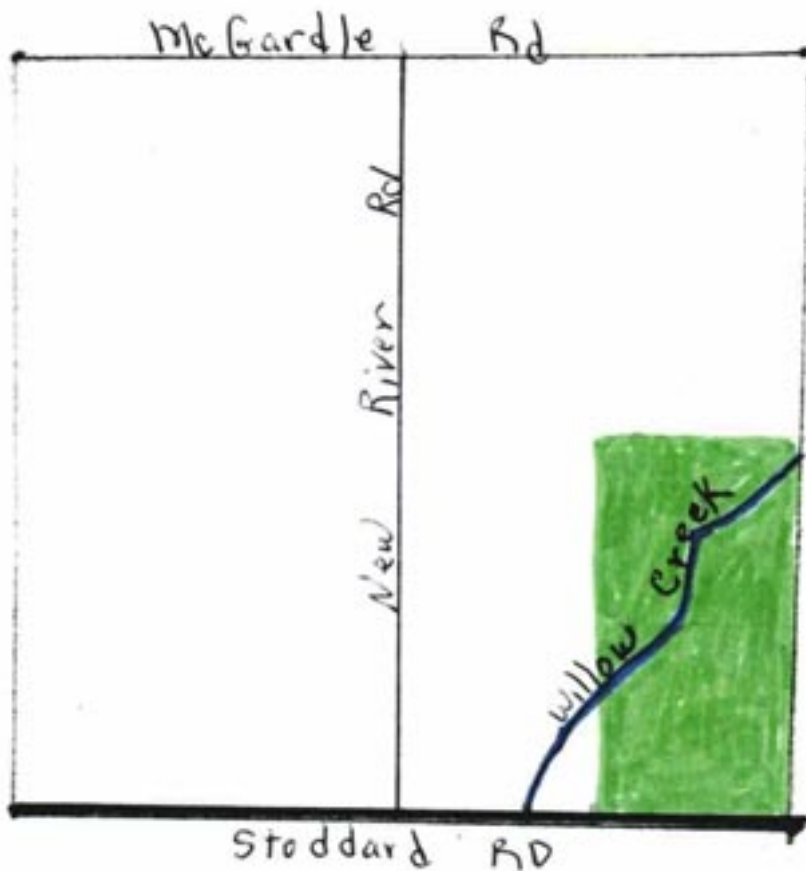

Huron Township **MASTER PLAN** **SECTION 8**

ROADS:

- McGardle
- Stoddard
(Black Top, C. Primary)
- New River (Center N/S)

CURRENT ZONING:

- Ag
- River Front and/or Recreational

FEATURES: Willow Creek

OTHER INFORMATION:

EXISTING NON-CONFORMING USE:

FUTURE USE: Ag

Recreation & River Front Zone

Huron Township MASTER PLAN SECTION 9

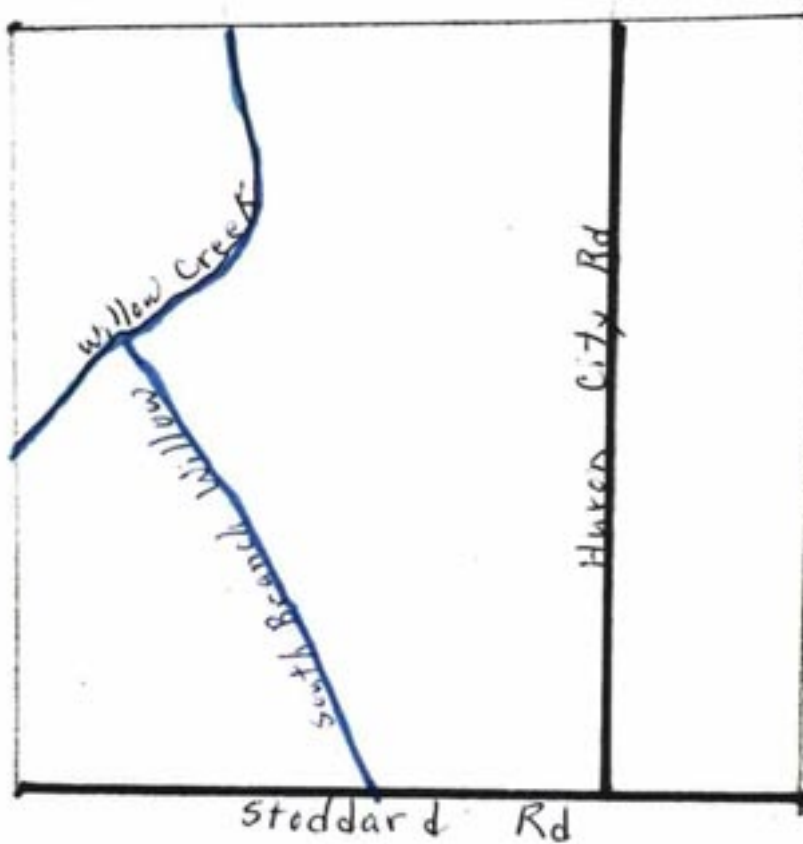

ROADS:

- Stoddard
(Black Top, C. Primary)
- Huron City (East 1/4 Line)
(Black Top, C. Primary)

CURRENT ZONING:

- Ag
- ~ River Front Zone

FEATURES: Willow Creek

Huron City Hunt Club

Tinsey Drain

OTHER INFORMATION: _____

EXISTING NON-CONFORMING USE: _____

FUTURE USE: Ag

River Front Zone

Huron Township **MASTER PLAN** **SECTION 10**



ROADS:

- Parisville Rd.
- Stoddard Rd.
(Black Top, C. Primary)

CURRENT ZONING:

☐ Ag

FEATURES: Sucker Brook

Huron City Hunt Club

OTHER INFORMATION: _____

EXISTING NON-CONFORMING USE: _____

FUTURE USE: Ag

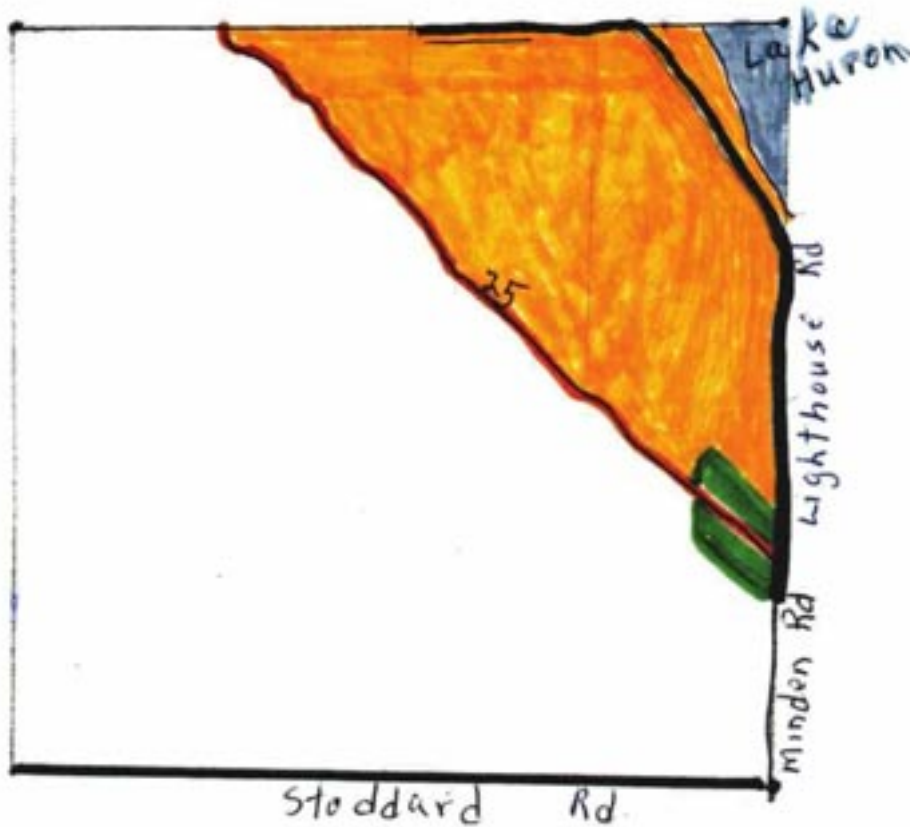

Huron Township **MASTER PLAN** **SECTION 11**

ROADS:

- Minden
- Parisville
- Lighthouse (E 1/2 +
Black Top – C. Primary)
- Stoddard
(Black Top – C. Primary)
- M25 (Class A / Limits)

CURRENT ZONING:

- R-2
- Ag
- River Front and/or
Recreational

FEATURES: Park View Subdivision

Edison Grid

Water Line

OTHER INFORMATION: _____

EXISTING NON-CONFORMING USE: Engel Farm

FUTURE USE: Ag

R-2

Commercial

Huron Township MASTER PLAN SECTION 12

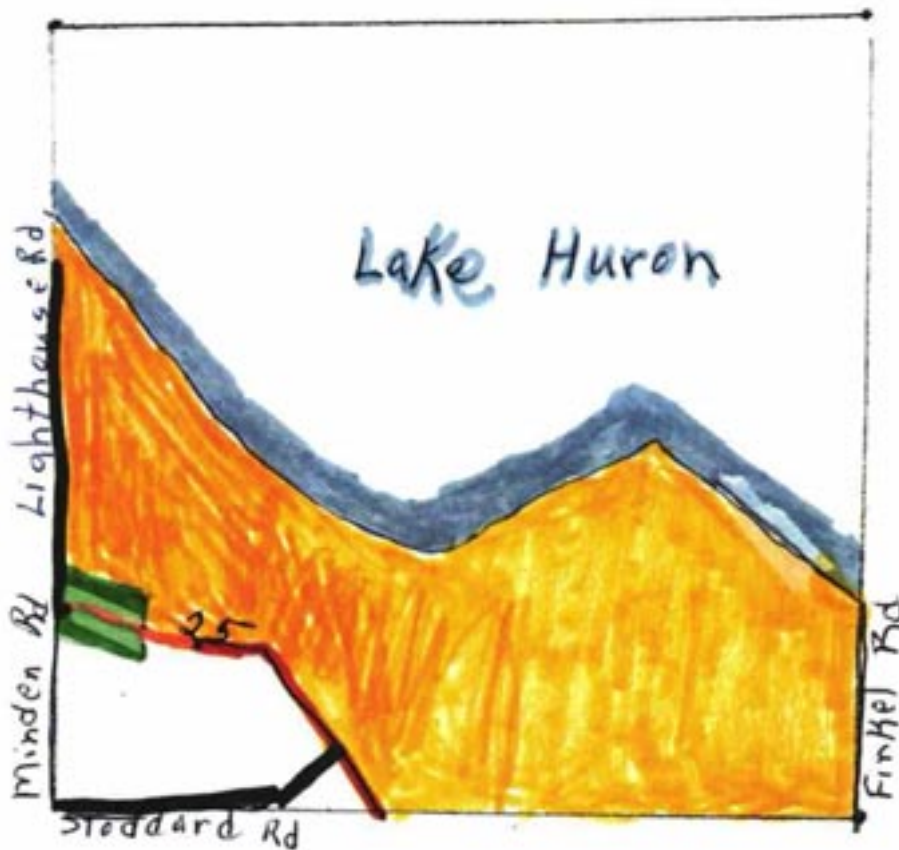

ROADS:

- Lighthouse/Minden
(Black Top – C. Primary)
(Gravel – Township)
- Stoddard (W 1/2 ±
Black Top – C. Primary)
- M25 (Class A / Limits)

CURRENT ZONING:

- R-2
- Ag
- River Front and/or
Recreational

FEATURES: Seagull Subdivision

Pawlitz Subdivision

Edison Grid

Water Line

OTHER INFORMATION:

EXISTING NON-CONFORMING USE: Pawlitz Construction

FUTURE USE: Ag

R-2

Commercial

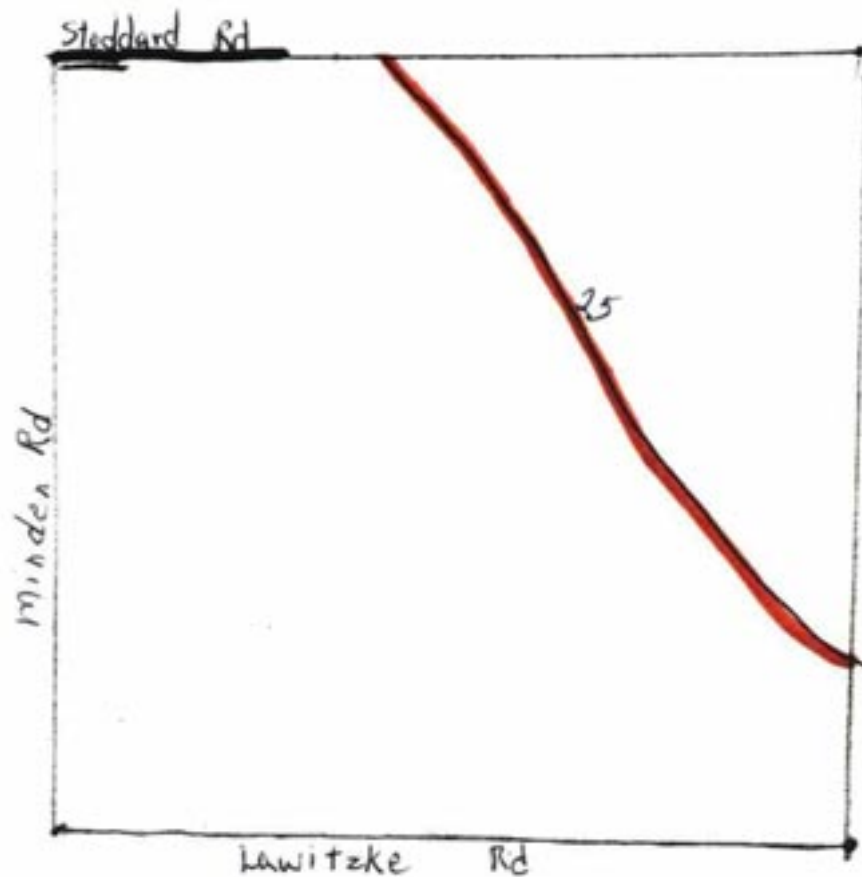

Huron Township **MASTER PLAN** **SECTION 13**

ROADS:

- Minden
(Gravel – Township)
- Stoddard (W 1/2 ±
Black Top – C. Primary)
- Lawitzke
- M25 (Class A / Limits)

CURRENT ZONING:

○ Ag

FEATURES: Water Line

OTHER INFORMATION: _____

EXISTING NON-CONFORMING USE: _____

FUTURE USE: Ag

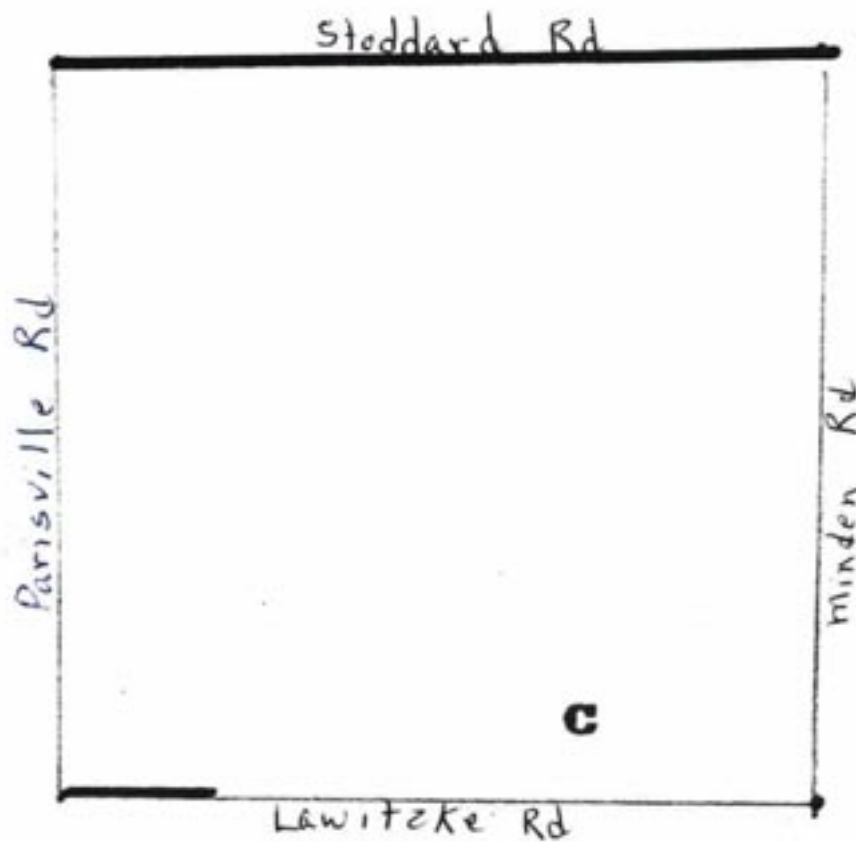

Huron Township **MASTER PLAN** **SECTION 14**

ROADS:

- Minden
- Parisville (Improved)
- Stoddard
(Black Top - C. Primary)
- Lawitzke
(Paved W 1,000')

CURRENT ZONING:

○ Ag

FEATURES: Communication Tower

OTHER INFORMATION: _____

EXISTING NON-CONFORMING USE: B & M Battery

FUTURE USE: Ag

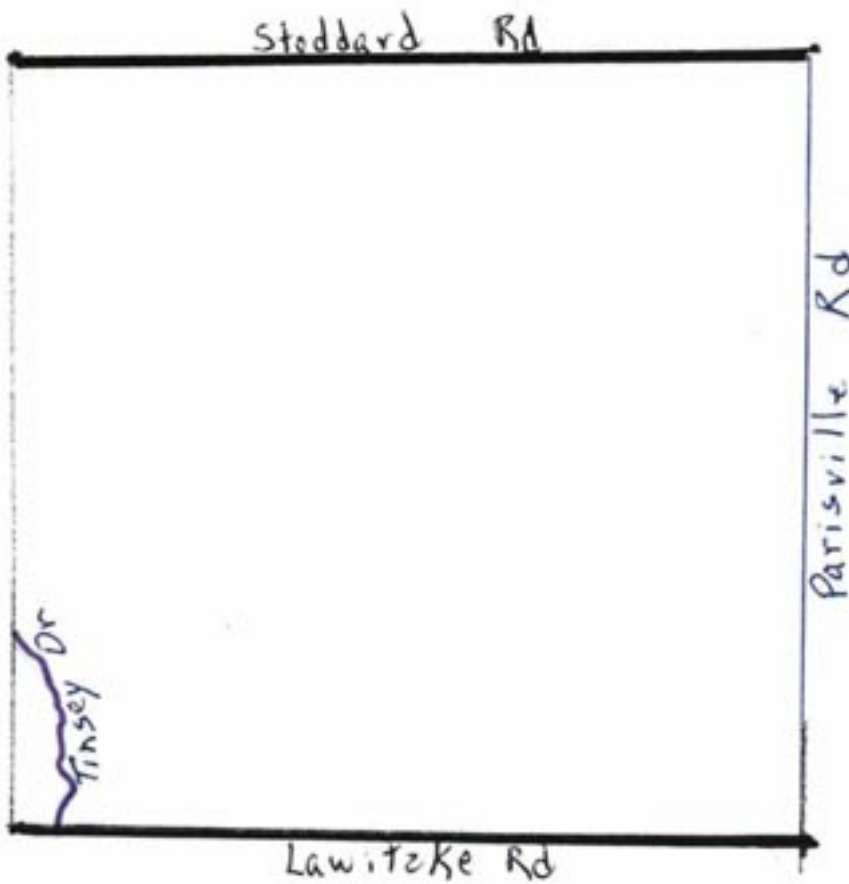

Huron Township **MASTER PLAN** **SECTION 15**

ROADS:

- Parisville (*Improved*)
- Stoddard
(*Black Top – C. Primary*)
- Lawitzke (*Black Top*)

CURRENT ZONING:

☐ Ag

FEATURES: Tinsey Drain

OTHER INFORMATION: _____

EXISTING NON-CONFORMING USE: _____

FUTURE USE: Ag

Huron Township MASTER PLAN SECTION 16



ROADS:

- Hubbard (N 1/2)
- Stoddard
(Black Top – C. Primary)
- Lawitzke (E 1/2 Paved)
- Huron City
(Black Top – C. Primary)

CURRENT ZONING:

○ Ag

FEATURES: Tinsey Drain

Stone Quarry

Flat Rock Farm LLC

Hot Shot Outfitters

OTHER INFORMATION:

EXISTING NON-CONFORMING USE:

FUTURE USE: Ag

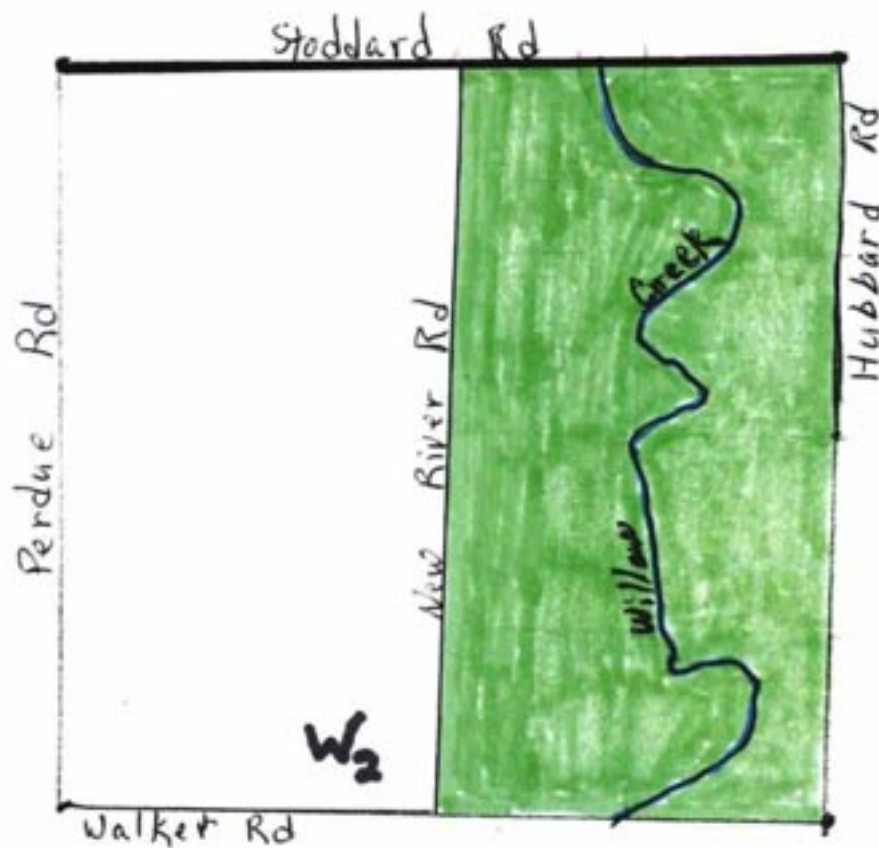

Huron Township **MASTER PLAN** **SECTION 17**

ROADS:

- Hubbard
(N 1/2 -- Improved)
- Perdue
- Stoddard
(Black Top -- C. Primary)
- Walker (W 1/2)
- New River (Center N/S)

CURRENT ZONING:

- ☐ Ag
- ☒ River Front and/or Recreational

FEATURES: Willow Creek

OTHER INFORMATION:

EXISTING NON-CONFORMING USE:

FUTURE USE: Ag

Recreational and/or River Front Zone

Huron Township MASTER PLAN SECTION 18

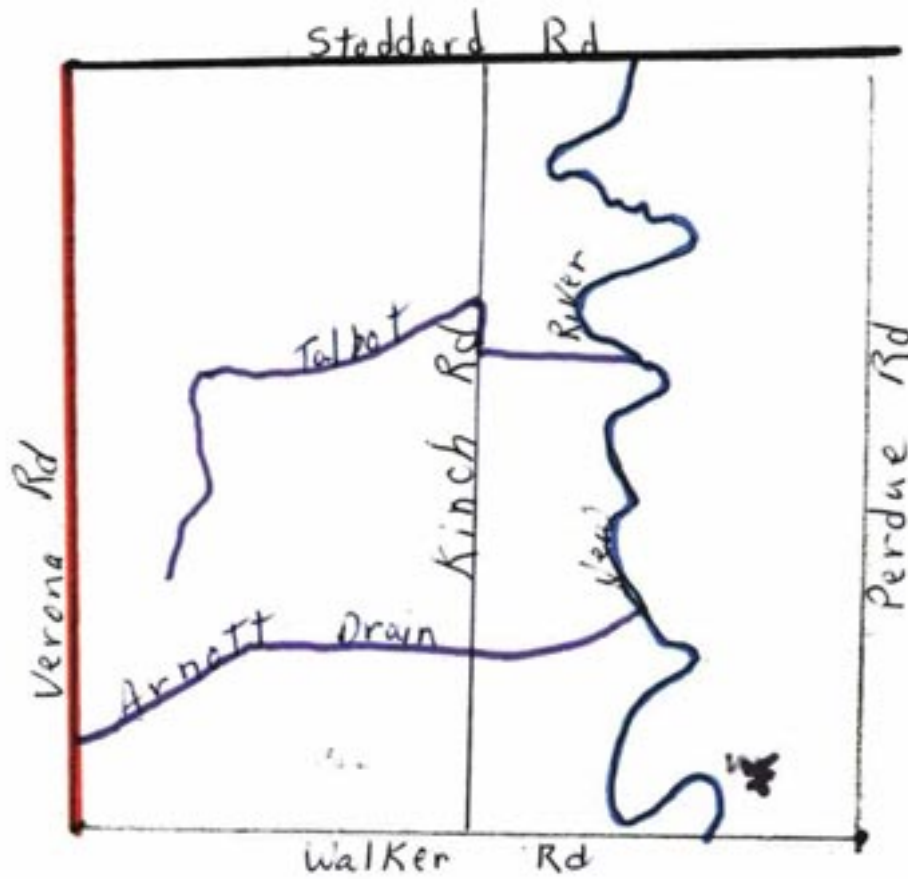

ROADS:

- Perdue
- Verona (Black Top – C. Class A, C. Primary)
- Stoddard (Black Top – C. Primary)
- Walker
- Kinch (Center N/S)

CURRENT ZONING:

- Ag
- ~ River Front Zone

FEATURES: New River

Arnott Drain

Talbot Drain

OTHER INFORMATION:

EXISTING NON-CONFORMING USE:

FUTURE USE: Ag

River Front Zone

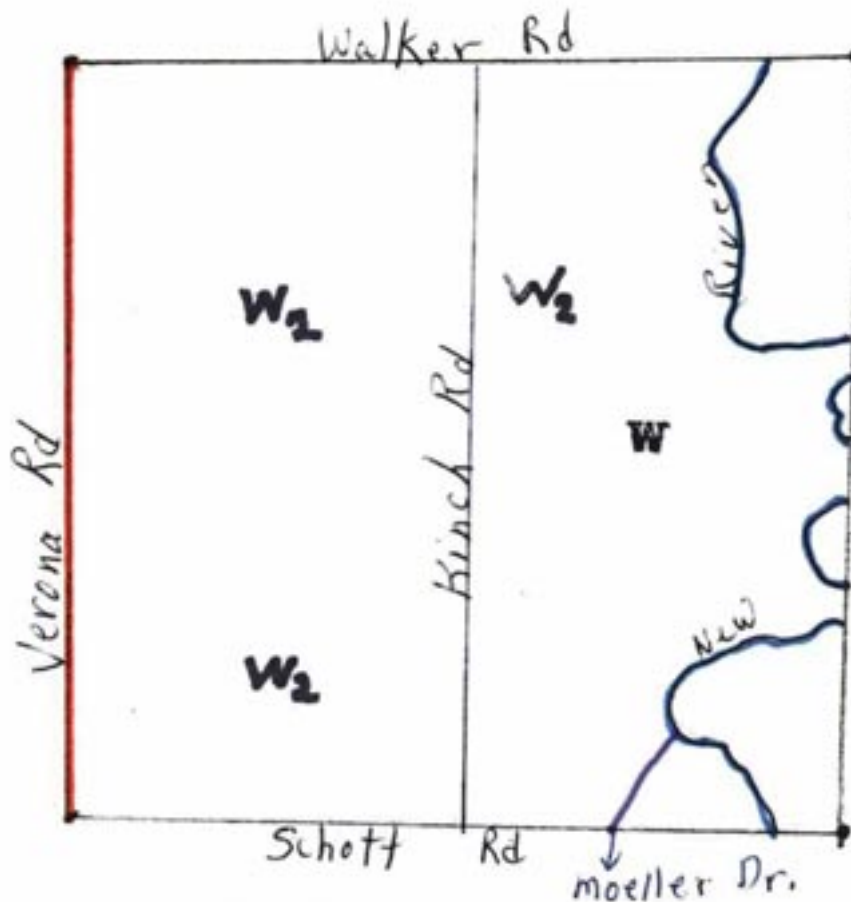

Huron Township MASTER PLAN SECTION 19

ROADS:

- Verona
(Black Top –
Class A, C. Primary)
- Walker
- Schott
- Kinch (Center N/S)

CURRENT ZONING:

- Ag
- ~ River Front Zone

FEATURES: New River

Wind Tower T65

OTHER INFORMATION: _____

EXISTING NON-CONFORMING USE: _____

FUTURE USE: Ag

River Front Zone

Huron Township MASTER PLAN SECTION 20

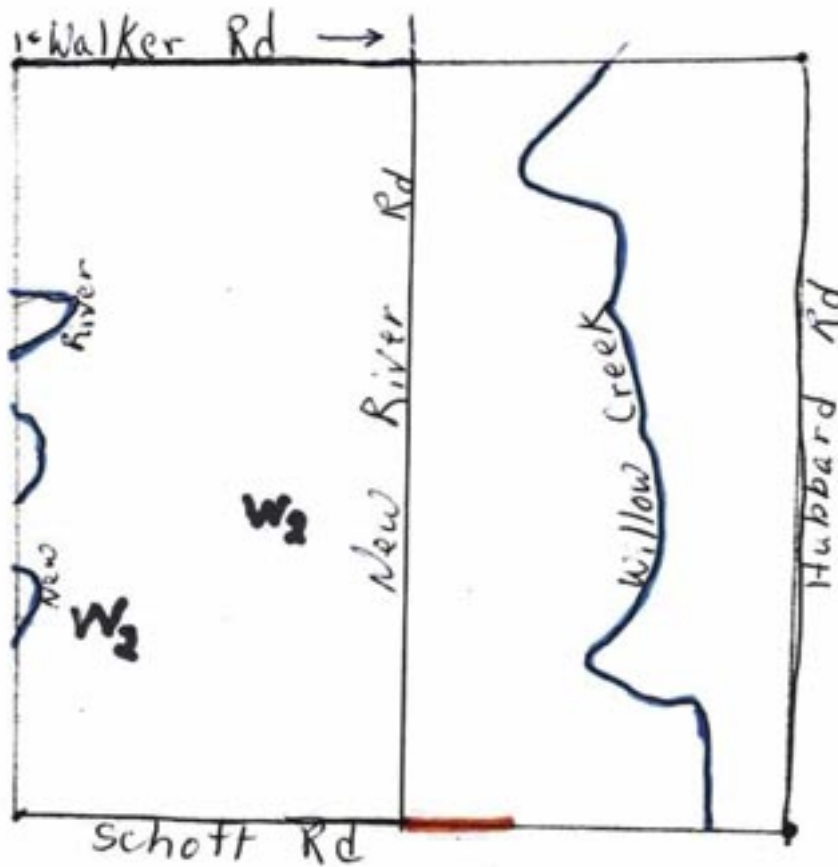

ROADS:

- Hubbard Rd.
- Walker (W 1/2)
- Schott (W 1/2 ±)
- New River (Center N/S)

CURRENT ZONING:

- Ag
- ~ River Front Zone

FEATURES: New River Willow Creek

OTHER INFORMATION: _____

EXISTING NON-CONFORMING USE: _____

FUTURE USE: Ag River Front Zone

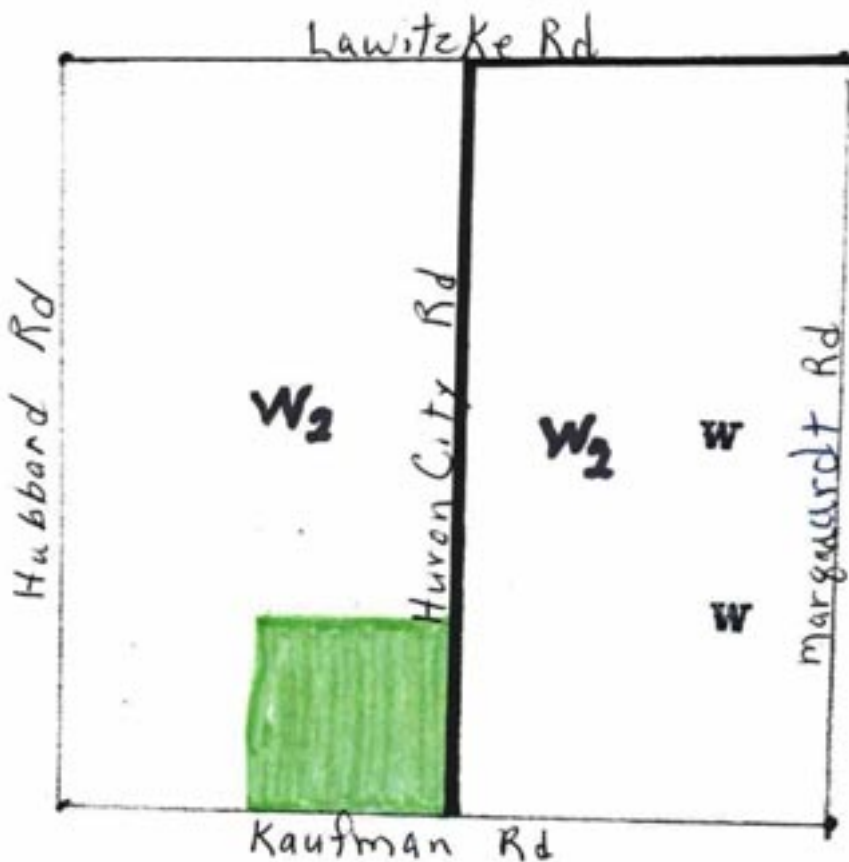

Huron Township MASTER PLAN SECTION 21

ROADS:

- Marquardt Rd.
- Hubbard Rd.
- Lawitzke Rd. (E 1/2 Paved)
- Kaufman Rd.
- Huron City Rd.
(Center N/S,
Black Top – C. Primary)

CURRENT ZONING:

- Ag
- River Front and/or
Recreational

FEATURES: Grindstone-Port Hope Sportsmen's Club

Wind Towers T45 and T46

OTHER INFORMATION:

EXISTING NON-CONFORMING USE:

FUTURE USE: Ag Recreational

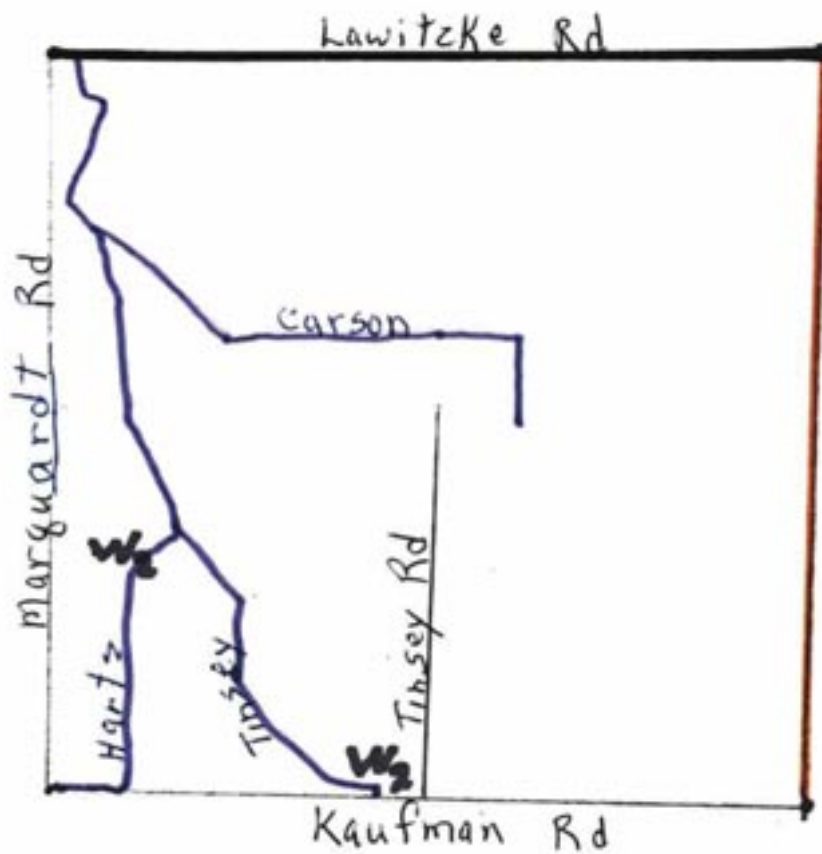

Huron Township **MASTER PLAN** **SECTION 22**

ROADS:

- Parisville Rd.
(Unimproved)
- Marquardt Rd.
- Lawitzke Rd. (Paved)
- Kaufman Rd.
- Tinsey Rd. (S 1/4,
Center N/S)

CURRENT ZONING:

○ Ag

FEATURES: Carson Drain Hartz Drain Tinsey Drain

OTHER INFORMATION:

EXISTING NON-CONFORMING USE:

FUTURE USE: Ag

Huron Township **MASTER PLAN** **SECTION 23**



ROADS:

- Minden
- Parisville Rd.
(1/4 M N Improved;
Unimproved)
- Lawitzke Rd.
(W 1,000' Paved)
- Kaufman Rd.

CURRENT ZONING:

○ Ag

FEATURES: _____

OTHER INFORMATION: _____

EXISTING NON-CONFORMING USE: _____

FUTURE USE: Ag _____

Huron Township
MASTER PLAN
SECTION 24

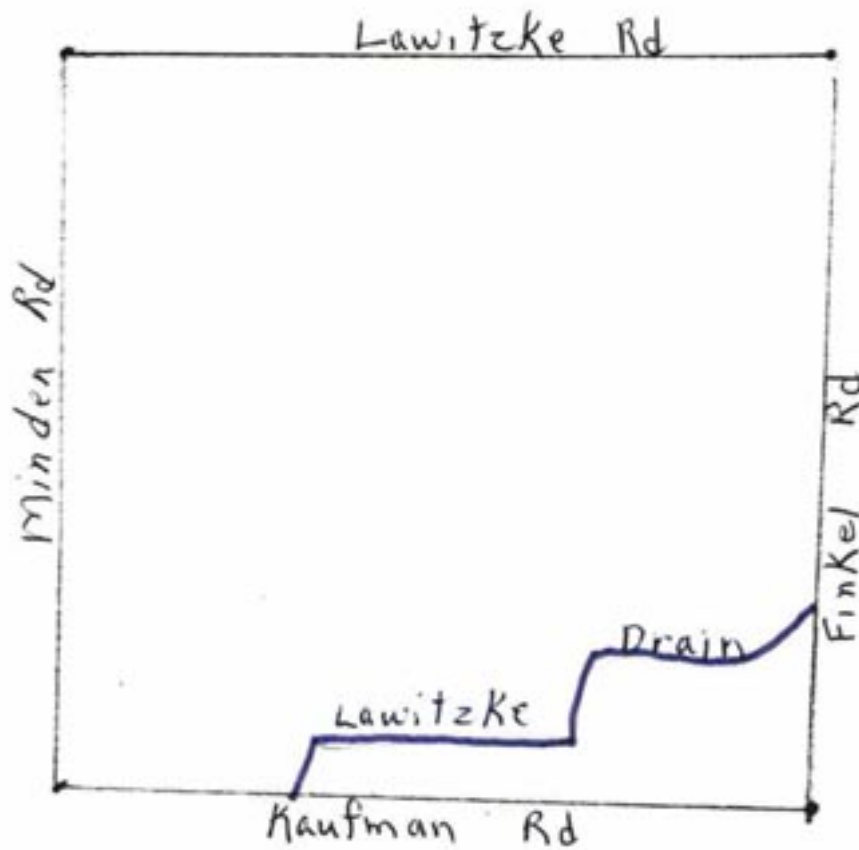

ROADS:

- Finkel
- Minden
- Lawitzke
- Kaufman

CURRENT ZONING:

- Ag

FEATURES: Lawitzke Drain

OTHER INFORMATION: _____

EXISTING NON-CONFORMING USE: _____

FUTURE USE: Ag

Huron Township MASTER PLAN SECTION 25



ROADS:

- Finkel
- Minden
- Kaufman
- Moeller

CURRENT ZONING:

☐ Ag

FEATURES: Marquardt Cemetery Hood Drain

OTHER INFORMATION:

EXISTING NON-CONFORMING USE:

FUTURE USE: Ag

Huron Township MASTER PLAN SECTION 26

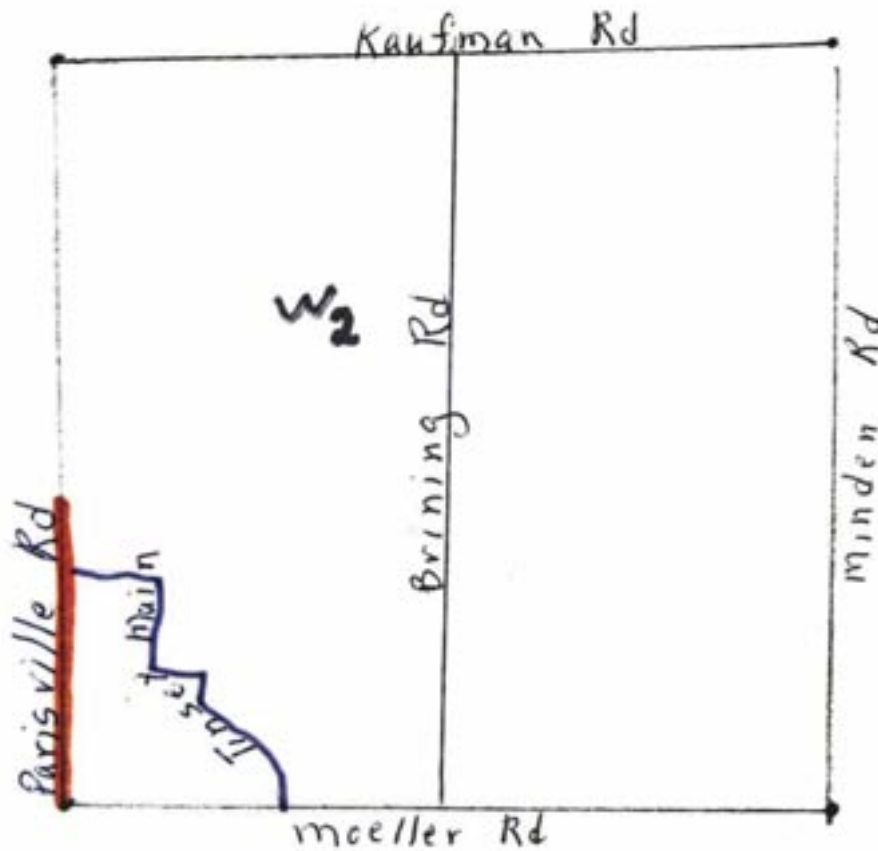

ROADS:

- Minden
- Parisville
(S 1/4 Unimproved)
- Kaufman
- Moeller
- Brining (Center N/S)

CURRENT ZONING:

○ Ag

FEATURES: Tinsey Drain

OTHER INFORMATION: _____

EXISTING NON-CONFORMING USE: _____

FUTURE USE: Ag

Huron Township MASTER PLAN SECTION 27

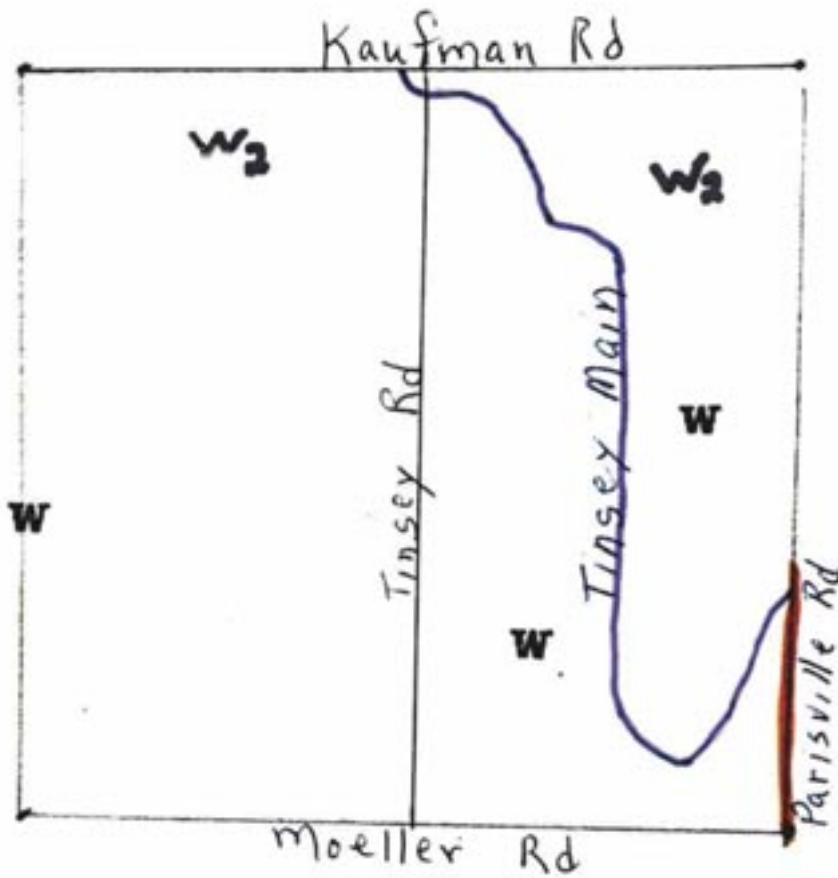

ROADS:

- Parisville (S 1/4 Unimproved)
- Kaufman
- Moeller
- Tinsey (Center N/S)

CURRENT ZONING:

○ Ag

FEATURES: Tinsey Drain

Wind Towers T55, T56, T49

OTHER INFORMATION: _____

EXISTING NON-CONFORMING USE: _____

FUTURE USE: Ag

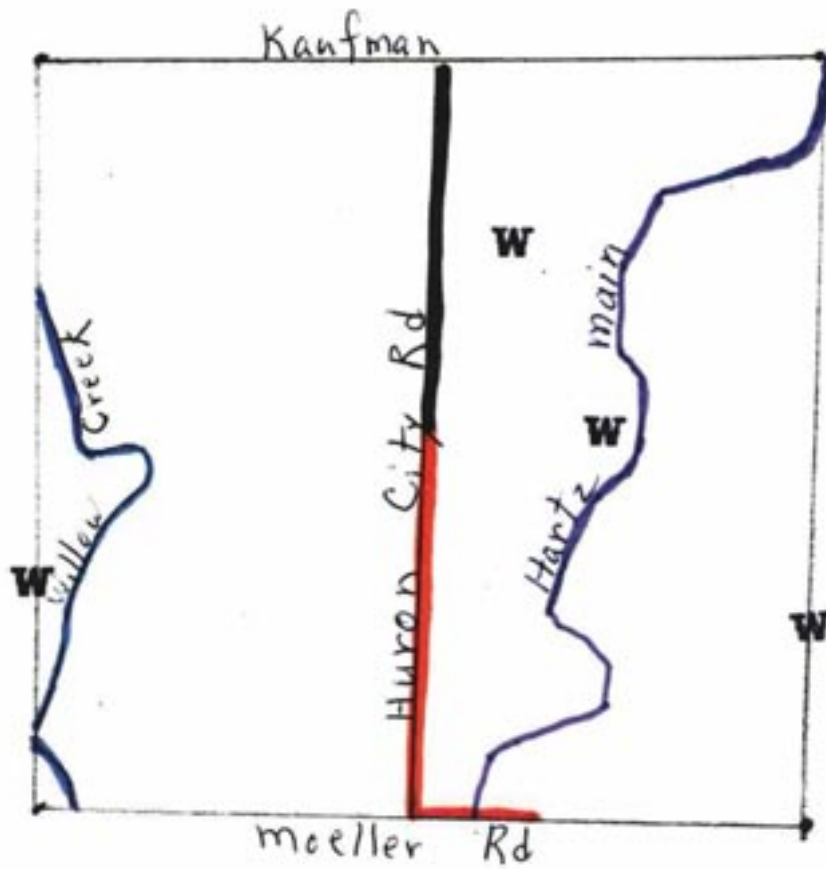

Huron Township **MASTER PLAN** **SECTION 28**

ROADS:

- Kaufman
- Moeller
- Huron City (Center N/S, Black Top, C. Primary)

CURRENT ZONING:

- Ag
- ~ River Front Zone

FEATURES: Willow Creek Hartz Drain

Wind Towers T49, T48, T47, T37

OTHER INFORMATION:

EXISTING NON-CONFORMING USE:

FUTURE USE: Ag River Front Zone



Huron Township MASTER PLAN SECTION 29

ROADS:

- Iseler (Unimproved)
- Schott (W 1/2 ±)
- Moeller
- New River (Center N/S)

CURRENT ZONING:

- Ag
- ~ River Front Zone

FEATURES: New River Willow Creek

Wind Towers T37, T38, T35, T66

OTHER INFORMATION: _____

EXISTING NON-CONFORMING USE: _____

FUTURE USE: Ag River Front Zone

Huron Township MASTER PLAN SECTION 30

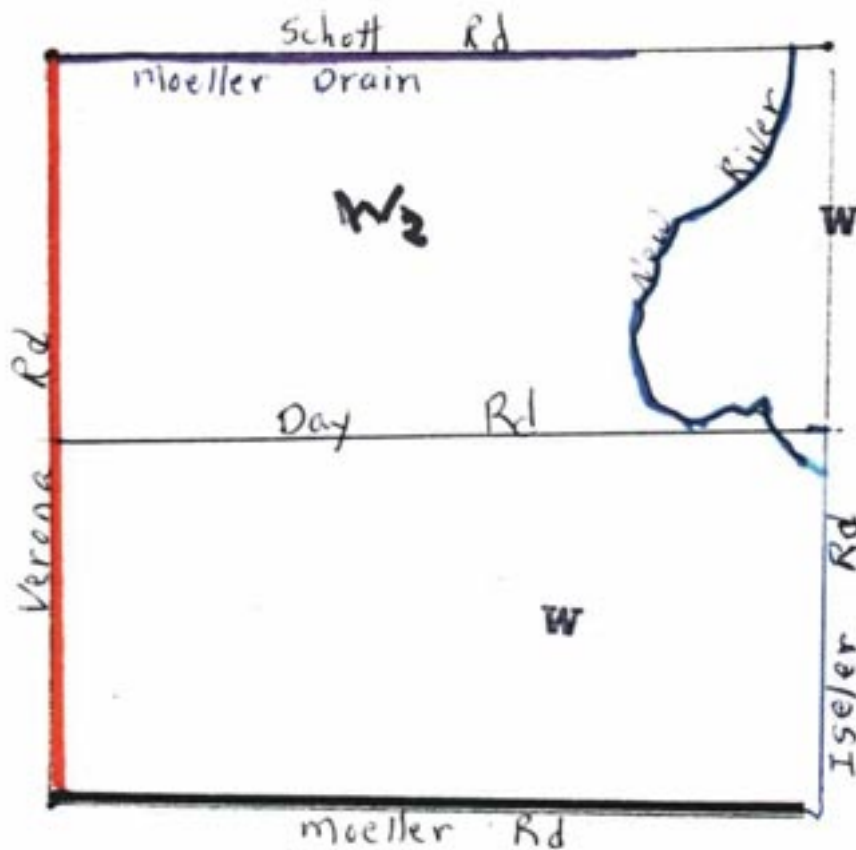

ROADS:

- Iseler (Unimproved)
- Verona (Black Top, Class A, C. Primary)
- Schott
- Moeller (Black Top)
- Day (Center E/W)

CURRENT ZONING:

- Ag
- ~ River Front Zone

FEATURES: New River

Wind Towers T66, T28

OTHER INFORMATION:

EXISTING NON-CONFORMING USE:

FUTURE USE: Ag

River Front Zone

Huron Township MASTER PLAN SECTION 31



ROADS:

- Iseler (Unimproved)
- Verona (Black Top, Class A, C. Primary)
- Moeller (Paved)
- Kinde (Black Top, Class A, C. Primary)

CURRENT ZONING:

- Ag
- ~ River Front Zone

FEATURES: New River Zion Cemetery

Wind Towers T29, T30, T31,

OTHER INFORMATION: _____

EXISTING NON-CONFORMING USE: _____

FUTURE USE: Ag River Front Zone

Huron Township MASTER PLAN SECTION 32

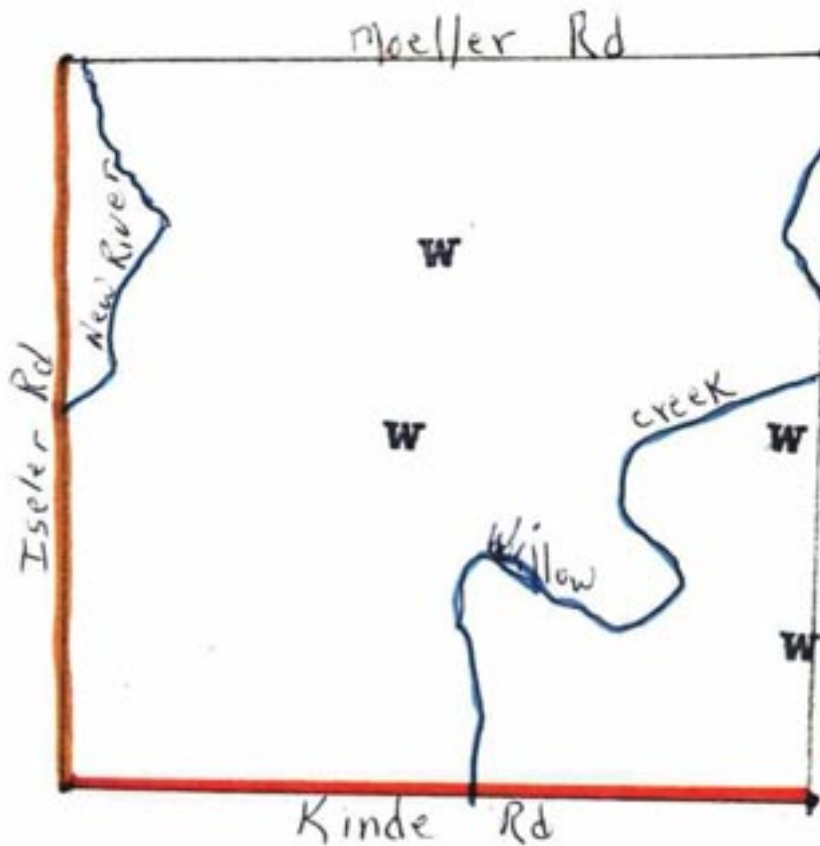

ROADS:

- Iseler (*Unimproved*)
- Moeller
- Kinde (*Black Top, Class A, C. Primary*)

CURRENT ZONING:

- Ag
- ~ River Front Zone

FEATURES: New River Willow Creek

Wind Towers T38, T39, T40, A3

OTHER INFORMATION:

EXISTING NON-CONFORMING USE:

FUTURE USE: Ag River Front Zone

Huron Township MASTER PLAN SECTION 33

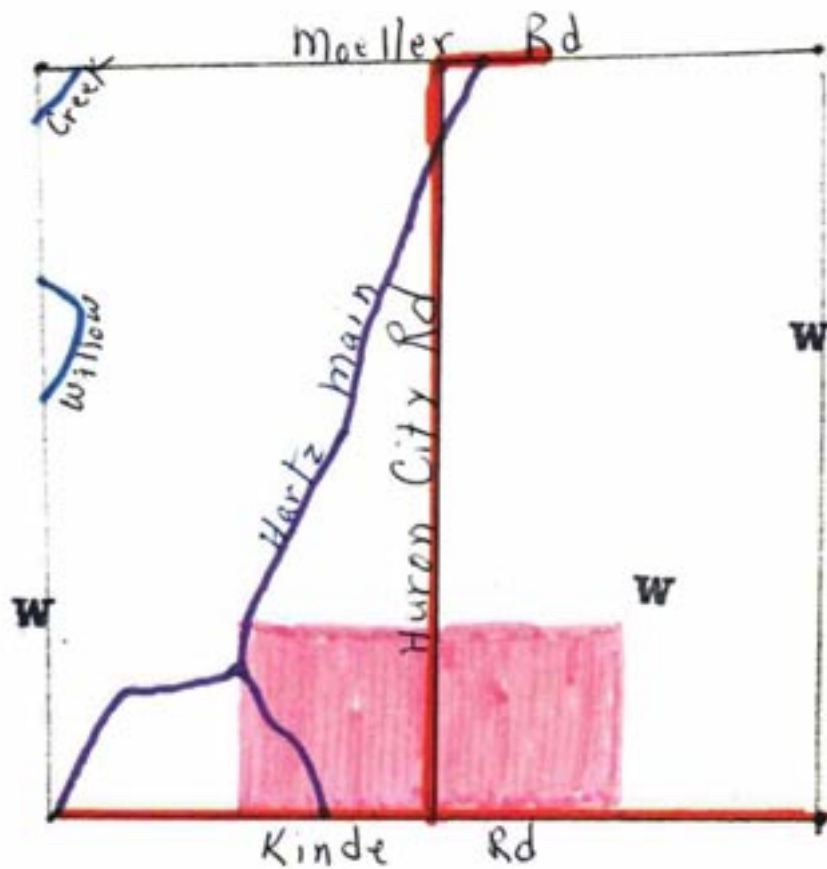

ROADS:

- Moeller
- Kinde (*Black Top, Class A, C. Primary*)
- Huron City (*Center N/S, Black Top, Class A, C. Primary*)

CURRENT ZONING:

- Ag
- Commercial
- ~ River Front Zone

FEATURES: Willow Creek Hartz Drain

Wind Towers T50, T40, T69

Lewisville

Saloon

OTHER INFORMATION:

EXISTING NON-CONFORMING USE:

FUTURE USE: Ag Commercial River Front Zone

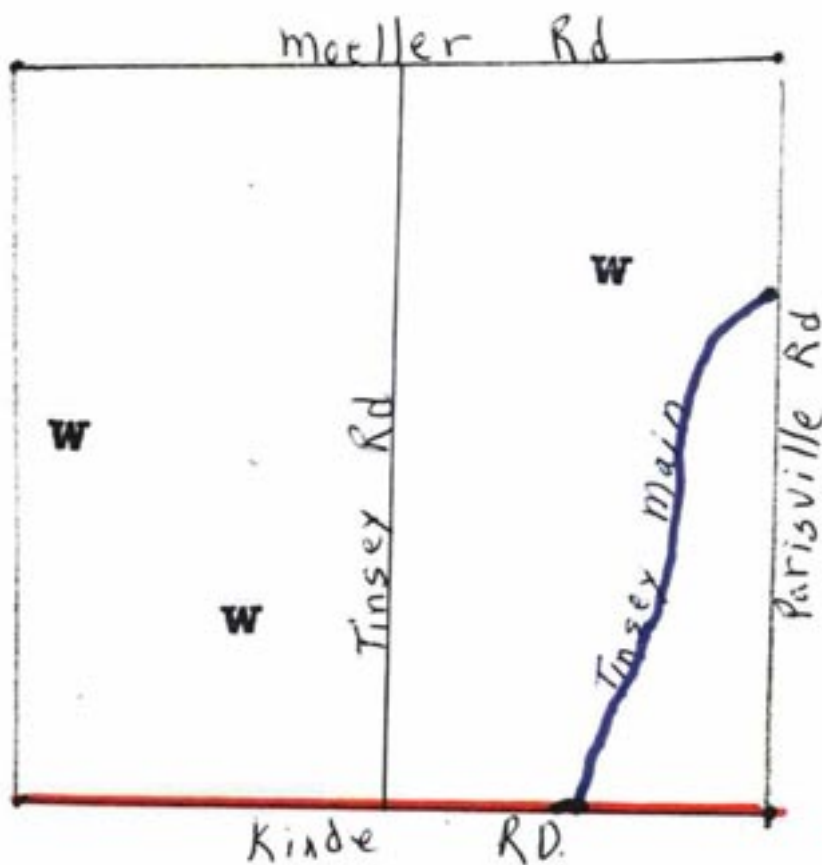

Huron Township **MASTER PLAN** **SECTION 34**

ROADS:

- Parisville
- Moeller
- Kinde (*Black Top, Class A, C. Primary*)
- Tinsey (*Center N/S*)

CURRENT ZONING:

○ Ag

FEATURES: Tinsey Drain

Wind Towers T52, T57, T51

OTHER INFORMATION: _____

EXISTING NON-CONFORMING USE: _____

FUTURE USE: Ag

Huron Township MASTER PLAN SECTION 35

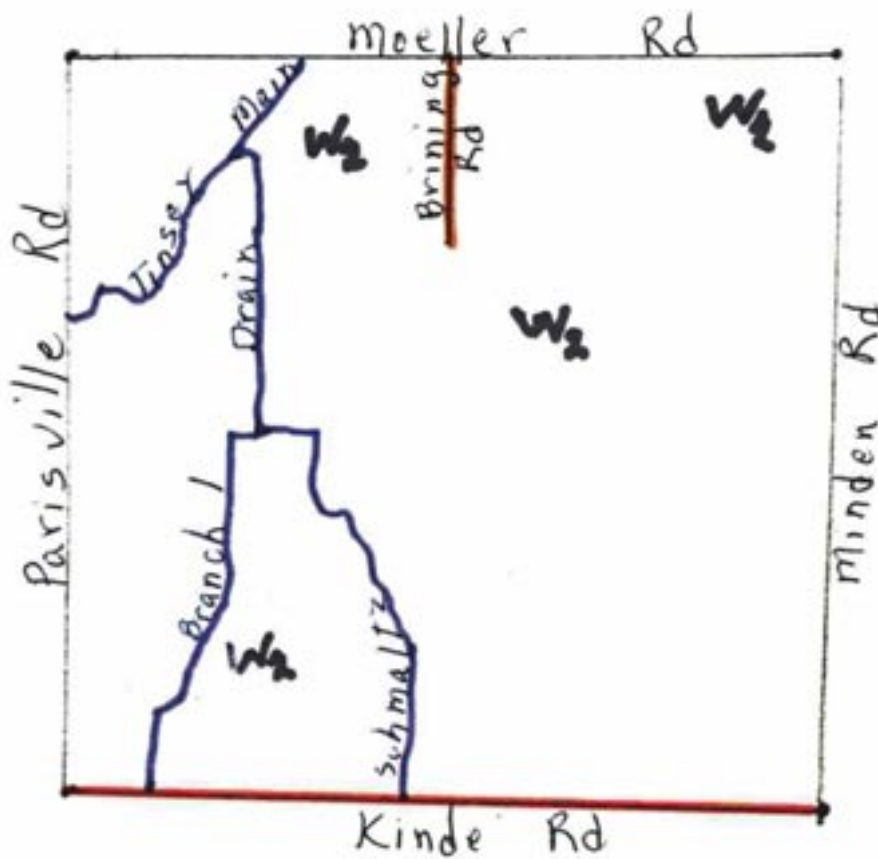

ROADS:

- Minden
- Parisville
- Moeller
- Kinde (Black Top, Class A, C. Primary)
- Brining (Center N 660', Unimproved)

CURRENT ZONING:

○ Ag

FEATURES: Tinsey Drain Schmaltz Drain Branch 1 Drain

OTHER INFORMATION: _____

EXISTING NON-CONFORMING USE: _____

FUTURE USE: Ag

Huron Township MASTER PLAN SECTION 36

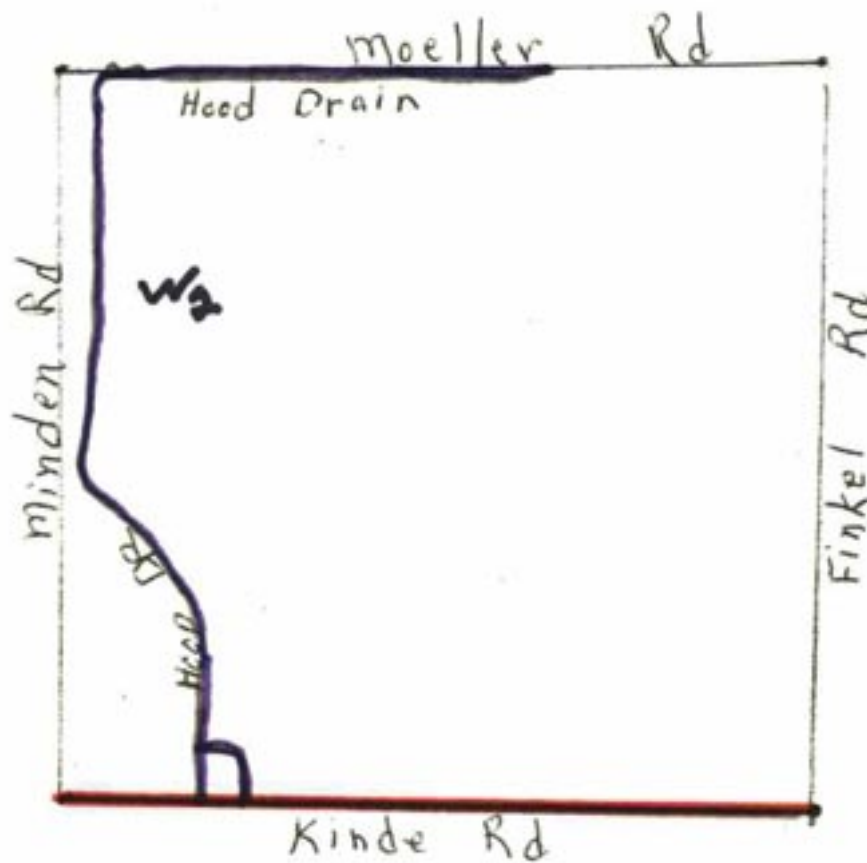

ROADS:

- Finkel
- Minden
- Moeller
- Kinde (Black Top, Class A, C. Primary)

CURRENT ZONING:

○ Ag

FEATURES: Hood Drain

OTHER INFORMATION:

EXISTING NON-CONFORMING USE:

FUTURE USE: Ag