



# The Yorktowne XVIII with Double Garage



"Live The Great Life"



"Distinctive Craftsman Style Homes"



"Distinctive Craftsman Style Homes"

**Craftowne Homes**

"Distinctive Craftsman Style Homes"

(864) 654-5750

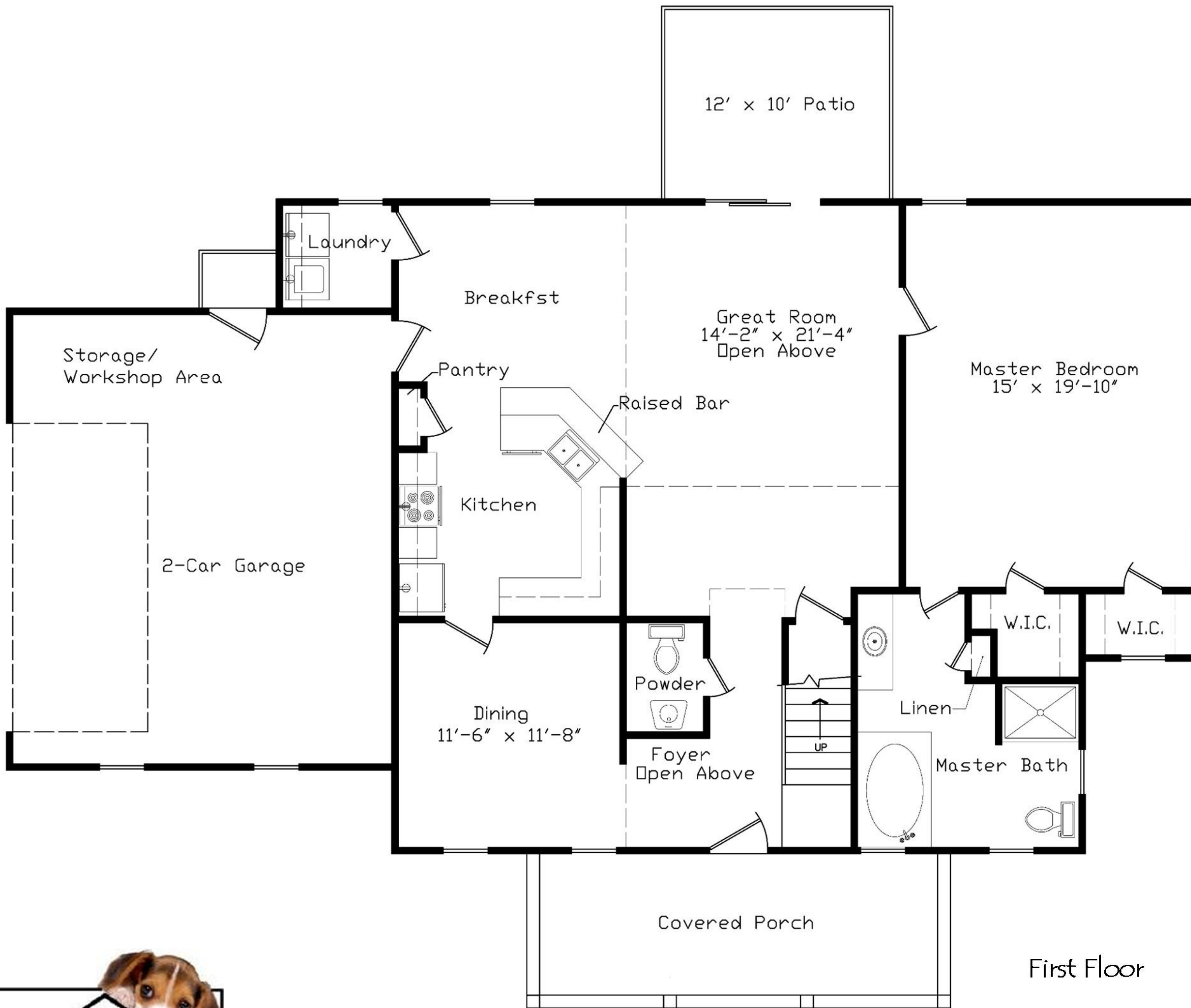

- Features:
- Distinctive Architecture
  - 4 Bedrooms/3.5 Baths
  - Master on Main
  - Lounge Balcony
  - Playroom/Bedroom
  - Formal Dining
  - Double Covered Porches
  - 9 Ft. Ceilings (Down)

- Areas:
- 1st Floor: 1,404 sq. ft.
  - 2nd Floor: 964 sq. ft.
  - Total Heated: 2,368 sq. ft.
  - Garage: 480 sq. ft.
  - Covered Porch: 352 sq. ft.
  - Under Roof: 3,200 sq. ft.

First Floor

# The Yorktowne XVIII with Double Garage



"Live The Great Life"

"Distinctive Craftsman Style Homes"

**Craftowne Homes**

"Distinctive Craftsman Style Homes"

(864) 654-5750

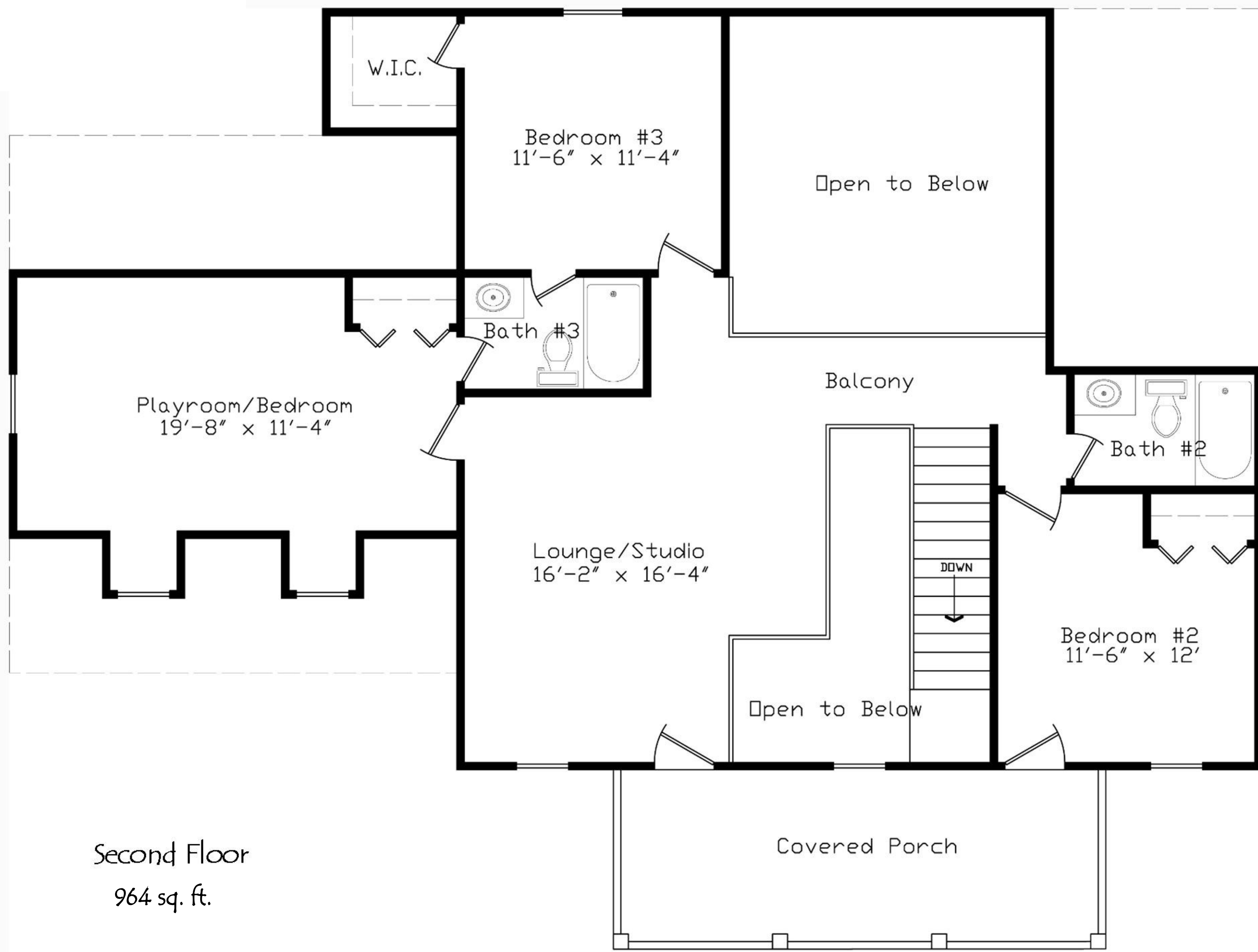

Second Floor  
964 sq. ft.

**Features:**

- Distinctive Architecture
- 4 Bedrooms/3.5 Baths
- Master on Main
- Lounge Balcony
- Playroom/Bedroom
- Formal Dining
- Double Covered Porches



# The Yorktowne XVIII with Double Garage



"Live The Great Life"



























