

# Hydraulic Elevators / Hidrolik Asansörler

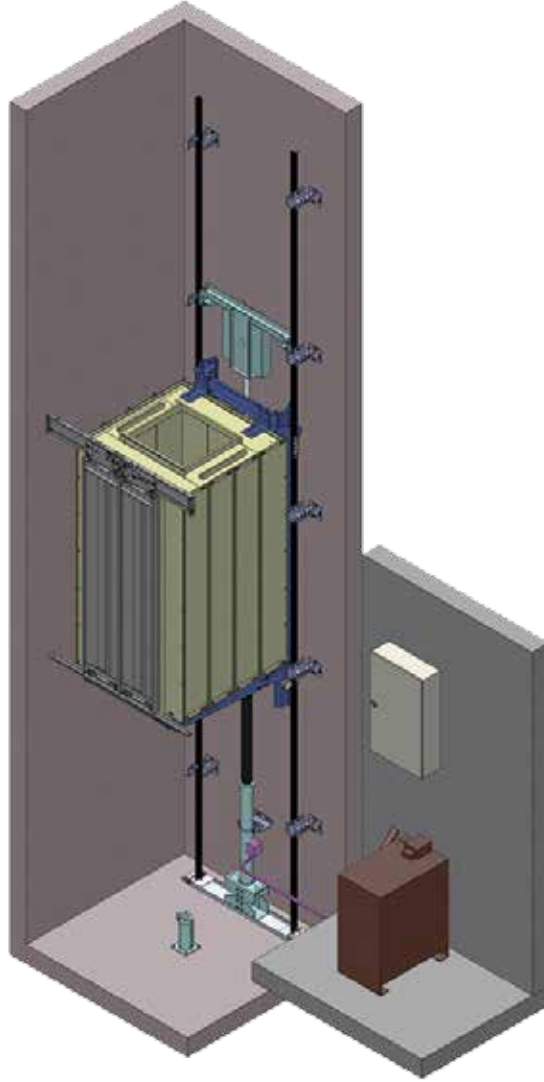

## Açıklama

- 1,2 m/s azami hız, açık ara en sessiz hidrolik sistem
- Smooth Start / Smooth Stop, ekstra yumuşak duruş/kalkış
- Full elektronik valfli hassas ve mutlak kontrol
- 1,5 – 4,5 kW monofaze hidrolik tanklar
- 2,7 – 75 kW trifaze hidrolik tanklar
- 8 – 650 l/dak pompa sistemleri
- Maxi ç, uzun ömürlü valf sistemleri
- 50 – 280 mm pistonlar
- 2 ve 3 kademeli teleskopik pistonlar
- Yandan 1/1 – 2/1 tek veya çift piston sistemler
- Alttan direkt etkili sistemler
- 2 veya 3 noktadan bölünmüş eklenebilir pistonlar
- “CE” belgeli orijinal Karkaslar

## Description

- 1.2 m/s maximum speed, the most quiet hydraulic system
- Smooth Start / Stop Smooth, extra soft stop / start
- Sensitive and absolute full electronic valve control
- 1,5 - 4,5 KW single phase hydraulic tanks
- 2.7 to 75 kW three-phase hydraulic tanks
- 8-650 l / min pump systems
- Maxi coil, long-lasting valve systems
- 50-280 mm pistons
- 2 and 3-stage telescopic cylinders
- Side 1/1 - 2/1 for single or double piston system
- Bottom of the direct-acting systems
- 2 or 3 points that can be added to split from the pistons
- “CE” certified original Carcasses

## Hidrolik Asansörler / Hydraulic Elevators

KULLANIM / USAGEV	İlla, Panoramik, Yolcu, Özürlü, Hastane, Arça ve Yük Asansörleri Villa, Panoramic, Passenger, Disabled, Hospital, Car, Freight Elevators
KAPASİTE / RATED LOADS (PERSONS/KG)	200 Kg. - 10.000 Kg.
DURAK SAYISI / MAXIMUM STOPS	28 m
BEYAN HIZI / CAR SPEED (M/S)	0.63
MOTOR TİPİ / MOTOR TYPE	Hidrolik Tahrikli / Hydraulic Electronic
KUYU DİBİ / PIT DEPTH (MINIMUM)	1400 (500)
ÜST BOŞLUK / HEADROOM (MINIMUM)	3600 (2500)
GİRİŞ SAYISI / MAXIMUM CAR ENTRANCES	3

