

Cottage



## Appliances Included:

Refrigerator, Stove, Microwave, Dishwasher,  
Garbage Disposal, Washer, Dryer

## Updated Options:

Flooring, Carpeting, Lighting, Hardware,  
Corian Countertop, Tile Backsplash

# HIGHLAND II

## 2 Bedroom, 1 Bathroom

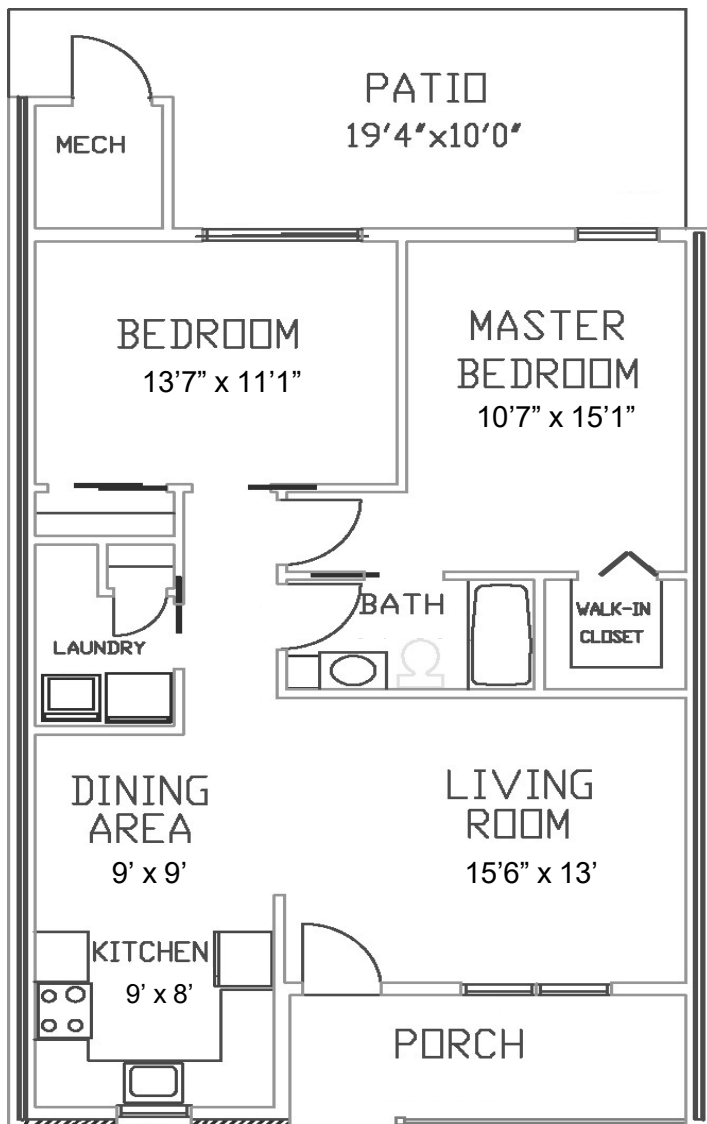

(986 SF)

Floor plans shown are not to scale and indicate  
approximate square footage

## Entry Fee:

# \$207,000

*75% Refund at Resale*

Upgraded features on reverse side

## Monthly Maintenance & Service Fee includes:

- 24/7 On-Call Maintenance
- Property and School Taxes
- Property Insurance
- Maintenance  
(Inside, Outside, & Appliances)
- Water/Sewer
- Trash/Recycling
- Landscaping
- Snow Removal

**1 Resident: \$1,350**

**2 Residents: \$1,580**

*Fee ends when home is returned for resale.*

- Homes have forced air/natural gas heat w/central air.
- Resident is responsible for utilities (heat, electric, cable, internet, & phone).
- We encourage all residents to carry content insurance, e.g., tv, furniture, jewelry, etc.



### Upgraded Features: Highland II

Garage	\$22,000
Extra Half Bath	\$ 3,300
Patio Enclosure	\$ 5,200
Patio Enclosure w/ Heat & Air	\$ 7,800
4-Season Sunroom Addition	\$20,000
Extra Patio	\$ 2,000
Single Home	\$13,000

Upgraded features vary by home

## NOTES