

# SICKLE BAR MOWER FB

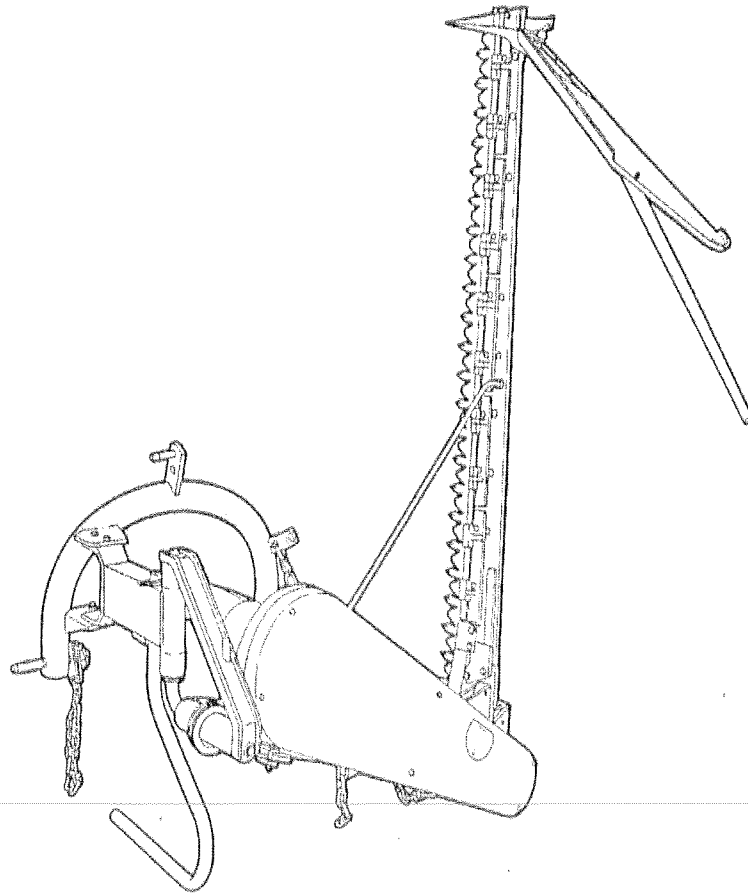

## INDEX

Foreword .....	3
Technical data .....	4
Warranty .....	6
Warranty becomes void .....	7
Identification .....	7
Safety and accident preventing provisions .....	8
Safe servicing .....	13
<b>USE INSTRUCTIONS</b> .....	13
Attaching the cutting arm .....	13
Setting-up the mowing mach ..	14
Hitching to the tractor .....	14
Cardan shaft .....	15
Adapting the mowing bar .....	17
Adjustment .....	17
Mowing .....	19
<b>MAINTENANCE</b> .....	20
Every 3 work hours .....	21
Every 8 work hours .....	21
Every 50 work hours .....	21
Periodically .....	21
After each mowing job .....	22
Cleaning and oiling the cutt. ...	22
The cutters .....	22
Storage .....	23
<b>SPARE PARTS</b> .....	25
Frame .....	Tab. 61/11
Feeler unit .....	Tab. 61/20
Hinge .....	Tab. 61/31
Cutting arm .....	Tab. 61/42

## 1.0 FOREWORD

This handbook contains the use and maintenance instructions plus a list of the parts supplied as spares for the mower Mod. "FB".

### 1.0.1 DESCRIPTION OF THE MOWER

This agricultural implement can only operate by means of a cardan shaft applied to the pto of an agricultural tractor equipped with lift and universal three-point hitch.

Since it is movable, the mowing machine can be easily mounted on tractors with different gauges or on tracked vehicles (Fig. 1).

The two-motion tooth-blade system used in mowing machines, makes possible a scissors cut which leads to a high speed operation on a any crop.

The original tooth-blade motion guarantees a sharp and clean cut on any type of grass, be it damp or flattened. It is thanks to the total absence of soil which this mowing system does not raise, sharp because the stems are not frayed.

The mower may also be used with the cutting arm tilted for working on canals, ditches, embankments. (Fig. 2 and 3).

It is therefore advisable to strictly comply with the following instructions in order to prevent faults which could jeopardize the correct and long-lasting operation of

Fig. 1

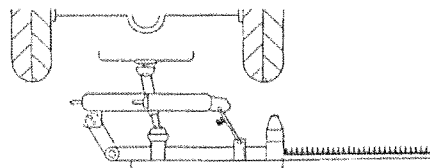
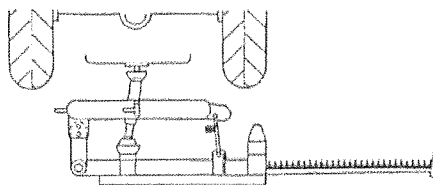

Fig. 2

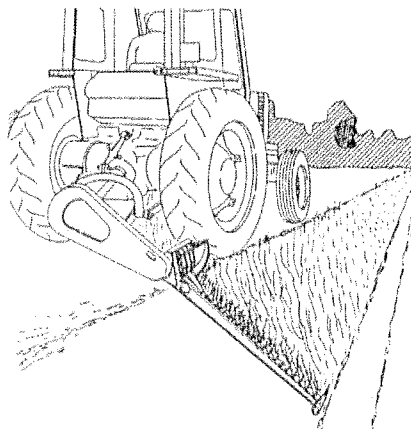
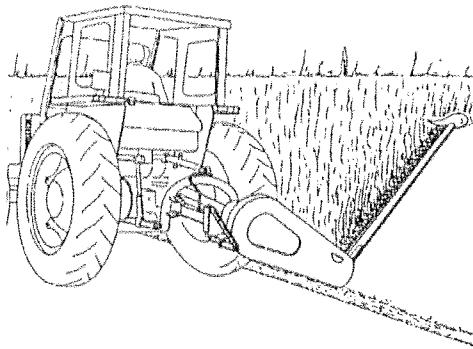

Fig. 3



the implement.

Compliance with the instructions in this handbook is also important since the **Manufacturer declines all and every responsibility for damage to persons or property caused by negligence and failure to comply with these instructions.**

The Manufacturer shall, however, remain at the customers' disposal for immediate and thorough assistance together with anything else that may be required in order to ensure the correct operation and maximum efficiency of the implement.

The Manufacturer reserves the right to make any modifications and improvements to the implement as may be considered opportune, without being obliged to immediately inform the user. The Italian text shall be considered valid in the event of dispute.

### 1.0.2 WARRANTY

- When the machine is delivered, check that it has not been subjected to damage during transport and that the accessories are in a perfect condition and complete.
- **Any claims following the receipt of damaged goods shall be presented in writing within 8 days from receipt of the goods themselves.**
- The purchaser may only make claims under guarantee when he has complied with the warranty conditions in the supply contract.
- The guarantee is valid for one year. It covers all material defects and runs from the date on which the implement without guards.
- The guarantee does not cover labor and shipping costs (the transport of parts and material under the terms of this guarantee is at the exclusive risk of the receiver).

- Any damage which may be caused to persons or property is not covered by the guarantee.
- The guarantee is limited to the repair or replacement of definitive parts. Repair or replacement shall take place according to the manufacturer's instructions, and at no charge to the customer.

#### 1.0.2.1 WHEN THE WARRANTY BECOMES VOID

Besides the cases specified in the supply agreement, the guarantee shall in any case become void:

- When the implement has been used beyond the specified limits, as given in the technical data chart on page 4.
- When the user has failed to comply with the instructions in this handbook.
- The guarantee does not cover malfunctions due to improper use, inadequate maintenance, or erroneous actions taken by customer.
- The guarantee shall be considered null and void if modifications to the unit have been made without the manufacturer's prior written authorization, or if non-original replacement parts have been used.

### 1.0.3 HANDLING

If the machine is handled, it must be lifted by hooking onto the appropriate holes with a suitable winch or crane of sufficient capacity. Because of the danger involved, this operation should be carried out by trained and responsible personnel. The mass of the machine is on the identification Plate (11 fig. 4).

Stretch the rope to keep the machine level.

The hook points can be detected by finding the "hook" symbol (fig. 5).

### 1.0.4 IDENTIFICATION

Each single piece of equipment, is equipped with an identification plate (18 fig. 2), which bears:

- Manufacturer's mark
- Name, business name and address of the Manufacturer;
- Type of machine
- Registration of the machine
- Year of manufacture
- Mass, in Kilograms.

This information must always be quoted whenever assistance or spare parts are needed.

### 1.0.5 TECHNICAL DATA

Power required ..... 25 HP  
Power take-off revs ..... 540 rpm  
Schinit ..... 10÷12 Km/h  
Cutting arm length.. 1,30-1,45-1,75-2,05 mt  
Weight ..... 192-195-207-213 Kg

- 1 External shoe
- 2 Mowing guide
- 3 Cutting arm
- 4 Upper 3rd point hitches
- 5 Gauge varying articulation
- 6 Chassis
- 7 Tirant
- 8 Lower 3rd point hitches
- 9 Frame height adjuster chain
- 10 Support
- 11 Identification plate
- 12 Cover
- 13 Outer skid and cutter guard
- 14 Lower 3rd point hitches
- 15 Left arm
- 16 Support
- 17 Bar height adjuster chain
- 18 Lift link adjuster chain

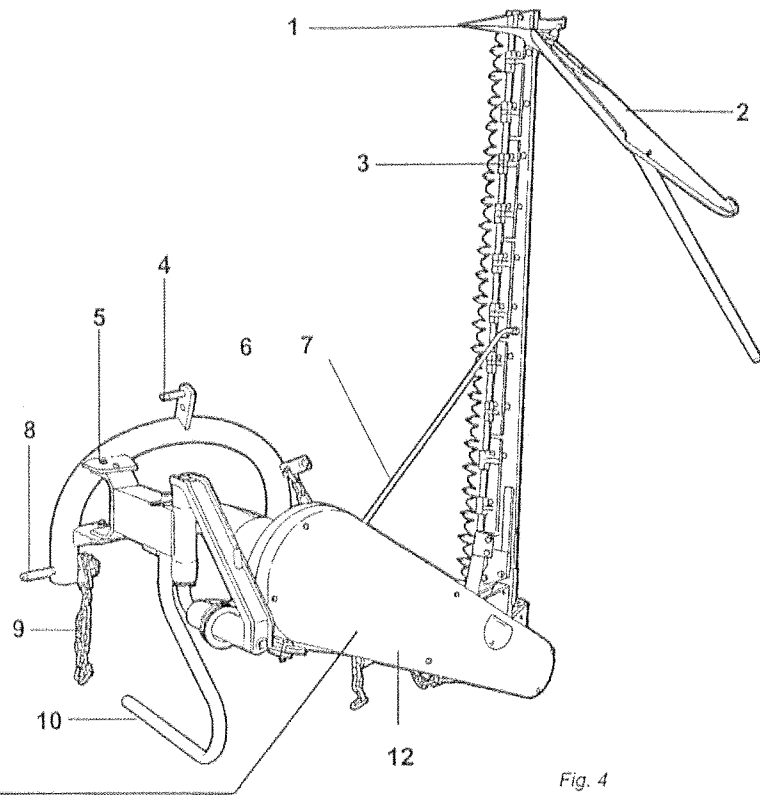
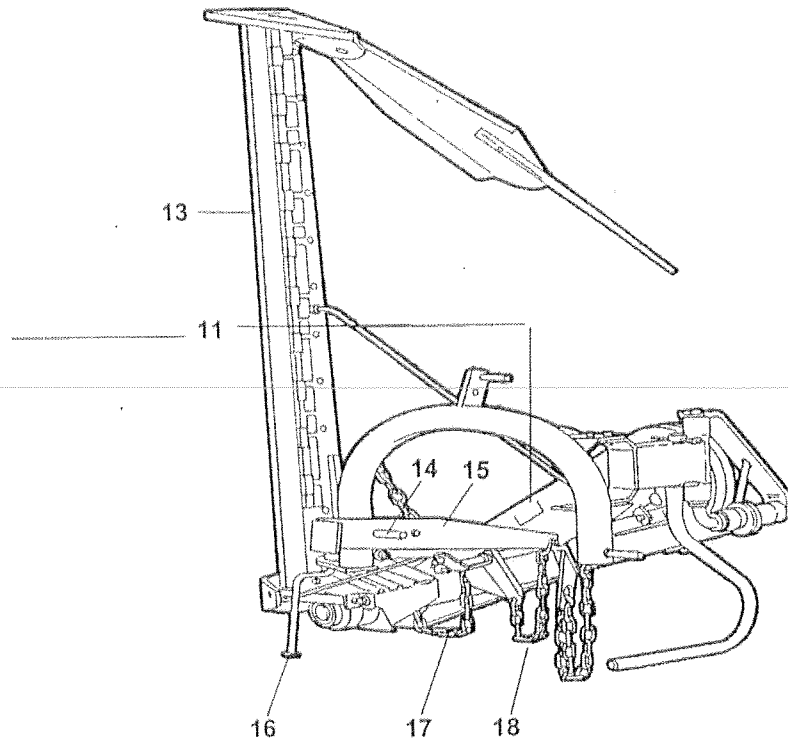

Fig. 4

**WALTON** <sup>(UK)</sup>



### 1.0.6 DANGER SIGNALS

The signs described in fig. 3 are reproduced on the machine. Keep them clean and replace them if they should come off or become illegible. Carefully read each description and learn their meanings by heart.

- 1) Before operating, carefully read the instruction booklet.
- 2) Before carrying out maintenance, stop the machine and consult the instruction booklet.
- 3) Danger of getting squashed during opening. Keep at a safe distance from the machine.
- 4) You could be hit by sharp stones. Keep well away from the machine while it operates.
- 5) Danger of injury to the legs or the arms.
- 6) Cardan shaft, keep well away.
- 7) Signs the hooking points for lifting.

1

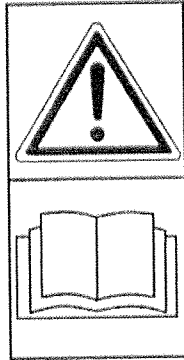

2

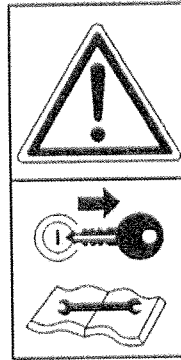

3

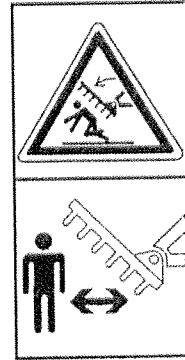

4



5



6

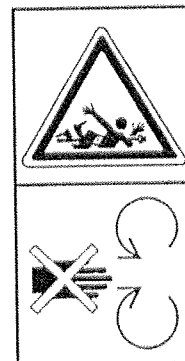

7

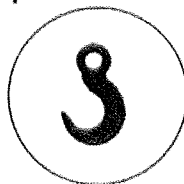



Pay great attention to the danger signal where indicated in this handbook.

There are three types of danger signal:



**DANGER:** This signal warns when serious injuries, death or long-term health risks would be caused by failure to correctly carry out the described operations.



**ATTENTION:** This signal warns when serious injuries, death or long-term health risks could be caused by failure to correctly carry out the described operations.



**CAUTION:** This signal warns when damage to the machine could be caused by failure to carry out the described operations.

## 2.0 SAFETY AND ACCIDENT PREVENTING PROVISIONS

Thoroughly read all the instructions before using the machine. Contact the technicians of your Authorized Dealer in case of doubt.

The Manufacturer declines all and every responsibility for failure to comply with the following safety and accident preventing provisions.

- 1) Comply with the instructions given by the danger symbols in this handbook and affixed to the mower.
- 2) Never ever touch any moving part.
- 3) Operations and adjustments to the implement must always be carried out when the engine is off and the tractor braked.
- 4) It is absolutely forbidden to carry passengers or animals on the implement.
- 5) It is absolutely forbidden for persons without a driving license, inexperienced persons or those in precarious health conditions to drive the tractor with the implement mounted.
- 6) Strictly comply with all the recommended accident preventing measures described in this handbook.
- 7) Assembly of a supplementary implement on the tractor will shift the weights on the axles. It is therefore advisable to add weights to the front part of the tractor in order to balance the weights on the axles themselves.
- 8) The coupled implement may only be controlled through the cardan shaft complete with the necessary safety devices for overloads and with the guards fixed with the relative latch.
- 9) Before starting the tractor and implement, always check that all safety devices guarding transport and use are in a perfect condition.
- 10) With help from the instructions, strictly comply with the relative safety and accident preventing prescriptions.
- 11) The instruction labels affixed to the machine give useful advice on how to prevent accidents.
- 12) Always comply with the highway code in force in your country when travelling on public roads.
- 13) Always become familiar with the controls and their operation before starting work.
- 14) Always wear suitable clothing. Never ever wear loose garments or those with edges that could in some way become caught up in rotating parts or moving mechanisms.
- 15) Before operating the implement, check all around the machine to see that there are no persons (particularly children) or domestic animals nearby and that visibility is optimum.
- 16) Keep away from the cardan shaft while it is turning.
- 17) As indicated, couple the implement to a tractor of adequate power and configuration, using a device (lift) conforming to the prescriptions.
- 18) Take the utmost care during the implement coupling and release phases.
- 19) Comply with the maximum permissible weight on the axle, the total adjustable weight, transport regulations and the highway code.
- 20) Any accessories for transport must be equipped with adequate signals and guards.
- 21) Never ever leave the driving seat whilst the tractor is moving.
- 22) It is very important to remember that the road holding, steering and braking capacity may be even notably influenced by the presence of a towed or mounted implement.
- 23) Always take care of the centrifugal force exercised by the furthered position of the center of gravity, when turning corners with the implement mounted.
- 24) Only begin work with the implement after having checked that all guards are in a good condition, installed and in their safety positions.
- 25) Before engaging the pto, check that the rpm rate is that prescribed. Never exchange the 540 rpm rate for 1000 rpm.
- 26) It is absolutely forbidden to stand within the operative range of the machine where there are moving parts.
- 27) It is absolutely forbidden to use the implement without guards.

28) Before leaving the tractor, lower the implement coupled to the lift unit, stop the engine, engage the hand brake, remove the ignition key from the control panel, cover the cutters and outer skid with the relative guards. Raise the mowing bar (transport protection) in compliance with the instructions given in this handbook.

29) It is absolutely forbidden to stand between the tractor and the implement (Fig. 5) when the engine is running and the cardan shaft is engaged without having first engaged the hand brake and placed a block or stone under the wheels to prevent them from moving.

30) Always set the lift control lever to the locked position before coupling or releasing the implement from the three-point coupling.

31) The category of the implement coupling pins must correspond to that of the lift coupling.

32) Take care when working near the lift links. This is a very dangerous zone.

33) It is absolutely forbidden to stand between the tractor and the implement when manoeuvring the lift control from the outside (Fig. 5).

34) Fix the side lift links with the relative chains and idlers during the

Fig 5

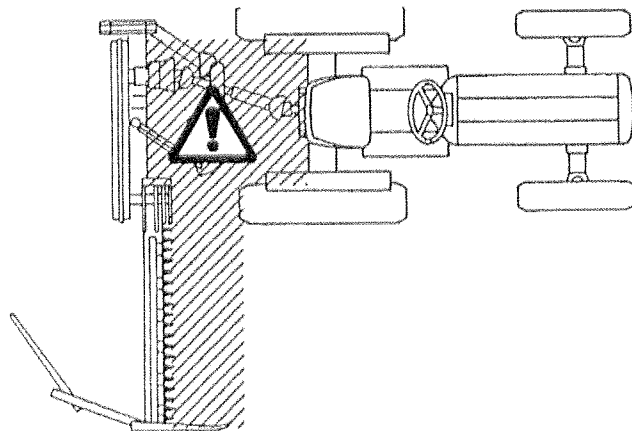

Fig 6

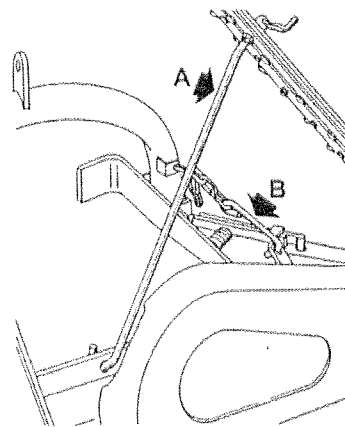
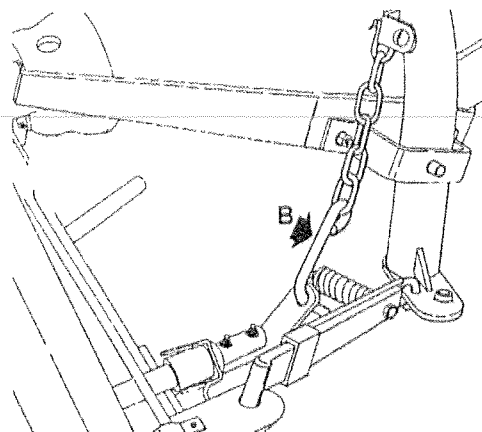

Fig 7





*transporte phase; raise the cutter arm; fix it in place with the rod (A, Fig. 6); insert the safety hook(B, Fig. 6 and 7); cover the cutters and outer skid with the relative guards; raise the mowing bar; set the control lever of the hydraulic lift to the locked position with the implement raised.*

- 35) Only use the cardan shaft recommended by the Manufacturer.*
- 36) Frequently and periodically check the cardan shaft guard. It must always be in an excellent condition.*
- 37) Take great care of the guard, both in the transport and work positions.*
- 38) The cardan shaft must only be installed or dismantled whilst the engine is off.*
- 39) Take great care to ensure that the cardan shaft is correctly assembled and safe.*
- 40) Use the supplied latch to prevent the cardan shaft guard from turning.*
- 41) Before engaging the pto, ensure that there are no persons or animals in the field of action of the machine and that the selected running rate corresponds to the permissible value.  
Never exceed the recommended maximum rate.*
- 42) Never engage the pto when the engine is off or in synchronism with the wheels.*
- 43) Always disengage the pto when the cardan shaft is set at an excessively open angle (never beyond 10 degrees - Fig. 8) and when it is not in use.*
- 44) Only clean and grease the cardan shaft when the pto is disengaged, the engine off, the hand brake engaged and the ignition key removed.*
- 45) Rest the cardan shaft on its stand when not in use.*
- 46) Refit the protective cap on the pto shaft after having dismantled the cardan shaft.*
- 47) Movements beyond the work zone must only occur when the implement*

is set in the transport position.  
 48) Before operating the mowing machine, check that the support struts (A and B, fig.9 and 10) have been removed from underneath the implement. Make sure that the mower has been correctly mounted and adjusted. Check that the machine is in perfect order and that all components subject to wear and deterioration are efficient.

Fig 8

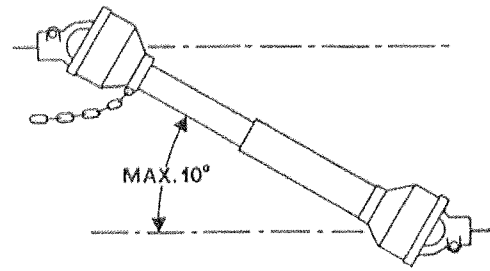
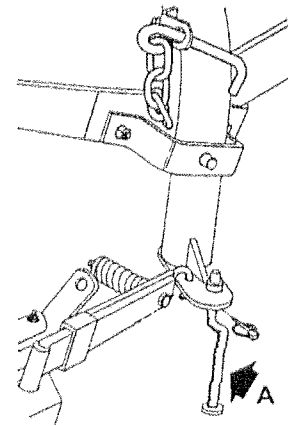

Fig 9



**Safe servicing**

- 49) Never carry out maintenance or cleaning work unless the pto has been disengaged, the engine switched off, the hand brake engaged and the tractor locked in position by a block or stone under the wheels.
- 50) Periodically check that all nuts and bolts are fully tightened. Re-tighten them if necessary.

Fig 10

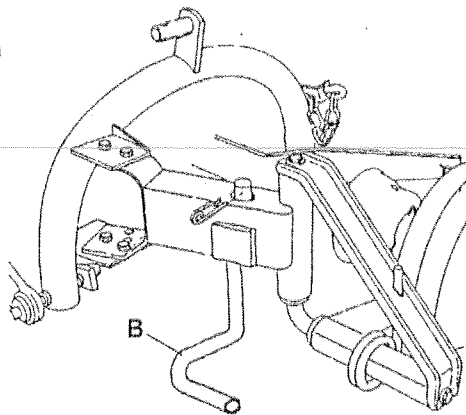
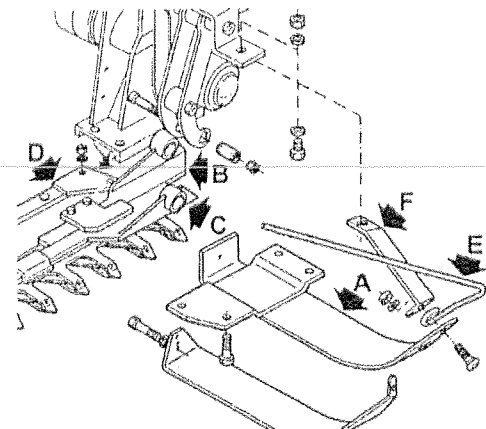

Fig 11



- 51) As a precaution, always set adequate supports under the implement during assembly, servicing, cleaning or assembly work with the mowing bar raised.
- 52) Before approaching the mowing bar, disengage the pto, switch off the tractor, engage the parking brake and check that the cutters are at a complete standstill.
- 53) The spare parts must correspond to the requirements established by the manufacturer. Only use genuine spare parts.

### 3.0 USE INSTRUCTIONS

Strictly comply with the following instructions to achieve the best performances.



#### **ATTENTION:**

It is absolutely essential to disengage the tractor pto, lower the mowing machine, switch off the tractor, ensure that this is at a complete standstill and remove the key before servicing, adjusting or preparing the implement for work. All assembly operations must be carried out on a work bench.

### 3.0.1 ATTACHING THE CUTTING ARM TO THE CHASSIS

- Assemble the cutting arm (D, Fig. 11) and shoe (A) to the hinge.
- Fit the blades (B and C, Fig. 11) in the cutting arm guides, fixing first blade (B) then blade (C) using the screws and expansion bushes (G, Fig. 12).
- Fit the raguard (E, Fig. 11) whitspacer (F) and check that all screws are fully tightened.
- Fit the move guide (H, Fig. 13) to the outhter shoe.

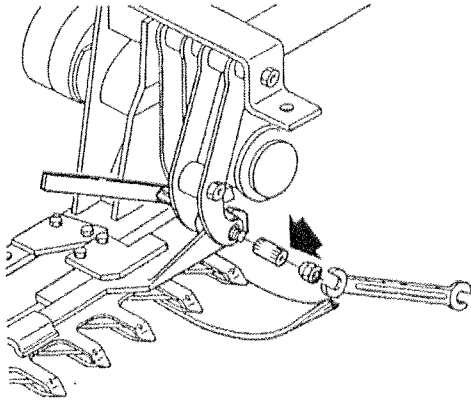

Fig. 12

### 3.0.2 SETTING-UP THE MOWING MACHINE

The mowing machine must be set-up on flat and compact ground, supported by the relative bearing struts (A-B, Fig. 9 and 10).

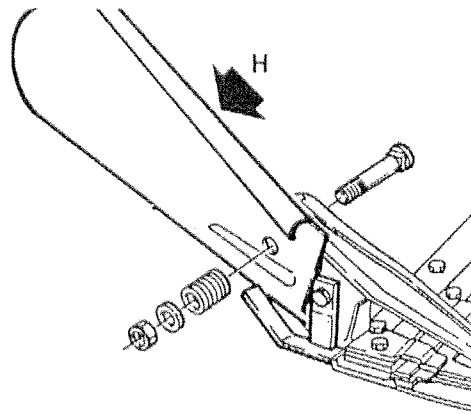

Fig. 13

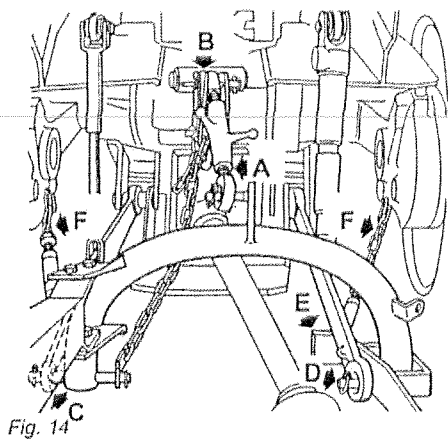

Fig. 14

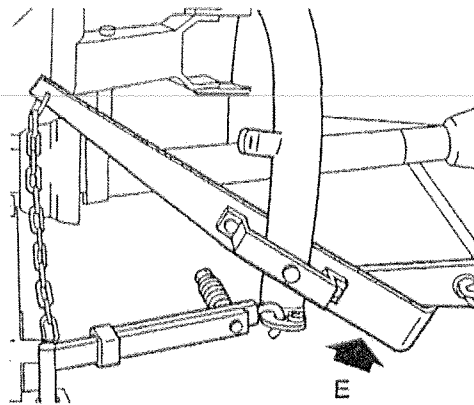

Fig. 15

### 3.0.3 HITCHING TO THE TRACTOR

The mower can be hitched to any tractor equipped with a universal three-point coupling.



#### **DANGER:**

*Application of any implement to a tractor is a very dangerous operation and must only be carried out with the utmost care in compliance with the instructions.*

*The correct tractor/mower position is established by setting the implement at such a distance from the tractor that the universal coupling remains 5-10 cm from its maximum closing position. Now proceed in the following way:*

- 1 - Connect the upper third-point and correctly regulate by means of the adjuster (A, Fig. 14). Place plate (B, Fig. 14) at the left side of the hitch integral with the same pin. Lock in place with the snap-in split pins.*
- 2 - Hook the oscillating arms of the tractor to pins (C and D, Fig. 14).  
The hoisting arm (E, Fig. 15) must be fixed underneath the tractor arm. Lock in place with the snap-in split pins.*
- 3 - Lock the lift links using the relative chains (F, Fig. 14) and couplings parallel to the tractor. This operation must be carried out to prevent the machine from moving in a horizontal direction.*
- 4 - Engage the cardan shaft and check that it is perfectly locked on the pto. Check that the guard is free to turn and fix it with the relative latch.*

### 3.0.4 CARDAN SHAFT ADAPTION

The Cardan shaft, supplied with the machine, is of standard length. Therefore it might be necessary to adapt the Cardan shaft. In that case, before doing anything, consult the Manufacturer for the eventual adaptation.

#### CAUTION

- When the cardan shaft is fully extended, the two tubes must overlap by at least 15 cm (A Fig. 16). When fully inserted, the minimum play must be 4 cm.
- If the implement is used on another tractor, always check the above and that the guards completely cover the rotating parts of the cardan shaft.

#### ATTENTION:

Comply with the manufacturer's instructions when transporting the mowing machine.

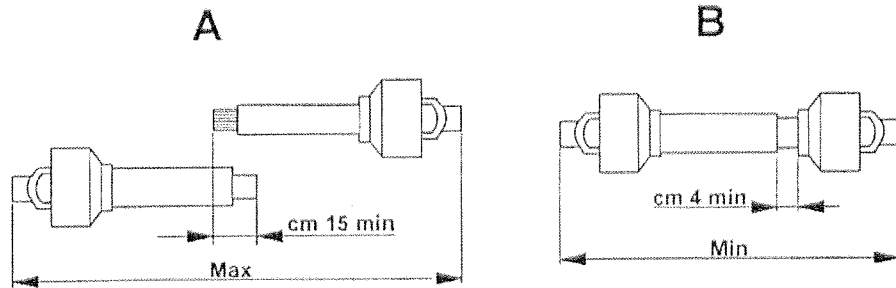

Fig. 16

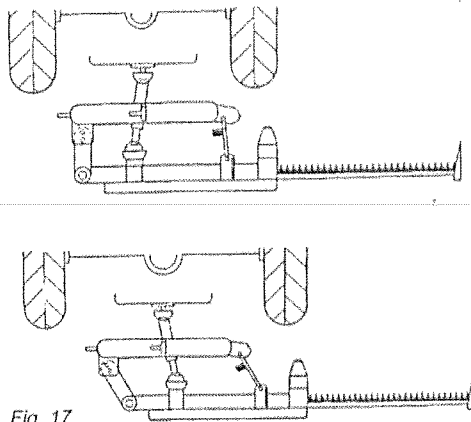

Fig. 17

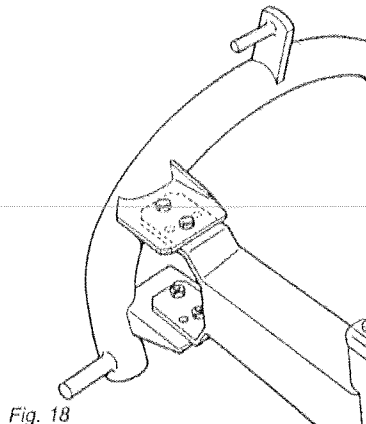

Fig. 18

### 3.0.5 ADAPTING THE MOWING BAR

To ensure optimum use, the mowing bar must completely project from the tractor (Fig. 17); three situations are shown in the figures (18, 19 and 20)

- hitching to a tractor normally used for mowing jobs;
- hitching to a large tractor;
- hitching to a small tractor or to certain types of tracked vehicle.

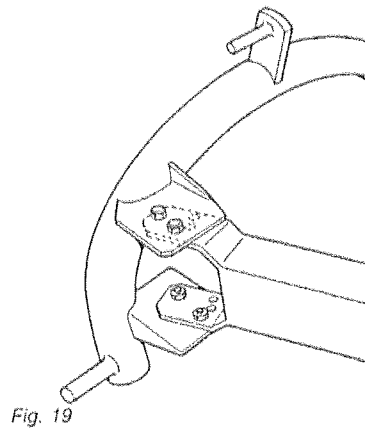

Fig. 19

### 3.0.6 ADJUSTMENT

- Remove safety hook (A, Fig. 21), required only for transportation, and fit it back in the slot positioned above the chassis. Reduce to the minimum length in order to hook it in (B, Fig. 21) with the mower raised.
- Fit the mower by adjusting the tractor tie-rods so that, when the mower attachment is fitted to the three points on the tractor, the external tip of the cutting arm is approximately 5 cm. forward with respect to the arm base (Fig. 22).
- Using chain (A, Fig. 23), adjust the height of the mower attachment with respect to the tractor. Attach the appropriate link to the special plate hole (B, Fig. 23). Mark the link used so that the same



Fig. 20

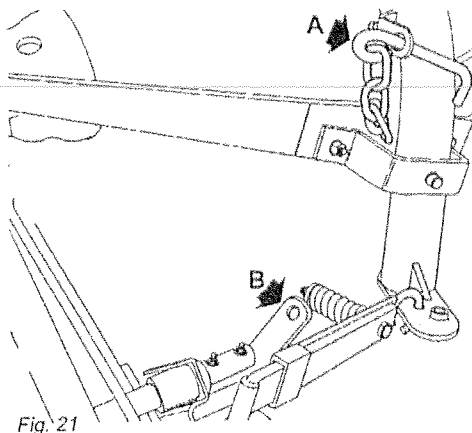

Fig. 21

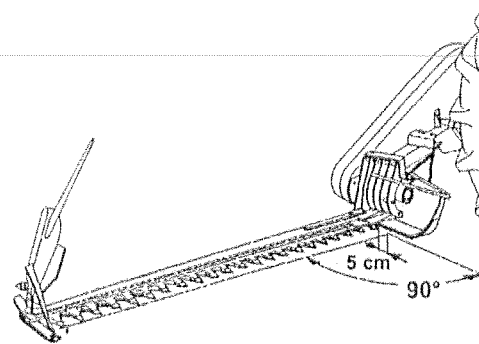

Fig. 22

position may be used each time the mower is fitted to the tractor.

- Adjusting the hoisting chain (A, Fig. 24) so that during mowing the hoisting arm (B, Fig. 24) is free to move up and down; in this way, the cutting arm can follow any unevenness of the ground.
- Adjust the height of the cutting arm from the ground with chain (C, Fig. 24). Lower the mower; when the external tip of the arm touches the ground, the inner shoe must remain approximately 10 cm. above ground level (Fig. 26). Adjust by moving the chain links.
- Adjust inclination of the cutting arm teeth using tie rod (A, Fig. 25).
- The supplementary guide is recommended mostly for forage which tends to obstruct the normal guide. Mount the supplementary mowing guide on the external shoe and tighten with the slide screw (Fig. 27).
- The mower may be used with the cutting arm tilted for working on canal, ditches, embankments, etc. by adjusting hoisting chains (A and C, Fig. 24) after removing the mowing guide of the external shoe.

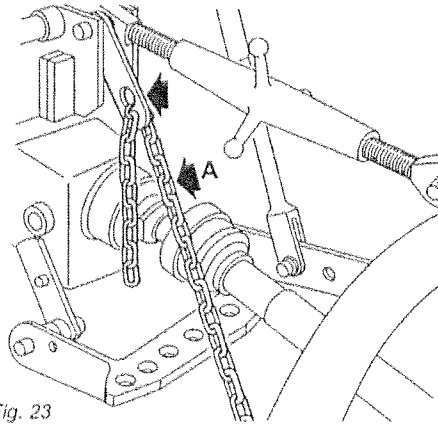

Fig. 23

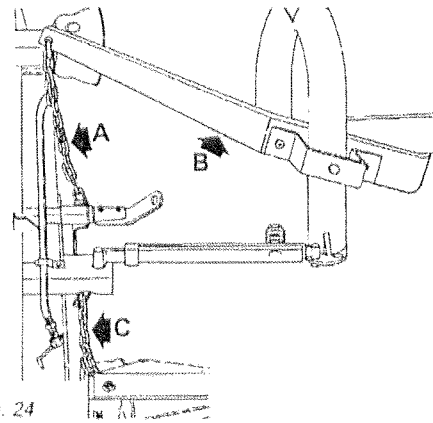

Fig. 24

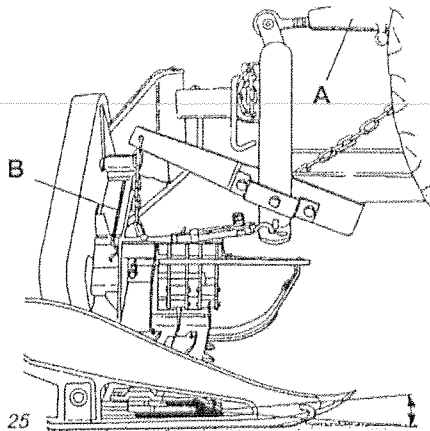

Fig. 25

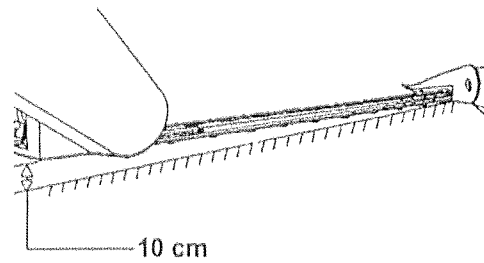

Fig. 26



## MOWING

- Remove support (A and B, Fig. 28 and 29) and remount them, upside-down in their seat.
- Remove tie rod (B, Fig. 25) from the cutting arm and secure it in its seat.
- The mower is fitted with a safety device for protection against obstacles. If this device is tripped by impact with an obstacle, stop the tractor without raising the cutting arm. Check that the universal joint has not become separated, if so, reassemble it. If the tie rod releases easily, adjust spring (A, Fig. 30) using nut (B, Fig. 30) which should be tightened half turn at a time.

### CAUTION:

- Always raise the implement in order to reverse or change direction.
- The cutting arm should not be raised abruptly in order to avoid damaging the cutting blades.
- Do not work with P.T.O. in synchronism with the wheels.
- Power take-off must not exceed 540 r.p.m.

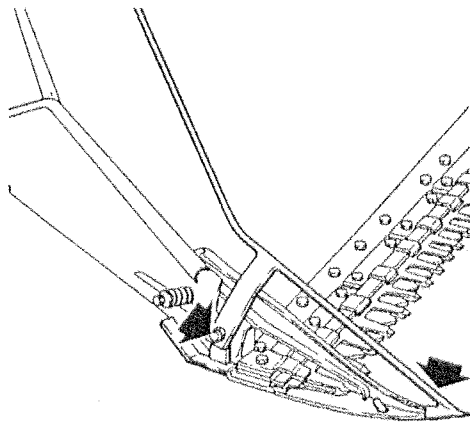

Fig. 27

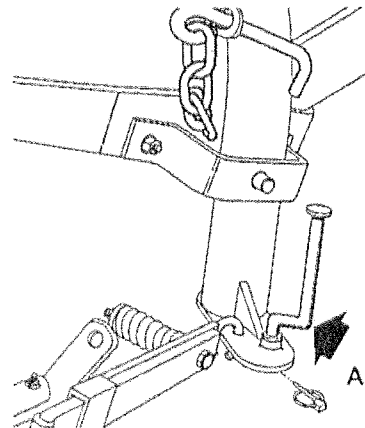

Fig. 28

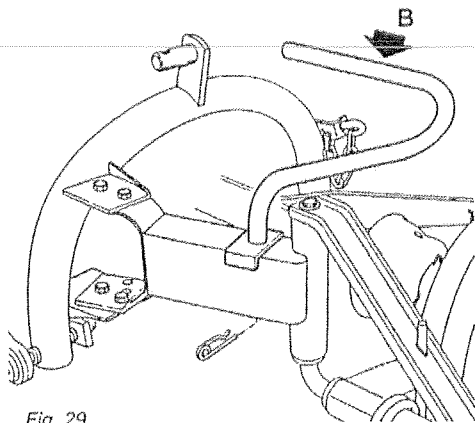

Fig. 29

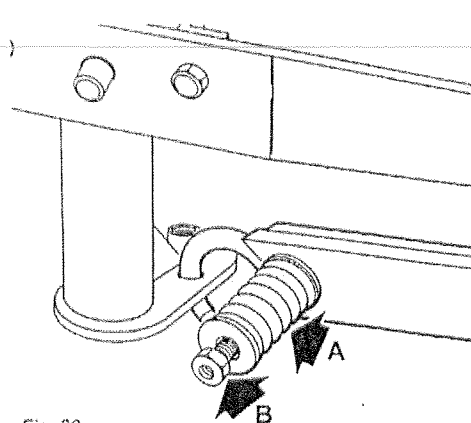

Fig. 30

- *Never run the motor at maximum power while mowing.*
- *In order to prevent breakages or damage, the speed of the tractor must never exceed 10 Km/hour when the implement is working.*



**DANGER:**

*The mowing machine has sharp cutting blades. Always make sure that there are no person, children, domestic animals, electrical cables, pipes and so forth, within the field of action of the implement*

#### **4.0 MAINTENANCE**

*The various servicing operations are listed in the following paragraphs. Lower running costs and longer machine life depend on constant and methodical compliance with these operations.*



**CAUTION:**

- *The given frequencies are indicative and refer to normal conditions of use. They may therefore be subject to variations in relation to the type of service, a more or less dusty environment, seasonal factors, etc.*
- *In the case of heavy-duty conditions, the maintenance operations should obviously be more frequent.*
- *Before injecting grease into the lubricators, the greasing points must be thoroughly cleaned to prevent mud, dust or foreign bodies from mixing with the lubricant, thus reducing or even annulling its lubricating effect.*



### **ATTENTION:**

- Always keep oils and greases well away from children's reach.
- Always thoroughly read the warnings and precautions indicated on the containers.
- Avoid contact with the skin.
- Always thoroughly and fully wash after use.
- The utilized oils should be treated in compliance with the current laws in force.

### **EVERY 2 WORK HOURS**

Grease points (A, Fig. 31).

### **EVERY 8 WORK HOURS**

- Grease the cardan shaft cross journals.
- Adjust belt tension periodically by adjusting nut (A, Fig. 32). Check tension via the viewing panel on the belt guard. Belt slack must not exceed 2 cm. It is essential to close the inspection hatch with the relative lid after the belts have been examined.

### **EVERY 50 WORK HOURS**

Check the tightness of the connecting rod bolts regularly (Fig. 33).

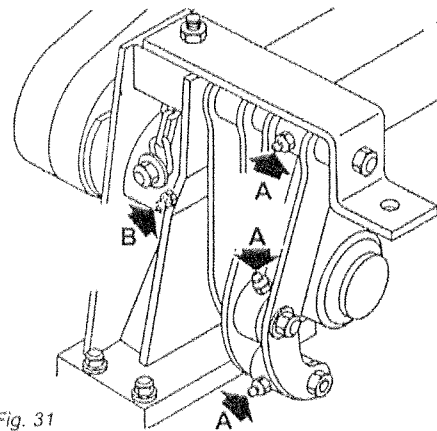

Fig. 31

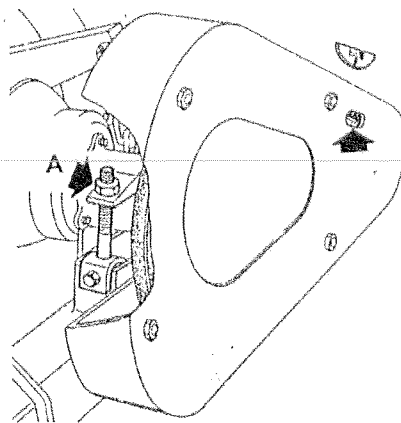

Fig. 32

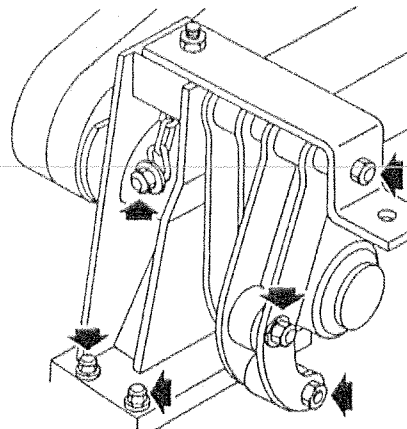

Fig. 33

**PERIODICALLY (6 MONTHS)**  
Grease point (B, Fig. 31).

**AFTER EACH MOWING JOB**

Clean and oil the mowing bar blades according to the instructions in the chapter entitled: "Cleaning and oiling the cutters".

**CLEANING AND OILING THE CUTTERS**

 **DANGER:**

Mowing bar cleaning and oiling are very dangerous operations. Always comply with the following instructions:

- Lift the implement by means of the lift links in a flat place where it cannot slip;
- Operate the mowing bar, checking that there are no persons or animals in the vicinity;
- Brake the tractor and make sure it is unable to move;
- Wash the mowing bar with a jet of pressurized water, standing at least one and a half meters away from the implement;
- Switch off the tractor, remove the starter key and disengage the pto;
- Check the condition of the cutters;
- When the mowing bar is dry, oil the cutters with very viscous oil;
- Operate the mowing bar for a few

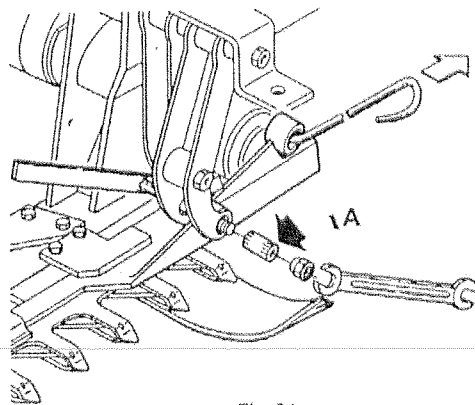

Fig. 34

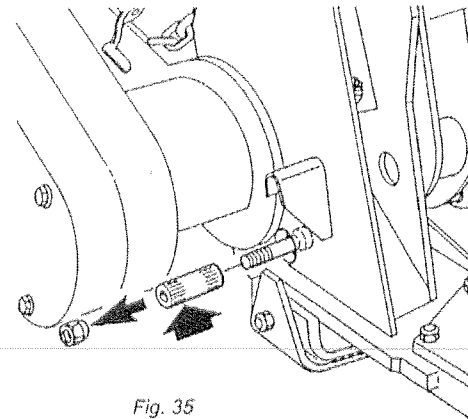

Fig. 35

seconds, checking that there are no persons or animals in the vicinity;

- Switch off the tractor, remove the starter key and disengage the pto;
- Fit the guards over the cutters and outer skid (13 Fig. 4)

*The mower is supplied with:*

- universal joint
- one blade (as a spare part)
- manual
- bushing for thirds points
- special key
- key n. 17-19
- cutter guard

### **CUTTING BLADES**

*In order to extract the cutting blades, release and then remove the screw and bush (A, Fig. 34 and 35), Attach the blade head and extract the blade. Lubricate the cutters with very viscous oil during the assembly phase. Grese.*

*Remember that the Manufacturer is always at your disposal for any assistance or spare parts as may be required.*

### **STORAGE**

*It is advisable to proceed in the following way at the end of the season or if the machine is to remain inactive for a long period of time:*

- Treat the implement in compliance with the instructions given in the chapter entitled: "Cleaning and oiling the cutters".
- Carefully check for any damaged or worn parts and replace these as necessary.
- Fully torque all screws and bolts.
- Apply a little lubricant to the unpainted parts.
- Protect the entire implement with a tarpaulin.
- Lastly, store the implement in a dry place where it cannot be tampered with by unauthorized persons.

*Careful compliance with these instructions will be all to the advantage of the user who will be sure to use an implement in perfect conditions when work begins again.*

## 5.0 SPARE PARTS

Orders must be transmitted through our area dealers and should always include the following indications:

- **Type, model and serial number of the machine.** These data are punched on the data plate with which every implement is equipped (4 Fig. 11).
- **Code number of the required spare part.** This will be found in the spare parts catalogue.
- **Description of the part and required quantity.**
- **Means of dispatch.** If this item is not indicated, the Manufacturer, while dedicating particular care to this service, shall not be held responsible for delays in delivery caused by cases of force majeure.  
Transport expenses shall always be at the consignee's charge. The goods travel at the purchaser's risk and peril even when sold ex destination.

**NOTE:** The terms *Right* or *Left* indicated in the descriptions refer to the implement when viewed from the rear side.

### TABLE INDEX

Frame .....	Tab. 61/11
Feeler unit .....	Tab. 61/20
Hinge .....	Tab. 61/31
Cutting arm .....	Tab. 61/42

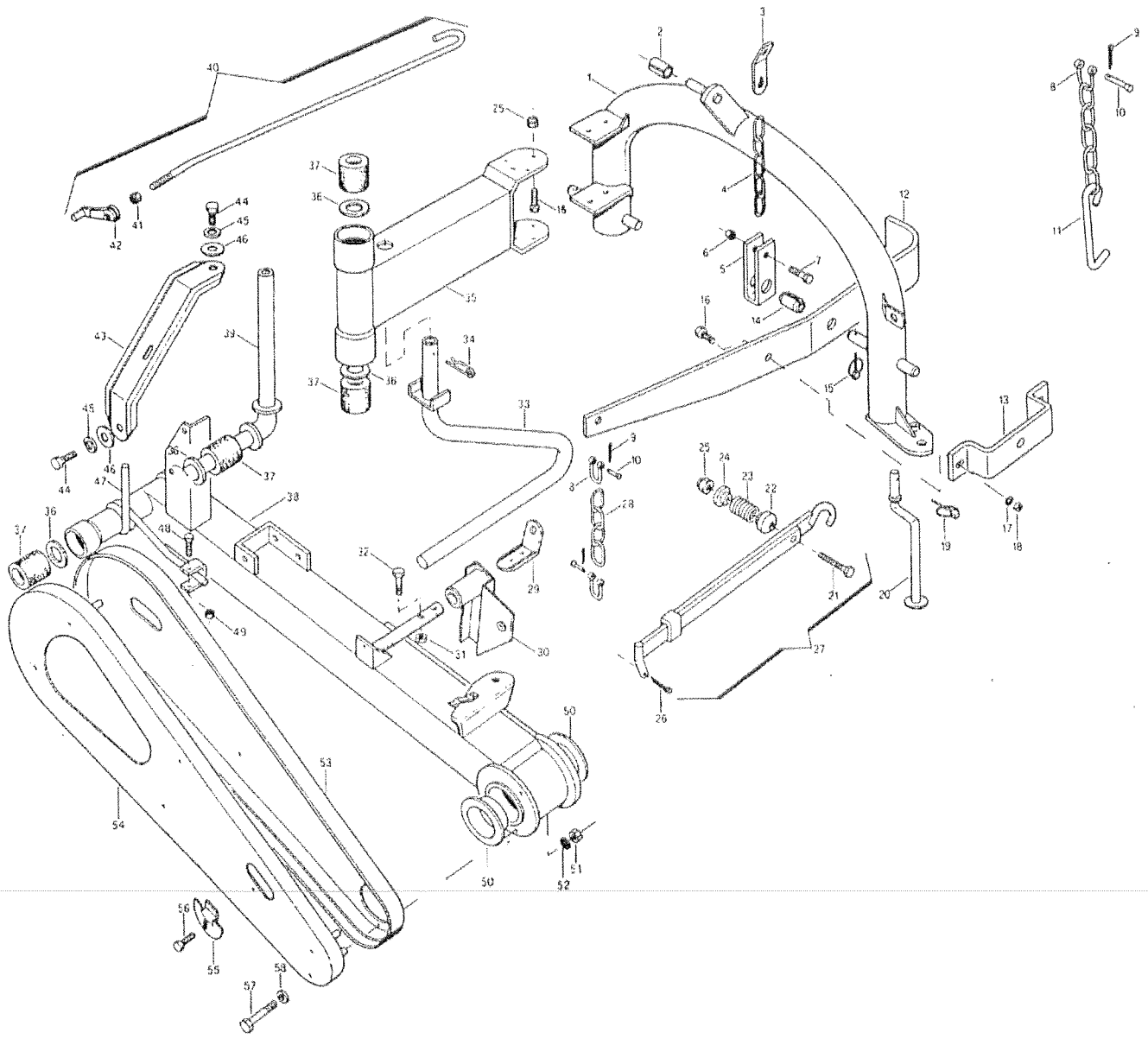

POS.	CODE	DESCRIPTION	POS.	CODE	DESCRIPTION
1	G 21120300	FRAME	55	G 21120217	INSPECTION OPENING COVER-GUARD
2	G 21010043	BUSHING 3RD POINT	56	G 41605015	BOLT 6X16 UNI 5739
3	G 21030007	TRACTOR COUPLING PLATE	57	G 41602034	BOLT 8X100 UNI 5737
4	G 21030035	CHAIN	58	G 44953003	WASHER D8 UNI 6592
5	G 21030034	FRAME COUPLING			
6	G 43549003	NUT TRISTOP M10			
7	G 41605042	BOLT 10X30 UNI 5739			
8	G 64130004	Clevis			
9	G 45961041	SPLIT PIN 3X25 UNI 1336			
10	G 21010010	U BOLT PIN			
11	G 21030005	SAFETY HOOK			
12	G 21120304	LIFTING ARM			
13	G 21120305	ARM COUPLING			
14	G 21010042	BUSHING 1ST - 2ND POINT			
15	G 45965007	SNAP PIN D9			
16	G 41605052	VBOLT 12X40 UNI 5739			
17	G 44957008	WASHER D12 UNI 6798			
18	G 43530008	NUT M12 UNI 5588			
19	G 45965001	SNAP PIN D5			
20	G 21120303	ANTERIOR PROP			
21	G 41602068	BOLT 12X130 UNI 5737			
22	G 21120301	CONE DISCONNECT			
23	G 67004030	SPRING G 38X75 SPECIAL SPRINGS			
24	G 22310047	REAR ARM BUSHING DP			
25	G 43442007	NORMAL SELF-LOCKING NUT M12			
26	G 45961122	SPLIT PIN 10X40 UNI 1336			
27	G 21120302	SNAP TIE ROD			
28	G 21120007	ARM SIDE CHAIN			
29	G 21120308	SAFETY HOOK COUPLING			
30	G 21120006	LIFTER ROCKER			
31	G 43442005	NORMAL SELF-LOCKING NUT M8			
32	G 41602026	BOLT 8X50 UNI 5737			
33	G 21120306	PROP			
34	G 65336018	SPEC. SPRING			
35	G 21120307	FRAME CONNECTION			
36	G 20970067	WASHER 54X5X32			
37	G 21030027	RUBBER BLOCKS			
38	G 21120309	HINGE BEARING ARM			
39	G 21030010	ARM ARTICULATION			
40	G 21120211	CUTTER BAR TIE ROD			
41	G 43539009	Nut M14 UNI 5588			
42	G 21010020	Nut M 14			
43	G 21120212	JOINT ELEMENT			
44	G 41605050	BOLT 12X30 UNI 5739			
45	G 44953005	WASHER D12 UNI 6592			
46	G 20970035	WASHER 32X4X13			
47	G 21120319	HINGE ARM SPRING			
48	G 41602014	BOLT 6X50 UNI 5737			
49	G 43530004	NUT M6 UNI 5588			
50	G 66248064	HINGE ARM BUSHING			
51	G 43530006	NUT M8 UNI 5588			
52	G 44957006	WASHER D8 UNI 6798 D.I.			
53	G 21120215	INNERPROTECTION CASE			
54	G 21120216	OUTERPROTECTION CASE			



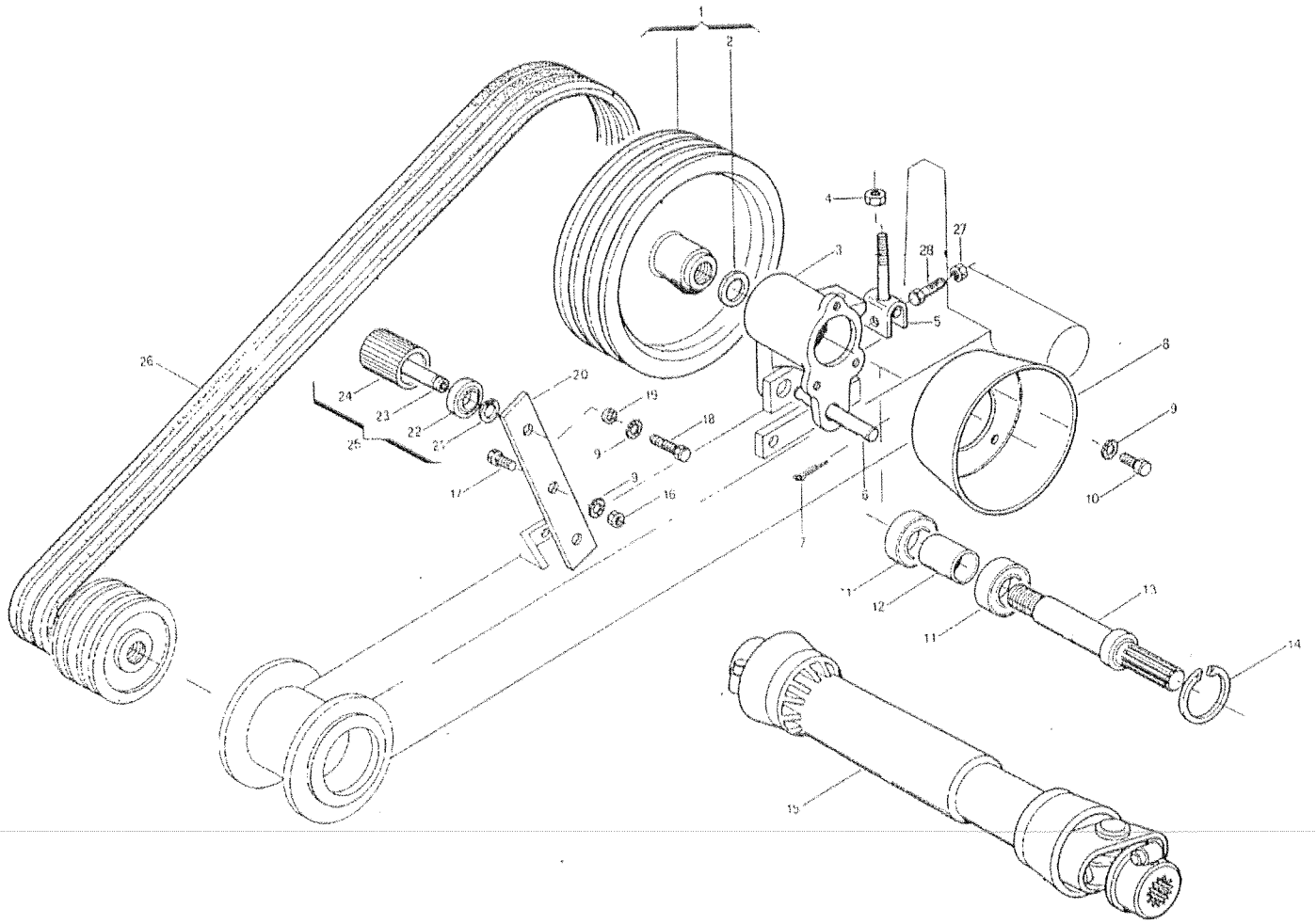

POS.	CODE	DESCRIPTION	POS.	CODE	DESCRIPTION
1	G 21120117	3 GROOVE PULLEY DRIVING			
2	G 20970129	WASHER			
3	G 21030015	PTO SUPPORT			
4	G 43530009	NUT M14 UNI 5588			
5	G 21120318	BELT REGISTER ASSY			
6	G 21120013	INTERM.TRANSM. SUPP. PIN			
7	G 45961083	SPLIT PIN M5X30 UNI 1336			
8	G 21010037	POWER TAKE-OFF PROTECTION HOUS			
9	G 44957006	WASHER D8 DIN 6798 D.I.			
10	G 41605027	BOLT M8X16 UNI 5739			
11	G 51105407	BEARING 6206 2RS			
12	G 21030020	SPACER			
13	G 21120152	POWER TAKE-OFF			
14	G 52122050	STOP RING M72 UNI 7437-75			
15	G 58160018	UNIVERSAL JOINT T40 100 P 112 R12			
15	G 58160019	UNI. JOINT T40 100 P 112 R12 (EXPORT FRANCE)			
16	G 43530006	NUT M8 UNI 5588			
17	G 41605029	BOLT M8X20 UNI 5739			
18	G 41605031	BOLT M8X25 UNI 5739			
19	G 44953003	WASHER D8 UNI 6592			
20	G 21120226	BELT TIGHTENER ROLLERS SUPPORT			
21	G 52121014	STOP RING M17 UNI 7435-75			
22	G 51105404	BEARING 6203 2RS			
23	G 21120119	3 GROOVE P.TIGHTENER PIN			
24	G 66248107	BELT TIGHTENER L.70			
25	G 21120121	TIGHTENER ROLLER 3G CP			
26	G 54233093	BELTS B-93			
27	G 43549004	NUT TRISTOP M12			
28	G 41605052	BOLT M12X40 UNI 5739			

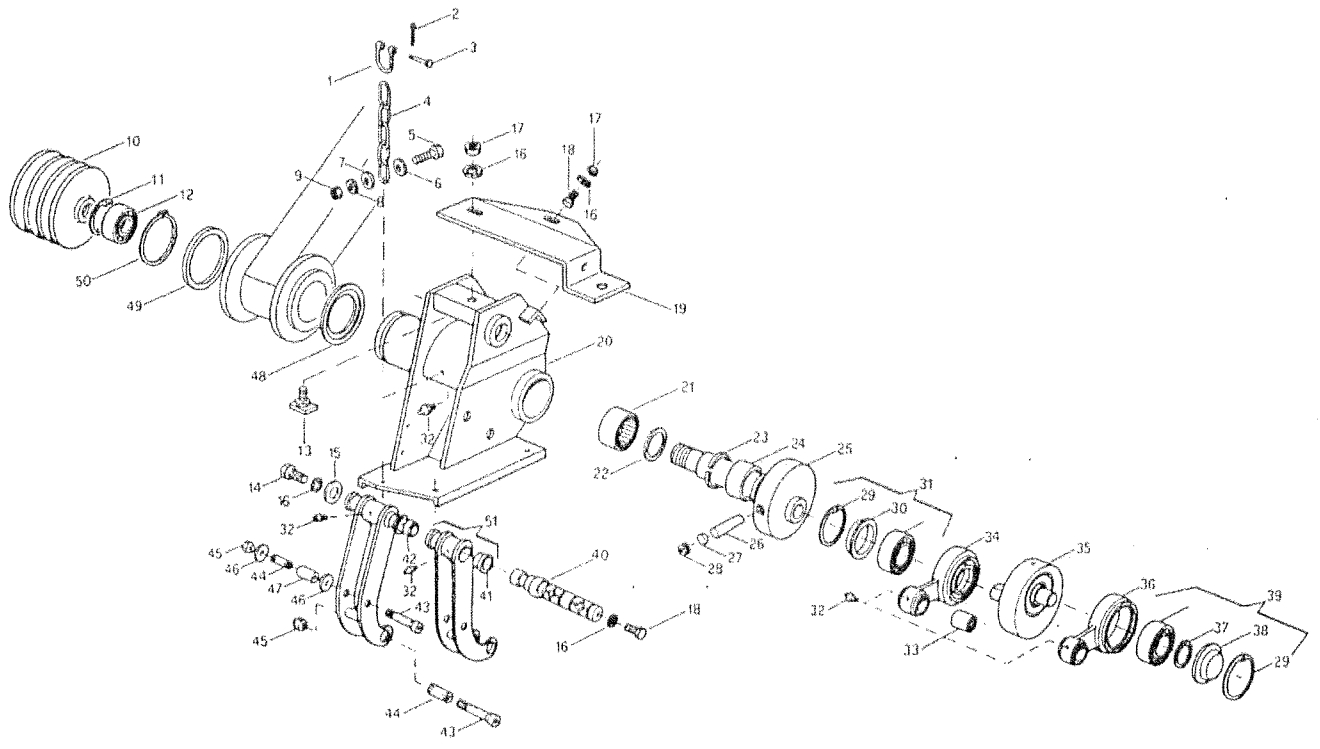

## HINGE

POS.	CODE	DESCRIPTION	POS.	CODE	DESCRIPTION
1	G64130004	CLEVIS			
2	G45961041	SPLIT PIN 3X25 UNI 1336			
3	G21010010	U BOLT PIN			
4	G21120008	HINGE SIDE CHAIN			
5	G4 1605052	BOLT 12X40 UNI 5739			
6	G20970007	WASHER 35X8X13			
7	G20970035	WASHER 32X4X13			
8	G44957008	WASHER D12 UNI 6798			
9	G43530008	NUT M12 UNI 5588			
10	G21120118	3- GROOVE DRIVEN PULLEY			
11	G52122050	STOP RING 62 UNI 7437-75			
12	G51105107	BEARING 6206 Z			
13	G21120218	BOLT M10 W/STOP FB/S			
14	G4 1605042	BOLT 10X30 UNI 5739			
15	G20970099	WASHER 38X4X11			
16	G44957007	WASHER D10 UNI 6798			
17	G43530007	NUT 10 UNI 5588			
18	G41605041	BOLT 10X25 UNI 5739			
19	G21120221	BLADE SHAFT SUPPORT			
20	G21120310	HINGE			
21	G51127002	BEARING DHK 5025			
22	G53225001	SEALING RING DH 50X58X4			
23	G52121061	SHOULDER RING WR 45			
24	G51128002	INTERNAL IR. RING 45X50X35			
25	G21120223	HINGLE SPINDLE			
26	G21120126	CONIC PIN			
27	G21120136	PIN SPACER			
28	G21120127	PIN GRUB-SCREW			
29	G52122059	STOP RING 72 UNI 7437-75			
30	G66248111	DUST COVER HINGE			
31	G21120153	KIT-INT CONN ROD BEARING			
32	G47969001	SPHERE NIPPLE M6X1/A			
33	G51127001	BEARING DHK 2538			
34	G21120128	PIN HINGE CONNECTING ROD			
35	G21170020	HINGE ECCENTRIC			
36	G21170021	OUTER CONNECTING ROD			
37	G52121027	STOP RING 30 UNI 7435-75			
38	G21120028	PROTECTION PLUG			
39	G21120154	KIT-EXT. CONN. ROD BEARING			
40	G21120224	HINGE BLADE SHAFT ASSY			
41	G21120067	BRONZE BUSHING			
42	G21120225	BLADES SPACER			
43	G21120071	PIN FASTENING BOLT			
44	G21120069	EXPANSION PIN			
45	G21120068	CONICAL NUT			
46	G20970519	BOTTOMED WASHER 39X20-25X5X1			
47	G21120137	INTERNAL RING			
48	G21120018	ANTERIOR WASHER			
49	G20970023	WASHER 102X2X75-2			
50	G52121060	STOP RING 75 UNI 7435-75			
51	G21120070	BLADE W/BUSHINGS			

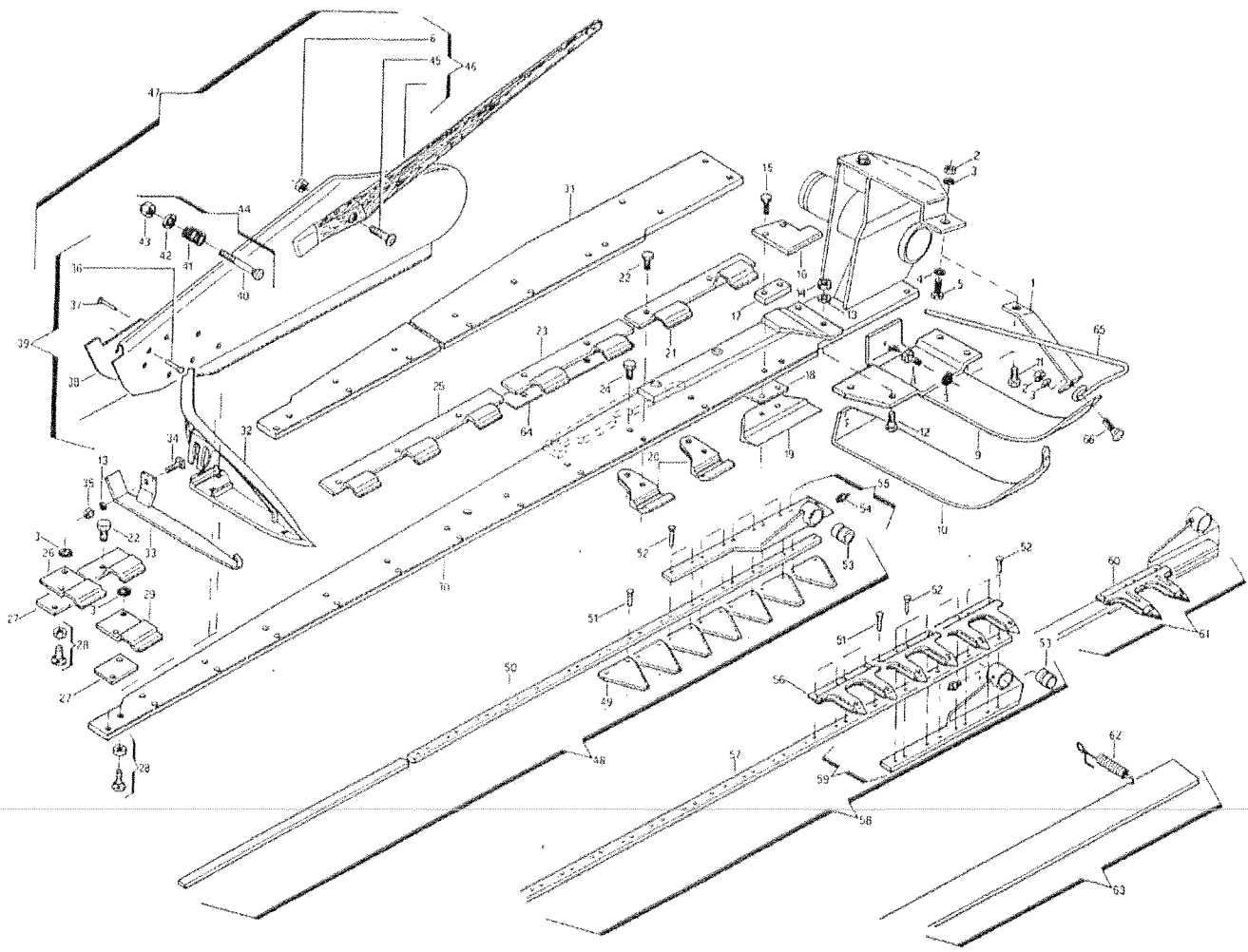

# SICKLE BAR MOWER

POS.	CODE	DESCRIPTION	POS.	CODE	DESCRIPTION
1	G 21120321	INNER SLIDE SPACER FB940	48	G 21120240	CUTTING BLADE MT 1,75
2	G 43530007	NUT 10UNI 5588 6.8 GALVANIZED	48	G 21120241	CUTTING BLADE MT 2.05
3	G 44957007	WASHER D10 DIN 6798 D.INT.ZN	48	G 21120242	CUTTING BLADE MT 2,35
4	G 44953004	WASHER D10 UNI 6592 GALVANIZED	49	G 21120243	CUT SECTION
5	G 41605041	BOLT 10X25 5739 8.G GALVANIZED	50	G 21120244	ROD SECTION MT 1,30
6	G 43442005	NORMAL SELF-LOCKING NUT 8 GALVANIZED	50	G 21120245	ROD SECTION MT 1,45
7	G 41182002	BOLT 8X25 5732 4.6 GALVANIZED	50	G 21120246	ROD SECTION MT 1,75
8	G 41605039	BOLT 10X20 5739 8.G GALVANIZED	50	G 21120247	ROD SECTION MT 2,05
9	G 21120323	INTERNAL RUNNER FB 940	50	G 21120248	ROD SECTION MT 2,35
10	G 21120324	RUNNER WIDE INT.SLIDE FB940	51	G 48974018	RIVET TS 6x13
11	G 41602055	BOLT 12X45 5737 8.G GALVANIZED	52	G 48974019	RIVET TS 6x19
12	G 41602056	BOLT 12X50 5737 8.G GALVANIZED	53	G 21120048	BUSHING-BLADE HEAD 28X20X24
13	G 44957008	WASHER D12 DIN 6798 D.INT.ZIN	54	G 47969001	SPHERE NIPPLE M6X1/4
14	G 43530008	NUT 12 UNI 5588 6.8 GALVANIZED	55	G 21120267	BLADEHEAD SECTION
15	G 41601039	BOLT M10x45 UNI 5737	56	G 21120268	NORMAL DOUBLE TOOTH
16	G 21120312	UPPER INNER BLADE GUIDE FB940	57	G 21120249	BLADE ROD MT. 1,30
17	G 21120231	SHIMS MM 10 FB/S	57	G 21120250	BLADE ROD MT 1,45
18	G 21120044	SHIMS MM 1	57	G 21120251	BLADE ROD MT 1,75
19	G 21120045	INNER LOWER BLADE GUIDE	57	G 21120252	BLADE ROD MT 2,05
20	G 21120042	LOWER BLADE GUIDE	57	G 21120253	BLADE ROD MT 2,35
21	G 21120232	UPPER HIGH BLADE FUIDE FB/S	58	G 21120554	TOOTH BLADE MT. 1,30 COMPL
22	G 41604042	BOLT M10x30 UNI 5739 8.G.	58	G 21120555	TOOTH BLADE MT. 1,45 COMPL.
23	G 21120041	UPPER DOUBLE BLADE GUIDE	58	G 21120556	TOOTH BLADE MT. 1,75 COMPL.
24	G 41604041	BOLT M10x25 UNI 5739 8G	58	G 21120557	TOOTH BLADE MT. 2,05 COMPL.
25	G 21170065	TRIPLE UPPER BLADE GUIDE	58	G 21120558	TOOTH BLADE MT. 2,35 COMPL.
26	G 21120113	CUTTING BAR EXT.UPPER GUIDE M	59	G 21120259	BLADEHEAD TEETH
27	G 21120040	SHIMS MM.1 UPPER EXT.GUIDE	60	G 21120260	SPECIAL DOUBLE TEETH
28	G 42180004	BOLT M 10x40 UNI 6104 4.6	61	G 21120261	SPEC.TOOTH BLADE MT.1,30 COMPL.
29	G 21120039	UPPER OUT.BLADE GUIDE	61	G 21120262	SPEC.TOOTH BLADE MT. 1,45 COMPL.
30	G 21120315	REINFORCED BAR MT. 1.75 FB940	61	G 21120263	SPEC.TOOTH BLADE MT. 1,75 COMPL.
30	G 21120316	REINFORCED BAR MT .2.05 FB940	61	G 21120264	SPEC.TOOTH BLADE MT. 2,05 COMPL.
30	G 21120317	REINFORCED BAR MT. 2.35 FB940	61	G 21120265	SPEC.TOOTH BLADE MT. 2,35 COMPL.
31	G 21120313	BAR MT 1,30	62	G 65337002	TRACTION SPRING GUARD
31	G 21120314	BAR MT 1,45	63	G 21120109	COMPL.PROTECTION MT. 1,30
32	G 21120037	EXTERNAL RUNNER	63	G 21120110	COMPL.PROTECTION MT. 1,45
33	G 21120038	EXT.RUNNER SLIDE	63	G 21120111	COMPL.PROTECTION MT. 1,75
34	G 20800055	BOLT M11	63	G 21120112	COMPL.PROTECTION MT. 2,05
35	G 43529015	MUT M11 UNI 5588 6.8	63	G 21120266	COMPL.PROTECTION MT. 2,35
36	G 48974007	RIVET TPS 5,4x14	64	G 21120320	SHIMS-UPPERBLADE GUIDE
37	G 48971025	RIVET TTL 5,4x16	65	G 21120322	HINGE PROTECTION
38	G 20800060	REINFORCED SWATHBOARD	66	G 41182008	BOLT 10x45 5732 4.8 GALVANIZED
39	G 20800059	SWATHBOARD			
40	G 41182013	BOLT M12x80 UNI 5732			
41	G 65338001	ZN SWATHBOARD COMP.SPRING F.			
42	G 44953005	WASHER D. 12 UNI 6592			
43	G 43442007	NORMAL SELF-LOCKING NUT 12 GAL			
44	G 21120133	SWATHBOARD BOLT ASSY FB.			
45	G 41182014	BOLT M8x40 5732 4.6 GALVANIZED			
45	G 41182014	BOLT M8x40 5732 4.6 GALVANIZED			
46	G 20800061	SWATHBOARD ROD ASSY			
47	G 21120134	SWATHBOARD - ASSY FB			
48	G 21120238	CUTTING BLADE MT.1,30			
48	G 21120239	CUTTING BLADE MT.1,45			