



KUSAM
OUTDOOR SOLUTIONS





Tavola 1



SPECIFICATIONS

Width	38"
Length	56"
Height	16"
Surface	11"
Burner Size	24" / 65,000 BTU
Weight	360 lbs.
Fuel Source	LP or NG
Ignition	Key Valve
Materials	Glass fiber reinforced cement



Tavola 2



SPECIFICATIONS

Width	36"
Length	36"
Height	16"
Surface	8 1/4"
Burner Size	15" / 65,000 BTU
Weight	240 lbs.
Fuel Source	LP or NG
Ignition	Key Valve
Materials	Glass fiber reinforced cement

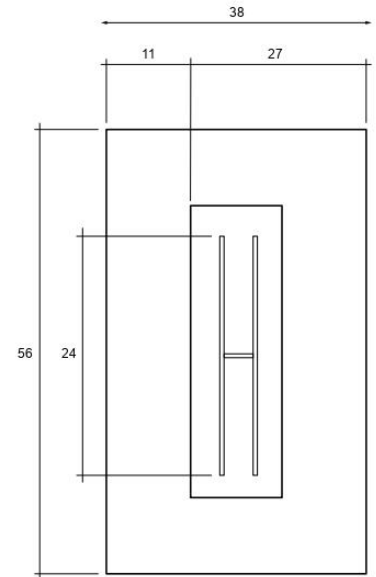
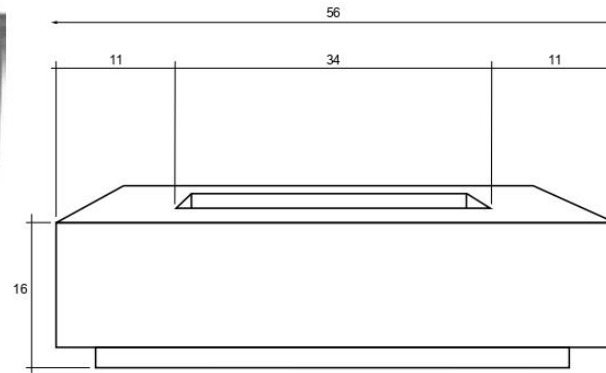

Tavola 3



SPECIFICATIONS

Width	48"
Length	48"
Height	16"
Surface	12"
Burner Size	18" / 65,000 BTU
Weight	450 lbs.
Fuel Source	LP or NG
Ignition	Key Valve
Materials	Glass fiber reinforced cement

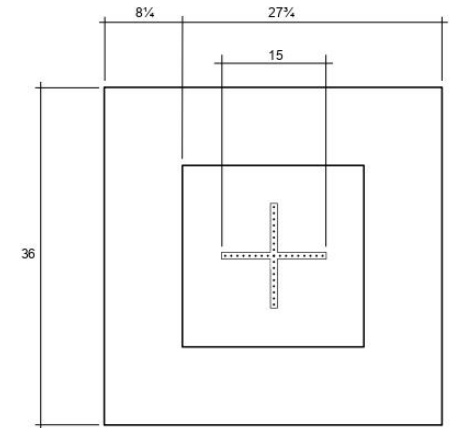
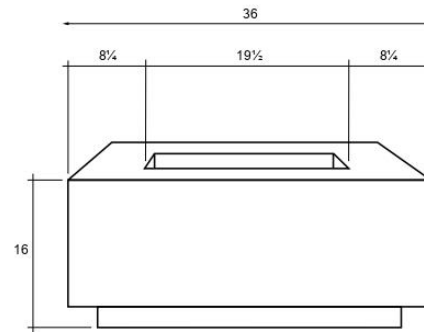

Tavola 4



SPECIFICATIONS

Width	38"
Length	66"
Height	16"
Surface	16" / 11"
Burner Size	24" / 65,000 BTU
Weight	500 lbs.
Fuel Source	LP or NG
Ignition	Key Valve
Materials	Glass fiber reinforced cement

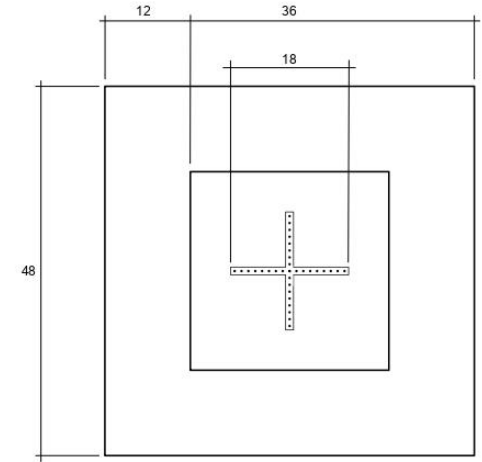
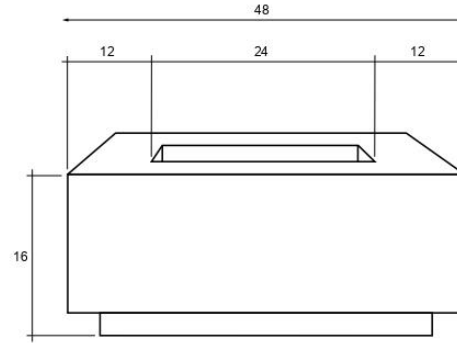

Tavola 5



SPECIFICATIONS

Width	38"
Length	80"
Height	16"
Surface	11" / 33¼"
Burner Size	24" / 65,000 BTU
Weight	650 lbs.
Fuel Source	LP or NG
Ignition	Key Valve
Materials	Glass fiber reinforced cement

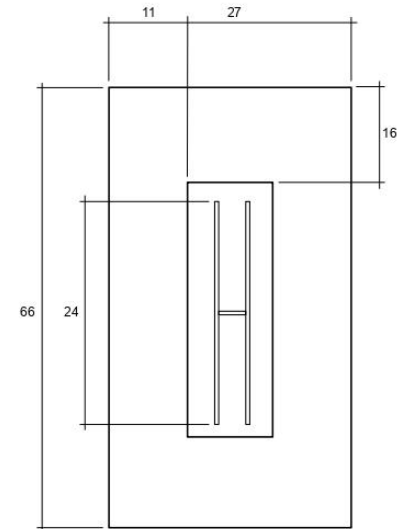
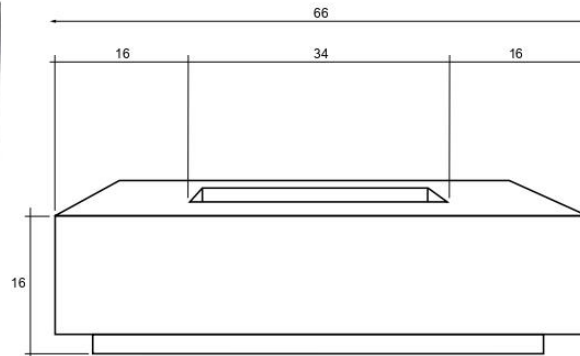

Tavola 6



SPECIFICATIONS

Width	38"
Length	90"
Height	16"
Surface	11"
Burner Size	60" / 90,000 BTU
Weight	650 lbs.
Fuel Source	LP or NG
Ignition	Key Valve
Materials	Glass fiber reinforced cement

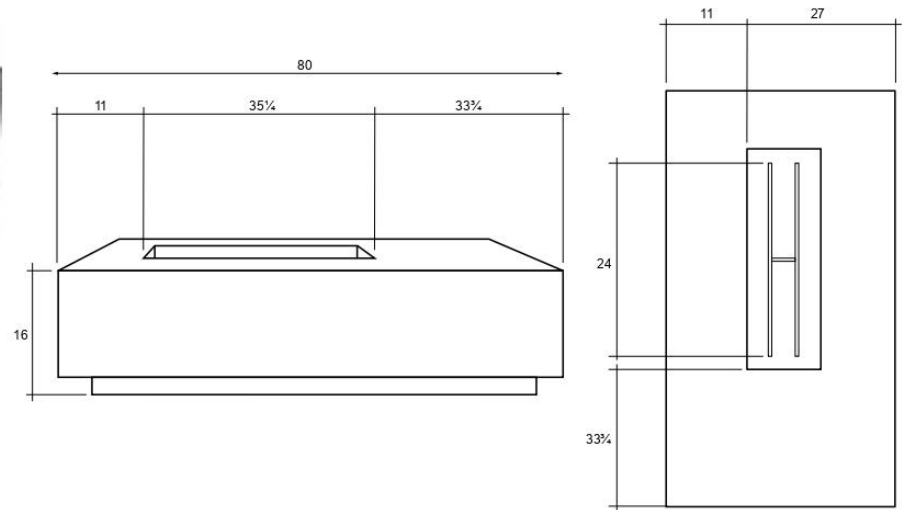

Tavola 7



SPECIFICATIONS

Width	50"
Length	60"
Height	16"
Surface	16"
Burner Size	24" / 65,000 BTU
Weight	500 lbs.
Fuel Source	LP or NG
Ignition	Key Valve
Materials	Glass fiber reinforced cement

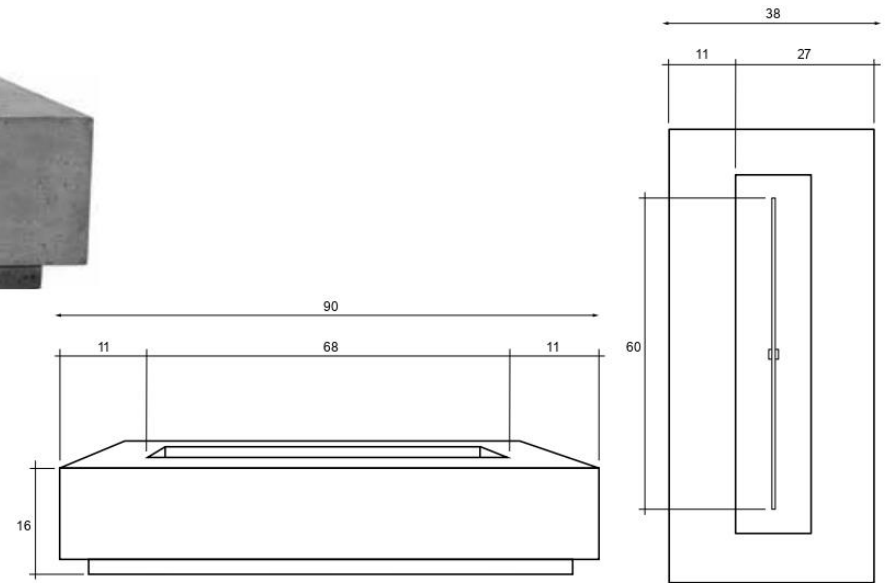

Tavola 42



SPECIFICATIONS

Width	42"
Length	42"
Height	16"
Surface	8 1/2"
Burner Size	15" / 65,000 BTU
Weight	360 lbs.
Fuel Source	LP or NG
Ignition	Key Valve
Materials	Glass fiber reinforced cement

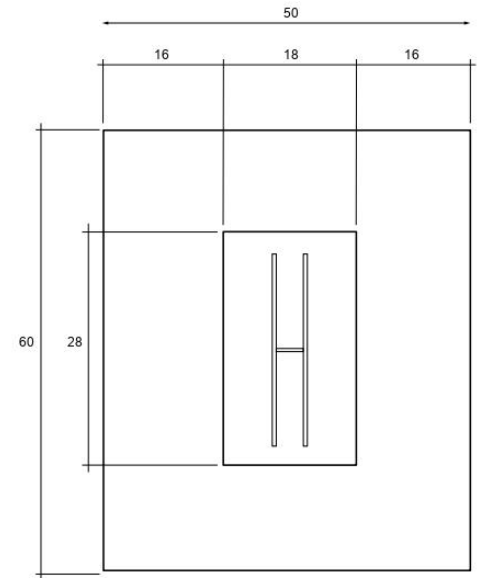
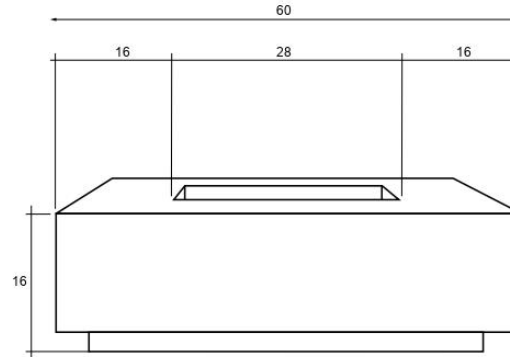
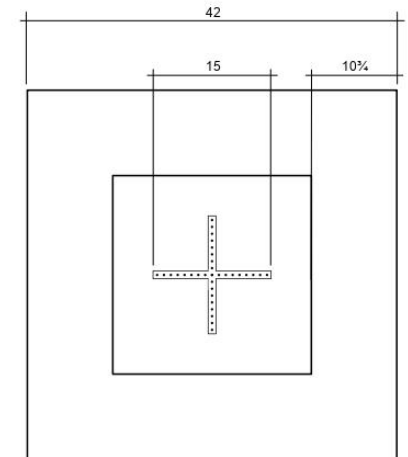
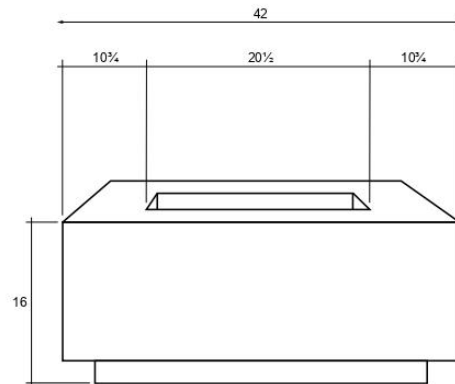





Portos 68 (Enclosed Propane Unit)



SPECIFICATIONS	
Width	38"
Length	68"
Height	22"
Surface	17" / 11"
Burner Size	24" / 65,000 BTU
Weight	550 lbs.
Fuel Source	Enclosed Propane Unit
Ignition	Key Valve
Materials	Glass fiber reinforced cement

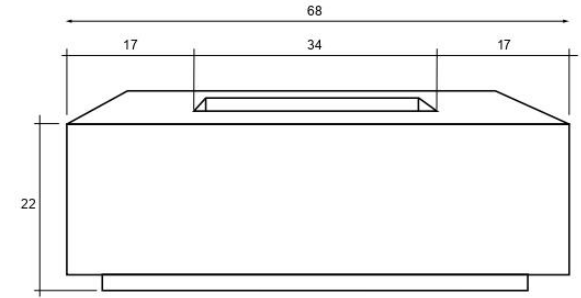

Portos 58 (Enclosed Propane Unit)

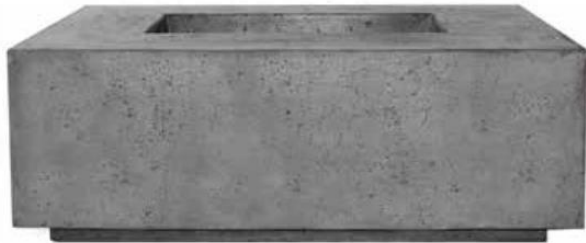

SPECIFICATIONS	
Width	38"
Length	58"
Height	22"
Surface	12" / 11"
Burner Size	24" / 65,000 BTU
Weight	450 lbs.
Fuel Source	Enclosed Propane Unit
Ignition	Key Valve
Materials	Glass fiber reinforced cement

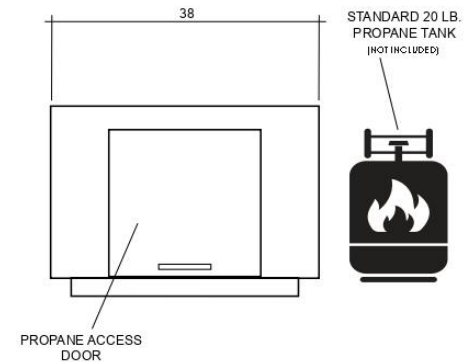
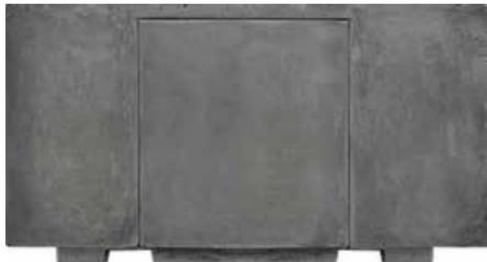
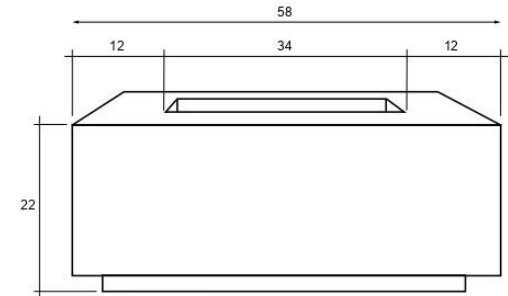



Moderno 1



SPECIFICATIONS

Diameter	39"
Bottom Diameter	16"
Height	18"
Burner Size	15" / 65,000 BTU
Weight	210 lbs.
Fuel Source	LP or NG
Ignition	Key Valve
Materials	Glass fiber reinforced cement

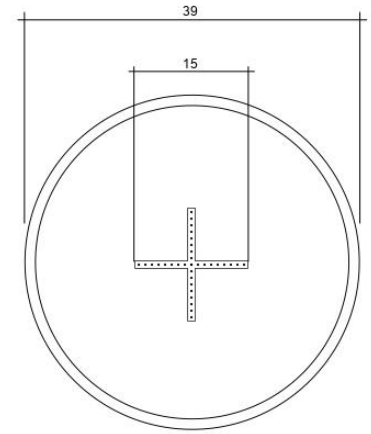
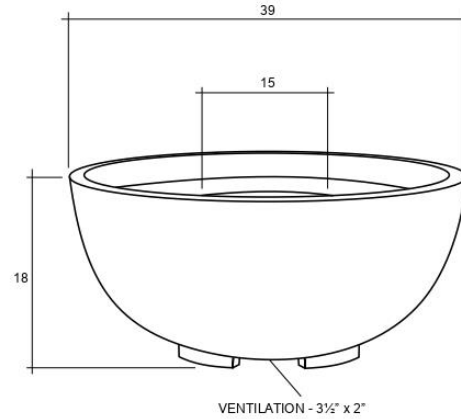

Moderno 2



SPECIFICATIONS

Diameter	29"
Bottom Diameter	14"
Height	12"
Burner Size	15" / 65,000 BTU
Weight	90 lbs.
Fuel Source	LP or NG
Ignition	Key Valve
Materials	Glass fiber reinforced cement

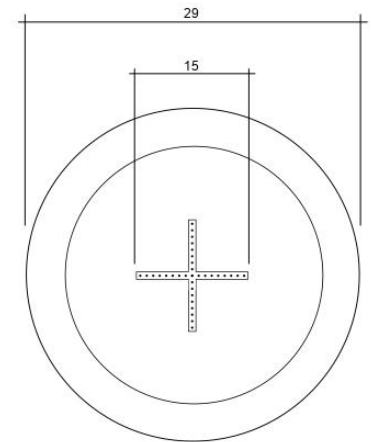
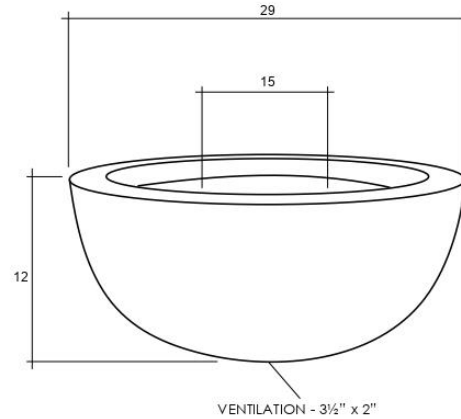





Moderno 3



SPECIFICATIONS

Diameter	30"
Bottom Diameter	14"
Height	18"
Burner Size	15" Diameter / 65,000 BTU
Weight	125 lbs.
Fuel Source	LP or NG
Ignition	Key Valve
Materials	Glass fiber reinforced cement

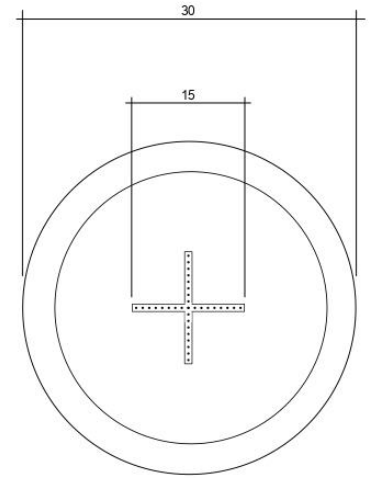
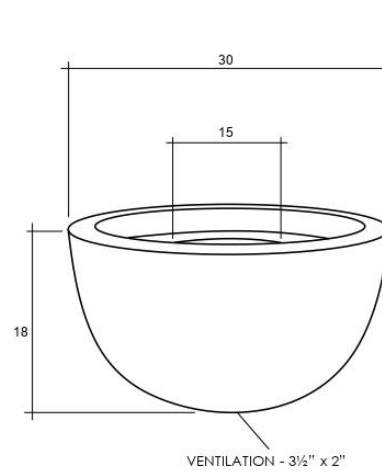

Moderno 4



SPECIFICATIONS

Diameter	48"
Bottom Diameter	24"
Height	17"
Burner Size	18" / 65,000 BTU
Weight	400 lbs.
Fuel Source	LP or NG
Ignition	Key Valve
Materials	Glass fiber reinforced cement

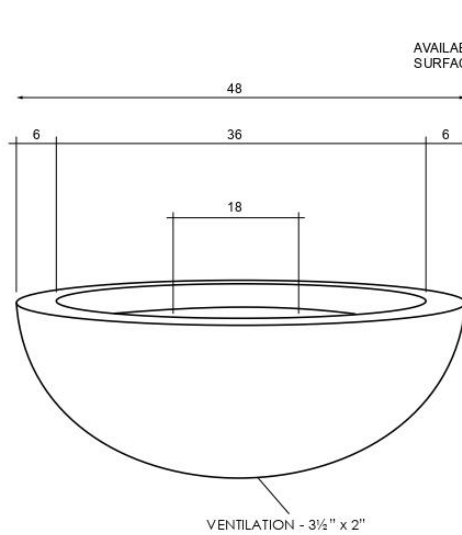

AVAILABLE WITH 4" SURFACE AREA

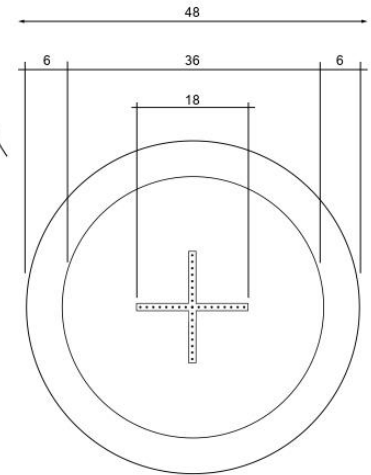

DIAMETER | 48"

Moderno 5



SPECIFICATIONS

Diameter	36"
Height	16"
Burner Size	15" / 65,000 BTU
Weight	250 lbs.
Fuel Source	LP or NG
Ignition	Key Valve
Materials	Glass fiber reinforced cement

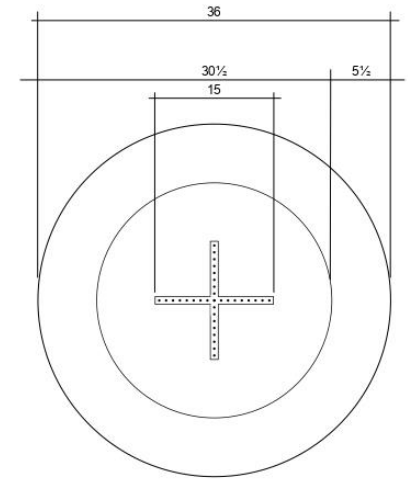
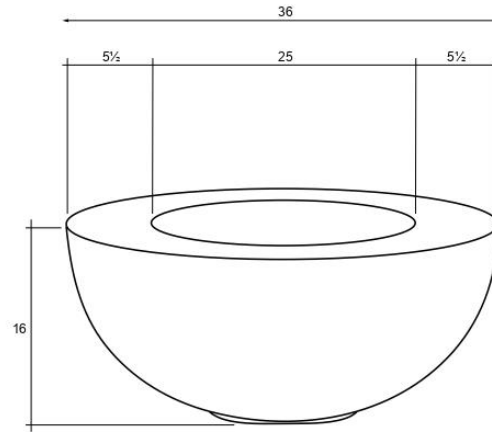

Moderno 6



SPECIFICATIONS

Diameter	39"
Height	15"
Burner Size	15" / 65,000 BTU
Weight	95 lbs.
Fuel Source	LP or NG
Ignition	Key Valve
Materials	Glass fiber reinforced cement

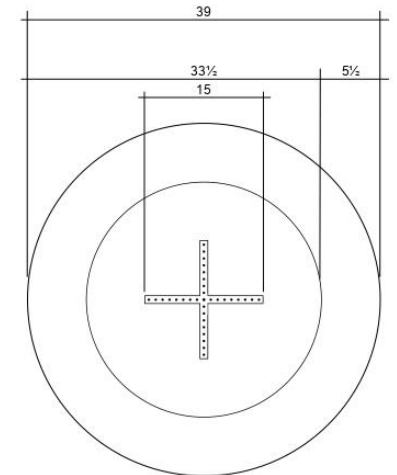
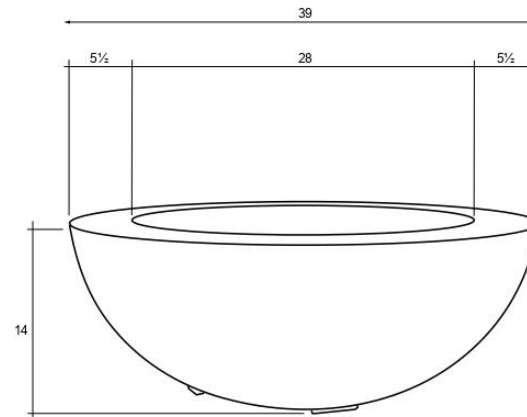



Pentola 1



SPECIFICATIONS

Diameter	24"
Height	28"
Burner Size	15" Diameter / 65,000 BTU
Weight	135 lbs.
Fuel Source	LP or NG
Ignition	Key Valve
Materials	Glass fiber reinforced cement

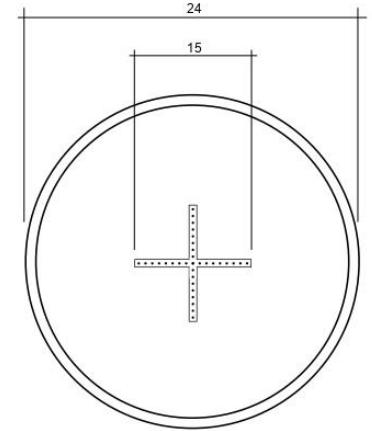
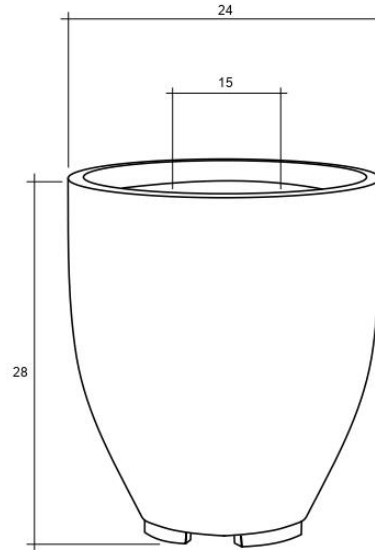

Pentola 2



SPECIFICATIONS

Diameter	24"
Height	21"
Burner Size	15" Diameter / 65,000 BTU
Weight	125 lbs.
Fuel Source	LP or NG
Ignition	Key Valve
Materials	Glass fiber reinforced cement

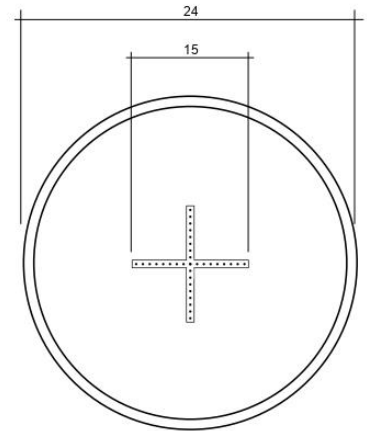
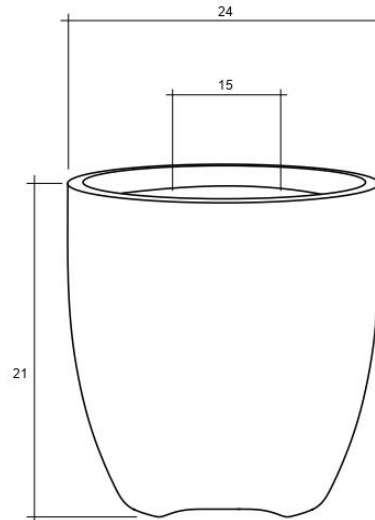

Pentola 3 (Enclosed Propane Unit)



SPECIFICATIONS

Diameter	24"
Height	26"
Burner Size	15" / 65,000 BTU
Weight	135 lbs.
Fuel Source	Enclosed Propane
Ignition	Key Valve
Materials	Glass fiber reinforced cement

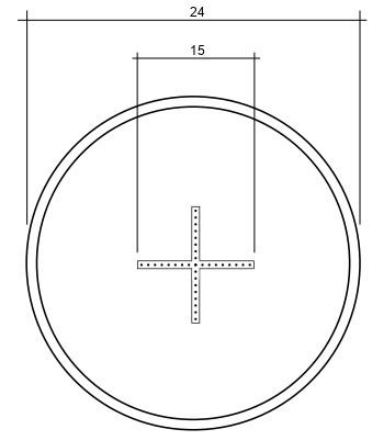
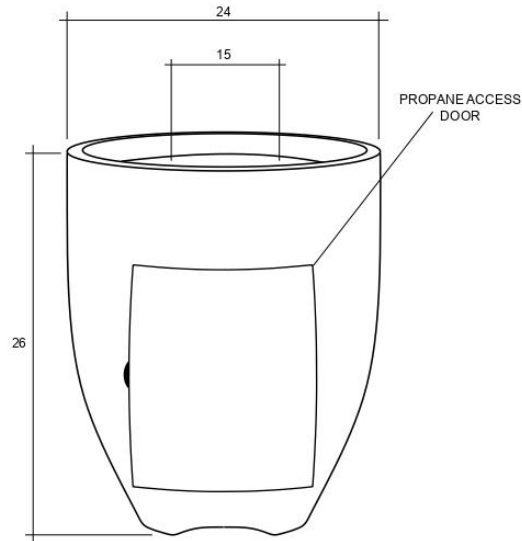

Scatola



SPECIFICATIONS

Width	20"
Height	18"
Pan Size	14" / 65,000 BTU
Weight	130 lbs.
Fuel Source	LP or NG
Ignition	Key Valve
Materials	Glass fiber reinforced cement

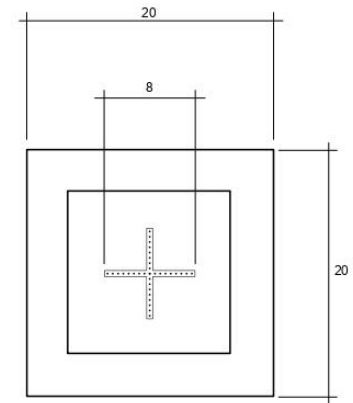
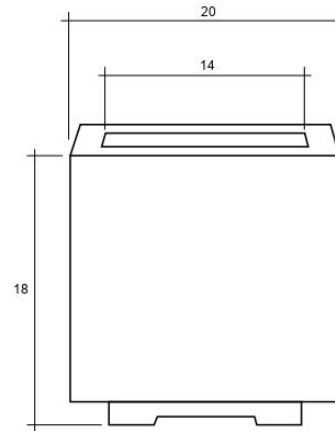



Pebble

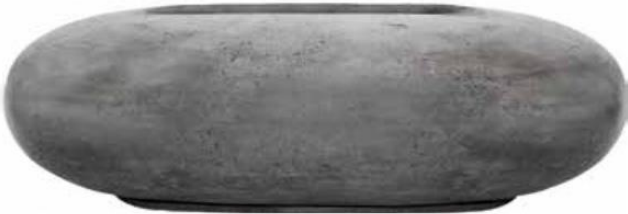

SPECIFICATIONS

Width	38"
Length	56"
Height	16"
Burner Size	24" / 65,000 BTU
Weight	350 lbs.
Fuel Source	LP or NG
Ignition	Key Valve
Materials	Glass fiber reinforced cement

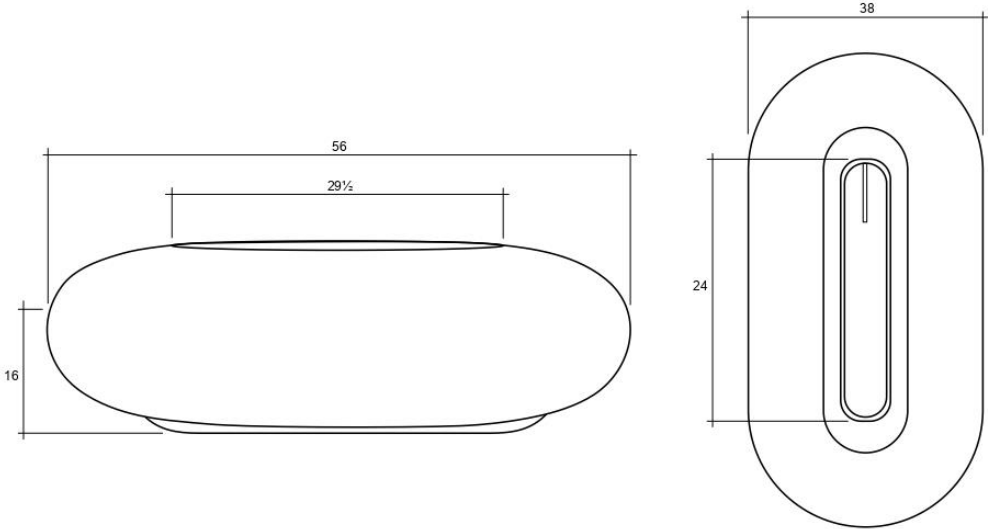

Rotondo

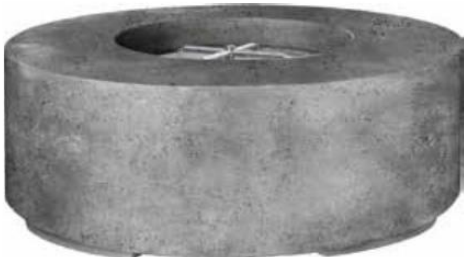

SPECIFICATIONS

Diameter	48"
Height	18"
Surface	11"
Burner Size	18" / 65,000 BTU
Weight	430 lbs.
Fuel Source	LP or NG
Ignition	Key Valve
Materials	Glass fiber reinforced cement

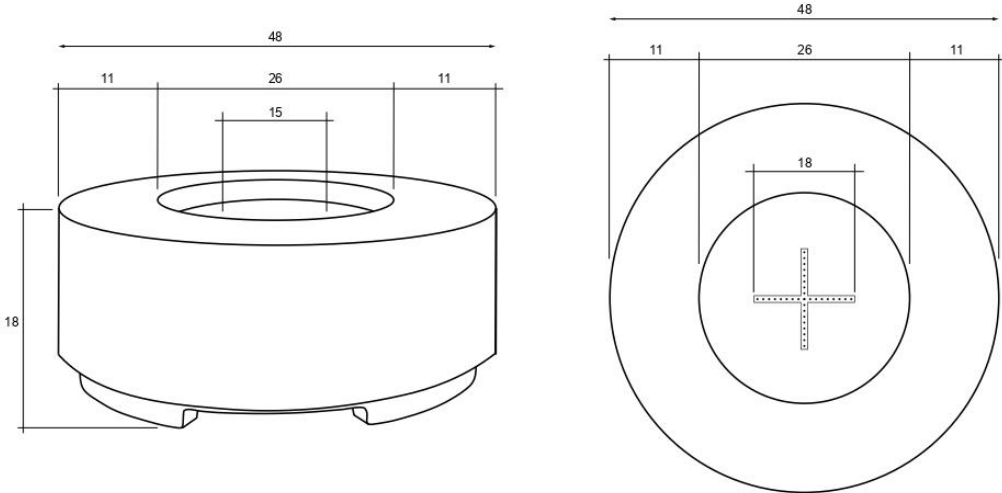

Lombard



SPECIFICATIONS

Width	40"
Height	18"
Surface	6"
Burner Size	18" / 65,000 BTU
Weight	280 lbs.
Fuel Source	LP or NG
Ignition	Key Valve
Materials	Glass fiber reinforced cement

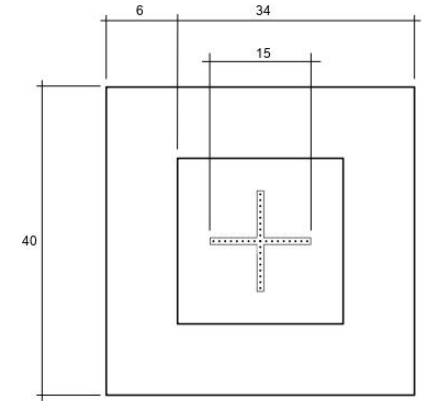
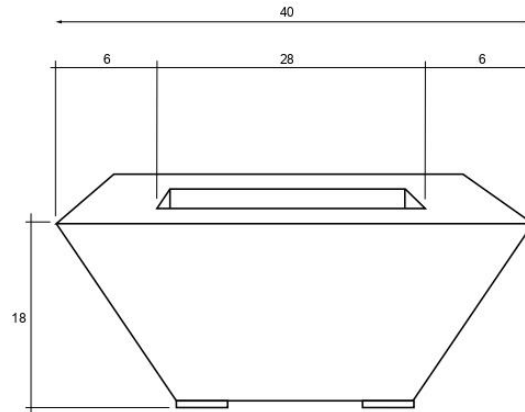

Embarcadero



SPECIFICATIONS

Diameter	48"
Height	15"
Surface	7"
Burner Size	18" / 65,000 BTU
Weight	225 lbs.
Fuel Source	LP or NG
Ignition	Key Valve
Materials	Glass fiber reinforced cement

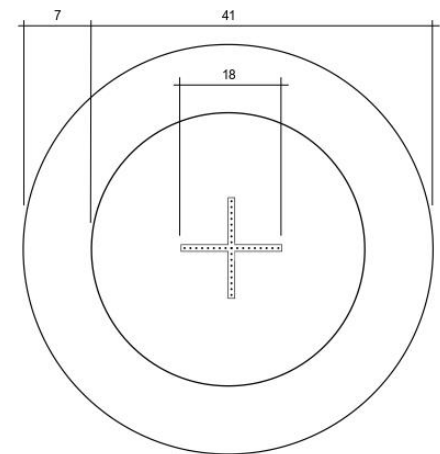
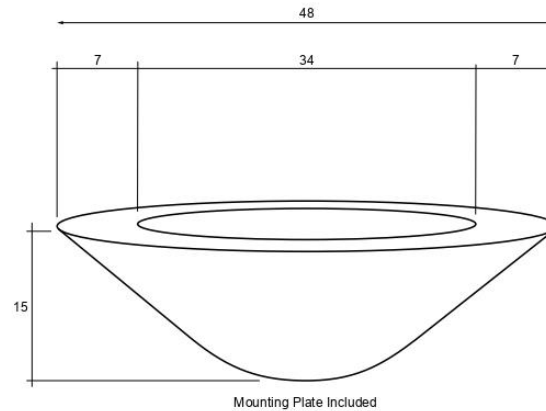





Propane Enclosures



TAV SPECIFICATIONS

Width	20"
Height	21½"
Weight	80 lbs.
Materials	Glass fiber reinforced cement

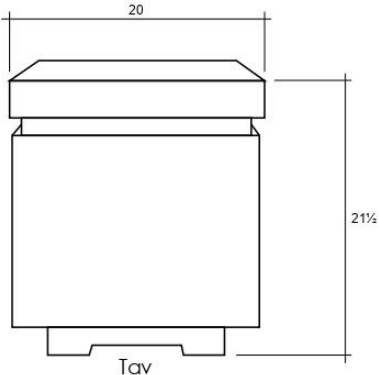

MOD SPECIFICATIONS

Diameter	20"
Height	21½"
Weight	80 lbs.
Materials	Glass fiber reinforced cement

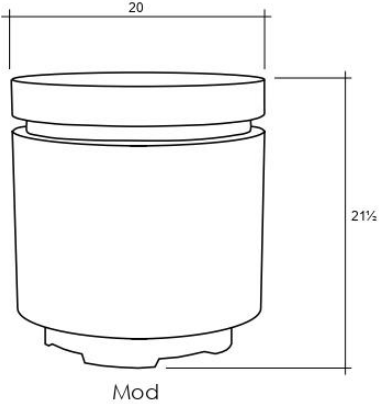

SAUSALITO SPECIFICATIONS

Width	20"
Height	21½"
Weight	80 lbs.
Materials	Glass fiber reinforced cement

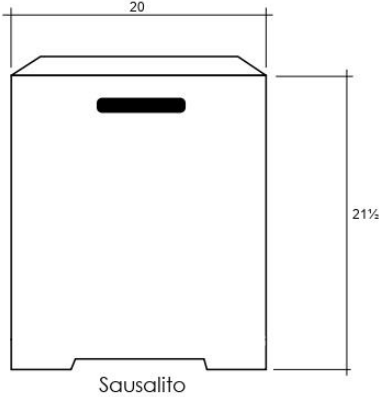

Lombard (Pedestal)



SPECIFICATIONS

Width	29"
Height	14"
Surface	3"
Burner Size	15" / 65,000 BTU
Weight	90 lbs.
Fuel Source	LP or NG
Ignition	Key Valve
Materials	Glass fiber reinforced cement

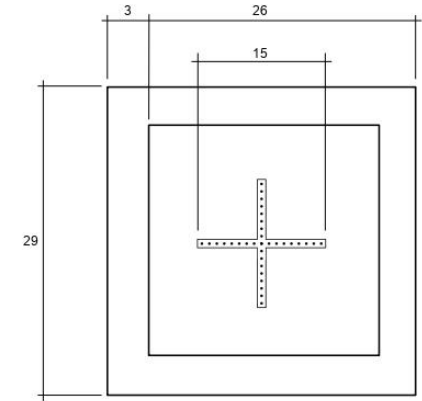
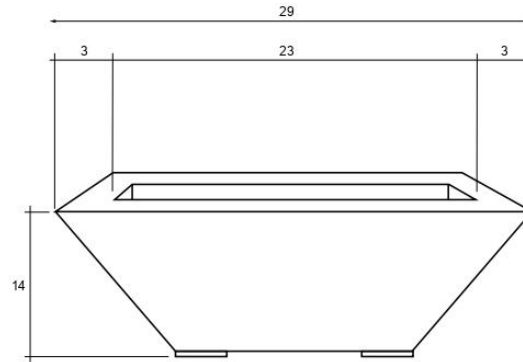

Embarcadero (Pedestal)



SPECIFICATIONS

Diameter	31"
Height	10"
Surface	2½"
Burner Size	15" / 65,000 BTU
Weight	90 lbs.
Fuel Source	LP or NG
Ignition	Key Valve
Materials	Glass fiber reinforced cement

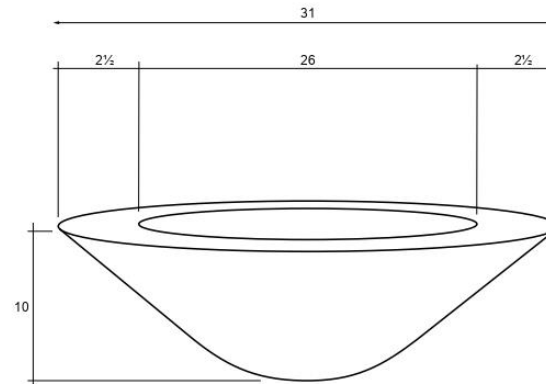

Mounting Plate Included

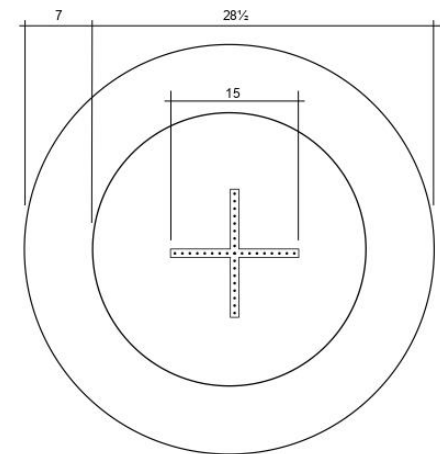



BURNER UNIT ASSEMBLY

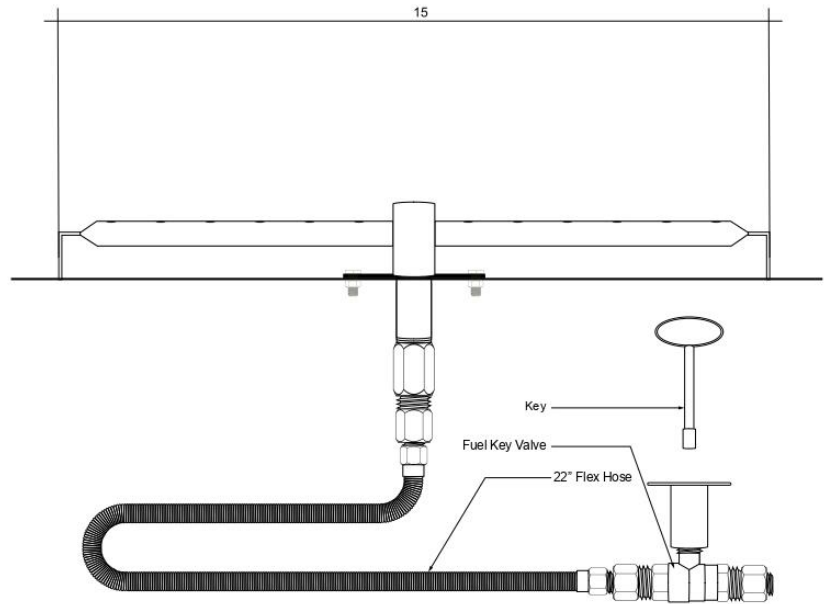
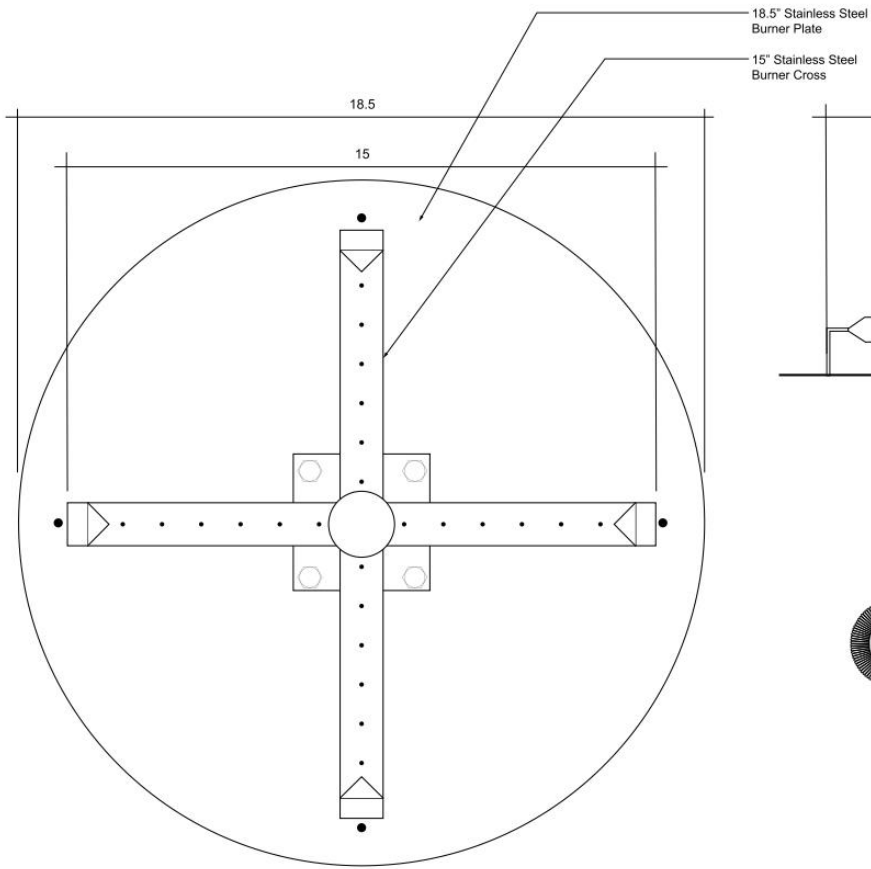

- New Cross Burner Specifications**
- Made in the USA
 - 65,000 BTU's
 - Key Valve Ignition
 - 304 Stainless Steel
 - Tested to meet CSA/ANSI standards
 - 2-year Warranty





Falò (Wood Burning)

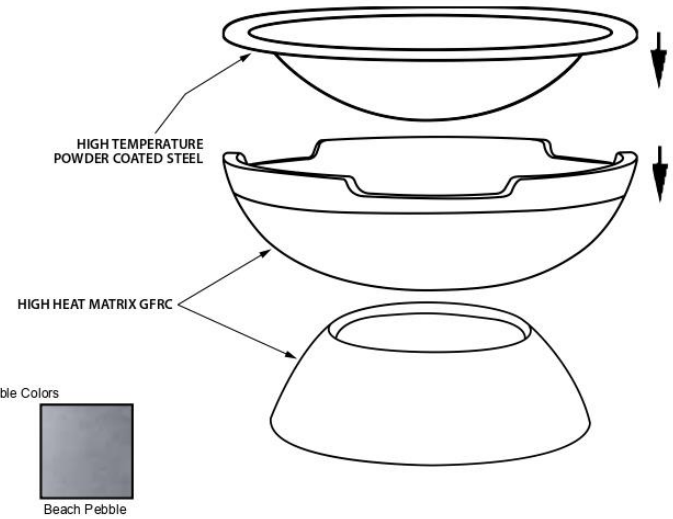
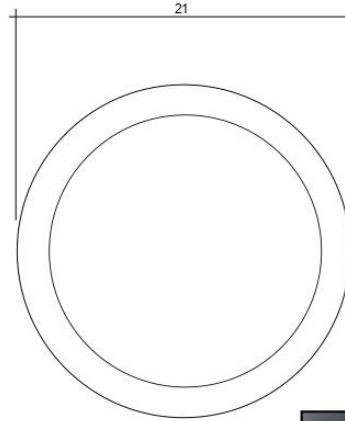

SPECIFICATIONS

Diameter	21"
Height	10½"
Weight	30 lbs.
Fuel Source	Wood
Materials	Glass fiber reinforced cement
Burner Pan	High Temp Powder Coated Steel



LIGHT WEIGHT



QUICK ASSEMBLY



RUST RESISTANT



FROST RESISTANT



EASY DISPOSAL



HEAT RESISTANT



create the perfect environment

- fire anytime, anywhere.

With Falò's lightweight and portable design, you can create the perfect lighting, warmth and ambiance for an evening with friends & family.

- modern design

Falò uses the perfect blend of design and modern materials to create the lightweight, sleek look of the fire bowl, while maintaining the integrity of the materials under extreme conditions.

- portability

Falò uses state of the art technology to create the perfect accessory for your outdoor setting. Lightweight yet strong, use Falò at your home, or take it with you for an outdoor adventure. Falò's quick assembly allows for easy travel and set up.



EDEL

HOSPITALITY COLLECTION



MODERNO 1

SPECIFICATIONS

Diameter	39"
Bottom Diameter	16"
Height	18"
Burner Size	20" / 65,000 BTU
Weight	71 lbs.
Fuel Source	LP or NG
Ignition	Key Valve
Materials	Bush Hammered Copper

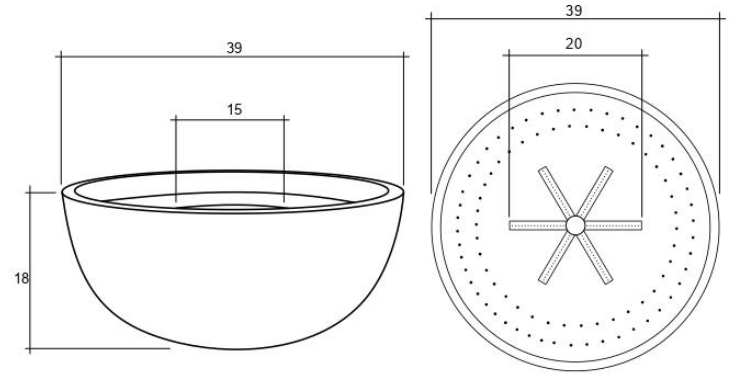

MODERNO 3

SPECIFICATIONS

Diameter	30"
Bottom Diameter	14"
Height	18"
Burner Size	15" / 65,000 BTU
Weight	51 lbs.
Fuel Source	LP or NG
Ignition	Key Valve
Materials	Bush Hammered Copper

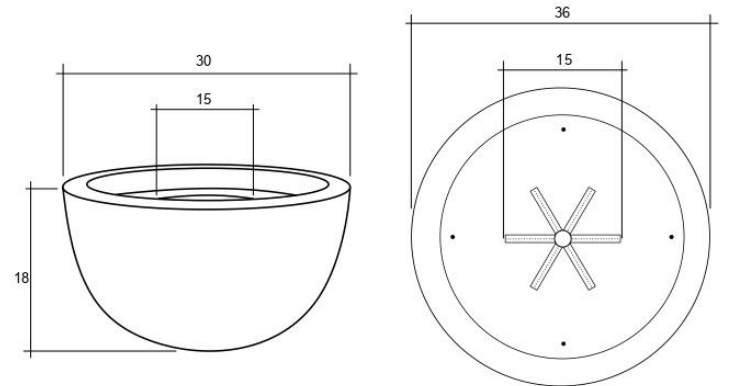

MODERNO 4

SPECIFICATIONS

Diameter	48"
Bottom Diameter	24"
Height	17"
Burner Size	22" / 65,000 BTU
Weight	102 lbs.
Fuel Source	LP or NG
Ignition	Key Valve
Materials	Bush Hammered Copper

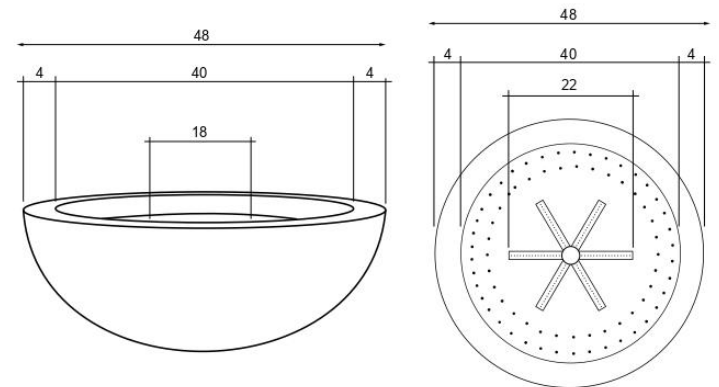



TAVALO 110

SPECIFICATIONS

Length	110"
Width	38"
Height	16"
Surface	11"
Burner Size	80" / 250,000 BTU
Weight	680 lbs.
Fuel Source	Natural Gas
Ignition	Key Valve / Electro AWEIS / Mini Ignition
Materials	GFRC / Powder Coated Steel
Media	Tumbled Indonesian Lava Rock

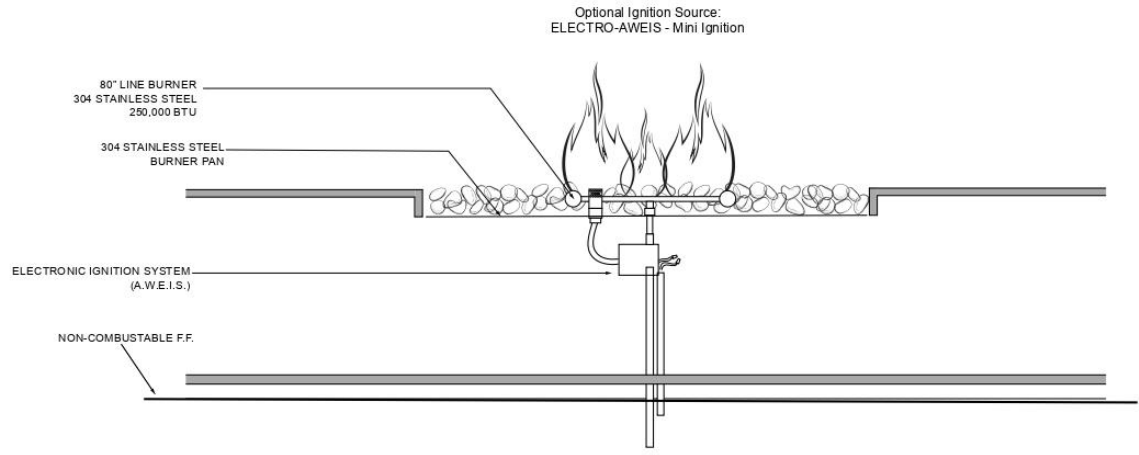
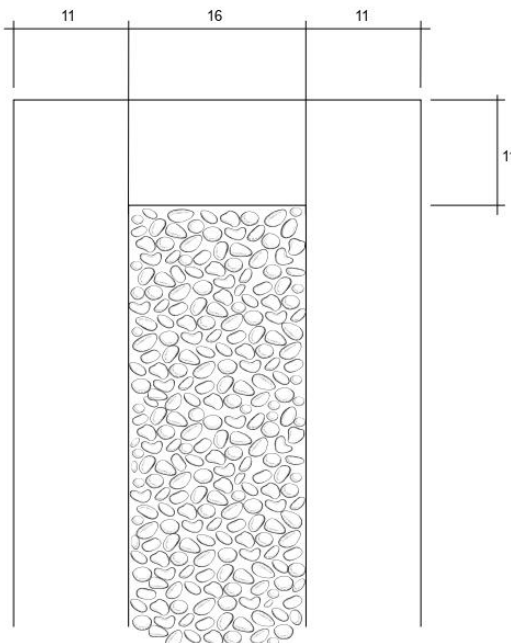
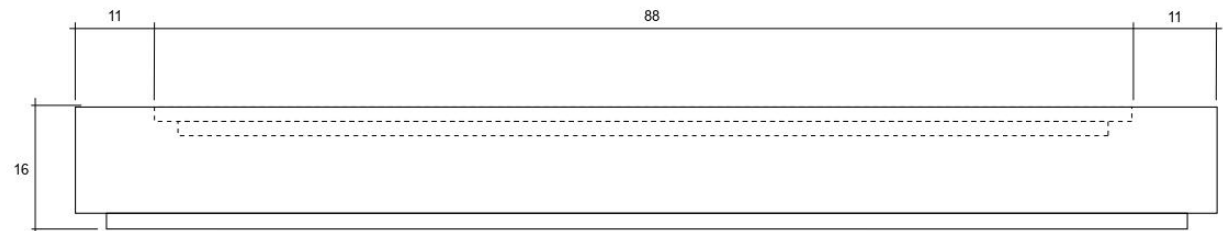
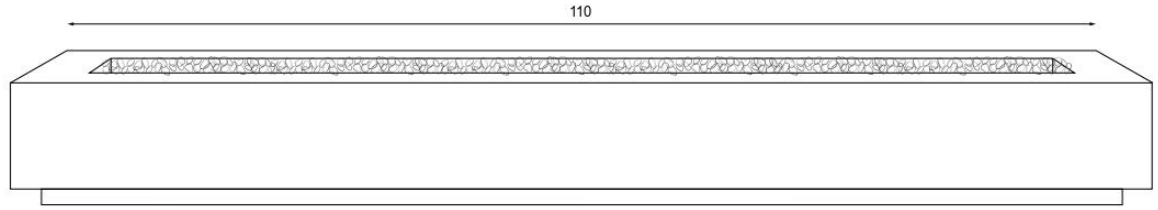



EDEL HOSPITALITY COLLECTION

DIVANO

GFR Color Options

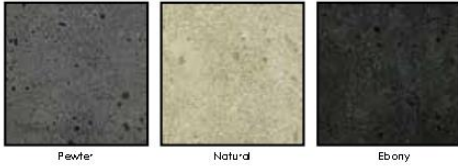

Cushion/Pillow Color Options

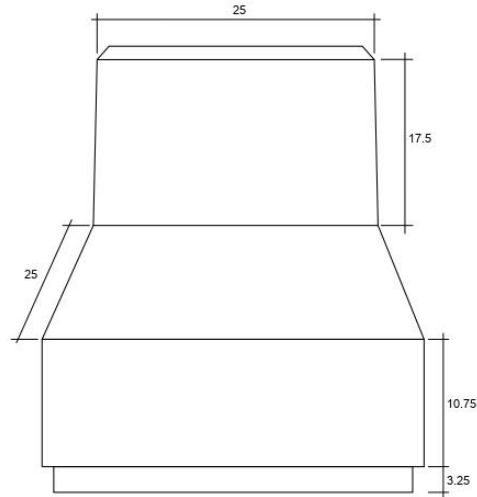
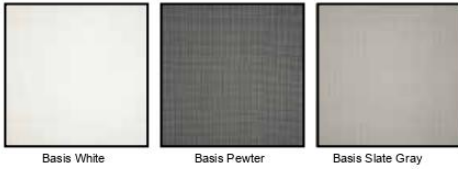

Middle Section

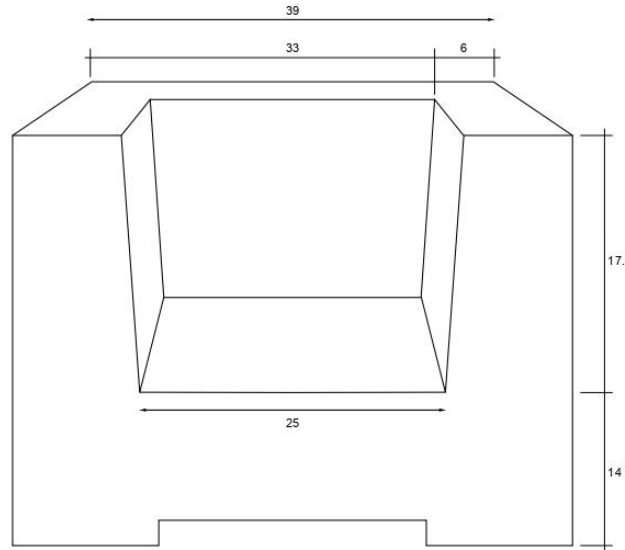
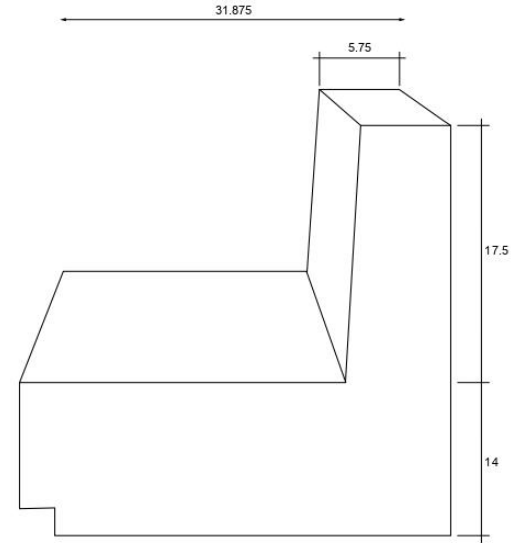

Club Chair

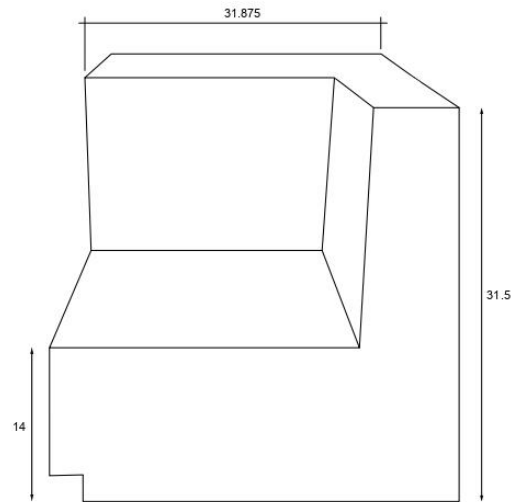

End Section



CLUB CHAIR

EDEL HOSPITALITY COLLECTION
FUEGO

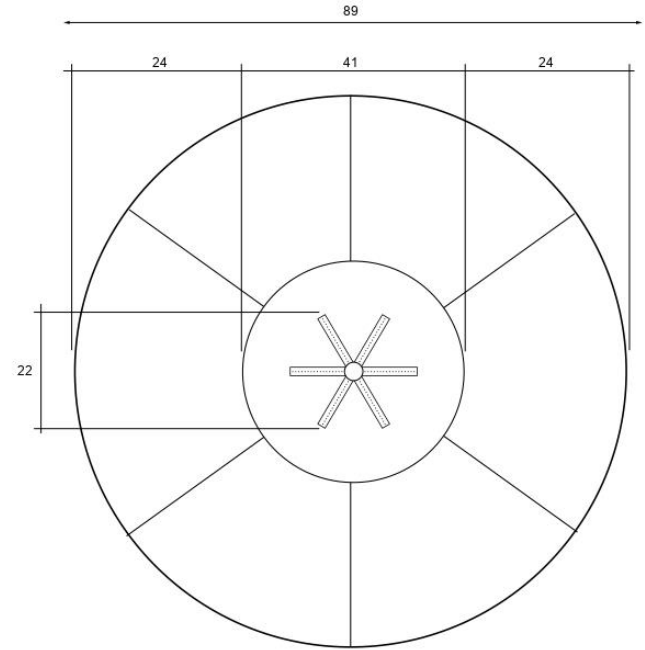
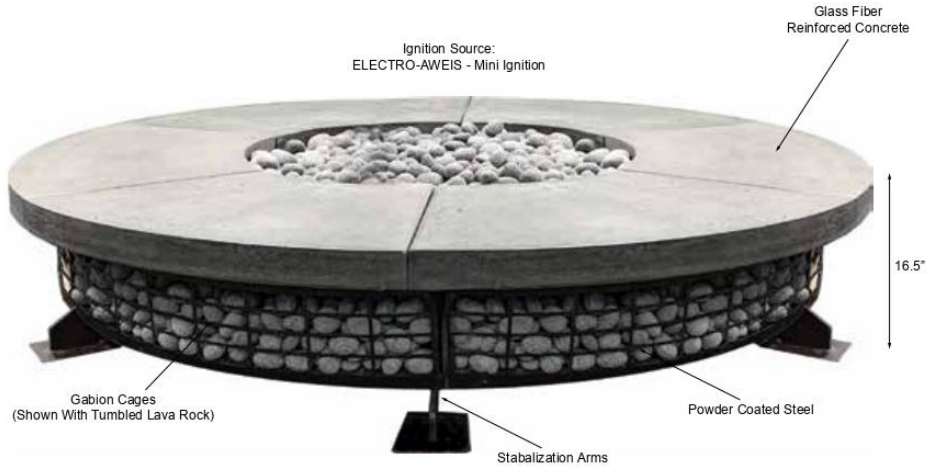

SPECIFICATIONS

Diameter	89"
Height	16.5"
Burner Size	22" / 125,000 BTU
Weight	1050 lbs.
Fuel Source	Natural Gas
Ignition	Electro AWEIS Mini Ignition
Materials	GFRC / Powder Coated Steel
Media	Tumbled Indonesian Lava Rock

GFR Color Options

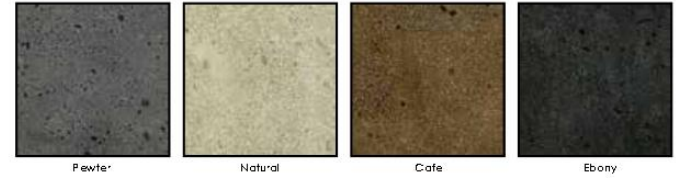

Cage & Base Color Options







Pewter



Natural



Café



Ultra



Ebony

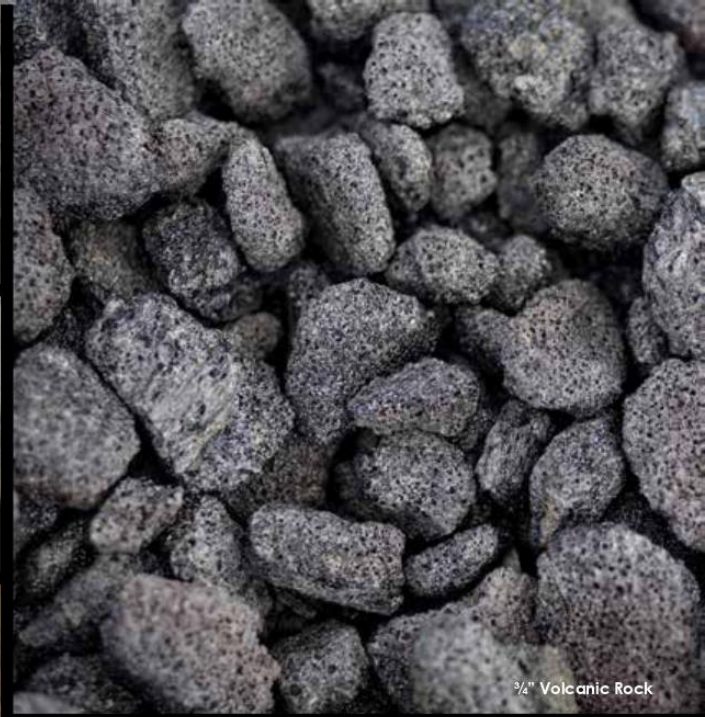

3/4" Volcanic Rock



Tumbled Lava Rock



MONTERREY

Vasconcelos 207 Ote. Col del Valle,
San Pedro Garza García
T (81) 2092 9879
C 81 2581 5796
KUSAM.COM.MX

SALTILLO

José Musa de León 151
Residencial Los Pinos
T (844) 180 0389
KUSAM.COM.MX