



SERVICE BULLETIN



WORL DLAWN POWER EQUIPMENT, INC.
2415 Ashland Ave
Beatrice, NE 68310
(402) 228-4255

Bulletin Number: SB1407
Date: 8/15/14

Product Affected: EC52FX730V3, EC52FX730V5, EC60FX730V3 & EC60FX801V5 mowers with serial numbers 61601 and below.

Situation: We had several customer requests to improve the durability of the spline driver 543085 used on the unit.

Solution: We worked with our supplier on the driver design and material composition. We also added a heavy flat washer as shown below.

Parts Required: In the future any orders for 543085 spline driver will be replaced with kit 542123 which contains the 543085 spline driver 103038 flat washer. The parts manuals will be updated as well.

Warranty: It is not recommended nor required to update existing machines. This is considered a product improvement and not a warrantable update. Should any failure occur you should use the diver with spacer kit.

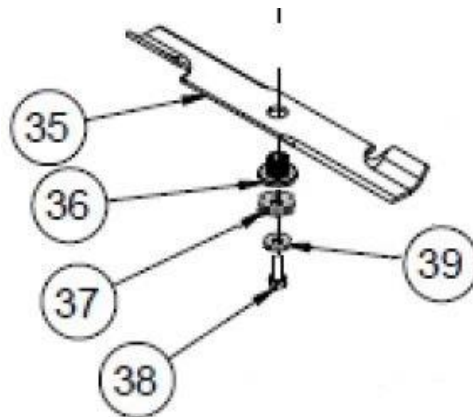

ITEM	PART NO	DESCRIPTION
35	543293	BLADE, STD 18.0"
36	543085	DRIVER, BLADE
37	103038	WASHER, FLAT
38	100537	1/2-20 X 2-1/2 HHCS
39	105502	WASHER, SPING DISC 1/2