



MID-CUT AND FRONT CUT UNITS



Instructional / Parts Manual

Part Number: 151018 (154011 & 154025) &
Adapter Kits (152057, 152058,
152059, 152060, 152061 &
152064)

January 2004



Table of Contents

- PROWLER GRASS CATCHER TWO PACKAGED ITEMS LIST
 - 154025 PROWLER BLOWER ASSEMBLY BOX ITEMS A - 1
 - 154011 CATCHER HOOD BOX ITEMS WITH BOLT BAG CONTENTS

- ASSEMBLY INSTRUCTION B - 1

- PARTS MANUAL
 - BLOWER ASSEMBLY C - 1
 - HOOD ASSEMBLY C - 4

PROWLER GRASS CATCHER

TWO PACKAGED ITEMS

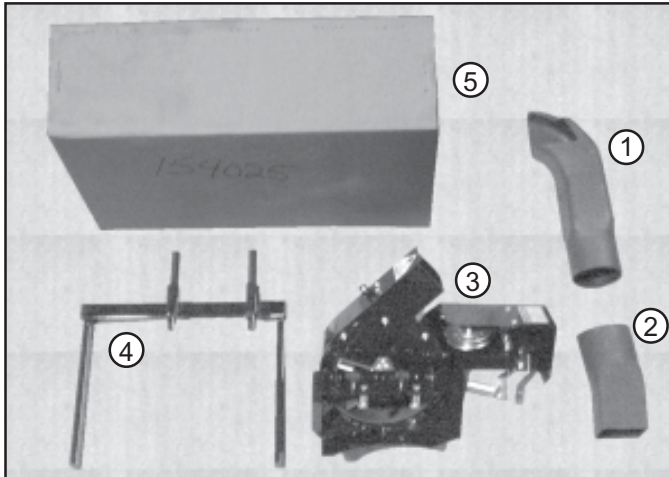

154025 BLOWER ASSY

BOXED (BOX 1 OF 2)

#	PART #	QTY	PART NAME
1	153211	1	HOOD INLET ADAPTER
2	153212	1	BLOWER HOSE ADAPTER
3	NA	1	PROWLER BLOWER ASSY.
4	582027	1	CATCHER MOUNT WELDMENT
5	NA	1	Z CATCHER BLOWER BOX - NC



154011 CATCHER HOOD

BOXED (BOX 2 OF 2)

#	PART #	QTY	PART NAME
1	NA	1	HOOD ASSY.
2	152052	1	BAG FRAME w/ LATCH
3	153217	1	GRASS TUBE 6"
4	153048	2	GRASS TUBE CLAMP
5	153171	2	SEWN BAG w/FRAME
6	153214	1	PULLEY GUARD
7	NA	1	BOLT BAG PRWLR- GC
8	933168	1	ASSMBLY/PARTS MANUAL
9	NA	1	CATCHER HOOD BOX (NC)

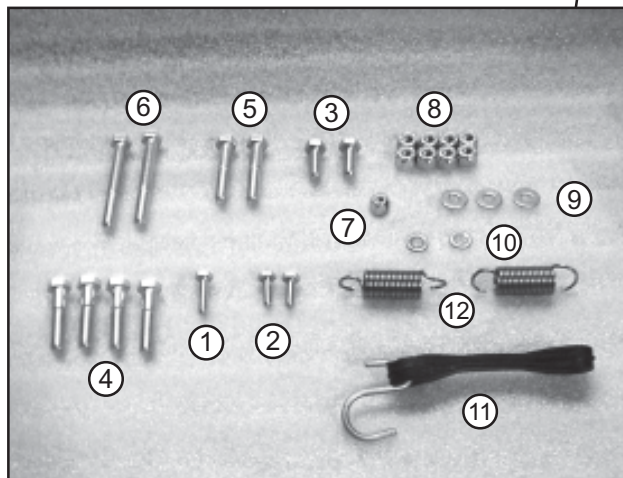

BOLT BAG

#	PART #	QTY	PART NAME
1	100004	1	1/4 - 20 x 1 HHCS
2	100252	2	1/4 - 20 x 3/4 HHCS
3	100292	2	3/8-16 X 1 HHCS
4	100295	4	3/8-16 X 1 3/4 HHCS
5	100296	2	3/8-16 X 2 HHCS
6	100300	2	3/8-16 X 3 HHCS
7	104255	1	1/4 - 20 NYLOCK NUT
8	104257	8	3/8-16 X NYLOC NUT
9	105256	3	1/4 STD. FLATWASHER
10	153045	2	5/16 PUSH NUT
11	153050	1	BLOWER TIE DOWN
12	523048	2	PUMP IDLER SPRING
13	NA	1	PLASTIC BAG

PROWLER GRASS CATCHER DRIVE KITS

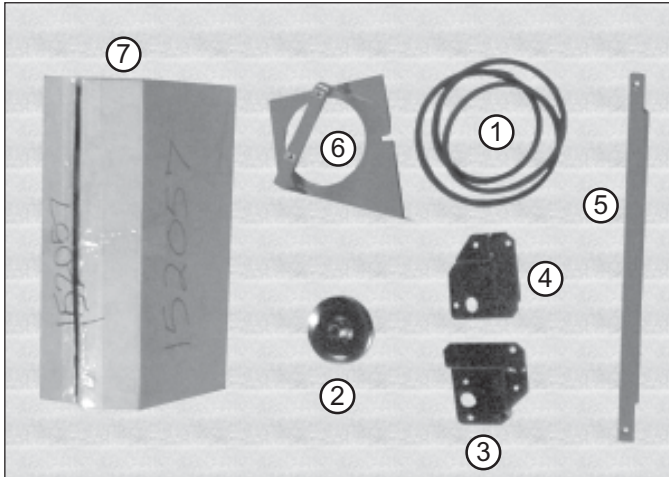

152057 52 MC CATCHER ADAPTER KIT

#	PART #	QTY	PART NAME
1	153158	1	DRIVE BELT – Z52 (A79)
2	153215	1	PROWLER DRIVE PULLEY 4-3/4"
3	592050	1	RH CATCHER ADAPTER - MC
4	592052	1	LH CATCHER ADAPTER - MC
5	152056	1	52 – LIFT BAR GC
6	109015	2	1/4 - 20 NUT CLIP
6	522126	1	52" BELT COVER – MC / GC
7	NA	1	SERVICE BOX

This Drive Kit is used on the follow unit(s):

52K650ZP 52K23A
52K700ZP 52K25A
52K850ZP 52K27L

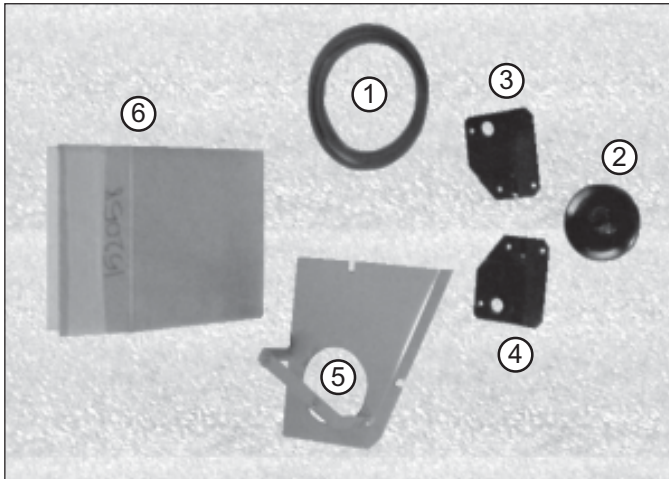

152058 61 MC CATCHER ADAPTER KIT

#	PART #	QTY	PART NAME
1	153158	1	DRIVE BELT – Z52 (A79)
2	153215	1	PROWLER DRIVE PULLEY 4-3/4"
3	592050	1	RH CATCHER ADAPTER - MC
4	592052	1	LH CATCHER ADAPTER - MC
5	109015	2	1/4 - 20 NUT CLIP
5	592054	1	61" BELT COVER – MC / GC
6	NA	1	MULCH KIT BOX

This Drive Kit is used on the follow unit(s):

62K650ZP 61K25A
61K650P 61K27L
61K700ZP
61K850ZP

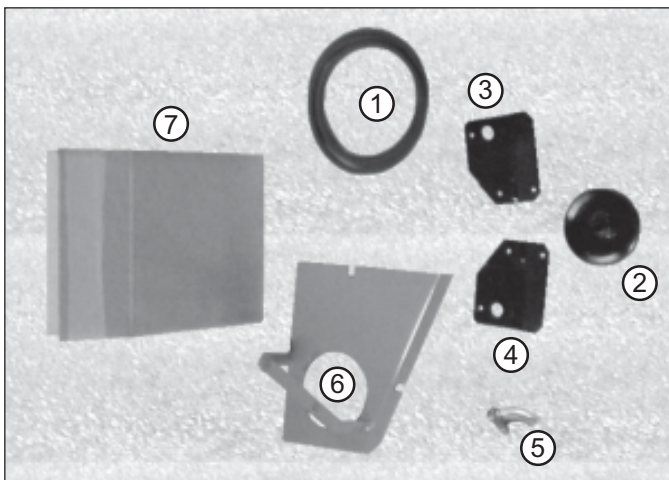

152059 61 MC IL3 CATCHER ADAPTER KIT

#	PART #	QTY	PART NAME
1	153158	1	DRIVE BELT – Z52 (A79)
2	153215	1	PROWLER DRIVE PULLEY 4-3/4"
3	592050	1	RH CATCHER ADAPTER - MC
4	592052	1	LH CATCHER ADAPTER - MC
5	593105	1	IL3 EXHAUST DEFLECTOR
5	593106	1	MUFFLER CLAMP – 1 1/2
6	109015	2	1/4 - 20 NUT CLIP
6	592054	1	61" BELT COVER – MC / GC
7	NA	1	MULCH KIT BOX

This Drive Kit is used on the follow unit(s):

61B850ZP 61B27LD
61B850P 61B31LD
61B950P

PROWLER GRASS CATCHER DRIVE KITS

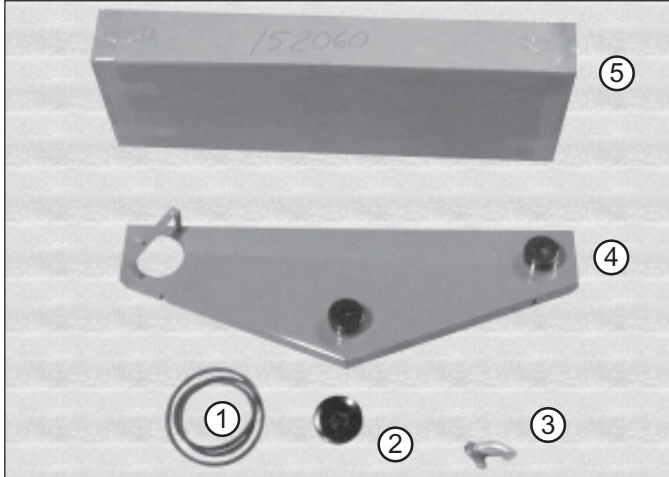

152060 61 FC IL3 CATCHER ADAPTER KIT

#	PART #	QTY	PART NAME
1	153158	1	DRIVE BELT – Z52 (A79)
2	153215	1	PROWLER DRIVE PULLEY 4-3/4"
3	593105	1	IL3 EXHAUST DEFLECTOR
3	593106	1	MUFFLER CLAMP – 1 1/2
4	109015	2	1/4 - 20 NUT CLIP
4	582035	1	BELT SHIELD – 61 – GC
5	913076	1	FC BELT SHIELD BOX

This Drive Kit is used on the follow unit(s):
B850PFC B950PFC

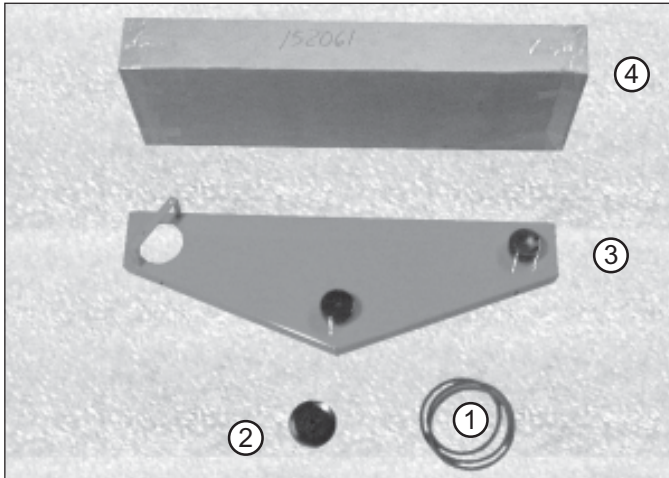

152061 61 FC CATCHER ADAPTER KIT

#	PART #	QTY	PART NAME
1	153158	1	DRIVE BELT – Z52 (A79)
2	153215	1	PROWLER DRIVE PULLEY 4-3/4"
3	109015	2	1/4 - 20 NUT CLIP
3	582035	1	BELT SHIELD – 61 – GC
4	913076	1	FC BELT SHIELD BOX

This Drive Kit is used on the follow unit(s):
K800PFC K850PFC

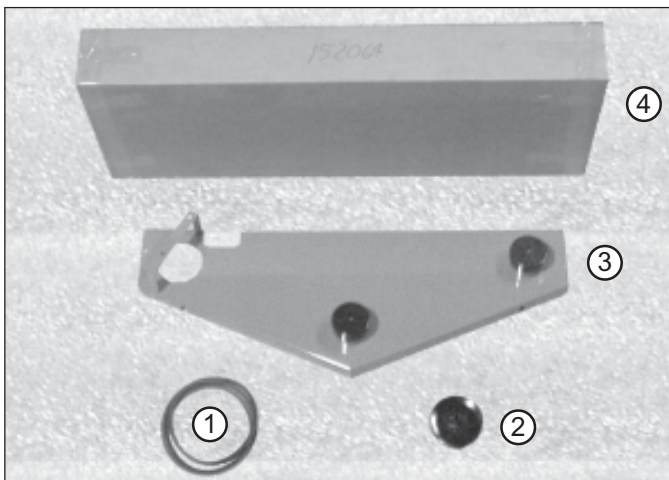

152064 52 FC CATCHER ADAPTER KIT

#	PART #	QTY	PART NAME
1	153158	1	DRIVE BELT – Z52 (A79)
2	153215	1	PROWLER DRIVE PULLEY 4-3/4"
3	109015	2	1/4 - 20 NUT CLIP
3	582033	1	BELT SHIELD – 52 – GC
4	NA	1	FC BELT SHIELD BOX

This Drive Kit is used on the follow unit(s):
K800PFC K850PFC

ASSEMBLY INSTRUCTION

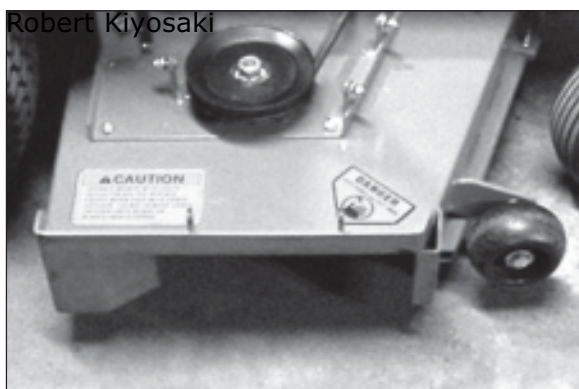

Figure 1
Begin by removing the discharge cover and RH belt shield.

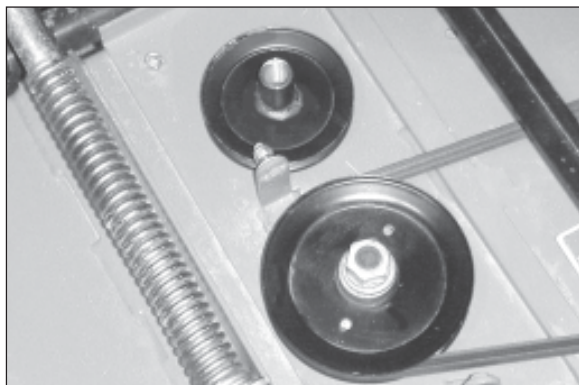

Figure 2
Remove the retaining nut from the RH spindle pulley. Using the drive pulley found in the drive kit, apply some removable loctite (blue) to the threads and fasten pulley to top of spindle. Torque to 90 ft-lbs.

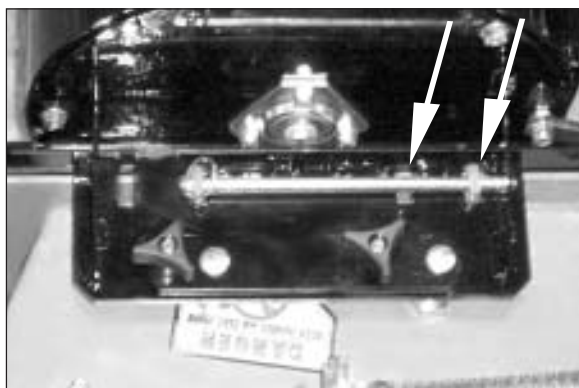

Figure 3
Install blower assembly using the rear slots for a 61" deck and the front slots for a 52" deck. Slide the blower retaining pin through the mount tabs and secure blower against retaining pin by tightening the elevator knobs mounted on the blower.

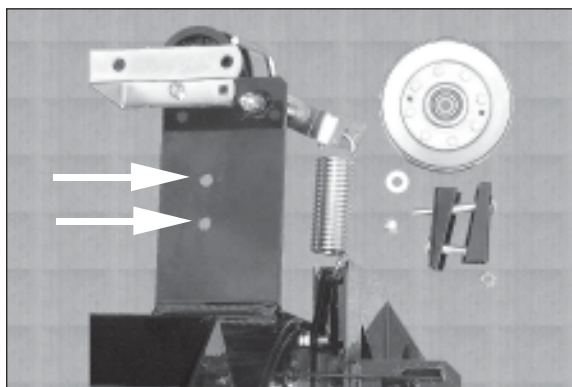

Figure 4
Remove the blower belt shield to locate the V-idler. Make certain the V-idler is mounted in the front hole for a 61" deck and the back hole for a 52" deck.

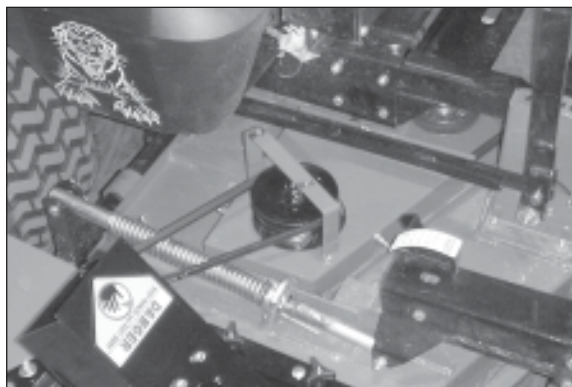

Figure 5
Install the lower RH belt shield found in the drive kit onto the RH blade spindle.



Figure 6
Route the drive belt so that the drive pulley spins the belt in a clockwise direction. Make certain the back side of the belt rides against the tensioner idler and the inside of the V-belt rides against the V-idler. Refer to figure 6 for illustration of belt routing.

ASSEMBLY INSTRUCTION



Figure 7
Re-fasten the blower belt shield onto the blower. Also mount the upper RH belt shield to the bracket that is welded to the lower RH belt shield.

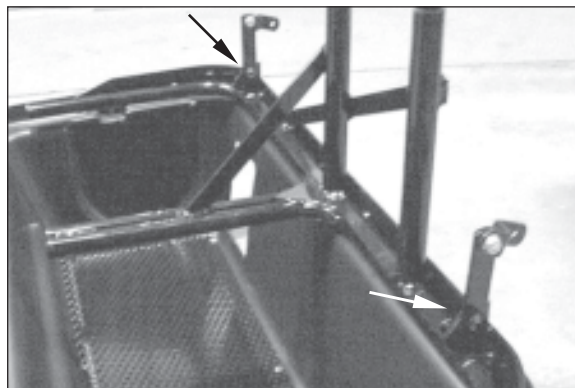

Figure 9
Lay the catcher hood on the floor upside down and slide pins on catcher frame through the holes on the catcher hood. Drive the 5/16" pushnuts found in the bolt bag onto the hood pins to secure frame to the catcher hood.



Figure 8a



Figure 8b
Install the catcher mount weldment found in the blower assembly box to the back end of the frame rails. *NOTE: Prowler Midcuts will require the RH & LH catcher adapters to be installed prior to mounting the catcher mount weldment (Figs. 8a & 8b).*

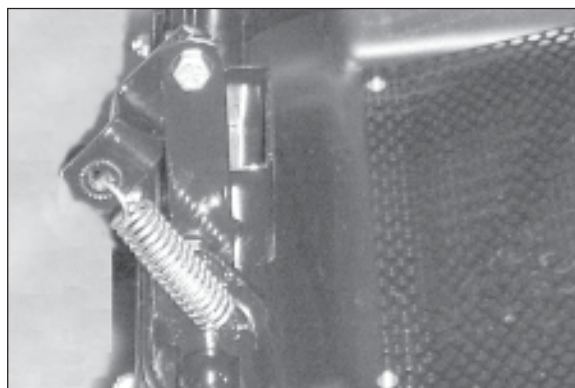

Figure 10
Mount tension springs between the catcher frame pins and hood "Z"-brackets.



Figure 11
Slide the assembled hood onto the catcher mount weldment and install the grass bags.

ASSEMBLY INSTRUCTION

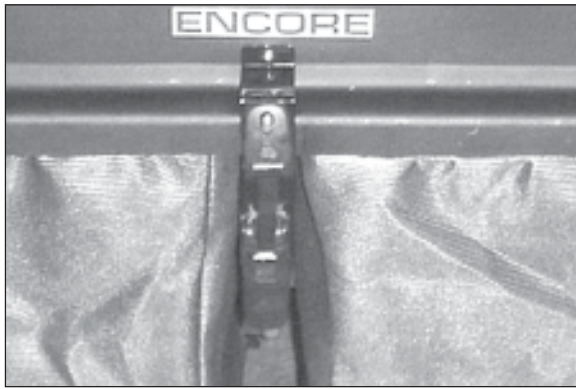

Figure 12
Close the catcher hood and secure the hood latch.

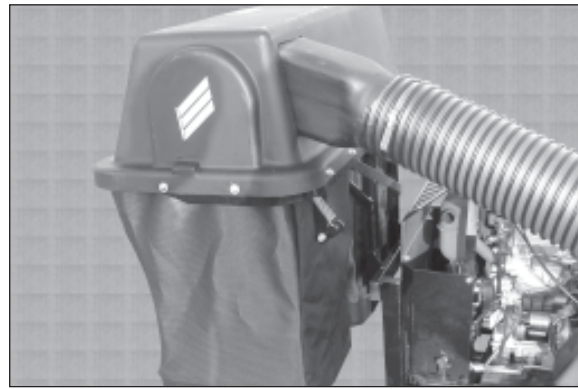

Figure 15
Install the grass tube and secure into place using two hose clamps found in the hood assembly box. *NOTE: The hose may have to be trimmed to length as the same hose is used for Prowler Frontcuts and Midcuts.*

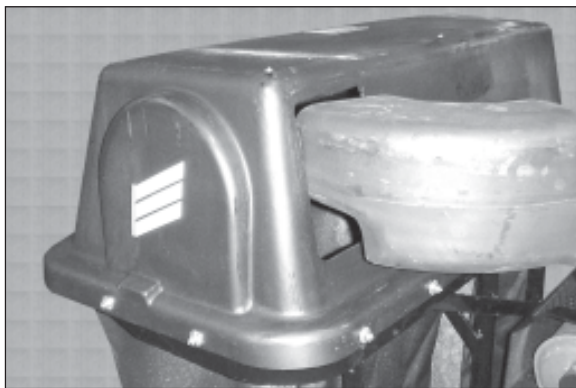

Figure 13
Slide the upper tube assembly into the opening of the catcher hood.

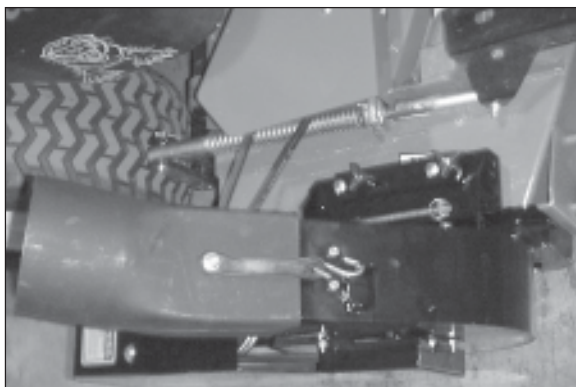

Figure 14
Fasten the tie-down strap to the blower hose adapter.



Figure 16
This completes the installation of your new Prowler Grass Catcher System.



PROWLER GRASS CATCHER BLOWER ASSY - 154025

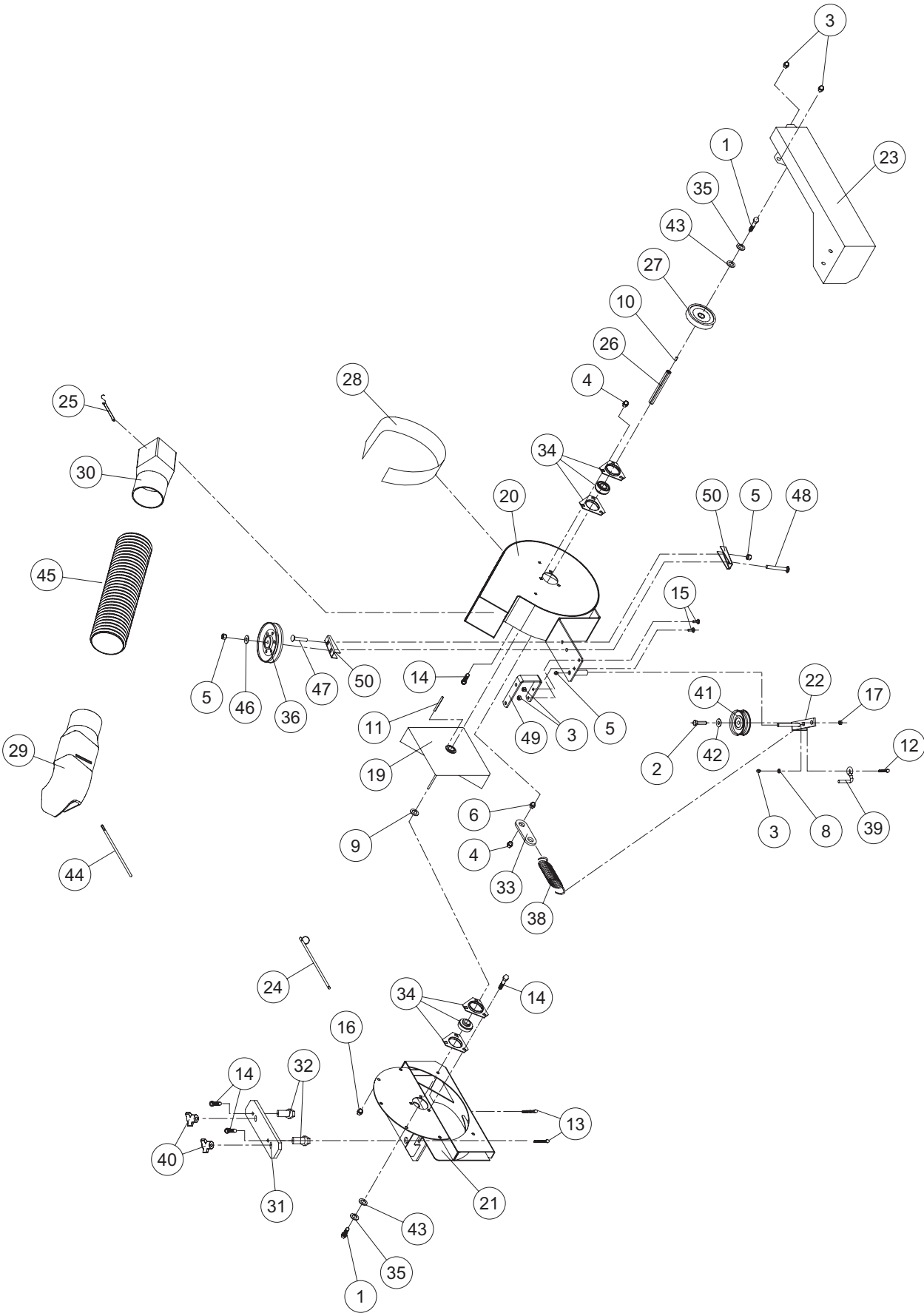

PROWLER GRASS CATCHER BLOWER ASSY - 154025

#	PART NO.	QTY	DESCRIPTION
1	100273	2	5/16-18 X 1 HHCS
2	100294	1	3/8"-16 X 1 1/2" HEX BOLT
3	104255	10	1/4"-20 NYLOC NUT
4	104256	7	5/16-18 NYLOC NUT
5	104257	3	3/8"-16 NYLOC NUT
6	104751	1	5/16-18 JAM NUT
7	-----	--	-----
8	105256	3	1/4" FLAT WASHER
9	105269	1	3/4 SAE FLATWASHER
10	107253	1	3/16" X 3/16" X 1/2" KEY
11	107266	1	3/16 X 3/16 X 2 MACH. KEY
12	107510	1	1/4"-20 X 1" CARRIAGE BOLT
13	107520	2	5/16"-18 X 1 3/4" TAP BOLT
14	107522	8	5/16"-18 X 5/8" CARRIAGE BOLT
15	107502	2	1/4"-20 X 3/4" CARRIAGE BOLT
16	109001	4	5/16"-18 WHIZLOCK NUT
17	109007	2	3/8"-16 WHIZLOCK NUT
18	-----	--	-----
19	152016	1	IMPELLER
20	152020	1	HOUSING WELDMENT
21	152050	1	PROWLER MOUNT WELDMENT
22	152024	1	IDLER ARM
23	152054	1	BELT COVER
24	153046	1	RING PIN
25	153050	1	BLOWER TIE DOWN
26	153066	1	DRIVE SHAFT
27	153072	1	PULLEY(DRIVEN)
28	153110	1	BLOWER LINER
29	153211	1	HOOD INLET ADPT.
30	153212	1	BLOWER HOSE ADPT.
31	153133	1	ADAPTER STRAP
32	153135	2	ADAPTER RAM
33	153138	1	SPRING MOUNT
34	153216	2	TRIANGLE FLANGE BEARING
35	363226	2	5/16 DISC SPRING WASHER
36	483025	1	IDLER PULLEY
37	-----	--	-----
38	523327	1	SPRING
39	553025	1	BELT GUIDE
40	753028	2	KNOB
41	823351	1	DRIVE IDLER
42	105259	1	3/8 SAE FLATWASHER
43	153240	2	IMPELLER SHAFT WASHER
44	153048	2	GRASS TUBE CLAMP
45	153217	1	GRASS TUBE 6"
46	105260	1	3/8" STANDARD FLAT WASHER

PROWLER GRASS CATCHER BLOWER ASSY - 154025

#	PART NO.	QTY	DESCRIPTION
47	107501	1	3/8"-16 X 2" CARRIAGE BOLT
48	107513	1	3/8"-16 X 3" CARRIAGE BOLT
49	153208	1	BELT SHIELD STRAP
50	153192	2	IDLER ANGLE

PROWLER GRASS CATCHER HOOD ASSY - 154011

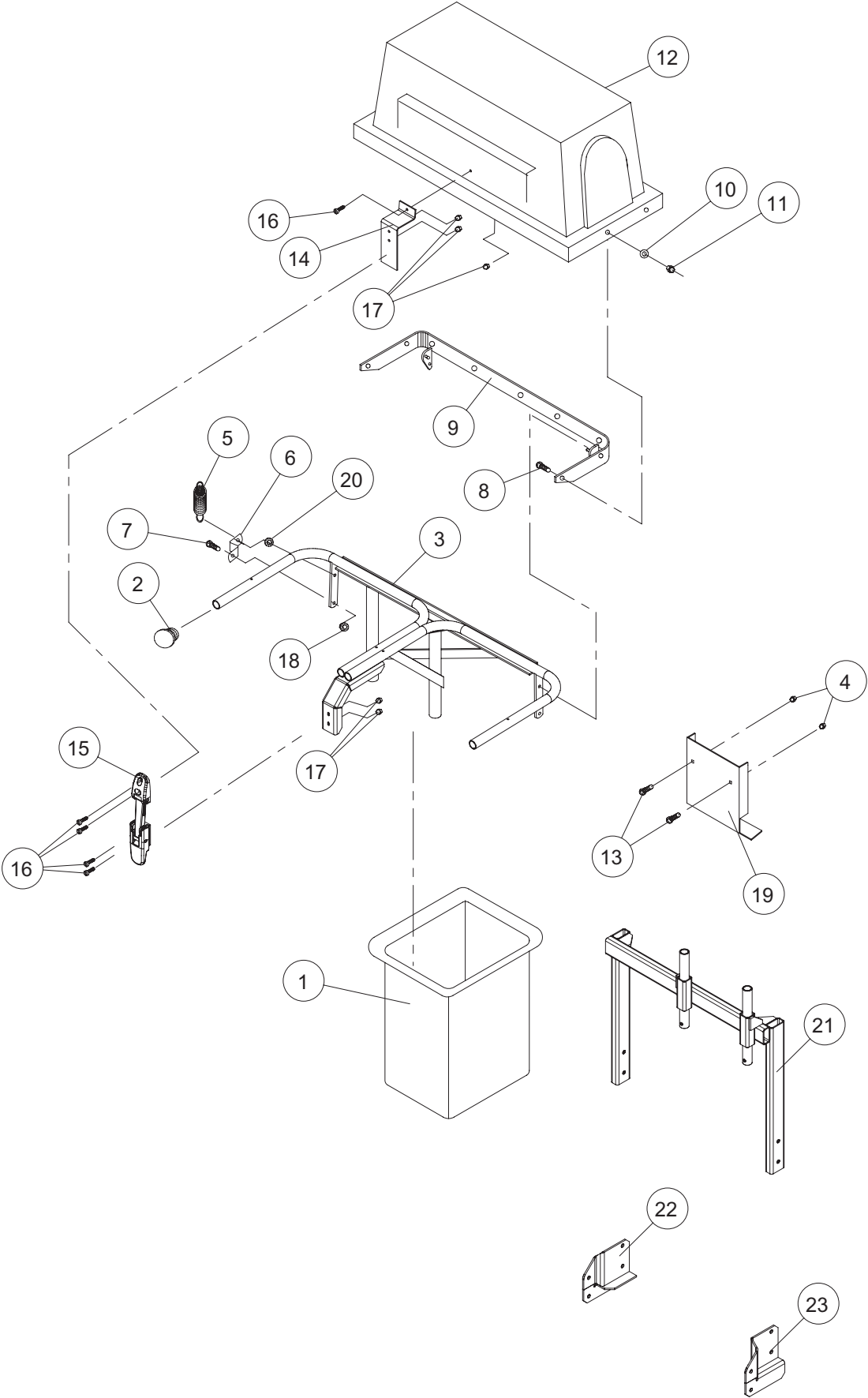

PROWLER GRASS CATCHER HOOD ASSY - 154011

#	PART NO.	QTY	DESCRIPTION
1	153171	2	SEWN BAG w/FRAME
2	523033	4	HANDLE PLUG
3	152052	1	BAG FRAME w/ LATCH
4	104256	2	5/16"-18 NYLOC NUT
5	523048	2	SPRING
6	153056	2	HOOD SPRING BRACKET
7	100271	2	5/16"-18 X 3/4" HEX BOLT
8	107502	10	1/4"-20 X 3/4" CARRIAGE BOLT
9	152009	1	HOOD STRAP
10	105256	10	1/4" FLAT WASHER
11	104255	10	1/4"-20 NYLOC NUT
12	153059	1	BLOWER HOOD
13	107512	1	5/16" X 2 1/2" CARRIAGE BOLT
14	153188	1	UPPER LATCH MOUNT
15	153218	1	HOOD LATCH
16	101039	5	#10-24 X 5/8" LG PAN HD SCREW
17	104252	5	#10-24 HEX NYLOCK NUT
18	109001	2	5/16"-18 WHIZLOCK NUT
19	153156	1	GRASS COLLECTOR BRACE
20	153045	2	5/16" PUSH NUT
21	582027	1	CATCHER MOUNT WELDMENT
22	592052	1	LH CATCHER ADAPTER - (Mid-Cut Only)
23	592050	1	RH CATCHER ADAPTER - (Mid-Cut Only)

OPTIONS:

592058	1	WEIGHT BRACKET KIT
821017	1	FC WEIGHT KIT (60 lb. weight)

Notes:

Notes:

