

A



ROLLER ADAPTERS

Punch Adapters	226 - 229
Bolted Adapters	230 - 231
Die Holders	232
Die Adapters	233 - 235
Modification: bar	235

A

ROLLERI ADAPTERS Punch Adapters

AD11

1000 kN/m max.

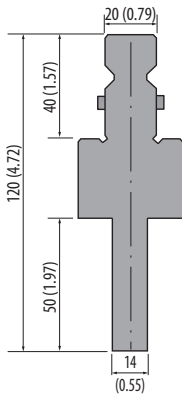

150 mm | 5.91 in | 3.0 kg

Rolleri Type R2
→ Rolleri Type R1

C45: 560-710 N/mm²



AD22

1000 kN/m max.

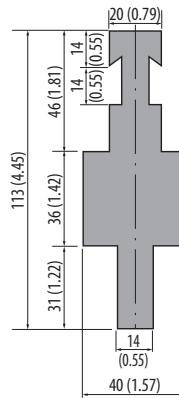

150 mm | 5.91 in | 3.4 kg

Rolleri Type R3 Beyeler R
→ Rolleri Type R1

C45: 560-710 N/mm²



AD3

1000 kN/m max.

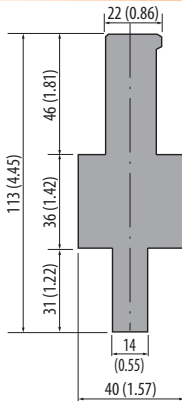

150 mm | 5.91 in | 3.3 kg

Rolleri Type R3 Beyeler S
→ Rolleri Type R1

C45: 560-710 N/mm²



AD10

1000 kN/m max.

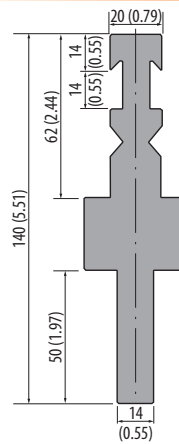

150 mm | 5.91 in | 3.4 kg

Rolleri Type R3 Beyeler
RFA → Rolleri Type R1

C45: 560-710 N/mm²



AD1

1000 kN/m max.

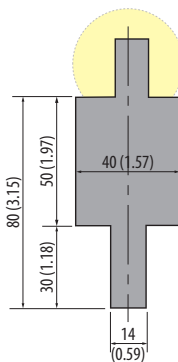

Tang A: **AD1-A**

150 mm | 5.91 in | 3.1 kg

Tang B: **AD1-B**

150 mm | 5.91 in | 3.1 kg

Tang C: **AD1-C**

150 mm | 5.91 in | 3.1 kg

Tang D: **AD1-D**

150 mm | 5.91 in | 3.1 kg

Rolleri Type RX LVD
→ Rolleri Type R1

C45: 560-710 N/mm²



Tangs LVD

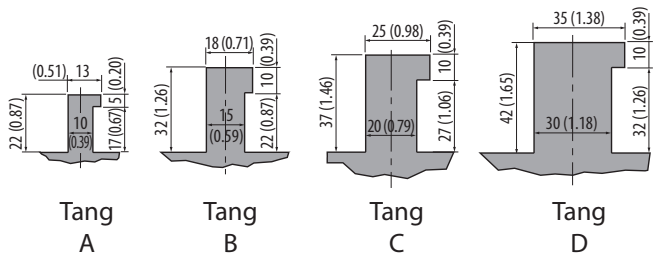

Tang
A

Tang
B

Tang
C

Tang
D

With adapters you can use
the vast range of Rolleri
R1 type punches!

AD13

1000 kN/m max.

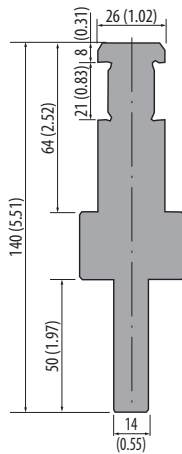

150 mm | 5.91 in | 3.0 kg

Rolleri Type RX EHT
→ Rolleri Type R1

C45: 560-710 N/mm²



AD14

1000 kN/m max.

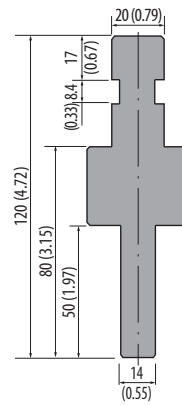

150 mm | 5.91 in | 3.2 kg

Rolleri Type RX Gas-parini
→ Rolleri Type R1

C45: 560-710 N/mm²



AD15

1000 kN/m max.

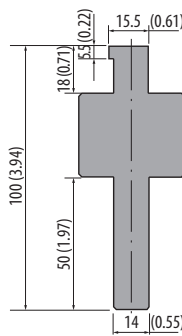

150 mm | 5.91 in | 4.0 kg

Rolleri Type RX Ajial-Axial
→ Rolleri Type R1

C45: 560-710 N/mm²



AD16

1000 kN/m max.

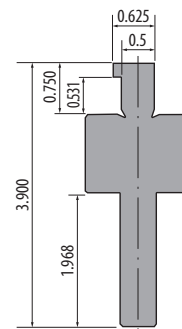

150 mm | 5.91 in | 4.0 kg

Rolleri Type American
→ Rolleri Type R1

C45: 560-710 N/mm²



AD12

1000 kN/m max.

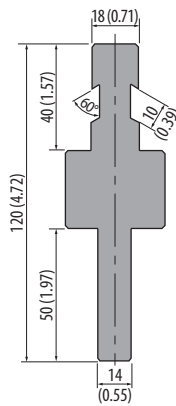

150 mm | 5.91 in | 1.5 kg

Rolleri Type RX Colgar
→ Rolleri Type R1

C45: 560-710 N/mm²



AD23

1000 kN/m max.

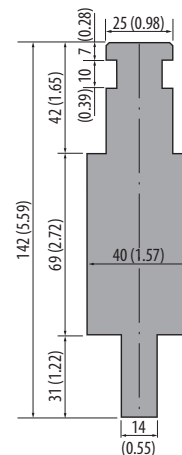

150 mm | 5.91 in | 5.0 kg

Rolleri Type RX Weinbrenner
→ Rolleri Type R1

C45: 560-710 N/mm²



Article on stock



Please ask for delivery time!

1 kg = 2.20 Pounds (lb) = 35.27 Ounces (oz)
100 mm = 3.94 Inch (in) = 0.33 Feet (ft)



Articles on stock – Please note that delivery time depends on your location.

A

ROLLERI ADAPTERS Punch Adapters

ADX

1000 kN/m max.

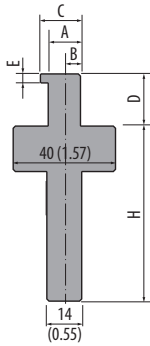

150 mm 5.91 in 3.5 kg

Type X
→ Rolleri Type R1

Production according
to your specifications

C45: 560-710 N/mm²



AD19-A

1000 kN/m max.

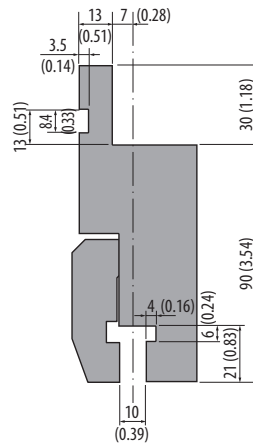

150 mm 5.91 in 6.0 kg

Rolleri Type R1
→ Rolleri Type RX LVD

C45: 560-710 N/mm²



ADX2

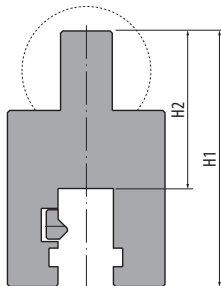

150 mm 5.91 in 4.0 kg

Type X
→ Rolleri Type R2

Production according
to your specifications

C45: 560-710 N/mm²



AD20

1000 kN/m max.

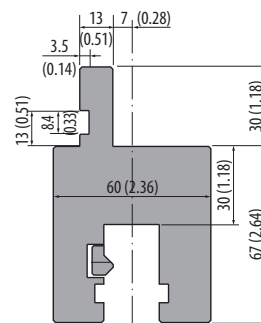

150 mm 5.91 in 4.0 kg

Rolleri Type R1
→ Rolleri Type R2

C45: 560-710 N/mm²



Pneumatic
Adapters
see page 219

AD20 LVD

1000 kN/m max.

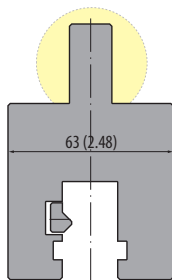

Tang A: AD20 LVD-A

150 mm 5.91 in 3.6 kg

Tang B: AD20 LVD-B

150 mm 5.91 in 3.8 kg

Tang C: AD20 LVD-C

150 mm 5.91 in 4.0 kg

Tang D: AD20 LVD-D

150 mm 5.91 in 4.0 kg

Rolleri Type RX LVD
→ Rolleri Type R2

C45: 560-710 N/mm²



AD28

1000 kN/m max.

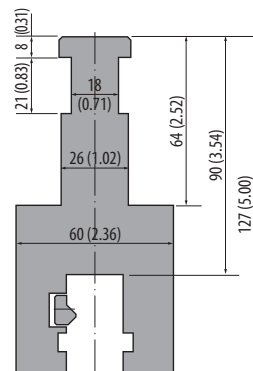

150 mm 5.91 in 5.0 kg

Rolleri Type RX EHT
→ Rolleri Type R2

C45: 560-710 N/mm²



Tangs LVD

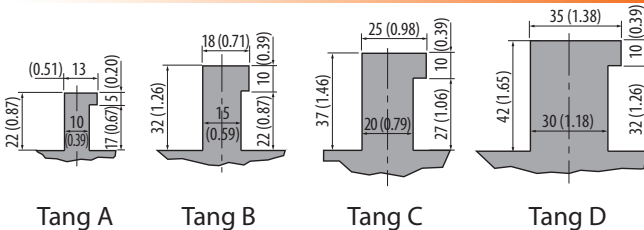

AD29

1000 kN/m max.

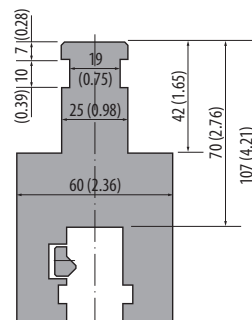

150 mm 5.91 in 4.5 kg

Rolleri Type RX
Weinbrenner
→ Rolleri Type R2

C45: 560-710 N/mm²



Rolleri Videos

Bolted Adapters AW, P. 230-231
www.rolleritools.com/videos/bolted-adapters



A

ROLLERI ADAPTERS Punch Adapters

INT80-100

1000 kN/m max.

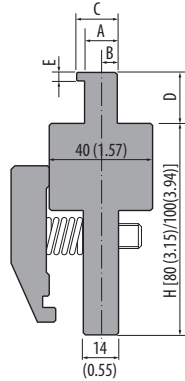

835 mm	32.87 in	25.0 kg
415 mm	16.34 in	12.5 kg

C45: 560-710 N/mm²



INT67-79

1000 kN/m max.

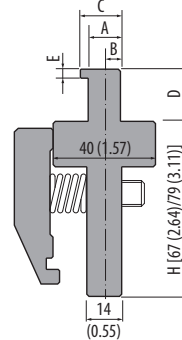

835 mm	32.87 in	20.5 kg
415 mm	16.34 in	10.0 kg

C45: 560-710 N/mm²



INT100-A / INT120-A

1000 kN/m max.

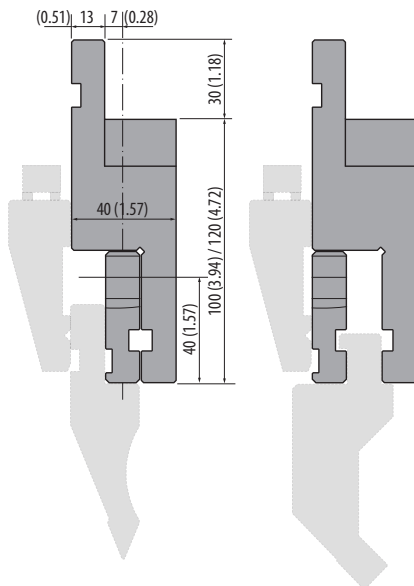

INT100-A		
150 mm	5.91 in	3.5 kg

INT120-A		
150 mm	5.91 in	5.2 kg

C45: 560-710 N/mm²

suitable Models:

- Manual system (ST60, STL60, STX60 etc.), see page 217
- Fast Clamping (ROL1 Clamp3), see page 218
- Pneumatic system only on INT120-A (ROL1 Clamp3 PN), see page 218



INT100-N (Newton)

1000 kN/m max.

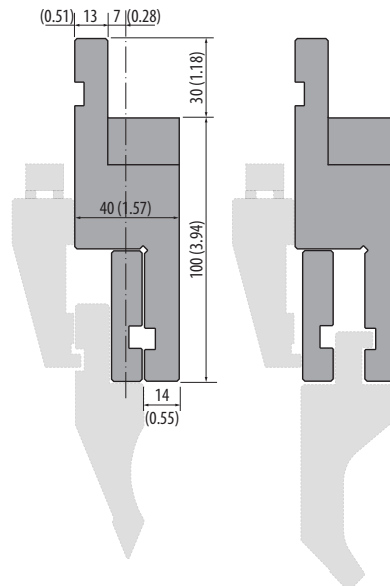

150 mm	5.91 in	3.5 kg
--------	---------	--------

C45: 560-710 N/mm²



suitable Models:

- Manual system (ST60, STL60, STX60 etc.), see page 217
- Fast Clamping (ROL1 Clamp3), see page 218



INT120-40-A

1000 kN/m max.

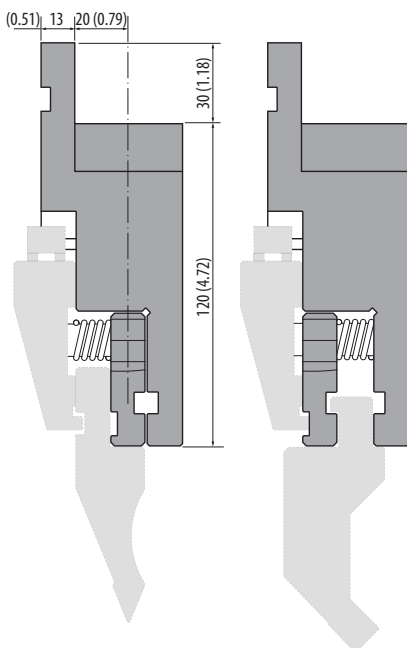

150 mm	5.91 in	6.0 kg
--------	---------	--------

C45: 560-710 N/mm²

suitable Models:

- Manual system (ST60, STL60, STX60 etc.), see page 217
- Fast Clamping (ROL1 Clamp3), see page 218



INT100-A (American)

1000 kN/m max.

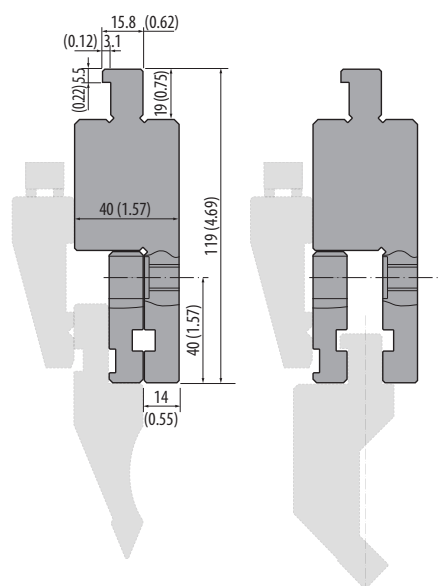

150 mm	5.91 in	3.5 kg
--------	---------	--------

C45: 560-710 N/mm²



suitable Models:

- Manual system (ST60, STL60, STX60 etc.), see page 217
- Fast Clamping (ROL1 Clamp3), see page 218



A

ROLLERI ADAPTERS Bolted Adapters

AW11

1000 kN/m max.

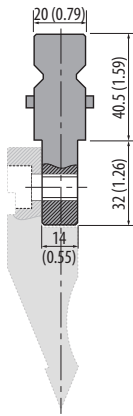

835 mm	32.87 in	3.0 kg
415 mm	16.34 in	1.5 kg
805 mm segmented	31.69 in segmented	2.9 kg

Rolleri Type R2
→ Rolleri Type R1

C45: 560-710 N/mm²



Do you prefer our QuickLock or ROL1-System?
Contact us now!

AW3

1000 kN/m max.

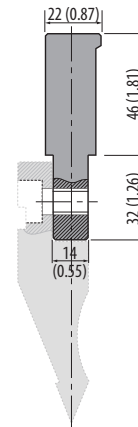

835 mm	32.87 in	9.0 kg
415 mm	16.34 in	4.5 kg
805 mm segmented	31.69 in segmented	8.7 kg

Rolleri Type R3 Beyeler S
→ Rolleri Type R1

C45: 560-710 N/mm²



AW10

1000 kN/m max.

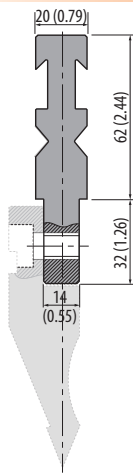

835 mm	32.87 in	10.0 kg
415 mm	16.34 in	5.0 kg
805 mm segmented	31.69 in segmented	9.6 kg

Rolleri Type R3 Beyeler RFA
→ Rolleri Type R1

C45: 560-710 N/mm²



AW12

1000 kN/m max.

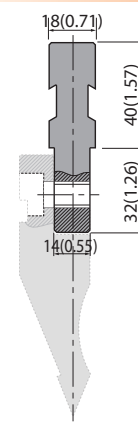

835 mm	32.87 in	7.0 kg
415 mm	16.34 in	3.5 kg
805 mm segmented	31.69 in segmented	6.7 kg

Rolleri Type RX Colgar
→ Rolleri Type R1

C45: 560-710 N/mm²



AW1-A

1000 kN/m max.

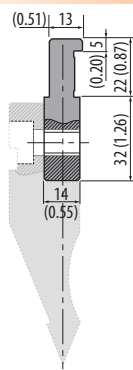

835 mm	32.87 in	4.5 kg
415 mm	16.34 in	2.2 kg
805 mm segmented	31.69 in segmented	4.3 kg

Rolleri Type RX LVD A
→ Rolleri Type R1

C45: 560-710 N/mm²



AW1-B

1000 kN/m max.

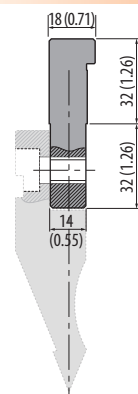

835 mm	32.87 in	6.3 kg
415 mm	16.34 in	3.1 kg
805 mm segmented	31.69 in segmented	6.0 kg

Rolleri Type RX LVD B
→ Rolleri Type R1

C45: 560-710 N/mm²



AW1-C

1000 kN/m max.

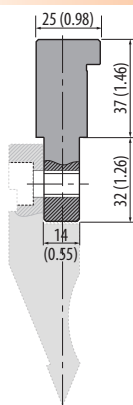

835 mm	32.87 in	9.7 kg
415 mm	16.34 in	4.8 kg
805 mm segmented	31.69 in segmented	9.4 kg

Rolleri Type RX LVD C
→ Rolleri Type R1

C45: 560-710 N/mm²



AW1-D

1000 kN/m max.

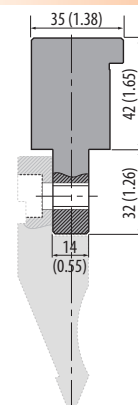

835 mm	32.87 in	11.5 kg
415 mm	16.34 in	5.7 kg
805 mm segmented	31.69 in segmented	11.1 kg

Rolleri Type RX LVD D
→ Rolleri Type R1

C45: 560-710 N/mm²



A

ROLLERI ADAPTERS Bolted Adapters

AW13

1000 kN/m max.

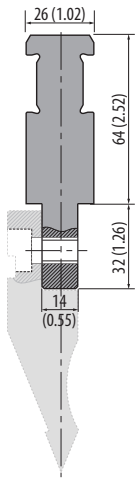

835 mm	32.87 in	12.6 kg
415 mm	16.34 in	6.3 kg
805 mm segmented	31.69 in segmented	12.1 kg

Rolleri Type RX EHT
→ Rolleri Type R1

C45: 560-710 N/mm²



AW14

1000 kN/m max.

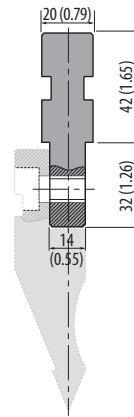

835 mm	32.87 in	8.0 kg
415 mm	16.34 in	4.0 kg
805 mm segmented	31.69 in segmented	7.7 kg

Rolleri Type RX Gasparini
→ Rolleri Type R1

C45: 560-710 N/mm²



AW15

1000 kN/m max.

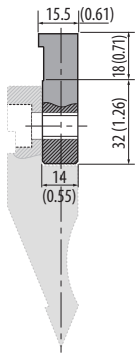

835 mm	32.87 in	4.6 kg
415 mm	16.34 in	2.3 kg
805 mm segmented	31.69 in segmented	4.4 kg

Rolleri Type RX Ajial-Axial
→ Rolleri Type R1

C45: 560-710 N/mm²



AWC16

1000 kN/m max.

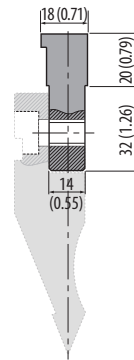

835 mm	32.87 in	5.0 kg
415 mm	16.34 in	2.5 kg
805 mm segmented	31.69 in segmented	4.8 kg

Rolleri Type RX Colly
→ Rolleri Type R1

C45: 560-710 N/mm²



AWC13.5

1000 kN/m max.

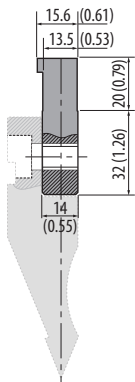

835 mm	32.87 in	4.8 kg
415 mm	16.34 in	2.4 kg
805 mm segmented	31.69 in segmented	4.6 kg

Rolleri Type RX Colly
→ Rolleri Type R1

C45: 560-710 N/mm²



AWX

1000 kN/m max.

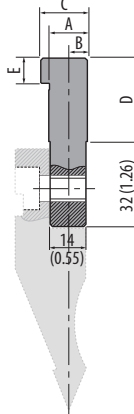

835 mm	32.87 in	3.0 kg
415 mm	16.34 in	1.5 kg
805 mm segmented	31.69 in segmented	3.0 kg

Individual
→ Rolleri Type R1

C45: 560-710 N/mm²



INT35

1000 kN/m max.

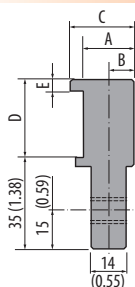

835 mm	32.87 in	4.0 kg
525 mm	20.67 in	2.5 kg
805 mm segmented	31.69 in segmented	3.9 kg

C45: 560-710 N/mm²



INT35-A

1000 kN/m max.

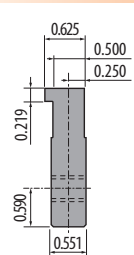

835 mm	32.87 in	5.0 kg
415 mm	16.34 in	2.5 kg
805 mm segmented	31.69 in segmented	4.8 kg

C45: 560-710 N/mm²



Article on stock



Please ask for delivery time!

1 kg = 2.20 Pounds (lb) = 35.27 Ounces (oz)
100 mm = 3.94 Inch (in) = 0.33 Feet (ft)



Articles on stock – Please note that delivery time depends on your location.

A

ROLLERS ADAPTERS Die Holders

C 2000/S / C 2500/S / C 3000/S / C 4000/S

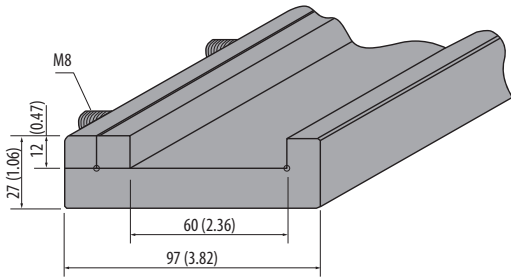

Model	Length (mm)	Length (in)	Weight
C 2000/S	2100	82.68	27.0 kg
C 2500/S	2600	102.36	34.0 kg
C 3000/S	3100	122.05	40.0 kg
C 4000/S	4100	161.42	53.0 kg



C45: 560-710 N/mm²

TC 2000/S / TC 2500/S / TC 3000/S / TC 4000/S

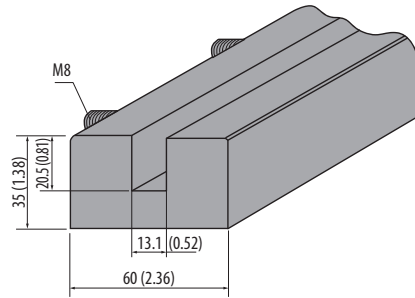

Model	Length (mm)	Length (in)	Weight
TC 2000/S	2100 mm	82.68	30.0 kg
TC 2500/S	2600 mm	102.36	37.0 kg
TC 3000/S	3100 mm	122.05	44.0 kg
TC 4000/S	4100 mm	161.42	59.0 kg



C45: 560-710 N/mm²

C 1050/R

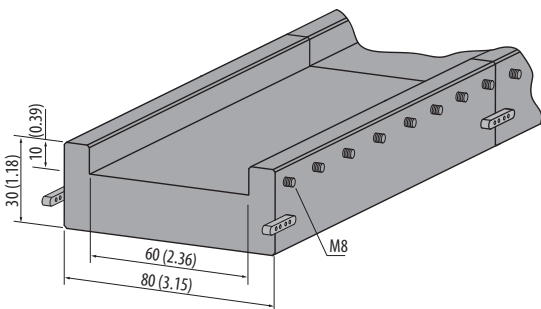

Model	Length (mm)	Length (in)	Weight
C 1050/R	1050	41.34	15.0 kg
C 1050/R/C	520	20.47	7.5 kg



C45: 560-710 N/mm²

C 1050/RS

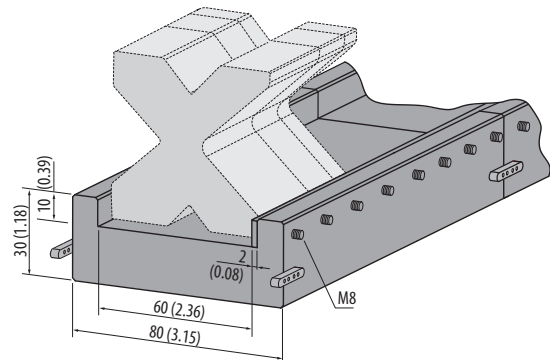

Model	Length (mm)	Length (in)	Weight
C 1050/RS	1050 mm	41.34	15.0 kg
C 1050/RS/C	520 mm	20.47	7.5 kg



C45: 560-710 N/mm²

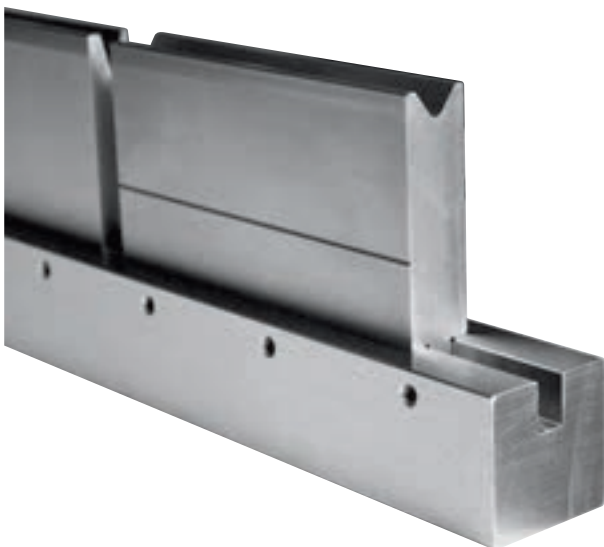

C 1050-90

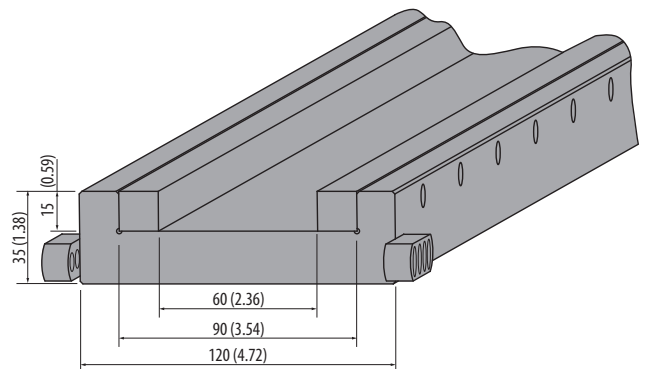

Model	Length (mm)	Length (in)	Weight
C 1050-90	1050	41.34	27.2 kg
C 1050-90/C	520	20.47	13.5 kg



C45: 560-710 N/mm²

AD6

1000 kN/m max.

1000 mm	39.37 in	12.0 kg
500 mm	19.68 in	6.0 kg

Rolleri Type R1
→ Rolleri Type R2/R3

C45: 560-710 N/mm²

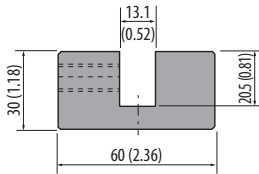

AD6 Example of Application

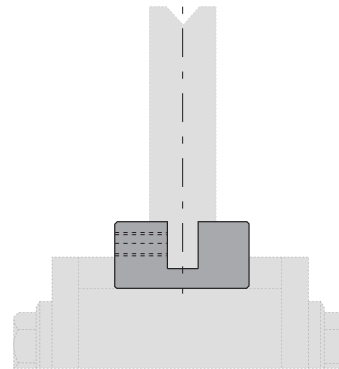

AD5

1000 kN/m max.

1000 mm	39.37 in	26.1 kg
500 mm	19.68 in	13.0 kg

Rolleri Type R1
→ Rolleri Type R2/R3

C45: 560-710 N/mm²

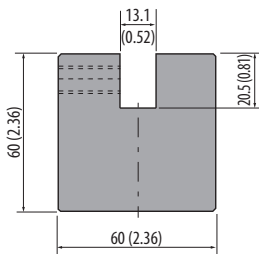

AD5 Example of Application



AD7

1000 kN/m max.

835 mm	32.87 in	18.0 kg
415 mm	16.34 in	9.0 kg

Rolleri Type R2/R3
→ Rolleri Type R1

C45: 560-710 N/mm²

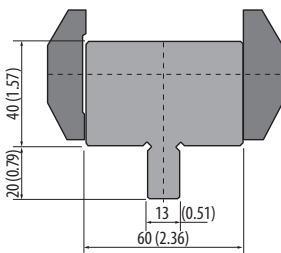

AD7 Example of Application

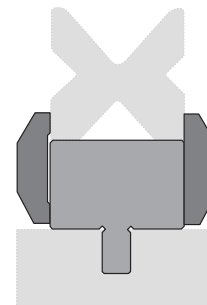

AD24

1000 kN/m max.

835 mm	32.87 in	28.5 kg
415 mm	16.34 in	14.2 kg

Rolleri Type RX EHT
→ Rolleri Type R1

C45: 560-710 N/mm²

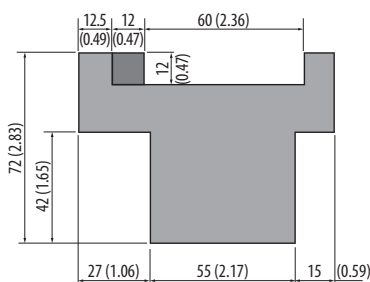

AD24 Example of Application

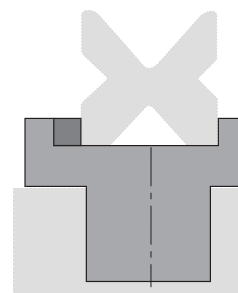

Article on stock



Please ask for delivery time!

1 kg = 2.20 Pounds (lb) = 35.27 Ounces (oz)
100 mm = 3.94 Inch (in) = 0.33 Feet (ft)



Articles on stock – Please note that delivery time depends on your location.

A

ROLLERI ADAPTERS Die Adapter

AD25

1000 kN/m max.

500 mm	19.68 in	7.5 kg
--------	----------	--------

Rolleri Type RX EHT
→ Rolleri Type R2/R3

C45: 560-710 N/mm²

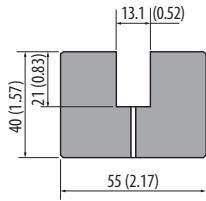

AD25 Example of Application

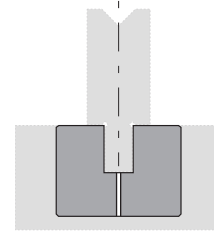

AD9-12.7

1000 kN/m max.

835 mm	32.87 in	17.0 kg
415 mm	16.34 in	8.5 kg

Rolleri Type RX LVD
→ Rolleri Type R1

C45: 560-710 N/mm²

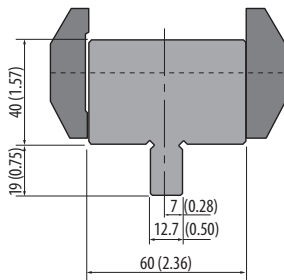

AD9-12.7 Example of Application

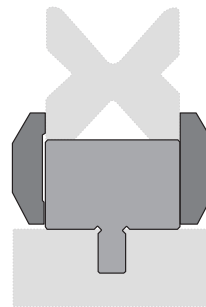

AD8-12.7

1000 kN/m max.

1000 mm	39.37 in	15.0 kg
500 mm	19.68 in	7.5 kg

Rolleri Type RX LVD
→ Rolleri Type R2/R3

C45: 560-710 N/mm²

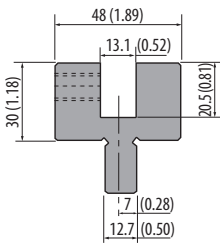

AD8-12.7 Example of Application

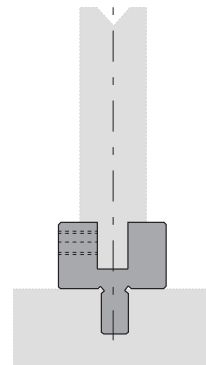

AD26

1000 kN/m max.

835 mm	32.87 in	23.0 kg
415 mm	16.34 in	11.4 kg

Rolleri Type RX
Weinbrenner
→ Rolleri Type R1

C45: 560-710 N/mm²

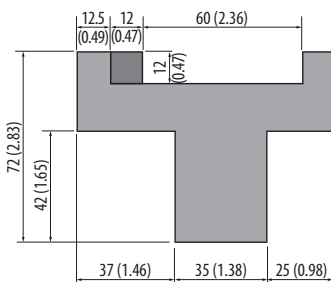

AD26 Example of Application

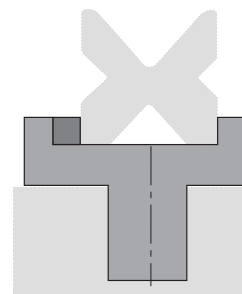

AD27

1000 kN/m max.

500 mm	19.68 in	4.5 kg
--------	----------	--------

Rolleri Type RX
Weinbrenner
→ Rolleri Type R2/R3

C45: 560-710 N/mm²

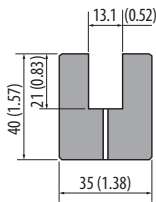

AD27 Example of Application

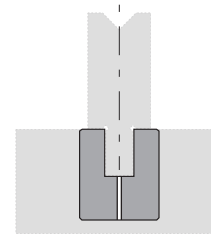

AD17

1000 kN/m max.

835 mm	32.87 in	18.0 kg
415 mm	16.34 in	9.0 kg

Type American
→ Rolleri Type R1

C45: 560-710 N/mm²

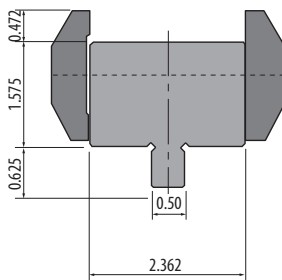

AD17 Example of Application

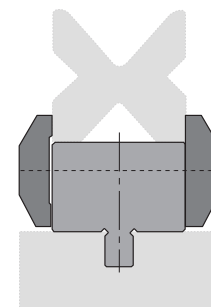

AD18

1000 kN/m max.

835 mm	32.87 in	18.0 kg
415 mm	16.34 in	9.0 kg

Type American
→ Rolleri Type R1

C45: 560-710 N/mm²

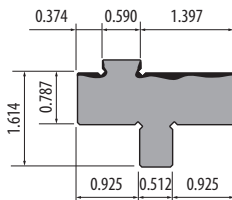

AD18 Example of Application



Modification: bar

To use Rolleri Type R1 dies in other press brakes, a 10 mm (0.39 in) groove is milled where a ground bar is mounted.

Wedge Bar (W x H)	System
13 x 30 mm (0.51 x 1.18 in)	Rolleri Type R2 and R3 (Bystronic-Beyeler/Safan/Trumpf etc.)
55 x 55 mm (2.17 x 2.17 in)	Rolleri Type RX EHT
12.7 x 29 mm (0.50 x 1.14 in)	Rolleri Type RX LVD
35 x 55 mm (1.38 x 2.17 in)	Rolleri Type RX Weinbrenner

Specific information and prices are found in the Rolleri Modifications Chapter (see page 268)

Mounting example

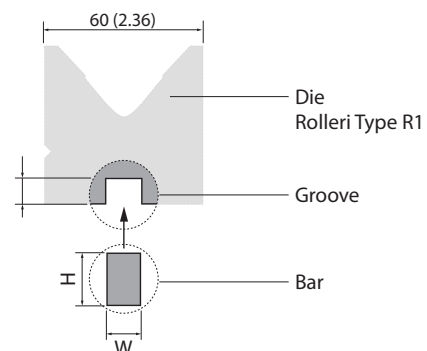

Article on stock



Please ask for delivery time!

1 kg = 2.20 Pounds (lb) = 35.27 Ounces (oz)
100 mm = 3.94 Inch (in) = 0.33 Feet (ft)



Articles on stock – Please note that delivery time depends on your location.