



# Declaration of Performance

Identification Code: **VW3-060-STST**

Meeting the requirements of Annex **ZA, EN 845-3:2003+A1:2008 Bed Joint Reinforcement defined in 4.2.2 of the standard**

## Description of Use:

For structural use in walls and partitions.

### Testing Body:

Lucideon Ltd  
Queens Road  
Penkull  
Stoke on Trent  
ST4 7LQ

### Notification Body No:

1289

### Performance:

<b>Length:</b>	2700mm +/- 1.5%
<b>Width:</b>	60mm +/- 5mm
<b>Profile Height:</b>	3.5mm +/- 0.4mm
<b>Longitudinal Wire size:</b>	3.0mm +/- 0.1mm
<b>Cross Wire Size:</b>	2.5mm +/- 0.1mm
<b>Pitch of Cross Wires:</b>	450mm +/- 3.0%
<b>Characteristic Yield Strength of Longitudinal Wires:</b>	500N/mm <sup>2</sup>
<b>Characteristic Yield Strength of Cross Wires:</b>	500N/mm <sup>2</sup>
<b>Bond Strength:</b>	3060N
<b>Lap Length:</b>	225mm
<b>Shear Load Capacity Welds:</b>	2988N
<b>Ductility:</b>	Normal
<b>Durability-Material Coating Reference:</b>	R3 (Stainless Steel)
<b>Dangerous Substances:</b>	None

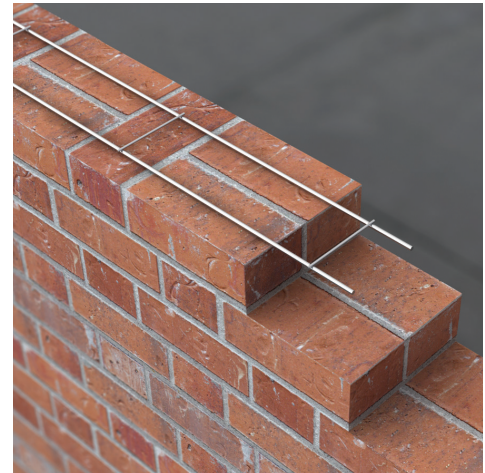

Authorised Signature:

Philip Travis, Managing Director  
3<sup>rd</sup> June 2013