

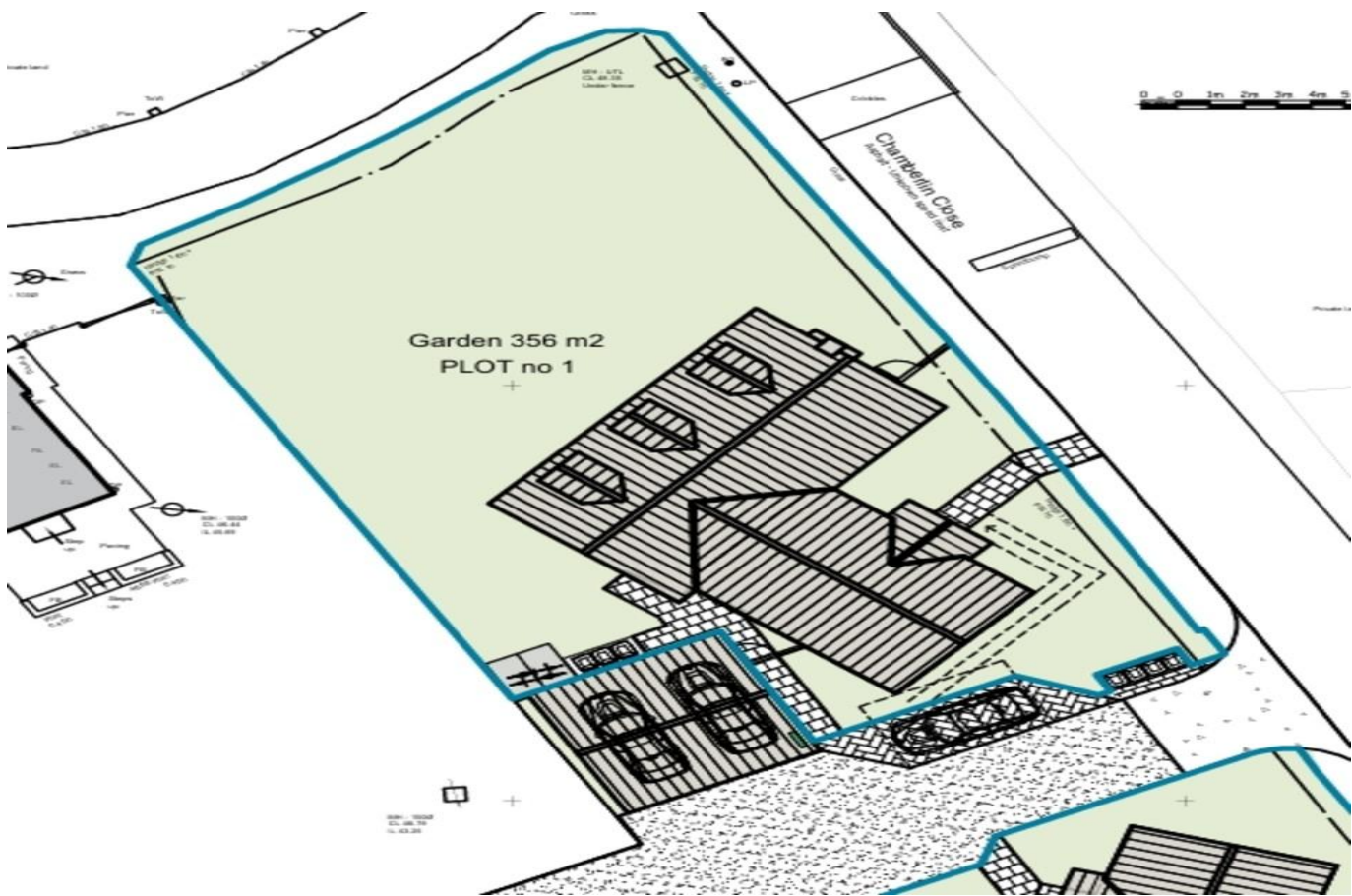

Jackson & Co



Chamberlin Close

Bildeston, Ipswich, Suffolk, IP7 7EZ

£750,000

Brand new build, unique chalet bungalow, superbly designed by a highly regarded local developer with energy efficiency at the forefront of their design, boasting top-of-the-range fixtures and fittings throughout

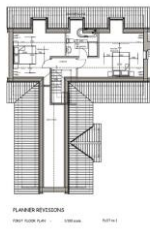

Property Features

- New build, unique chalet bungalow style property
- Detached car port and abundance of parking
- Spacious ground floor accomodation
- Two bedrooms benefitting from ensuite bathrooms
- Circa 2,000 square foot of accomodation
- Local well regarded developer
- Close to the village centre and local amenities
- Ground floor underfloor heating
- Top of the range kitchen with built in appliances
- 10 year warranty

FULL DESCRIPTION

****THIS PROPERTY IS UNDER CONSTRUCTION, THE PHOTOS USED ARE CGI/ARCHITECT DRAWINGS AND PREVIOUS LIKE FOR LIKE BUILD EXAMPLES****

Nestled on Chamberlin Close in the desirable village of Bildeston, this detached chalet bungalow offers a blend of modern luxury and scenic tranquillity. Boasting 3/4 bedrooms and 3 bathrooms.

The ground floor of this property boasts an array of features including Bedroom Two with an ensuite, the Family Bathroom, Study/Bedroom Four, a spacious Living Room,

top-of-the-range Kitchen/Breakfast Room with modern appliances additionally benefitting from an island, there is also a utility room with plant room.

The first floor hosts the Master Bedroom with an ensuite bathroom, Bedroom Three, both benefitting from dormer windows that offer stunning views of the surrounding Suffolk countryside.

Set on a substantial plot, the property features a well-maintained wrap around garden, a parking space and double car port with access to the rear garden.

Agents notes:- ** This property is being built and is due to be complete mid 2026** - Photos are CGI generated and offer a like for like comparison to the finished designs. For more information, please contact the office.

Tenure: Freehold

Council Tax Band: TBC

Services: Mains Water & Electric

Heating: Energy Source Heat Pump







Jackson & Co Bury St
Edmunds

www.jacksonandcocomcoveringsuffolk.co.uk
contact@jackson-ps.co.uk
01284 598 030

Agents Note: Whilst every care has been taken to prepare these particulars, they are for guidance purposes only. All measurements are approximate are for general guidance purposes only and whilst every care has been taken to ensure their accuracy, they should not be relied upon and potential buyers/tenants are advised to recheck the measurements