



## Sloeberry Road

Ipswich, IP3

O.I.E.O £155,000

Don't Miss Out!

This modern apartment in Ravenswood offers the perfect blend of comfort, style, and convenience. Whether you are a first-time buyer or an investor, seize this fantastic opportunity to make this impressive space your own! Schedule your viewing today and experience firsthand all that this amazing property has to offer.





# Property Features

- Two bedrooms ●
- Allocated parking ●
- Newly fitted kitchen ●
- Newly fitted bathroom ●
- Must be viewed ●

## Full Description

### DESCRIPTION

Discover Your Dream Home in Ravenswood!

Welcome to this stylish and modern two-bedroom apartment, nestled on the second floor of a sought-after development in the vibrant Ravenswood area, just southeast of Ipswich. With its allocated parking space, this delightful residence promises both comfort and convenience, making it the ideal choice for contemporary living.

#### Location, Location, Location!

Enjoy quick and easy access to the A12 and A14, ensuring your commuting worries are a thing of the past. You'll appreciate the nearby local shopping parade, featuring everything you need from a well-stocked gym to renowned retailers like John Lewis/Waitrose, Sainsbury's, and Lidl-perfect for all your daily errands and indulgences!

#### Stylish Living Spaces

Step inside and be greeted by a welcoming communal entrance hall that leads you up to your new home. Once inside, you'll find new flooring throughout, shining with modern elegance. The cleverly designed hall offers seamless access to all rooms, maximizing space and functionality.

The spacious dual-aspect sitting/dining room bathed in natural light invites you to unwind, while creating an ideal setting for gatherings with friends and family. The contemporary kitchen is complete with an array of stylish base and eye-level units, generous work surfaces, and the latest appliances, including a brand-new electric hob and oven-perfect for culinary adventures!

#### Comfortable Bedrooms and Modern Bathing

Retreat to your serene bedrooms, where the second bedroom features a window overlooking the front, offering a cozy space for guests or a home office. The main bedroom, adorned with windows on both the front and side, provides an abundance of light.

The elegant bathroom complements this delightful home with its chic suite, featuring a bathtub with a shower overhead, a basin, and a W/C, all designed to cater to your everyday needs.

### AGENTS NOTES

For leasehold information please contact the agent





## GROUND FLOOR

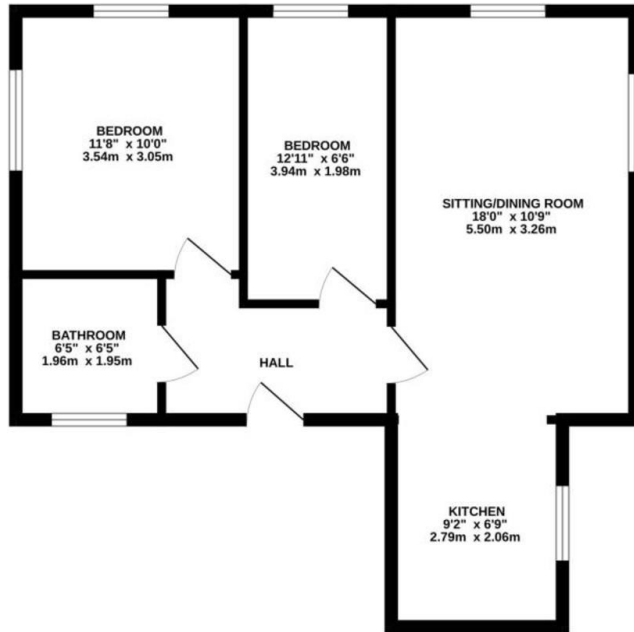

Whilst every attempt has been made to ensure the accuracy of the floorplan contained here, measurements of doors, windows, rooms and any other items are approximate and no responsibility is taken for any error, omission or mis-statement. This plan is for illustrative purposes only and should be used as such by any prospective purchaser. The services, systems and appliances shown have not been tested and no guarantee as to their operability or efficiency can be given.  
Made with Metaplan (2020)

Jackson & Co  
43 Basepoint  
70-72 The Havens  
Ransomes Euro Park  
IP3 9BF

[www.jackson-ps.co.uk](http://www.jackson-ps.co.uk)  
[contact@jackson-ps.co.uk](mailto:contact@jackson-ps.co.uk)  
01473 722981

Agents Note: Whilst every care has been taken to prepare these particulars, they are for guidance purposes only. All measurements are approximate are for general guidance purposes only and whilst every care has been taken to ensure their accuracy, they should not be relied upon and potential buyers/tenants are advised to recheck the measurements