

Pride in Our Past Building Our Future

GAMMA LAMBDA CHAPTER OF PI KAPPA PHI



MISSOURI UNIVERSITY OF SCIENCE & TECHNOLOGY



PRIDE IN OUR PAST: THE STORY OF GAMMA LAMBDA



Pi Kappa Phi is a first-class fraternity whose members believe firmly in the tenets of Character, Leadership, Academics, Sportsmanship, and Service. For 55 years, our chapter has been committed and dedicated to living out Pi Kappa Phi values in Rolla. We act with kindness, humility, and compassion toward everyone in our brotherhood.

We have a unique opportunity in front of us to rebuild our presence on campus and make our brotherhood even stronger. Gamma Lambda has always stayed true to its roots while instilling the same value from Pi Kappa Phi. Now is the time to develop the next generation of Gamma Lambdas who will not only push themselves as leaders but also push the entire brotherhood to ensure their future for the next 55 years.

Gamma Lambda created an experience for members that couldn't be taught in the classroom. *"It was a leadership-changing experience for me. I wouldn't have acquired the leadership skills I have now if it wasn't for Gamma Lambda."* –1980s alumnus

A TRANSFORMATIONAL EXPERIENCE

Fraternities empower students and provide a strong support system.

Members experience **greater gains in learning and graduate at higher rates** than their peers.

Brothers are **more connected** to their local communities, and they spend **more time volunteering** than nonaffiliated students.

Members are **more academically engaged** than their peers.

When members **seek help**, they are **twice as likely to turn to a brother** than anyone else.

83% of members say their confidence in their **leadership skills increased** because of their membership.



**RESEARCH
PROVES OUR
MISSION IS
IMPORTANT**

A COMPETITIVE ENVIRONMENT

Our house on Pine Street is falling behind when compared to other facilities on campus and concerning what appeals to the modern-day college student. The foundation has become unstable and the amenities outdated. To ensure the future of Gamma Lambda, we must rebuild our house to provide a new sense of growth and opportunity.

Other fraternities and campus housing over the last 10 years have gone through their own renovations and rebuilds:

Fraternity Housing



Kappa Sigma



Lambda Chi Alpha



Sigma Phi Epsilon

Missouri S&T Housing



“Every alumnus knows the importance of a new house. This project has been in mind since the original members bought the old house. The house is in bad enough shape that the active brothers do not have the manpower or finances to keep up with maintenance. We have enough alumni to be able to support a project AND have the financial support from National.”

–Chris Steger, GL 168

University Commons (built in 2016)

Apartment-style, 450-bed facility that houses students in primarily eight-person apartments. Each apartment has four bedrooms, a living room, a full kitchen, and two bathrooms. The building also utilizes the latest security technology by providing access to rooms through the Student ID card.

Residential Commons (2005 and 2007)

Houses 550 students while offering single deluxe rooms and double deluxe rooms with similar suite-style living to University Commons.



BUILDING OUR FUTURE

The Gamma Lambda committee has developed a plan to address the long-term viability of the Gamma Lambda experience on the Missouri S&T campaign. Through careful study and planning, it had been determined that rebuilding of the chapter house will allow for the following:



A house conducive for academic excellence.



A central hub for all brotherhood activities.



A tool for fostering an increase in recruitment.

**PROJECT
COST:
\$1 MILLION**

Alumni fundraising
\$600,000

Pi Kappa Phi
Properties*: Housing
Investment Fund,
cash provided, and
funds from a lender
\$400,000

**Subject to Pi Kappa Phi
Properties Board approval*

FEATURES OF THE NEW HOUSE:

- Single rooms
- House capacity of 15 to allow for junior and senior members to live out
- Large common areas for all chapter activities
- Study room
- Engineering lab
- Off-street parking behind the house on Elm Street
- Dedicated, secure space to display history of Gamma Lambda Chapter and alumni
- Kitchen and dining area for serving meals to all in-house and out-of-house members

*“This is a life-or-death project for the chapter.
We need to update, and this is a step in the right direction.”*

–1980s alumnus

FLOOR PLANS

Lower Level

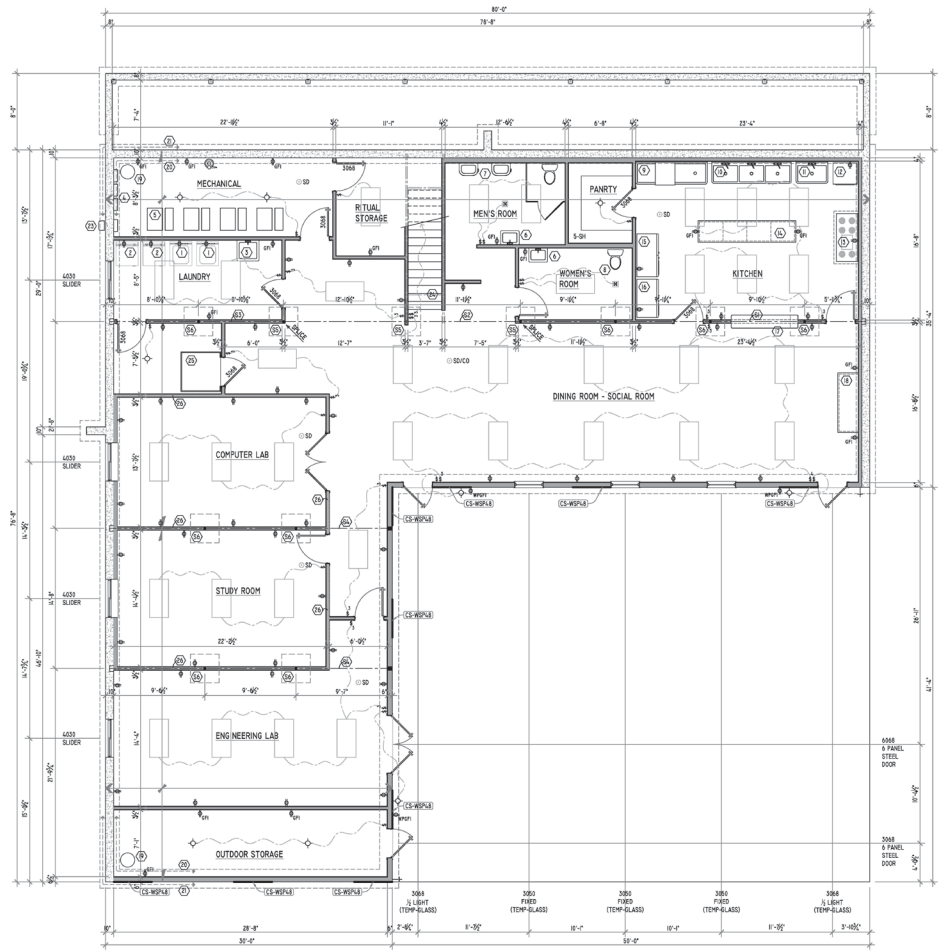

First Floor

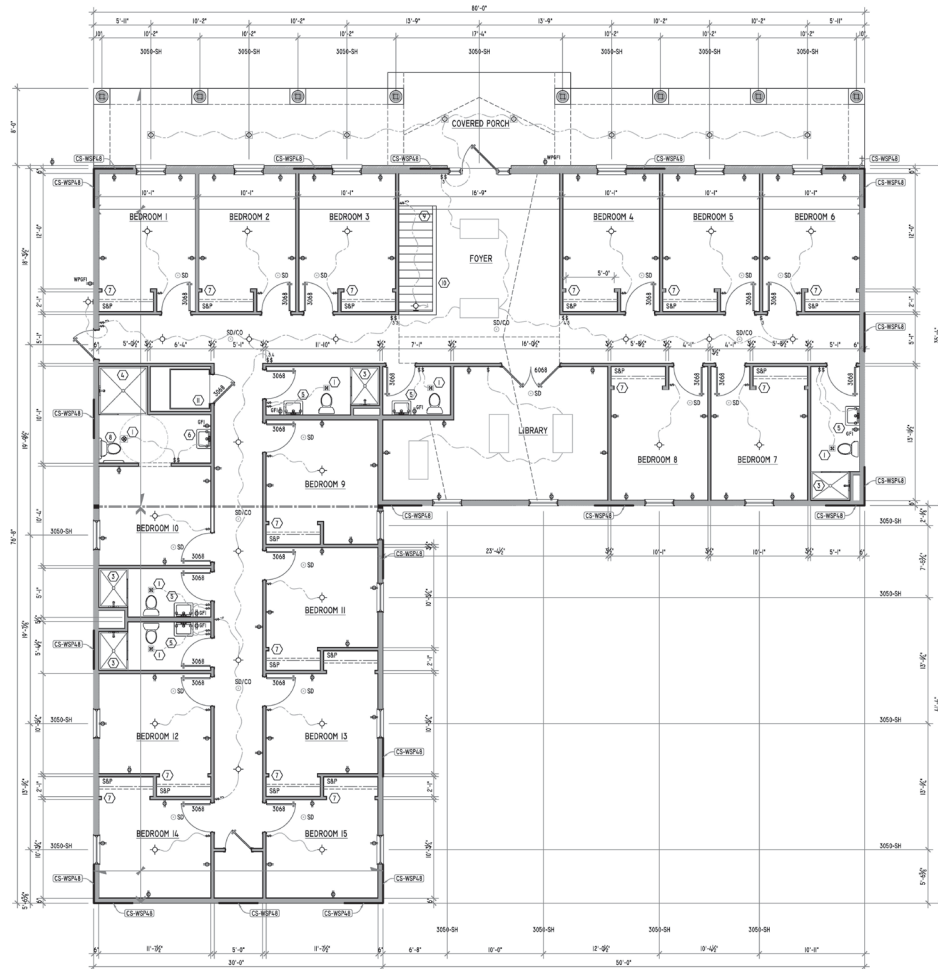



Every generation faces its unique set of challenges. Among other trials, today's generation has so many resources at their fingertips that it can be overwhelming. We ask you, as a distinguished alumnus, to help guide and support our undergraduate brothers in fostering and navigating these resources; help them continue to improve the academic success of Pi Kappa Phi at Missouri S&T and engage in our meaningful brotherhood while pursuing the betterment of the community around them.

AN ALUMNI EFFORT

"I believe in the future of Gamma Lambda and want to be a part of its future as I was of its past. I had the privilege of being the first Archon of Gamma Lambda Chapter, and I want to continue to provide to future engineers what the chapter provided me."

—Joe McBride, GL 17

GIVING LEVELS

Phi Beta Iota Society
\$75,000 and above

The 1968 Society
\$50,000 to \$74,999

Gamma Lambda Society
\$25,000 to \$49,999

Pine Street Society
\$15,000 to \$24,999

St. Patrick's Society
\$10,000 to \$14,999

White and Gold Society
\$5,000 to \$9,999

Alex's Pizza Society
\$2,500 to \$4,999

Help us continue our legacy by donating today!

WAYS TO GIVE:

GIFTS OF SECURITIES _____

A contribution of appreciated securities may be an excellent way to support the campaign. The donor of appreciated securities to a 501(c)(3) will not ordinarily be subject to capital gains tax on the appreciated value of the gift. Please consult your tax advisor for potentially significant tax advantages.

REQUIRED MINIMUM DISTRIBUTIONS (RMDS) _____

Alumni 72 years or older have the opportunity to donate their required minimum distribution to support Gamma Lambda Chapter. Please consult your tax advisor for potentially significant tax advantages.

MATCHING GIFTS _____

If your employer offers a matching gift program, you may be able to double your contribution to the Pi Kappa Phi Foundation.

If you have questions or would like to make a gift via any of the above options, please contact our campaign coordinator at (785) 843-1661.

RECOGNITION:

Donors of \$2,500 and above will be recognized in the appropriate giving categories in all campaign publications, unless otherwise requested by donor.



Joe McBride, GL 17 – Campaign Chairman
Bob Bentzinger, GL 29
Don Bingaman, GL 62
Gerald Loomstein, GL 141
Anthony Holmes, GL 151
Chris Steger, GL 168
Derek Dillinger, GL 380

If you are looking to learn more about
volunteering, please contact our campaign
coordinator at (785) 843-1661.