

PROJECT DESCRIPTION

PETERSBURG INDIAN ASSOCIATION IS PLANNING TO CONSTRUCT SIDEWALKS AND STORM SEWERS ALONG 12TH STREET, HOWKAN STREET AND 13TH STREET. THE PROJECT WILL BE IN THREE PARTS: BASE BID, ADDITIVE ITEM #1 & ADDITIVE ITEM #2.

SHEET INDEX

Sheet 1	Title Page
Sheet 2	Bid Items
Sheet 3	Project Quantities
Sheet 4	Plan View - 12 th Street
Sheet 5	Plan View - Howkan St.
Sheet 6	Plan View - 13 th Street
Sheet 7	Tables - Storm Sewer
Sheet 8	Tables - Signs & Ramps
Sheet 9	Typical Roadway Improvements
Sheet 10	Curb Details
Sheet 11	Joint & Tile Detail
Sheet 12	Curb & Gutter, Sidewalk Details
Sheet 13	Storm Sewer & Rockwall Details
Sheet 14	Ramp & Apron Details
Sheet 15	Project Survey Control
Sheet 16	Curb & Gutter Layout - 12 th St.
Sheet 17	Curb & Gutter Layout - Howkan St.
Sheet 18	Curb & Gutter Layout - 13 th St.
Sheet 19	Storm Drain Details - 12 th Street
Sheet 20	Storm Drain Details - Howkan St.
Sheet 21	Storm Drain Details - 13 th Street
Sheet 22	Traffic Control

DRAWING:
Title Page

PROJECT:
12th, 13th & Howkan St. Sidewalk Project
Location
~PETERSBURG, ALASKA~

PETERSBURG INDIAN ASSOCIATION
P.O. BOX 1418, PETERSBURG, AK. 99833
(907) 772-3636

REVISIONS

REV	DATE	DESCRIPTION

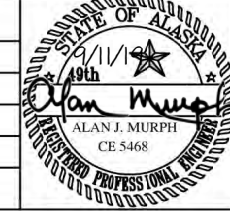

DESIGNED BY:
HARAI & ASSOCIATES, INC
P.O. BOX 625, PETERSBURG, ALASKA 99833
DATE: FEBRUARY, 2019

SHEET NUMBER 1	TOTAL SHEETS 22
-------------------	--------------------

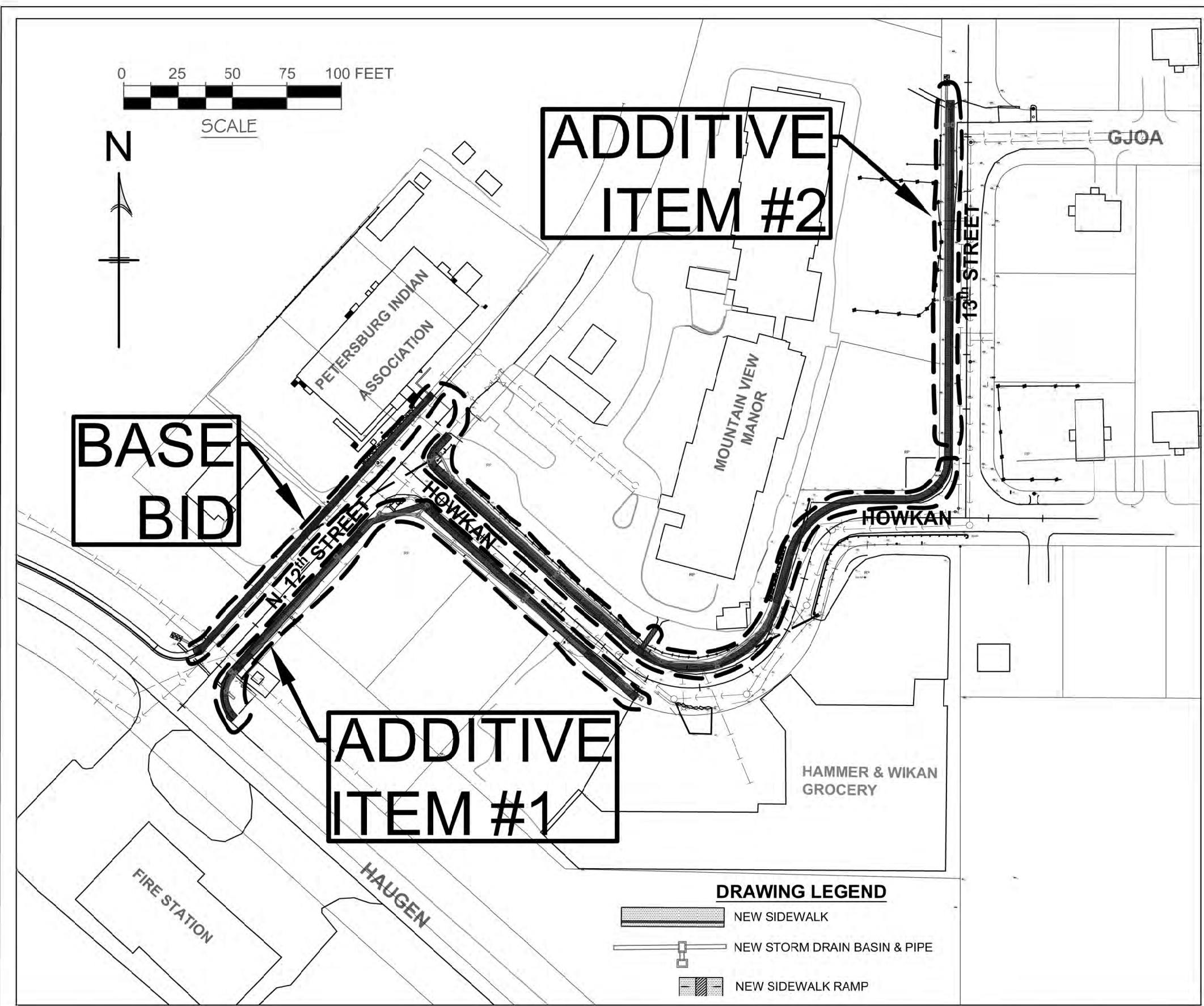

PROJECT DESCRIPTION

PETERSBURG INDIAN ASSOCIATION IS SEEKING A CONTRACTOR TO BUILD SIDEWALKS, CURB, GUTTERS AND STORM SEWERS ALONG TWELFTH STREET, HOWKAN STREET AND THIRTEENTH STREET.

THE CONSTRUCTION PROJECT BID WILL BE THREE PARTS (BASE BID, ADDITIVE ITEM #1, ADDITIVE ITEM #2) THE BID WILL BE AWARDED WITH BASE BID ALONE OR BASE BID WITH A COMBINATION OF BID ITEMS, EITHER ITEM OR BOTH.

LISTED IS A ABBREVIATED SUMMARY OF THE BASE BID AND THE ITEMS:

BASE BID - CONSTRUCT SIDEWALKS, CURB, GUTTERS, STORM DRAINS AND DRAINAGE STRUCTURE ALONG ALL THE LEFT SIDE OF 12TH STREET, RIGHT SIDE OF 12TH STREET FROM STATION 10+00 TO 11+00, ALL THE LEFT SIDE OF HOWKAN STREET, 13TH STREET LEFT SIDE STATION 10+00 TO 10+55. THIS INCLUDES ALL ASSOCIATED ITEMS; PAVEMENT PATCHING, SIGN PLACEMENT, TRAFFIC CONTROL, ECT.

ADDITIVE ITEM #1 - CONSTRUCT SIDEWALKS, CURB, GUTTERS, STORM DRAINS AND DRAINAGE STRUCTURE ALONG ALL THE RIGHT SIDE OF 12TH STREET, RIGHT SIDE OF HOWKAN STREET. THIS INCLUDES ALL ASSOCIATED ITEMS; PAVEMENT PATCHING, SIGN PLACEMENT, TRAFFIC CONTROL, ECT.

ADDITIVE ITEM #2 - CONSTRUCT SIDEWALKS, CURB, GUTTERS, STORM DRAINS AND DRAINAGE STRUCTURE ALONG ALL THE LEFT SIDE OF 13TH STREET STATION 10+55 TO 14+00. THIS INCLUDES ALL ASSOCIATED ITEMS; PAVEMENT PATCHING, SIGN PLACEMENT, TRAFFIC CONTROL, ECT.

DRAWING LEGEND

- NEW SIDEWALK
- NEW STORM DRAIN BASIN & PIPE
- NEW SIDEWALK RAMP

DRAWING:
Contract Bid Items

PROJECT:
12th, 13th & Howkan St. Sidewalk Project
Location
~PETERSBURG, ALASKA~

PETERSBURG INDIAN ASSOCIATION
P.O. BOX 1418, PETERSBURG, AK. 99833
(907) 772-3636

REVISIONS		
REV	DATE	DESCRIPTION

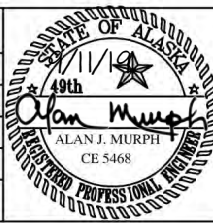

DESIGNED BY:
HARAI & ASSOCIATES, INC
P.O. BOX 625, PETERSBURG, ALASKA 99833

DATE: FEBRUARY, 2019

SHEET NUMBER 2	TOTAL SHEETS 22
-------------------	--------------------

ESTIMATE OF QUANTITIES (BASE BID)			
ITEM NO.	ITEM DESCRIPTION	PAY UNIT	QUANTITY
1510.1	MOBILIZATION	LUMP SUM	ALL REQUIRED
2004.1	CLEARING & GRUBBING	LUMP SUM	ALL REQUIRED
2010.1	EXCAVATION	LUMP SUM	ALL REQUIRED
2021.1	EMBANKMENT - 3" MINUS SHOT ROCK	LUMP SUM	ALL REQUIRED
2022.1	BASE COURSE - 3/4" MINUS GRAVEL	LUMP SUM	ALL REQUIRED
3002.1	CURB & GUTTER	LINEAR FOOT	1013
3002.2	DEPRESSED CURB & GUTTER	EACH	2
3003.1	6" CONCRETE SIDEWALK - 4' WIDE	LINEAR FOOT	325
3003.2	6" CONCRETE SIDEWALK - 5' WIDE	LINEAR FOOT	713
3003.3	CONCRETE SIDEWALK APRON	EACH	5
3004.1	CURB RAMP	EACH	5
3012.1	CONCRETE PAVEMENT PATCH	LINEAR FOOT	1070
5505.1	CATCH BASIN - TYPE "A"	EACH	16
5520.1	18" Ø CORRIGATED POLYETHYLENE PIPE	LINEAR FOOT	692
5520.2	24" Ø CORRIGATED POLYETHYLENE PIPE	LINEAR FOOT	18
6502.1	CONSTRUCTION SURVEYING	LUMP SUM	ALL REQUIRED
7011.1	SIGN REMOVAL & INSTALLATION	EACH	11
7021.1	ROCKWALL	LINEAR FOOT	120
7026.1	TRAFFIC MAINTENANCE & FLAGGING	LUMP SUM	ALL REQUIRED
7030.1	EROSION & SEDIMENT CONTROL	LUMP SUM	ALL REQUIRED

BASE BID - ALL THE LEFT SIDE OF 12TH STREET, THE RIGHT SIDE OF 12TH STREET FROM STATION 10+00 TO 11+00 AND ALL THE LEFT SIDE OF HOWKAN STREET, 13TH STREET LEFT SIDE FROM STATION 10+00 TO 10+55.

ESTIMATE OF QUANTITIES (ADDITIVE ITEM #1)			
ITEM NO.	ITEM DESCRIPTION	PAY UNIT	QUANTITY
1510.1	MOBILIZATION	LUMP SUM	ALL REQUIRED
2004.1	CLEARING & GRUBBING	LUMP SUM	ALL REQUIRED
2010.1	EXCAVATION	LUMP SUM	ALL REQUIRED
2021.1	EMBANKMENT - 3" MINUS SHOT ROCK	LUMP SUM	ALL REQUIRED
2022.1	BASE COURSE - 3/4" MINUS GRAVEL	LUMP SUM	ALL REQUIRED
3002.1	CURB & GUTTER	LINEAR FOOT	504
3002.2	DEPRESSED CURB & GUTTER	EACH	2
3003.1	6" CONCRETE SIDEWALK - 4' WIDE	LINEAR FOOT	0
3003.2	6" CONCRETE SIDEWALK - 5' WIDE	LINEAR FOOT	555
3003.3	CONCRETE SIDEWALK APRON	EACH	3
3004.1	CURB RAMP	EACH	5
3012.1	CONCRETE PAVEMENT PATCH	LINEAR FOOT	504
5505.1	CATCH BASIN - TYPE "A"	EACH	12
5520.1	18" Ø CORRIGATED POLYETHYLENE PIPE	LINEAR FOOT	531
5520.2	24" Ø CORRIGATED POLYETHYLENE PIPE	LINEAR FOOT	10
6502.1	CONSTRUCTION SURVEYING	LUMP SUM	ALL REQUIRED
7011.1	SIGN REMOVAL & INSTALLATION	EACH	3
7026.1	TRAFFIC MAINTENANCE & FLAGGING	LUMP SUM	ALL REQUIRED
7030.1	EROSION & SEDIMENT CONTROL	LUMP SUM	ALL REQUIRED

ADDITIVE ITEM #1 - ALL OF THE RIGHT SIDE OF 12TH STREET AND THE RIGHT SIDE OF HOWKAN STREET.

ESTIMATE OF QUANTITIES (ADDITIVE ITEM #2)			
ITEM NO.	ITEM DESCRIPTION	PAY UNIT	QUANTITY
1510.1	MOBILIZATION	LUMP SUM	ALL REQUIRED
2004.1	CLEARING & GRUBBING	LUMP SUM	ALL REQUIRED
2010.1	EXCAVATION	LUMP SUM	ALL REQUIRED
2021.1	EMBANKMENT - 3" MINUS SHOT ROCK	LUMP SUM	ALL REQUIRED
2022.1	BASE COURSE - 3/4" MINUS GRAVEL	LUMP SUM	ALL REQUIRED
3002.1	CURB & GUTTER	LINEAR FOOT	328
3002.2	DEPRESSED CURB & GUTTER	EACH	0
3003.1	6" CONCRETE SIDEWALK - 4' WIDE	LINEAR FOOT	0
3003.2	6" CONCRETE SIDEWALK - 5' WIDE	LINEAR FOOT	328
3003.3	CONCRETE SIDEWALK APRON	EACH	2
3004.1	CURB RAMP	EACH	1
3012.1	CONCRETE PAVEMENT PATCH	LINEAR FOOT	328
5505.1	CATCH BASIN - TYPE "A"	EACH	4
5520.1	18" Ø CORRIGATED POLYETHYLENE PIPE	LINEAR FOOT	200
5520.2	24" Ø CORRIGATED POLYETHYLENE PIPE	LINEAR FOOT	0
6502.1	CONSTRUCTION SURVEYING	LUMP SUM	ALL REQUIRED
7011.1	SIGN REMOVAL & INSTALLATION	EACH	2
7026.1	TRAFFIC MAINTENANCE & FLAGGING	LUMP SUM	ALL REQUIRED
7030.1	EROSION & SEDIMENT CONTROL	LUMP SUM	ALL REQUIRED

ADDITIVE ITEM #2 - ALL OF THE LEFT SIDE OF 13TH STREET FROM STATION 10+55 TO 14+00.

GENERAL NOTES

1. PETERSBURG BOROUGH STANDARD SPECIFICATIONS ~ 2012, APPLIES TO THESE PLANS AND SPECIFICATIONS. PETERSBURG INDIAN ASSOCIATION WILL BE THE ADMINISTRATIVE AUTHORITY NOT PETERSBURG BOROUGH.
2. THE CONTRACTOR WILL FURNISH TO THE ENGINEER A WORK PLAN THAT DETAILS CONSTRUCTION DATES, TRAFFIC AND SAFETY PLANS. CONTRACTOR WILL ALSO FURNISH TO THE ENGINEER MATERIAL CERTIFICATION SHEETS TO SHOW THAT ALL MATERIAL USED IN THIS PROJECT MEETS THE SPECIFICATIONS OF THESE PLANS AND PETERSBURG ENGINEER STANDARD SPECIFICATIONS ~ 2012.
3. SAFETY AND PUBLIC ACCESS. CONTRACTOR IS RESPONSIBLE FOR ALL NECESSARY SAFETY BARRIERS, SIGNAGE AND TRAFFIC CONTROL NECESSARY FOR SAFE OPERATION TO THE PUBLIC. THE AREA WILL REMAIN OPEN TO THE PUBLIC.
4. SITE CLEANUP. CONTRACTOR SHALL CLEANUP SITE OF ALL CONSTRUCTION MATERIAL, WASTE CONCRETE SPILLS, AND CONSTRUCTION TRASH AND DISPOSE OF AT A SITE APPROVED BY THE ENGINEER.
5. DRIVEWAYS DAMAGED DURING CONSTRUCTION WILL BE REBUILT. THIS REBUILD INCLUDES REPLACEMENT OF DITCH DRAINAGE PIPE, REGRADING DRIVEWAY WITH 4" TOPPING OF 3/4" MINUS CRUSHED ROCK COMPACTED. THE REBUILT DRIVEWAY WILL BE OF THE SAME WIDTH AS THE ORIGINAL DRIVEWAY. ALL EXCAVATION AND BACKFILL WILL BE CONSIDERED INCIDENTAL AND NOT BE MEASURED FOR PAYMENT.
6. HOURS OF CONSTRUCTION WORK WILL BE BETWEEN 7AM TILL 7 PM, MONDAY THROUGH SUNDAY.
7. CALL BEFORE YOU DIG ~ 907-772-4430x36. PETERSBURG BOROUGH WILL MARK ON THE GROUND ALL UTILITIES IN THE AREA. CALL A MINIMUM OF 2 DAYS BEFORE EXCAVATION. THIS IS A REQUIREMENT OF THE BOROUGH AND THIS CONTRACT.

DRAWING:
PROJECT
QUANTITIES

PROJECT:
12th, 13th & Howkan St. Sidewalk Project
Location
~PETERSBURG, ALASKA~

PETERSBURG INDIAN ASSOCIATION
P.O. BOX 1418, PETERSBURG, AK. 99833
(907) 772-3636

REVISIONS		
REV	DATE	DESCRIPTION

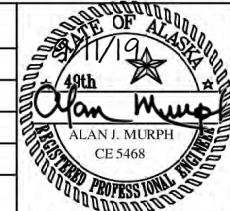

DESIGNED BY:
HARAI & ASSOCIATES, INC
P.O. BOX 625, PETERSBURG, ALASKA 99833
DATE: FEBRUARY, 2019
SHEET NUMBER 3 TOTAL SHEETS 22

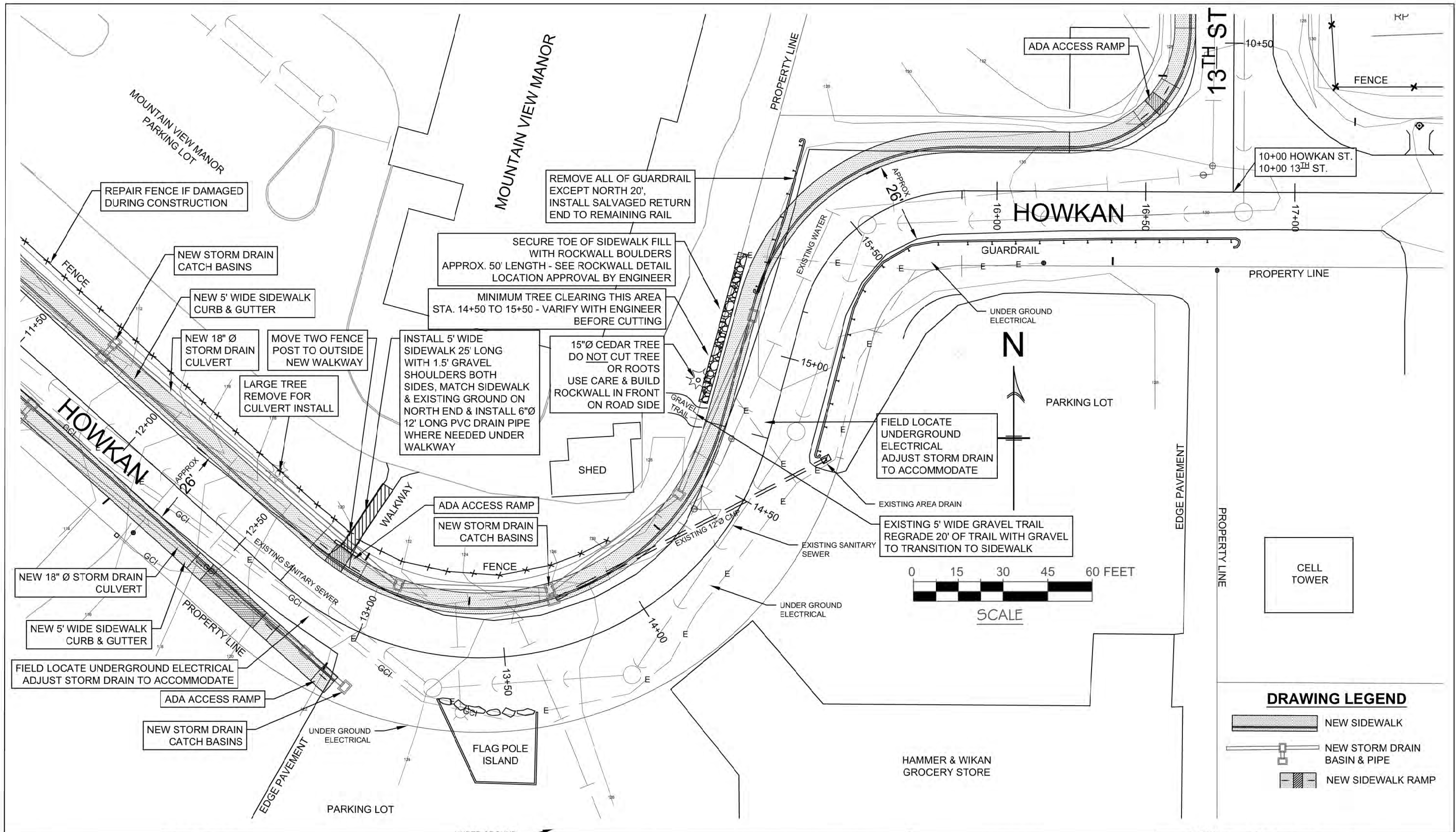

DRAWING:
Plan View
Howkan Street

PROJECT:
12th, 13th & Howkan St. Sidewalk Project
Location
~PETERSBURG, ALASKA~

PETERSBURG INDIAN ASSOCIATION
P.O. BOX 1418, PETERSBURG, AK. 99833
(907) 772-3636

REVISIONS		
REV	DATE	DESCRIPTION

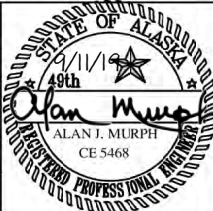

DESIGNED BY:
HARAI & ASSOCIATES, INC
P.O. BOX 625, PETERSBURG, ALASKA 99833
DATE: FEBRUARY, 2019

SHEET NUMBER	TOTAL SHEETS
5	22

DRAWING LEGEND

	NEW SIDEWALK
	NEW STORM DRAIN BASIN & PIPE
	NEW SIDEWALK RAMP

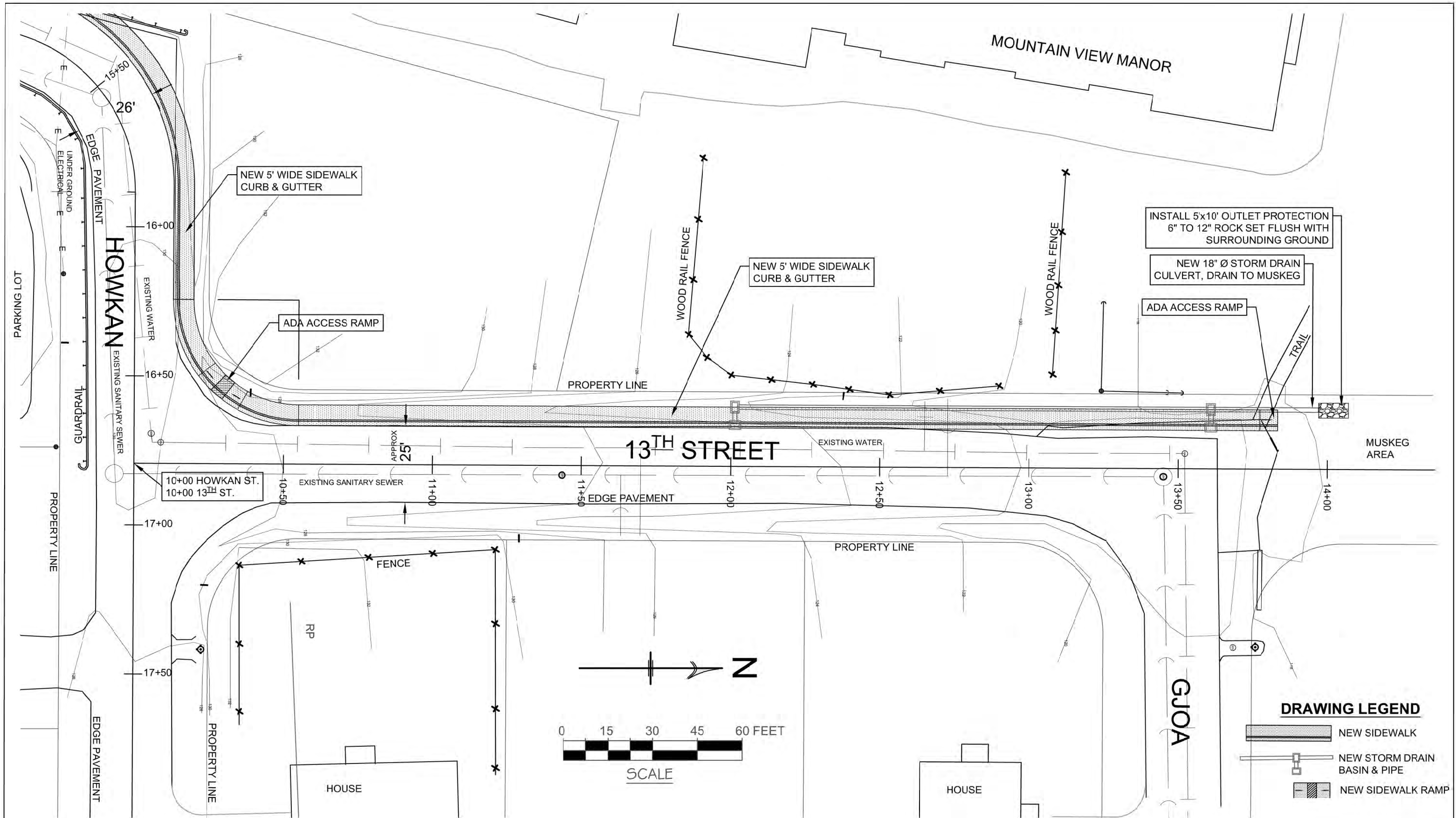

DRAWING:
Plan View
13th Street

PROJECT:
12th, 13th & Howkan St. Sidewalk Project
Location
~PETERSBURG, ALASKA~

PETERSBURG INDIAN ASSOCIATION
P.O. BOX 1418, PETERSBURG, AK. 99833
(907) 772-3636

REVISIONS		
REV	DATE	DESCRIPTION

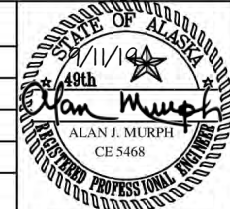

DESIGNED BY:
HARAI & ASSOCIATES, INC
P.O. BOX 625, PETERSBURG, ALASKA 99833
DATE: FEBRUARY, 2019

SHEET NUMBER	TOTAL SHEETS
6	22

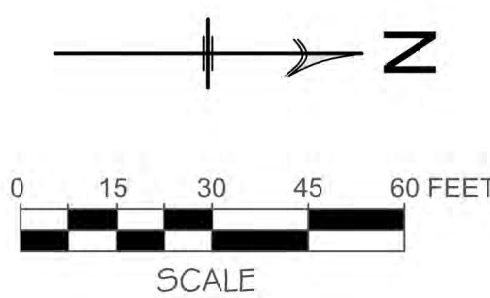
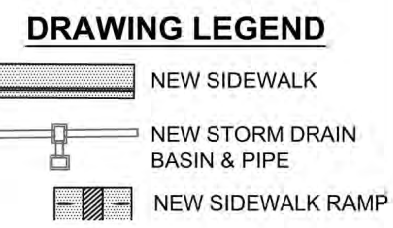

12 TH STREET ~ STORM DRAIN INLET, TYPE A				
STRUCTURE	STATION	OFFSET	FRAME & GRATE	NOTES
SD1A	7+49.0	LT - 19.9	CURB INLET & GRATE	
SD1B	7+49.0	LT - 23.0	SOLID LID	
SD2A	8+96.3	LT - 19.9	DEPRESSED INLET/GRT	CONNECT TO EXISTING 12"Ø CMP
SD2B	8+96.3	LT - 23.0	SOLID LID	
SD3A	9+81.1	LT - 19.9	CURB INLET & GRATE	
SD3B	9+81.1	LT - 23.0	SOLID LID	
SD4	7+37.1	RT - 20.3	SOLID LID	CONNECT TO EXISTING 24"Ø CMP
SD5A	7+53.5	RT - 11.8	CURB INLET & GRATE	
SD5B	7+53.5	RT - 15.9	SOLID LID	INSTALL SIDEWALK APRON
SD6A	8+96.3	RT - 11.8	CURB INLET & GRATE	
SD6B	8+96.3	RT - 15.9	SOLID LID	INSTALL SIDEWALK APRON
SD23	9+52.7	RT - 15.9	AREA GRATE	

HOWKAN STREET ~ STORM DRAIN INLET, TYPE A				
STRUCTURE	STATION	OFFSET	FRAME & GRATE	NOTES
SD7A	10+43.1	RT - 11.9	CURB INLET & GRATE	
SD7B	10+43.1	RT - 24.8	AREA GRATE	
SD11A	11+67.0	RT - 11.9	CURB INLET & GRATE	
SD11B	11+67.0	RT - 17.9	SOLID LID	INSTALL SIDEWALK APRON
SD12	12+88.1	RT - 14.1	CURB INLET & GRATE	
SD13	13+02.6	RT - 18.7	AREA GRATE	PATCH ASPHALT CUT(6" CONCRETE), SHAPE TO DRAIN
SD8A	10+17.1	LT - 18.4	CURB INLET & GRATE	
SD8B	10+20.6	LT - 30.0	AREA GRATE	
SD9	10+43.2	LT - 21.7	SOLID LID	INSTALL SIDEWALK APRON
SD10A	11+73.8	LT - 15.5	CURB INLET & GRATE	
SD10B	11+73.8	LT - 21.7	SOLID LID	INSTALL SIDEWALK APRON
SD14	13+06.9	LT - 19.7	SOLID LID	INSTALL SIDEWALK APRON
SD15A	13+71.1	LT - 15.5	CURB INLET & GRATE	CONNECT TO EXISTING 12"Ø CMP
SD15B	13+71.1	LT - 19.7	SOLID LID	INSTALL SIDEWALK APRON
SD16	14+39.3	LT - 19.7	SOLID LID	INSTALL SIDEWALK APRON
SD17	15+10.7	LT - 15.5	CURB INLET & GRATE	

13 TH STREET ~ STORM DRAIN INLET, TYPE A				
STRUCTURE	STATION	OFFSET	FRAME & GRATE	NOTES
SD20A	12+01.3	LT - 13.9	CURB INLET & GRATE	
SD20B	12+01.3	LT - 19.9	SOLID LID	INSTALL SIDEWALK APRON
SD21A	13+60.9	LT - 13.9	CURB INLET & GRATE	
SD21B	13+60.9	LT - 19.9	SOLID LID	INSTALL SIDEWALK APRON

STORM DRAIN INSTALLATION NOTE:

OFFSET DISTANCE IS TO THE CENTER OF THE BASIN. USE THE CURB LAYOUT DATA FOR THE FINAL INSTALLATION LOCATION OF CURB INLET DRAINS.

- CURB INLET & GRATE = OLYMPIC FOUNDRY INC., MODEL #SM47 OR APPROVED EQUIVALENT
- DEPRESSED INLET & GRATE = OLYMPIC FOUNDRY INC., MODEL #SM43 OR APPROVED EQUIVALENT
- AREA DRAIN = NEENAH FOUNDRY INC., MODEL #R-1878-B7G OR APPROVED EQUIVALENT
- SOLID LID = NEENAH FOUNDRY INC., MODEL #R-1878-B7L OR APPROVED EQUIVALENT

CULVERT SUMMARY											
PIPE	INLET			OUTLET			LENGTH (FT)	SIZE	REMARKS	APPROX GRADE	
	STATION	OFFSET	INVERT	STATION	OFFSET	INVERT					
12 TH STREET	P1	SD-1B	LT	98.0	7+44.8	LT - 41.5	97.5	18	18"Ø CPP	INSTALL OUTLET PROTECTION	2.78%
	P2	SD-1A	LT	98.0	SD-1B	LT	98.0	1	18"Ø CPP	CONNECT BASINS, BACK TO BACK	0.00%
	P3	SD-2B	LT	100.4	SD-1B	LT	98.0	145	18"Ø CPP		1.59%
	P4	SD-2A	LT	100.4	SD-2A	LT	100.4	1	18"Ø CPP	CONNECT BASINS, BACK TO BACK	0.00%
	P5	SD-8A	RT	103.0	SD-2A	LT	100.4	EXIST CMP	12"Ø CMP	2' PIPE STUB CONNECT TO EXISTING	MATCH
	P6	SD-3B	LT	102.0	SD-2B	LT	100.4	82	18"Ø CPP		1.95%
	P7	SD-3A	LT	102.0	SD-3B	LT	102.0	1	18"Ø CPP	CONNECT BASINS, BACK TO BACK	0.00%
	P8A	7+37.0	RT-31.2	98.6	SD-4	RT	98.6	10	24"Ø CPP	PIPE INLET IN DITCH	0.00%
	P8B	SD-4	RT	98.6				EXIST CMP	24"Ø CMP	FIT SD4 BASIN OVER EXISTING CMP	
	P9	SD-5B	RT	98.6	SD-4	RT	98.6	15	18"Ø CPP	PIPE INLET IN DITCH	0.00%
	P10	SD-5A	RT	98.6	SD-5B	RT	98.6	1	18"Ø CPP	CONNECT BASINS, BACK TO BACK	0.00%
	P11	SD-6B	RT	100.5	SD-5B	RT	98.6	141	18"Ø CPP		1.35%
	P12	SD-6A	RT	100.5	SD-6B	RT	100.5	1	18"Ø CPP	CONNECT BASINS, BACK TO BACK	0.00%
P13	SD-23	RT	100.9	SD-6B	RT	100.5	54	18"Ø CPP		0.74%	
HOWKAN STREET	P14	SD-7B	RT	101.1	SD-23	RT	100.9	35	18"Ø CPP		0.57%
	P15	SD-7A	RT	103.1	SD-7B	RT	101.1	11	18"Ø CPP		18.18%
	P16	SD-11B	RT	110.0	SD-7B	RT	101.1	123	18"Ø CPP		7.30%
	P17	SD-11A	RT	110.0	SD-11B	RT	110.0	4	18"Ø CPP		0.00%
	P18	SD-12	RT	118.6	SD-11B	RT	110.0	122	18"Ø CPP		7.05%
	P19	SD-13	RT	119.2	SD-12	RT	118.6	15	18"Ø CPP		4.00%
	P21	SD-8B	LT	103.0	SD-8A	LT	103.0	10	18"Ø CPP		0.00%
	P22	SD-9	LT	104.2	SD-8B	LT	103.0	23	18"Ø CPP		5.22%
	P23	SD-10B	LT	110.6	SD-9	LT	104.2	129	18"Ø CPP		4.96%
	P24	SD-10A	LT	110.6	SD-10B	LT	110.6	4	18"Ø CPP		0.00%
	P25	SD-14	LT	119.9	SD-10B	LT	110.6	124	18"Ø CPP		7.50%
P26	SD-15B	LT	122.2	SD-14	LT	119.9	50	18"Ø CPP		4.60%	
P27	SD-15A	LT	122.2	SD-15B	LT	122.2	1	18"Ø CPP	CONNECT BASINS, BACK TO BACK	0.00%	
P28	SD-16	LT	124.7	SD-15B	LT	122.2	53	18"Ø CPP		4.72%	
P29	SD-17	LT	125.3	SD-16	LT	124.7	63	18"Ø CPP		0.95%	
13 TH ST	P30				SD-15A	LT	123.8	EXIST CMP	12"Ø CMP	2' PIPE STUB CONNECT TO EXISTING	MATCH
	P31	SD-20A	LT	121.1	SD-20B	LT	121.1	4	18"Ø CPP		0.00%
	P32	SD-20B	LT	121.1	SD-21B	LT	117.4	158	18"Ø CPP		2.34%
	P33	SD-21A	LT	117.4	SD-21B	LT	117.4	4	18"Ø CPP		0.00%
P34	SD-21B	LT	117.4	13+96.9	LT - 19.9	116.9	35	18"Ø CPP	INSTALL OUTLET PROTECTION	1.43%	

DRAWING:
Storm Drain Tables

PROJECT:
12th, 13th & Howkan St. Sidewalk Project
Location
~PETERSBURG, ALASKA~

PETERSBURG INDIAN ASSOCIATION
P.O. BOX 1418, PETERSBURG, AK. 99833
(907) 772-3636

REVISIONS		
REV	DATE	DESCRIPTION

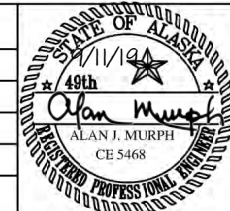

DESIGNED BY:
HARAI & ASSOCIATES, INC
P.O. BOX 625, PETERSBURG, ALASKA 99833

DATE: FEBRUARY, 2019

SHEET NUMBER	TOTAL SHEETS
7	22

DEPRESSED CURB / GUTTER AND SIDEWALK RAMP LOCATION TABLE					
	STATION	OFFSET	WIDTH	REMARKS	DETAIL
12 TH STREET	7+22.23	RT - 43.61		END SW RAMP, INSTALL WARNING TILE (2' X 4')	
	7+68.0	RT - 12.9	8.0	DEPRESSED CURB, INSTALL WARNING TILE (2' X 4')	
	9+06.7	LT - 21.0	25.0	DEPRESSED CURB	
	9+20.2	RT - 12.9	5.0	RAMP, INSTALL BACKING CURB & WARNING TILE (2' X 4')	
	9+58.3	LT - 21.0	24.0	DEPRESSED CURB	
	10+48.87	RT - 13.20		END SW RAMP, INSTALL WARNING TILE (2' X 4')	
	10+66.48	LT - 21.0		END SW RAMP, INSTALL WARNING TILE (2' X 3')	
HOWKAN ST	10+54.0	LT - 16.7	5.0	RAMP, INSTALL BACKING CURB & WARNING TILE (2' X 4')	
	10+54.0	RT - 13.0	5.0	RAMP, INSTALL BACKING CURB & WARNING TILE (2' X 4')	
	12+60.2	RT - 13.0	24.0	DEPRESSED CURB	
	12+79.8	LT - 16.7	6.0	RAMP, INSTALL WARNING TILE (2' X 4')	
	12+99.2	RT - 18.6		END SW RAMP, INSTALL WARNING TILE (2' X 4')	
13 TH ST	10+28.7	LT - 24.7	5.0	RAMP, INSTALL BACKING CURB & WARNING TILE (2' X 4')	
	13+83.26	LT - 14.89		END SW RAMP, INSTALL WARNING TILE (2' X 4')	

LOCATIONS MEASURED TO CENTER AT TOP BACK OF CURB.

SIGN SUMMARY					
	SIGN #	LEGEND	STATION	OFFSET	REMARKS
12 TH STREET	1	STOP	7+59.6	LT - 25.2	REMOVE, STORE, REPLACE BEHIND SIDEWALK SAME STATION
	2	NO PARKING	8+59.5	LT - 28.7	REMOVE, STORE, REPLACE BEHIND SIDEWALK SAME STATION
	3	NO PARKING	10+39.9	LT - 21.4	REMOVE, STORE, REPLACE BEHIND SIDEWALK SAME STATION
	4	NO PARKING	10+36.5	RT - 20.8	REMOVE, STORE, REPLACE BEHIND SIDEWALK SAME STATION
HOWKAN STREET	10	STOP	10+32.8	LT - 21.0	REMOVE, STORE, REPLACE BEHIND SIDEWALK SAME STATION
	11	NO PARKING	10+96.9	LT - 20.8	REMOVE, STORE, REPLACE BEHIND SIDEWALK SAME STATION
	12	NO PARKING	11+97.4	LT - 18.2	REMOVE, STORE, REPLACE BEHIND SIDEWALK SAME STATION
	13	CROSSWALK	12+90.0	LT - 22.0	REMOVE, STORE, REPLACE BEHIND SIDEWALK SAME STATION
	14	CROSSWALK AHEAD	13+37.0	LT - 19.0	REMOVE, STORE, REPLACE BEHIND SIDEWALK SAME STATION
	15	CROSSWALK AHEAD	14+23.0	LT - 18.4	REMOVE, STORE, REPLACE BEHIND SIDEWALK SAME STATION
	16	CROSSWALK AHEAD/ NO PARKING	10+99.6	RT - 23.5	REMOVE, STORE, REPLACE BEHIND SIDEWALK SAME STATION
	17	CROSSWALK AHEAD	12+07.3	RT - 19.5	REMOVE, STORE, REPLACE BEHIND SIDEWALK SAME STATION
18	CROSSWALK AHEAD	12+95.0	RT - 15.3	REMOVE, STORE, REPLACE BEHIND SIDEWALK SAME STATION	
13 TH STREET	20	STOP	10+39.0	LT - 22.9	REMOVE, STORE, REPLACE BEHIND SIDEWALK SAME STATION
	21	SPEED LIMIT	12+37.7	LT - 23.8	REMOVE, STORE, REPLACE BEHIND SIDEWALK SAME STATION
	22	TRAIL SIGN	13+82.0	LT - 8.0	REMOVE, STORE, REPLACE BEHIND SIDEWALK SAME STATION

TYPICAL SIGN INSTALLATION HEIGHT IS 7' ABOVE SIDEWALK TO THE BOTTOM OF SIGN.
TYPICAL SIGN POST EMBEDMENT DEPTH IS 2.5'. SIGN POST WILL BE SET IN A HOLE WITH A MINIMUM DIAMETER OF 12" AND FILLED WITH CONCRETE.

DRAWING:
Sign & Ramp
Tables

PROJECT:
12th, 13th & Howkan St. Sidewalk Project
Location
~PETERSBURG, ALASKA~

PETERSBURG INDIAN ASSOCIATION
P.O. BOX 1418, PETERSBURG, AK. 99833
(907) 772-3636

REVISIONS		
REV	DATE	DESCRIPTION

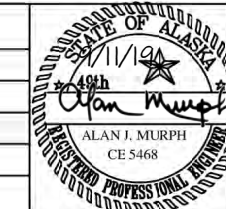

DESIGNED BY:
HARAI & ASSOCIATES, INC
P.O. BOX 625, PETERSBURG, ALASKA 99833
DATE: FEBRUARY, 2019
SHEET NUMBER: 8
TOTAL SHEETS: 22

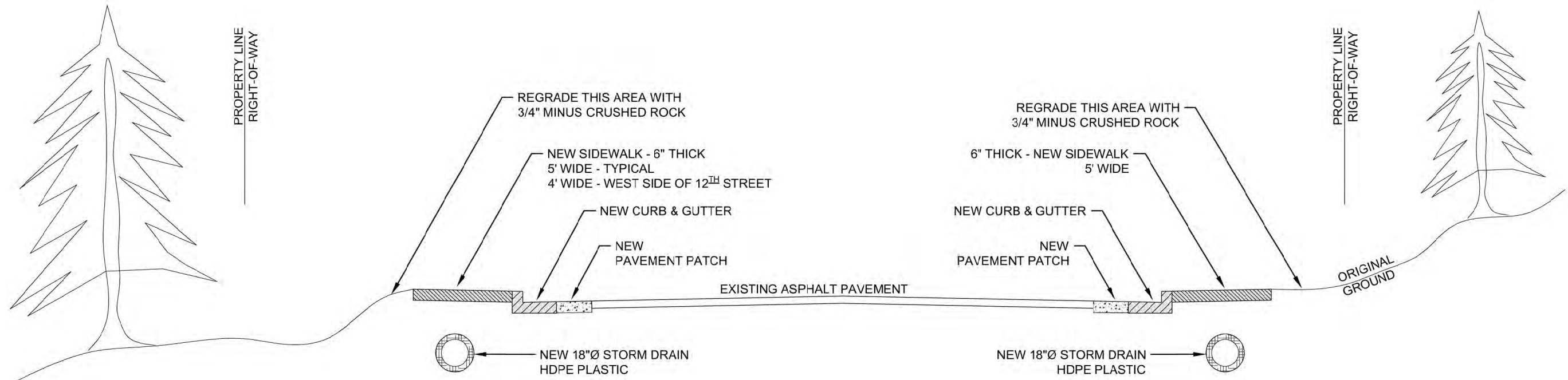

TYPICAL ROADWAY IMPROVEMENTS

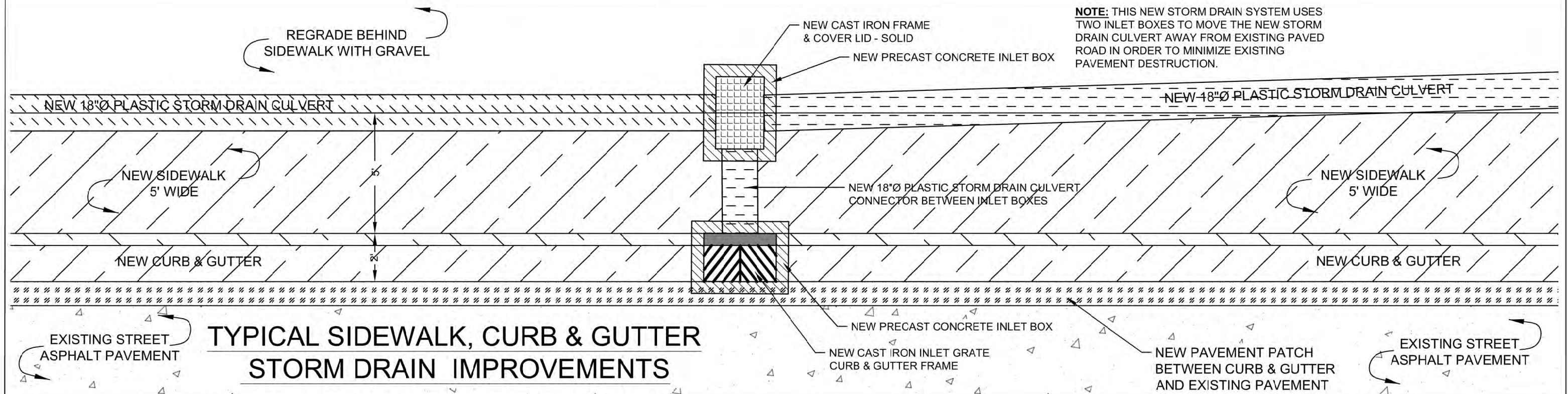

TYPICAL SIDEWALK, CURB & GUTTER STORM DRAIN IMPROVEMENTS

DRAWING:
TYPICAL
ROADWAY
IMPROVEMENTS

PROJECT:
12th, 13th & Howkan St. Sidewalk Project
Location
~PETERSBURG, ALASKA~

PETERSBURG INDIAN ASSOCIATION
P.O. BOX 1418, PETERSBURG, AK. 99833
(907) 772-3636

REVISIONS		
REV	DATE	DESCRIPTION

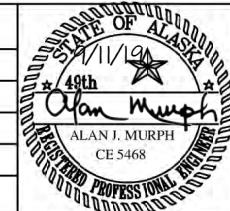

DESIGNED BY:
HARAI & ASSOCIATES, INC
P.O. BOX 625, PETERSBURG, ALASKA 99833

DATE: FEBRUARY, 2019

SHEET NUMBER	TOTAL SHEETS
9	22

SIDEWALK JOINT LAYOUT

NOTES:

1. 1/2" THICK, FULL DEPTH EXPANSION JOINT.
2. V-GROOVE. 1/4" DEEP
3. ALL CONCRETE SURFACES SHALL BE COMPLETED WITH A BROOM FINISH.
4. INSTALL EDGE JOINTS PER JOINT DETAIL.

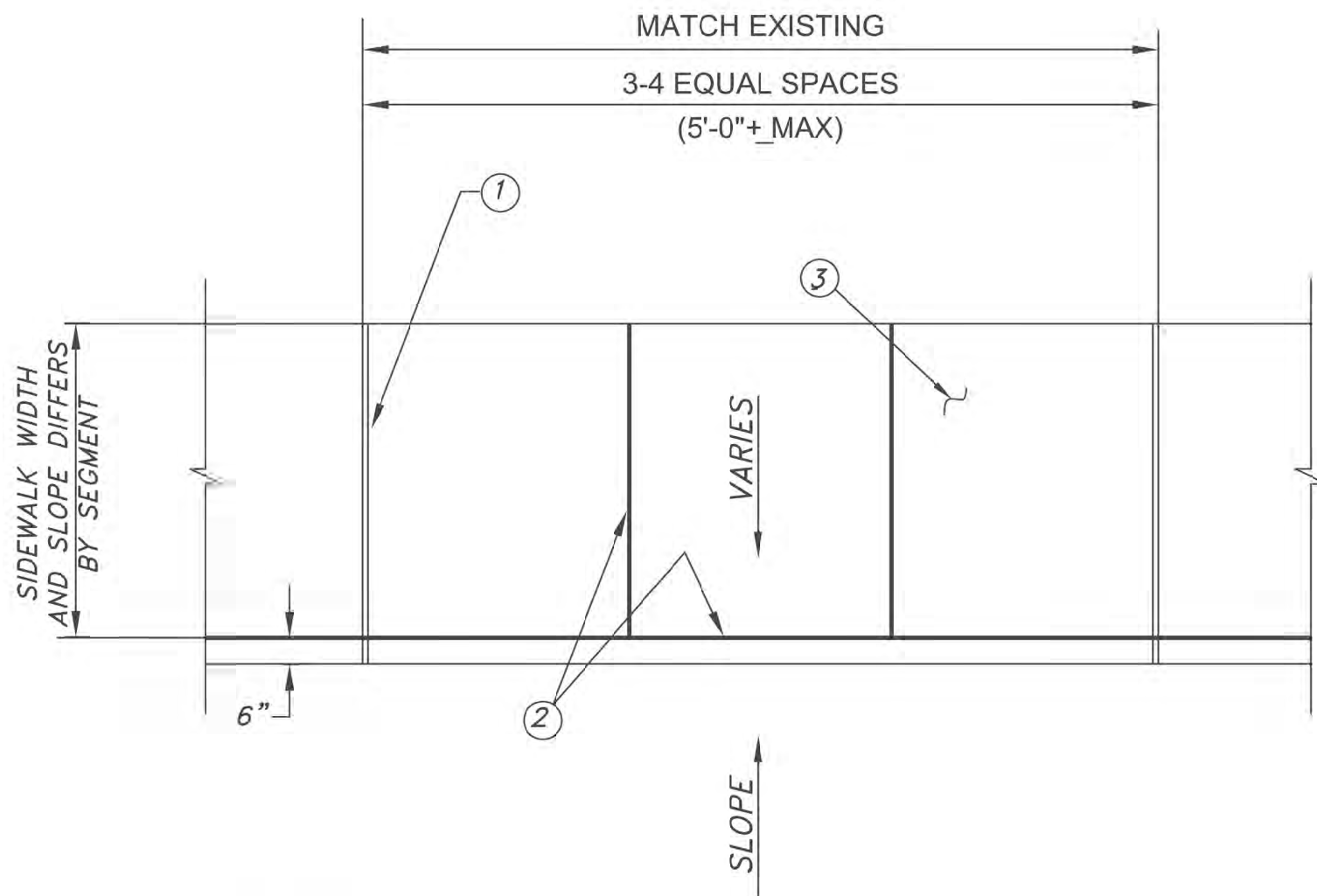

DETECTABLE WARNING TILE DETAIL

NOTES:

1. INSTALL 24" WIDE STRIPS OF SAFETY YELLOW CAST-IN-PLACE COMPOSITE DETECTABLE WARNING TILES WITH TRUNCATED DOME DETECTABLE WARNING TEXTURE ON THE STREET SIDE EDGE OF LOWER LANDINGS AS SHOWN. DOMES SHALL BE IN A SQUARE PATTERN. ALIGN TRUNCATED DOME PATTERN IN THE PREDOMINANT DIRECTION OF WHEELCHAIR TRAVEL TO PERMIT WHEELS TO ROLL BETWEEN THE DOMES.
2. TACTILE STRIPS SHALL BE VITRIFIED POLYMER COMPOSITE (ARMOR-TILE BRAND, HERCULITE SERIES) CAST IN PLACE TILE THAT ARE EASILY REPLACEABLE. COLOR SHALL BE OCHRE YELLOW #33538. INSTALLATION SHALL BE AS PER MANUFACTURERS RECOMMENDATIONS.
3. INSTALLATION: POUR AND FLOAT CONCRETE, SET TILE BY TAMPING DOWN INTO CONCRETE UNTIL ALL AIR VOIDS ARE REMOVED, EDGE AROUND THE PERIMETER, CUT OFF PROTECTIVE PLASTIC SHEET.

TEXTURE PATTERN DETAIL

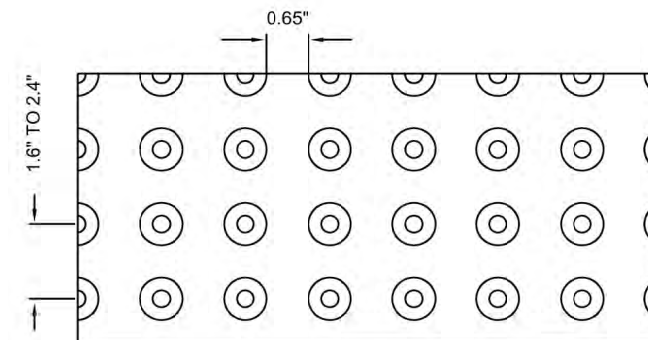

TRUNCATED DOME DETAIL

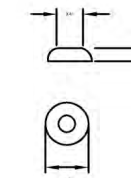

FULL DEPTH EXPANSION JOINT

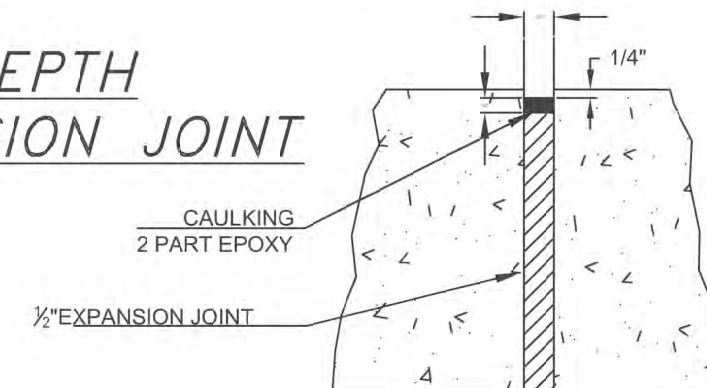

DRAWING:
Joint and Tile
Details

PROJECT:
12th, 13th & Howkan St. Sidewalk Project
Location
~PETERSBURG, ALASKA~

PETERSBURG INDIAN ASSOCIATION
P.O. BOX 1418, PETERSBURG, AK. 99833
(907) 772-3636

REVISIONS

REV	DATE	DESCRIPTION

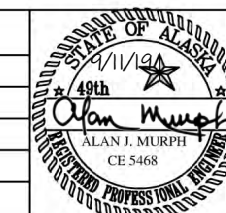

DESIGNED BY:
HARAI & ASSOCIATES, INC
P.O. BOX 625, PETERSBURG, ALASKA 99833

DATE: FEBRUARY, 2019

SHEET NUMBER	TOTAL SHEETS
11	22

CONSTRUCTION NOTES

1. 1/4-INCH THICK MAX EASE END ON ALL RAMP SECTION
2. INSTALL EDGE JOINTS PER DETAIL B
3. TEXTURED PATTERN PER ADOT STAD.DWG 1-21.01
4. ALL CONCRETE SURFACES SHALL BE COMPLETED WITH A BROOM FINISH PER ADOT 50193.09
5. 1/2-INCH THICK FULL DEPTH EXPANSION JOINT
6. RADIUS LENGTH IS APPROXIMATE - FIELD DETERMINE
7. V-GROOVE, 1/4" - INCH DEEP.
8. FIELD FORM FIT

RAMP DETAILS

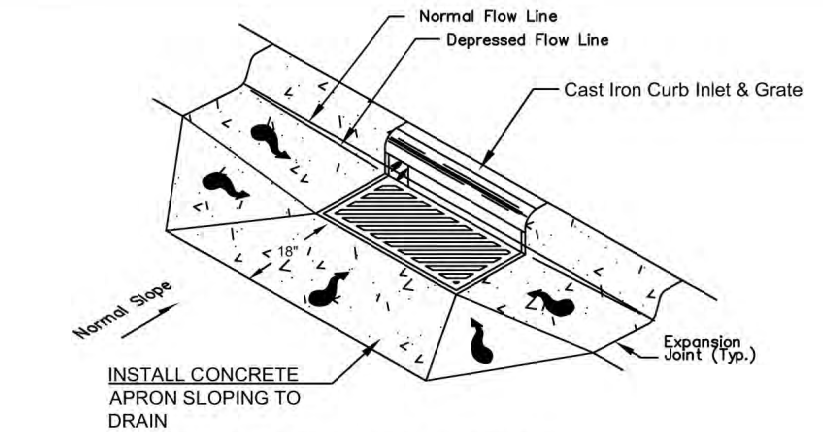
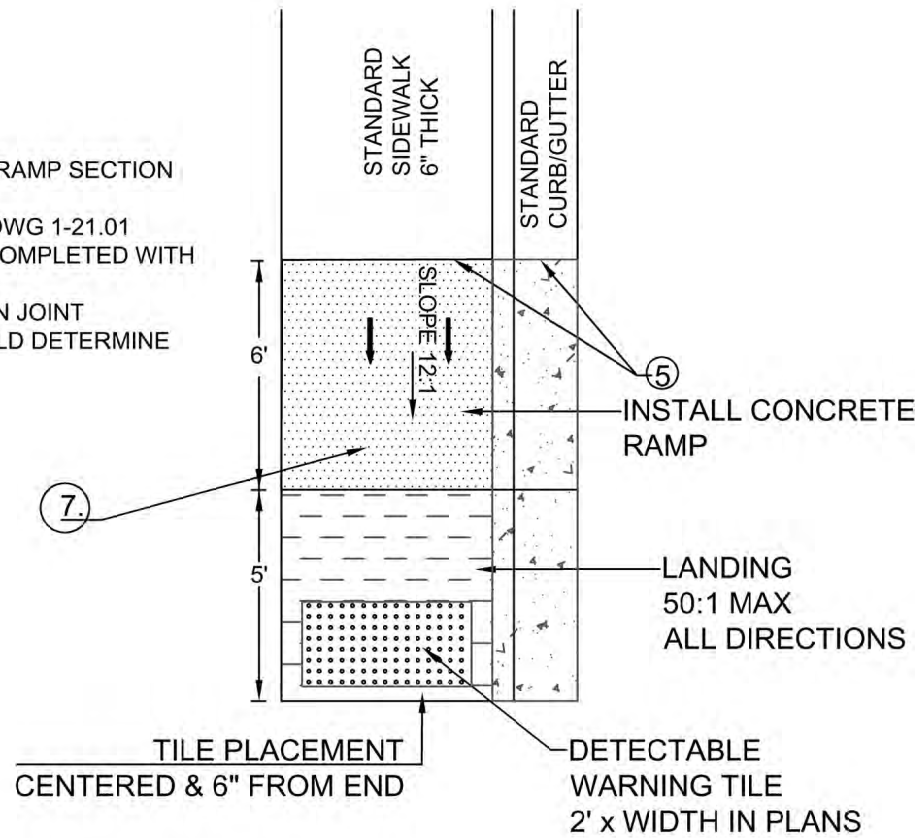

STANDARD CURB INLET INSTALLATION

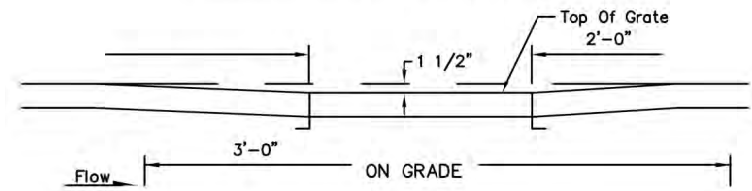

DEPRESSION IN FLOW LINE AT INLET CONSTRUCTION DETAILS

DROP INLET DRAIN DETAIL
N.T.S.

Flush transition at flowline - no lip or groove

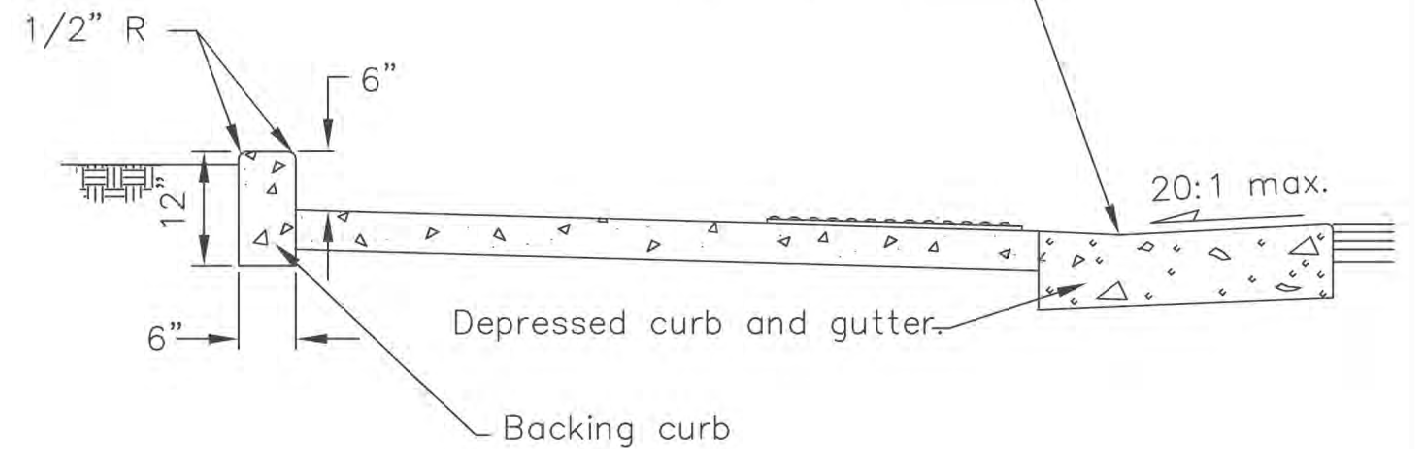

BACKING CURB

CONTRACTOR SHALL SAW CUT AND REMOVE AN ADDITIONAL 4" MINIMUM FROM EDGE OF THE ORIGINAL CUT. THIS CUT SHALL BE DONE ON THE DAY THAT THE CONCRETE PAVEMENT PATCH IS TO BE PLACED.

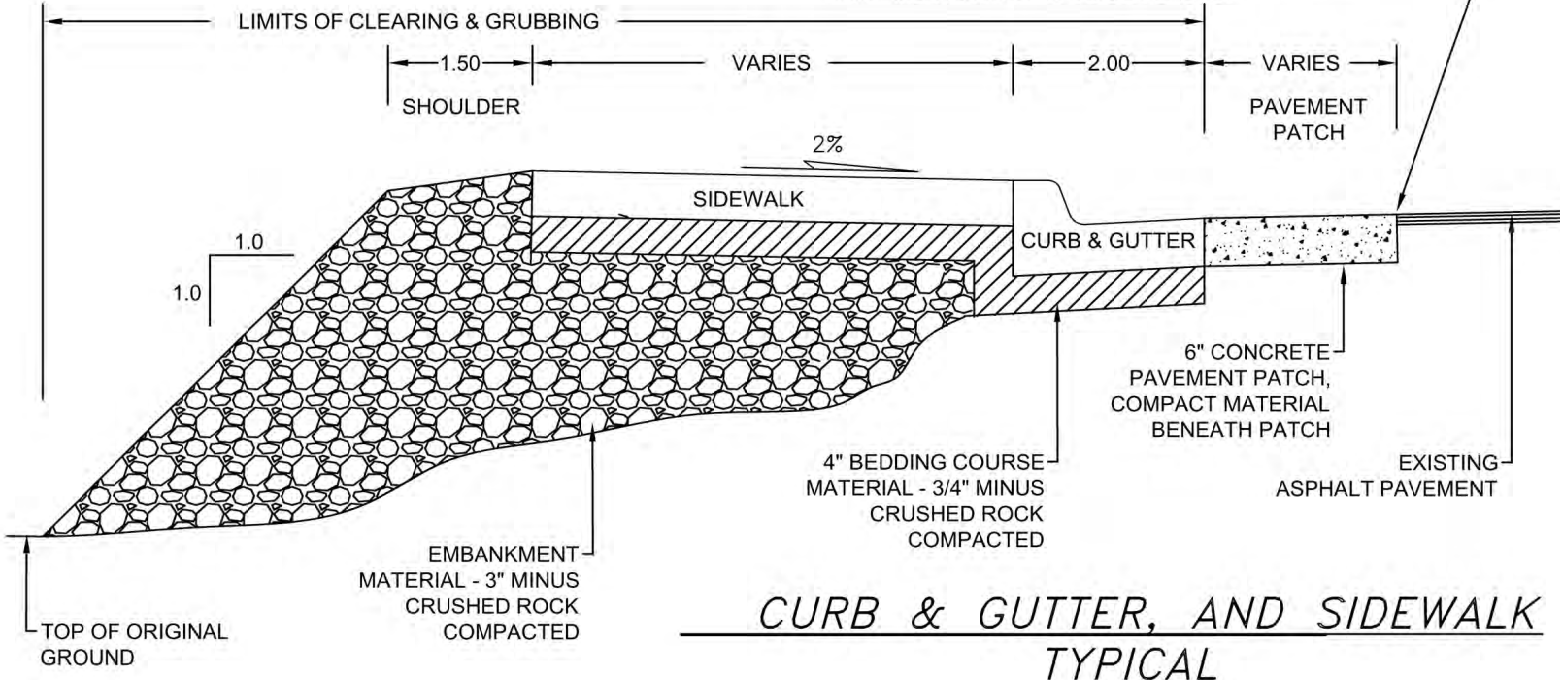

DRAWING:
Curb & Gutter
Sidewalk
Details

PROJECT:
12th, 13th & Howkan St. Sidewalk Project
Location
~PETERSBURG, ALASKA~

PETERSBURG INDIAN ASSOCIATION
P.O. BOX 1418, PETERSBURG, AK. 99833
(907) 772-3636

REVISIONS

REV	DATE	DESCRIPTION

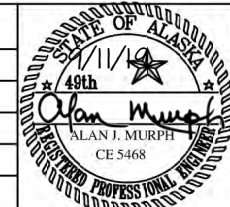

DESIGNED BY:
HARAI & ASSOCIATES, INC
P.O. BOX 625, PETERSBURG, ALASKA 99833

DATE: FEBRUARY, 2019

SHEET NUMBER	TOTAL SHEETS
12	22

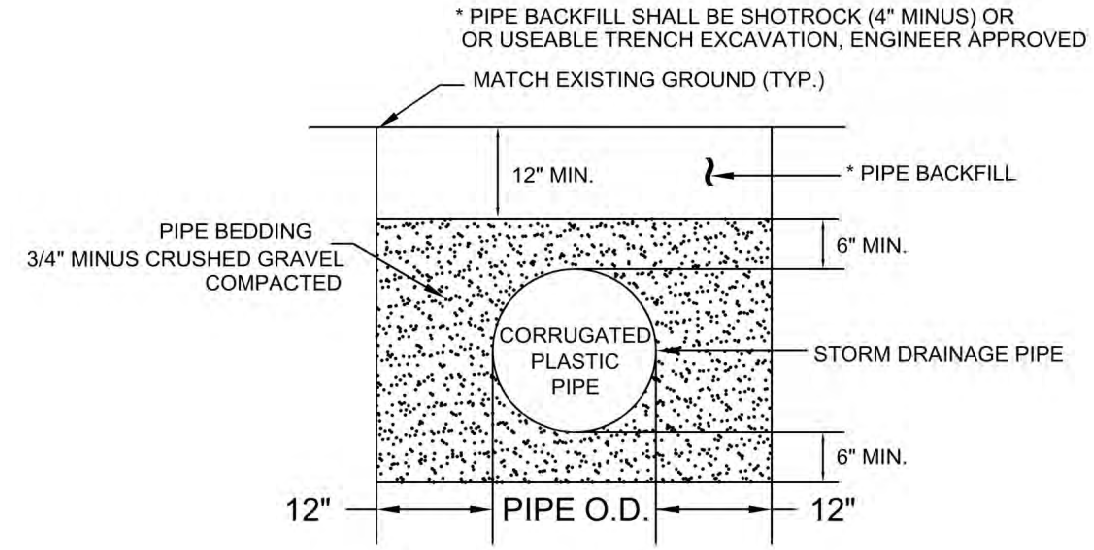
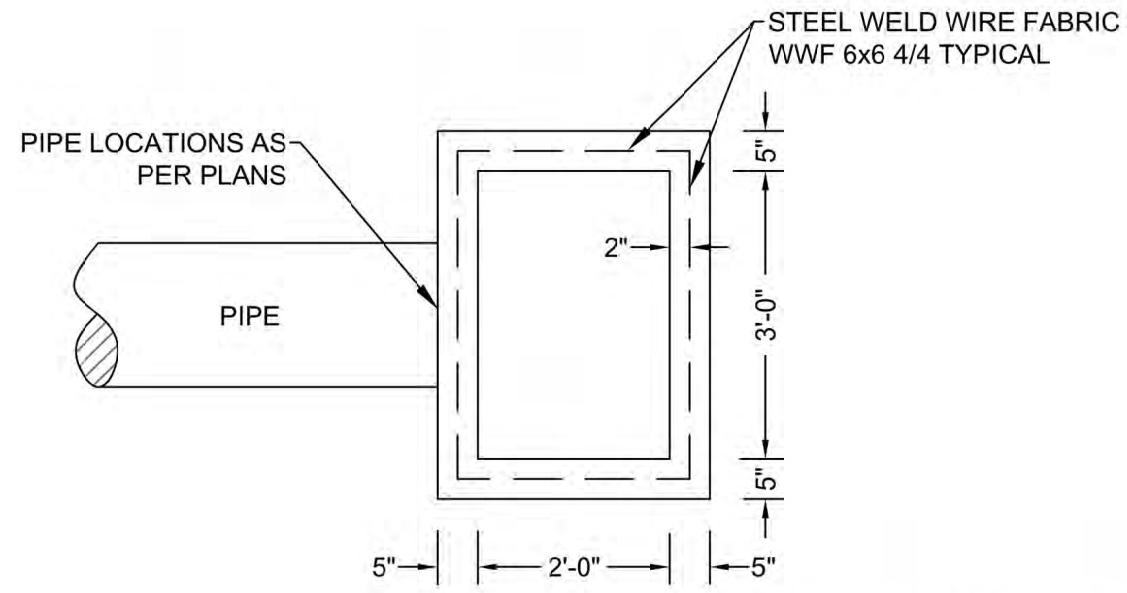

STORM DRAIN PIPE
N.T.S.

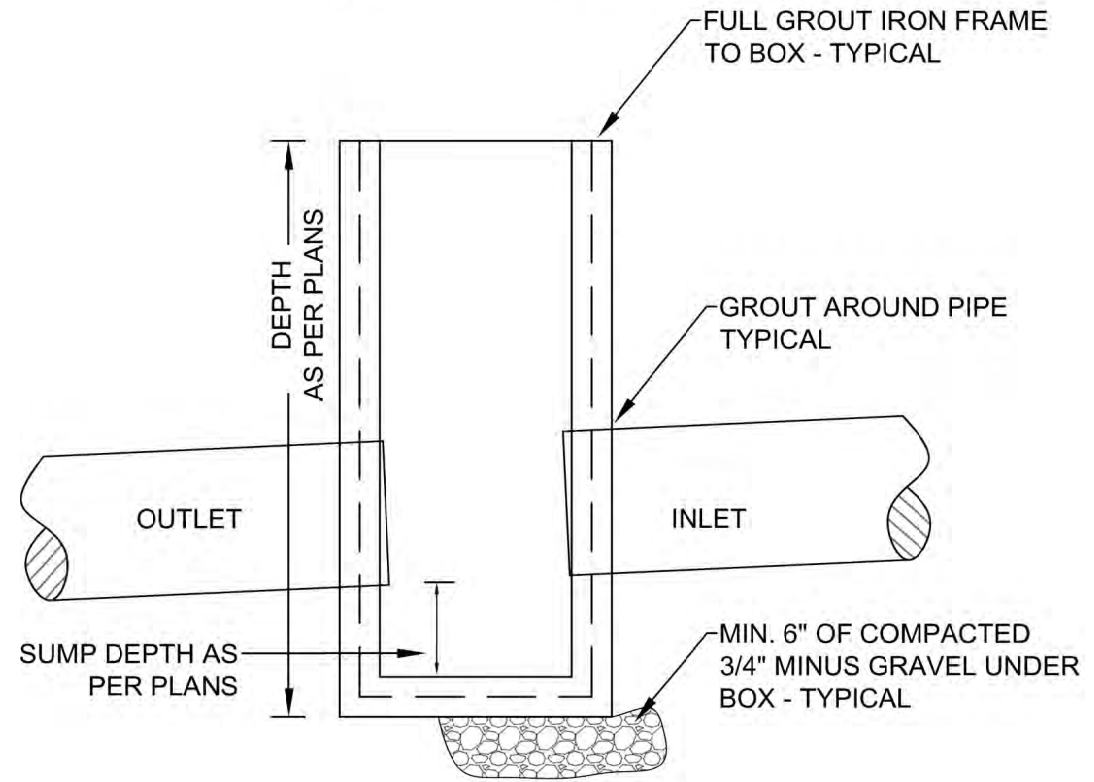

TYPE "A" CONCRETE INLET BOX
STATE OF ALASKA DOT & PF
STANDARD DRAWING D-26.04

1. STAGGER AND INTERLOCK ROCKS FOR STABILITY.
2. HOWKAN STREET - TOP ELEVATION OF ROCK BOULDER WALL IS TOP BACK OF SIDEWALK - ENGINEER APPROVAL.
3. 12TH STREET - TOP ELEVATION OF ROCK BOULDER WALL WILL MATCH GROUND BEHIND WALL - ENGINEER APPROVAL.
4. THE HIGHEST WALL WILL BE A MAXIMUM OF 3 ROCKS TAPERING TO 2 ROCKS OR 1 ROCK AS NEEDED - ENGINEER APPROVAL.

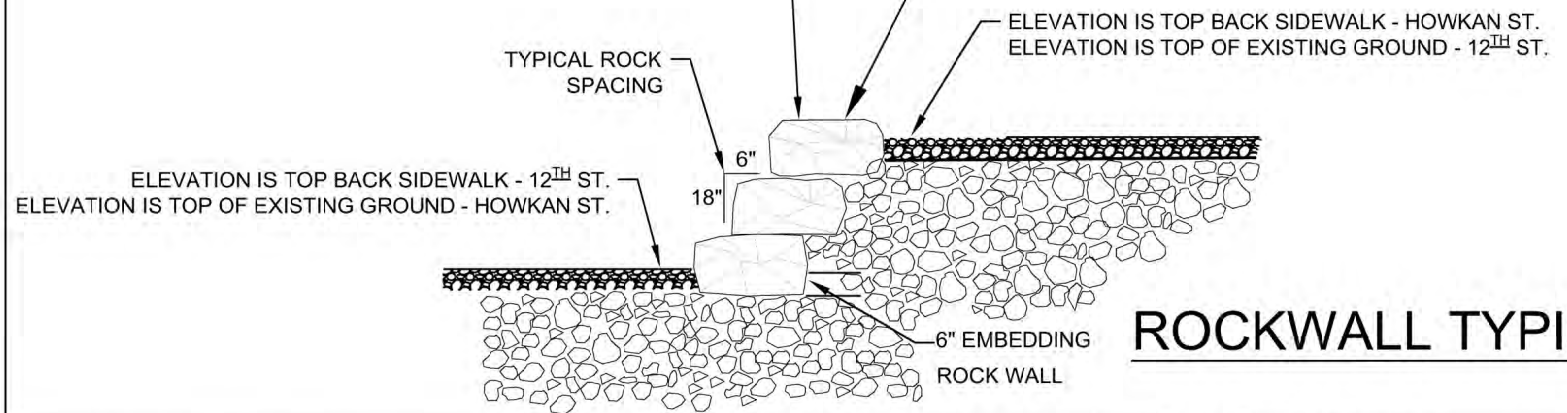
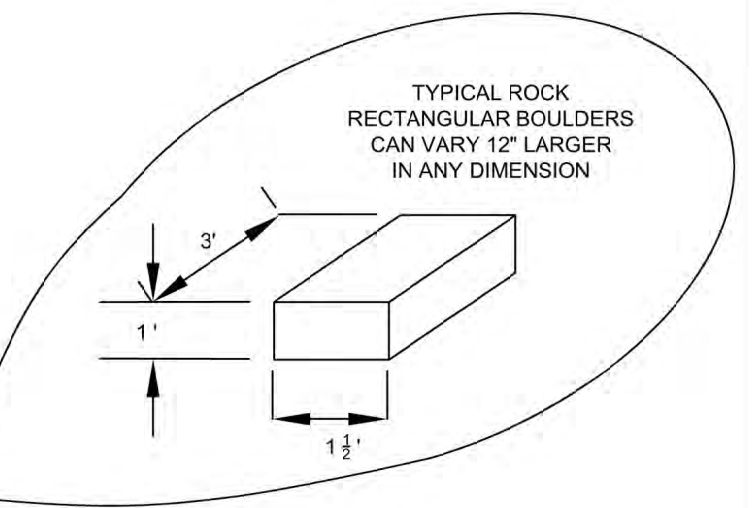

ROCKWALL TYPICAL

DRAWING:
Storm Sewer
& Rockwall
Details

PROJECT:
12th, 13th & Howkan St. Sidewalk Project
Location
~PETERSBURG, ALASKA~

PETERSBURG INDIAN ASSOCIATION
P.O. BOX 1418, PETERSBURG, AK. 99833
(907) 772-3636

REVISIONS		
REV	DATE	DESCRIPTION

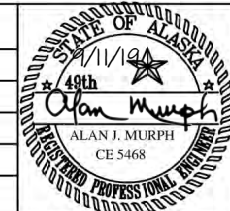

DESIGNED BY:
HARAI & ASSOCIATES, INC
P.O. BOX 625, PETERSBURG, ALASKA 99833
DATE: FEBRUARY, 2019
SHEET NUMBER: 13
TOTAL SHEETS: 22

CONSTRUCTION NOTES

1. 1/4-INCH THICK MAX EASE END ON ALL RAMP SECTION
2. INSTALL EDGE JOINTS PER DETAIL B
3. TEXTURED PATTERN PER ADOT STAD.DWG 1-21.01
4. ALL CONCRETE SURFACES SHALL BE COMPLETED WITH A BROOM FINISH PER ADOT 50193.09
5. 1/2-INCH THICK FULL DEPTH EXPANSION JOINT
6. RADIUS LENGTH IS APPROXIMATE - FIELD DETERMINE
7. V-GROOVE, 1/4" - INCH DEEP.
8. FIELD FORM FIT

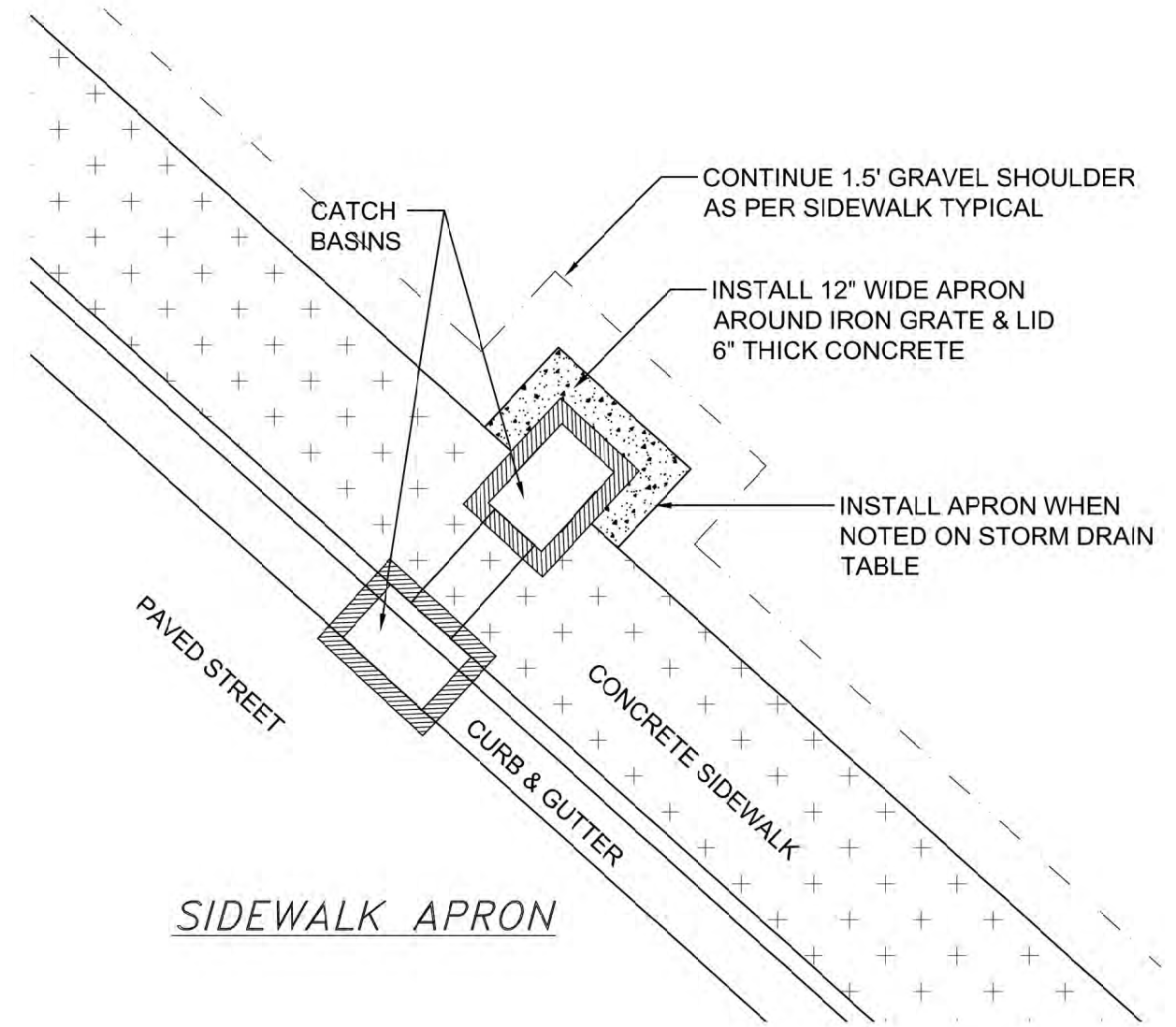
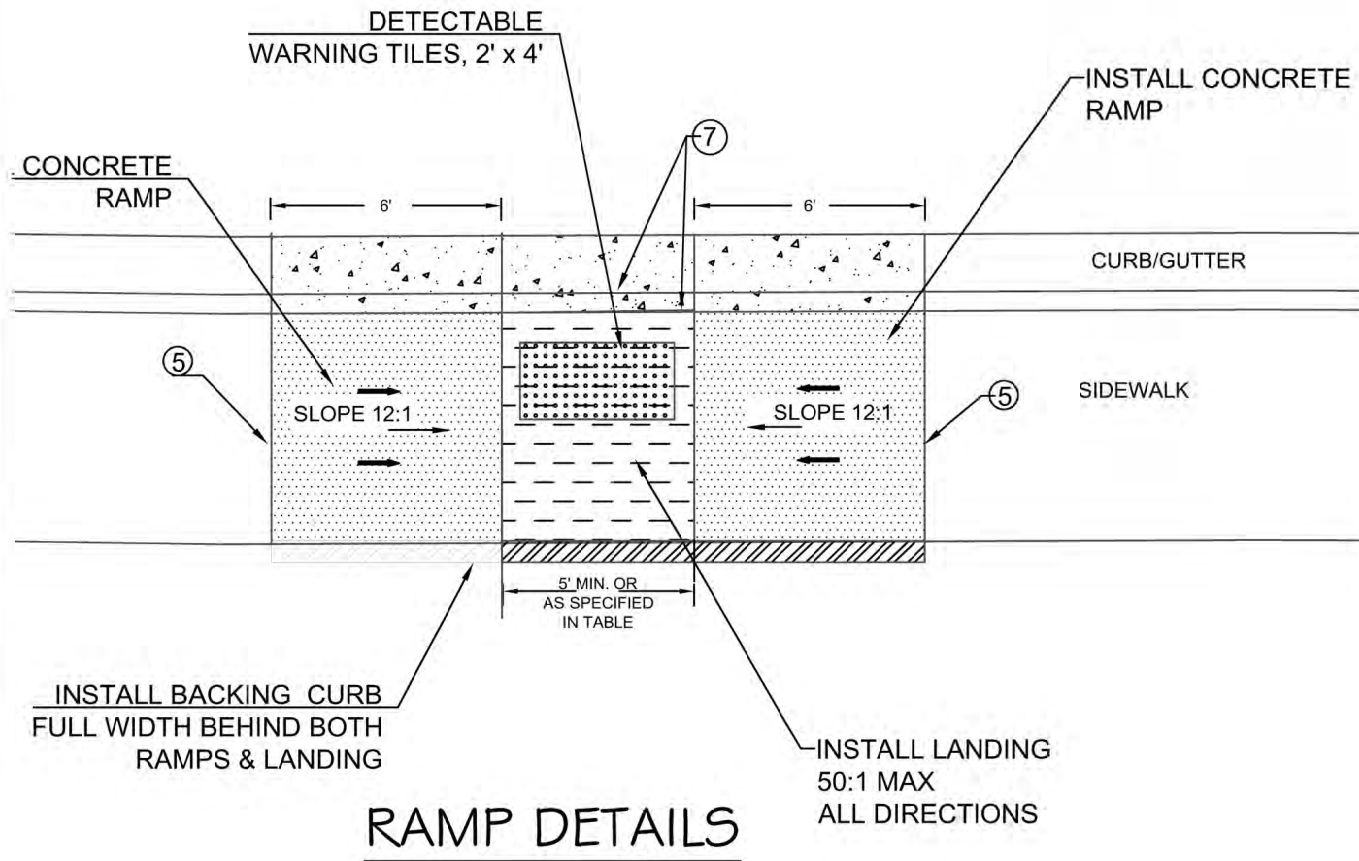

DRAWING:
Ramp & Apron
Details

PROJECT:
12th, 13th & Howkan St. Sidewalk Project
Location
~PETERSBURG, ALASKA~

PETERSBURG INDIAN ASSOCIATION
P.O. BOX 1418, PETERSBURG, AK. 99833
(907) 772-3636

REVISIONS		
REV	DATE	DESCRIPTION

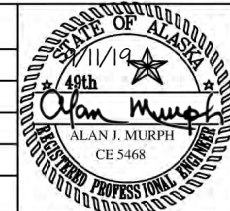

DESIGNED BY:
HARAI & ASSOCIATES, INC
P.O. BOX 625, PETERSBURG, ALASKA 99833

DATE: FEBRUARY, 2019

SHEET NUMBER	TOTAL SHEETS
14	22

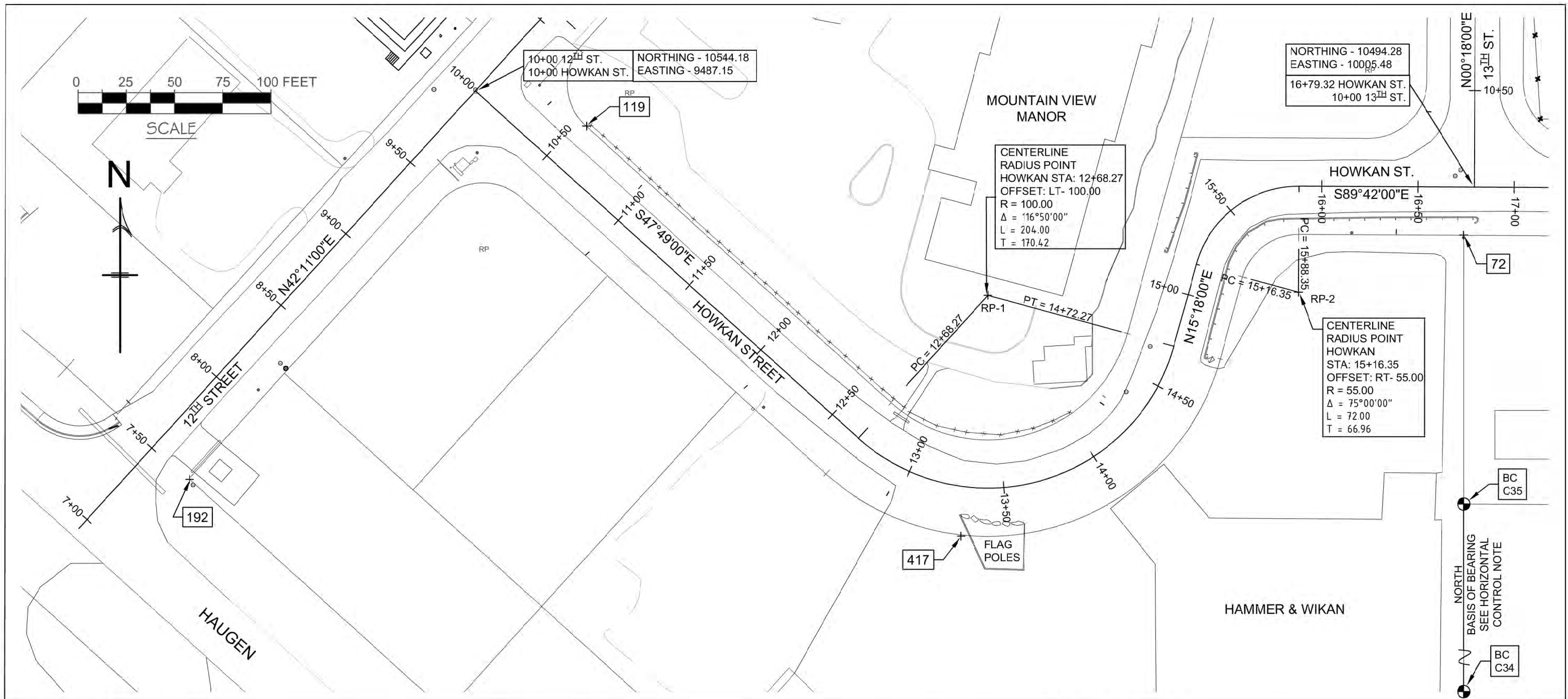

HORIZONTAL CONTROL

THE BASIS OF THE HORIZONTAL CONTROL FOR THIS PROJECT IS A SET OF BRASS CAP MONUMENTS, 3"Ø BRASS CAP ON 2.5"Ø STEEL POST - SET WITH ORIGINAL SURVEY OF THE PETERSBURG AIRPORT BOUNDARY IN 1969 BY TONER & NORDLING. THESE MONUMENTS ARE THE CORNERS DESIGNATED AS C34 AND C35. THESE MONUMENTS ARE SHOWN IN THE PLAT #77-2, PETERSBURG RECORDING DISTRICT. PLAT #77-2 IS THE RECORD SURVEY CONTROLLING THE ROAD R.O.W. IN THIS PROJECT. THE RECORD BEARING BETWEEN THE MONUMENTS IS NORTH.

VERTICAL CONTROL

THE BASIS OF THE VERTICAL CONTROL FOR THIS PROJECT IS POINT #417, A "PK" NAIL IN THE ASPHALT PAVEMENT WEST OF FLAG POLES CONCRETE WALL IN THE WEST PARKING LOT OF HAMMER & WIKAN GROCERY STORE. THIS POINT HAS AN ELEVATION OF 124.36'. THIS ELEVATION IS ASSUMED AND IS ONLY GOOD WITHIN THIS PROJECT.

SURVEY CONTROL

POINT #	NORTHING	EASTING	ELEVATION	DISCRIPTION	STATION	OFFSET
192	10342.71	9338.80	99.38	1.5"Ø ALUM. CAP (MURPH) ON 5/8"Ø REBAR	(12TH) 7+51.09	RT - 25.36
119	10525.95	9544.77	107.31	1.5"Ø ALUM. CAP (BRAUN) ON 5/8"Ø REBAR	(HOWKAN) 10+54.94	LT - 25.18
417	10313.26	9739.06	124.36	"PK" NAIL IN ASPHALT WEST OF FLAG POLES	(HOWKAN) 13+30.71	RT - 25.67
72	10469.42	9999.94	132.77	1.5"Ø ALUM. CAP (BRAUN) ON 5/8"Ø REBAR	(HOWKAN) 16+73.90	RT - 24.89
RP-1	10438.14	9753.09		CENTER LINE RADIUS POINT #1 HOWKAN	(HOWKAN) 12+68.27	LT - 100.00
RP-2	10439.76	9914.22		CENTER LINE RADIUS POINT #2 HOWKAN	(HOWKAN) 15+16.35	RT - 55.00
BC-C34	10329.93	10000.00		3"Ø BRASS CAP ON 2.5"Ø STEEL POST		
BC-C35	10000.00	10000.00		3"Ø BRASS CAP ON 2.5"Ø STEEL POST		

NOTE: FIELD VERIFY THAT HORIZONTAL AND VERTICAL CONTROL POINTS (192, 119, 417, 72) MATCH VALUES SHOWN IN THIS TABLE BEFORE CONSTRUCTION LAYOUT. CONFIRM VALUES WITH THE ENGINEER.

DRAWING:
PROJECT CONTROL
SURVEY INFORMATION

PROJECT:
12th, 13th & Howkan St. Sidewalk Project
Location
~PETERSBURG, ALASKA~

PETERSBURG INDIAN ASSOCIATION
P.O. BOX 1418, PETERSBURG, AK. 99833
(907) 772-3636

REVISIONS		
REV	DATE	DESCRIPTION

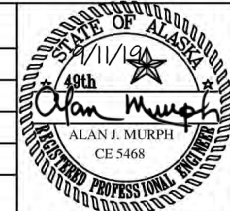

DESIGNED BY:
HARAI & ASSOCIATES, INC
P.O. BOX 625, PETERSBURG, ALASKA 99833

DATE: FEBRUARY, 2019

SHEET NUMBER	TOTAL SHEETS
15	22

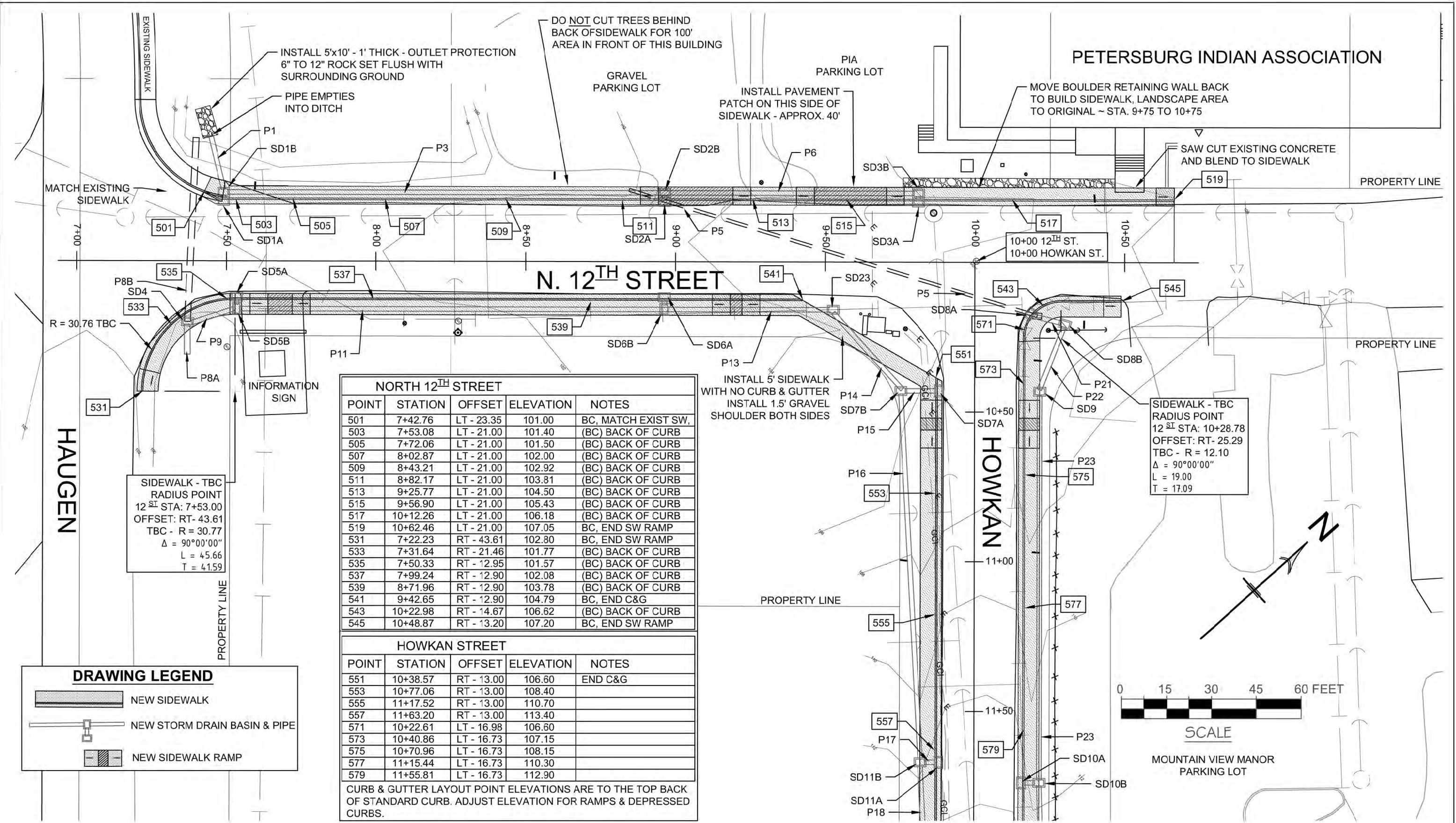

NORTH 12 TH STREET				
POINT	STATION	OFFSET	ELEVATION	NOTES
501	7+42.76	LT - 23.35	101.00	BC, MATCH EXIST SW.
503	7+53.08	LT - 21.00	101.40	(BC) BACK OF CURB
505	7+72.06	LT - 21.00	101.50	(BC) BACK OF CURB
507	8+02.87	LT - 21.00	102.00	(BC) BACK OF CURB
509	8+43.21	LT - 21.00	102.92	(BC) BACK OF CURB
511	8+82.17	LT - 21.00	103.81	(BC) BACK OF CURB
513	9+25.77	LT - 21.00	104.50	(BC) BACK OF CURB
515	9+56.90	LT - 21.00	105.43	(BC) BACK OF CURB
517	10+12.26	LT - 21.00	106.18	(BC) BACK OF CURB
519	10+62.46	LT - 21.00	107.05	BC, END SW RAMP
531	7+22.23	RT - 43.61	102.80	BC, END SW RAMP
533	7+31.64	RT - 21.46	101.77	(BC) BACK OF CURB
535	7+50.33	RT - 12.95	101.57	(BC) BACK OF CURB
537	7+99.24	RT - 12.90	102.08	(BC) BACK OF CURB
539	8+71.96	RT - 12.90	103.78	(BC) BACK OF CURB
541	9+42.65	RT - 12.90	104.79	BC, END C&G
543	10+22.98	RT - 14.67	106.62	(BC) BACK OF CURB
545	10+48.87	RT - 13.20	107.20	BC, END SW RAMP

HOWKAN STREET				
POINT	STATION	OFFSET	ELEVATION	NOTES
551	10+38.57	RT - 13.00	106.60	END C&G
553	10+77.06	RT - 13.00	108.40	
555	11+17.52	RT - 13.00	110.70	
557	11+63.20	RT - 13.00	113.40	
571	10+22.61	LT - 16.98	106.60	
573	10+40.86	LT - 16.73	107.15	
575	10+70.96	LT - 16.73	108.15	
577	11+15.44	LT - 16.73	110.30	
579	11+55.81	LT - 16.73	112.90	

CURB & GUTTER LAYOUT POINT ELEVATIONS ARE TO THE TOP BACK OF STANDARD CURB. ADJUST ELEVATION FOR RAMPS & DEPRESSED CURBS.

SIDEWALK - TBC
RADIUS POINT
12ST STA: 7+53.00
OFFSET: RT- 43.61
TBC - R = 30.77
 $\Delta = 90^{\circ}00'00''$
L = 45.66
T = 41.59

SIDEWALK - TBC
RADIUS POINT
12ST STA: 10+28.78
OFFSET: RT- 25.29
TBC - R = 12.10
 $\Delta = 90^{\circ}00'00''$
L = 19.00
T = 17.09

DRAWING LEGEND

- NEW SIDEWALK
- NEW STORM DRAIN BASIN & PIPE
- NEW SIDEWALK RAMP

DRAWING:
Curb & Gutter
Layout - 12th St.

PROJECT:
12th, 13th & Howkan St. Sidewalk Project
Location
~PETERSBURG, ALASKA~

PETERSBURG INDIAN ASSOCIATION
P.O. BOX 1418, PETERSBURG, AK. 99833
(907) 772-3636

REVISIONS		
REV	DATE	DESCRIPTION

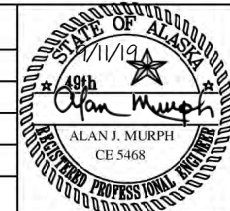

DESIGNED BY:
HARAI & ASSOCIATES, INC
P.O. BOX 625, PETERSBURG, ALASKA 99833

DATE: FEBRUARY, 2019

SHEET NUMBER	TOTAL SHEETS
16	22

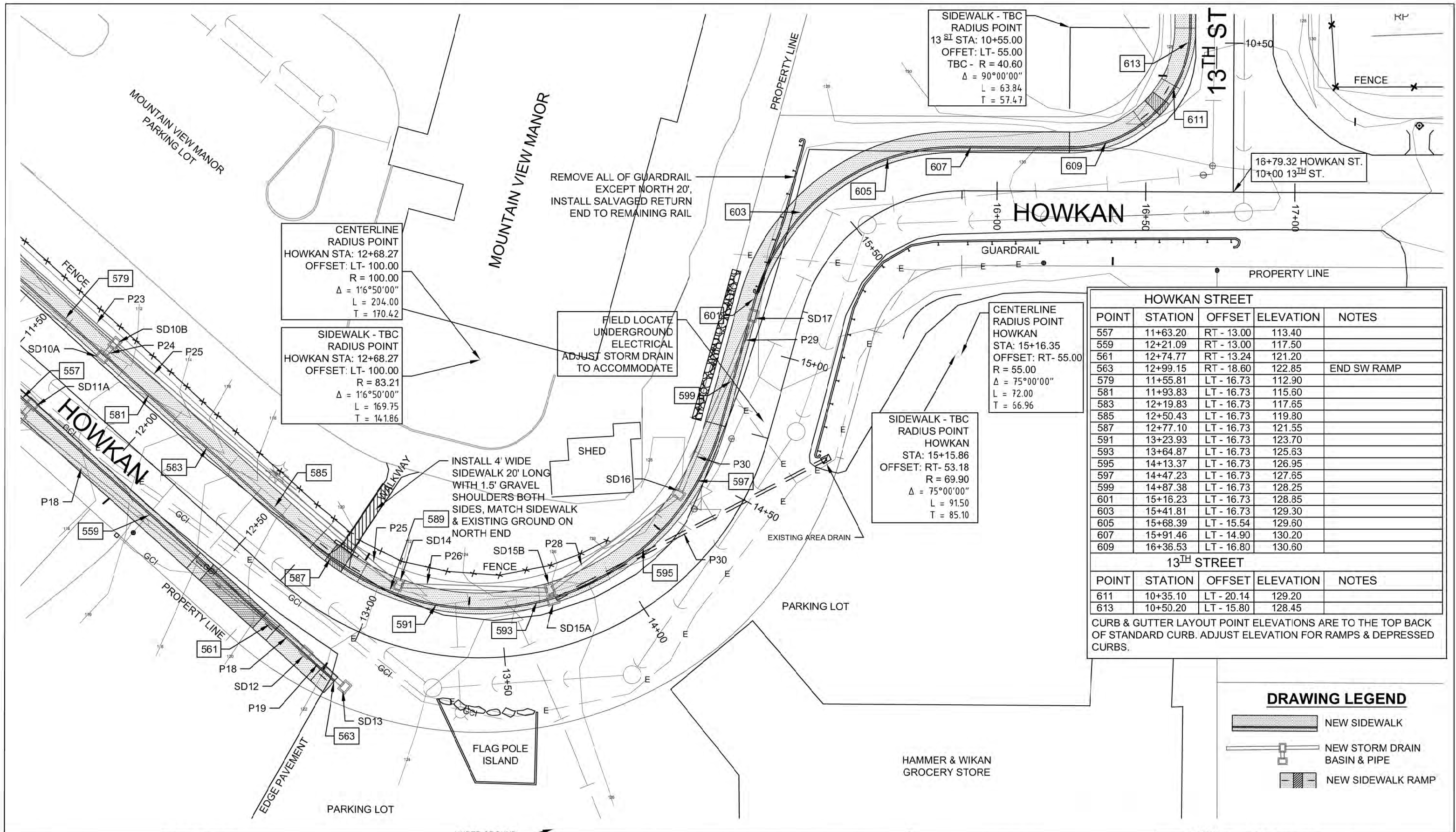

CENTERLINE
RADIUS POINT
HOWKAN STA: 12+68.27
OFFSET: LT- 100.00
R = 100.00
 $\Delta = 1'6''50''00''$
L = 204.00
T = 170.42

SIDEWALK - TBC
RADIUS POINT
HOWKAN STA: 12+68.27
OFFSET: LT- 100.00
R = 83.21
 $\Delta = 1'6''50''00''$
L = 169.75
T = 141.86

SIDEWALK - TBC
RADIUS POINT
13th STA: 10+55.00
OFFSET: LT- 55.00
TBC - R = 40.60
 $\Delta = 90''00''00''$
L = 63.84
T = 57.47

REMOVE ALL OF GUARDRAIL
EXCEPT NORTH 20',
INSTALL SALVAGED RETURN
END TO REMAINING RAIL

FIELD LOCATE
UNDERGROUND
ELECTRICAL
ADJUST STORM DRAIN
TO ACCOMMODATE

CENTERLINE
RADIUS POINT
HOWKAN
STA: 15+16.35
OFFSET: RT- 55.00
R = 55.00
 $\Delta = 75''00''00''$
L = 72.00
T = 56.96

SIDEWALK - TBC
RADIUS POINT
HOWKAN
STA: 15+15.86
OFFSET: RT- 53.18
R = 69.90
 $\Delta = 75''00''00''$
L = 91.50
T = 85.10

INSTALL 4' WIDE
SIDEWALK 20' LONG
WITH 1.5' GRAVEL
SHOULDERS BOTH
SIDES, MATCH SIDEWALK
& EXISTING GROUND ON
NORTH END

HOWKAN STREET				
POINT	STATION	OFFSET	ELEVATION	NOTES
557	11+63.20	RT - 13.00	113.40	
559	12+21.09	RT - 13.00	117.50	
561	12+74.77	RT - 13.24	121.20	
563	12+99.15	RT - 18.60	122.85	END SW RAMP
579	11+55.81	LT - 16.73	112.90	
581	11+93.83	LT - 16.73	115.60	
583	12+19.83	LT - 16.73	117.65	
585	12+50.43	LT - 16.73	119.80	
587	12+77.10	LT - 16.73	121.55	
591	13+23.93	LT - 16.73	123.70	
593	13+64.87	LT - 16.73	125.63	
595	14+13.37	LT - 16.73	126.95	
597	14+47.23	LT - 16.73	127.65	
599	14+87.38	LT - 16.73	128.25	
601	15+16.23	LT - 16.73	128.85	
603	15+41.81	LT - 16.73	129.30	
605	15+68.39	LT - 15.54	129.60	
607	15+91.46	LT - 14.90	130.20	
609	16+36.53	LT - 16.80	130.60	

13 th STREET				
POINT	STATION	OFFSET	ELEVATION	NOTES
611	10+35.10	LT - 20.14	129.20	
613	10+50.20	LT - 15.80	128.45	

CURB & GUTTER LAYOUT POINT ELEVATIONS ARE TO THE TOP BACK OF STANDARD CURB. ADJUST ELEVATION FOR RAMPS & DEPRESSED CURBS.

DRAWING LEGEND

- NEW SIDEWALK
- NEW STORM DRAIN BASIN & PIPE
- NEW SIDEWALK RAMP

DRAWING:
Curb & Gutter
Layout - Howkan

PROJECT:
12th, 13th & Howkan St. Sidewalk Project
Location
~PETERSBURG, ALASKA~

PETERSBURG INDIAN ASSOCIATION
P.O. BOX 1418, PETERSBURG, AK. 99833
(907) 772-3636

REVISIONS

REV	DATE	DESCRIPTION

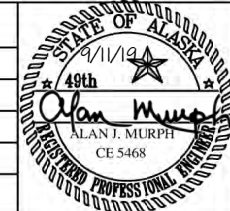

DESIGNED BY:
HARAI & ASSOCIATES, INC
P.O. BOX 625, PETERSBURG, ALASKA 99833
DATE: FEBRUARY, 2019

SHEET NUMBER	TOTAL SHEETS
17	22

HOWKAN STREET				
POINT	STATION	OFFSET	ELEVATION	NOTES
603	15+41.81	LT - 16.73	129.30	
605	15+68.39	LT - 15.54	129.60	
607	15+91.46	LT - 14.90	130.20	
609	16+36.53	LT - 16.80	130.60	

13 TH STREET				
POINT	STATION	OFFSET	ELEVATION	NOTES
611	10+35.10	LT - 20.14	129.20	
613	10+50.20	LT - 15.80	128.45	
615	11+23.19	LT - 14.89	127.45	
617	11+56.46	LT - 14.89	125.75	
619	11+98.25	LT - 14.89	124.75	
621	12+52.98	LT - 14.89	123.40	
623	12+90.51	LT - 14.89	122.50	
625	13+39.78	LT - 14.89	121.50	
627	13+63.93	LT - 14.89	120.90	
629	13+83.26	LT - 14.89	120.40	END SW RAMP

CURB & GUTTER LAYOUT POINT ELEVATIONS ARE TO THE TOP BACK OF STANDARD CURB. ADJUST ELEVATION FOR RAMPS & DEPRESSED CURBS.

SIDEWALK - TBC
 RADIUS POINT
 13TH STA: 10+55.00
 OFFSET: LT- 55.00
 TBC - R = 40.60
 $\Delta = 90^{\circ}00'00''$
 L = 63.84
 T = 57.47

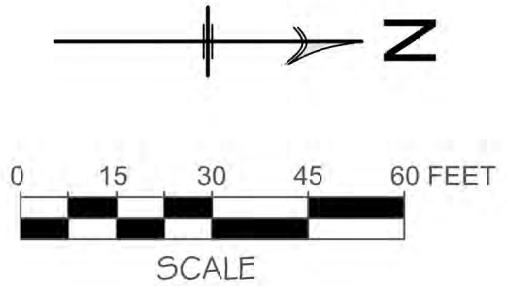
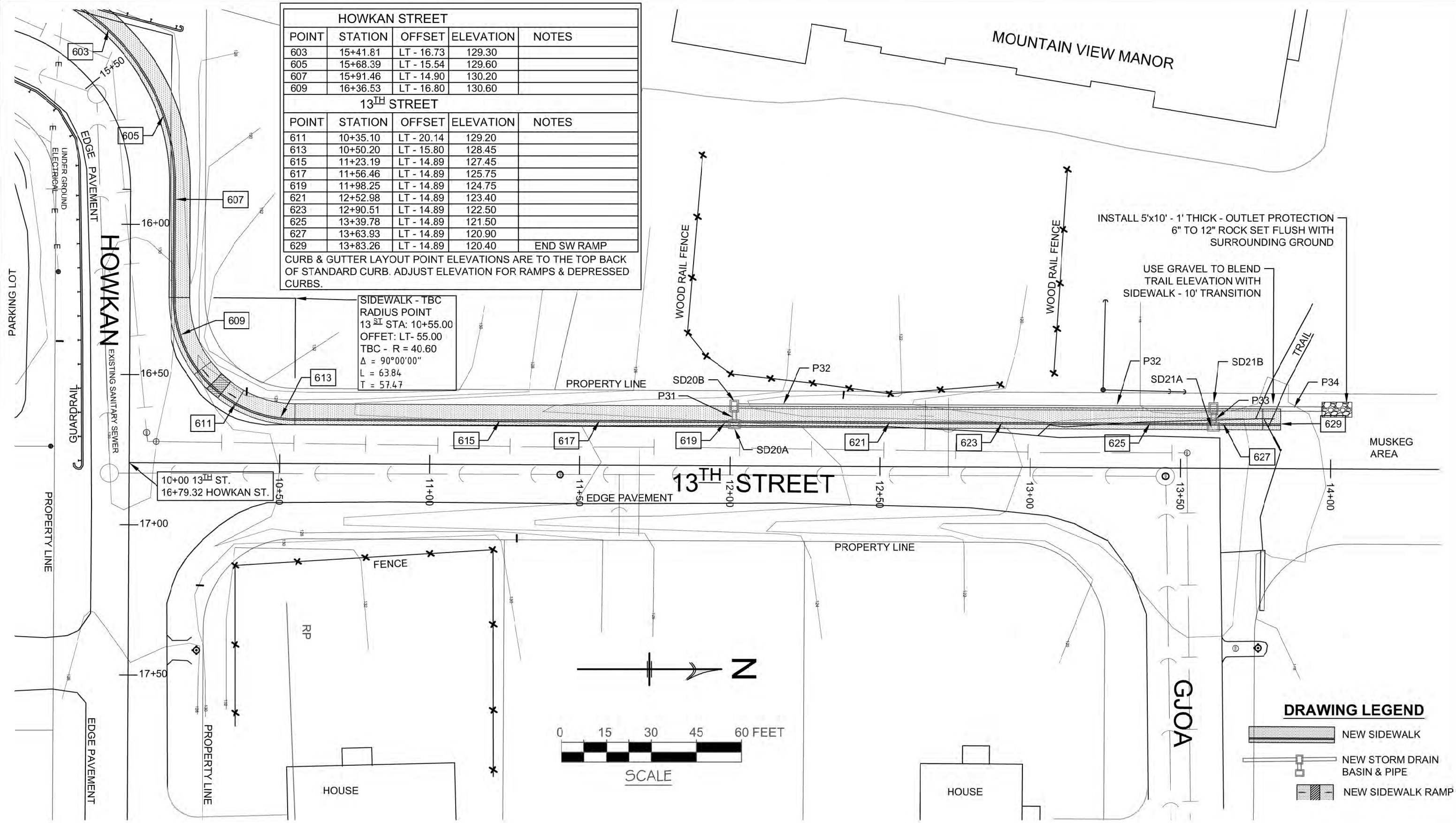

DRAWING LEGEND

	NEW SIDEWALK
	NEW STORM DRAIN BASIN & PIPE
	NEW SIDEWALK RAMP

DRAWING:
 Curb & Gutter
 Layout - 13th St.

PROJECT:
 12th, 13th & Howkan St. Sidewalk Project
 Location
 ~PETERSBURG, ALASKA~

PETERSBURG INDIAN ASSOCIATION
 P.O. BOX 1418, PETERSBURG, AK. 99833
 (907) 772-3636

REVISIONS

REV	DATE	DESCRIPTION

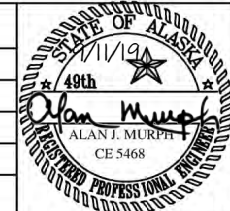

DESIGNED BY:
 HARAI & ASSOCIATES, INC
 P.O. BOX 625, PETERSBURG, ALASKA 99833

DATE: FEBRUARY, 2019

SHEET NUMBER	TOTAL SHEETS
18	22

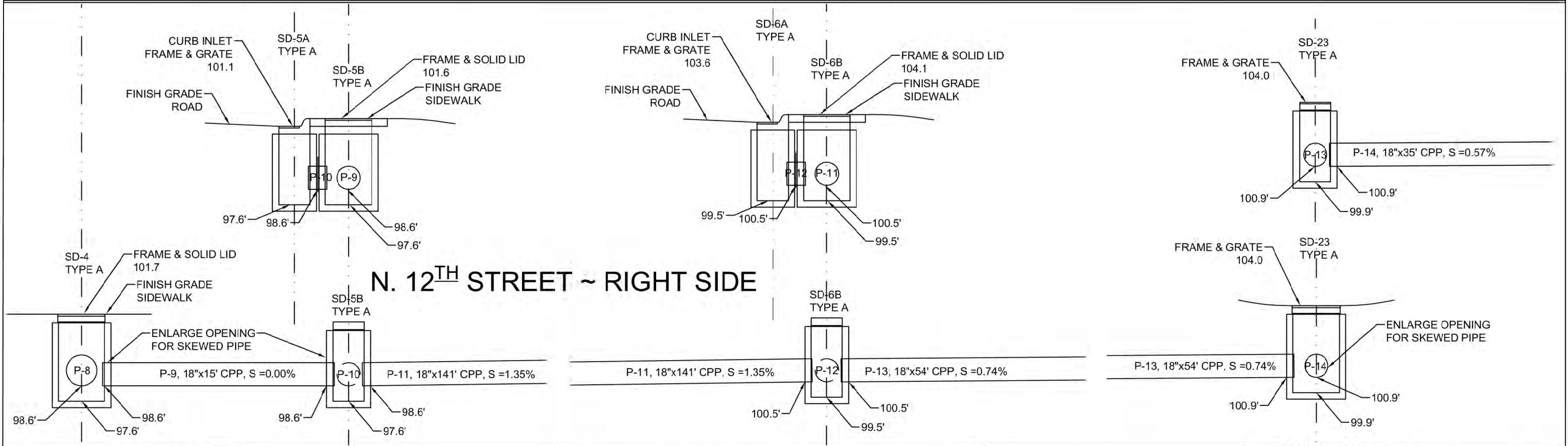
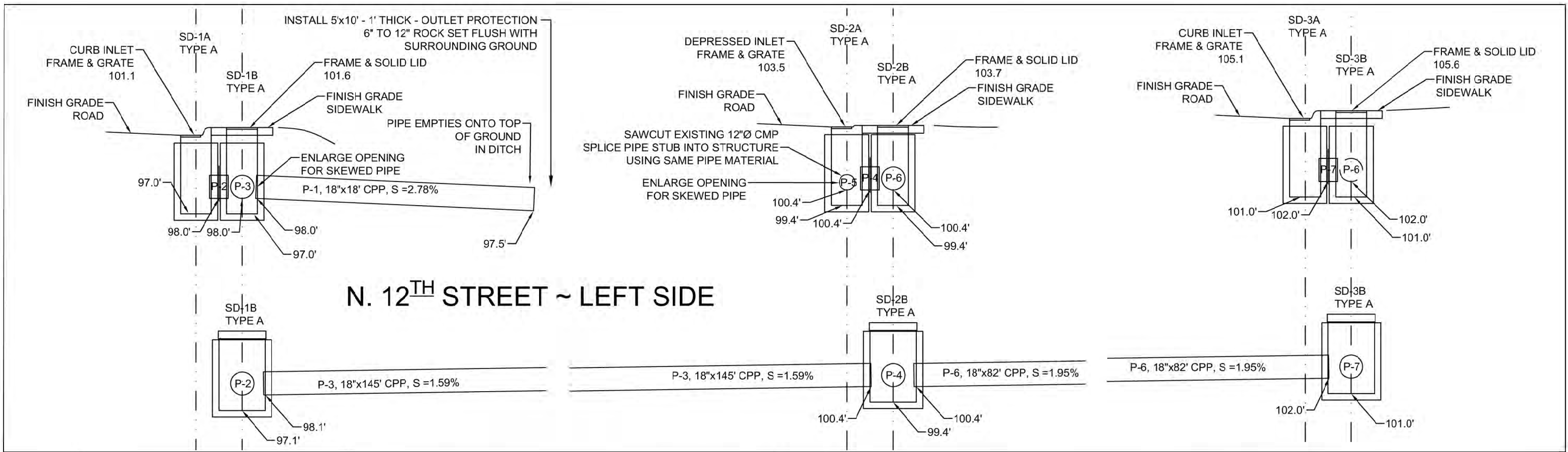

DRAWING:
STORM DRAIN
DETAILS
12th Street

PROJECT:
12th, 13th & Howkan St. Sidewalk Project
Location
~PETERSBURG, ALASKA~

**PETERSBURG INDIAN
ASSOCIATION**
P.O. BOX 1418, PETERSBURG, AK. 99833
(907) 772-3636

REVISIONS		
REV	DATE	DESCRIPTION

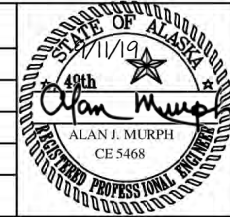

DESIGNED BY:
HARAI & ASSOCIATES, INC
P.O. BOX 625, PETERSBURG, ALASKA 99833
DATE: FEBRUARY, 2019

SHEET NUMBER	TOTAL SHEETS
19	22

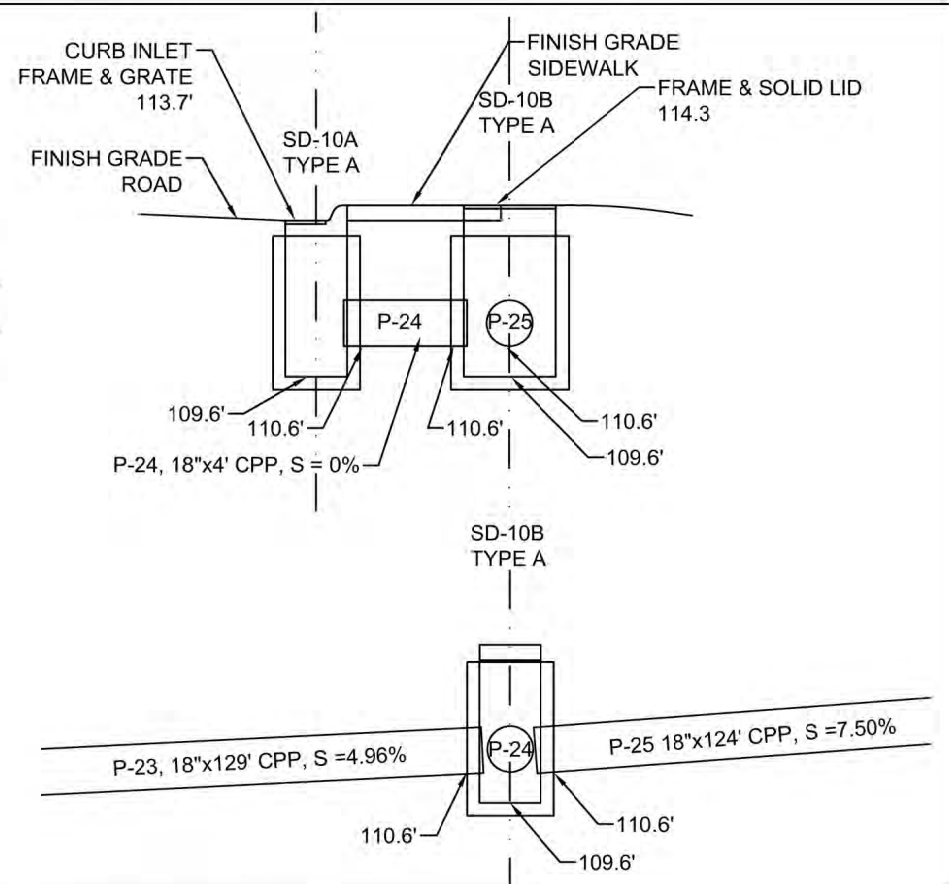
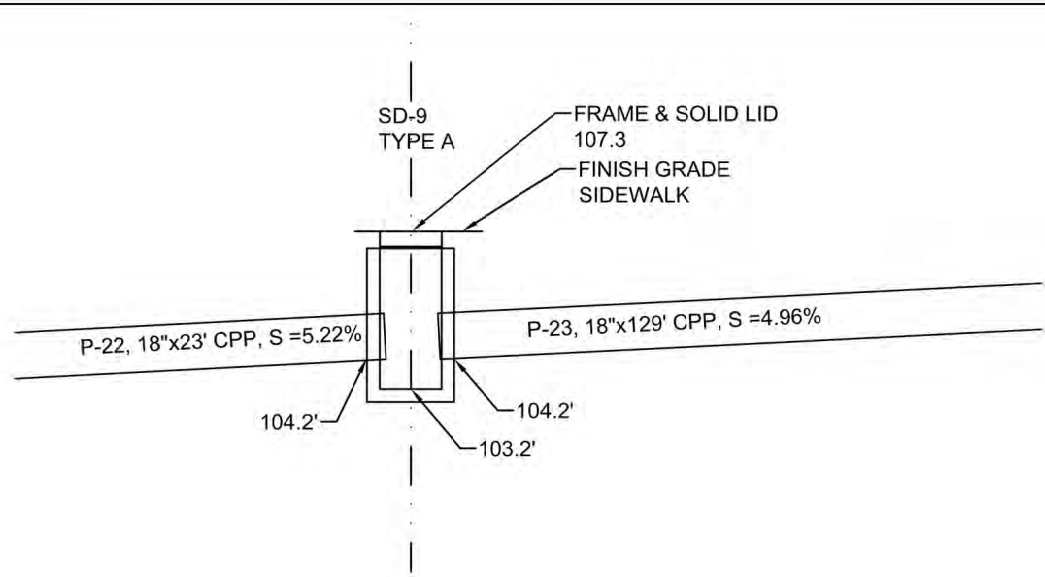
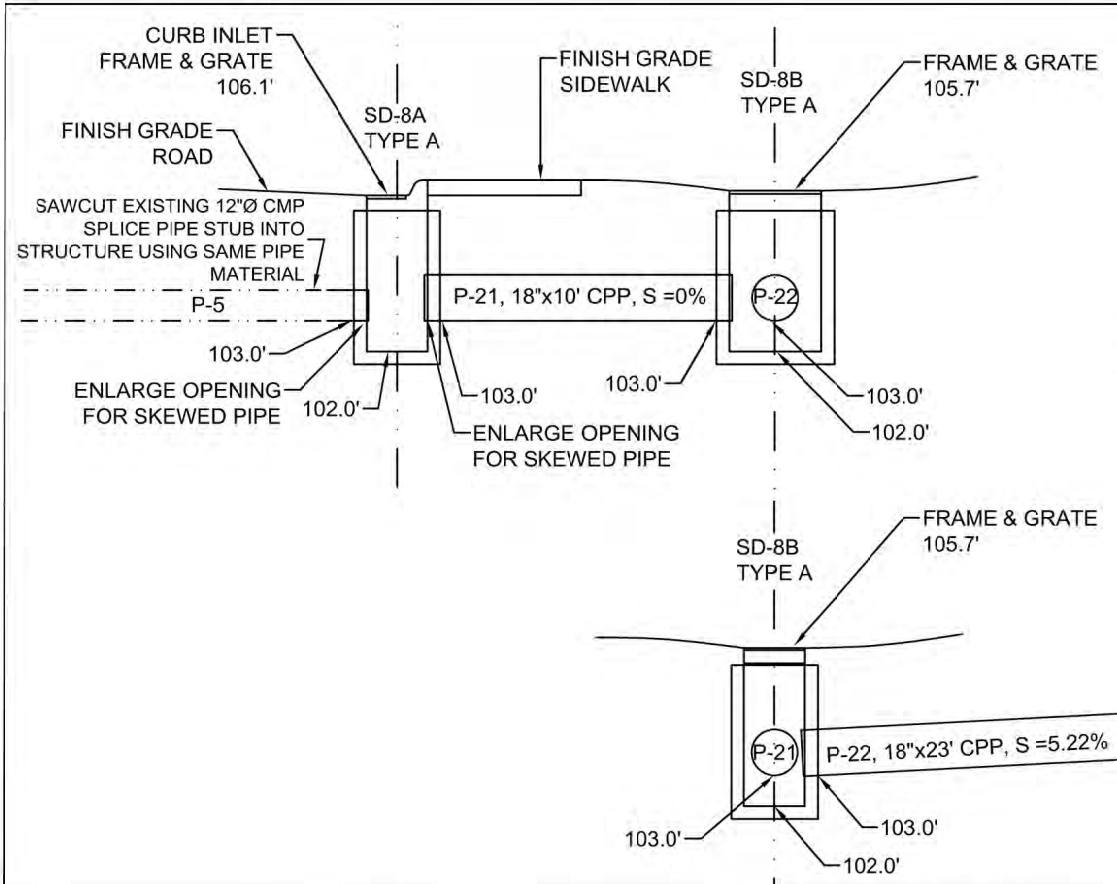

HOWKAN STREET ~ LEFT SIDE

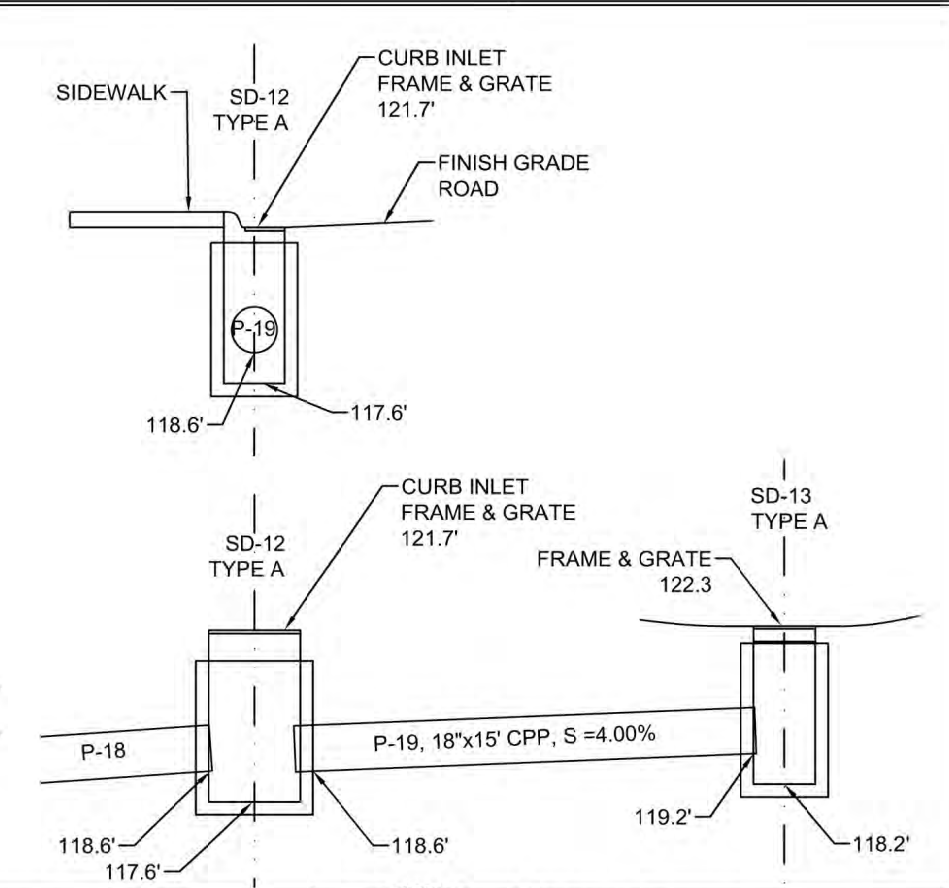
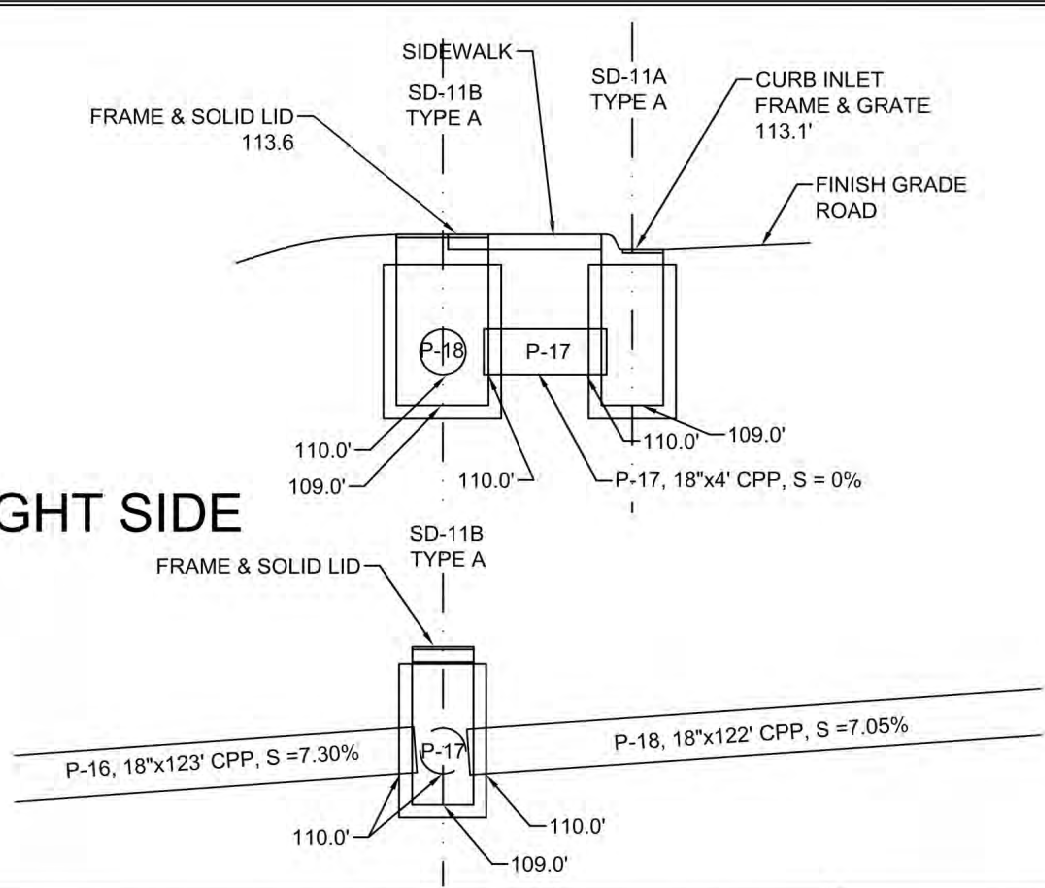
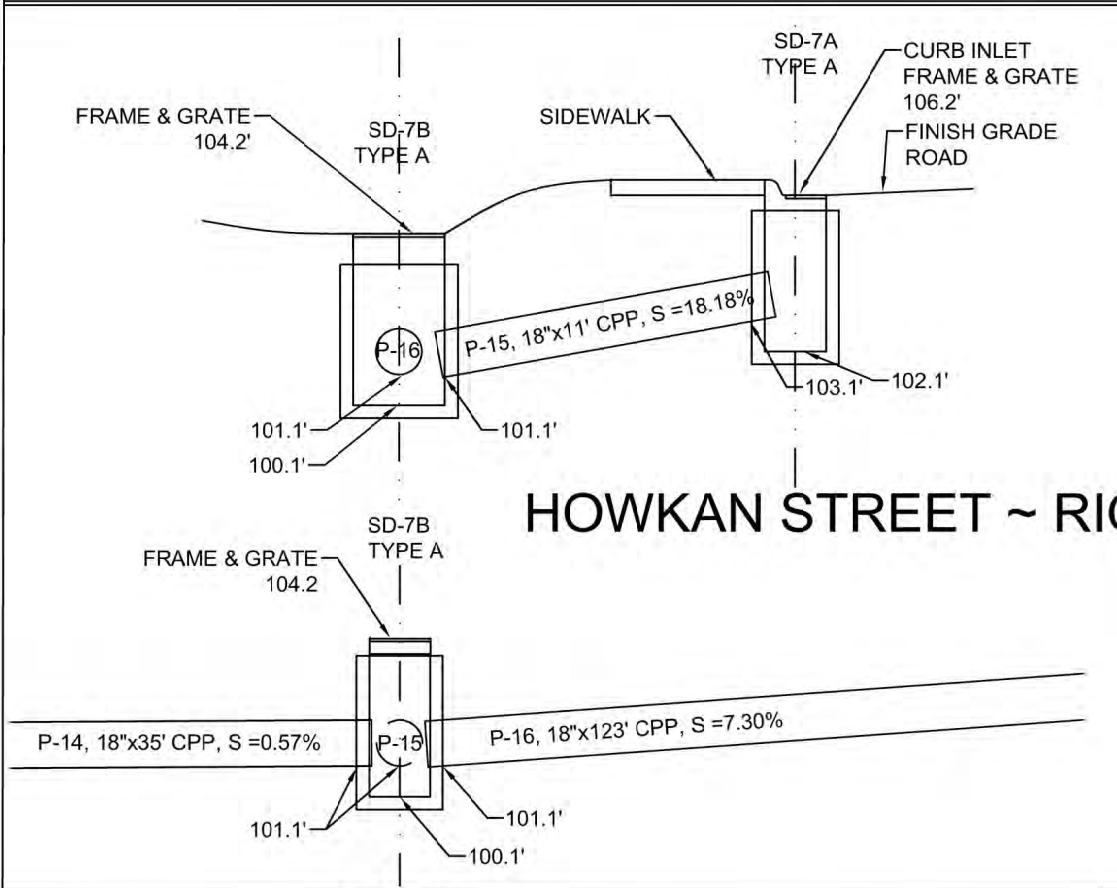

HOWKAN STREET ~ RIGHT SIDE

DRAWING:
STORM DRAIN
DETAILS
Howkan Street

PROJECT:
12th, 13th & Howkan St. Sidewalk Project
Location
~PETERSBURG, ALASKA~

PETERSBURG INDIAN ASSOCIATION
P.O. BOX 1418, PETERSBURG, AK. 99833
(907) 772-3636

REVISIONS		
REV	DATE	DESCRIPTION

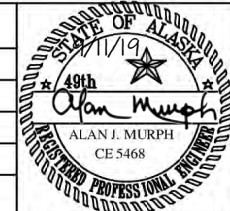

DESIGNED BY:
HARAI & ASSOCIATES, INC
P.O. BOX 625, PETERSBURG, ALASKA 99833

DATE: FEBRUARY, 2019

SHEET NUMBER	TOTAL SHEETS
20	22

HOWKAN STREET ~ LEFT SIDE

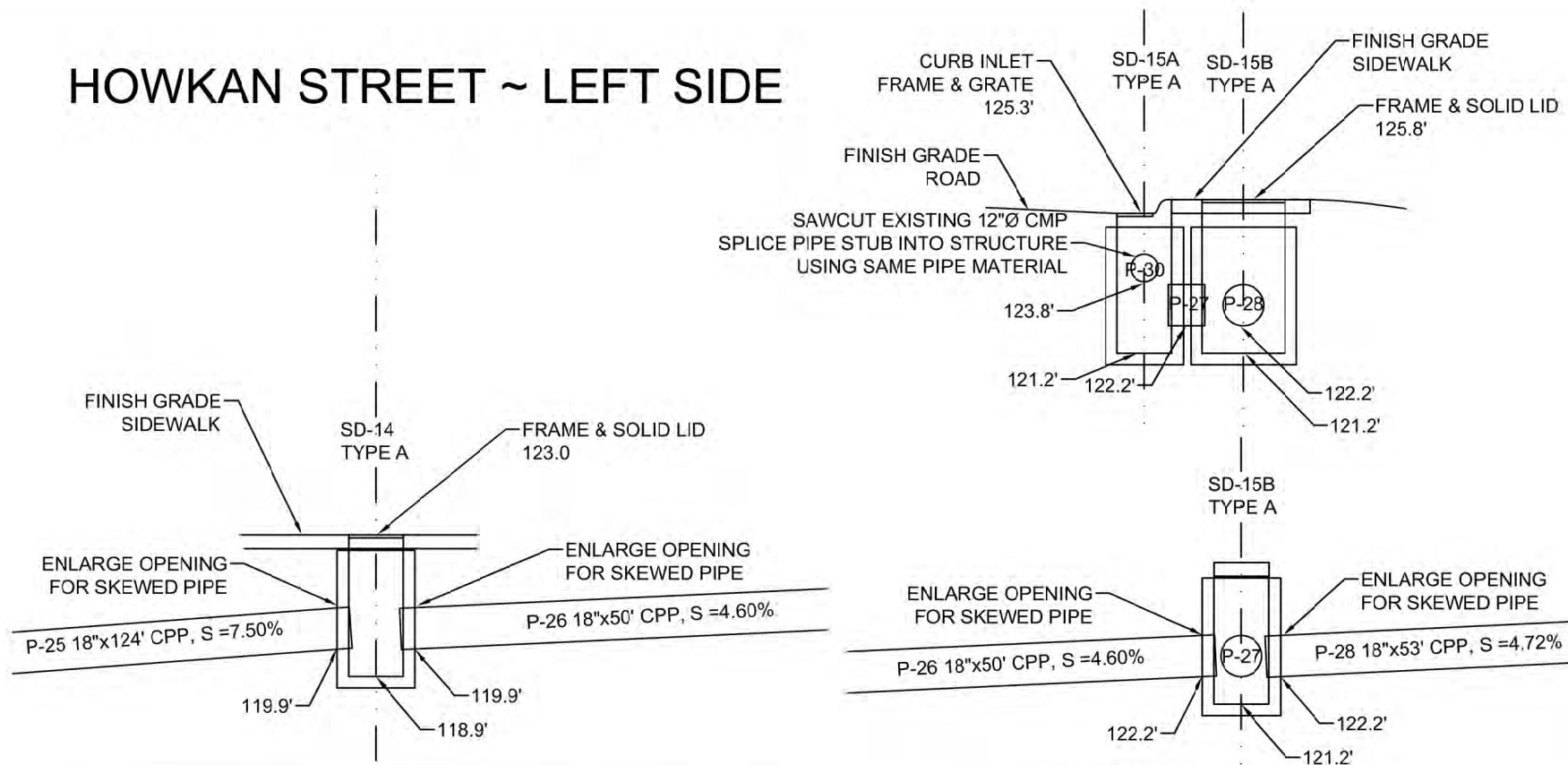

13TH STREET LEFT SIDE

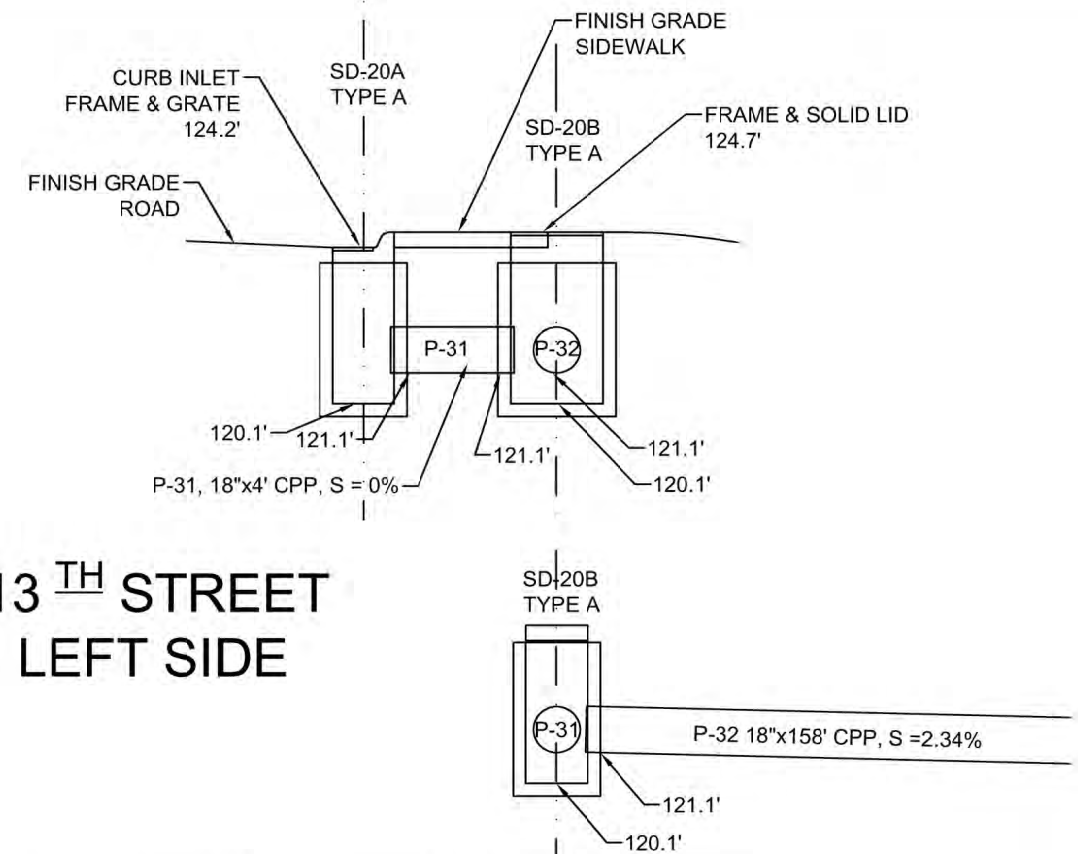

HOWKAN STREET ~ LEFT SIDE

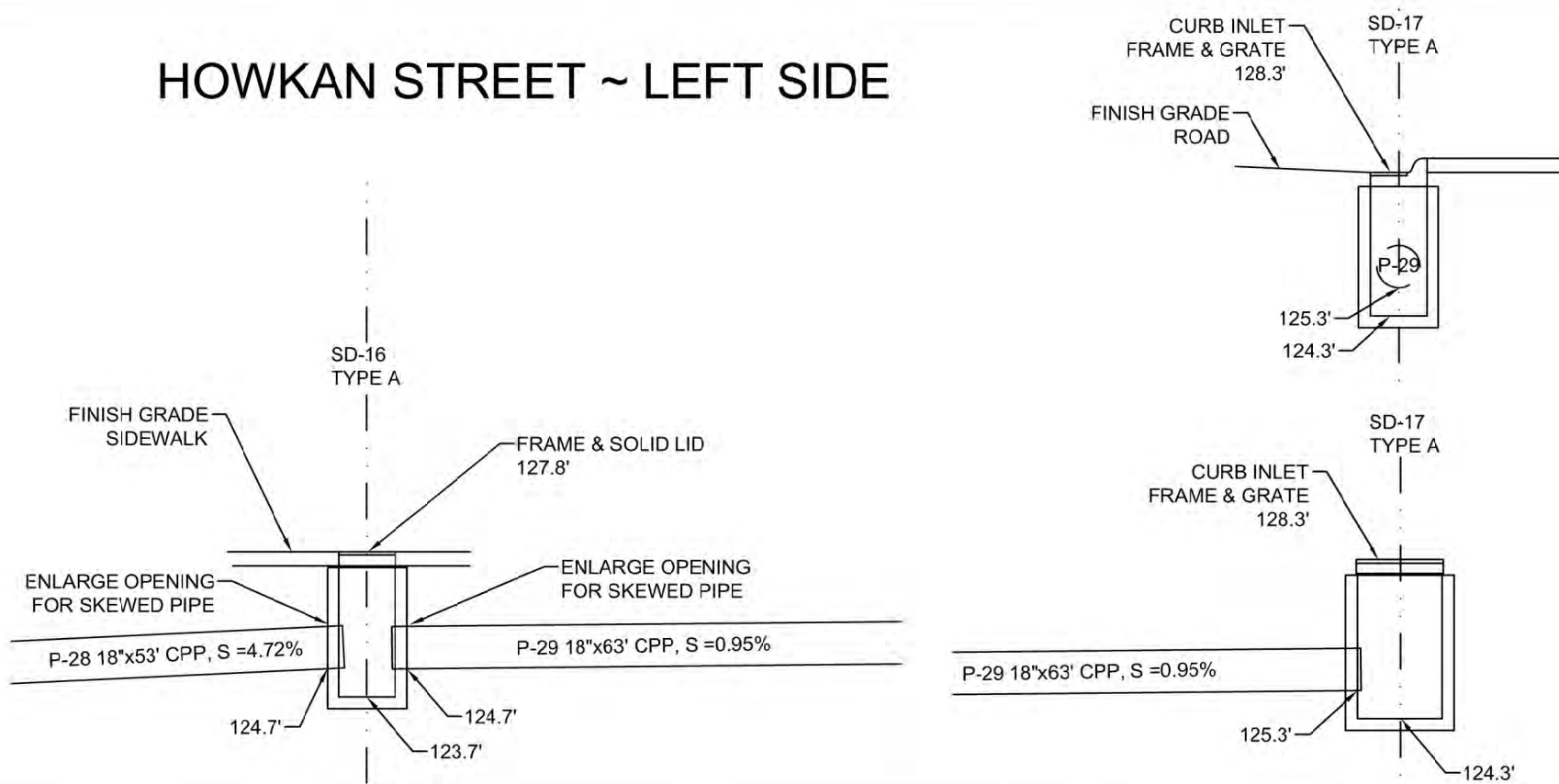

13TH STREET LEFT SIDE

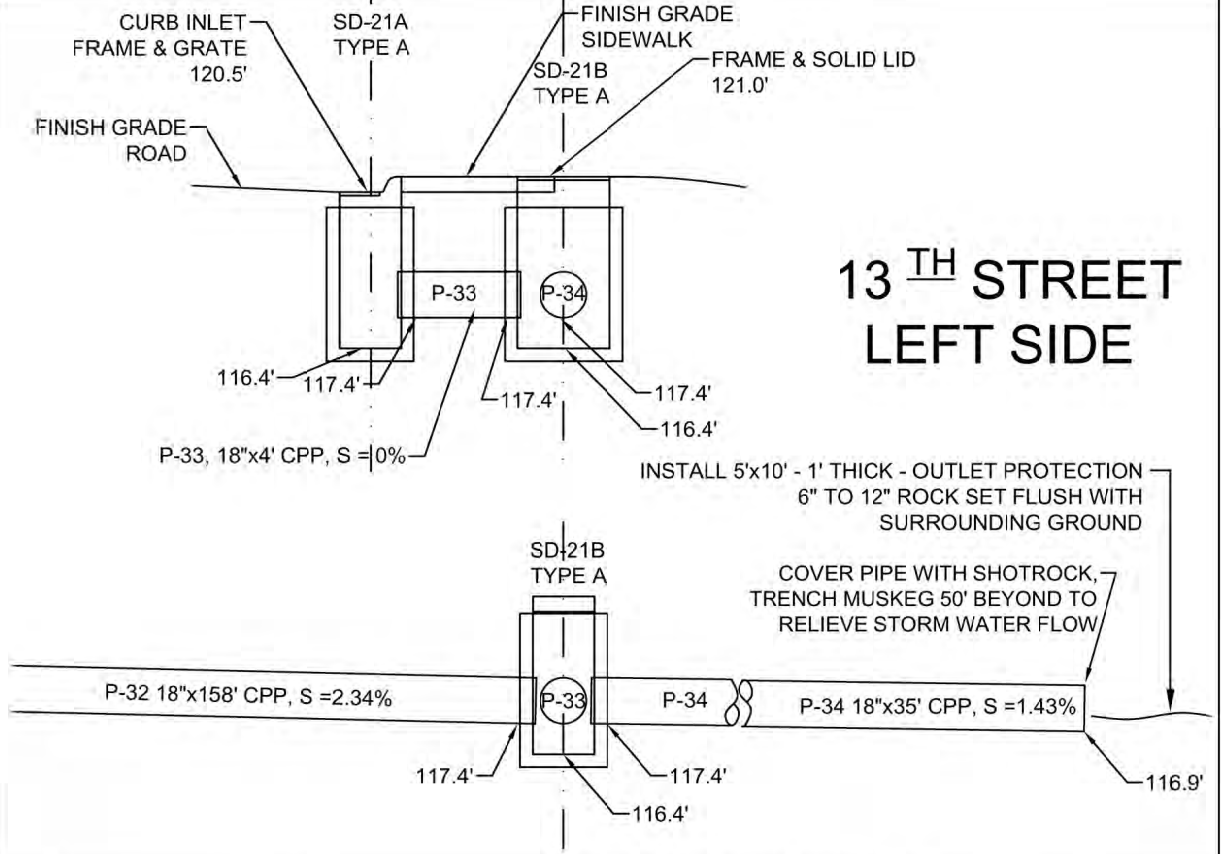

DRAWING:
STORM DRAIN
DETAILS
Howkan & 13th St.

PROJECT:
12th, 13th & Howkan St. Sidewalk Project
Location
~PETERSBURG, ALASKA~

PETERSBURG INDIAN ASSOCIATION
P.O. BOX 1418, PETERSBURG, AK. 99833
(907) 772-3636

REVISIONS		
REV	DATE	DESCRIPTION

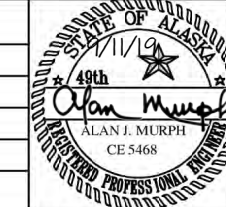

DESIGNED BY:
HARAI & ASSOCIATES, INC
P.O. BOX 625, PETERSBURG, ALASKA 99833
DATE: FEBRUARY, 2019
SHEET NUMBER 21 TOTAL SHEETS 22



W20-7a
36"x36"



W3-4
36"x36"



W20-1
36"x36"



W20-4
36"x36"

A COMBINATION OF THE SIGNS SHOWN TO THE LEFT WILL BE USED FOR TRAFFIC CONTROL ON THIS PROJECT. THE COMBINATION AND THE SPACING WILL BE DICTATED BY THE LOCATION OF THE WORK AREA. THIS WILL BE SHOWN IN THE TRAFFIC CONTROL PLAN THAT THE CONTRACTOR SUBMITS TO THE ENGINEER FOR APPROVAL.

KEEP SIGNS WITHIN THE BLOCK AND SPACE DISTANCES EQUALLY BETWEEN



TRAFFIC CONTROL NOTES

1. THE CONTRACTOR SHALL SUBMIT FOR APPROVAL A TRAFFIC CONTROL PLAN TO THE ENGINEER 48 HOURS BEFORE START OF CONSTRUCTION. TRAFFIC CONTROL PLAN SHALL CONFORM TO THE REQUIREMENTS OF "MUTCD".
2. MINIMUM OF ONE LANE SHALL REMAIN OPEN AT ALL TIMES IN WORK AREAS, EXCEPT WHERE THERE IS A ONE WAY STREET, THEN THE STREET SHALL BE TEMPORARILY CLOSED.
3. TEMPORARY DRIVING LANES SHALL HAVE A MINIMUM WIDTH OF 10'.
4. CONSTRUCTION SIGNING SHALL BE IN PLACE ONLY WHEN THE CONDITIONS EXIST FOR WHICH THE SIGNS ARE INTENDED.
5. DRIVEWAYS MAY BE CLOSED DURING ACTUAL WORK ON A GIVEN DRIVEWAY, PROVIDED THAT THE CLOSURE DOES NOT EXCEED 8 HOURS AND THE AFFECTED RESIDENTS HAVE BEEN GIVEN 24 HOURS NOTICE OF THE CLOSURE.
6. THE CONTRACTOR SHALL KEEP THE PUBLIC INFORMED OF HIS CONSTRUCTION ACTIVITIES THROUGH THE USE OF THE LOCAL NEWS MEDIA. NEWS RELEASES SHALL BE APPROVED BY THE PROJECT ENGINEER PRIOR TO THEIR RELEASE. NEWS RELEASES WILL BE REQUIRED BY NOT LIMITED TO: THE ONSET OF WORK, AND CHANGES IN THE LANE CONFIGURATIONS.
7. THE CONTRACTOR MUST PROVIDE PEDESTRIANS WITH ROUTE THROUGH WORK ZONE.
8. DELAY OF TRAFFIC MUST 5 MINUTES OR LESS. IF DELAY EXCEEDS 5 MINUTES, THE CONTRACTOR MUST REDUCE SIZE OF WORK ZONE.
9. FLAGGERS WILL BE USED ANY TIME THERE IS CONSTRUCTION IN THE ROADWAY. MINIMUM OF TWO FLAGGERS ARE REQUIRED UNLESS APPROVED BY THE ENGINEER. ALL ROADWAY CONSTRUCTION WILL REQUIRE FLAGGERS EXCEPT 13TH STREET. ONLY SIGNAGE WILL BE NECESSARY ON 13TH STREET.
10. ALL WORK SHALL CONFORM TO THE US DEPT OF TRANSPORTATION FEDERAL HIGHWAY ADMINISTRATION MANUAL ON UNIFORM TRAFFIC CONTROL DEVICES FOR STREETS AND HIGHWAYS.
11. MAINTAIN ACCESS TO BUSINESSES AND RESIDENCES AS NECESSARY THROUGH THE CONSTRUCTION SITE IN ACCORDANCE WITH ADA REQUIREMENTS.

DRAWING:
TRAFFIC CONTROL

PROJECT:
12th, 13th & Howkan St. Sidewalk Project
Location
~PETERSBURG, ALASKA~

PETERSBURG INDIAN ASSOCIATION
P.O. BOX 1418, PETERSBURG, AK. 99833
(907) 772-3636

REVISIONS		
REV	DATE	DESCRIPTION

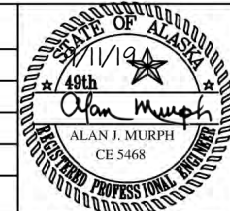

DESIGNED BY:
HARAI & ASSOCIATES, INC
P.O. BOX 625, PETERSBURG, ALASKA 99833
DATE: FEBRUARY, 2019

SHEET NUMBER	TOTAL SHEETS
22	22