



Sreeredy Properties Private Limited.,

SREE REDDY HOMES

Kammanahalli



SREE REDDY HOMES

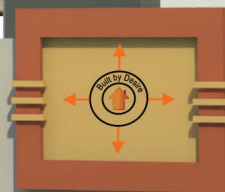

Elevation may change as per site condition

Plans and measurements may change as per site condition

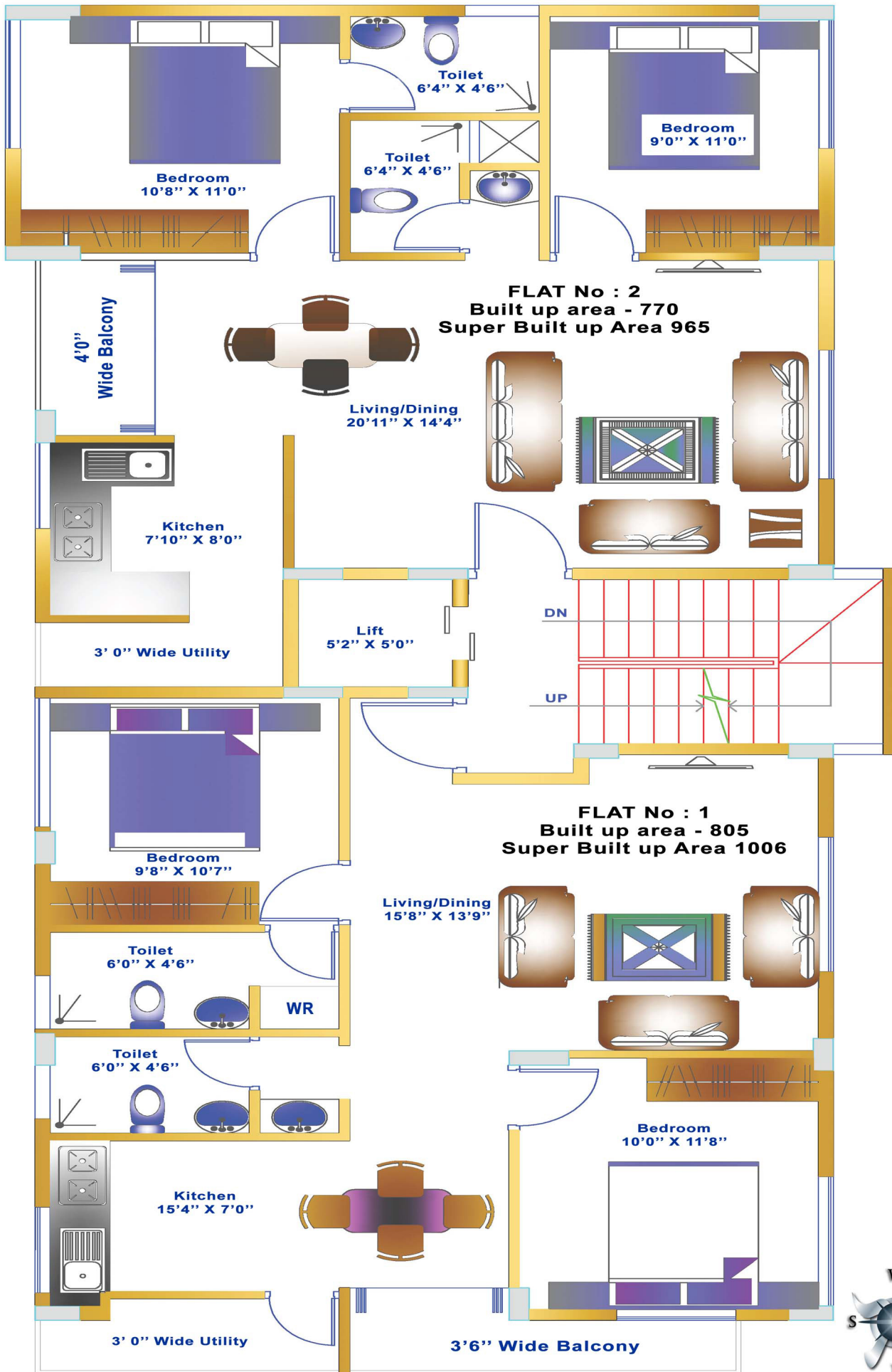

Road

Amenities:

Lift
Solar Water Heater
Reserved Parking
Power Back up for common area and Partly to Flats
24 hrs Water Supply
Cauvery Water
Bore well Water
Automatic water filling system for overhead tanks and sumps.
Separate Sump and Overhead Tank for Cauvery Water and Bore Well Water
24 Hour Security
Intercom Facility
Car Wash Facility
Toilet Facilities for Drivers in the Basement Floor

Advantages:

Fully Vitrified flooring
Solar and Geyser diverter in the bathroom
24 hours back for common area
Good cross ventilation in the flat
Lightning protection system in accordance with Indian standard
Separate Cauvery Water connection to kitchen
All corner flats
2 Flats per floor
Near To Dr.RajKumar Park, HRBR Layout (Pure Cow Milk Available Near to Park in Morning and Evening)
Fully Developed Area.

SPECIFICATIONS

Structure

RCC framed structure
External 6' Solid Blocks and Internal walls of 4" solid concrete blocks.
External walls with cement plaster and internal walls with cement plaster finished smooth with lime.
Terrace- Waterproofing with cement mortar mixer with water-proof chemicals.
Basement, Pathways and driveways finished with pavement blocks concrete or cement flooring.

Doors

Main doors- Teak frame and OST designed door with SS hardware door fittings or equivalent.
Other doors- wooden frame and door with molted panel doors with SS hardware door fittings or equivalent.
Toilet and Balcony doors- Flush door commercial painted with SS hardware door fittings or equivalent.

Kitchen

20mm polished granite counter platform with stainless steel sink with drain bord. Printed ceramic glazed dading tiles up to 2 feet above counter.

Power Supply and Electrical

Anchor or equivalent electric wiring.
Anchor or equivalent modular switches.
Telephone and TV points in living and Master bedroom.
Individual Electrical meter for each flat.

Parking

One Covered car parking for each flat in basement floor

Water Supply

Kaveri Water (BWSSB) to kitchen
Bore well water to toilet.

Flooring

2 x 2 Premium quality vitrified tiles in living & dining and bedrooms.
Anti skid Ceramic flooring for bathrooms and printer ceramic tiles for walls upto 7 feet height.
Granite/marble/vitrified in entrance lobby, staircase.

Windows

3 Track aluminum powder coated aluminum framed sliding windows with clear glass with designed painted safety grills with mosquito net shutter.

Bathrooms

Anti skid Ceramic flooring for bathrooms and printer ceramic tiles for walls upto 7 feet height.
Jaguar/Hindustan / Parry ware or equivalent sanity ware and Jaguar or equivalent chrome plated fittings.

Painting

Internal Walls-Oil bound distemper for all internal walls
External Walls- Apex paint for exteriors walls.

Backup Generator

A stand by generator supports lighting of common areas, Lift in the event of power failure. It also supports two points in each flat

Previous project



Sree Dhanyatha
Banaswadi



Sree Makkuntam
Banaswadi

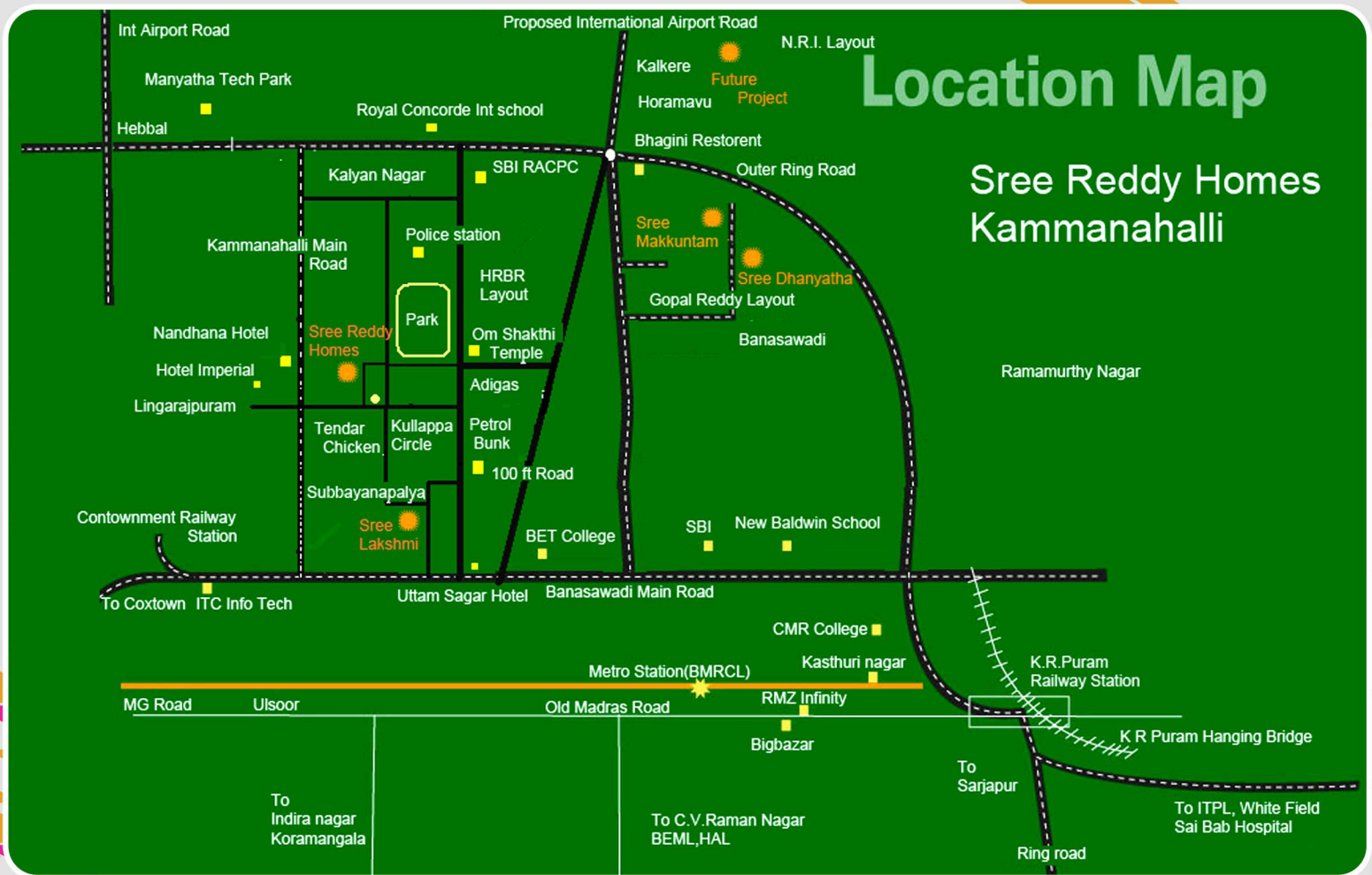

Location Map

Sree Reddy Homes Kammanahalli

Distance

Manyatha Tech Park 5

Metro station BMRCL 3.5

Banaswadi Railway station 2

K R Puram Railway station (Old Madras Road) 3.5

ITC Infotech park, coxtown 4

Banaswadi Outer Ring Road (Int Airport Road) 1

M G Road 7

Cantonment Railway station 6

ITPL (White field) 12

Satellite KS RTC bus stand (Byappanahalli) 3

Schools and Colleges:

Royal concorde international school, East Point School, New Baldwin residential school and college, BET College, CMR National Institutions (Public school, P U College, Management Studies, Nursing, Physiotherapy and law school), Delhi public school, Indo Asian Academy group of Institutions, Maruthi Vidyalaya, St. Jorge College. Maxwell Public School, SSB International School, Little Angels School, Metro Public School, New Baldwins School, Evershine English School, ST Charles High School, St Annes High School, , met English High School, Priyadarshini High School, Patel Public School, Jyothi Primary School, Infant Jesus High School, Cmr National Public school, SJR Public School, Jss Public School

Hospitals.

Doctor's diaganotise centre, Pruthvi Diabetes Center, Zion Hospital And Research Centre, Rk hospital, Sathya hospital, Joes Veterinary Clinic, Sanjeevini Ayurvedic Clinic, DR Zamindars Microsurgical Eye Hospital, Vasan Eye Care Hospital, Blue Cross Veterinary Solutions, Spandana Hospital & Diagnostic Center, Lokhandes Hospital, Chatrapathi Nursing Home, Amrik Nethralaya & Multispeciality Bangalore Eye Hospital & Retina Center, Sushruta Nursing Home, Family Clinic

Office:

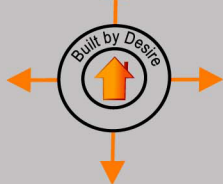

Sreeredy Properties Private Limited.,

Flat No.401, Sree Dhanyatha Apts, 2nd Main, Gopal Reddy Layout,

Doddabanaswadi, Bangalore-560 043. Ph No: 080 - 32211112,

Fax : 080 - 25424647

Mobile : 09880977703,

E mail : sirish@sreeredygroup.com www.sreeredygroup.com