

The Spencer Theater for the Performing Arts Tech Info

Physical address: 108 Spencer Road
Alto, New Mexico 88312

Wifi Network:Spencertheater

Password: Spencer1997108

Contacts:

Charles Centilli (Director) Charles@spencertheater.com

Jason Kennedy (Technical Director) Jason@spencertheater.com

Sharon Davis (Hotels, House Manager, Bar Manager) Sharon@spencertheater.com

Simone Keith (Hospitality, Menus, Backstage requirements) Simone@spencertheater.com

Donna Clarke (Box office manager, Artist Comps, Merch contact) DClarke@spencertheater.com

HOUSE:

Total capacity is 515. 365 capacity in orchestra section. 150 capacity in balcony. Continental seating. Very good sightlines and excellent acoustics. Farthest seat from the balcony is approximately 60 feet from stage. Modern "Scandinavian" interior features with red oak paneling.

STAGE:

Proscenium opening is 40' wide by 30' high. Stage is 48' deep from proscenium to back wall and 44' deep from proscenium to last upstage fly line. Apron is 2' 8" deep from proscenium line to down stage edge with an additional 10' 4" of apron over orchestra pit covered by Wenger staging. Unobstructed wing space stage right is 22' wide by 42' deep; stage left is 18' wide by 42' deep. House, work light and utility racks permanently installed against proscenium wall stage left and right protruding 32" up stage.

STAGE FLOOR:

1" x 2-1/4" T & G northern maple over 1-1/8" T & G "Sturdifloor" over 2 x 4 sleepers over 2" resilient pads over concrete. Finished with black acrylic paint. Free of splinters and suitable for dance.

FLY SYSTEM:

Single purchase counterweight T-track system. Total of 48 battens, two [#10, 24] are dedicated sets for two orchestra shell ceiling sections and line set #5 has permanent electrical raceway installed. Battens are typically 1-1/2" schedule 40 pipe, 60' long with [6] 1/4" wire rope loft lines per batten 11' apart spanning center. Maximum weight capacity of arbors is 1000 pounds. Purchase lines are all 3/4" polyester with double braid Dacron shield. Maximum high trim for battens is 67' above stage. Grid height is 74 above stage. Main curtain is currently set up for GUILLOTINE TRAVEL ONLY.

Drapery:

Quantity	Item	Full	Size
1	Act Curtain	75%	(2) @ 25'X35'
8	Borders	0%	60'X12'
6	Legs	0%	16'X34'
10	Legs	0%	12'X34'
2	Full Blacks	0%	(4) @ 31'X35'
1	White Scrim	0%	60'X35'
1	Black Scrim	0%	60'X35'
1	Cyclorama	0%	60'X35'
4	House Acoustic	0%	56'X36', 32', 27', 21'
2	H & H 418 TRAVELLERS 60' AVAILABLE UPON REQUEST.		

ORCHESTRA PIT:

Beginning 2.5' downstage of curtain line and extending 9.5' downstage, 30.5' wide and 5.5' deep. 3' of off stage side of pit taken up by 3' wide entrance stairway. When not in use, pit is covered with Wenger decking covers to act as stage apron.

MISC. EQUIPMENT:

Quantity	Item
1	30' "Genie" Lift
8	Rolls "Rosco" Dance Floor - 63'X44'
12	TPI Intercom Headsets
10	TPI Intercom Belt Packs
1	"Clearcom" Base Station
10	Single Pipe Lighting Booms 10' to 14'
1	"Coffing" 1/2 Ton Chain Motor (for stacking)
100	Wenger Musician Chairs
75	Wenger Classic 50 Music Stands
40	Music Stand Lights
24	Wenger Versalite 4X8 Risers W/24 Legs Each @ 8", 16", 24", 32"
9	30' Tall Wenger Diva Shell Wall Sections W/2 Dive Ceiling Units
5	Wenger 3 Step Choir Risers
19	Rolling Wardrobe Racks

POWER:

4	400 amp 3 phase Services Up Stage Right
1	100 amp 3 phase Services Down Stage Left
1	400 amp 3 phase Services On Loading Dock
1	60 amp / 220VAC Bus Shore Power Near End of Loading Ramp

DRESSING ROOMS:

Downstairs

4 - 150 Sqft Star dressing rooms with individual bathrooms/showers

1 - 500 Sqft chorus room with 25 mirrors and 1 bathroom/shower

Upstairs

2 – 245 Sqft Chorus rooms with 11 mirrors and 1 bathroom/shower

PRODUCTION OFFICE:

Conference room located on 2nd floor adjacent to chorus rooms. Large tables, desk and analog phone lines available. A fax machine is available in the operations manager's office across from green room. Fax number is 575-336-0028. The direct on stage and technical director's office telephone number is 575-336-0018.

GREEN ROOM:

Located adjacent to stage right. Contains small, fully equipped kitchen.

LAUNDRY ROOM:

Located on stage level adjacent to green room. Equipped with a 30 lb industrial washer and a 50 lb. Industrial dryer. Also available: 2 wardrobe steamers, irons and ironing boards and heavy duty sewing machine.

LOADING DOCK:

24' wide x 20' deep adjacent to stage right and accessed by 14' x 10' roll up door. Dock is 3' 6" above grade with space for 2 trailers with 1 pneumatic dock leveler. Truck ramp slopes at 1" per foot. Access to stage right, through scene shop, isolated by 12' x 21' soundproof doors.

BUS PARKING:

Parking available at curbside near stage door adjacent to loading dock. 1 – 60 amp / 220 VAC available for bus shore power.

LIGHTING BOOTH:

Located at the rear of the orchestra seating area, enclosed with fixed glass windows, with good sightlines to stage. House lights may be controlled from this location or from lighting board. Lighting board and house lights can also be run from stage right.

SPOTLIGHT BOOTH:

Located above the sound booth approximately 75 feet from the stage. It is enclosed with glass windows and has good sightlines to the stage. Equipped with 2 Lycian Starklite II, 1200 HMI, follow spots.

LIGHTING INVENTORY:

36	10 Degree
65	19 Degree
60	26 Degree
54	36 Degree
12	50 Degree
36	Altman 175Q-8" Fresnels W/ BVT
12	Altman 165Q-6" Fresnels W/ BLT
70	Source 4 PAR W/ HPL575x
10	L&E Ministrips, 3 cct W/ MRI6EYC
7	Altman Far Cyc, 3 cct W/ 1000 Watt FCL
2	Lycian 1272 Starklite II W/ 1200 Watt HMI
4	Wildfire WF-401 UVA
6	LRW Cyberlight SV W/ 1200 Watt MSR
12	LRW Studio Color 575-S W/ 575/2MSR
2	F100 Foggers
10	10' Booms W/ 30 Sidearms
468	ETC Sensor D20 E Dimmers
4	ETC Sensor D50Af Dimmers
1	ETC Ion w/2 - 40 channel Fader Wings
3	DMX Repeaters
3	4 PAR ACL Light Bars
1	60' X 33' Fiber Optic Star Curtain w/6 - LED Illuminators
10	Mac 500
24	Altman Spectra 200 LED Cyc Lights

SOUND BOOTH:

Located above lighting booth at the rear of the balcony seating area, approximately 60' from the stage. Booth is not enclosed and the balcony speakers are "focused" directly at the mix position to facilitate referencing the house sound. Due to the proximity of the sound booth to the stage and the small seating capacity of the house, there is no way for the sound to be mixed from the orchestra seating. Input and output distribution boxes are located DSR, DSL, USR and in orchestra pit. GOLDLINE SPL120RM3 is installed to meter SPL at center of auditorium. SPL SHALL NOT EXCEED 85 dbA (see contract).

SOUND SYSTEM INVENTORY:

FOH CONSOLE:

- **Yamaha PM 5D**
- 40 Input Channels; 4 Stereo Input Channels; 4 Stereo Returns;
- 8 Sub-masters; 3 Masters (L-R-M); 11 x 4 Matrix;
- 8 Aux Busses; 4 Point EQ w/ sweeping Mids and Variable High
- Pass Filters; 8 Mute Groups or 256 Page Midi Mutes

EQUALIZERS:

- Ashly GOX-3102 dual 31 Band Graphic (4 Channels Patchable)
- Rane PE-17 Parametric 5 point EQ w/ High and low Pass Filters

CROSSOVERS:

Built in to Bose Processor

PLAYBACK:

- 1 -Tascam CD RW700
- 1 -Tascam CD A700
- 1 -Rane SM-26 Line Mixer
- 1 -dbx 760X Preamp

(All FOH equipment patchable through 1/4" patch field)

(All carried effects must have TRS tip hot 1/4 cables)

(Inserts are separate 1/4" balanced Sends and Returns)

MAINS LEFT/RIGHT:

- 8 - Bose Room Match Line Array system (4 per side)

FRONT FILL

- 3 - Proel, Edge 25PB

POWER:

- 2 – Bose

- Crown CT-200 (backstage and FOH paging speakers)

MONITOR CONSOLE:

- Yamaha M7CL-48, 48 Channel inputs / 16 Outputs / 4 Stereo

EQUALIZERS:

- 6 - Ashly GQX-3102 Dual 31 Band (10 Channels on Inserts)

SPEAKERS:

- 4 - TSI Dual 15 x 2 Side / Drum fill Monitors

6 – TSI Single 15 floor monitors

- 12 - EV Phoenix PX1122m

CROSSOVERS:

- TDM CX24 (12 channels)

MONITOR POWER:

- 6 - Crown MA-1200

- 6 - Crown MT-600

MICS:

Quantity - Item

8 - Countryman B-3

1 - Audio Technica AT853a

8 - Sennheiser ME-2 Lav Wireless

4 - Sennheiser SKM 300 Hand Held Wireless

8 - Shure SM 58 Vocal Mic

16 - Shure SM 57 Condenser Mic

4 - Shure SM 81 Condenser Mic

4 - Shure SM 98 Condenser Mic

1- Shure SM 91 Condenser Mic

2 - AKG D112 Mic

9 - Rapco Passive Direct Boxes

2 – Passive Stereo Direct Boxes

2 – Active Mono Direct Boxes

1 - BSS Active Direct Box

2 - Barkus Berry DISQ 1000 Piezo Guitar Pickup

1 - Barkus Berry 4000 XL Piano Pickup

Misc:

- 10 - TPI Intercom Headsets / Belt Packs
- 2 - Channel Clearcom Power Station
- 30 - Various Mic Stands W/ Booms
- 10 - Mic Ease Drum Clips
- 2 - 12 Channel 75' Sub Snake
- 1 - 12 Channel 100' Sub Snake
- 1 - 6 Channel Whirlwind 50' Snake
- 1 - 16/4 Channel Pro-Co 100' Snake
- 24 - Monitor Cables
- 4 - Stage Panels (SR, SL, US, Right Pit)
- 3 - DS Floor Pockets W/ 8 Mic & 4 Mon Lines (Patchable at SR/SL Stage Panels)
- 1 - Allen & Heath Mix Wiz 16:2 Swiss Army Mixer
- Large Assortment of Mic Cables

PROGRAM:

Monitor System for Green Room and Dressing Rooms

Spencer Theater Standard Lineset Schedule – 11/03/18

Line #	Dist. US	Description	Weight	Notes
2	1'6"	#1 Border	142.5#	
3	2'0"	#1 Legs	114#	20' off CL
4	2'6"			
5	3'6"	#1 Electric		Permanent Raceway
6	5'0"			
7	5'6"			
8	6'6"			
9	7'0"	#2 Border	142.5#	
10	8'6"	#1 Orch. Ceiling	1200#	Permanent
11	10'0"	#2 Legs	142.5#	19'6" off CL
12	10'6"			
13	11'0"	Border		
14	12'0"			
15	13'0"			
16	14'0"	#2 Electric		
17	15'0"			
18	16'0"			
19	17'6"	#3 Border	142.5#	
20	18'6"	#3 Legs	142.5#	19'0" off CL
21	19'6"	LED Stardrop for Half stage		
22	20'0"			
23	21'0"			
24	22'6"	#2 Orch. Ceiling	1500#	Permanent
25	24'0"	#3 Electric		
26	24'6"			
27	25'6"			
28	26'0"			
29	26'6"	#4 Border	142.5#	
30	27'6"	#4 Legs	142.5#	18'6" Off CL
31	28'6"			
32	29'6"			
33	30'6"			
34	31'0"			
35	32'0"			
36	32'6"	#4 Electric		
37	33'6"			
38	35'0"			
39	36'0"	#5 Border	142.5#	
40	37'0"	#5 Legs	114#	18'0" Off CL
41	38'0"	#5 Electric		Cyc LX
42	39'0"			
43	40'0"			
44	41'0"			
45	41'6"			
46	42'0"			
47	42'6"			
48	43'0"	Cyclorama	171#	
49	44'0"	LED Stardrop for full stage		

**OUTDOOR
STAGE**

STAGEHOUSE

FLY RAIL

**TO WORKSHOP
& LOADING DOCK**

**TO
DRESSING
ROOMS**

**ORCHESTRA PIT
(COVERED)**

**ORCHESTRA LEVEL
LIGHTING BOOTH;
BALCONY LEVEL
SOUND BOOTH;
TECH GALLERY LEVEL
FOLLOW SPOT BOOTH**

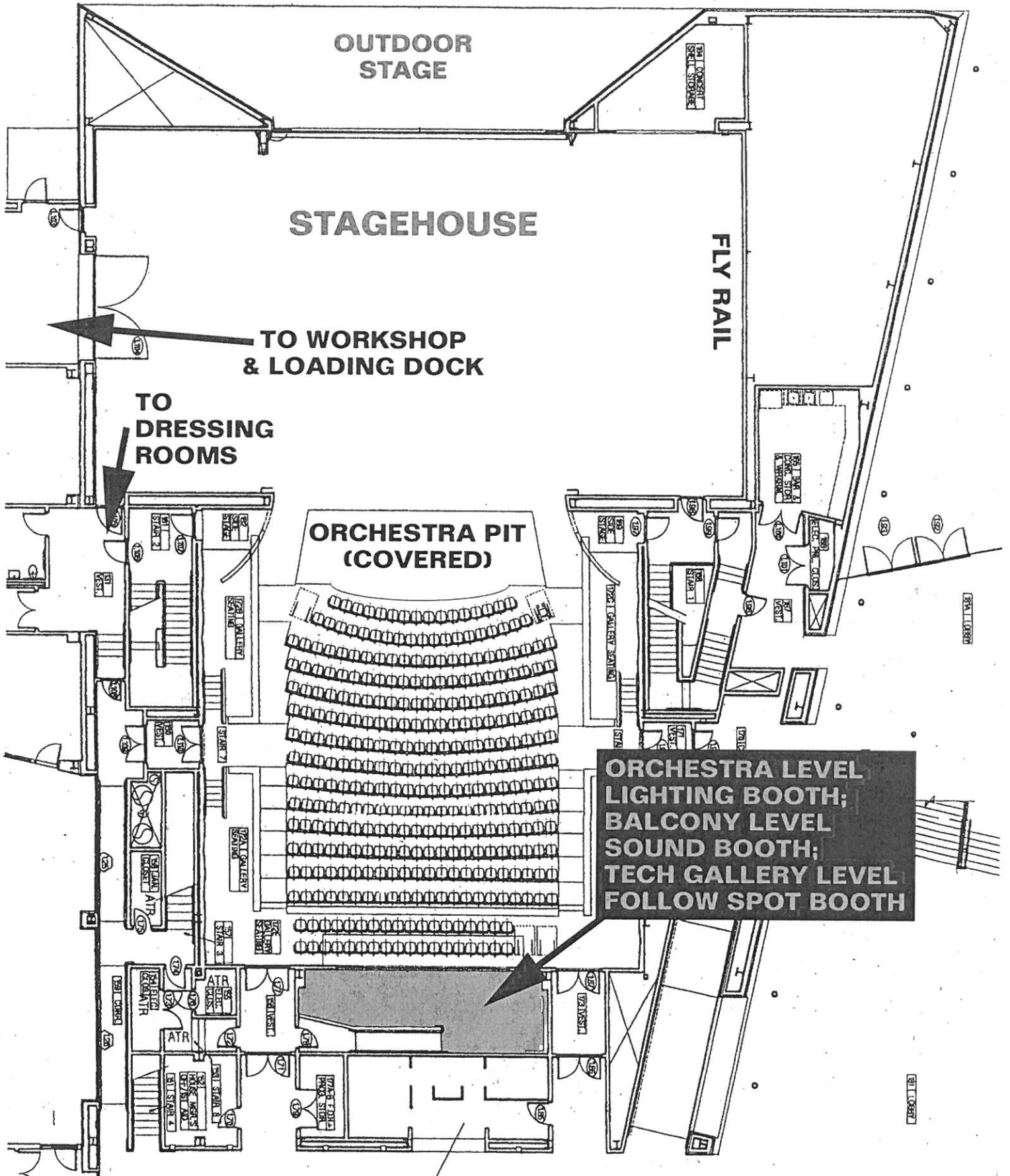

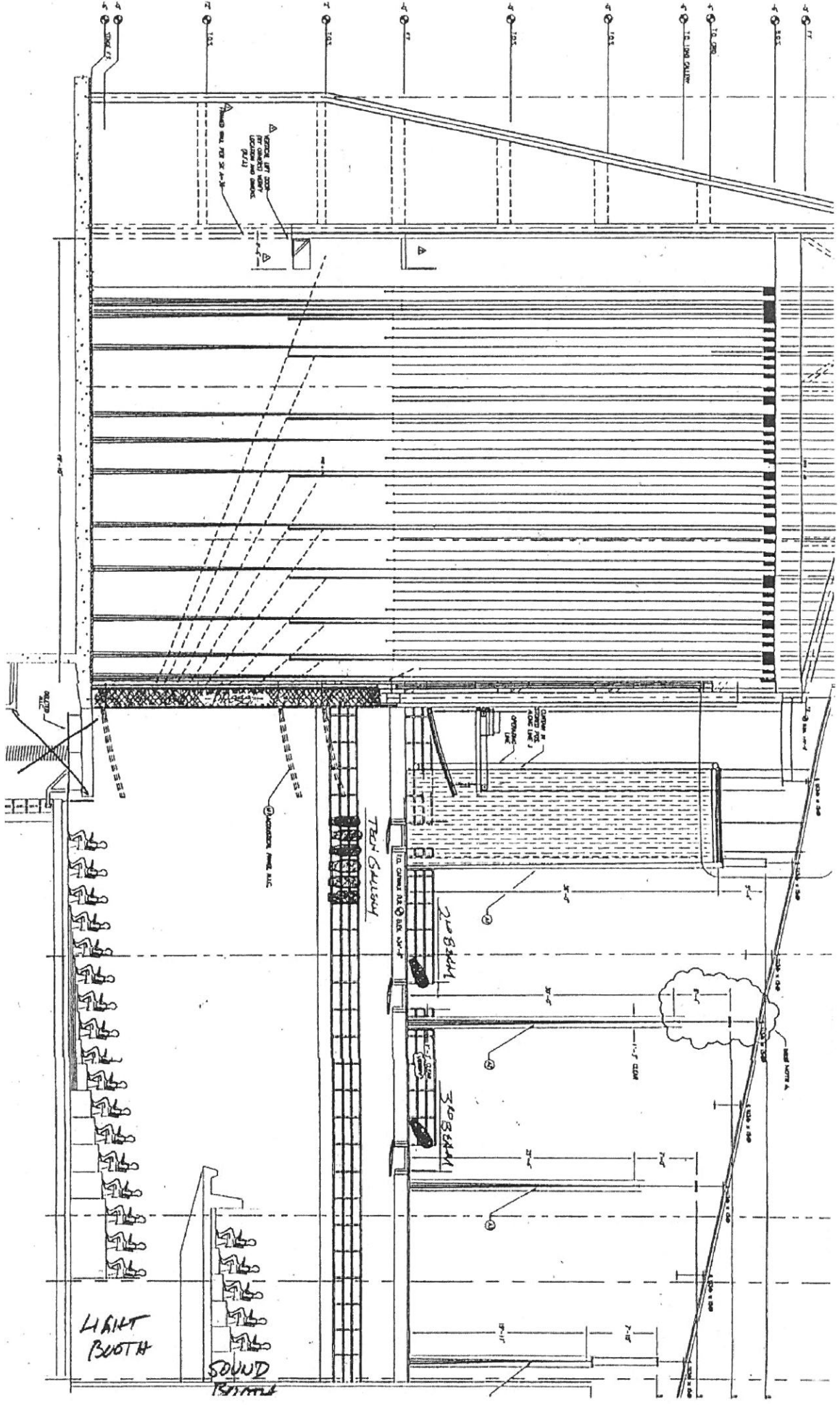

VERTICAL AIR ZONES FOR COOLING SYSTEM (LOCATION AND NUMBER P. 21)

TECH STAIRWAY

TECH STAIR

2108 B 4441

3108 B 4441

LIGHT BOOTH

SOUND BOOTH

CLOSET IN CORNER OF STAIRWAY

STAIR

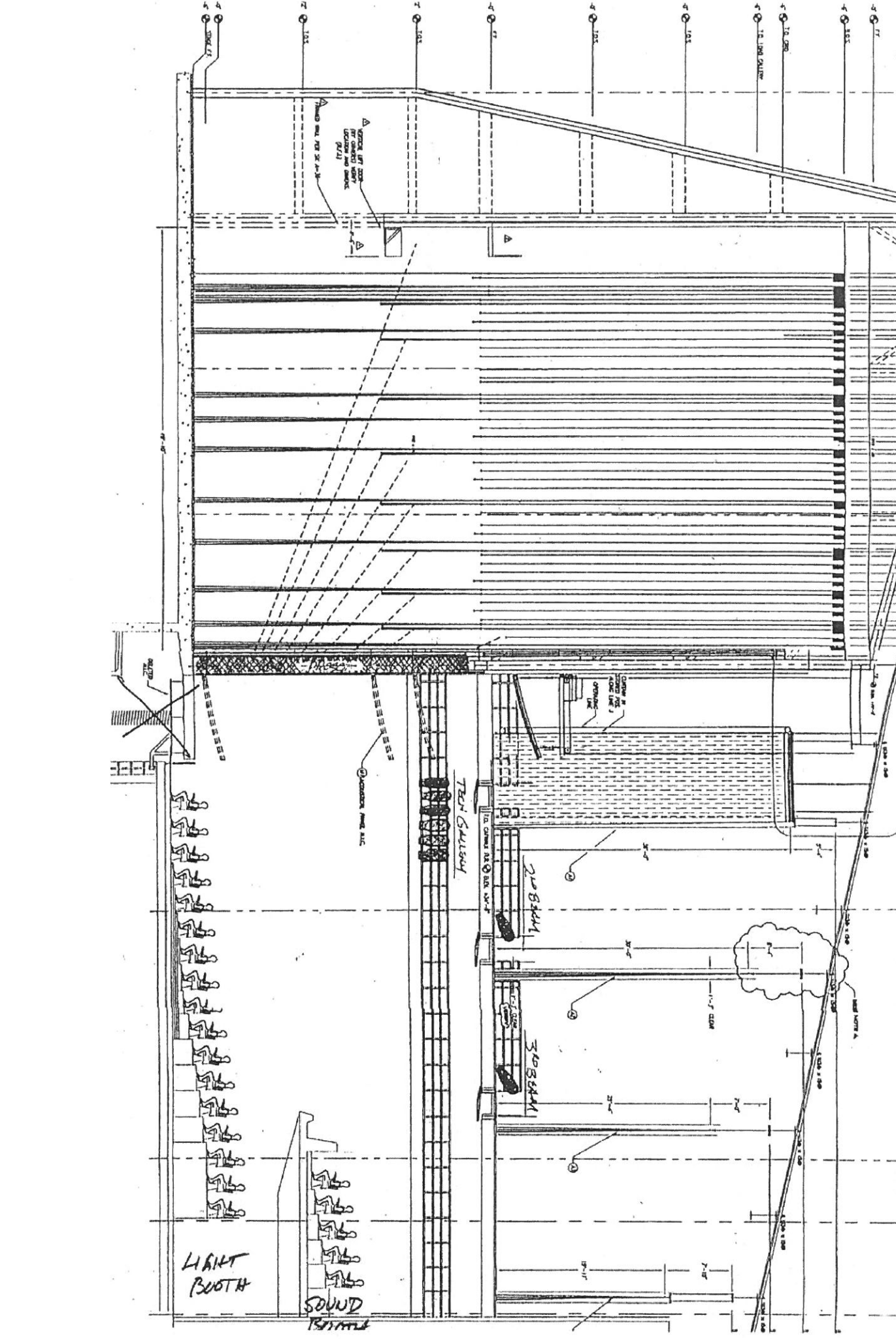

Spencer Theater for the Performing Arts
108 Spencer Road
Alto, New Mexico 88312
575.336.4800 / fax: 575.336.4001

Contact Information

Charles Centilli
Executive Director
Ph#: 575.336.0011
charles@spencertheater.com

Jason Kennedy
Tech <http://www.spencertheater.com/tech.html>
Ph#: 575.336.0018
jason@spencertheater.com

Simone Keith
Hospitality/Catering Manager
PH#: 575.336.0017
simone@spencertheater.com

Sharon Davis
Lodging/Patron/Bar Manager
Ph#: 575.336.0029
sdavis@spencertheater.com

Kathleen McDonald
Publicity
Ph#: 575.336.0016
kathleen@spencertheater.com

Donna Clarke
Merchandise / Box Office Manager
575.336.0023
dclarke@spencertheater.com