

CCT TUNABLE LED BACKLIT PANEL

Available Sizes

- 2x2(602x602x30mm)
- 2x4(602x1209x30mm)
- 1x4(298x1209x30mm)



Features

- No LGP, never yellowing.
- High efficacy up to 125lm/w, meet DLC 5.0 standard and premium version .
- Series: Color&Wa age tunable.
- .5 years warranty.

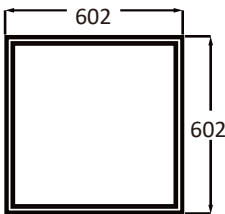
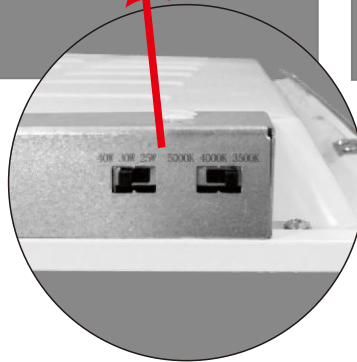
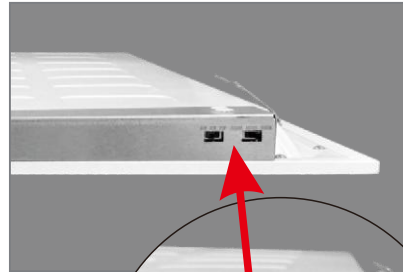

602*602mm

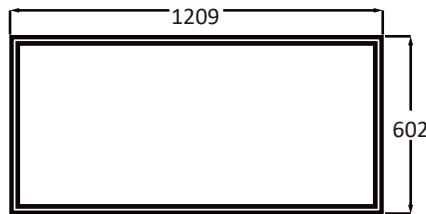

602*1209mm

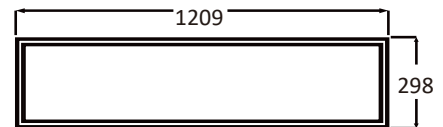

298*1209mm

CCT TUNABLE LED BACKLIT PANEL

Product Parameter

Model	2x2	1x4	2x4
Wattage(W)	25W-30W-40W	25W-30W-40W	30W-40W-50W
Efficacy(lm/w)	110 125	110 125	110 125
Color Temp(K)	3500K-4000K-5000K	3500K-4000K-5000K	3500K-4000K-5000K
CRI		>80	
Voltage		AC:120-277V 120-347V	DC:28-40V
PF		>0.9	
Beam angle		110°	
Working Temperature		-25℃-40℃	
Relative Humidity		10%-90%RH	
Gross weight	2.0kg	2.3kg	4.1kg
Carton size	L662xW185xH667mm 4PCS/CTN	L1269xW185xH363mm 4PCS/CTN	L1269xW185xH667mm 4PCS/CTN

CCT TUNABLE LED BACKLIT PANEL

Surface Mounted Frame MG-M001

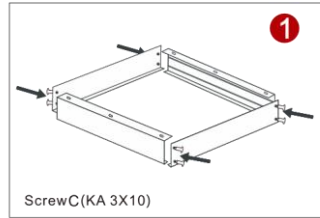
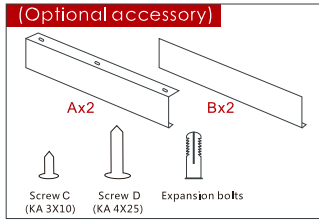

1. Assemble the four frames with Screw C to a whole square.

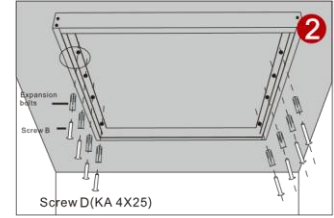

2. Fix the square frames to the ceiling with Screw D.

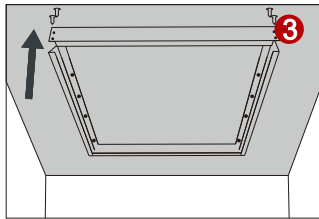

3. Demount one frame

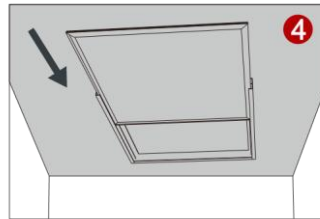

4. Put the panel into the frame square.

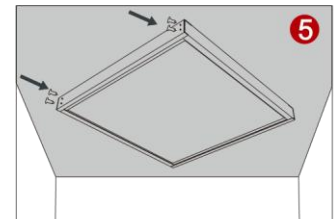

5. Fix the last frame with screw C.

Recessed Frame MG-M002

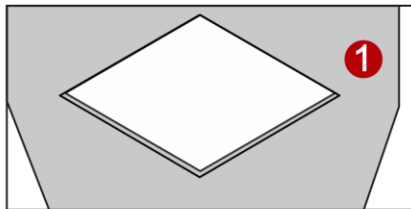

1. Open a hole on the ceiling

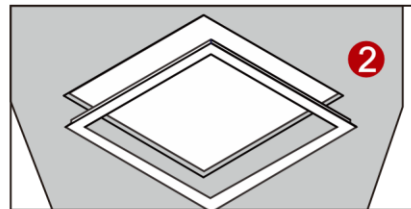

2. Fix the frame to the hole

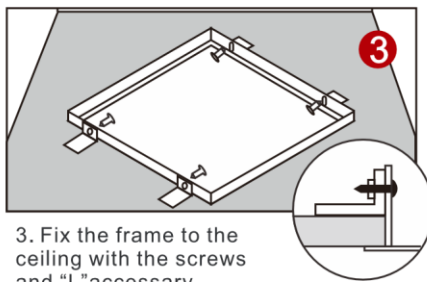

3. Fix the frame to the ceiling with the screws and "L" accessory

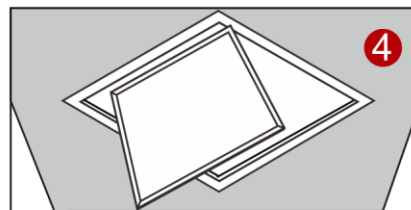

4. Put the panel into the frame

Wiring Diagram



CCT TUNABLE LED BACKLIT PANEL

Product installation instructions and precautions

Main features

50% energy saving, high brightness and even light.

Fast start, no flickering and noise, wide working voltage AC120-277V.

The latest high efficiency constant current driver, ana-wave interference. Lead-free, green environmental protection, meet ROHS requirements.

Application

Factory, office building, shopping center, home lighting etc.

Precautions

1. Rated voltage AC120-277V, 50-60Hz, in the voltage too high or too low state of long-term use, will affect the normal function and lifespan.
2. Do not install it in a flammable object, and shall not be covered by insulation or similar materials under any circumstances.
3. When installing and replacing the lamp, power must be cut off to ensure personal safety.
4. Do not use outside or in places where rain has fallen.
5. The lamp should be installed by a qualified electrician and the wiring should comply with the IEE electrical standards or national standards.