

# FAQ

breathe  
easier  
live  
better  
and  
longer

## HOW CAN I TELL IF I NEED A RPS WHOLE HOME HEPA?

Now that homes are better constructed, indoor air quality is deteriorating. The numbers are out and are alarming as asthma and allergy rates are increasing. According to the American Heart Association and Lung Association allergies, asthma, lung cancer and heart problems have all been linked to poor indoor air quality. If someone in your family has allergies to airborne particulates, they should experience relief when a RPS Whole Home HEPA system is installed.

## WILL IT AFFECT MY EXISTING AIR DISTRIBUTION SYSTEM?

RPS Whole Home HEPA Filters contain its own blowers and are normally installed in a "BY-PASS" configuration. This means about 1/5 to 1/3 of the air about to pass through the furnace (or air conditioner) is drawn off, cleaned, and returned to the airstream before the furnace. It will have no effect on the efficiency of your heating system.

## SHOULD I KEEP THE FILTERS IN MY FURNACE?

Yes, they can help to keep heating (or cooling) components free from dust and dirt. By trapping large airborne particles they will increase the life of the RPS Whole Home HEPA so that it can do what it does best - trap the very small particles that pass through the furnace filter.

## WARRANTY

- 10 Year Warranty
- Lifetime Service Warranty
- Lifetime Trade-In Warranty
- Lifetime Fire Protection Warranty



## FIELD TEST

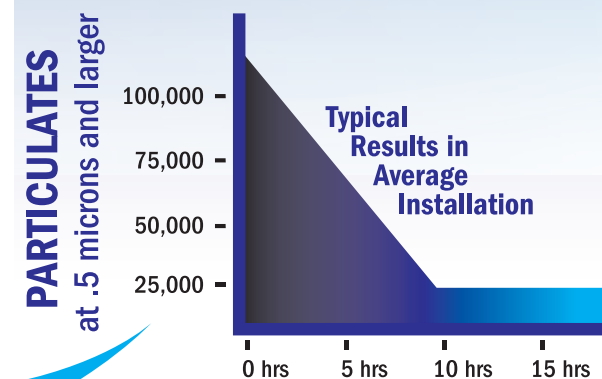

2000 sq ft home,  
approximately 1000 CFM  
forced air system.

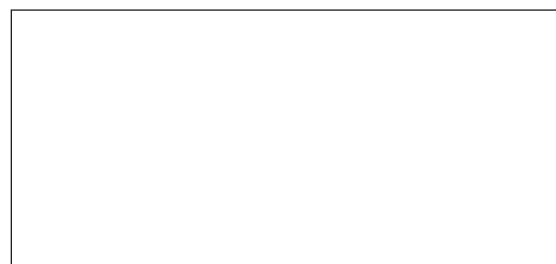

breathe easier  
live better and longer



On any given day, each member of your family takes over 20,000 breaths. Who knows what your family is breathing in?

The air in your home is much more likely to be polluted than the air outdoors. In fact, The EPA has now ranked indoor air pollution among the top five environmental dangers facing today's public. Most people spend about 90% of their time indoors. Do you know what your family is breathing in? Your family's good health may very well depend on you protecting them from an unrelenting attack by the hundreds of millions of airborne particles in your home. Indoor air pollution is caused by sources of combustion, building materials, chemicals, outdoor pollutants, and a variety of other substances including pet dander, mould, mildew, bacteria, and viruses.

**WHAT IS THE RPS CENTRAL WHOLE HOME HEPA SYSTEM?**

The good news is... you can now help protect your family from indoor air pollution. The Central HEPA Whole



Home System has been designed to help in the removal of indoor air contaminants that are present in your home such as dust mites, household dust, pollen, mould spores, bacteria, viruses, pet dander, cooking smoke, tobacco smoke, odours and more.

**HOW IT WORKS**

Millions of airborne pollutants are carried through the return air ducts of the heating/cooling system. The RPS Central Whole Home HEPA uses a permanent washable pre-filter to capture larger particulates followed by a carbon impregnated filter to

reduce odours. This powerful combination is also backed up with over 40 square feet of true HEPA filtration to rid your home's air of particles containing bacterial, viral organisms and a host of other potential containments.

With your furnace fan in the off position, the Central Whole Home HEPA System will treat approx 13,000 cubic feet of air per hour.

What this means to your family is it will treat the air in a 2,000 sq ft home with 8 ft ceilings 20 times per day, approx. 7,000 times per year.

**\*ALL FOR LESS THAN \$100 DOLLARS PER YEAR.**

**RPS CENTRAL WHOLE HOME HEPA SYSTEM**

- Installs easily on the return air duct of your heating and air conditioning system
- No external connections required
- Based on 2017 Ontario Hyrdo Rates\*

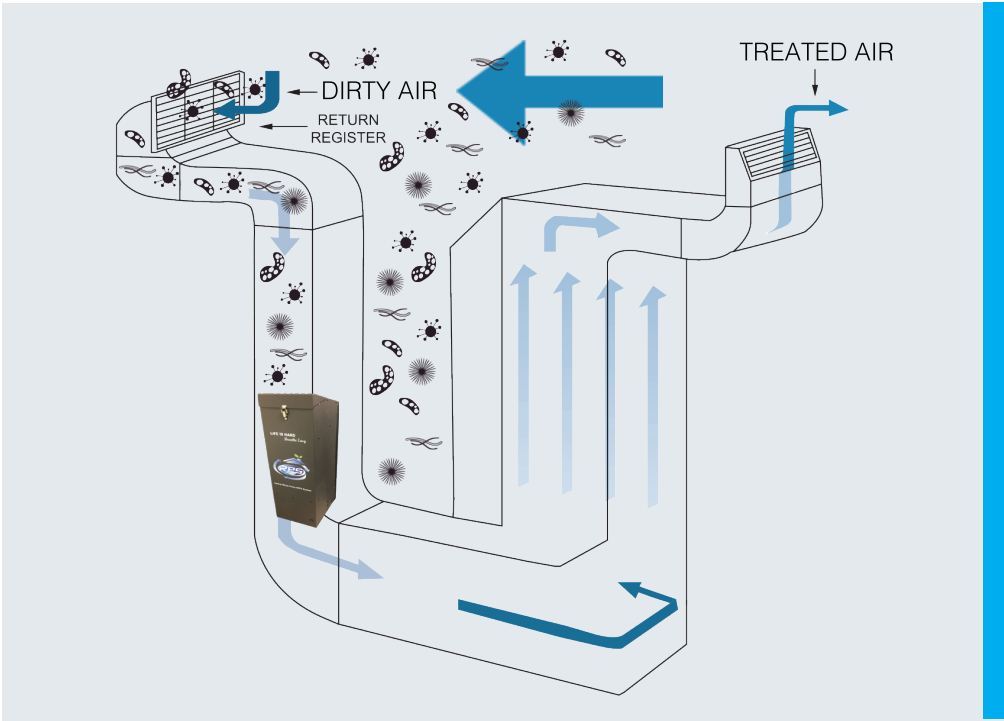

**CENTRAL WHOLE HOME HEPA SYSTEM**

**3 STAGE FILTRATION**

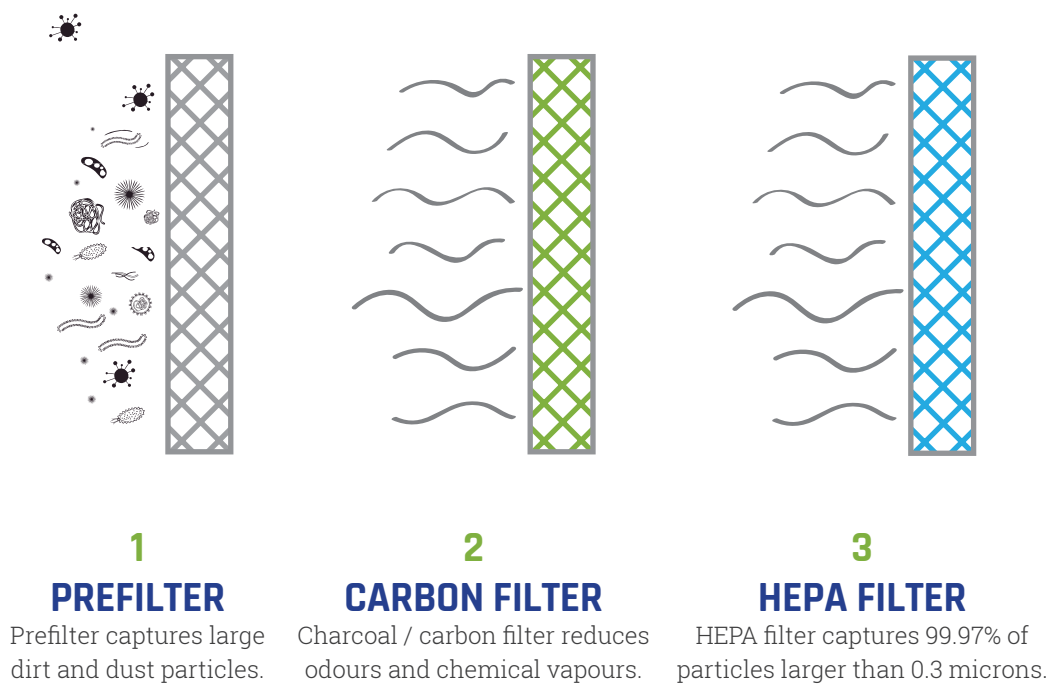

**CHEMICAL POLLUTANTS**

- Carbon Dioxide
- Formaldehyde
- Lead
- Asbestos
- VOC
- Cigarette Smoke

**MATERIAL POLLUTANTS**

- Mould, Mildew
- Fungi
- House Dust Mites
- Pollen
- Spores
- Dust, Dander
- Hair
- Lint

