

High Current Power Inductors AWIM2313 Series



Product features

- DC-DC converter work frequency up to 1MHz
- Soft saturation. Low EMI.
- High current, low DCR, high efficiency.
- Current range from 9A to 70A
- Inductance range from 1.0 μ H to 100 μ H.
- High reliability.
- 100% Lead (Pb)-Free and RoHS compliant.
- Operating temperature -55~+125°C (Including self - temperature rise)

Applications

- Note PC power system, server VRMs and EVRDs.
- DC/DC converter, Electric pumps, motor control and auxiliaries.
- Data networking and storage system.
- LED lighting/Battery management systems/Powertrain control module

Dimensions (mm) AWIM-YT2313

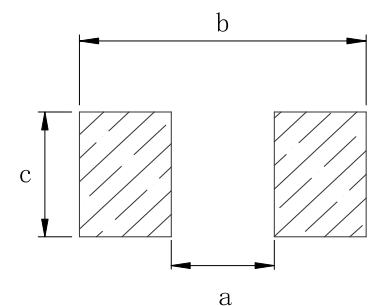
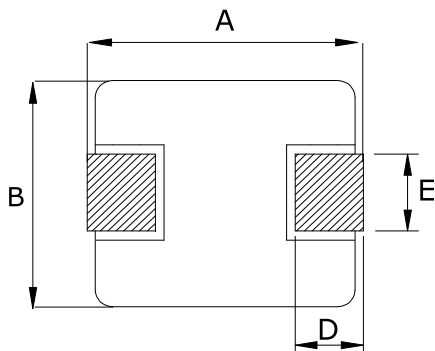

Recommend Land Pattern

A	B	C	D	E	a typ	b typ	c typ
23.5 \pm 0.5	22.0 \pm 0.3	12.6 \pm 0.4	5.0 \pm 0.4	19.0 \pm 0.3	12.5	24	19.6

Specifications AWIM-YT2313

Part Number	Inductance ² ±20% (μH)	I _{rms} ³ (A)	I _{sat} ⁴ (A)	DCR MAX (mΩ)
AWIM-YT2313-1R0M	1.0	70	60	0.95
AWIM-YT2313-1R5M	1.5	62	52	1.15
AWIM-YT2313-2R2M	2.2	58	48	1.25
AWIM-YT2313-3R3M	3.3	49	41	1.75
AWIM-YT2313-4R7M	4.7	47	38	2.2
AWIM-YT2313-6R8M	6.8	40	36	3.1
AWIM-YT2313-100M	10	33	28	4.15
AWIM-YT2313-150M	15	26	23	6.12
AWIM-YT2313-220M	22	22	15	11
AWIM-YT2313-330M	33	19	12	15.4
AWIM-YT2313-470M	47	17	12	20.8
AWIM-YT2313-680M	68	14	12	29.5
AWIM-YT2313-820M	82	12	9	34.2
AWIM-YT2313-101M	100	11	9	40

Notes:

1. All test data is reference to 25°C ambient.
2. Test Condition:100KHz,1.0Vrms.
3. I_{dc}: DC current (A) that will cause an approximate ΔT of 40°C
4. I_{sat} : DC current (A) that will cause L0 to drop approximately 30%
5. Operate between temperature range -55°C to +125°C
6. The part temperature (ambient + temp rise) should not exceed 125°C under worst case operating conditions. Circuit design, component. PWB trace size and thickness, airflow and other cooling procession all affect the part temperature. Part temperature should be verified in the den application.