

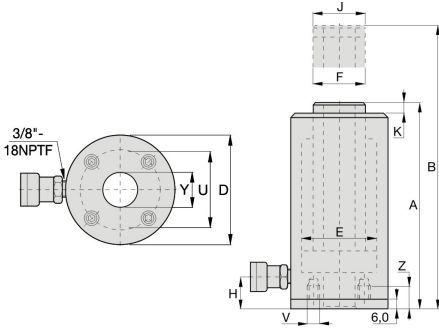

ALUMINUM (RACH)

- Composite bearings prevent metal-to-metal contact increasing cylinder life and resistance to side-loads of up to 10%.
- Hard-Coat finish on all surfaces resists damage and extends cylinder life.
- Handles included on all models.
- Steel base plate and saddle for protection against load-induced damage.
- Integral stop ring prevents plunger over-travel and is capable of withstanding the full cylinder capacity.



Model	Cylinder Capacity tons (kN)	Stroke		Cylinder Effective Area		Oil Capacity Area		A Height		B Extended Height		D Outside Diameter		E Cylinder Bore Diameter		F Plunger Diameter		H Bottom to Advance Port		J Saddle Diameter		K Saddle Protrusion from Plunger		Weight	
		mm	inch	cm ²	inch ²	cm ³	inch ³	mm	inch	mm	inch	mm	inch	mm	inch	mm	inch	mm	inch	mm	inch	mm	inch	kg	lbs
RACH-202	20 (229)	50	1.97	32.7	5.07	164	10.01	188	7.40	238	9.37	100	3.94	75	2.95	55	2.17	29	1.14	55	2.17	10	0.39	5.2	11.5
RACH-204		100	3.94	32.7	5.07	327	19.95	251	9.88	351	13.82	100	3.94	75	2.95	55	2.17	29	1.14	55	2.17	10	0.39	6.1	13.5
RACH-206		150	5.91	32.7	5.07	491	29.96	315	12.40	465	18.31	100	3.94	75	2.95	55	2.17	29	1.14	55	2.17	10	0.39	7.1	15.7
RACH-208		200	7.87	32.7	5.07	654	39.91	378	14.88	578	22.76	100	3.94	75	2.95	55	2.17	29	1.14	55	2.17	10	0.39	8.0	17.6
RACH-2010		250	9.84	32.7	5.07	818	49.92	442	17.40	692	27.24	100	3.94	75	2.95	55	2.17	29	1.14	55	2.17	10	0.39	9.0	19.8
RACH-302	30 (358)	50	1.97	51.1	7.92	256	15.62	208	8.19	258	10.16	130	5.12	95	3.74	70	2.76	29	1.14	70	2.76	10	0.39	8.0	17.6
RACH-304		100	3.94	51.1	7.92	511	31.18	267	10.51	367	14.45	130	5.12	95	3.74	70	2.76	29	1.14	70	2.76	10	0.39	9.5	20.9
RACH-306		150	5.91	51.1	7.92	766	46.74	333	13.11	483	19.02	130	5.12	95	3.74	70	2.76	29	1.14	70	2.76	10	0.39	11.2	24.7
RACH-308		200	7.87	51.1	7.92	1022	62.37	395	15.55	595	23.43	130	5.12	95	3.74	70	2.76	29	1.14	70	2.76	10	0.39	12.9	28.4
RACH-3010		250	9.84	51.1	7.92	1277	77.93	458	18.03	708	27.87	130	5.12	95	3.74	70	2.76	29	1.14	70	2.76	10	0.39	14.5	32.0
RACH-602	60 (596)	50	1.97	84.7	13.13	423	25.81	251	9.88	301	11.85	180	7.09	130	5.12	100	3.94	61	2.40	100	3.94	12	0.47	16.2	35.7
RACH-604		100	3.94	84.7	13.13	847	51.69	315	12.40	415	16.34	180	7.09	130	5.12	100	3.94	61	2.40	100	3.94	12	0.47	19.5	43.0
RACH-606		150	5.91	84.7	13.13	1270	77.50	380	14.96	530	20.87	180	7.09	130	5.12	100	3.94	61	2.40	100	3.94	12	0.47	25.6	56.4
RACH-608		200	7.87	84.7	13.13	1694	103.37	445	17.52	645	25.39	180	7.09	130	5.12	100	3.94	61	2.40	100	3.94	12	0.47	26.0	57.3
RACH-6010		250	9.84	84.7	13.13	2117	129.19	510	20.08	760	29.92	180	7.09	130	5.12	100	3.94	61	2.40	100	3.94	12	0.47	29.6	65.3
RACH-1002	100 (1157)	50	1.97	164.6	25.51	823	50.22	258	10.16	308	12.13	250	9.84	185	7.28	145	5.71	61	2.40	145	5.71	14	0.55	33.8	74.5
RACH-1004		100	3.94	164.6	25.51	1646	100.45	325	12.80	425	16.73	250	9.84	185	7.28	145	5.71	61	2.40	145	5.71	14	0.55	39.8	87.7
RACH-1006		150	5.91	164.6	25.51	2487	151.77	391	15.39	541	21.30	250	9.84	185	7.28	145	5.71	61	2.40	145	5.71	14	0.55	46.2	101.9
RACH-1008		200	7.87	164.6	25.51	3291	200.83	459	18.07	659	25.94	250	9.84	185	7.28	145	5.71	61	2.40	145	5.71	14	0.55	52.2	115.1
RACH-10010		250	9.84	164.6	25.51	4114	251.05	527	20.75	777	30.59	250	9.84	185	7.28	145	5.71	61	2.40	145	5.71	14	0.55	58.8	129.6
RACH-1502	150 (1588)	50	1.97	225.8	35.0	1129	68.90	280	11.02	330	12.99	275	10.83	205	8.07	150	5.91	61	2.40	145	5.71	14	0.55	48.9	107.8
RACH-1504		100	3.94	225.8	35.0	2258	137.79	360	14.17	460	18.11	275	10.83	205	8.07	150	5.91	61	2.40	145	5.71	14	0.55	55.7	122.8
RACH-1506		150	5.91	225.8	35.0	3387	206.69	430	16.93	580	22.83	275	10.83	205	8.07	150	5.91	61	2.40	145	5.71	14	0.55	63.0	138.9
RACH-1508		200	7.87	225.8	35.0	4517	275.64	500	19.69	700	27.56	275	10.83	205	8.07	150	5.91	61	2.40	145	5.71	14	0.55	70.1	154.5
RACH-15010		250	9.84	225.8	35.0	5646	344.54	570	22.44	820	32.28	275	10.83	205	8.07	150	5.91	61	2.40	145	5.71	14	0.55	77.2	170.2