

Kitchen The new kitchen sits within the existing footprint and is now light-filled and spacious, thanks to frameless glazing and a linear layout with Howdens Clerkenwell Super Matt handleless cupboards. The contrasting shades of graphite base units and a bank of floor-to-ceiling grey cupboards encourage a sense of openness as well as providing lots of storage

'It's a blend of Mid-century and Melbourne style'

Jane McCarthy and Ian Harman took their design cues from living in Australia when it came to updating their London family home

Words JANE CRITTENDEN Styling MARISHA TAYLOR Photography JAMES FRENCH



Design details 'I really love our architect's use of glazing,' says Jane. 'The pop-out side window with the window seat is a favourite feature.' The dining table is from Made.com, and the reeded glass pendant lights from Spark & Bell add to the Mid-century look. For similar chairs, try the Wishbone natural weave design from Cult Furniture

Pattern play The Terrazzo Nouveau matt floor tiles from Mandarin Stone were inspired by coffee shops in Melbourne, and Jane has picked out the shades of the flecks in her accessories. 'I love to collect coloured glassware,' she says. For similar rattan bar stools, try the Ola graphic weave from Graham & Green



After enjoying four years of living in Melbourne, Australia, Jane McCarthy and her family moved back to their London home, which they'd rented out while they were abroad. It was returning to 'a horror show' however that prompted the couple to redecorate and make plans to renovate the kitchen and bathroom. 'We'd been living in a Spanish-style villa covered in pretty bougainvillea, but came home to a house with mould growing up the kitchen walls and a jungle of a garden,' recalls Jane. 'We had got used to space and light and wanted to extend into the side return, so we contacted architect Darren Oldfield, who was recommended by friends.'

Jane and husband Ian had bought their Victorian semi in 2010, living in the property for four years before moving to Australia. They had initially been drawn to the four double bedrooms, large bathroom – which had once been a bedroom – and the sizable garden. The front living room had lovely >

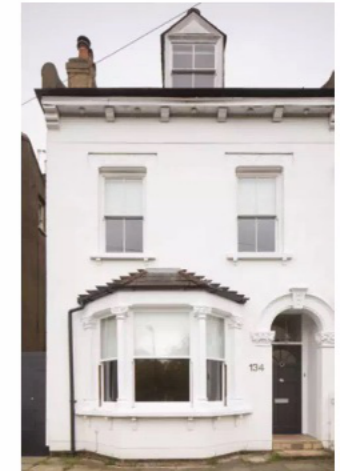

Step inside...

Meet the owners
Jane McCarthy, who works in communications, lives here with her husband Ian Harman, a sales director, their children, Stanley, 15 and Wilf, 13, and Margot the French bulldog

House details
A four-bedroom semi-detached Victorian property in East Dulwich, south London

Facts & figures
The couple bought the house for £600,000 in October 2010, and it's now worth around £1.3m

Living room 'I wanted a tonal brown for the walls to create a warm backdrop for the pink sofa we brought back from Australia,' says Jane. 'Little Greene's Roman Plaster is a lovely beige with green tones.' A floor lamp from Habitat complements the Mid-century coffee table from Crystal Palace Antiques, and for similar style chairs, try Vinterior



'Everywhere was painted white in our Australian house due to the light, but we wanted the rooms here to feel cosier with some colour on the walls'





COLOUR TIP
 Heralded as the 'new neutral', dusky pink works perfectly when paired with other earthy hues such as amber, brown and dark, leafy green. Choosing this kind of pale plaster shade for your walls will also provide a great starting point to layer other colours into your scheme. Try Setting Plaster by Farrow & Ball; Dried Plaster by Craig & Rose or Fresh Plaster by Dulux

◀ **Mantel display**
 Jane has combined vintage finds with contemporary buys to achieve her desired aesthetic. The large framed *San Jacinto* photo is by Derek Swalwell, and the shapely glass vases and candle holders form part of Jane's colourful collection

bay windows and the middle room behind was ideal for a playroom, but the kitchen had been extended over forty years before, and felt out of sorts. 'The space should have benefited from the morning sun, but we had a tiny back door so it always felt gloomy,' Jane explains. 'The layout was back to front, with a table as you came into the room and cupboards closest to the garden, but no view.'

The couple were surprised then when Darren discouraged them from building into the side return. 'I had a vision for a kitchen with a sofa and a log burner, but

he rightly pointed out that we already had comfortable seating and log burners in the other downstairs rooms,' says Jane. 'Changing the layout instead has made the kitchen look bigger and saved us the expense of extending.'

High on the list in the kitchen brief was a need for more light, so Darren showed Jane and Ian designs with floor-to-ceiling doors across the back, and a large roof light. A glass box window on the side, with a deep sill for a window seat, especially appealed to them. 'We immediately fell in love with Darren's ideas,' says Jane. ▶



Tonal touches Leafy pot plants from The Nunhead Gardener draw on the green pigments in the wall colour to complement Jane's pink accessories, including in the Poppy rug from French Connection Home. The leather vintage chair was reupholstered in a grey fabric

Main bedroom Jane took inspiration from designer Emma Gurner and painted the ceiling using Farrow & Ball's Middleton Pink to highlight the ceiling rose and Frosted Bubble chandelier from Dowsing & Reynolds. Jane's grandma hand-crocheted the bedspread for her 21st birthday



Cool contrast Shaker wardrobes by Freeborn Carpentry have been painted in Valspar's Inky Prose, and Jane brought the dressing table and chair back from Australia. For similar, try the Origami desk from Maisons du Monde. The *Resting Feet 01* print by Julie Pike is available from Nordic Nest



'And because he'd done such a beautiful job on our friends' house, we trusted that his work would be of good quality.'

Darren also came up with a solution to create space for a cloakroom by relocating the cellar steps beneath the staircase to an access hatch in the hall floor. 'It was a great idea, as was his solution for a laundry space,' says Jane. 'We weren't sure what to do with the separate upstairs toilet next to the bathroom – which already had a loo – so we now have a stacked washer and dryer here.'

With the property being in a Conservation Area, the plans needed approval, plus the 1980s extended part of the kitchen had to be rebuilt and engineered for the structural glazing, which also resolved the damp issues in the process. Darren recommended builders Darenix Construction, and in April 2019 he began project managing for the couple, who both work full-time.

The builders struck an unforeseen problem however when they discovered a drain in an unexpected location. ►



Bathroom Oak veneer joinery designed by Darren Oldfield Architects and made by Andwoodcraft conceals the cistern on one side and boiler on the other, creating the perfect recess for the Lusso Stone basins. 'I love the symmetry to the layout and the look of marble against the warmth of the wood,' says Jane. Mirrors from Maisons du Monde and brass pendants with opal shades from Spark & Bell give the space a Mid-century feel



LOOKING FOR BATHROOM FURNITURE?

 For the latest designs, head to [goodhomesmagazine.com](https://www.goodhomesmagazine.com) for our style edit



◀ *Statement tub*
 'I've always wanted a big stone bath, and was so pleased to find this Picasso design by Lusso Stone, which is a company local to where I'm from in Middlesbrough,' says Jane. Mont Blanc marble-effect floor tiles from Tile Giant complete the look

▼ *Walk-in shower*
 Hexagonal tiles add interest to this corner of the bathroom; for a similar design, try the Aspect Grey tile at Walls and Floors. The bespoke black-trim screen is by Spiral Hardware, and for similar black sanitaryware, try Drench



resulting in an expensive solution to re-route the pipes. 'It was very frustrating because we then had to scale back what we had wanted to spend on the kitchen,' explains Jane. 'Darren suggested we look at Howdens, which I was a bit unsure about at first, but after visiting the showroom I was pleasantly surprised by the choice and the robust quality.'

Once the building work had finished, Jane rolled out her vision for the new space, which was influenced by interior design in Melbourne's many city-centre coffee shops. 'Coffee is like a religion there – everyone goes for breakfast, and the shops are beautifully styled with a great vibe,' she says. 'One of my favourite places had pink and brass fittings and an amazing terrazzo floor. So I chose brushed gold taps, blonde-wood furniture, handleless cupboards and sleek black appliances.'

By this point, the rest of the house was in good shape too, with the floors sanded, fitted wardrobes installed and walls replastered, ready to decorate. In our Australian house, everywhere was painted white because of the light, whereas here we wanted the rooms to feel cosier with some colour on the walls,' Jane explains. 'A palette of greens, golds and dusky pinks works so well with our Mid-century furniture.' ▶



‘We chose a palette to include greens and dusky shades, which we knew would work well with our Mid-century furniture’

▲ *Stanley's room*
Painting the floor in Little Greene's Lamp Black grounds this teen bedroom with its white walls and vintage furniture. For a similar velvet chair, try the Ella from Cult Furniture; for a retro *Star Wars* poster, try Amazon

Jane also took inspiration from interior designers Emma Gurner and Sarah Sherman Samuel. 'I love the way Emma decorates the ceiling, treating it like a fifth wall, so I've done this in our bedroom with a pale pink,' she says. 'Sarah's style is light and clean, and I like how she pairs Mid-century furniture and marble.'

Contemporary lighting and artwork bring depth to each room; the couple love photography by Derek Swalwell and Gemma Booth, and are fans of lighting company Spark & Bell. 'Their designs are beautiful and affordable, plus I like to support small businesses,' says Jane.

Light and warmth come together perfectly in Jane and Ian's home, forming a comfortable yet stylish setting that is appreciated by both family and friends. 'We're really happy with the results,' she says. 'The house has such a great feeling.' 📍

HIGHLY EFFECTIVE, ENERGY EFFICIENT

DIY Heat Recovery Ventilation Kit



bre✓

- ✓ Push-fit semi rigid duct system
- ✓ BRE Certified
- ✓ Complete range for every residential application
- ✓ Powerful user friendly app



Free Amazon Echo Dot when ordering any kit



Order now: **0116 298 7046**

Scan with camera to go to our online store¹



¹Amazon Echo Deal only available when ordering via phone number on this advert