



**Contact us for a quote today.**

**Introducing** NursePod, a remote turn-key nurse facility solution to assist in safely re-opening educational facilities. As schools prepare to re-open, a key concern districts face is to provide isolation spaces to reduce risk of transmission. In response to guidance from Health, ASHRAE and Government guidelines, NursePod provides a code compliant facility located remotely to protect students, staff and all building occupants. Constructed as a modular structure, this provides for fast turnaround and avoids costly and time-consuming existing building alterations and related construction issues. Our flexible lease options provide you with the means to address the immediate need as well as a potential long-term asset that is designed to serve many potential uses.



Rendering of structure exterior

[NursePod.com](http://NursePod.com)  
[info@nursepod.com](mailto:info@nursepod.com)

Serving Public & Private School Districts, Colleges & Universities, Municipalities, Assisted Living, Senior Housings, Daycare Centers.

NursePod, Inc. Proudly Made in USA 833-980-9888

R2.0

**Excerpt from the New York State Education Department (NYSED) Guidance on Nurse's Office:**

"Ideally schools should have two rooms for school health personnel- one room for healthy students who have injuries or need their medications or nursing treatments, and another room for assessing and caring for ill students and staff. Both rooms require a supervising adult to be present and should have easy access to a bathroom and sink with hand hygiene supplies."

"Students suspected of having COVID-19 awaiting transport home by the parent/guardian must be isolated in a room or area separate from others, with a supervising adult present utilizing appropriate PPE."

Districts may choose to expand their square footage to better cope with COVID-19. "Projects that are labeled as "COVID-19 Reopening" will be expedited. Leased facilities, modular buildings, tents, additions, and alterations require an LOI and typical project submission requirements; pre-screening will be waived. Questions can be directed to the OFP."

**Excerpt from ASHRAE's Task Force on Re-opening Schools includes the following guidance on nurse facility:**

- ▶ Treat as isolation rooms – 1 bed per building follow ASHRAE 170 and 2019 ASHRAE Handbook Chapter 9.
- ▶ If retrofits are not possible, recommend temporary nurse's station trailers.
- ▶ Dedicated bathrooms.
- ▶ The nurse station will include Anteroom/ Protective Equipment Room.
- ▶ Normal non-isolation nursing office.
- ▶ Provisions for biohazard waste.
- ▶ The HVAC operation will be "Isolation mode" OR "Normal Mode".
- ▶ Follow CDC guidelines for supply air return air paths, do not mix isolation room air with any other spaces. Directly exhaust isolation rooms. Follow design guidelines for location of OA intakes and exhaust air from exhaust fans.
- ▶ Recommend locations of nurse's office HVAC on an exterior wall.



## The NursePod Solution

**Guidance from State officials as well as ASHRAE for school nurse facilities as shown above make it clear that existing spaces were simply not designed for how to function during a pandemic or to slow transmission of viruses.**

**Modifying the Nurse's Office in an existing facility is difficult, if not impossible, especially considering the time frame in preparing the schools to be ready for the possibility that a child may exhibit symptoms of COVID-19. Physical changes involve planning and design, testing for asbestos and lead with abatement/remediation, public bidding and a lengthy construction...all to make permanent physical changes to a building for a current situation.**

[NursePod.com](http://NursePod.com)  
[info@nursepod.com](mailto:info@nursepod.com)

Serving Public & Private School Districts, Colleges & Universities,  
Municipalities, Assisted Living, Senior Housings, Daycare Center  
NursPod, Inc. Proudly Made in USA 833-980-9888. R2.0



SCHEMATIC FLOOR PLAN  
NOT TO SCALE

833-980-9888 NursePod.com NursPod, Inc.  
info@nursepod.com

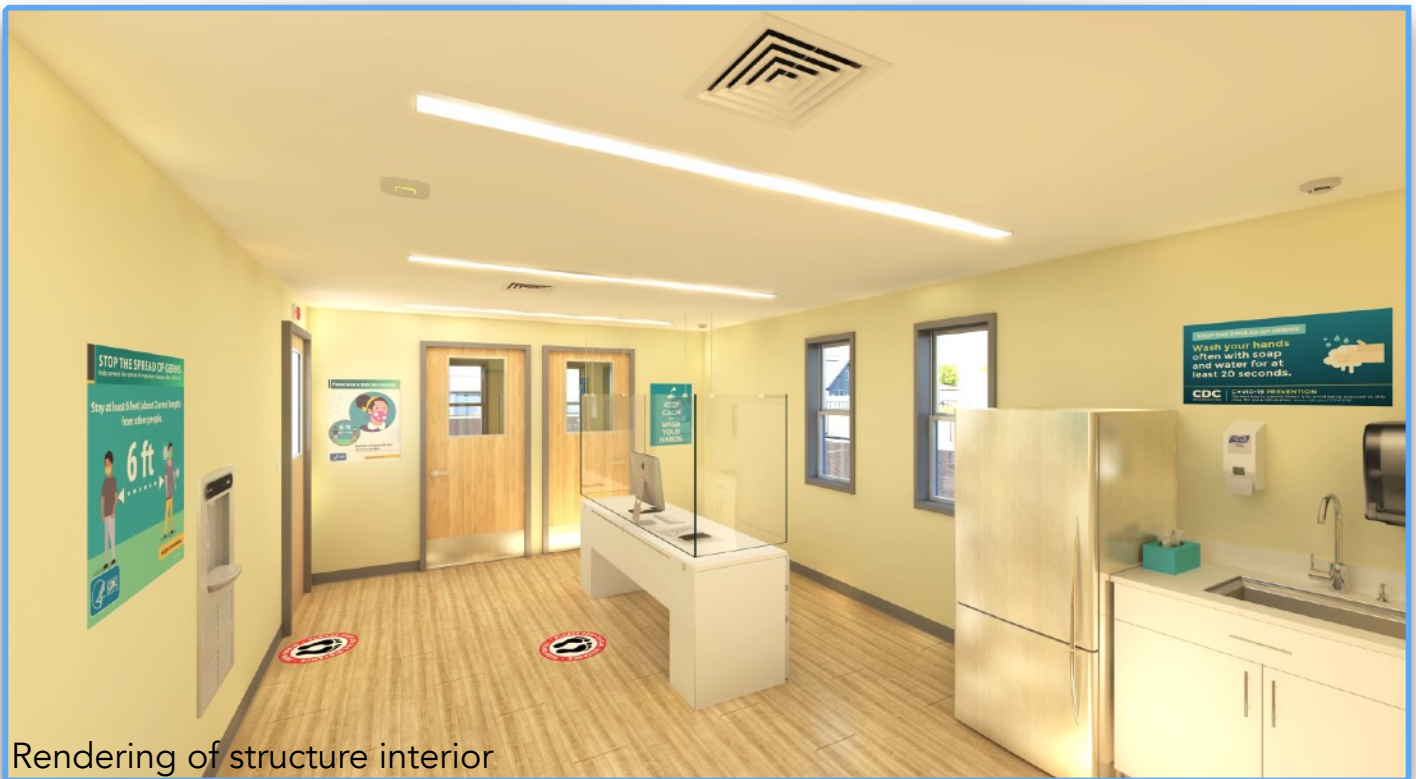
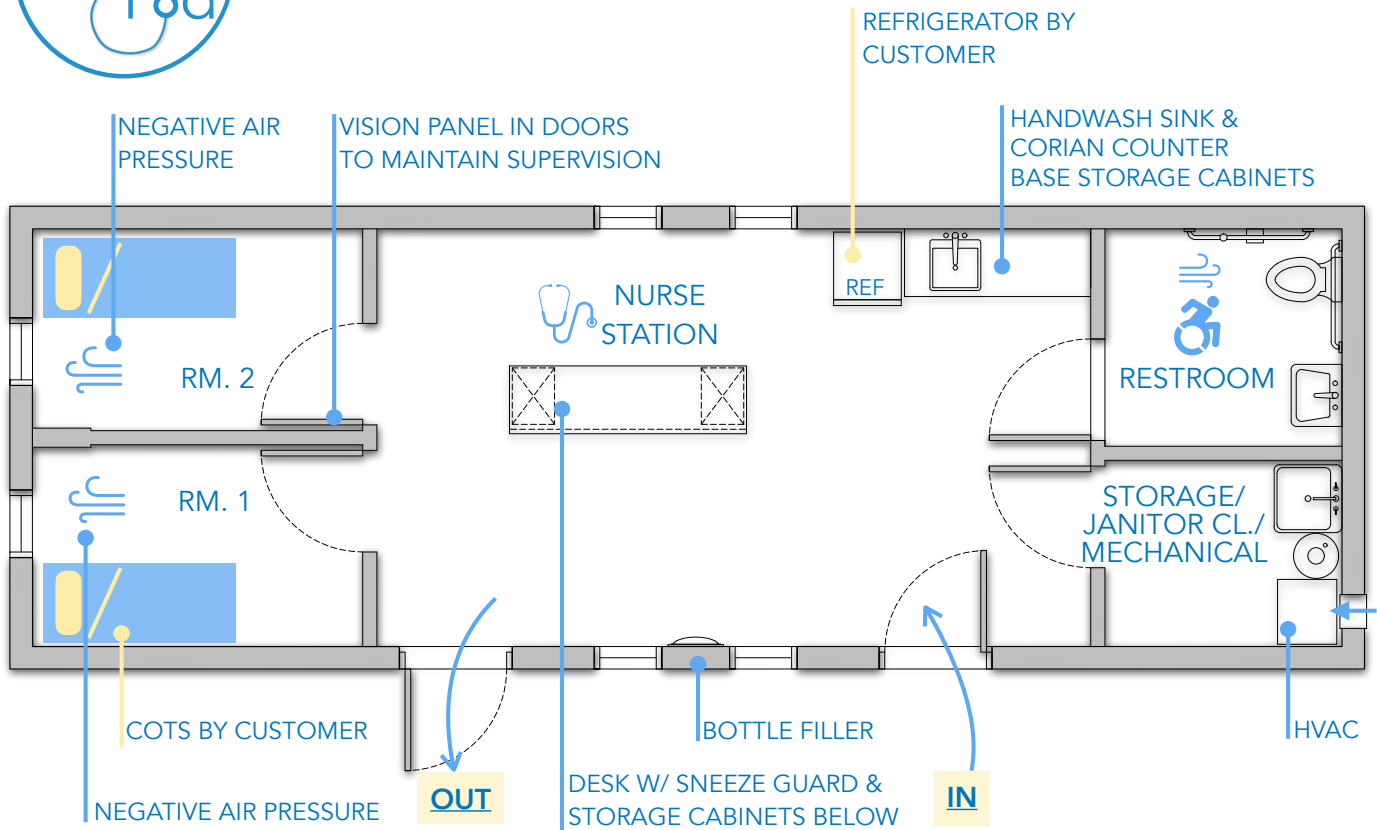

Rendering of structure interior

## Why is NursePod the right solution?

Recommendation	NursePod Solutions		Existing School Approach	
Isolation rooms that meet ASHRAE 170	Meets ASHRAE 170 and ASHRAE Handbook Chapter 9 requirements	✓	Using an empty room with a unit ventilator that pushes potentially contaminated relief air into the corridors, or window A/C that recirculates air	✗
Washable surfaces	Antibacterial counters, touchless faucets, washable surfaces	✓	School renovations require demolition, construction, potentially lead/asbestos remediation	✗
Dedicated bathroom	ADA accessible bathroom	✓	Schools' assigned room rarely has a bathroom. And they are often not ADA compliant.	✗
PPE supplies storage	A large storage room and cabinets are included for storing PPE supplies.	✓	Converted classrooms do not have adequate space for dedicated PPE storage.	✗
Biohazard waste	Bio-waste container included with NursePod.	✓	School must purchase separately	✗
Two modes of HVAC operation	Modular has switched exhaust fans when isolation rooms are in use	✓	None	✗
Pressure relationships	Modular has isolated waiting rooms switched to negative pressure, exhausting air to exterior when rooms are in use.	✓	None	✗

NursePod is a **modular building** suitable as an educational support space. It is code compliant, accessible, safe and inviting.

Other potential uses for NursePod when a remote nurse facility is no longer needed:

- **Teacher Resource Center**
- **Field House**
- **Special Education**
- **School Psychology**
- **Post-Secondary Career Office**
- **Guidance Counselor**
- **Athletic Trainer**



Custom color options available for school colors and school spirit!



[NursePod.com](http://NursePod.com)  
[info@nursepod.com](mailto:info@nursepod.com)

Serving Public & Private School Districts, Colleges & Universities, Municipalities, Assisted Living, Senior Housings, Daycare Center  
 NursPod, Inc. Proudly Made in USA 833-980-9888. R2.0

# The NursePod Solution



## Isolation

In accordance to State Education and ASHRAE guidance; students who show symptoms of any communicable or infectious disease shall be excluded from the school and isolated in another room for assessment and care while waiting for their guardian. NursePod offers two (2) separated but supervised rooms to provide a safer working environment for the health personnel while maintaining supervision of the ill student.



## Thoughtful Design

NursePod is thoughtfully designed with care to prevent the stigma of being ill. Both the interior and exterior project a sense of calm with inviting warm color tones. Students feel welcomed and safe while resting comfortably with privacy and proper supervision. NursePod is equipped with:

- Easy to clean finishes to prevent bacterial growth.
- Durable materials to withstand harsh cleaning agents
- Customization in finishes available to match school colors and to promote school spirit.



## Compliance

MyNursePod was designed to meet the various governing agencies' recommendations and guidance on how to re-open schools.

MyNursePod is:

- ADA compliant
- Installed on campus but remote from the school building to minimize spread of airborne diseases
- Designed to help protect student confidentiality for FERPA compliance.
- Designed to meet ASHRAE 170 requirements:
  - ▶ (2) air exchanges/hr for outside air
  - ▶ (6) air exchanges/hr for isolation rooms.
  - ▶ Negative air pressure



## Connectivity

NursePod comes with conduits ready for field specific wiring installation to save the school districts time and money:

- Fire alarm back boxes
- Back boxes for WIFI/Data connections

[NursePod.com](http://NursePod.com)

[info@nursepod.com](mailto:info@nursepod.com)

Serving Public & Private School Districts, Colleges & Universities, Municipalities, Assisted Living, Senior Housings, Daycare Centers.

NursPod, Inc. Proudly Made in USA 833-980-9888

R2.0