

WEIGHT = 602.13 LBS.

ROTATES 127° TO OPERATOR'S LEFT

(HOSES RATED FOR 15,000 PSI BURST PRESSURE)

2" BORE X 3.5" STROKE
CYLINDER
9425 LB PUSH
7069 LB PULL

2.5" BORE X 12.5" STROKE
CYLINDER
14726 LB PUSH
11045 LB PULL

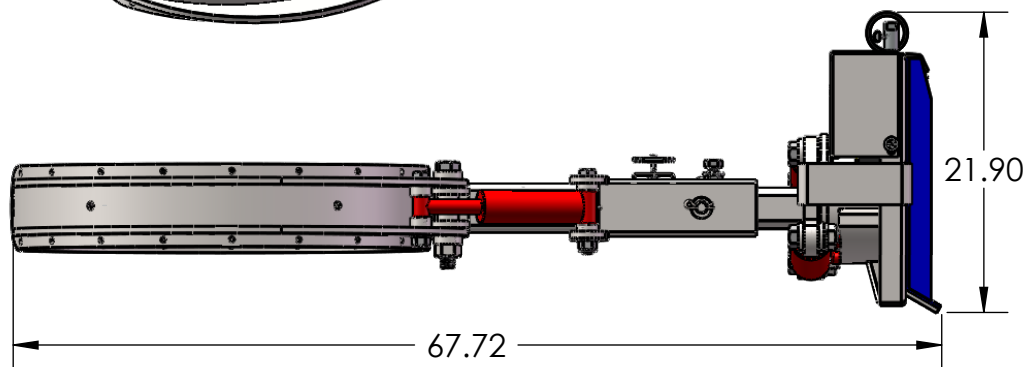
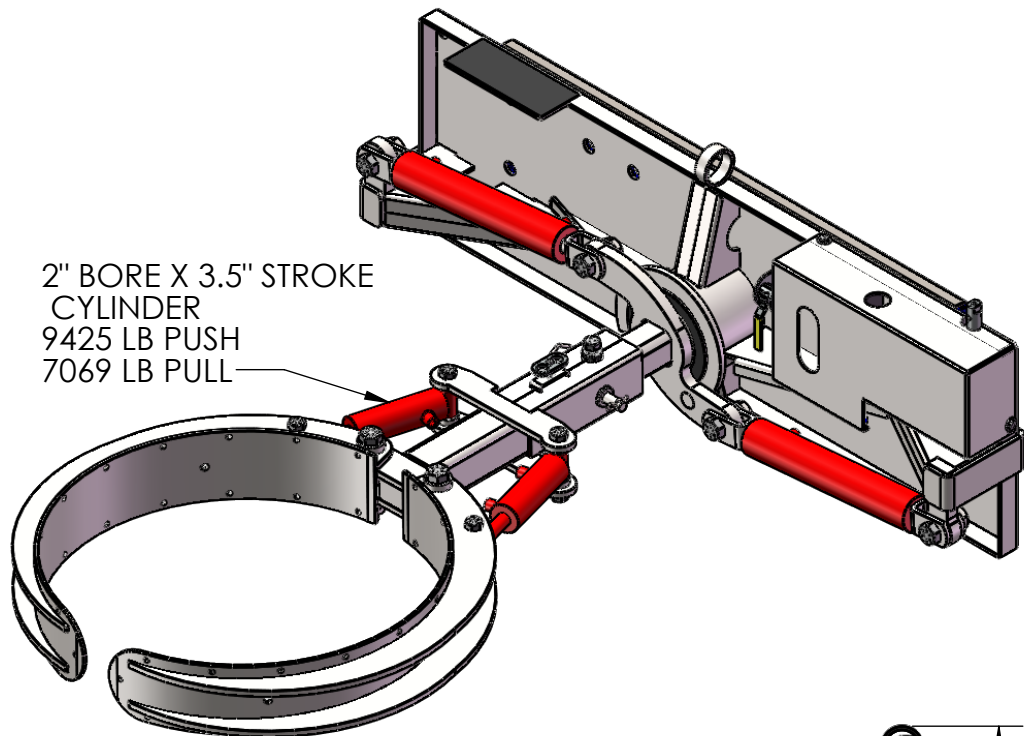
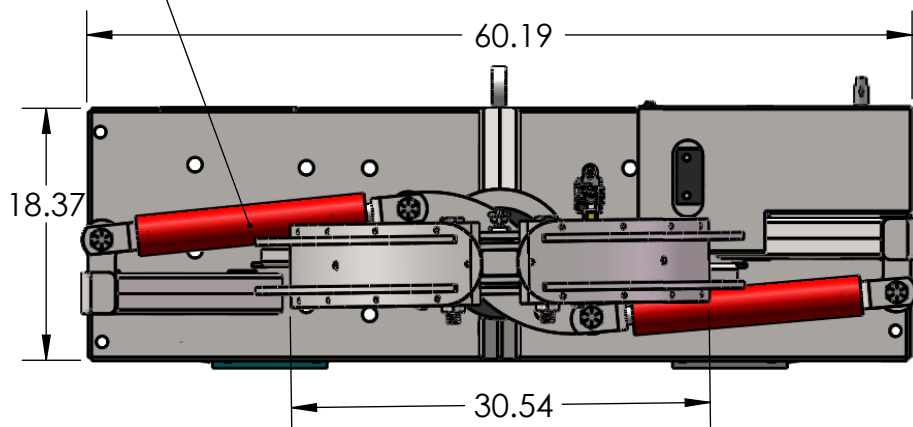

				UNLESS OTHERWISE SPECIFIED:		NAME		DATE		<div>EZ-SPOT-UR</div> <div>TITLE: ASSY, 110 GALLON BARREL HANDLER ON DOUBLE CYLINDER ROTATING BASE</div> <div>SIZE A</div> <div>DWG. NO. EZ-01-0018 - CLOSED 110 GAL BARREL HANDLER</div> <div>REV A</div> <div>SCALE: 1:14</div> <div>WT: 602.13 LBS.</div> <div>SHEET 1 OF 1</div>					
				DIMENSIONS ARE IN INCHES		DRAWN		TIM R.						7-22-2010	
				TOLERANCES:		CHECKED									
				FRACTIONAL ±		ENG APPR.									
				ANGULAR: MACH ± BEND ±		MFG APPR.									
				TWO PLACE DECIMAL ±		Q.A.									
				THREE PLACE DECIMAL ±		COMMENTS:									
REVISIONS				INTERPRET GEOMETRIC TOLERANCING PER:											
REV.	DESCRIPTION			DATE	APPROVED	MATERIAL N/A									
A	UPDATED THE CYLINDER INFORMATION			10/22/2019	BEVAN	FINISH									
<div>PROPRIETARY AND CONFIDENTIAL</div> <div>THE INFORMATION CONTAINED IN THIS DRAWING IS THE SOLE PROPERTY OF EZ-SPOT-UR. ANY REPRODUCTION IN PART OR AS A WHOLE WITHOUT THE WRITTEN PERMISSION OF EZ-SPOT-UR IS PROHIBITED.</div>															
				NEXT ASSY		USED ON									
				APPLICATION				DO NOT SCALE DRAWING							