



For MrSteam Models
CU360A, CU500A, CU750A, CUI000A, CUI250A and CUI400A

IMPORTANT NOTE: As you follow these instructions, you will notice warning and caution symbols. This blocked information is important for the safe and efficient installation and operation of this Generator. These are types of potential hazards that may occur during this installation and operation:

 **WARNING** states a hazard may cause serious injury or death if precautions are not followed.

 **CAUTION** signals a situation where minor injury or product damage may occur if you do not follow instructions.

IMPORTANT NOTE: This highlights information that is especially relevant to a problem-free installation.

 **WARNING** TO AVOID A SHOCK HAZARD, BE CERTAIN ELECTRICITY IS SHUT OFF AT MAIN PANEL BEFORE ATTEMPTING TO WIRE OR SERVICE THE PC BOARD. CU BOILERS MAY HAVE A DISCONNECT FOR BOTH THE CONTROL CIRCUIT AND THE POWER CIRCUIT.

 **WARNING** Electric shock hazard. MrSteam boilers are connected to high voltage and contain live electrical components. All installation and service to be performed by qualified and licensed electricians and plumbers only. Installation or service by unqualified persons or failure to use Sussman-Automatic parts may result in property damage or in a personal injury.

IMPORTANT NOTES:

1. CU Generator Board Replacement only to be performed after consultation with a MrSteam Technical Service Representative.
2. REPAIR PROCEDURES MUST BE ACCOMPLISHED BY A QUALIFIED LICENSED ELECTRICIAN.
3. Use only MrSteam supplied replacement parts.
4. Follow all instructions in the CU Series Steam Generator Installation, Operation, and Maintenance Manual. This manual is provided with the CU generator and is also available online at: www.mrsteam.com.

I04477 Kit Parts

- 1x I04456 CU Board Adapter
- 1x I04460 Level Control Board
- 4x A0172 Screw 6-32x3/8" SS Type F
- 4x A0252 Screw 6-32x7/8" SS Type F

Tool required (not provided)

- #2 Philips head screwdriver

For MrSteam Models
CU360A, CU500A, CU750A, CUI000A, CUI250A and CUI400A

Figure 1

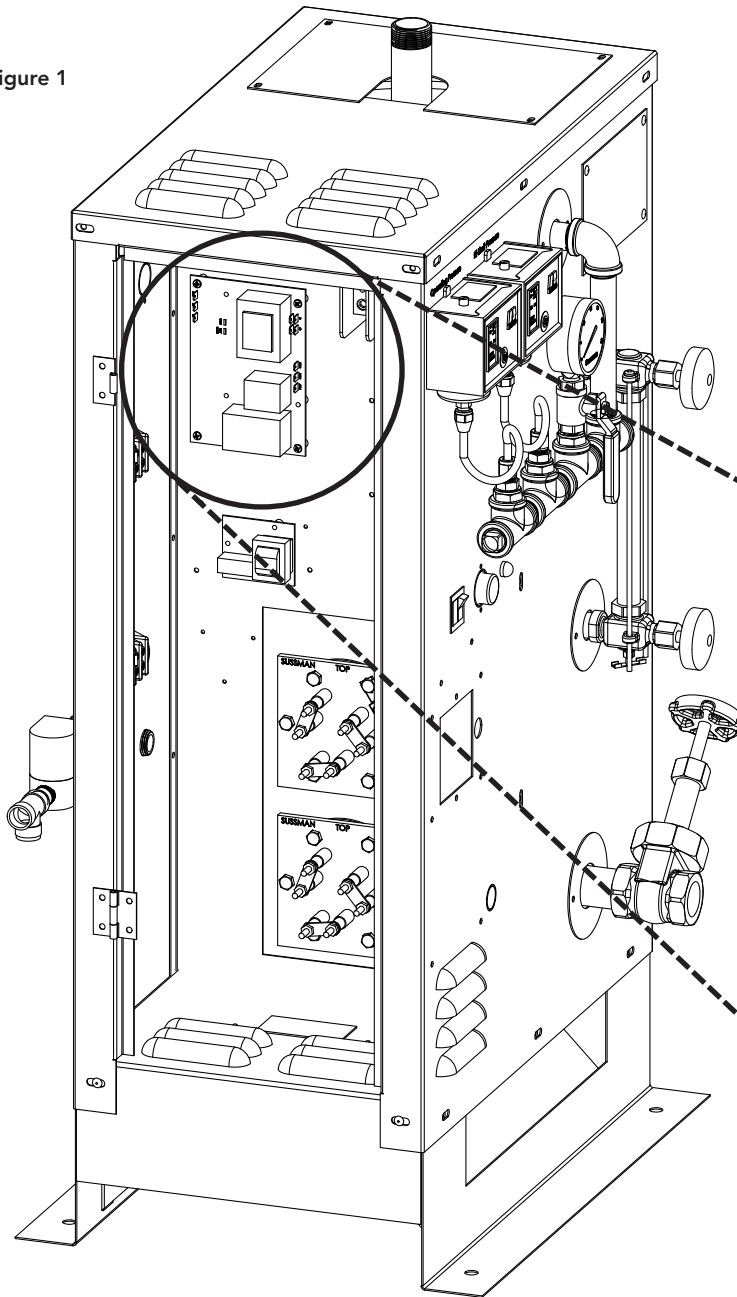

Installation Instructions

! WARNING Shock hazard. Power must be disconnected at the main electrical supply before opening boiler cabinet door.

1. Locate the existing board (see Fig. 1)
2. Remove the wiring noting where each wire was connected..
3. Remove the board from the jacket by removing the 4 mounting screws.(see Fig. 1a)

Figure 1a

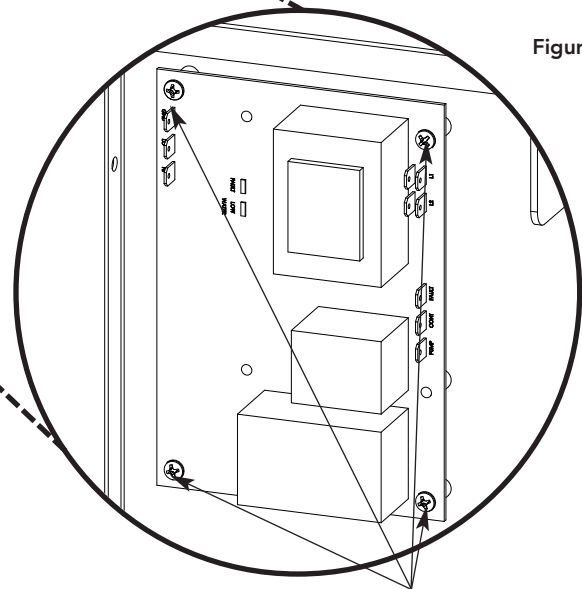

Mounting Screws

For MrSteam Models
CU360A, CU500A, CU750A, CU1000A, CU1250A and CU1400A

4. Place the adapter plate (I04456) over the original mounting holes. (see Fig. 2) **The mounting plate is only required when boilers do not have the the mounting holes for the I04460 board.**
5. Mount the plate by threading the 3/8" screws (A0172) through the plate and to the jacket.
6. Align the new board (I04460) as shown.
7. Mount the board by threading the 7/8" screws (A0252) through the board and into the adapter plate.

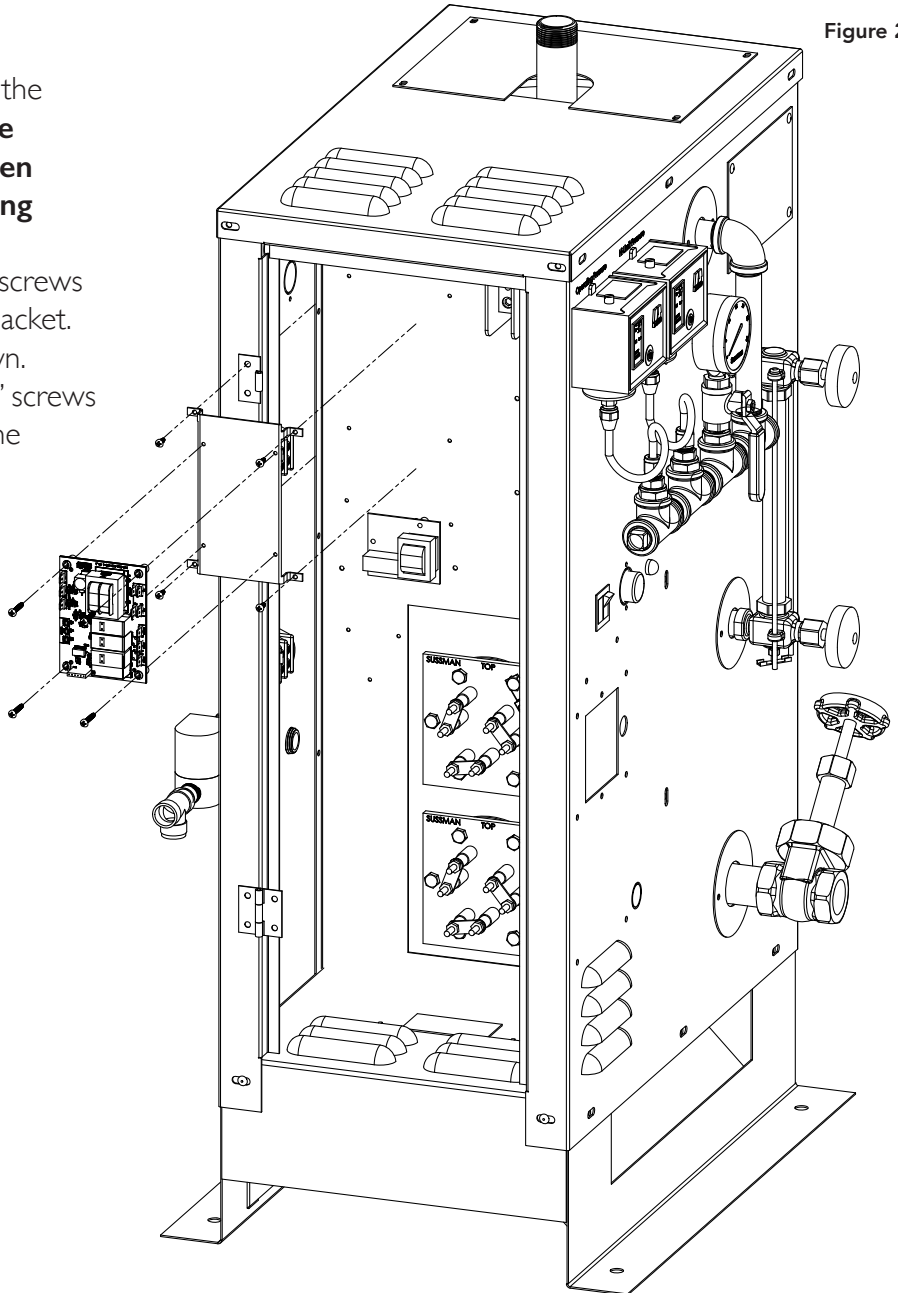

Figure 2

For MrSteam Models
CU360A, CU500A, CU750A, CU1000A, CU1250A and CU1400A

Figure 3

8. Connect Green/Yellow wire to GND terminal on the board.
9. Connect Purple wire to LOW terminal on the board.
10. Connect Pink wire to HIGH terminal on the board.
11. Connect Black wire to PUMP terminal on the board.
12. Connect Orange wire to CONT terminal on the board.
13. Connect White wire to L2 terminal on the board.
14. Connect Black wire to L1 terminal on the board.
15. Close the boiler cabinet door
16. Power may be restored at the main electrical supply.
17. Test the new board per the "Pre Operation Check" section of the CU Series Steam Generator Installation, Operation and Maintenance Manual.

