

# **The Escape POA, Inc.**



## **Welcome Packet**

**Phone 570-857-9090**

Welcome to **The Escape Property Owners Association, Inc.** We have put together this packet for you to have a quick reference to some commonly accessed phone numbers. There is no way we could include every number there is for any certain category, so also please reference a local phone book or the internet for more options. We do not recommend anyone in particular. Please use your discretion when using any services from the numbers we have listed. Ask your friends and neighbors for their references and experience with any of the businesses listed. A personal recommendation is always best.

Please familiarize yourself with the Community By-Laws and the Rules & Regulations. These are what the association runs on and is ruled by.

We ask that you please keep your information on file up to date. This includes your mailing address, phone numbers and emergency contacts. Also, be aware that each year by June 1, you are required to bring your automobile registrations to the office so you can obtain current EPOA parking stickers for your vehicles. Parking stickers are required to park at common areas in The Escape. New parking stickers are issued each January.

For Dock owners, Boat owners, Jet Ski owners, ATV and Golf Cart owners: The following information must be updated annually to receive EPOA stickers:

**Docks:** Dock registration form for Owner and/or Renter of dock

**Boats:** Current Registration and Insurance pages

**Jet Skis:** Current Insurance pages

**ATV's / UTV's:** Current Registration and Insurance pages

**Golf Carts:** Current Insurance pages

**ALL OF THE ABOVE-MENTIONED RECREATIONAL ITEMS NEED CURRENT EPOA STICKERS!**

You can find current information pertaining to all things Escape at our website, [theescapepoa.com](http://theescapepoa.com) or on our Facebook page, The Escape POA.

Information included on the website: Meeting Dates, Meeting Minutes, Important Announcements, Board Members, Events and Pictures, to name a few.

The Facebook page is a great way to meet and get to know your neighbors.  
Please check it often for the most up to date information.

For emergency announcements and reminders, think about signing up for **REMIND**, a text/email service that we use for that purpose. See attached info on how to sign up. We also use "Call-Em-All", a robocall service for emergencies. If you receive a robocall, there is no need to contact us back; just listen to the message.

# EPOA REFLECTIVE ADDRESS MARKER SIGNS

Get Help in Case of Emergency!

If you can't be FOUND, you can't be HELPED!

Order your ADDRESS SIGN today

**BEFORE** you NEED it!

Sign Features: Highly Visible Day or Night

**Only  
\$20**

Reflective Material on Both Sides

Fade Resistant, Lasts for Years

Pre-drilled Holes (you supply post if needed  
or can be installed on house)

White Reflective Numbers on Green Background

Sign is also great to get deliveries (UPS, Fed Ex, Flowers,) or give  
directions via GPS devices.

Signs need to be picked up from the office. Please fill out the form below and  
return it with a check or money order for \$20 per sign to the office either in  
person or by mail.

The Escape POA, P.O. Box 282, Greentown, PA 18426

Name: \_\_\_\_\_

Address: \_\_\_\_\_

Phone # \_\_\_\_\_

Physical Escape Address (Number To Be On Sign – NOT LOT #) \_\_\_\_\_

Vertical – 2 sided for post \_\_\_\_\_ Horizontal – 1 sided for house \_\_\_\_\_

If you are unsure of you address number, please call the office 570-857-9090



Office Hours:

Sunday: Closed

Monday: 8:30 - 4:30

Tuesday 8:30 - 4:30

Wednesday: Closed

Thursday: 8:30 - 4:30

Friday: 8:30 - 4:30

Saturday: 9:00 - 3:00

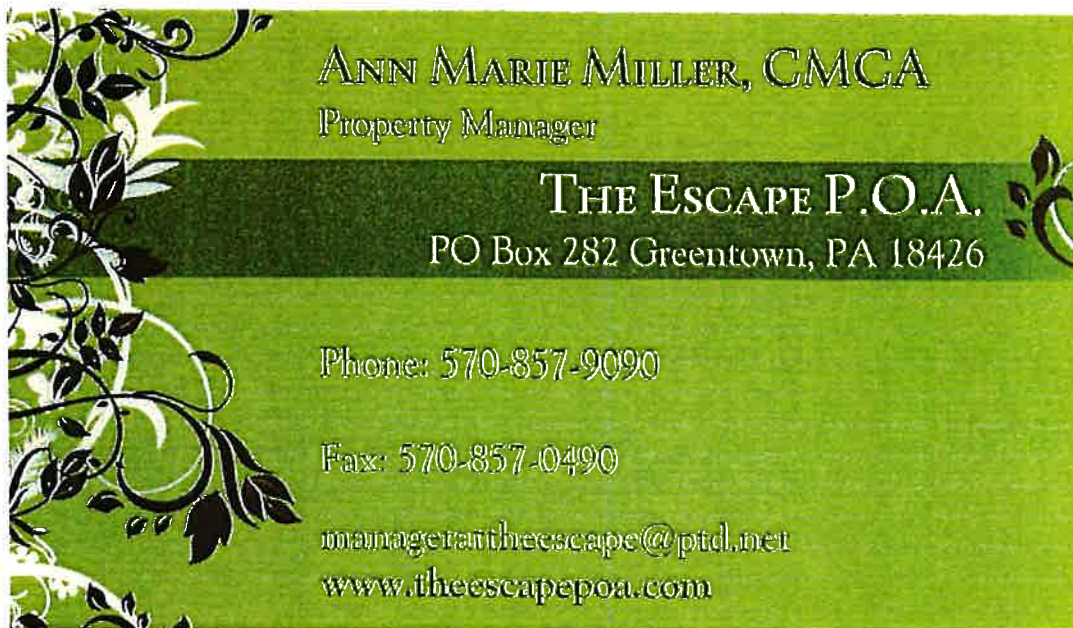

Please feel free to call or email with any questions.



## THE ESCAPE SCHOOL BUS REGULATIONS

- EPOA Speed limit is 15 mph. All drivers must observe the speed limit and all stop signs but especially the one at Escape Way and the Roundhouse. Anyone speeding or not making a complete stop at the stop sign will be cited.
- No moving of any vehicle while bus lights are flashing yellow or red on EPOA property. This means all buses or other vehicles with "Wallenpaupack School Bus" transportation on the vehicle.
- Parking is permitted only at designated parking areas. Anyone parked either at the incoming or outgoing lanes or in any place there are no designated lines for parking will receive a citation.
- EPOA regulations on littering are in effect in the parking lot. Please take your trash with you.
- Parents must keep an eye on their children when exiting and entering vehicles.
- There will be no written warnings for any of these violations. Please be courteous to other people.

Have a safe school season.

A handwritten signature in cursive script that reads "Ann Marie Miller".

Ann Marie Miller  
Property Manager



# The ESCAPE

Property Owner's Association

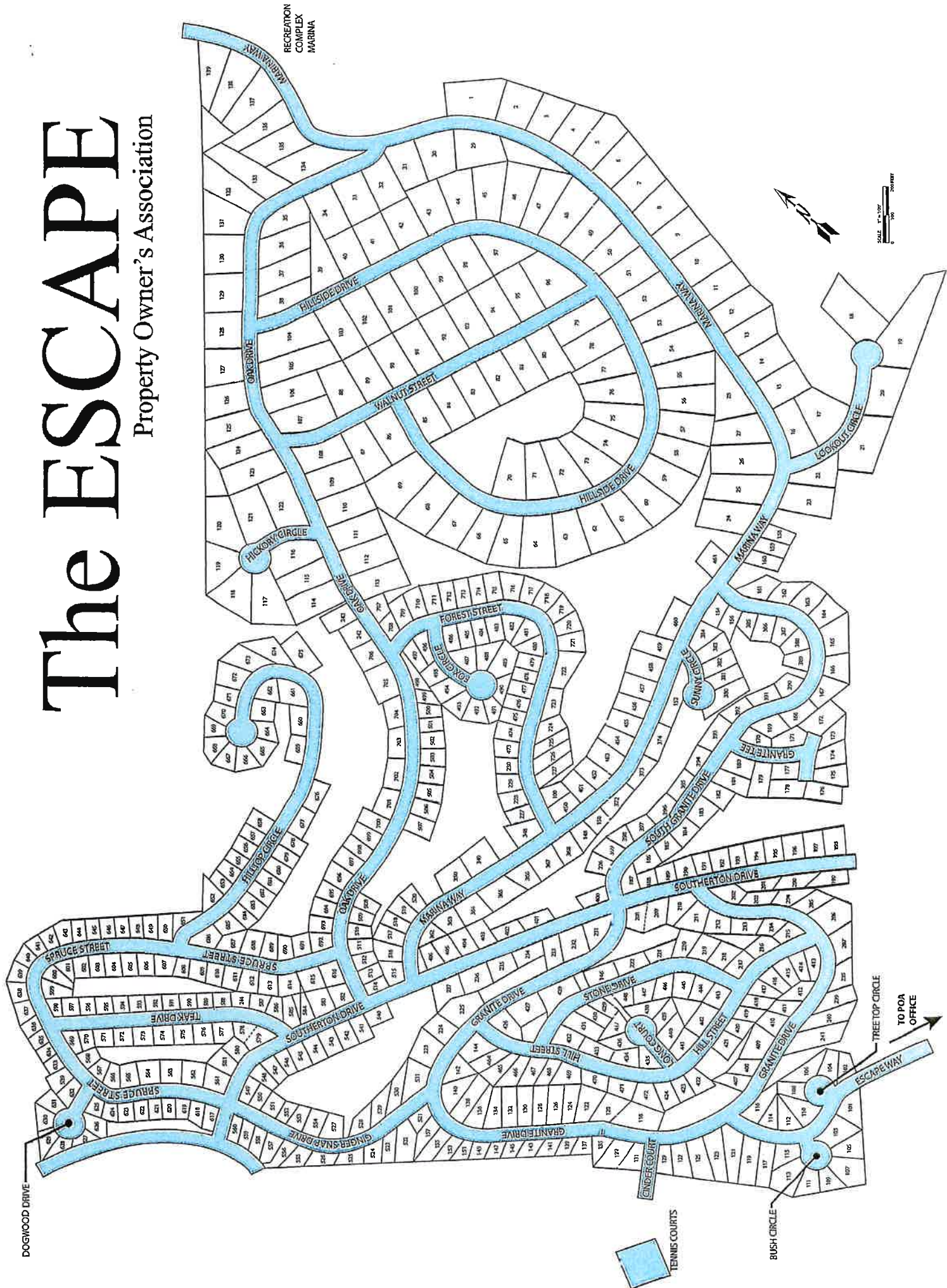



# LAKE WALLENPAUPACK

## 5,700 acres

### PRIMARY SPECIES OF WALLENPAUPACK



LAKE WALLENPAUPACK

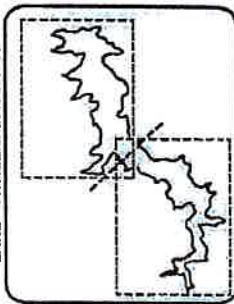

DEPTH IN FEET

BOAT DOCKS - MARINA

SUBMERGED ROAD BEDS

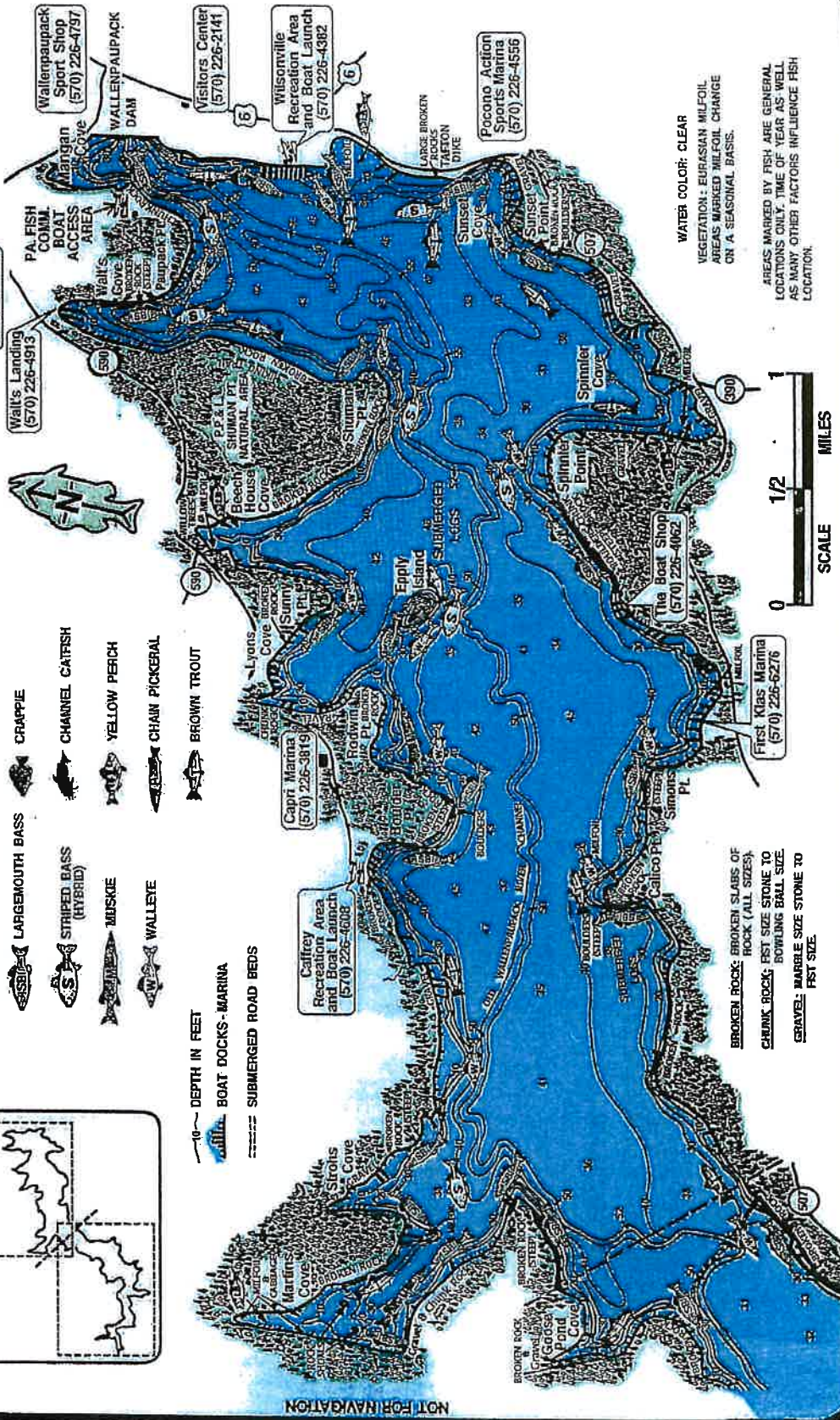

WATER COLOR: CLEAR

VEGETATION - EURASIAN MULFOIL AREAS MARKED MULFOIL CHANGE ON A SEASONAL BASIS.

AREAS MARKED BY FISH ARE GENERAL LOCATIONS ONLY. TIME OF YEAR AS WELL AS MANY OTHER FACTORS INFLUENCE FISH LOCATION.

First Kids Marina (570) 226-6276

BROKEN ROCK: BROKEN SLABS OF ROCK (ALL SIZES)  
CHUNK ROCK: FIRST SIZE STONE TO BOWLING BALL SIZE  
GRAVEL: MARBLE SIZE STONE TO FIRST SIZE



## Useful Phone Numbers For Your Information

THE ESCAPE ADMINISTRATION OFFICE	570-857-9090
EMERGENCY	911
PA STATE POLICE BLOOMING GROVE STATION	570-226-5718
PA STATE POLICE HONESDALE STATION	570-253-7126
GREENE-DREHER VOLUNTEER FIRE COMPANY	570-676-4207
GREEN TOWNSHIP OFFICES	570-676-3910
	570-676-9325
PALMYRA TOWNSHIP OFFICE/WAYNE COUNTY	570-226-6566
GREENTOWN POST OFFICE	570-616-3790
PIKE COUNTY ADMINISTRATION	570-296-7744

### ANIMAL CONTROL/ANIMAL SHELTERS

COUNTY DOG WARDEN	570-350-3589
STATE DOG WARDEN	570-350-2563
DESSIN ANIMAL SHELTER	570-253-4037
PIKE COUNTY HUMANE SOCIETY	570-296-1654

### BANKS

CITIZENS SAVINGS BANK	570-253-2560
THE DIME BANK	570-676-8390
FIRST NATIONAL COMMUNITY BANK	570-251-8840
HONESDALE NATIONAL BANK	570-253-3355
WAYNE BANK	570-253-1455

### CABLE TV/INTERNET

BLUE RIDGE COMMUNICATIONS, HAWLEY	570-226-4914
-----------------------------------	--------------

### HARDWARE/HOME CENTERS

GREENTOWN AGWAY	570-676-9860
GUMBLE BROS; GREENTOWN	570-226-8380
HOME DEPOT, HONESDALE	570-253-3148
LOWE'S, MT. POCONO	570-839-6204
ROUNDHOUSE TRUE VALUE, NEWFOUNDLAND	570-676-9560
SHAFFER'S HARDWARE, HAMLIN	570-689-4071
TRACTOR SUPPLY, LAKE ARIEL	570-689-7990



### HOSPITALS/URGENT CARE

COMMUNITY MEDICAL CENTER, SCRANTON	570-969-8000
GEISINGER COMMUNITY MEDICAL CENTER, SCRANTON	570-703-8000
HAMLIN FAMILY HEALTH CENTER, LAKE ARIEL	570-689-9965
WAYNE MEMORIAL, HONESDALE	570-253-8100

### LIBRARIES

HAWLEY LIBRARY	570-226-4620
LACKAWAXEN TOWNSHIP BRANCHLIBRARY, GREELEY	570-685-3100
NEWFOUNDLAND AREA PUBLIC LIBRARY, NEWFOUNDLAND	570-676-4518
SALEM PUBLIC LIBRARY	570-689-0903

### MARINAS

1 <sup>ST</sup> KLAS MARINA, TAFTON	570-226-6276
CAPTAIN'S COVE, HAWLEY	570-226-8642
LIGHTHOUSE HARBOR, LAKE WALLENPAUPACK	570-857-0220
PINE CREST MARINA, PALMYRA	570-857-1850
SEELEY'S LANDING, HAWLEY	570-226-3055
SCHAFFER MARINE, GREENTOWN	570-676-3114
WALT'S LANDING, HAWLEY	570-226-4913

### MISCELLANEOUS PA INFO.

PA FISH & BOAT COMMISSION	570-448-2101
PENNDOT - INTERSTATE ROAD CONDITIONS	TOLL FREE 511

### OIL/PROPANE SUPPLIERS - HELLER'S GIVES COMMUNITY RATE

AMERIGAS, HONESDALE	570-616-0743
COMBINED ENERGY SERVICES, HONESDALE	570-251-8700
EASTERN PROPANE, HAWLEY	570-226-3771
FOWLER OIL COMPANY, HONESDALE	570-253-2686
HELLER'S GAS IN LAKE ARIEL (COMMUNITY RATE)	570-752-8451
HIGHHOUSE OIL COMPANY, HONESDALE	570-253-3520
HOWE OIL, LAKE ARIEL	570-689-5821
PAUPACK FUEL OIL, HAWLEY	570-226-4823
POCONO OIL & PROPANE, HAWLEY	570-226-4501
SANTARELLI OIL, PECKVILLE	570-489-7690
SUBURBAN PROPANE, HONESDALE	570-253-1890
TOWN & COUNTRY ENERGY CORP, HONESDALE	570-224-6777

### PHARMACIES

CVS, HAMLIN	570-689-5011
CVS, CRESCO	570-595-7131
CVS, HAWLEY	570-226-6550
CVS, MT. POCONO	570-839-6670
CVS, HONESDALE	570-253-1730
RITE AID, HAWLEY	570-775-0405
STEPHENS PHARMACY, HAWLEY	570-226-3900
STEPHENS PHARMACY, HONESDALE	570-253-7700
WELLSPRING HOMEOPATHIC PHARMACY, HONESDALE	570-253-5650

### PHONE COMPANIES

BLUE RIDGE COMMUNICATIONS	570-296-8200
FRONTIER COMMUNICATIONS	800-921-8101
VERIZON	800-483-5000

### PHYSICIANS/DENTISTS

PLEASE ASK YOUR FRIENDS, NEIGHBORS AND/OR CURRENT DOCTORS FOR RECOMMENDATIONS

### REALTORS

CENTURY 21	570-676-4900
KELLER WILLIAMS	570-296-6400
WEICHERT	570-296-5292

### RESTAURANTS

\* SEE LAST PAGE OF THIS PACKET OR CONSULT A LOCAL PHONE BOOK

### SCHOOLS

WALLENPAUPACK PRIMARY SCHOOL, HAWLEY	570-226-4557
WALLENPAUPACK SOUTH ELEMENTARY SCHOOL, NEWFOUNDLAND	570-676-3335
WALLENPAUPACK NORTH INTERMEDIATE SCHOOL, HAWLEY	570-226-4557
WALLENPAUPACK AREA MIDDLE SCHOOL, HAWLEY	570-226-4557
WALLENPAUPACK AREA HIGH SCHOOL, HAWLEY	570-226-4557

### SEPTIC

R.L. FENKNER, GREENTOWN	570-857-0105
KOBERLEIN, LOCAL AREAS	888-345-6688
SEPTIC SURGEONS, LOCAL AREAS	877-874-4822



### SERVICE STATIONS

590 SERVICE STATION	570-685-2690
AJ'S AUTOMOTIVE, GREENTOWN	570-676-3116
FOWLER SERVICE STATION, HONESDALE	570-253-2180
UPTOWN TEXACO, HONESDALE	570-253-9777

### SHOPPING CENTERS

STEAMTOWN MALL, SCRANTON	570-343-3400
VIEWMONT MALL, DICKSON CITY/SCRANTON	570-946-9165
WALMART, HONESDALE	570-251-9543
WALMART, MILFORD	570-491-4940
WALMART, MT. POCONO	570-895-4700

### SUPERMARKETS

DUTCH'S MARKET, GREENTOWN	570-676-3373
WEIS, HAMLIN	570-689-7791
* ALSO SEE LOCAL PHONE BOOK	

### TRASH REMOVAL/DUMPSTERS

AFFORD A DUMPSTER	888-431-JUNK
AFFORDABLE DUMPSTERS	570-427-4976
BUNNELL WASTE REMOVAL	570-253-5082
COUNTY WASTE & RECYCLING	570-685-5000
MURRAY'S ROLL OFF DUMPSTER SERVICES	570-839-7400
WASTE MANAGEMENT	800-869-5566
WASTE REDUCTION	570-825-3522

### TREE SERVICE

BLUE OX TREE SERVICE	570-677-8914
SCHMIDT TREE SERVICE	570-309-8699

### UTILITIES

PA POWER & LIGHT (PPL)	800-342-5775
------------------------	--------------

### VETERINARIANS

CHERRY RIDGE VETERINARY CLINIC, HONESDALE	570-523-2402
COUNTRYSIDE ANIMAL HOSPITAL, MOSCOW	570-842-1414
HAMLIN VERERINARY CLINIC	570-689-9905
HOUSE CALL VETERINARY SERVICE, LAKE ARIEL	570-689-0342
MILFORD ANIMAL HOSPITAL	570-296-8448
NEWTON ANIMAL HOSPITAL, NEWTON, NJ	973-383-4321

WALLENPAUPACK VETERINARY CLINIC, HAWLEY

570-226-2212

AMUSEMENT/ENTERTAINMENT

BOWLING:

IDLE HOUR LANES, DICKSON CITY	570-489-7526
PORT JERVIS BOWL, PORT JERVIS, NY	845-856-2113
SKYLANES BOWLING CENTER, EAST STROUDSBURG	570-421-7680
WALLENPAUPACK BOWLING CENTER, HAWLEY	570-226-8499

GOLF:

CLIFF PARK INN & GOLF COURSE, MILFORD	570-296-6491
HIGH POINT GOLF CLUB, MONTAGUE, NJ	973-293-0180
HONESDALE GOLF CLUB	570-253-4374
MOUNTAIN MANOR, MARSHALLS CREEK	570-223-2671
SHAWNEE INN & GOLF RESORT	570-424-4000
TAMIMENT GOLF CLUB	570-588-6652

HIKING TRAILS/STATE PARKS/NATURE:

TOO MANY TRAILS TO LIST - SEE WEBSITES LISTED BELOW / ENTER ZIP CODE  
IN THE SEARCH BAR

ALLTRAILS.COM

HIKINGPROJECT.COM

TRAILS.COM

NPS.GOV (ENTER "TRAILS" IN THE SEARCH BAR)

BUSHKILL FALLS, BUSHKILL	570-588-6682
--------------------------	--------------

CHILD'S PARK, DINGMANS FERRY	570-426-2435
------------------------------	--------------

DINGMAN'S FALLS, DINGMANS FERRY	570-828-2253
---------------------------------	--------------

POCONO ENVIRONMENTAL EDUCATION CENTER, DINGMANS FERRY	570-828-2319
---	--------------

PROMISED LAND STATE PARK, GREENTOWN	570-676-3428
-------------------------------------	--------------

STOKES STATE FOREST, BRANCHVILLE, NJ	973-948-3820
--------------------------------------	--------------

MOVIE THEATERS:

AMC CRYSTAL RUN 16, MIDDLETOWN, NY - SEE WEBSITE AMCTHEATRES.COM

AMC ROCKAWAY 16, ROCKAWAY, NJ	" "	"
CINEMARK STROUD MALL, STROUDSBURG	570-421-1284	

CIRCLE DRIVE-IN, DICKSON CITY	570-489-5731	
-------------------------------	--------------	--

FLAGSHIP PREMIUM CINEMAS, MATAMORAS	570-491-2903	
-------------------------------------	--------------	--

HONESDALE CINEMAS (CINEMA 6)	570-647-0660	
------------------------------	--------------	--

PHOENIX THEATRES-IRON HORSE MOVIE BISTRO, SCRANTON	570-344-7328	
--	--------------	--

REGAL DICKSON CITY STADIUM 14 & IMAX	844-462-7342	
--------------------------------------	--------------	--



RECREATION/FAMILY FUN/ZOOS:

CAMELBEACH (WATER PARK) TANNERSVILLE	570-629-1662
CAROUSEL WATER & FUN PARK, BEACH LAKE	570-729-7532
CLAWS 'n' PAWS (ZOO) LAKE ARIEL	570-698-6154
COSTA'S FAMILY FUN PARK, HAWLEY	570-226-8585
DORNEY PARK, ALLENTOWN	610-395-3724
HAVE A HOOT FAMILY FUN CENTER, MILFORD	570-491-4668
HERSHEY PARK	800-HERSHEY
KITTANY CANOES, VARIOUS LOCATIONS	800-356-2852
KNOEBELS, ELYSBURG	800-487-4386
SESAME PLACE, LANGHORNE	215-702-ELMO
SHAWNEE MOUNTAIN (SKIING, FESTIVALS, ETC.)	570-421-7231
SPACE FARMS ZOO & MUSEUM, SUSSEX, NJ	973-875-5800

**FOOD**

**HUNGRY?**

**WHAT DO WE WANT  
TO EAT????**

**BACKROADS CAFÉ & DAIRY BAR, NEWFOUNDLAND – 570-216-1222**

**THE BOATHOUSE, HAWLEY – 570-226-5027**

**CAKES AND SCONES BAKERY, GREENTOWN – 570-676-4155**

**DER JAEGER, LAKEVILLE – 570-226-8252**

**DOC'S AT THE ROCKS, LAKE ARIEL – 570-689-3627**

**THE DOCK, HAWLEY – 570-226-4388**

**GREENTOWN GRILL, GREENTOWN – 570-252-4499**

**GRESHAM'S CHOP HOUSE, HAWLEY – 570-226-1500**

**THE HOTEL RESTAURANT, NEWFOUNDLAND – 570-676-8646**

**IHOP, LAKE ARIEL – 570-689-9112**

**JOHN'S GENERAL STORE, HAWLEY 570-226-9374**

**JOHN'S ITALIAN, GREENTOWN – 570-676-9830**

**LAKESIDE PIZZERIA, GREENTOWN – 570-857-7577**

**MOUNTAIN HOUSE TAVERN, GREENTOWN – 570-252-4275**

**OLD RANGERS INN, GREENTOWN – 570-676-3905**

**OVERBOARD'S, GREENTOWN – 570-857-1776**





**RINGSIDE FIRE GRILL, TAFTON – 570-390-0390**

**SPANKY'S COUNTRY, NEWFOUNDLAND – 570-676-0399**

**SUBWAY, GREENTOWN – 570-676-9761**

**VINNY'S II, GREENTOWN – 570-290-3961**

**WALLENPAUPACK BREWING COMPANY, HAWLEY – 570-390-7933**

AS WE CAN NOT POSSIBLY LIST ALL THE RESTAURANTS IN THIS PACKET,

WE GAVE YOU A SAMPLING OF A FEW LOCAL ESTABLISHMENTS.

PLEASE ASK AROUND FOR SOME PERSONAL RECOMMENDATIONS.

# bon appétit

**MY FAVES:**

---

---

---

---

---

---