



ARCHITECTS & PLANNERS

300 General Palmer Drive  
P.O. Box 5  
Palmer Lake, CO 80133  
(719) 484-0480  
Brian K. Bucher, AIA  
Architect  
CO license no. C-4889  
CA license no. C-23305

A PROPOSED RESIDENCE FOR

LEVEL ONE HOMES

LOT 28 TRAPEZOIDAL CT. MONUMENT, CO

Sheet Title:  
**MAIN FLOOR PLAN**

Drawing Status:  
**SD SET PRELIMINARY**

NOT FOR CONSTRUCTION

Revisions:

No.	Description	By	Date

Date: 5/4/18

Drawn by:

Checked by:

Scale: AS NOTED

Job No.:

Sheet No.:

A11  
Of

NOTE:  
MAIN WINDOW + EXT. DR. HD. HTS. SHALL BE 4'-0" UNCL.  
SLIDING GLASS DRIS. SHALL BE NARROW STYLE / REAL STYLE TYP.  
WINDOWS SHALL BE VINYL WINDOWS W/ DUAL GLAZED LOW E2 INSULATED GLAZING TYP UNCL. VERIFY W/ OWNER.  
ALL WINDOWS AND DOORS TO BE CENTERED IN ROOM UNCL.  
ALL EXTERIOR STRUCTURAL AND PLUMBING WALLS TO BE 2x6 STUDS UNCL.  
ALL INTERIOR WALLS TO BE 2x4 UNCL.  
ALL WALLS WITH POCKET DOORS TO BE 2x6 STUDS UNCL.  
INSTALL MOISTURE RESISTANT DWR BD. AT ALL WALLS IN ROOMS WITH HIGH MOISTURE CONDITIONS.  
VERIFY ALL CABINET HEIGHTS & FINISHES W/ OWNER TYP.  
PROVIDE BLOWN-IN INSULATION AT ALL PLUMBING WALLS BETWEEN FLOOR JOISTS AND AT ALL WALLS AROUND BATHROOM, TYPICAL.  
PROVIDE PPE INS. @ ALL LHC PENETS TYP.  
ALL LAMINATE ENGINEERED & SOLID HARDWOOD TO BE INSTALLED IN STRICT ACCORDANCE WITH MFG. SPECIFICATIONS 2009 IPC & THE NATIONAL WOOD FLOORING ASSOCIATION TYPICAL.  
PROVIDE ESCAPE OPENING PER RECT. ROD  
Minimum net clear opening area: 57 sq. ft.  
Minimum net clear opening area for glass floor coverage: 5 sq. ft.  
Minimum net clear opening height: 2'-0"  
Minimum net clear opening width: 2'-0"  
Maximum sill height: 4"  
Minimum sill height above the opening is located more than 7'-0" abv. ft. grade: 2"

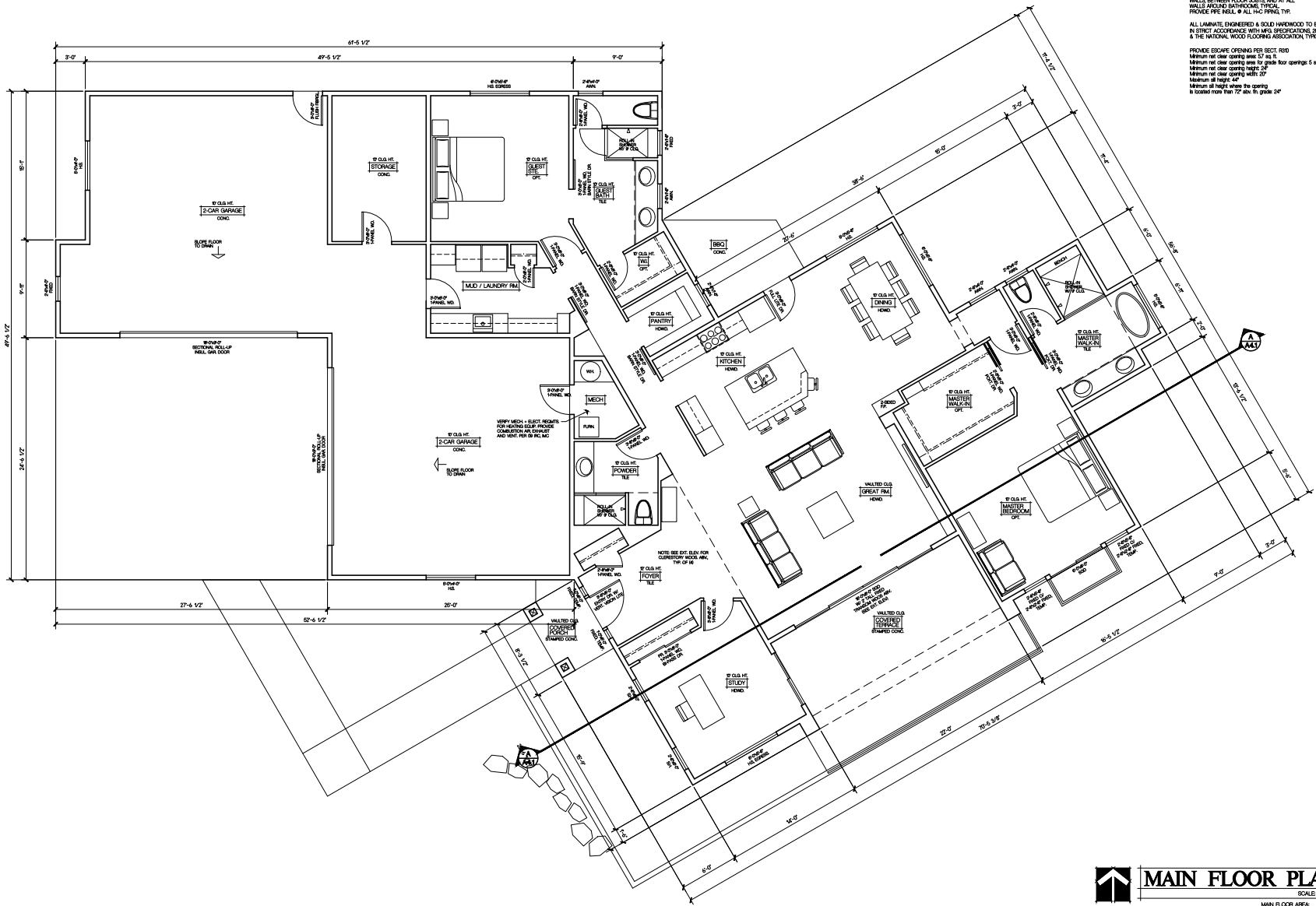

**MAIN FLOOR PLAN**  
SCALE 1/4"=1'-0"  
MAIN FLOOR AREA: 2578 SF  
GARAGE/STORAGE FLOOR AREA: 1485 SF

