

Summer 2026 Exhibition Allied Artists of Johnstown at Community Arts Center of Cambria County

1217 Menoher Blvd, Johnstown, PA 15905 (Westmont)

Receiving: Saturday July 25, 10am-Noon

Pickup rejected Art approximately 1:30-3pm (You will be notified)

Reception Friday July 31, 6:00-8:00pm

Show end / Pickup Saturday August 29, 10:00am-Noon

Juror: Bud Gibbons

Painter Charles W. (Bud) Gibbons' preferred method of painting is "en plein air," and he has painted in Pennsylvania, around the US and the world. Bud has exhibited both regionally and nationally and his work is in numerous public and private collections. He served as Professor of Art at Pennsylvania State University, New Kensington Campus for over thirty years, and was named a professor emeritus of visual arts at Penn State New Kensington in 2014.

For more information about Bud's artwork, exhibits and experience visit

<https://bud-gibbons.squarespace.com/about>

Awards

Best in Show \$200, one \$100 prize for watercolor, and five additional \$100 prizes

Instructions for entries:

1) Pre-registration: To ensure accurate exhibit labels, please pre-register each piece by emailing or texting the following information to Patrise Henkel at patrisehenkel@gmail.com or 202-903-1885 by Wednesday, July 22. Late submissions may not be accepted.

For each piece, provide:

- Title
- Medium and surface/support
- Size
- Price (or NFS)

This is the information that will appear on the label displayed with your work. It should match exactly what is written on the artwork entry form attached to the back of your art.

2) Enter up to two pieces:

- As CACC is a smaller gallery, please enter up to 2 pieces, preferably no larger than 36" in its longest dimension.

3) Fees & Membership:

- There is a \$15 entry fee for current members.
- Non-members will be charged \$25 for annual membership. In the unlikely event that no works are accepted by the juror, the membership fee is refunded to you. The entry fee is not.
- Entry fee payable in cash or check due at drop off.
- Please bring an exact amount as we will not be able to change large bills.

4) Pricing & Commission:

- Sale of artwork during the exhibit is subject to 30% commission for Community Arts Center and 20% commission to Allied Artists of Johnstown for a total of %50.. **Be sure to price works accordingly.**
- Only one NFS piece per exhibit. If you are only entering one piece of art, it must have a price.

5) Insurance

- AAJ and the CACC do not assume any responsibility for damage or loss.
- The artist shall understand that submissions of art constitute an agreement with the conditions set forth herein and considers this application a commitment to exhibit.
- The artist also agrees that any accepted art will hang for the entirety of the exhibit.

6) Original Art Only

- All submissions must be original art by the artist. No giclees or commercial prints from original artwork allowed.
- **OUR POLICY ON AI-CREATED WORK:**
 - This exhibition invites thoughtful engagement with emerging technologies, including artificial intelligence, as part of the broader conversation about art, engineering, creativity, and society. Artists may incorporate AI tools into their creative process; however, submissions must reflect substantial human agency, decision-making, and intentionality.
 - Works that rely primarily on generative AI without meaningful human intervention, such as prompt-only image generation, will not be accepted. Contributors using AI are expected to clearly disclose how AI tools were used and demonstrate human authorship through concept development, iteration, modification, or integration with other media. If you have questions about whether your work qualifies, contact the exhibit chair at 202-903-1885.

7) Professional Presentation & Labeling

- Professional presentation is important. Jurors may exclude artwork or not grant an award if poorly presented. Pieces should be framed, gallery wrap or otherwise neatly finished.
- Arrive with artwork prepared for hanging. For 2d works: wired securely, no sawtooth hangers.
- Absolutely no artwork will be acceptable if still wet!
- Attach your info forms to the back

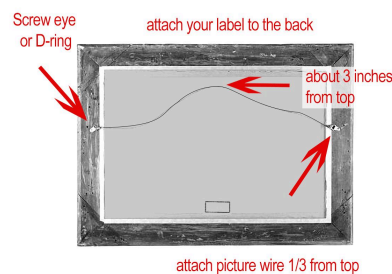

1. Email this information to patrisehenkel@gmail.com by July 23 to pre-register. This insures that your labels are correct!
2. ATTACH INDIVIDUAL FORMS TO BACK OF EACH ARTWORK.

Name _____

Address _____

Email _____ Phone _____ (cell)

Art Title _____

Medium _____ Size _____ (w x h)

Price (or NFS) _____ OK to show online exhibit: Y ___ N ___

Name _____

Address _____

Email _____ Phone _____ (cell)

Art Title _____

Medium _____ Size _____ (w x h)

Price (or NFS) _____ OK to show online exhibit: Y ___ N ___
