

# B.G.W. TRI-ROD

## Operation and Maintenance Instructions

1. Refer to the separate Engine Owner's Manual for complete engine operation and maintenance instructions.
2. **IMPORTANT** — Before starting engine, always make certain hand throttle is turned to the full "OFF" position.
3. Place both feet on the footrests before putting vehicle in motion and maintain until vehicle is brought to a **complete** stop.
4. Familiarize yourself with steering, braking and throttle response by selecting reasonably open terrain to start with and moderate speed.
5. **Lubrication** — All bearings in the drive mechanism and front fork are pre-lubricated and should need no further lubrication. Lubricate front wheel every fifteen hours with bearing lubricant, using grease gun on zerk fitting on hub of wheel. Hub should be filled completely with grease until it begins to squeeze through bearings. Lubricate drive chain every five hours with chain lubricant.
6. **Tire inflation** — Rear — 4 to 6 p.s.i.  
Front — 7 to 8 p.s.i.
7. **Chain adjustments** — Chain adjustment on a new Tri-Rod is set at the factory. To readjust, loosen the four 5/16" engine mounting bolts and the two 5/16" jack shaft and engine bracket bolts and slide entire assembly (Ref. No. 2) forward to tighten chain. Do not over-tighten. Chain should deflect approximately 3/8" when depressed sideways by hand. Retighten all six bolts securely.
8. **Brake adjustment** — To tighten brake, loosen the knurled lock nut on brake hand lever and turn the split adjusting barrel counterclockwise. Retighten lock nut.
9. **Front wheel bearings** — Do not overtighten axle bolts on front wheel, as this can damage wheel bearings. Bolts should only be tight enough to prevent endplay, but allow wheel to rotate freely.
10. **Torque convertor belt** — The center distance between engine shaft and jack shaft is fixed, since a certain amount of slack in belt is necessary for proper operation of torque convertor through speed range. The belt is a special "raw edge" design to give long life in torque convertor applications. When replacement becomes necessary, replace only with a belt of identical size and design.
11. **Rear axle and jack shaft bearings** — These bearings are provided with a special locking collar, which locks bearing securely to shaft. Should removal of shaft or bearing ever be necessary, collar may be loosened by first loosening set screw, then using drift pin or center punch in recessed hole in collar, force collar in same direction as normal shaft rotation until it loosens. To replace, the reverse procedure is necessary.
12. **Ski attachment** — Remove axle bolts and withdraw axle. Remove wheel and both spacers, replacing with ski assembly. Replace axle and retighten bolts to remove end play, but still allow ski to pivot freely.
13. **Periodic maintenance** — After a few hours of operation, and periodically thereafter, check all nuts, bolts and set screws for proper tightness to insure safety and performance.

# OWNER'S MANUAL

**MODEL  
TR-350  
TR-380**



## TRI-ROD

**BGW**  
INDUSTRIES, INC.

**MANSFIELD, OHIO**

**P.O. BOX 3683**

# TRI-ROD

## WARRANTY AND POLICY PROCEDURE

### Warranty

B.G.W. Industries, Inc., warrants each of its Tri-Rod vehicles to be free from defects and workmanship for 90 days from date of purchase. This warranty shall not cover parts which become defective during said 90-day period by reason of abnormal use. This warranty shall not apply to engines, since they are subject to the warranty of the engine manufacturer as specified in the separate Engine Owner's Manual, nor shall it apply to B.G.W. Tri-Rods used for competition racing. The differential is warranted separately by the differential manufacturer, to be identified by authorized B.G.W. service personnel. The fiberglass body is warranted through the 90-day period for normal use, with B.G.W. Industries reserving the right to determine, through its authorized service personnel, if defect is the result of misuse; in which case warranty will not apply.

The torque convertor drive belt is excluded from any warranty coverage by B.G.W. Industries. Warranty is solely for the benefit of the original retail buyer, and is not transferable.

### Defective Parts

All parts, which are defective in materials or workmanship as delivered to purchaser will be repaired or replaced, as B.G.W. elects, without charge for parts if a defect appears within 90 days from date of delivery of the product to the original purchaser.

### Accidents and Normal Maintenance

This warranty covers only defective material and workmanship. It does not cover depreciation or damage caused by normal wear, accident, improper maintenance, improper protection in storage or improper use. The cost of normal service shall be paid by the purchaser.

### How to Claim Warranty

All claims under the B.G.W. Warranty must be made through the authorized B.G.W. Purchasing Dealer within the warranty period provided. To obtain warranty service, the buyer must return the vehicle to the dealer and not to the factory. B.G.W. is not responsible for transportation costs.

### Labor to Replace Defective Parts

The labor performed by any B.G.W. dealer or other persons required to repair or replace defective parts is not the responsibility of B.G.W.

### Design Changes

B.G.W. Industries, Inc., reserves the right to incorporate design changes in any Tri-Rod model at any time without notice.

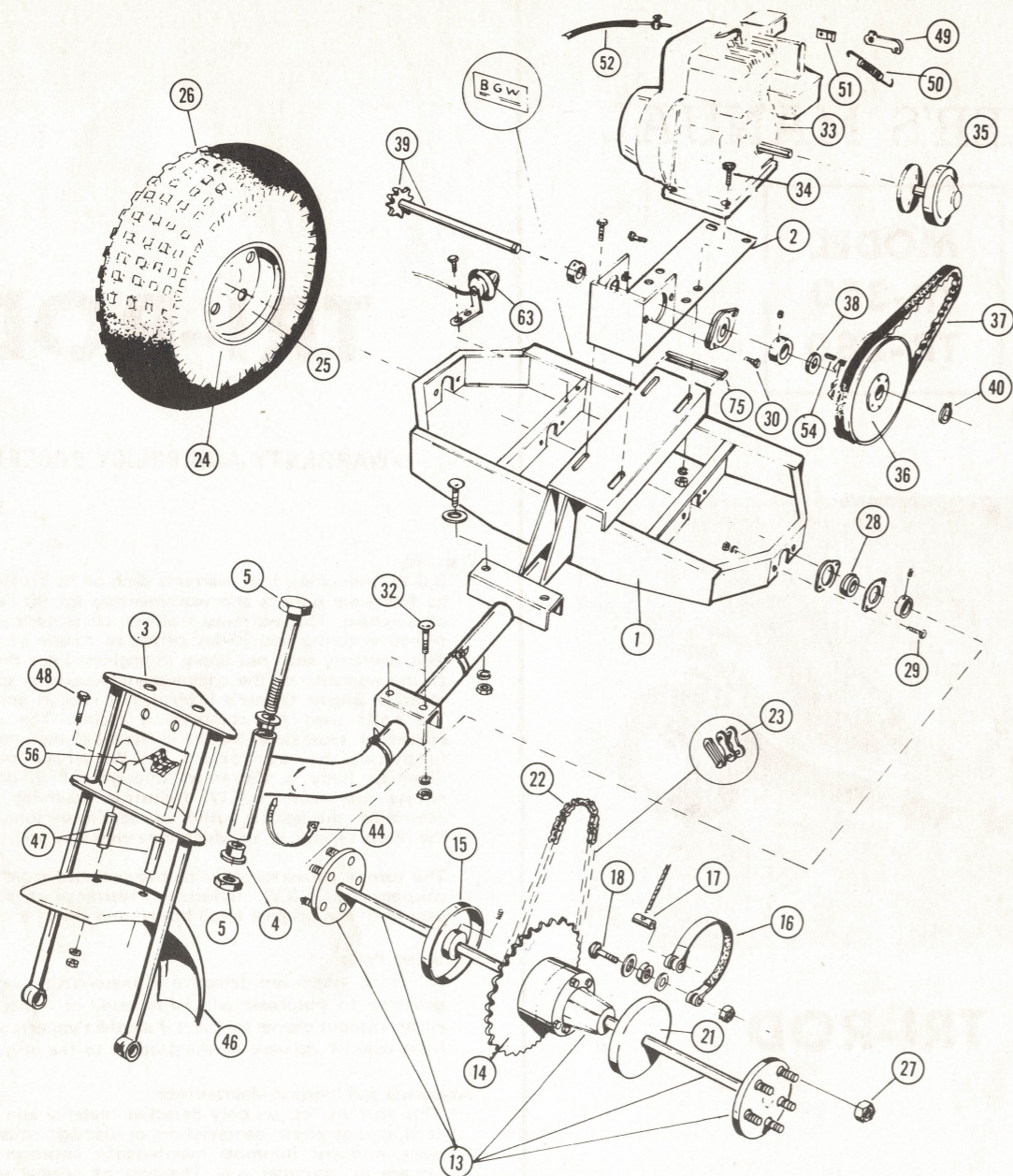

Ref. No.	Description	Part No.	No. Req'd.	Ref. No.	Description	Part No.	No. Req'd.
1	Frame Assembly	D-3002	1	20	Brake Lever Assembly	A-2037	2
2	Jack Shaft and Engine Bracket	D-3003	1	21	Brake Key	A-3030	2
3	Fork Assembly	D-3004	1	22	Chain Assembly Complete, TR-350	A-3026	1
4	Fork Bushing	A-3005	2		Chain Assembly Complete, TR-380	A-3026-1	1
5	Fork Bolt Assembly	A-3006	1	23	Chain Connector Link	A-2043-2	1
6	Front Wheel & Tire Ass'y. Complete	A-3008	1	24	Rear Wheel & Tire Ass'y.	A-3012	2
7	4.80/4.00 - 8 Tire	A-3008-1	1	25	Rear Wheel, Rim Only	A-3012-1	2
8	Wheel and Bearings (Less Tire)	A-3008-2	1	26	21 x 11.00-8 Tire Only	A-3012-2	2
9	Wheel Bearing	A-3008-3	2	27	Rear Wheel Nut	A-3013-1	10
10	Front Wheel Axle	A-3009	1	28	Axle & Jack Shaft Bearing Ass'y.	A-3014	6
11	Wheel Bolt Assembly	A-3009-1	2	29	Axle Bearing Bolt Ass'y.	A-3015	8
12	Wheel Spacer	A-3010	2	30	Jack Shaft Bearing Bolt Ass'y.	A-3016	4
13	Rear Axles, Hubs & Diff. Ass'y.	A-3011	1	31	Body	A-3017	1
14	Sprocket - TR-350	A-3011-1	1	32	Body Bolt Ass'y.	A-3018	4
	Sprocket - TR-380	A-3011-2	1	33	Engine-5 h.p. Standard	A-3019	1
15	Brake Drum	A-3027-1	2		Engine-5 h.p. w/Alternator	A-3019-1	1
16	Brake Band	A-3027-2	2		Engine-8 h.p. Standard	A-3045	1
17	Brake Cable Retainer	A-3027-3	2		Engine-8 h.p. w/Alternator	A-3045-1	1
18	Brake Bolt Assembly	A-3028	2	34	Engine Bolt Ass'y.	A-3020	4
19	Brake Cable Assembly	A-3029	2	35	Torque Converter Driver-TR-350	A-3021-1	1
					Torque Converter Driver-TR-380	A-3021-2	1

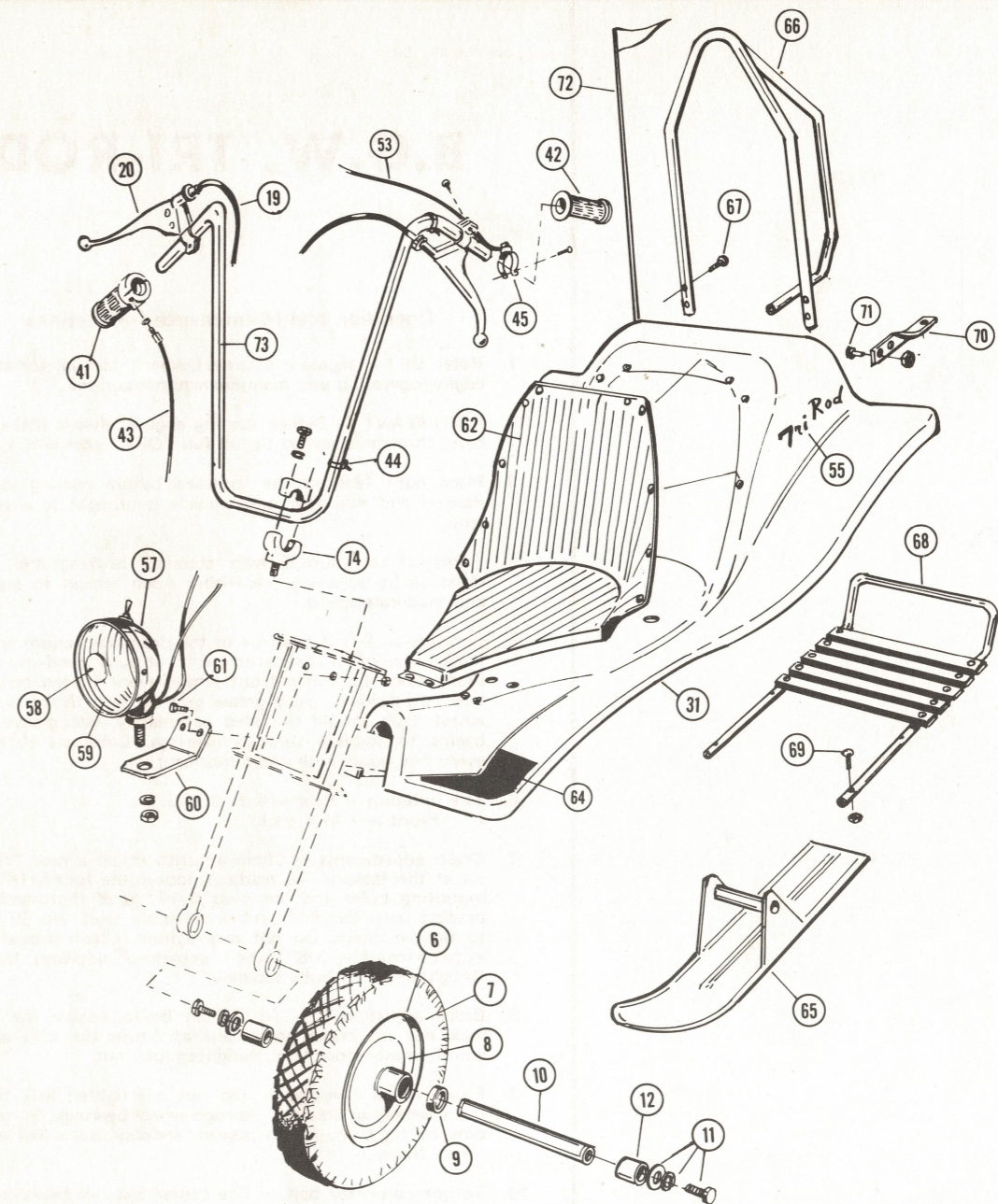

Ref. No.	Description	Part No.	No. Req'd.	Ref. No.	Description	Part No.	No. Req'd.
36	Torque Converter Driven	A-3022	1	55	Body Decal	A-3034	2
37	Torque Converter Belt	A-3023	1	56	Fork Decal	A-3035	1
38	Torque Converter Key	A-1051	1	57	Head Lamp Ass'y.	A-2027	1
39	Jack Shaft & Sprocket Ass'y. TR-350	A-3024-1	1	58	Head Lamp Bulb	A-2027-1	1
	Jack Shaft & Sprocket Ass'y. TR-380	A-3024-2	1	59	Head Lamp Lens	A-2027-2	1
40	Jack Shaft Retainer Ring	A-1010	1	60	Head Lamp Bracket-Chrome	A-2015	1
41	Twist Grip Ass'y., Less Cable	A-1025-1	1	61	Head Lamp Bolt Ass'y.	A-1050	2
42	Dummy Grip Only	A-1025-2	1	62	Seat Cushion-Double	A-3036	1
43	Throttle Cable	A-3031	1	63	Tail Light Ass'y.	A-3037	1
44	Cable Strap	A-1054	6	64	Foot Pad-Pair	A-3038	2
45	Kill Button Ass'y.	A-2029	1	65	Ski	B-3039	1
46	Fender - Chrome	A-2025-1	1	66	Roll Bar	B-3040	1
47	Fender Spacer	A-2036	2	67	Roll Bar Bolt Ass'y.	A-3041	6
48	Fender Bolt Ass'y.	A-3032	2	68	Cargo Carrier Ass'y.	B-3042	1
49	Throttle Cable Anchor	A-3031-1	1	69	Cargo Carrier Bolt Ass'y.	A-3041	4
50	Throttle Cable Spring	A-3031-2	1	70	Hitch Plate	A-3043	1
51	Throttle Cable Connector	A-3031-3	1	71	Hitch Plate Bolt Ass'y.	A-3016	2
52	Throttle Cable Retainer	A-1052	1	72	Dune Flag	A-3044	1
53	Insulated No. 16 Wire-8' length	A-3033	3	73	Handlebar-Chrome	A-3047	1
54	Torque Converter Spacer-TR-350	A-3022-1	1	74	Handlebar Mount Ass'y.	A-3048	2
	Torque Converter Spacer-TR-380	A-3022-2	1	75	Plastic Shroud	A-2064	1