

**IMPORTANT**— DO NOT THROW AWAY OR DISCARD THIS PAGE  
MAY BE USED TO ORDER PARTS IN THE FUTURE.

*Penneys Product Service*  
*491-8750-51-52*  
*parts - 491-0875*  
*line*



THIS VEHICLE IS BUILT WITH PRECISION. TREAT IT WITH CARE AND IT WILL SERVE YOU WELL.



## SCAT TRACKER

ASSEMBLY • OPERATING INSTRUCTIONS • PARTS LIST

MODEL 5200



## REPAIR PARTS LIST

Key	Part No.	Description
1	900-1021	Throttle Grip
2	901-151	Throttle Control
3	900-1034	Brake Lever—2 Req.
4	900-1076	Brake Lever Bracket—2 Req.
5	902-1010	Fork Shaft
6	900-1022	Hand Grip
7	900-1162	Brake Cable—2 Req.
8	902-1015	5/16-18 x 3/4" Hex Hd. Bolt—2 Req.
9	904-1023	Throttle Cable
10	901-208	Handle Bar
11	902-2009	Flange Lock Nut—2 Req.
12	902-3500	Washer, Rubber—2 Req.
13	901-299	Fork (Upper)
14	902-2007	5/16-18 Hex Lock Nut—2 Req.
15	901-1068	Cup—2 Req.
16	901-9011	Suspension Spring—2 Req.
17	901-259	Fork (lower)
18	*120854	1/4-20 x 5/8" Hex Hd. Bolt—2 Req.
19	901-1108	Stabilizer Bracket
20	901-265	Front Fender
21	902-2001	1/4-20 Hex Lock Nut—9 Req.
22	900-1002	Bearing—4 Req.
23	901-121	Front Wheel, inc. Key 21, 26—5 Req.;
		Key 22—2 Req.
24	900-1029	Tube—Front Tire
25	900-1078	Tire—Front
26	*120706	1/4-20 x 1/2" Hex Hd. Bolt—5 Req.
27	902-1021	Front Axle
28	902-2003	5/8-18 Hex Lock Nut—2 Req.
29	*121913	1/4-20 x 1-1/4" Hex Hd. Bolt—2 Req.
30	900-1024	Foot Rest Cover—2 Req.
31	904-105	Foot Rest Bracket
32	902-1017	5/16-18 x 3/4" Hex Serrated Flange
		Screw—16 Req.
33	902-2008	5/16-18 Hex Serrated Flange Nut—24 Req.
34	902-1024	1/4-20 x 5/8" Carriage Bolt—6 Req.
35	902-2016	1/4-20 Hex Serrated Flange Nut—6 Req.
36	904-103	Frame Assy.
37	904-107	Body, inc. Key 38
38	904-1040	Seat
39	902-1014	5/16-18 x 1-1/2" Hex Hd. Bolt—4 Req.
40	904-1008	Differential
41	904-1018	Flange—8 Req.
42	904-1017	Bearing—4 Req.
43	904-1016	Collar—4 Req.
44	*902-2004	3/8-16 Hex Nut—4 Req.
45	904-1046	Cable Guide
46	904-1047	Cable Lock
47	*902-1026	3/8-16 Hex Hd. Bolt—2 Req.
48	904-1048	Brake Band—2 Req.
49	904-1038	Key 1/4 x 2"—4 Req.
50	904-1049	Brake Hub—2 Req.
51	904-108	Chain
52	904-1039	Master Link-Chai.,
53	901-1116	Bearing Plate—2 Req.
54	900-1111	Bearing—2 Req.
55	900-1121	Collar—4 Req.
56	904-1035	Sprocket
57	900-1040	Key 3/16" x 3/4"
58	904-1001	Jackshaft
59	904-1043	Driven Shiv
60	900-1172	Key 3/16" x 2"—2 Req.
61	904-1013	Wheel—2 Req.
62	902-2015	3/4-16 Hex Lock Nut—2 Req.
63	904-1030	Tire (Rear)—2 Req.
64	904-1022	Engine
65	904-1019	Spark Arrestor

66	900-1158	Driver Shiv
67	904-1042	Belt
68	*446363	3/8 Flat Washer
69	902-1022	3/8-24 x 1-1/4" Hex Hd. Screw
70	904-7006	Instruction Manual (Not Ill.)
71	900-1036	Cable Stop, Throttle

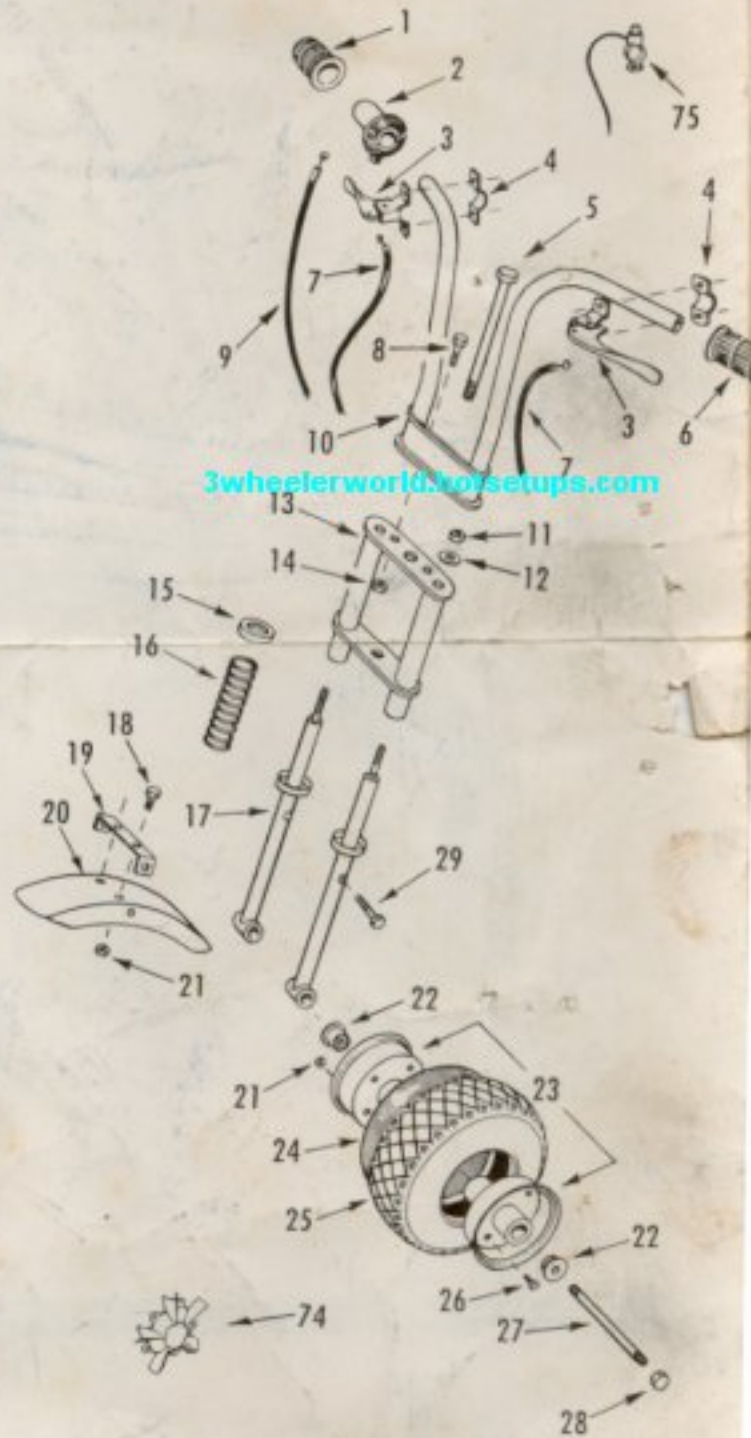

\*Items are standard hardware and can be secured loc

When ordering repair parts give following informati

- (1) Part Name or Description - Color
- (2) Part Number
- (3) Model Number and Serial Number

# Scat Tracker

## PARTS ILLUSTRATION

72	900-1037	Cable Housing Stop, Throttle
73	900-1013	Cable Clip—6 Req.
74	901-112	Mag Insert—2 Req.
75	904-1051	Switch
76	902-4008	No. 6 x 3/4" Truss Screw
77	902-3023	Washer
78	902-2021	Jam Nut

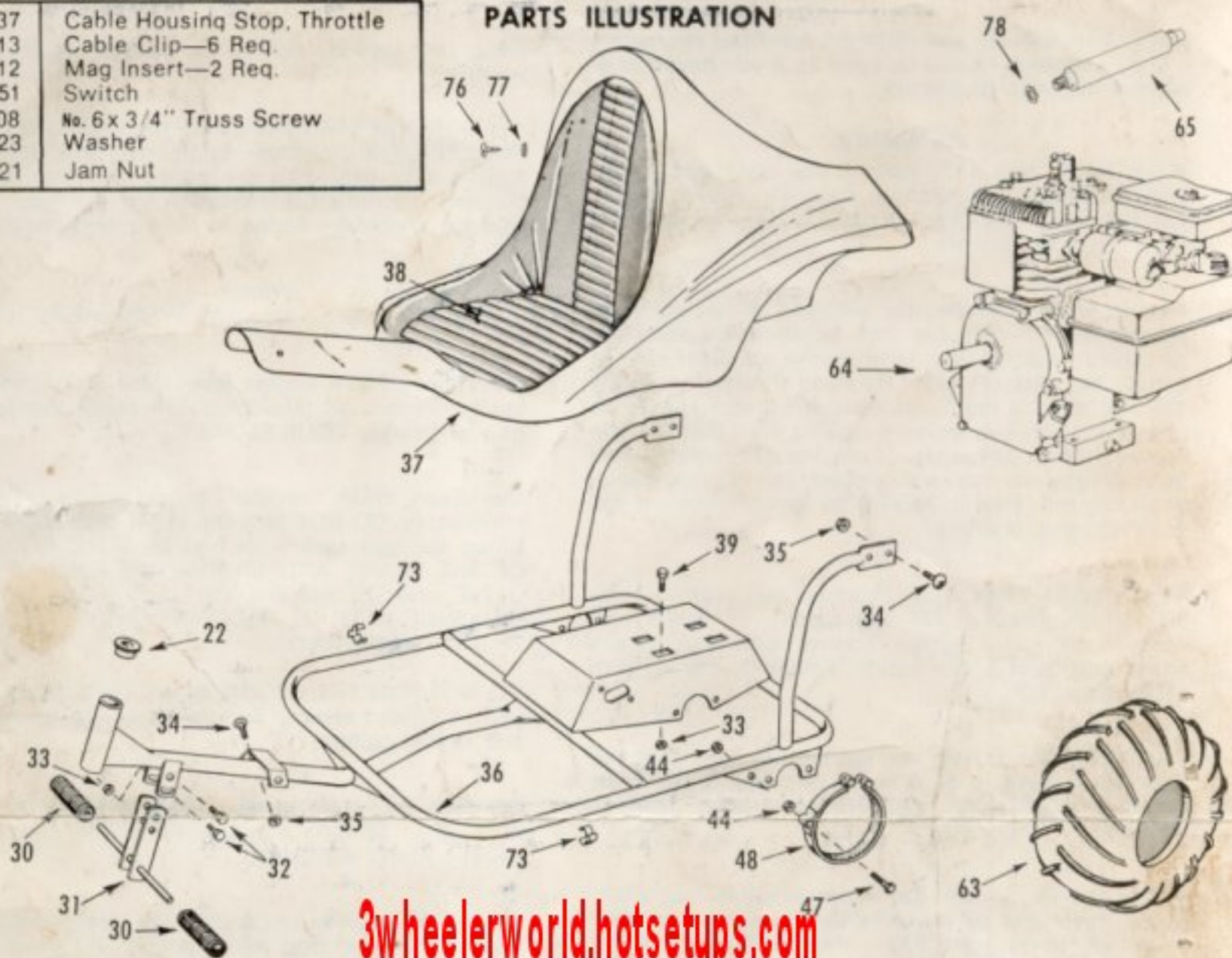

[3wheelerworld.hotsetups.com](http://3wheelerworld.hotsetups.com)

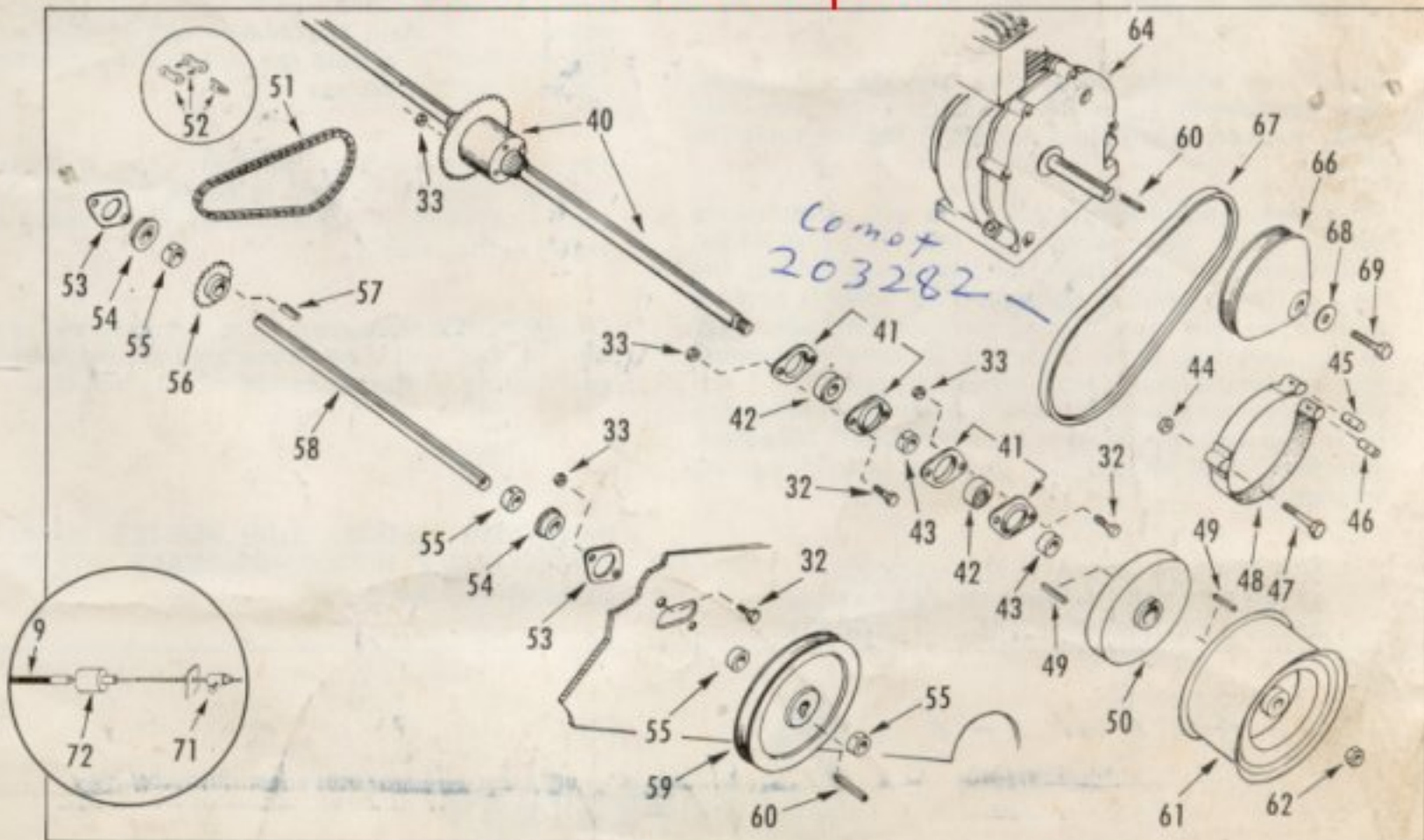

locally.  
nation:

# SCAT TRACKER

## ASSEMBLY • OPERATING INSTRUCTIONS

**NOTE:** This Vehicle has different handling characteristics — Caution should be used until you have familiarized yourself with the unit.

### ASSEMBLY

Place lower fork (17) onto frame (36) and attach with fork shaft (5). Tighten securely. Attach handle bar (10) onto fork (17) with two bolts (8) and nuts (14). Tighten securely.

Loosen screws on throttle control (2) and slide assembly over handle bar into position. Be sure key on throttle control bore is in groove on under side of handle bar. Attach grip (1). Hand throttle assembly (2) and throttle mechanism on carburetor should be checked for free movement making sure that throttle mechanism on carburetor is closing completely when hand control is released. Adjust only if necessary. Hand control should NEVER be forced forward beyond idle stop position.

Attach brake levers (3). Remove two screws from brake lever bracket (4) and mount on handle bar. Position to suit. Tighten screws securely. Attach brake cables to brake bands. Fasten to frame with cable clips. (73).

[3wheelerworld.hotsetups.com](http://3wheelerworld.hotsetups.com)

**CAUTION:** When attaching cables, be sure that the right hand brake lever cable is attached to brake on RIGHT side of frame; and left brake lever cable is attached to LEFT brake.

**Adjust brakes:** Loosen set screw in cable lock (46). Grasp open end of brake band and compress until band is tight on brake drum; then tighten set screw (set screw requires 1/8" Allen wrench).

**Install rear wheels.** Select 1/4" key (49) and insert key into keyway on axle shaft. Slide wheel onto axle shaft and secure with lock nut (62). Tighten securely.

**Drive chain adjustment:** All chain will stretch to a certain point. We recommend the following initial adjustments to the chain the first few hours of operation. The method of tightening the chain is simple; loosen the four nuts holding the jackshaft assembly to the mounting base. Slide the jackshaft assembly forward until chain is tight enough to permit 1/2" vertical movement. Hold jackshaft, squared to mounting base, and tighten the four nuts previously loosened. We feel this should be done at the following intervals:

AFTER FIRST HOUR OF OPERATION  
AFTER NEXT SIX HOURS OF OPERATION  
AFTER NEXT EIGHT HOURS OF OPERATION

After this period, tighten as needed, by the same method.

**READ ENGINE MANUAL CAREFULLY BEFORE STARTING UNIT.** Fill crankcase to the overflow point with high quality detergent oil having the American Petroleum Institute Classification for Service "M.S." Nothing should be added to the recommended oil.

Summer —  
Use SAE 30

Winter —  
Use SAE 5W-20 or SAE 10W

**Directions:** Place engine level. Use screw driver or bar to remove oil filler plug. Fill crankcase to point of over-flowing. POUR SLOWLY.

Use clean, fresh "regular" grade gasoline. Fill tank completely. DO NOT MIX OIL WITH GASOLINE. After filling the gas tank with fuel be SURE ALL PARTS OF THE FRAME AND ENGINE ARE FREE OF GASOLINE prior to starting the engine. DO NOT FILL GASOLINE TANK TO THE POINT OF OVERFLOWING. THIS IS IMPORTANT!

DO NOT RUN THE ENGINE IN AN ENCLOSED AREA. Exhaust gases contain carbon monoxide, an odorless and deadly poison.

DO NOT FILL GASOLINE TANK WHILE ENGINE IS RUNNING. Spilling gasoline on a hot engine may cause a fire or explosion.

[3wheelerworld.hotsetups.com](http://3wheelerworld.hotsetups.com)

**IMPORTANT:** Drive chain must be lubricated periodically to insure free movement of all chain links. Lubricate with "Chain Lube" or any good grade 30W motor oil. If chain becomes caked or clogged with dirt or sand, it should be cleaned in kerosene and relubed before next use.

Read engine warranty carefully. Any expressed or implied warranty is void in cases of abuse. This includes all parts and assemblies which make up the frame of the vehicle.

**CAUTION:** Extreme caution is required in the operation of this unit. The manufacturer assumes no responsibility in the operation of this vehicle.

**IMPORTANT NOTICE:** THIS VEHICLE IS NOT FOR USE ON PUBLIC ROADS, HIGHWAYS, CITY STREETS, SIDEWALKS OR PARKS.

21 X 11 - 8

**Penneys**  
ALWAYS FIRST QUALITY