

pacesetter enterprises, inc.

manufacturer of recreational vehicles

p.o. box 309 cascade, iowa 52033 telephone 319/852-3286

pacesetter

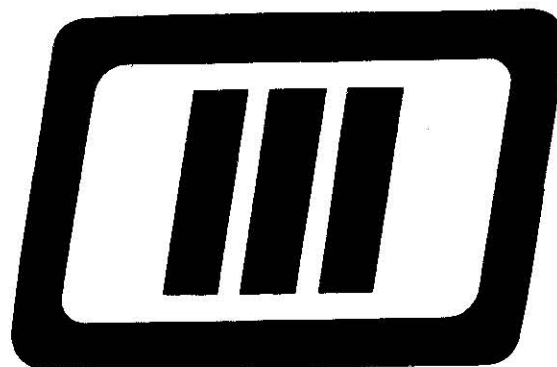

REPLACEMENT PARTS MANUAL
FOR
PACESETTER III

<u>Part#</u>	<u>Description</u>	<u>Price</u>
<u>SPROCKETS</u>		
0003	10 Tooth Jackshaft Sprocket	3.25
0004	Rear Drive Sprocket and Intergal Brake Drum	8.05
0005	Secondary Reduction Sprocket Cluster and Shaft	6.95
0006	Rear End Idler Sprocket with Bearings	4.05
<u>CHAINS</u>		
0102	#40 x 57 Pitch Chain	3.33
0103	#40 Connecting Link	.25
0104	#40 Offset Link	.35
0105	#40 Half Link	.25
<u>FASTENERS & HARDWARE</u>		
0201	Engine Mtg Bolts 3/8 x 24 x 1½ Capscrews Use 3/8 x 24 Locknut #0218	.25
0204	Front Fender Mtg Bolts ½ x 20 x 3/4 Capscrews Use Locknut #0214	.10
0204	Muffler Mtg Bolts ½ x 20 x 3/4 Capscrews Use Lock Washer #0219	.10
0205	Engine Head Bracket Mtg Bolts 5/16 x 24 x 3/4 Capscrew Use Locknut #0215	.10
0206	Fork Pivot Bolt 5/8 x 18 x 8" Capscrew Use Locknut #0229; Use Machine Bushing #0224	1.30
0207	Chain Tightner Mtg Bolt 5/16 x 24 x 1½ Capscrew Use Locknut #0215	.15
0207	Headlight Mtg Bolt 5/16 x 24 x 1½ Capscrew Use Locknut #0215	.15
0208	Trailing Link Pivot Bolts 3/8 x 24 x 1 Capscrew Use 3/8" Lockwasher #0220	.15
0214	¼ x 20 Locknut	.10
0215	5/16 x 24 Locknut Regular Height	.10
0218	3/8 x 24 Regular Height Locknut	.15
0219	¼" Lockwasher	.10
0220	3/8" Lockwasher	.10
0222	3/8" Flatwasher	.10
0224	5/8" Machine Bushing	.25
0225	Transmission Spacer 5/8" I.D. x 7/8" O.D. x 5/16" Wide	.81
0226	Set Collar 5/8" I.D. W/Set Screw	.87
0227	Jackshaft Sprocket Key 3/16" Square x 3/4" Long	.21
0228	Transmission Key 3/16" Square x 2" Long	.25
0229	Front Axle Locknut 5/8 x 18	.30
0229	5/8 x 18 Locknut	.30

<u>Part#</u>	<u>Description</u>	<u>Price</u>
<u>FASTENERS & HARDWARE (cont.)</u>		
0230	Shock Absorber Bolts 3/8 x 24 x 1-3/4 Capscrews Use Locknut #0218 Use Flatwasher #0222	.25
0231	Secondary Jackshaft Bearing Carrier Bolts 3/8 x 24 x 2 Capscrews Use Flatwasher #0222 Use Locknut #0218	.30
0232	Rear Axle Hub Drive Bolts 5/16 x 24 x 1½ Hardened Capscrews Use Locknut #0233	.40
0232	Rear Axle Drive Sprocket Bolts 5/16 x 24 x 1½ Hardened Capscrews Use Locknut #0233	.40
0233	5/16 x 24 Locknut Thin Height	.15
0234	Footpeg Mtg Bolts 5/16 x 24 x 1½ Capscrews Use Locknut #0215	.40
0235	Seat and Body Mtg Bolts ¼ x 20 x 1½ Capscrews Use Lockwasher #0219	.15
0236	Gas Tank Mtg Locknuts ¼ x 28	.10
0238	Wheel Nuts ½ x 13 Use Lockwasher #0239	.20
0239	½" Lockwasher	.15
0240	Taillight Mtg Locknut 10-32 Use Flatwasher #0241	.10
0241	3/16" Flatwasher	.10
0242	Transmission Spacer (on engine crankshaft) 1" I.D.	.25
0243	Trailing Link Bushing (Bronze) 5/8" I.D. x 13/16" O.D.	.80
0244	Secondary Jackshaft Spacer 7/8" Long x 3/4 I.D.	.71
0245	Secondary Jackshaft Spacer 9/16" Long x 3/4" I.D.	.68
0246	Torque Converter Cover Bolts Front 3/8 x 16 x 5/8 Machine Screws	.15
0247	Torque Converter Cover Bolt Rear ¼ x 20 x 3/4 Machine Screw Use #0248 Speedclip Nut	.10
0248	¼ x 20 Speedclip Nut	.20

BRAKES

0302	Brake Band Pin W/Set Screw	.50
0303	Brake Band 1" Wide	3.15
0304	Brake Band to Frame Mtg Pin 3/8" x 2-3/4"	.95

CONTROLS

0404	Replacement Throttle Cable	1.50
0405	Throttle Cable Stop	.55
0406	Brake Control	7.15
0407	Dummy Grip	.25

<u>Part#</u>	<u>Description</u>	<u>Price</u>
<u>CONTROLS (cont.)</u>		
0408	Throttle Control	7.31
0409	Replacement Brake Cable	1.50
 <u>ENGINE & RELATED PARTS</u>		
0503	7.5 HP Wisconsin Engine	151.58
0504	Butterfly Return Spring	.39
0505	Butterfly to Control Cable Bracket & Pin	.73
0506	Butterfly Spring to Engine Shroud Mtg Bracket	.38
0507	Exhaust Pipe and Flange	2.50
0508	Muffler, Spart Arresting	12.60
 <u>DECALS & TRIM</u>		
0707	Pacesetter III Body Decals (1 each side)	.88
0708	Pacesetter III Gas Tank Decals (1 each side)	.68
0708	Pacesetter III Fork Decal	.68
0709	Pacesetter III "III" Decal	.72
 <u>FRAME & RELATED BRACKETS</u>		
0813	Fork	17.50
0814	Front Fender	6.50
0815	Front Wheel Hub W/O Bearings	6.42
0816	Frame (engine cradle)	37.00
0817	Engine Head Mtg Bracket	2.95
0818	Trailing Link	23.75
0819	Secondary Jackshaft Bearing Carrier Plates	.95
0820	Rear Wheel Hub	4.85
0822	Foot Peg	7.35
0821	Body - Fiberglass	75.00
0822	Foot Peg Covers	.30
0823	Rear Chain Idler Sprocket Arm	2.57
	Use Nut #0238	
	Use Lockwasher #0239	

<u>Part#</u>	<u>Description</u>	<u>Price</u>
<u>WHEELS & TIRES</u>		
0903	Pacesetter III Knobby Tire & Wheel Assembly 21/12.00 x 8	54.60
<u>BEARINGS</u>		
1000	Front Axle Bearings 5/8" I.D.	1.40
1000	Front Fork Pivot Tube Bearings 5/8" I.D.	1.40
1000	Primary Jackshaft Bearings 5/8" I.D.	1.40
1001	Secondary Jackshaft Bearings 3/4" I.D.	2.10
1001	Rear Axle Bearings 3/4" I.D.	2.10
<u>SEAT</u>		
1102	Pacesetter III Seat	17.39
<u>GASTANK & FITTINGS</u>		
1200	Gas Tank	8.96
1201	Gas Tank Hose	.50
1202	Gas Tank Valve	.63
1203	Gas Tank Cap	.50
<u>ELECTRICAL COMPONENTS</u>		
1308	Headlight Assembly	14.77
1301	Headlamp Bulb	5.56
1309	Taillight Assembly	3.40
1310	Taillight Lens	2.15
1311	Taillight Bulb	.89
1305	Killswitch & Wire Lead	1.75
1306	Brake Light Switch	1.50
1312	Wiring Harness Pacesetter III	3.51

<u>Part#</u>	<u>Description</u>	<u>Price</u>
<u>SHOCK ABSORBERS</u>		
1400	Shock Absorber	6.50
 <u>AXLES & SHAFTS</u>		
1504	Front Axle	1.96
1505	Rear Axle	8.17
1506	Trailing Link Shaft	2.85
1507	Primary Jackshaft	6.30
 <u>OPTIONS & ACCESSORIES</u>		
1608	Mirror	2.25
1609	Electric Horn W/Lead Wire & Switch	4.75
1610	Speedometer Kit	24.95
1611	Foot Platform	14.95
1612	Rear Cargo Carrier	17.50
1613	Front Carrier	12.95
1614	PTO Kit	19.95

Belt # 0628
 Asymmetric 9.0"
 Comet Belt # 200397

COMET C.A.T.-99 N TORQUE CONVERTER

**ASSEMBLY
SEQUENCE
&
PARTS LIST**

One Inch Bore DRIVER UNIT
Model No. **CATN 991-100**

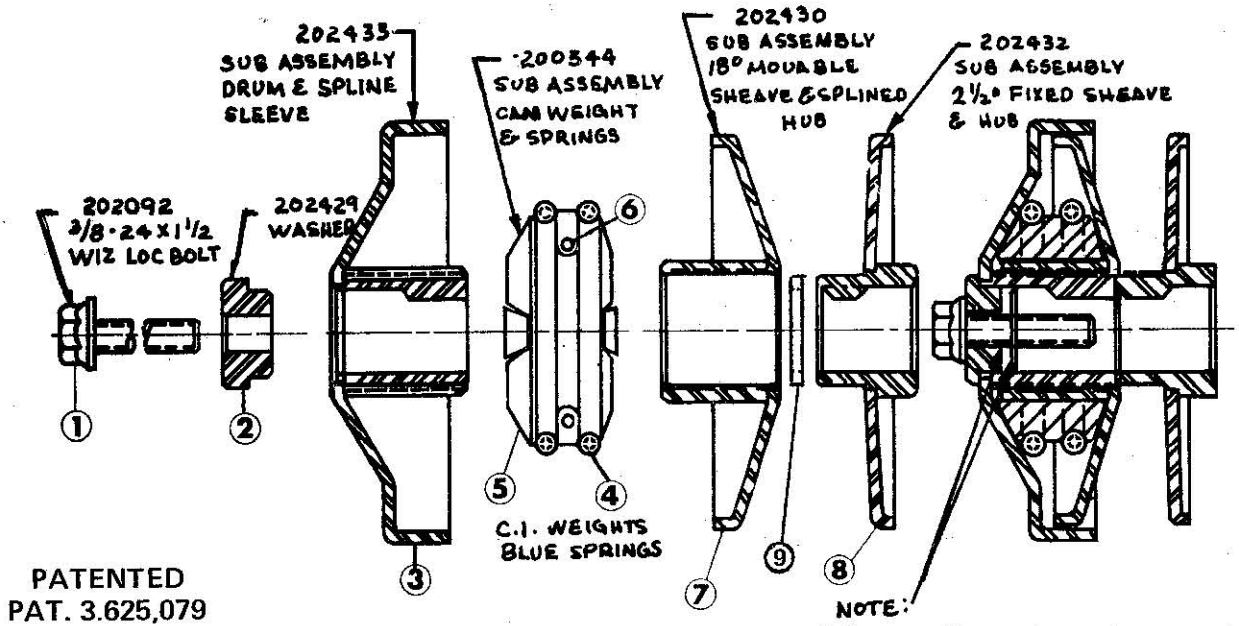

PATENTED
PAT. 3.625,079

NOTE:
WASHER # 202429 MUST NOT BOTTOM OUT
AGAINST END OF ENGINE SHAFT WHEN
BOLT IS TORQUED (30-40 FT. LBS.) TIGHT
AGAINST WASHER.

ITEM #	PART #	DESCRIPTION	QUANTITY REQUIRED	PRICE
1	202092	3/8-24 x 1 1/2 Wiz Loc Bolt	1	.30
2	202429	Washer - Spacer	1	.80
3	202433	Drum & Splined Sleeve	1	7.00
*4	11188	Blue Engagement Springs	2	.60
*5	200342	Shoe Cast Iron Weighted	2	1.50
*6	200543	Pin Roll	2	.20
7	202430	18° Movable Sheave W/Splined Hub	1	6.75
8	202432	2 1/2° Fixed Sheave W/Hub	1	5.25
*	200344	Items 4-5&6 Shoe Driver Assy. Complete	1	4.75
9	202684	Washer 16 Ga. 1-1/64" I.D. x 19/64	1	.20
	202445	COMPLETE FRONT UNIT		18.90
	0628	Belt (asymmetric 9.0")	1	4.85
	0629	Torque Converter Cover	1	10.85

COMET INDUSTRIES

A DIVISION OF HOFFCO INC. - RICHMOND, INDIANA 47374

The nations leading designers and manufacturers of clutches and transmission components for power equipment

COMET C.A.T.-99 N TORQUE CONVERTER

DRIVEN UNIT MOD. NOS. CATN992-62;
CATN992-75, CATN992-62-7 & CATN992-75-7

ASSEMBLY SEQUENCE & PARTS LIST

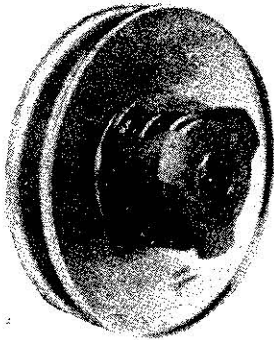

PATENTED
PAT. 3,625,079

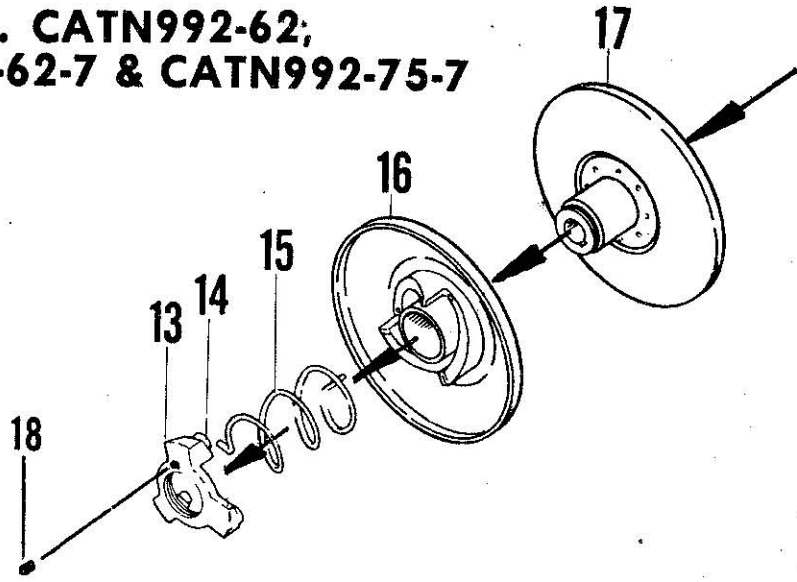

ITEM #	PART #	DESCRIPTION	PRICE
13	202110	Block, Cam W/Nylon Slide Inserts	4.50
14	200373	Slide, Nylon Button Inserts	.20
15	200372	Spring, Helical R.H.	1.50
16	200404	Sheave, Movable 18°	6.95
17	202105	Sheave Stationary 2½° , 5/8 I.D.	6.50
	202106	Sheave, Stationary 2½° , 3/4 I.D.	6.50
18	200741	Screw, Set Soc. Hd. 10-32 x ¼"	.20
	202060	COMPLETE REAR UNIT	15.50

COMET INDUSTRIES

A DIVISION OF HOFFCO INC. - RICHMOND, INDIANA 47374

The nations leading designers and manufacturers of clutches and transmission components for power equipment