

OPERATORS MANUAL THREE WHEEL RECREATIONAL VEHICLE TRI-SCAT & NOMAD SEVENTY TWO

WARRANTY

The Snow Company guarantees each new vehicle to be free of defects in workmanship and/or labor and will repair or replace, at its option, without charge to the original purchaser any part or parts found to be defective in workmanship or material upon examination by any authorized service dealer or at the Snow Company factory at Omaha, Nebraska, for a period not to exceed 90 days from date of sale. Exception: power train components are covered by separate warranty as follows:

The clutch, chain, tires, brakes, and sprockets by their very function, are subject to wear and are warranted for only 30 days against defects in material and/or workmanship. Labor costs for the replacement and/or repair of these parts is not under warranty.

All transportation charges on, and damages or loss incurred in connection with transportation of parts submitted for replacement or repair under this warranty shall be borne by the purchaser.

The engine is under separate warranty by the engine manufacturer and no such warranty thereon is expressed or implied by The Snow Company. See enclosed engine operating manual for engine warranty and list of service stations. Under no circumstances should engines be returned to The Snow Company. The return of any vehicle or component parts must first be authorized by written permission. All unauthorized returns will be refused.

This vehicle is designed for off-the-road use only and any licensing required to comply with local or state vehicle requirements is the sole responsibility of the purchaser.

The use of this vehicle in competitive racing or on commercial and/or rental tracks void any warranty stated or implied.

The preceding warranty is in lieu of all other warranties expressed, implied or statutory and of all other obligations and/or liabilities on the part of the distributor. The distributor neither assumes nor authorizes any other person, natural or corporate, to assume for it any other obligation or liability in connection with the sale of this vehicle. The distributor shall in no other event be liable for any consequential, incidental or special damages.

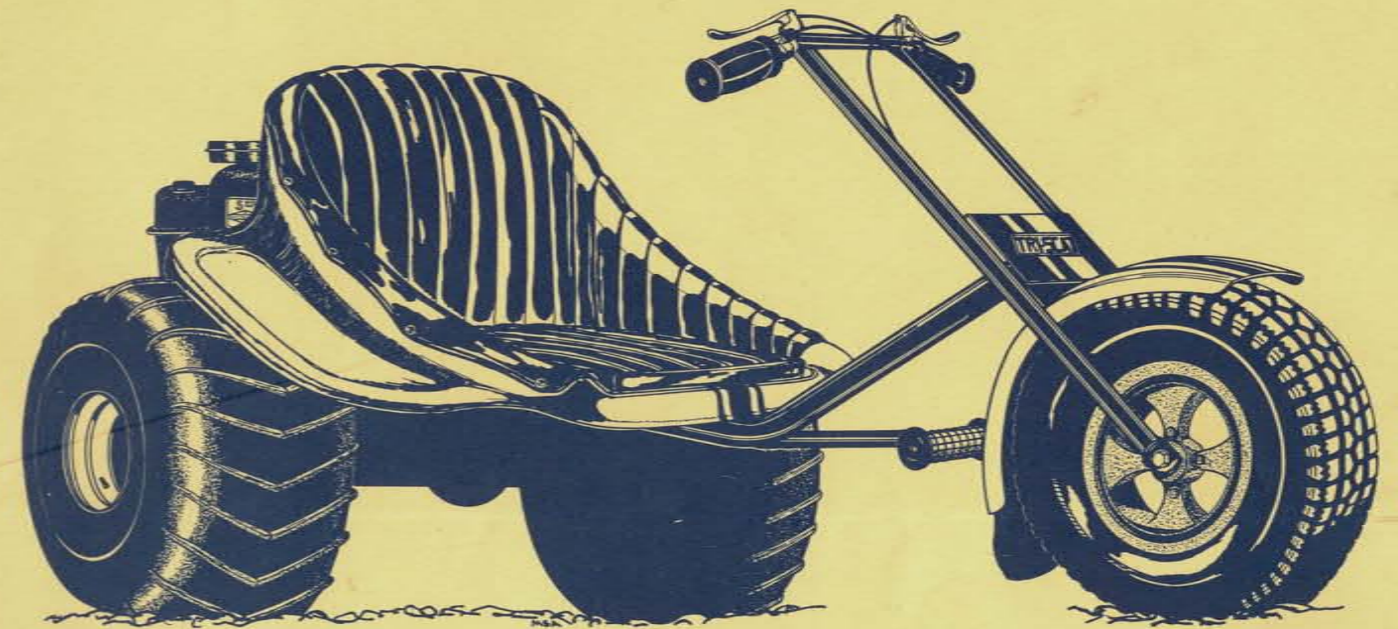

TRI-SCAT



NOMAD SEVENTY TWO

GENERAL INFORMATION

This owner's guide has been prepared to provide the information needed to assemble, operate and maintain your Three Wheel Recreational Vehicle. Read this owner's guide and the engine manual carefully. Be sure you know what the controls are and how they operate. The care your Three Wheel Recreational Vehicle requires is small, but important. Keep it clean and well lubricated. With proper care and maintenance, as explained in this manual, you will obtain long and efficient service.

Information regarding the operation, repairs and maintenance of the engine is not included in this manual. A separate engine instruction manual is included with your Three Wheel Recreational Vehicle and should be consulted for all information concerning engine adjustments, operation, maintenance and repairs. For all information concerning engine service and maintenance follow instructions in the engine manual.

THINK SAFETY BEFORE YOU USE YOUR THREE WHEEL RECREATIONAL VEHICLE

Your Three Wheel Recreational Vehicle was built to the highest standards in the industry. However, a Three Wheel Recreational Vehicle is only as safe as the operator. As with any type of power equipment, carelessness or error on the part of the operator can result in injury. Please read and follow these instructions on safe operation and be certain anyone using this Three Wheel Recreational Vehicle is familiar with them.

USE APPROVED PROTECTIVE HEAD GEAR WHEN OPERATING THIS VEHICLE

- Improper use of the Three Wheel Recreational Vehicle can result in damage. Give complete and undivided attention to your riding.
- Know the controls and how they operate.
- Know how to stop the Vehicle and engine instantly.
- Do not allow anyone to operate Vehicle without proper instruction and supervision.
- Keep Vehicle in good operating condition and all guards in place.
- Stop engine whenever you get off the Vehicle.
- Exercise caution when riding in rough areas.
- Do not attempt to service or adjust while the engine is running.
- Make sure throttle is free (not sticking open) before starting.
- Store gasoline in a safe container. Store the container in a cool, dry place.
- Fill gas tank outdoors. Avoid spilling gasoline. **Don't fill tank while engine is hot or running or while you are smoking.**
- Open doors if engine is run in garage. Exhaust gases are dangerous.
- Operate Vehicle without any passengers.

WARNING: This Three Wheel Recreational Vehicle has not been manufactured for racing or for use on public streets, roads, highways and sidewalks and cannot be licensed for such use. Do not operate on such streets, roads, highways and sidewalks.

Preparation for Operation

ASSEMBLY

Your Three Wheel Recreational Vehicle has been shipped in one carton with the front fork assembly, mudflap and front frame assembly unattached. The throttle and brake should be checked for adjustment after assembly. SEE "BRAKE ADJUSTMENT". Also for throttle control adjustment SEE "THROTTLE ADJUSTMENT".

1. Attach mud flaps to fender, at holes provided, with (2) $\frac{1}{4}$ -20x $\frac{3}{4}$ hex head cap screws, (4) $\frac{1}{4}$ flat washers, and (2) $\frac{1}{4}$ -20 hex lock nuts.
Note: Washers should be positioned under head of screw and under nut. (See Fig. 1).
2. Insert bearings in pivot tube of frame for front fork assembly. Attach front fork assembly to front frame pivot tube with (1) $\frac{5}{8}$ -11x $6\frac{1}{2}$ hex. head cap screw and (1) $\frac{5}{8}$ lock washer. Tighten enough to remove play, but not so tight to restrict steering movement.
3. Loosen (DO NOT REMOVE) the two screws in the brake control assembly and trace brake cable from right brake back to handle and place on the right side of the handle bar 6" in from end. Repeat procedure for left brake. The left brake control should be placed 5" in from the end.

LEFT BRAKE CONTROL MUST OPERATE LEFT BRAKE AND RIGHT BRAKE CONTROL MUST OPERATE RIGHT BRAKE.

Attach thumb throttle control assembly to right side of handle bar 5" from the end right behind the right brake control handle. (See Fig. 1).

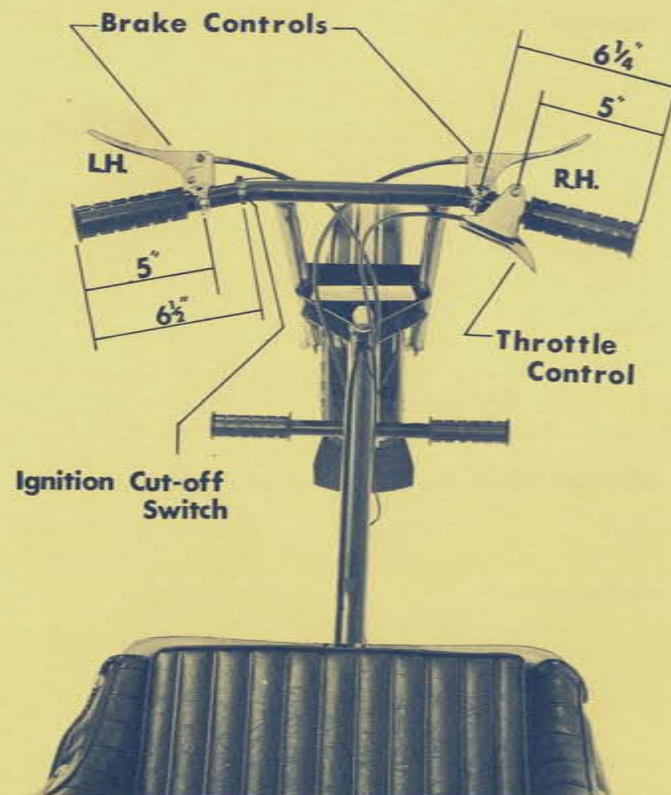

Figure 1

4. Install ignition cut off switch on left side of handle bar $6\frac{1}{2}$ from the end. (See Fig. 1).
5. FOR NOMAD SEVENTY TWO SEAT INSTALLATION. (See page 5).

OPERATION OF CONTROLS

1. Brake controls: This control is located on each handle bar and is operated by squeezing toward the handle bar. Squeezing engages the brake and releasing disengages brake. To stop vehicle, squeeze both left and right controls simultaneously. Two brake controls are provided to enhance traction and steering capabilities, squeeze right brake lever when turning handle bars to right and left brake lever when turning handle bars left. To increase traction, apply brake to wheel that is spinning freely. This will transfer the power to the opposite wheel.
2. Throttle control: This control is located on the right handle bar and is operated by depressing handle with the thumb. Depressing control increases the speed of the engine and causes the clutch to engage resulting in forward motion. Releasing thumb control reduces engine speed and forward motion. This control is a "dead-man" type and when released automatically returns to the idle position.

3. Ignition cut off switch: This control is located on the left handle bar. (See Fig. 1). To stop the engine depress button until engine stops.
4. Choke control: This control is located on the engine directly above the fuel tank. Pull choke out to choke engine for starting. Push choke in when engine has started. (See Engine Manual).

PRE-STARTING INSTRUCTIONS

CAUTION

Follow these steps thoroughly before starting the engine.

1. Check to see that the throttle control is in the idle position and that the engine throttle linkage is in the full idle position. If not, see maintenance and adjustment sections. (See Fig. 3).

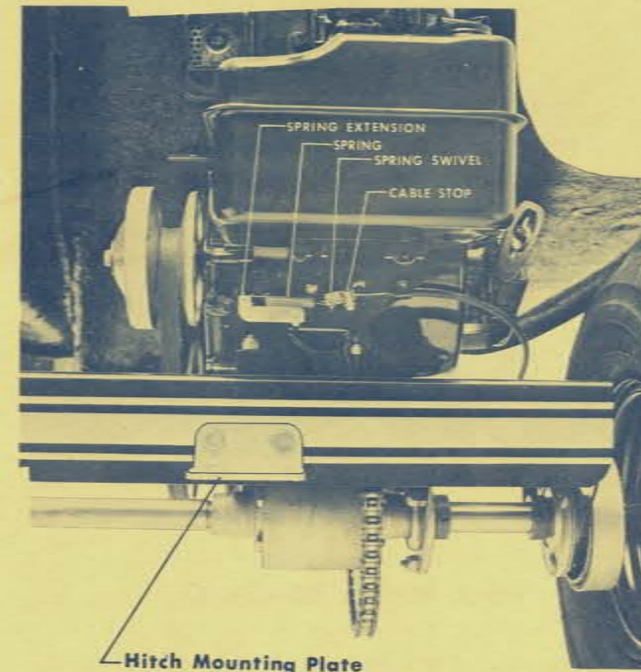

Figure 3

2. Test both brakes by applying brakes and pulling unit forward. Wheels should not rotate when brakes are applied. If wheels rotate, adjust brake per instructions.
3. Fill fuel tank completely with clean, fresh, leaded or non-leaded "Regular" grade gasoline. Do NOT mix with oil! Wipe away any gasoline which may be spilled.
4. Fill crankcase with clean, fresh, oil marked "MS" only. Do NOT use oil marked "MM" or "ML". Make sure vehicle is sitting level and fill to top of filler hole. Fill slowly to avoid trapping air. If engine is equipped with dipstick, fill to full mark only.

5. Check to see that spark plug wire is secure.
6. Check tire pressure. Front tire should have 5-10 lbs. pressure. Rear tires should have 2-4 lbs. pressure.

TRIAL RUN

Now that you have serviced the engine and know the operation and function of the controls, you are ready to take your Three Wheel Recreational Vehicle on a trial run. Remember, exercise extreme caution until you become familiar with your Vehicle.

TO START ENGINE

1. Check to make sure throttle is in idle position.
2. Place front wheel against immovable object before starting.
3. Push ignition switch forward to "ON."
4. Pull choke control out to choke engine. Don't choke if restarting a warm engine.
5. Stand directly behind engine and with left foot on rear frame, pull starter cord rapidly until the engine starts.
6. When engine starts, push choke control in gradually.

TO STOP ENGINE

1. To stop engine, depress button until engine stops.

Maintenance and Lubrication

1. Pivot tube bearings for front fork assembly must be greased periodically. All other bearings are pre-lubricated and do not require lubrication.
2. The chain has been lubricated at the factory. However, oil chain thoroughly when it appears to be excessively dirty or dry. Apply oil at large sprocket and push unit forward to rotate chain.
3. Check oil level of engine every 5 hours of operation. Clean away any dirt from around oil plug before removing. Change oil after first 5 hours of operation and every 25 hours thereafter. (See Engine Manual).
4. Clean and re-oil air cleaner element every 25 hours under normal conditions or every few hours under extremely dusty conditions. (See Engine Manual).
5. Make visual inspection of Three Wheel Recreational Vehicle every day for loose or damaged parts. Correct as required.
6. Apply a light coat of oil to axles and jackshaft to prevent rusting.

CHAIN ADJUSTMENT

Before operating vehicle, chain should be checked. If chain is loose adjust chain. See instructions on next page.

1. To adjust chain loosen bolt holding idler sprocket and move to desired position. (DO NOT HAVE CHAIN TOO TIGHT) and retighten nut and bolt. (See Fig. 4).

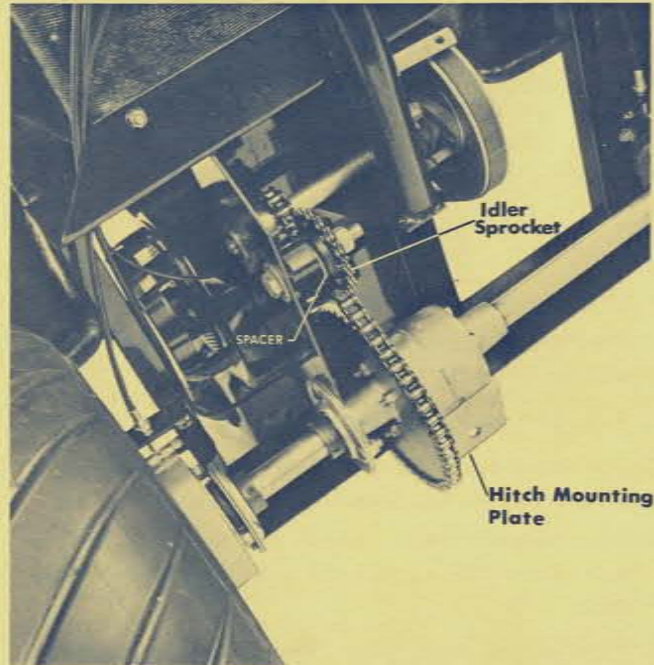

Figure 4

BRAKE ADJUSTMENT

Although the brakes have been adjusted at the factory, they will require readjustment after considerable use.

To adjust brakes (See Fig. 5):

1. Block up rear of unit to allow rear wheels to turn freely.



Figure 5

2. Loosen, DO NOT remove, locking nut several turns.
3. Hold conduit to prevent from twisting and turn adjusting nut to take up slack in cable. Keep turning adjustment nut until there is a noticeable drag on the wheel when rotated by hand. Then, back off adjustment nut just enough to eliminate drag.

4. Retighten locking nut and remove blocks.

NOTE: Make sure conduit is fully seated in slot of brake cable bracket when tightening.

THROTTLE ADJUSTMENT

Should the engine fail to reach maximum RPM or idle too fast, the throttle control should be adjusted as follows:

1. Loosen cable stop screw and allow throttle lever to move to full left (idle) position.
2. Check to see that throttle casing end is flush with edge of casing clamp. If not, loosen casing clamp screw and re-position. Tighten casing clamp securely.
3. With thumb control in idle position, retighten cable stop screw.
4. If above instructions do not correct problem refer to engine manual for more adjustment.

FRONT WHEEL REMOVAL

1. Remove lock nut from end of front axle bolt.
2. Remove wheel assembly by sliding axle bolt free.
3. To replace wheel assembly, reverse the above procedure. Tighten only enough to take up play. Over-tightening will damage the bearings. NOTE: See "Tire & Tube Removal" for repair of punctures or leaks.

REAR WHEEL REMOVAL

1. Block up rear of unit to clear rear wheels from the ground.
2. Remove nuts with standard lug wrench and remove wheel.
3. To mount wheel, reverse above procedure.

NOTE: The rear wheels are mounted with tubeless type tires and should be taken to a local filling station to repair leaks or punctures.

TIRE & TUBE REMOVAL (Front Only)

1. Remove wheel assembly per above.
2. Deflate tire.
3. Remove hex head screws and pull wheel halves apart.
4. Remove inner tube and repair as required.

5. Reverse above procedure to assemble wheel and tire, making sure not to pinch tube or valve between wheel halves.

BELT REMOVAL

1. Remove belt guard.
2. Block up rear of Vehicle so rear wheels turn freely.
3. Work belt off of large (jackshaft) pulley by rotating jackshaft pulley and remove from small (engine) pulley. (See Fig. 6).

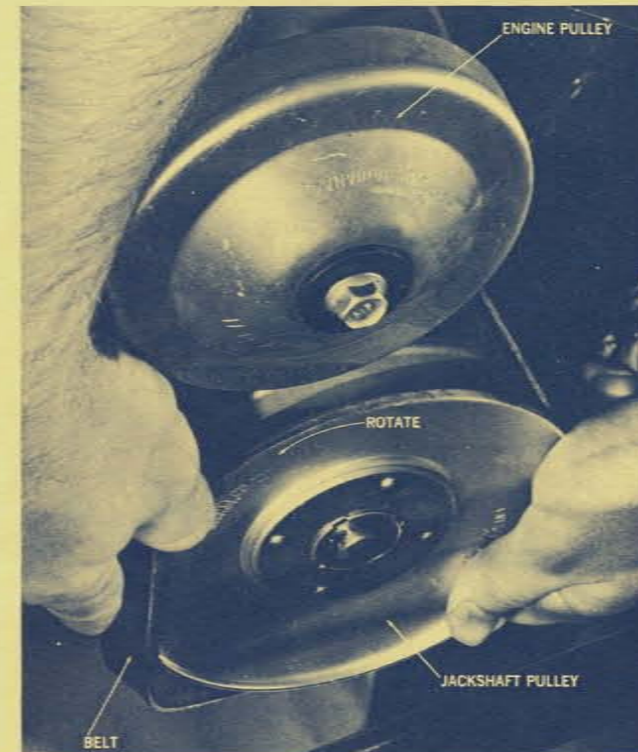

Figure 6

4. To install new belt, reverse the above procedure.
5. Replace belt guard.

STORAGE

If your Three Wheel Recreational Vehicle is not going to be used for a prolonged period, it should be serviced and stored in a dry place.

1. Check Engine Manual for storage instructions.
2. Drain gas from tank.
3. Run engine until remaining gas is used up and engine stops.
4. Cover exposed (unpainted or unplated) metal surfaces with a thin coat of oil.
5. Before using the Three Wheel Recreational Vehicle again, check for loose or damaged parts and correct as required. Follow "Pre-starting" and "Operation of Controls" instruction and review Engine Manual before proceeding.

NOMAD SEVENTY TWO SEAT INSTALLATION

SEAT INSTALLATION

1. Attach # (94) seat bottom support to main frame using two $\frac{1}{4} \times \frac{3}{4}$ bolts, flat washer and lock nut. Flat washer to be under bolt head. SEE ILLUSTRATION.

Mount # (83) seat cushion to seat bottom support using four $\frac{1}{4} \times \frac{3}{4}$ bolts with lock washer under bolt head and flat washer.

The # (95) & (96) left and right seat support is already attached to # (84) back seat cushion. Mount complete assembly to main frame using four # (62) U-bolts and lock nuts. SEE ILLUSTRATION.

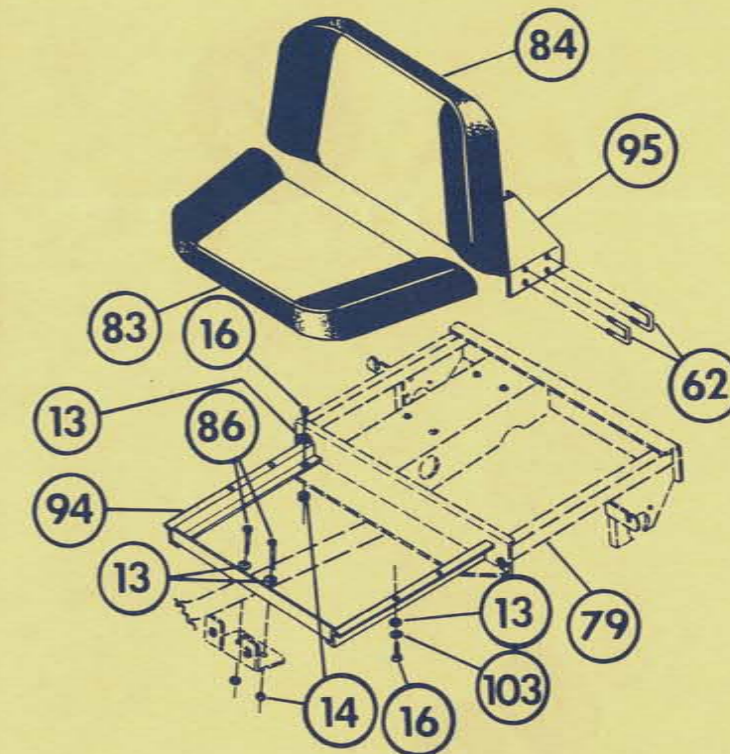

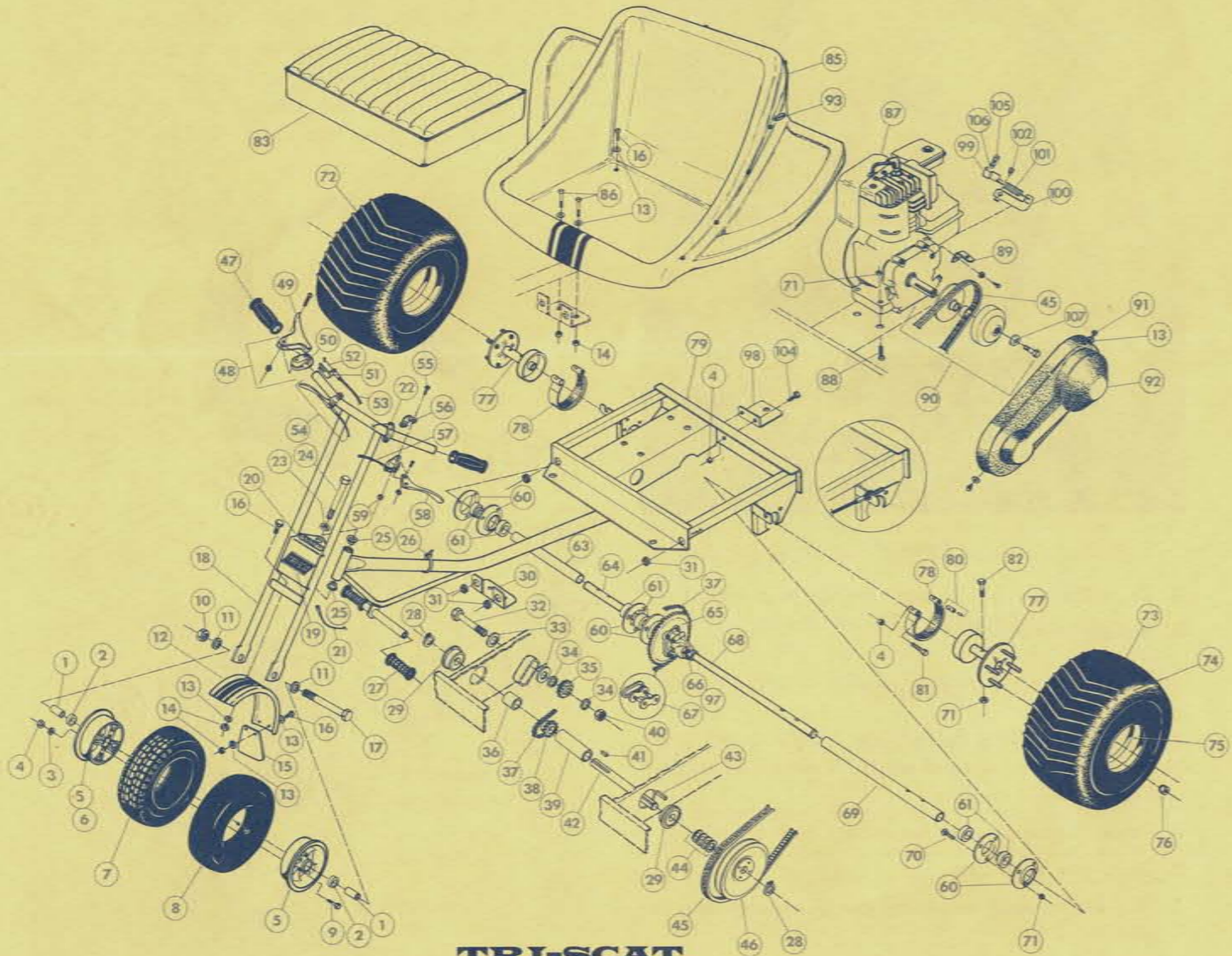
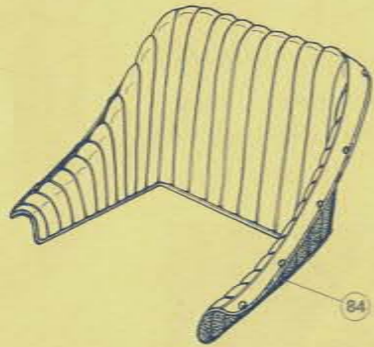

TRI-SCAT

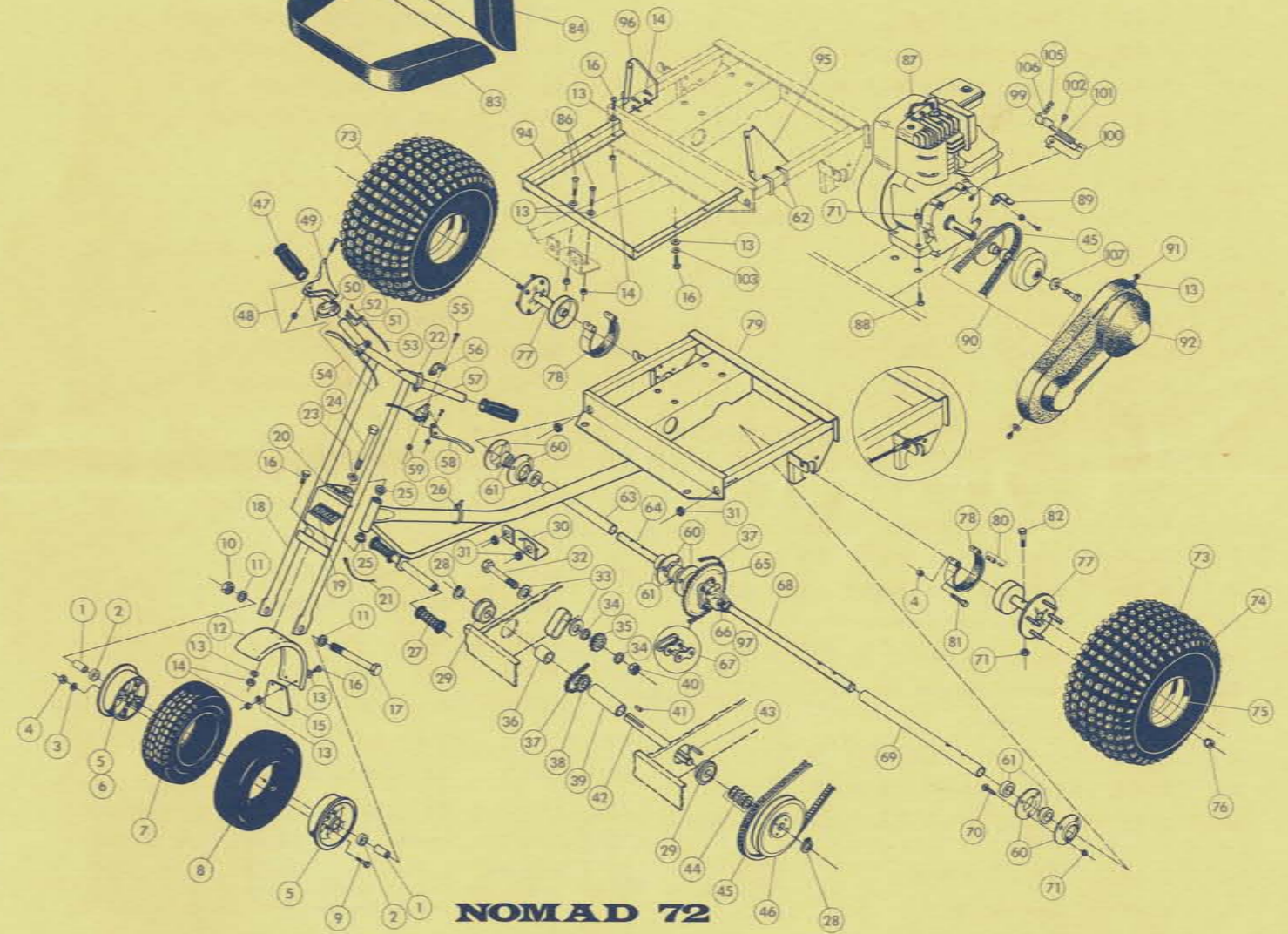
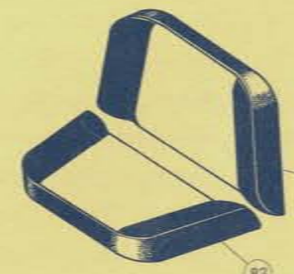

NOMAD 72

PARTS LIST

III. No.	Part No.	Description	III. No.	Part No.	Description
1	33-210	Bushing, Spacer 7/8 O.D.x5/8 I.D.x1 5/8	42	33-256	Shaft, Jack
2	33-208	Bearing—5/8" Ball	43	33-272	Key—3/16 Sqx1 3/4
3	91-061	Washer, Flat—3/8	44	91-404	Bushing, Mach. 5/8x18 Ga.
4	91-014	Nut, Lock 3/8	45	33-221	Belt,—7 1/2 TC883-75
5	33-311	Wheel, Assembled 4-Spoke Mag	46	33-220	Assem., Torque Converter—Driven
6	33-312	Wheel, Half (only) 4-Spoke Mag	47	33-304	Grip, Dummy Handle
7	33-204	Tire 5.30/4.50x6	48	33-298	Assem., Thumb Control Throttle
8	33-205	Tube, Inner 5.30/4.50x6	49	33-302	Control, Thumb (Throttle)
9	90-082	Screw, Cap 3/8x1 1/4 (High Tensile)	50	33-303	Clamp, Mtg. (Throttle)
10	91-018	Nut, Lock 5/8	51	33-301	Brkt., Throttle Cable Mtg.
11	91-064	Washer, Flat 5/8	52	33-389	Cable, Throttle
12	33-297	Fender, Front Steel w/Stripe (Tri-Scat)	53	33-299	Housing, Throttle Cable
	33-320	Fender, Front Steel No Stripe (Nomad 72)	54	33-237	Assem., Brake Control
13	91-059	Washer, Flat—1/4"	55	90-316	Screw, Rd. Hd. Mach. #10-24x3/4 N.C.
14	91-313	Nut, Lock—1/4"	56	33-307	Clamp, Mtg. (Brake)
15	33-201	Flap, Mud	57	33-285	Housing w/Cable (Brake)
16	90-001	Screw, Cap 1/4x3/4	58	33-306	Handle, Brake
17	90-076	Screw, Cap 5/8x7 1/2	59	91-302	Nut, Reg. Hex #10-24
18	33-259	Fork, Front	60	22-182	Flangette
19	33-266	Decal, "Tri-Scat"	61	22-183	Bearing w/Locking Collar SKF 478205-100 or Fafnir RA 100 NPPB
	33-309	Decal, "Nomad 72"	62	17-224	Bolt, "U" 1/4x1-5/16 Leg.
20	33-278	Decal, Ignition—"On-Off"	63	33-292	Sleeve, Right Axle
21	33-383	Wire—Magneto Ground 74 1/2 Lg.	64	33-290	Axle, Right w/Gear
22	33-346	Switch, Ignition Cut Off	65	33-287	Sprocket, Differential
23	91-074	Washer, Split Lock—5/8"	66	33-288	Housing, Differential w/2 Miter Gears
24	90-078	Screw, Cap 5/8x6 1/2	67	23-163	Link, Connector
25	33-212	Bearing, Flanged Heim RF-10-22-14	68	33-289	Axle, Left w/Gear
26	33-247	Tie—Plastic	69	33-291	Sleeve, Left Axle
27	33-263	Cover, Foot Peg	70	90-203	Bolt, Carriage 5/16x3/4
28	33-305	Ring, Snap—5/8 #5160-62	71	91-312	Nut, Lock 5/16
29	33-281	Bearing w/Snap Ring (Ramco N-23-2RS NR)	72	33-230	Assem., Tire & Wheel—Right (Tri-Scat)
30	33-271	Brk't., Seat Mtg.	73	33-229	Assem., Tire & Wheel—Left (Tri-Scat)
31	21-451	Grammet, Rubber		33-296	Assem., Knobby Tire & Wheel (Nomad 72)
32	90-037	Screw, Cap 1/2x3	74	33-293	Tire (Tri-Scat) 21x12/8
33	91-063	Washer, Flat 1/2		33-294	Knobby Tire (Nomad 72)
34	91-087	Bushing, Machine 9/16x18 Ga.	75	33-295	Wheel
35	33-262	Sprocket, Idler 2318-A	76	91-032	Nut, Lug 1/2 N.F.
36	33-274	Bushing, Spacer 5/8 I.D.x7/8 O.D.x5/8	77	33-252	Adapter, Axle-Wheel
37	33-261	Chain, Drive #40-58 Pitch	78	33-240	Band, Brake
38	33-276	Sprocket #40 9 Tooth	79	33-257	Frame
	33-404	Sprocket #40 8 Tooth	80	33-239	Assem., Pivot Pin—Brake Band
39	33-275	Bushing, Spacer 5/8 I.D.x7/8 O.D.x3 3/4	81	90-023	Screw, Cap 3/8x2
40	91-017	Nut, Lock 1/2	82	90-012	Screw, Cap 5/16x1 3/4 (High Tensile)
41	33-273	Key—3/16 Sq.x3/4	83	33-265	Cushion, Seat (Tri-Scat)

III. No.	Part No.	Description	III. No.	Part No.	Description
	33-308	Cushion, Seat (Nomad 72)	95	33-317	Support, Seat Back—Left (Nomad 72)
84	33-282	Seat, Cushioned Back w/Snaps (Tri-Scat)	96	33-318	Support, Seat Back—Right (Nomad 72)
	33-313	Back, Seat (Nomad 72)	97	33-286	Assem., Differential w/Sprocket
85	33-264	Seat (Tri-Scat)	98	33-316	Plate, Hitch Mtg. (Optional on Nomad 72)
86	90-081	Screw, Cap 1/4x2 1/4	99	33-329	Swivel, Throttle
87	33-251	Engine 130202-0354-01	100	33-330	Extension, Spring
88	90-010	Screw, Cap 5/16x1 1/2	101	33-331	Spring
89	33-314	Brk't., Belt Guard Mtg. (Top)	102	90-330	Screw, Hex. Hd. Slotted Mach. w/Lock Washer #10-32x5/8
90	33-222	Assem., Torque Converter—Driver	103	91-078	Washer, Lock 1/4
91	90-403	Screw, Self-Tapping 1/4x1 1/2	104	90-019	Screw, Cap 3/8x1 N.C.
92	33-310	Guard, Belt	105	33-233	Cable Stop—Throttle Wire
93	33-267	Decal, Small "Snowco" (Tri-Scat)	106	33-234	Screw—Cable Stop
94	33-319	Assem., Seat Bottom Support (Nomad 72)	107	91-408	Washer, Hex. Compression 5/16

PARTS ORDERING INFORMATION

Important! To insure prompt and accurate filling of your parts order it is important that you supply us with the following information:

Your Name	Part Number Required
Street Address	Quantity Required
City, State	Part Description
Zip Code	Serial Number of Vehicle

ORDER BY PART NUMBER ONLY. III. numbers are for your reference ONLY and cannot identify parts. Shipments WILL NOT be made prior to receipt of payment. Check or money order MUST accompany all parts orders. All orders require \$1.00 additional to cover postage and handling. Minimum parts order (exclusive of handling) \$1.00.

Order Repair Parts From Dealer Where Vehicle Was Purchased.

The Snow Company, 4350 McKinley Street, Omaha, Nebraska 68112