

NOTES:



815.814.2009

PROJECT:
2202 KITCHEN
SHOREWOOD, IL 60404

DATE:

7/20/2022

SCALE:

N/A

SHEET:

T-1

PROJECT NOTE: These drawing are scope documents indicating the general project design concept, dimension of the project, major architectural elements, and basic organization of structural and mechanical, electrical, and plumbing systems. As scope documents, these drawings do not necessarily describe or indicate all materials or work required for full performance and completion of the project. On the basis of the general scope indicated or described, the general contractor shall furnish all items required for execution and completion of the proposed project and verify all dimensions in the field.



| DRAWING INDEX | | | |
|---------------|---------------------|------------|------|
| SHEET # | DESCRIPTION | SCALE | REV# |
| | | N/A | |
| 01 | RENDERED FLOOR PLAN | N/A | |
| 02 | OVERVIEW | N/A | |
| 03 | RENDERING 1 | N/A | |
| 04 | RENDERING 2 | N/A | |
| 05 | RENDERING 3 | N/A | |
| 06 | RENDERING 4 | N/A | |
| 07 | RENDERING 5 | N/A | |
| 08 | RENDERING 6 | N/A | |
| 09 | RENDERING 7 | N/A | |
| 10 | RENDERING 8 | N/A | |
| 12 | PROPOSED MATERIALS | N/A | |
| A-1 | FLOOR PLAN | 1/4"=1'-0" | |

PROJECT # 2202_ KITCHEN DESIGN A



NOTES: _____



815.814.2009



PROJECT:

2202 KITCHEN
SHOREWOOD, IL 60404

DATE:

7/20/2022

SCALE:

N/A

SHEET:

01

PROJECT NOTE: These drawing are scope documents indicating the general project design concept, dimension of the project, major architectural elements, and basic organization of structural and mechanical, electrical, and plumbing systems. As scope documents, these drawings do not necessarily describe or indicate all materials or work required for full performance and completion of the project. On the basis of the general scope indicated or described, the general contractor shall furnish all items required for execution and completion of the proposed project and verify all dimensions in the field.

RENDERED FLOOR PLAN

NOTES:



815.814.2009

PROJECT:
2202 KITCHEN
SHOREWOOD, IL 60404

DATE:
1/20/2022

SCALE:
N/A

SHEET:
02

PROJECT NOTE: These drawing are scope documents indicating the general project design concept, dimension of the project, major architectural elements, and basic organization of structural and mechanical, electrical, and plumbing systems. As scope documents, these drawings do not necessarily describe or indicate all materials or work required for full performance and completion of the project. On the basis of the general scope indicated or described, the general contractor shall furnish all items required for execution and completion of the proposed project and verify all dimensions in the field.



OVERVIEW

NOTES:



815.814.2009



PROJECT:

2202 KITCHEN
SHOREWOOD, IL 60404

DATE:

7/20/2022

SCALE:

N/A

SHEET:

03

PROJECT NOTE: These drawing are scope documents indicating the general project design concept, dimension of the project, major architectural elements, and basic organization of structural and mechanical, electrical, and plumbing systems. As scope documents, these drawings do not necessarily describe or indicate all materials or work required for full performance and completion of the project. On the basis of the general scope indicated or described, the general contractor shall furnish all items required for execution and completion of the proposed project and verify all dimensions in the field.

NOTES:



815.814.2009



PROJECT:

2202 KITCHEN
SHOREWOOD, IL 60404

DATE:

7/20/2022

SCALE:

N/A

SHEET:

04

PROJECT NOTE: These drawing are scope documents indicating the general project design concept, dimension of the project, major architectural elements, and basic organization of structural and mechanical, electrical, and plumbing systems. As scope documents, these drawings do not necessarily describe or indicate all materials or work required for full performance and completion of the project. On the basis of the general scope indicated or described, the general contractor shall furnish all items required for execution and completion of the proposed project and verify all dimensions in the field.

NOTES: _____



815.814.2009



PROJECT:
2202 KITCHEN
SHOREWOOD, IL 60404

DATE:

7/20/2022

SCALE:

N/A

SHEET:

05

PROJECT NOTE: These drawing are scope documents indicating the general project design concept, dimension of the project, major architectural elements, and basic organization of structural and mechanical, electrical, and plumbing systems. As scope documents, these drawings do not necessarily describe or indicate all materials or work required for full performance and completion of the project. On the basis of the general scope indicated or described, the general contractor shall furnish all items required for execution and completion of the proposed project and verify all dimensions in the field.

NOTES: _____



815.814.2009



PROJECT:

2202 KITCHEN
SHOREWOOD, IL 60404

DATE:

7/20/2022

SCALE:

N/A

SHEET:

06

PROJECT NOTE: These drawing are scope documents indicating the general project design concept, dimension of the project, major architectural elements, and basic organization of structural and mechanical, electrical, and plumbing systems. As scope documents, these drawings do not necessarily describe or indicate all materials or work required for full performance and completion of the project. On the basis of the general scope indicated or described, the general contractor shall furnish all items required for execution and completion of the proposed project and verify all dimensions in the field.

NOTES:



815.814.2009



PROJECT:

2202 KITCHEN
SHOREWOOD, IL 60404

DATE:

7/20/2022

SCALE:

N/A

SHEET:

07

PROJECT NOTE: These drawing are scope documents indicating the general project design concept, dimension of the project, major architectural elements, and basic organization of structural and mechanical, electrical, and plumbing systems. As scope documents, these drawings do not necessarily describe or indicate all materials or work required for full performance and completion of the project. On the basis of the general scope indicated or described, the general contractor shall furnish all items required for execution and completion of the proposed project and verify all dimensions in the field.

NOTES: _____



815.814.2009



PROJECT:

2202 KITCHEN
SHOREWOOD, IL 60404

DATE:

7/20/2022

SCALE:

N/A

SHEET:

08

PROJECT NOTE: These drawing are scope documents indicating the general project design concept, dimension of the project, major architectural elements, and basic organization of structural and mechanical, electrical, and plumbing systems. As scope documents, these drawings do not necessarily describe or indicate all materials or work required for full performance and completion of the project. On the basis of the general scope indicated or described, the general contractor shall furnish all items required for execution and completion of the proposed project and verify all dimensions in the field.

NOTES: _____



815.814.2009



PROJECT:

2202 KITCHEN
SHOREWOOD, IL 60404

DATE:

7/20/2022

SCALE:

N/A

SHEET:

09

PROJECT NOTE: These drawing are scope documents indicating the general project design concept, dimension of the project, major architectural elements, and basic organization of structural and mechanical, electrical, and plumbing systems. As scope documents, these drawings do not necessarily describe or indicate all materials or work required for full performance and completion of the project. On the basis of the general scope indicated or described, the general contractor shall furnish all items required for execution and completion of the proposed project and verify all dimensions in the field.

NOTES:



815.814.2009



PROJECT:

2202 KITCHEN
SHOREWOOD, IL 60404

DATE:

7/20/2022

SCALE:

N/A

SHEET:

10

PROJECT NOTE: These drawing are scope documents indicating the general project design concept, dimension of the project, major architectural elements, and basic organization of structural and mechanical, electrical, and plumbing systems. As scope documents, these drawings do not necessarily describe or indicate all materials or work required for full performance and completion of the project. On the basis of the general scope indicated or described, the general contractor shall furnish all items required for execution and completion of the proposed project and verify all dimensions in the field.

NOTES: _____



815.814.2009

PROJECT:
2202 KITCHEN
SHOREWOOD, IL 60404

DATE:

7/20/2022

SCALE:

N/A

SHEET:

12

PROJECT NOTE: These drawing are scope documents indicating the general project design concept, dimension of the project, major architectural elements, and basic organization of structural and mechanical, electrical, and plumbing systems. As scope documents, these drawings do not necessarily describe or indicate all materials or work required for full performance and completion of the project. On the basis of the general scope indicated or described, the general contractor shall furnish all items required for execution and completion of the proposed project and verify all dimensions in the field.

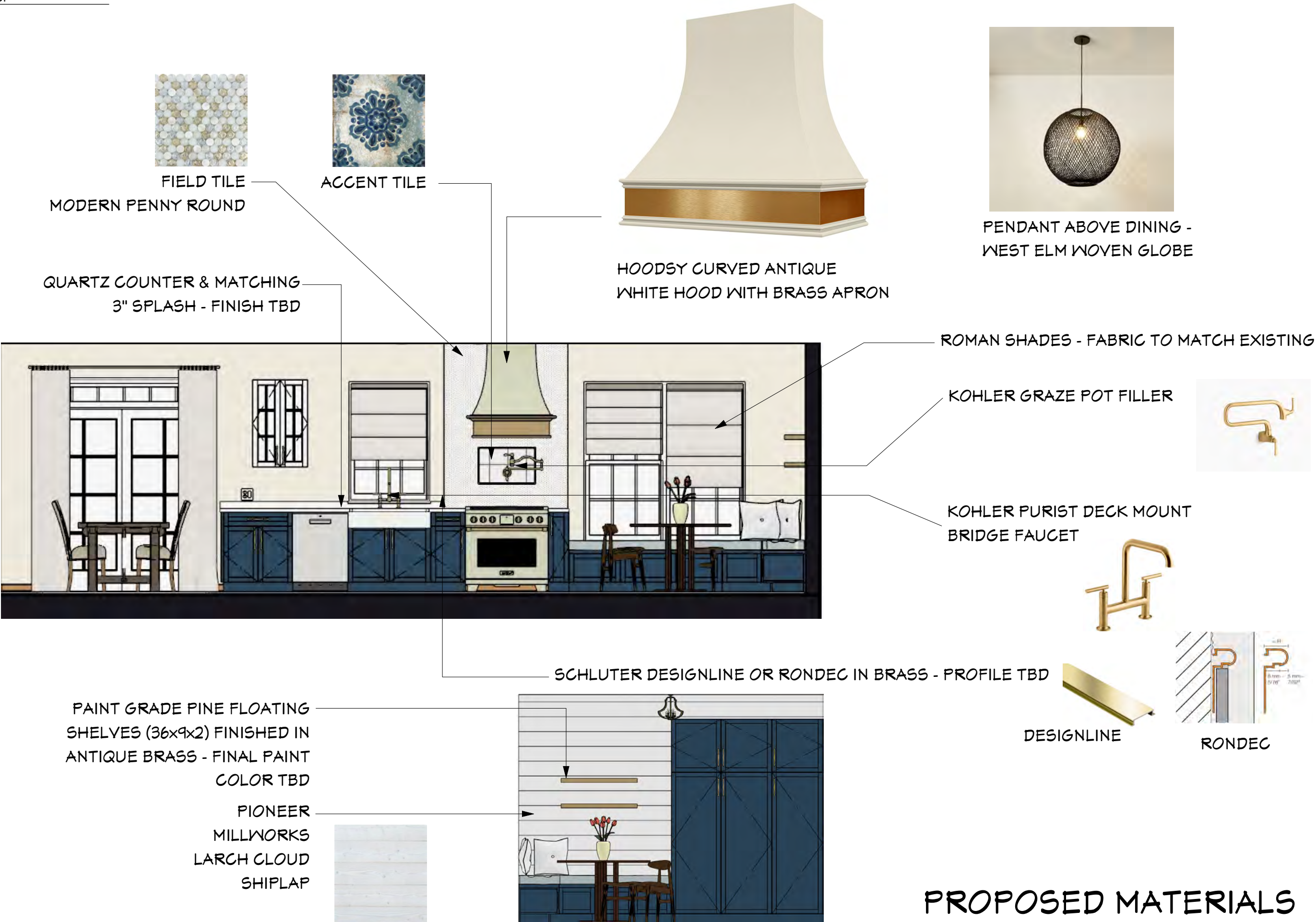

NOTES:



815.814.2009

PROJECT:
2202 KITCHEN
SHOREWOOD, IL 60404

DATE:

7/20/2022

SCALE:

$$1/4'' = 1' - 0''$$

SHEET:

A-1

PROJECT NOTE: These drawing are scope documents indicating the general project design concept, dimension of the project, major architectural elements, and basic organization of structural and mechanical, electrical, and plumbing systems. As scope documents, these drawings do not necessarily describe or indicate all materials or work required for full performance and completion of the project. On the basis of the general scope indicated or described, the general contractor shall furnish all items required for execution and completion of the proposed project and verify all dimensions in the field.

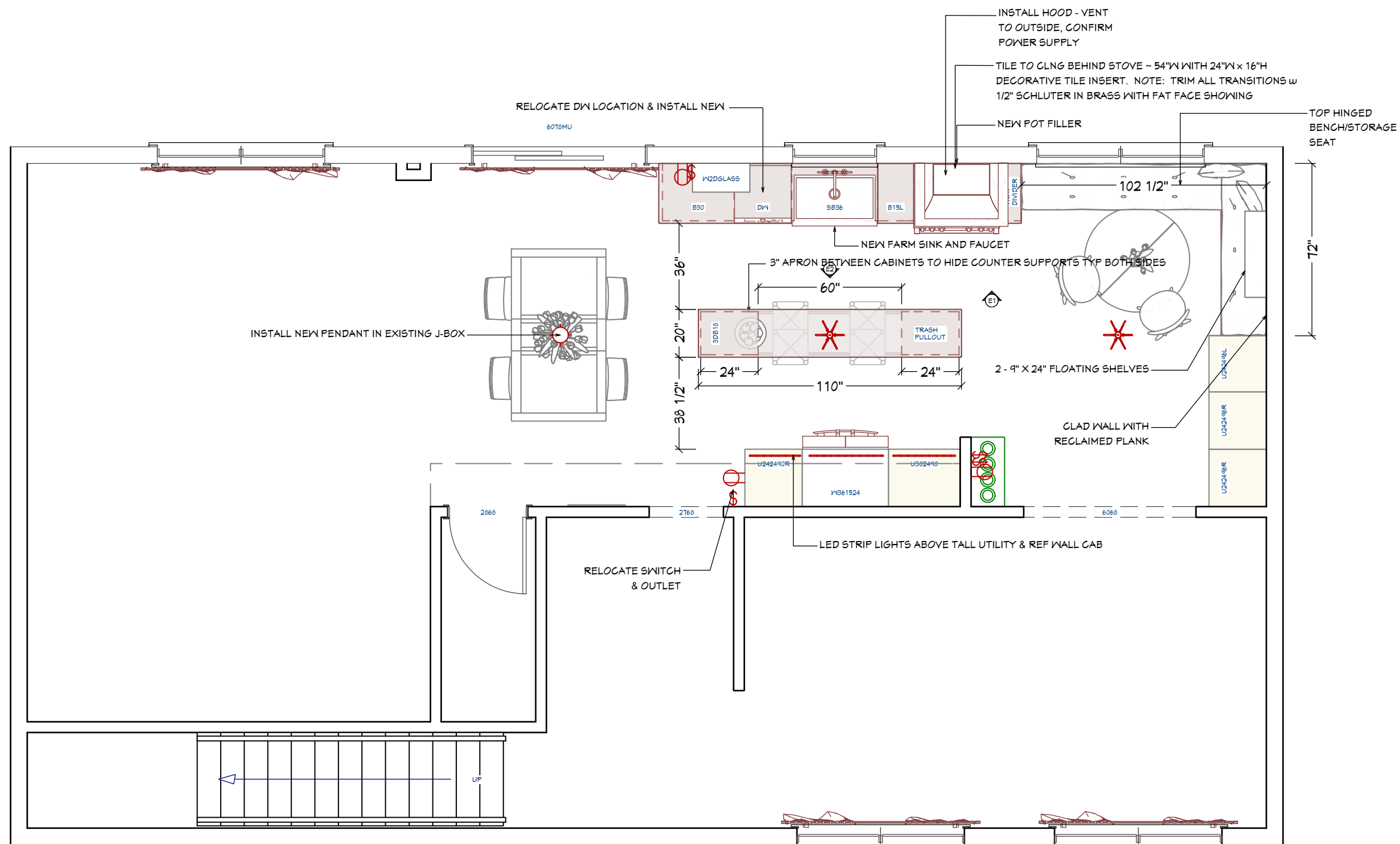

FLOOR PLAN

NOTES:



815.814.2009

PROJECT:

2202 KITCHEN
SHOREWOOD, IL 60404

DATE:

7/20/2022

SCALE:

N/A

SHEET:

T-1

PROJECT NOTE: These drawing are scope documents indicating the general project design concept, dimension of the project, major architectural elements, and basic organization of structural and mechanical, electrical, and plumbing systems. As scope documents, these drawings do not necessarily describe or indicate all materials or work required for full performance and completion of the project. On the basis of the general scope indicated or described, the general contractor shall furnish all items required for execution and completion of the proposed project and verify all dimensions in the field.



| DRAWING INDEX | | | |
|---------------|---------------------|------------|------|
| SHEET # | DESCRIPTION | SCALE | REV# |
| | | N/A | |
| 01 | RENDERED FLOOR PLAN | N/A | |
| 02 | OVERVIEW | N/A | |
| 03 | RENDERING 1 | N/A | |
| 04 | RENDERING 2 | N/A | |
| 05 | RENDERING 3 | N/A | |
| 06 | RENDERING 4 | N/A | |
| 07 | RENDERING 5 | N/A | |
| 08 | RENDERING 6 | N/A | |
| 09 | RENDERING 7 | N/A | |
| 10 | RENDERING 8 | N/A | |
| 12 | PROPOSED MATERIALS | N/A | |
| A-1 | FLOOR PLAN | 1/4"=1'-0" | |

PROJECT # 2202_ KITCHEN DESIGN C

NOTES: _____



815.814.2009

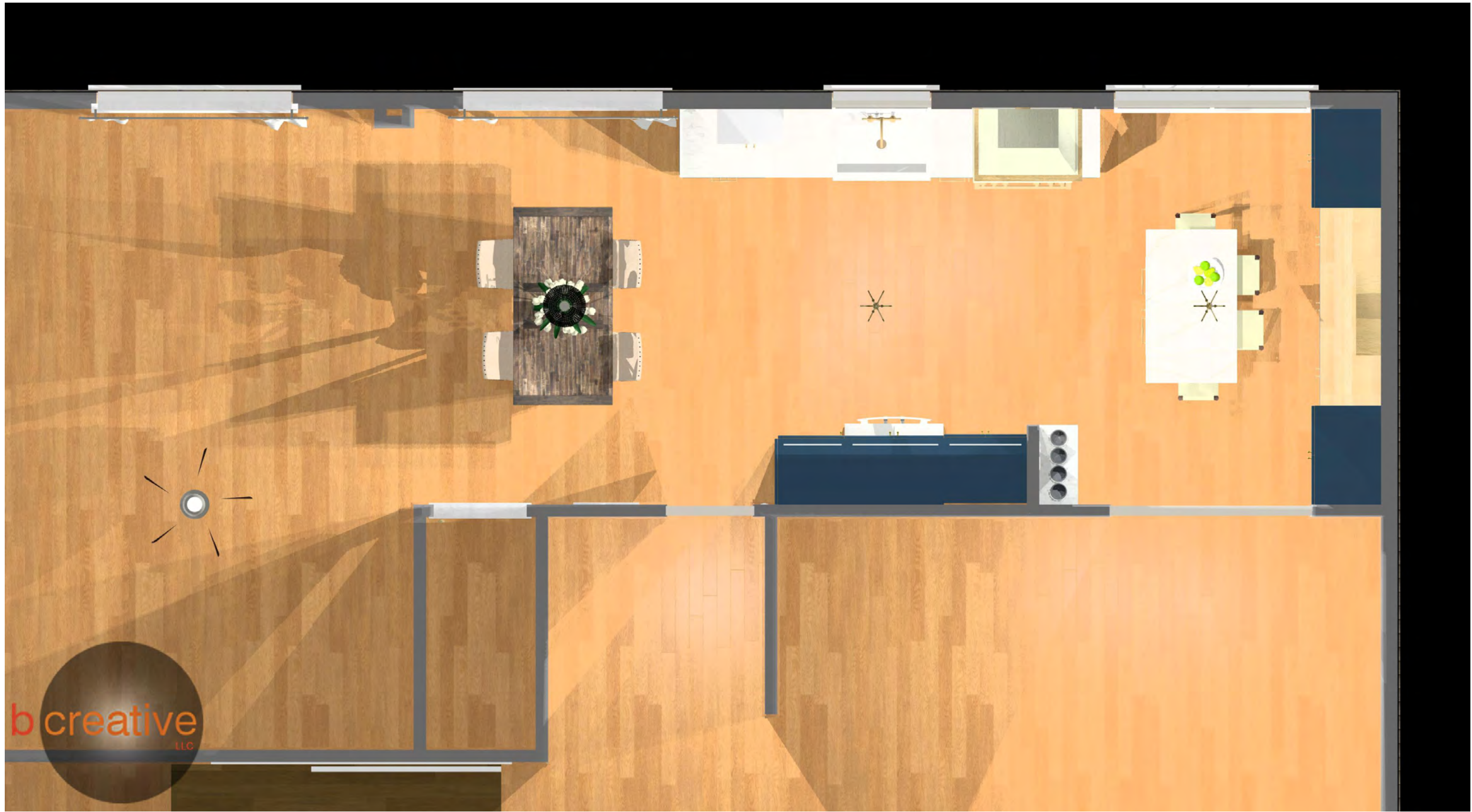

RENDERED FLOOR PLAN

PROJECT:

2202 KITCHEN
SHOREWOOD, IL 60404

DATE:

7/20/2022

SCALE:

N/A

SHEET:

01

PROJECT NOTE: These drawing are scope documents indicating the general project design concept, dimension of the project, major architectural elements, and basic organization of structural and mechanical, electrical, and plumbing systems. As scope documents, these drawings do not necessarily describe or indicate all materials or work required for full performance and completion of the project. On the basis of the general scope indicated or described, the general contractor shall furnish all items required for execution and completion of the proposed project and verify all dimensions in the field.

NOTES:



815.814.2009

PROJECT:
2202 KITCHEN
SHOREWOOD, IL 60404

DATE:

1/20/2022

SCALE:

N/A

SHEET:

02

PROJECT NOTE: These drawing are scope documents indicating the general project design concept, dimension of the project, major architectural elements, and basic organization of structural and mechanical, electrical, and plumbing systems. As scope documents, these drawings do not necessarily describe or indicate all materials or work required for full performance and completion of the project. On the basis of the general scope indicated or described, the general contractor shall furnish all items required for execution and completion of the proposed project and verify all dimensions in the field.



OVERVIEW

NOTES:



815.814.2009



PROJECT:

2202 KITCHEN
SHOREWOOD, IL 60404

DATE:

7/20/2022

SCALE:

N/A

SHEET:

03

PROJECT NOTE: These drawing are scope documents indicating the general project design concept, dimension of the project, major architectural elements, and basic organization of structural and mechanical, electrical, and plumbing systems. As scope documents, these drawings do not necessarily describe or indicate all materials or work required for full performance and completion of the project. On the basis of the general scope indicated or described, the general contractor shall furnish all items required for execution and completion of the proposed project and verify all dimensions in the field.

NOTES:



815.814.2009



PROJECT:

2202 KITCHEN
SHOREWOOD, IL 60404

DATE:

7/20/2022

SCALE:

N/A

SHEET:

04

PROJECT NOTE: These drawing are scope documents indicating the general project design concept, dimension of the project, major architectural elements, and basic organization of structural and mechanical, electrical, and plumbing systems. As scope documents, these drawings do not necessarily describe or indicate all materials or work required for full performance and completion of the project. On the basis of the general scope indicated or described, the general contractor shall furnish all items required for execution and completion of the proposed project and verify all dimensions in the field.

NOTES: _____



815.814.2009



PROJECT:

2202 KITCHEN
SHOREWOOD, IL 60404

DATE:

7/20/2022

SCALE:

N/A

SHEET:

05

PROJECT NOTE: These drawing are scope documents indicating the general project design concept, dimension of the project, major architectural elements, and basic organization of structural and mechanical, electrical, and plumbing systems. As scope documents, these drawings do not necessarily describe or indicate all materials or work required for full performance and completion of the project. On the basis of the general scope indicated or described, the general contractor shall furnish all items required for execution and completion of the proposed project and verify all dimensions in the field.

NOTES:



815.814.2009



PROJECT:

2202 KITCHEN
SHOREWOOD, IL 60404

DATE:

7/20/2022

SCALE:

N/A

SHEET:

06

PROJECT NOTE: These drawing are scope documents indicating the general project design concept, dimension of the project, major architectural elements, and basic organization of structural and mechanical, electrical, and plumbing systems. As scope documents, these drawings do not necessarily describe or indicate all materials or work required for full performance and completion of the project. On the basis of the general scope indicated or described, the general contractor shall furnish all items required for execution and completion of the proposed project and verify all dimensions in the field.

NOTES:



815.814.2009



PROJECT:

2202 KITCHEN
SHOREWOOD, IL 60404

DATE:

7/20/2022

SCALE:

N/A

SHEET:

07

PROJECT NOTE: These drawing are scope documents indicating the general project design concept, dimension of the project, major architectural elements, and basic organization of structural and mechanical, electrical, and plumbing systems. As scope documents, these drawings do not necessarily describe or indicate all materials or work required for full performance and completion of the project. On the basis of the general scope indicated or described, the general contractor shall furnish all items required for execution and completion of the proposed project and verify all dimensions in the field.

NOTES:



815.814.2009



PROJECT:

2202 KITCHEN
SHOREWOOD, IL 60404

DATE:

7/20/2022

SCALE:

N/A

SHEET:

08

PROJECT NOTE: These drawing are scope documents indicating the general project design concept, dimension of the project, major architectural elements, and basic organization of structural and mechanical, electrical, and plumbing systems. As scope documents, these drawings do not necessarily describe or indicate all materials or work required for full performance and completion of the project. On the basis of the general scope indicated or described, the general contractor shall furnish all items required for execution and completion of the proposed project and verify all dimensions in the field.

NOTES: _____



815.814.2009



PROJECT:

2202 KITCHEN
SHOREWOOD, IL 60404

DATE:

7/20/2022

SCALE:

N/A

SHEET:

09

PROJECT NOTE: These drawing are scope documents indicating the general project design concept, dimension of the project, major architectural elements, and basic organization of structural and mechanical, electrical, and plumbing systems. As scope documents, these drawings do not necessarily describe or indicate all materials or work required for full performance and completion of the project. On the basis of the general scope indicated or described, the general contractor shall furnish all items required for execution and completion of the proposed project and verify all dimensions in the field.

NOTES:



815.814.2009



PROJECT:

2202 KITCHEN
SHOREWOOD, IL 60404

DATE:

7/20/2022

SCALE:

N/A

SHEET:

10

PROJECT NOTE: These drawing are scope documents indicating the general project design concept, dimension of the project, major architectural elements, and basic organization of structural and mechanical, electrical, and plumbing systems. As scope documents, these drawings do not necessarily describe or indicate all materials or work required for full performance and completion of the project. On the basis of the general scope indicated or described, the general contractor shall furnish all items required for execution and completion of the proposed project and verify all dimensions in the field.

NOTES:



815.814.2009

PROJECT:
2202 KITCHEN
SHOREWOOD, IL 60404

DATE:

7/20/2022

SCALE:

N/A

SHEET:

12

PROJECT NOTE: These drawing are scope documents indicating the general project design concept, dimension of the project, major architectural elements, and basic organization of structural and mechanical, electrical, and plumbing systems. As scope documents, these drawings do not necessarily describe or indicate all materials or work required for full performance and completion of the project. On the basis of the general scope indicated or described, the general contractor shall furnish all items required for execution and completion of the proposed project and verify all dimensions in the field.

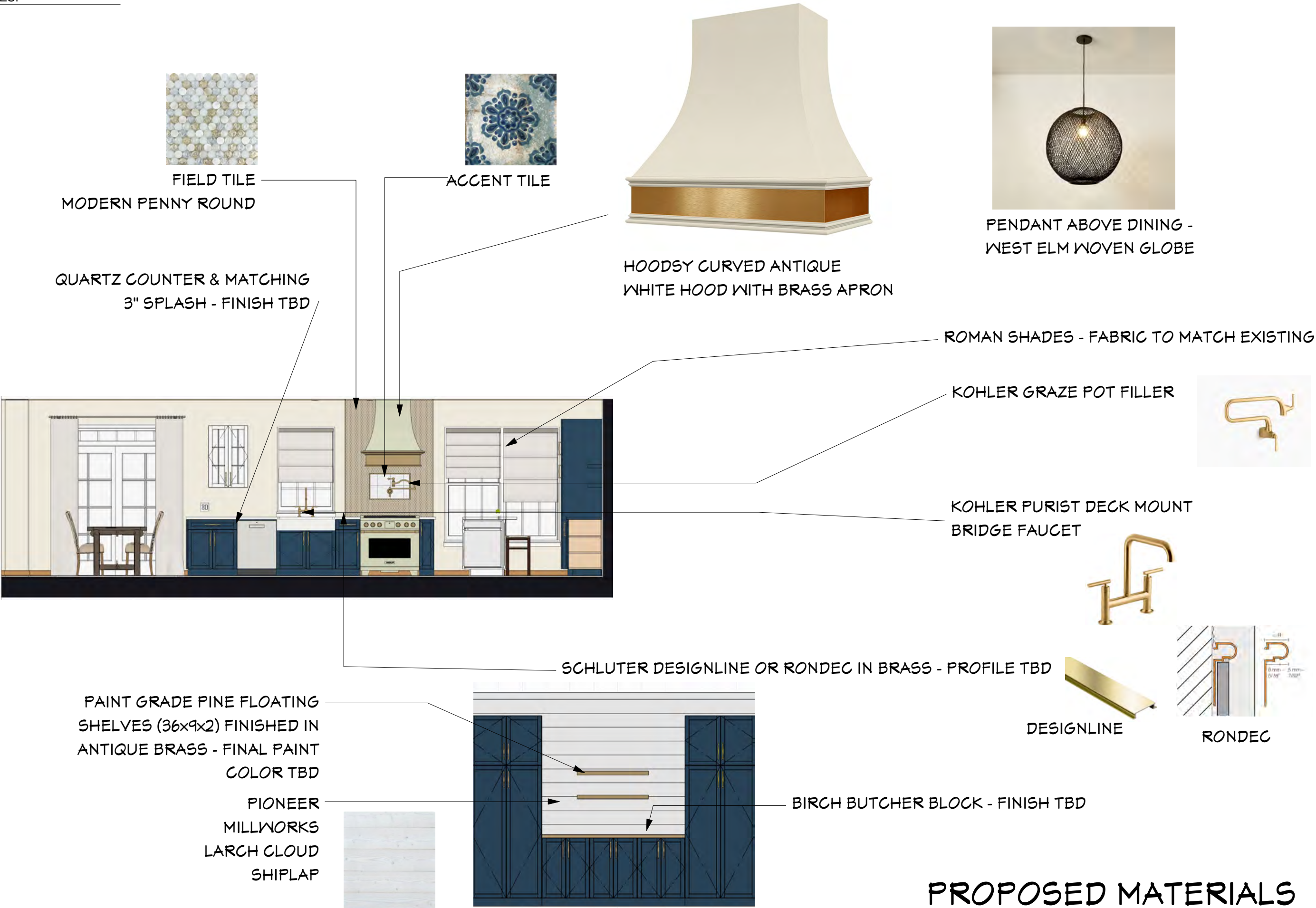

PROPOSED MATERIALS

NOTES:



815.814.2009

PROJECT:

2202 KITCHEN
SHOREWOOD, IL 60404

DATE:

7/20/2022

SCALE:

1/4"=1'-0"

SHEET:

A-1

PROJECT NOTE: These drawing are scope documents indicating the general project design concept, dimension of the project, major architectural elements, and basic organization of structural and mechanical, electrical, and plumbing systems. As scope documents, these drawings do not necessarily describe or indicate all materials or work required for full performance and completion of the project. On the basis of the general scope indicated or described, the general contractor shall furnish all items required for execution and completion of the proposed project and verify all dimensions in the field.

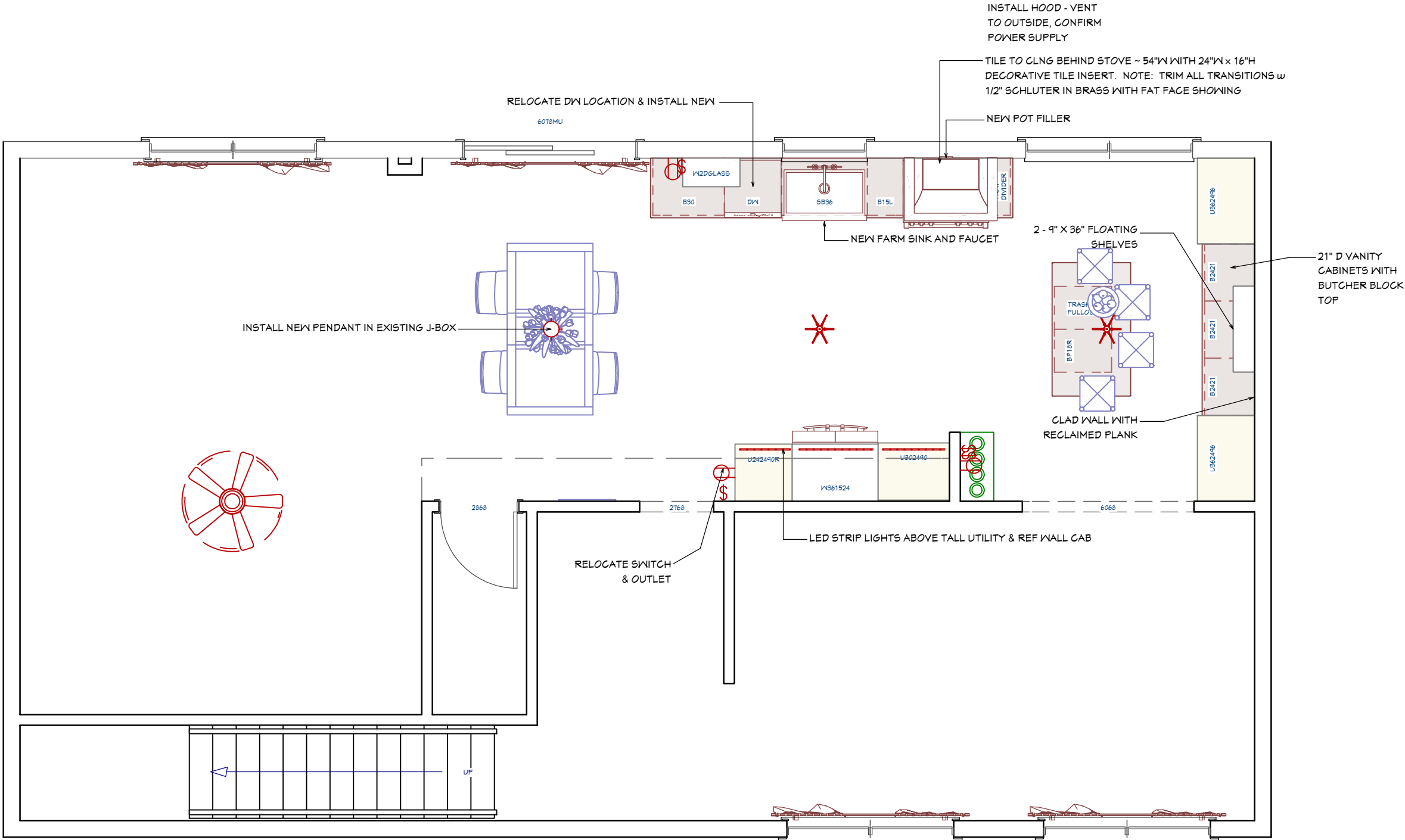

FLOOR PLAN