

R-BAT^{plus} REFERENCE GUIDE

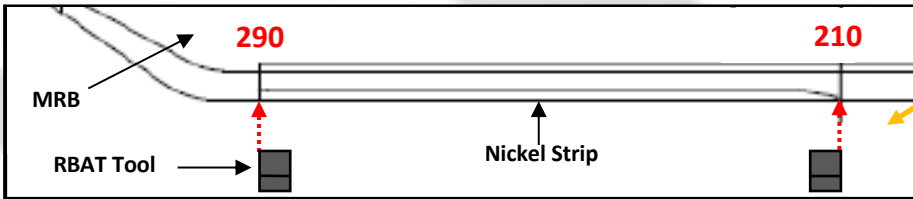

Part #: UPT-RBAT-002 CAGE #:3EV52 **FOR USE ON H-60M Main Rotor Blades Only!**



Measurement Locations
Align outside of RBAT tool with edge of nickel strip at Station 290 and 210 on leading edge MRBs. If a protective "taco" patch is located at 210 do not measure.



Measurement/Location Button

- Press and hold for 3 seconds to enter Calibration mode
- Single quick click for outboard 290 "-ob-" measurement
- Two quick clicks for inboard 210 "-ib-" measurement location



Measurement Screen

- **"-ob-" flashing:** Ready to make 290 (-ob-) measurement location
- **"-ob-" steady:** Measuring at 290 (-ob-) location
- **"-ib-" flashing:** Ready to make 210 (-ob-) measurement location
- **"-ib-" steady:** Measuring at 210 (-ib-) location
- **"cAL" flashing:** Unit is ready for calibration mode
- **"cAL" steady on:** Unit is calibrating
- **"good":** Calibration was completed successfully
- **"redo":** Measurement greater than 0.040" or less than 0.001". Retest blade. If no change, recalibrate unit
- **"batt"** Battery is low recharge before continuing
- **Displayed number is thickness of nickel in mils (0.00X")** Range is 1-40 mils

Charging Port
Uses standard USB micro cable.
Charging Time:
Up to 4 hours

Green -Yellow -Red LEDs
Blinks battery charge level on start-up and in sleep mode.
Shows nickel measurement rating for maintenance
Note: Maintenance ranges are listed below

Charging Light
On during charging. Will not light when battery is fully charged



System Kit
Contains RBAT, Tablet, Charger, Calibration Tool, & Instruction Guide

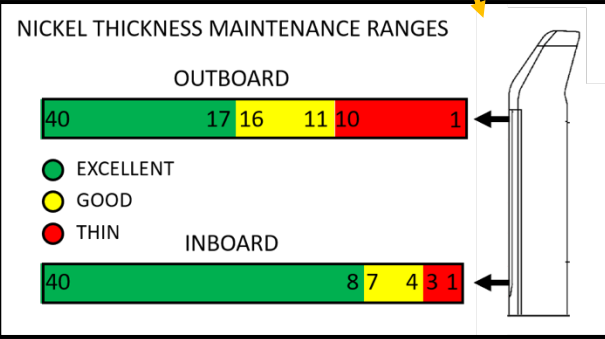

Operating Instruction Guide
Follow these instructions for R-BAT usage

RBAT Calibration Instructions

1. Power on RBAT.
2. Set RBAT in measurement environment for 5 min.
3. Press and hold **Measurement Button** for 3 seconds. "cAL" will begin to flash on screen.
4. Place R-BAT CAL tool in measurement position and press **Measurement Button** once. Steady "cAL" will be displayed on screen.
5. After 1-2 min. "good" will appear on screen.
6. Remove CAL tool to begin measurements.

Note: If "good" does not appear, contact RBEP team



TABLET INFO – SEE PAGE 2



R-BAT_{plus} REFERENCE GUIDE



Part #: UPT-RBAT-002 CAGE #:3EV52 FOR USE ON H-60M Main Rotor Blades Only!

Home Screen

Buttons for:

- Help
- Bluetooth
- Inspection
- Blade Log

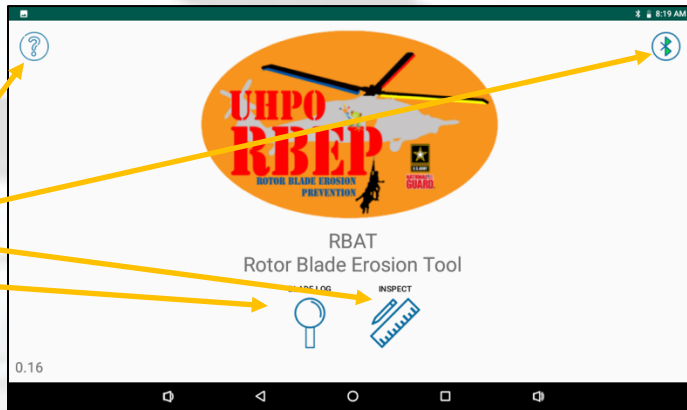

On/Off Switch

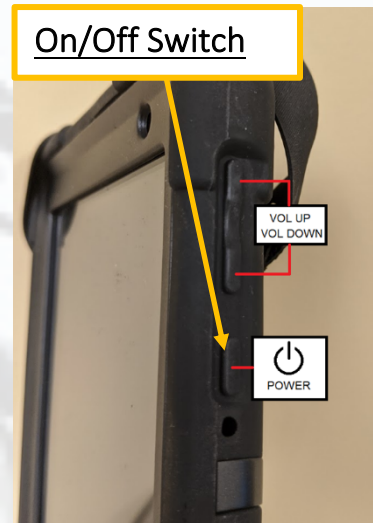

Help – Access to reference guide, training videos and troubleshooting.
Bluetooth – Green indicates that communication with the R-BAT. If the Bluetooth symbol is red, cycle the R-BAT unit power until the symbol turns to green, or enter the tablet settings to ensure that Bluetooth communication is turned on.
Inspection – Data entry for blade inspections and nickel strip measurements.
Blade Log – Search and review previous measurements and inspection data.



Charge Port

Inspection Screens

Begin Inspection Survey

Blade Selection

Pre-Inspection

Measure

Review

[Reference Guide](#)
[User Guide](#)
[Reference Guide](#)
[Troubleshooting](#)

Blade Log Screens

Blade Search

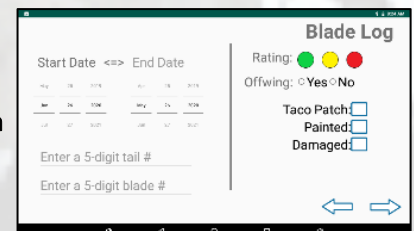

Blade Results

Date	Tail #
07May20 14:13:18	20111
05May20 16:01:20	20111
05May20 14:46:12	20111
05May20 14:38:56	20111
01May20 10:53:37	20111

Survey

Date	Outboard	Inboard
07May20 14:13:18	3	16
05May20 16:01:20	22	14
05May20 14:46:12	23	7
05May20 14:38:56	17	5
01May20 10:53:37	17	5

RBAT INFO – SEE PAGE 1

For more information call 877-552-8744 or email info@rbepteam.org

