

# Baby Rest Slim WA Users Manual

Please read this users manual carefully and use accordingly.  
Please keep this manual for future reference.

## Safety Warnings

Safety precautions noted here are divided into “warnings” and “cautions” according to the urgency and seriousness of the harm and damage that may occur. Please read this instruction manual carefully before use, and observe the safety precautions.

	<b>WARNINGS</b> If this label is ignored or mishandled, there is risk of serious injury or death.
	<b>CAUTIONS</b> If this label is ignored or mishandled, there is risk of injury or property damage.
	These illustrations demonstrate what should not be done with the Baby Rest Slim WA.
	These illustrations demonstrate the correct way to use the Baby Rest Slim WA.

## Proper Usage

<b>WARNINGS</b> <b>Keep watch</b> <b>Never leave</b> <b>Do not allow to play</b>	<b>CAUTIONS</b> <b>Flammables</b>
---	--------------------------------------

<b>Age limitation</b>	Infants from 5 months to 2 and a half years of age (15kg or less)	<b>Max. load</b>	300N (30kgf)
-----------------------	---	------------------	--------------

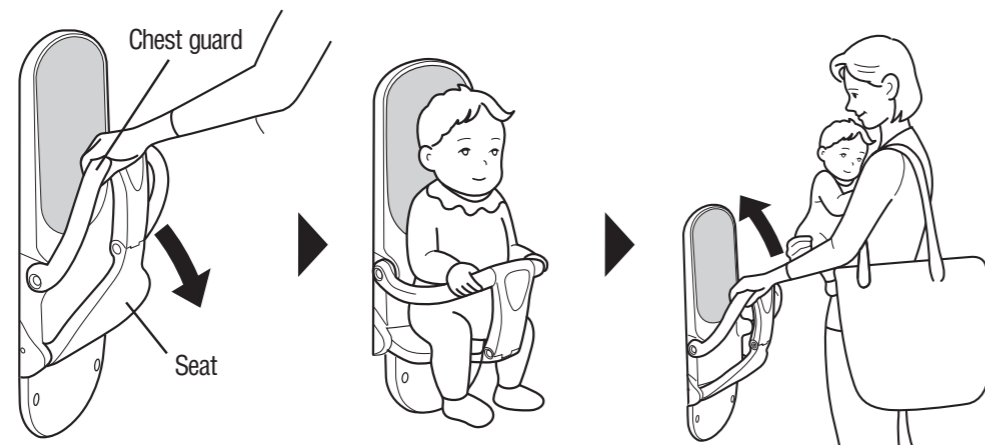

- ① Pull the chest guard forward. The seat will open.
- ② Be sure to hold the child to place in the seat firmly.
- ③ Make sure to close the seat after use.

\*The Combi Group follow environmental friendly business practices based on ISO 14000 Certification Guidelines.  
Please dispose of your Baby Rest Slim WA using proper waste management methods.

## Name and Dimensions

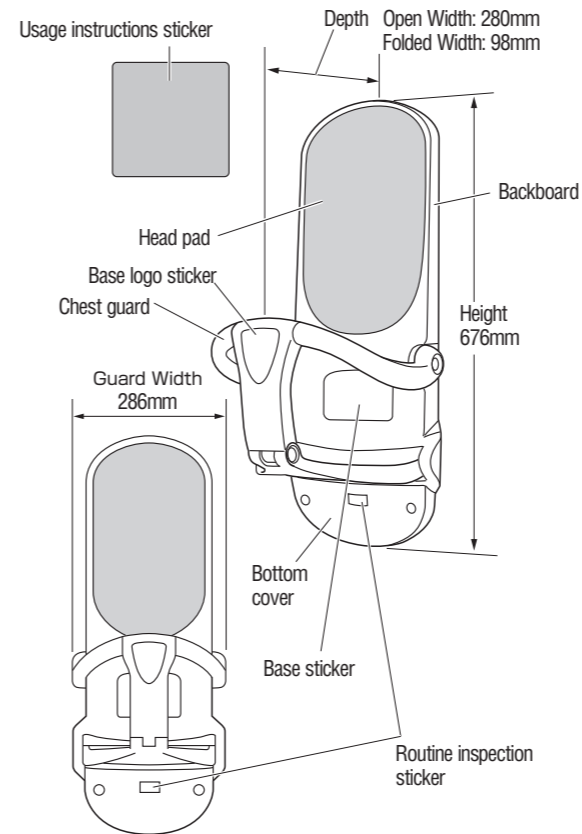

## For Safety Check

**WARNING** In order to use our product safely, better to do daily checks and annual inspections. Injury or serious accident could occur if safety inspections are not performed and/or problems with the product are not observed.

**The daily or weekly inspection should be done by both eyes and hands. No tools are necessary.**

### 1. Physical Inspection

1. Check for loose parts
2. Make sure the base does not wobble or shake, and that the guard is firmly in place
3. Check for scratches or broken parts

### 2. Checking the Guard's Mobility

1. Insure that the guard is firmly in place, does not wobble or shake, and moves from left to right.
2. After testing the opening and closing function of the guard several times, insure that neither the base nor the guard wobbles or shakes.

### 3. Sticker Check

Stickers and decals should be firmly adhered and legible. Check for scratches, rips, missing stickers, or fadedness.

### 4. Head and Seat Pad Check

Check for scratches and broken parts. Make sure the head and seat pads do not wobble or shake.

**If a problem is found during the inspection, immediately stop using it, and contact your dealer for assistance.**

**For more information regarding the maintenance inspection (at charge bases) and repair parts (at charge bases).**

- Main maintenance parts include pads and decals.
- Product durable period is 7 years. Repair Parts available within 5 years after end of production.

## Maintenance

- This product is designed for children to sit in. After installation, clean periodically.
- Use a watered-down mild detergent to clean product, then dry thoroughly.

**CAUTION** Do not use cleaners other than neutral detergents. Using other cleaners may compromise the integrity of the plastic parts of the product, or cause fading, cracks, and other physical damage.

## Technical Specifications

<b>Product Number</b>	BK-W62WH, BK-W63WH
<b>Product Name</b>	Baby Rest Slim WA
<b>Dimension</b>	W286×D98(Open Width:D280)×H676mm
<b>Nett weight</b>	4.6kg
<b>Materials</b>	•Base/ABS resin, steel •Head pad/frame: ABS resin, Cushion: urethane foam, Surface: Synthetic leather (urethane leather)

\*Be advised that technical specifications for this product may change without notice for reasons such as improvement in design.

\*For information on products, contact the distribution agency.

Manufacturer **Combi Corporation**  
2-6-7, Motoasakusa, Taito-ku, Tokyo 111-0041 Japan

Distributor **CombiWith Corporation**  
Head Office/2-6-7, Motoasakusa, Taito-ku, Tokyo 111-0041 Japan  
TEL : 81-3-5828-7631 FAX : 81-3-5828-7630  
www.combiwith.co.jp/