

XVM

Vertical, Multi-Staged Stainless Steel Pumps



FEATURES

- The XVM pump is a non-self-priming vertical multistage centrifugal pump coupled to a standard motor.
- Inlet and outlet are located at the bottom at the same plane (in-line type)
- All pumps are equipped with maintenance free mechanical seal set of the cartridge type.
- Motor: Squirrel cage in short circuits, enclosed construction with external ventilation (fan-cooled)
- Insulation Class: F, IP 55 Protection
- Maximum liquid temperature: 110°C
- Maximum ambient temperature: 40°C

If the ambient temperature exceeds this level, or the pump is installed an altitude exceeding 1000 meters, the motor must not be fully loaded due to risk of overheating.

Overheating may result from excessive ambient temperatures of the low density and consequently low cooling effect of the air. In such cases, it may be necessary to use a motor with a higher rated output.

- Direction of rotation
Counter-clockwise looking at the pump from the top down (for XVM 1, 3, 5, 10, 15, 20). Counter-clockwise looking at the pump from the top down (for XVM 32, 45, 64, 90)
- Maximum pressure: 25 Bar

APPLICATIONS

- Handling of water, free of suspended solids, in the civil, industrial and agricultural sectors
- Pressure boosting and water supply systems
- Irrigation systems
- Wash systems
- Water treatment plants
- Handling of moderately aggressive liquids, demineralized water, water and glycol, etc.
- Circulation of hot and cold water for heating, cooling and conditioning systems
- Boiler feed
- Pharmaceutical food & beverage industries

WATER SUPPLY AND PRESSURE BOOSTING

- Pressure boosting in building, hotel, and residential complexes
- Pressure booster stations, supply of water networks
- Booster packages

WATER TREATMENT

- Ultrafiltration and reverse osmosis systems
- Water softeners and de-mineralization
- Distillation systems and Filtration

LIGHT INDUSTRY

- Washing and cleaning plants (washing and degreasing of mechanical parts, car and truck wash tunnels, washing of electronic industry circuits).
- Commercial washers
- Firefighting system pumps

PHARMACEUTICAL AND FOOD & BEVERAGE INDUSTRIES

- Production plant where specific sanitary standards are required

IRRIGATION AND AGRICULTURE

- Greenhouses, humidifiers, sprinkler irrigation

HEATING, VENTILATION AND AIR CONDITIONING (HVAC)

- Cooling towers and systems
- Temperature control systems
- Refrigerators
- Induction heating
- Heat exchangers. Boilers, water recirculation and heating

Most Commonly Used Liquids

- Cutting Fluid (100 %)
- Deionized, Demineralized Water (100 %)
- Clean Water (100 %)
- Cleaning Products (5 %)
- Diathermic Oil (100 %)
- Emulsion oil and water (any)
- Ethylene glycol (20 %)
- Glycerin (100 %)
- Hydraulic Oil (100 %)
- Mineral Oil (100 %)
- Caustic Soda (20 %) (100 %)
- Vegetable Oil (particle-free) (100 %)
- Water condensate (100 %)
- Benzoic Acid (50 %)
- Citric Acid (5 %)
- Acetic Acid (80 %)

XVM

Vertical, Multi-Staged Stainless Steel Pumps



Mechanical Seal Sample for XVM 1-3-5-10-15-20



Mechanical Seal Sample for XVM 32-45-64-90



XVM 1-3-5-10-15-20 series have threaded connections as standard



XVM 32-45-64-90 series have flanged connections as standard

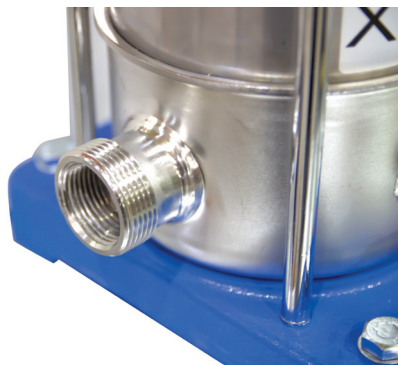

XVM 1-3-5 series have both internal and external threaded connections

XVM

Vertical, Multi-Staged Stainless Steel Pumps

Model	P2	3 PH 400 V A	Motor Flange Type	l/min Q m ³ /h	6,6	10	13,3	16,6	20	23,3	26,6	30	33,3	36,6	
	kW				0,4	0,6	0,8	1	1,2	1,4	1,6	1,8	2	2,2	
XVM 1-2	0,37	1	B14	H (m)	12	11,8	11,5	11	11	10,5	9,8	9,2	8,5	7,8	
XVM 1-3	0,37	1	B14		17,5	17	16,8	16,5	16	15,5	14	13,5	12	10,5	
XVM 1-4	0,37	1	B14		23,5	23	22,5	22	21	20,5	18,5	18	16,5	14	
XVM 1-5	0,37	1	B14		29	28,5	28	27,5	26,5	26	24	23	20,5	17,5	
XVM 1-6	0,37	1	B14		35	34,5	34	33	32	31	28	27	25	22	
XVM 1-7	0,37	1	B14		41	40	39	38,5	37	35	33	32	29	25	
XVM 1-8	0,55	1,5	B14		46,5	46	45,5	44	42	40	38	36	33	29	
XVM 1-9	0,55	1,5	B14		52	51,5	51	49,5	47,5	46	44	41	37	34	
XVM 1-10	0,55	1,5	B14		58	57,5	57	56	54	52	48	46	41,5	37	
XVM 1-11	0,55	1,5	B14		65	63	62,5	61	59	56	54	50	46	40	
XVM 1-12	0,75	1,7	B14		70	69	68	66	64	62	58	55	49	43	
XVM 1-13	0,75	1,7	B14		75	74,5	74	72	69	66	63	59	54	47	
XVM 1-15	0,75	1,7	B14		87	86	85	84	80,5	77	72	68	62	53	
XVM 1-17	1,1	2,6	B14		99	97,5	97	95	91	87	81,5	77	69	59	
XVM 1-19	1,1	2,6	B14		110,5	109	108	106	101	97	91	86	78	66	
XVM 1-21	1,1	2,6	B14		122	120,5	119,5	116	112	108	101	95	86	73	
XVM 1-23	1,1	2,6	B14		135	132,5	130	126	122	117	111	104	94	80	
XVM 1-25	1,5	3,4	B14		147	144	141	138	133	128	121	114	103	87	
XVM 1-27	1,5	3,4	B14		158	156	154	150	144	138	130	121	112	96	
XVM 1-30	1,5	3,4	B14		175	173	171	166	160	154	145	136	124	108	
XVM 1-33	2,2	4,5	B14	193	191	188	183	176	170	160	150	136	120		
XVM 1-36	2,2	4,5	B14	212	209	205	200	192	184	174	164	150	133		

Model	P2	3 PH 400 V A	Motor Flange Type	l/min Q m ³ /h	20	26,6	33,3	40	46,6	50	53,3	56,6	60	66,6	
	kW				1,2	1,6	2	2,4	2,8	3	3,2	3,4	3,6	4	
XVM 3-2	0,37	1	B14	H (m)	12	11,3	10,5	10	9	8,5	8	7,5	7	6	
XVM 3-3	0,37	1	B14		18	17	16	15	14	13	12	11	10	8	
XVM 3-4	0,37	1	B14		24	23	21,5	20	18,5	17,5	16,5	15	13,5	11	
XVM 3-5	0,37	1	B14		30	28,5	27	25	23	22	20,5	19	17,5	14	
XVM 3-6	0,55	1,5	B14		36	34	32	30	28	26	24	22	20	16,5	
XVM 3-7	0,55	1,5	B14		42	40,5	39	36	33	30,5	28,5	26	24	19,5	
XVM 3-8	0,75	1,7	B14		48	46	44	41	37	35	32,5	30	27	22,5	
XVM 3-9	0,75	1,7	B14		53	51	49	46	41,5	39	37	34	32	26	
XVM 3-10	0,75	1,7	B14		59	57	55	51	46	43	41	37	34	28	
XVM 3-11	1,1	2,6	B14		65	62,5	60	56	51	48	45	42	38	30,5	
XVM 3-12	1,1	2,6	B14		71	68	66	61	55	52	49	45,5	42	34	
XVM 3-13	1,1	2,6	B14		77	74	71	66	60	57	53	50	46	37	
XVM 3-15	1,1	2,6	B14		88	85	82	77	72	68,5	64	60	55	44	
XVM 3-17	1,5	3,4	B14		100	97	93	88	83	79	74	69	64	52	
XVM 3-19	1,5	3,4	B14		112	108	104	98	92	88	83	77	71	58	
XVM 3-21	2,2	4,5	B14		123	119	115	108	102	97	92	86	79	65	
XVM 3-23	2,2	4,5	B14		134	130	125	119	110	105	100	94	86	72	
XVM 3-25	2,2	4,5	B14		146	141	135	128	118	113	108	102	94	79	
XVM 3-27	2,2	4,5	B14		158	152	146	138	129	123	117	110	103	86	
XVM 3-29	2,2	4,5	B14		169	163	156	147	137	132	125	118	111	93	
XVM 3-31	3	6	B14	180	174	167	157	147	141	134	126	118	100		
XVM 3-33	3	6	B14	191	186	178	168	157	150	143	135	127	108		
XVM 3-36	3	6	B14	209	203	194	184	173	166	159	151	143	122		

XVM

Vertical, Multi-Staged Stainless Steel Pumps

Model	P2	3 PH 400 V A	Motor Flange Type	l/min Q m ³ /h	33,3	50	66,6	75	83,3	91,6	100	108,3	116,6	125	133,3
	kW				2	3	4	4,5	5	5,5	6	6,5	7	7,5	8
XVM 5-2	0,37	1	B14	H (m)	14	13	12	11,5	11	10	9	8	7,5	6,5	6
XVM 5-3	0,55	1,5	B14		19	18	16,5	15,5	15	14	13	12	11	9	8
XVM 5-4	0,55	1,5	B14		24,5	23	22,5	21	20	18,5	17	15,5	14	12,5	11
XVM 5-5	0,75	1,7	B14		30,5	29	27	26	24,5	23	21,5	20	17,5	16	14
XVM 5-6	1,1	2,6	B14		37	35	33	31,5	30	28	26	24	22	20	18
XVM 5-7	1,1	2,6	B14		43	41	39	37	35	33	31	28	26	24	21
XVM 5-8	1,1	2,6	B14		49	47	44	42	40	38	36	32	30	27	24
XVM 5-9	1,5	3,4	B14		56	53	50	47,5	45	42,5	40	37	33,5	30,5	27
XVM 5-10	1,5	3,4	B14		62	59	55	53	50	47	44	41	37	34	30
XVM 5-11	2,2	4,5	B14		68,5	65,5	61,5	59	56	52	49	45	41	37	33
XVM 5-12	2,2	4,5	B14		75	72,5	68	65	62	58	54	49	45	40,5	36
XVM 5-13	2,2	4,5	B14		81,5	79	74	71	68	64	59,5	54	49	44	39
XVM 5-14	2,2	4,5	B14		89	85	81	77	74	69	65	59	54	48	42
XVM 5-15	2,2	4,5	B14		96	93	88	84	80	75	70	64	59	52	45
XVM 5-16	2,2	4,5	B14		103	100	94	90	85	80	75	69	63	56	48
XVM 5-18	3	6	B14		115	110	104	100	96	90	85	78	71	63	54
XVM 5-20	3	6	B14		129	122	115	109	105	99	94	86	78	70	60
XVM 5-22	4	7,1	B14		139	134	126	121	116	110	103	95	87	77	66
XVM 5-24	4	7,1	B14		152	146	138	133	127	120	113	105	96	84	72
XVM 5-26	4	7,1	B14		164	158	150	144	138	131	122	114	104	91	78
XVM 5-29	4	7,1	B14		185	177	168	164	157	150	141	132	119	103	87
XVM 5-32	5,5	10,9	B14		205	197	189	183	176	166	158	147	134	114	96
XVM 5-36	5,5	10,9	B14		230	222	212	205	198	188	177	166	154	133	108

Model	P2	3 PH 400 V A	Motor Flange Type	l/min Q m ³ /h	33,3	66,6	100	133,3	166,6	200	233,3					
	kW				2	4	6	8	10	12	14					
XVM 10-1	0,37	1	B14	H (m)	13	12	11	9,5	8,5	7	6					
XVM 10-2	0,75	1,7	B14		23	22	20	18	16	13	10					
XVM 10-3	1,1	2,6	B14		33	32	31	28	25	21	16					
XVM 10-4	1,5	3,4	B14		43	42	40	37	32	27	20					
XVM 10-5	2,2	4,5	B14		53	51	48	44	39	32	24					
XVM 10-6	2,2	4,5	B14		62	61	58	53	46	38	28					
XVM 10-7	3	6	B14		73	72	67	61	54	43	32					
XVM 10-8	3	6	B14		83	81	78	71	62	51	37					
XVM 10-9	3	6	B14		93	91	87	81	71	59	42					
XVM 10-10	4	7,1	B14		104	101	98	91	81	67	47					
XVM 10-12	4	7,1	B14		123	121	117	108	95	78	55					
XVM 10-14	5,5	10,9	B14		143	141	136	124	110	90	63					
XVM 10-16	5,5	10,9	B14		163	161	154	143	125	102	71					
XVM 10-18	7,5	13,8	B5		183	179	173	161	144	118	82					
XVM 10-20	7,5	13,8	B5		202	198	191	180	160	133	93					
XVM 10-22	7,5	13,8	B5		222	217	209	198	178	149	106					

XVM

Vertical, Multi-Stage Stainless Steel Pumps

Model	P2	3 PH 400 V A	Motor Flange Type	l/min Q m ³ /h	133,3	166,6	200	233,3	250	266,6	300	333,3	366,6	400		
	kW				8	10	12	14	15	16	18	20	22	24		
XVM 15-1	1,1	2,6	B14	H (m)	14	13	12	11,5	11	10,5	10	9	8	7		
XVM 15-2	2,2	4,5	B14		26	25	24	23	22	21	20	18	16	14		
XVM 15-3	3	6	B14		39	38	37	34	33	31	29	27	24	20		
XVM 15-4	4	7,1	B14		52	50	48	46	44	43	40	36	31	26		
XVM 15-5	4	7,1	B14		66	64	61	58	56	54	50	45	39	33		
XVM 15-6	5,5	10,9	B14		80	78	75	70	67	65	60	54	47	41		
XVM 15-7	5,5	10,9	B14		94	92	88	83	80	78	71	64	56	50		
XVM 15-8	7,5	13,8	B5		108	105	101	96	93	90	83	75	66	57		
XVM 15-9	7,5	13,8	B5		122	119	115	109	106	103	95	87	77	66		
XVM 15-10	11	20	B5		136	133	128	123	120	116	107	98	86	76		
XVM 15-12	11	20	B5		158	155	150	144	140	135	126	116	102	89		
XVM 15-14	11	20	B5		183	178	172	165	162	156	145	133	118	103		
XVM 15-16	15	26,9	B5		210	204	197	190	185	179	168	153	137	118		
XVM 15-17	15	26,9	B5		224	218	212	203	198	193	181	166	151	129		

Model	P2	3 PH 400 V A	Motor Flange Type	l/min Q m ³ /h	133,3	166,6	200	233,3	266,6	300	333,3	400	433,3	466,6		
	kW				8	10	12	14	16	18	20	24	26	28		
XVM 20-1	1,1	2,6	B14	H (m)	14	13,5	13	12,5	12	11,5	10,5	9	8	7		
XVM 20-2	2,2	4,5	B14		28	27	26	25	24	22,5	21	18	16	14		
XVM 20-3	4	7,1	B14		41	40	39	38	36	34	32	27	24	21		
XVM 20-4	5,5	10,9	B14		54	53	52	51	50	46	43	36	32	27		
XVM 20-5	5,5	10,9	B14		68	67	65	63	61	58	55	45	40	33		
XVM 20-6	7,5	13,8	B5		82	80	78	77	73	70	66	55	48	40		
XVM 20-7	7,5	13,8	B5		96	94	92	89	86	82	77	65	58	47		
XVM 20-8	11	20	B5		110	107	104	102	99	95	89	76	67	56		
XVM 20-10	11	20	B5		137	135	132	128	124	118	112	98	86	73		
XVM 20-12	15	26,9	B5		164	162	158	154	149	142	136	118	106	90		
XVM 20-14	15	26,9	B5		191	189	186	181	176	169	161	140	126	110		
XVM 20-16	18,5	33,2	B5		219	217	214	208	203	195	186	164	147	129		
XVM 20-17	18,5	33,2	B5		234	231	228	223	217	210	202	178	162	142		

XVM

Vertical, Multi-Staged Stainless Steel Pumps

Model	P2	3 PH 400 V A	Motor Flange Type	l/min Q m ³ /h	200	266,6	333,3	400	466,6	500	533,3	600	666,6		
	kW				12	16	20	24	28	30	32	36	40		
XVM 32-1-1	1,5	3,4	B14	H (m)	14,5	14	13	12	11	10,5	10	9	7		
XVM 32-1	2,2	4,5	B14		19	18	16,5	15,5	14,5	14	13	11,5	9,5		
XVM 32-2-2	3	6	B14		30	28	26	24	22	21	19	16	14		
XVM 32-2	4	7,1	B14		36	34	32	30	27	26	24	21	17		
XVM 32-3-2	4	7,1	B14		48	45	42	39	36	34	32	27	21		
XVM 32-3	5,5	10,9	B14		54	52	49	46	42	39	37	31	25		
XVM 32-4-2	7,5	13,8	B5		66	63	59	55	50	47	44	38	29		
XVM 32-4	7,5	13,8	B5		72	69	66	62	56	53	50	42	34		
XVM 32-5-2	11	20	B5		84	80	76	71	64	61	57	48	37		
XVM 32-5-2	11	20	B5		91	87	83	78	71	66	62	53	42		
XVM 32-6-2	11	20	B5		101	97	92	87	79	75	70	59	47		
XVM 32-6	11	20	B5		109	105	101	95	87	83	77	65	52		
XVM 32-7-2	15	26,9	B5		119	115	110	105	96	90	84	71	57		
XVM 32-7	15	26,9	B5		127	123	118	112	103	97	91	78	61		
XVM 32-8-2	15	26,9	B5		136	132	127	120	110	104	97	82	66		
XVM 32-8	15	26,9	B5		143	139	134	126	117	111	104	88	70		
XVM 32-9-2	18,5	33,2	B5		153	149	144	137	126	119	112	95	75		
XVM 32-9	18,5	33,2	B5		161	157	152	145	134	126	119	102	80		
XVM 32-10-2	18,5	33,2	B5		172	168	162	154	143	135	127	108	84		
XVM 32-10	18,5	33,2	B5		179	174	169	162	149	142	134	114	88		
XVM 32-11-2	22	38	B5		189	184	178	170	158	149	141	120	93		
XVM 32-11	22	38	B5		197	192	186	178	165	157	148	126	97		
XVM 32-12-2	22	38	B5		207	202	196	187	174	165	155	132	102		
XVM 32-12	22	38	B5		214	210	203	194	180	171	161	137	107		
XVM 32-13-2	30	52	B5		225	220	213	203	188	179	169	143	112		
XVM 32-13	30	52	B5		232	227	220	210	197	187	177	150	118		
XVM 32-14-2	30	52	B5		243	238	230	220	206	197	185	156	124		
XVM 32-14	30	52	B5		250	245	237	227	212	203	192	163	130		

XVM

Vertical, Multi-Stage Stainless Steel Pumps

Model	P2	3 PH 400 V A	Motor Flange Type	l/min Q m ³ /h	416,67	500	583,3	666,6	750	833,3	916,6					
	kW				25	30	35	40	45	50	55					
XVM 45-1-1	3	6	B14	H (m)	20	19	18	17	15	13	11					
XVM 45-1	4	7,1	B14		24	23	22	21	19	18	16					
XVM 45-2-2	5,5	10,9	B14		40	38	36	33	30	27	23					
XVM 45-2	7,5	13,8	B5		48	46	44	42	39	35	31					
XVM 45-3-2	11	20	B5		63	61	58	54	50	44	38					
XVM 45-3	11	20	B5		72	70	67	63	58	53	45					
XVM 45-4-2	15	26,9	B5		87	84	80	75	69	62	54					
XVM 45-4	15	26,9	B5		98	94	87	84	77	70	61					
XVM 45-5-2	18,5	33,2	B5		113	108	102	96	88	80	69					
XVM 45-5	18,5	33,2	B5		123	118	112	105	97	88	77					
XVM 45-6-2	22	38	B5		137	132	125	118	109	98	86					
XVM 45-6	22	38	B5		147	141	135	127	118	107	94					
XVM 45-7-2	30	52	B5		160	154	147	139	128	116	101					
XVM 45-7	30	52	B5		169	164	156	147	136	124	109					
XVM 45-8-2	30	52	B5		184	178	169	160	147	132	116					
XVM 45-8	30	52	B5		194	189	180	168	155	141	124					
XVM 45-9-2	30	52	B5		209	202	193	182	169	152	133					
XVM 45-9	37	64,6	B5		219	212	203	191	177	161	141					
XVM 45-10-2	37	64,6	B5		233	225	215	203	188	170	148					
XVM 45-10	37	64,6	B5		245	236	225	212	196	179	156					
XVM 45-11-2	45	77	B5		259	250	239	226	209	191	166					
XVM 45-11	45	77	B5	267	259	248	235	217	198	174						
XVM 45-12-2	45	77	B5	284	274	263	248	230	209	183						
XVM 45-12	45	77	B5	295	286	273	259	239	219	192						
XVM 45-13-2	45	77	B5	309	300	286	270	250	227	199						

XVM

Vertical, Multi-Staged Stainless Steel Pumps

Model	P2	3 PH 400 V A	Motor Flange Type	l/min Q m ³ /h	500	666	833	1000	1066	1166	1333					
	kW				30	40	50	60	64	70	80					
XVM 64-1-1	4	7,1	B14	H (m)	19	18	16	14	13	11,5	9					
XVM 64-1	5,5	10,9	B14		27	25	23	20	19	17	14					
XVM 64-2-2	7,5	13,8	B5		37	35	32	28	26	23	17					
XVM 64-2-1	11	20	B5		47	44	40	36	34	30	24					
XVM 64-2	11	20	B5		55	51	47	42	40	37	30					
XVM 64-3-2	15	26,9	B5		66	62	56	50	46	41	32					
XVM 64-3-1	15	26,9	B5		73	69	63	56	53	48	39					
XVM 64-3	18,5	33,2	B5		81	76	70	64	60	55	46					
XVM 64-4-2	18,5	33,2	B5		92	87	80	71	66	60	49					
XVM 64-4-1	22	38	B5		100	94	87	78	73	67	54					
XVM 64-4	22	38	B5		107	101	94	85	80	74	61					
XVM 64-5-2	30	52	B5		119	113	105	95	89	80	64					
XVM 64-5-1	30	52	B5		128	121	112	102	96	87	71					
XVM 64-5	30	52	B5		136	129	119	109	103	94	78					
XVM 64-6-2	30	52	B5		147	140	130	118	112	101	81					
XVM 64-6-1	37	64,6	B5		157	149	138	125	118	108	88					
XVM 64-6	37	64,6	B5		164	156	145	132	125	115	95					
XVM 64-7-2	37	64,6	B5		176	167	156	140	133	121	99					
XVM 64-7-1	37	64,6	B5		185	176	163	147	140	128	106					
XVM 64-7	45	77	B5		193	183	170	155	147	135	112					
XVM 64-8-2	45	77	B5	204	194	181	164	155	142	116						
XVM 64-8-1	45	77	B5	214	203	189	170	162	149	123						

Model	P2	3 PH 400 V A	Motor Flange Type	l/min Q m ³ /h	833	1000	1166	1333	1416	1500	1666	1833					
	kW				50	60	70	80	85	90	100	110					
XVM 90-1-1	5,5	10,9	B14	H (m)	22	20	18	16	15	13	10	6					
XVM 90-1	7,5	44	B5		30	27	25	23	21	19	15	11					
XVM 90-2-2	11	73,3	B5		41	39	36	32	30	28	22	15					
XVM 90-2	15	110	B5		56	53	49	45	43	40	35	30					
XVM 90-3-2	18,5	135	B5		68	65	60	55	52	49	41	33					
XVM 90-3	22	172	B5		83	79	73	67	64	61	54	47					
XVM 90-4-2	30	210	B5		98	93	87	80	76	72	62	50					
XVM 90-4	30	210	B5		110	105	100	92	88	84	75	65					
XVM 90-5-2	37	241	B5		126	120	113	105	100	95	83	68					
XVM 90-5	37	241	B5		140	133	126	117	113	107	95	83					
XVM 90-6-2	45	345	B5		155	148	139	129	124	118	104	87					
XVM 90-6	45	345	B5		168	160	151	141	135	130	117	103					

XVM

Vertical, Multi-Staged Stainless Steel Pumps

XVM 1

ISO9906 Annex A 2900 rpm

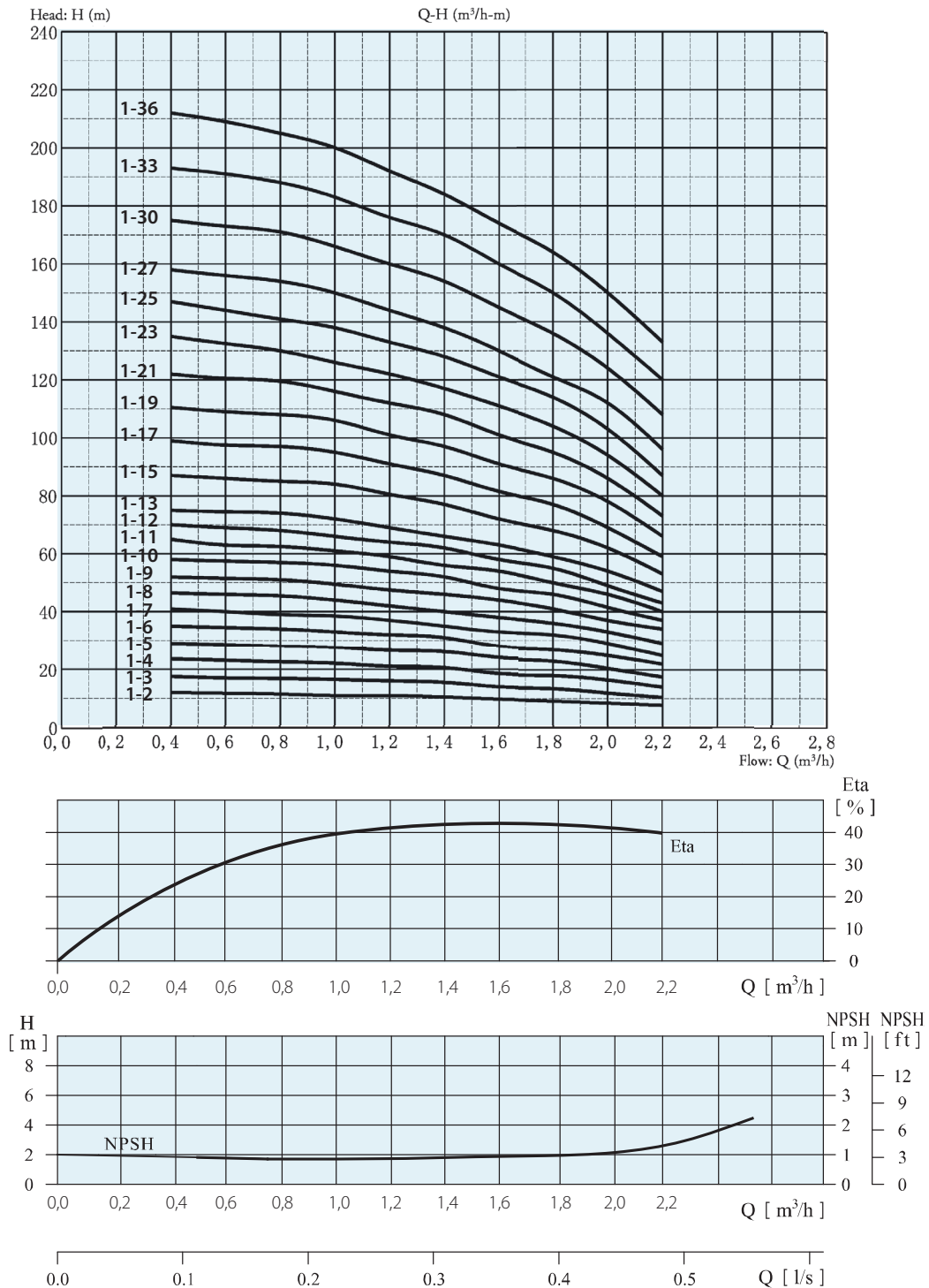

XVM

Vertical, Multi-Staged Stainless Steel Pumps

XVM 3

ISO9906 Annex A 2900rpm

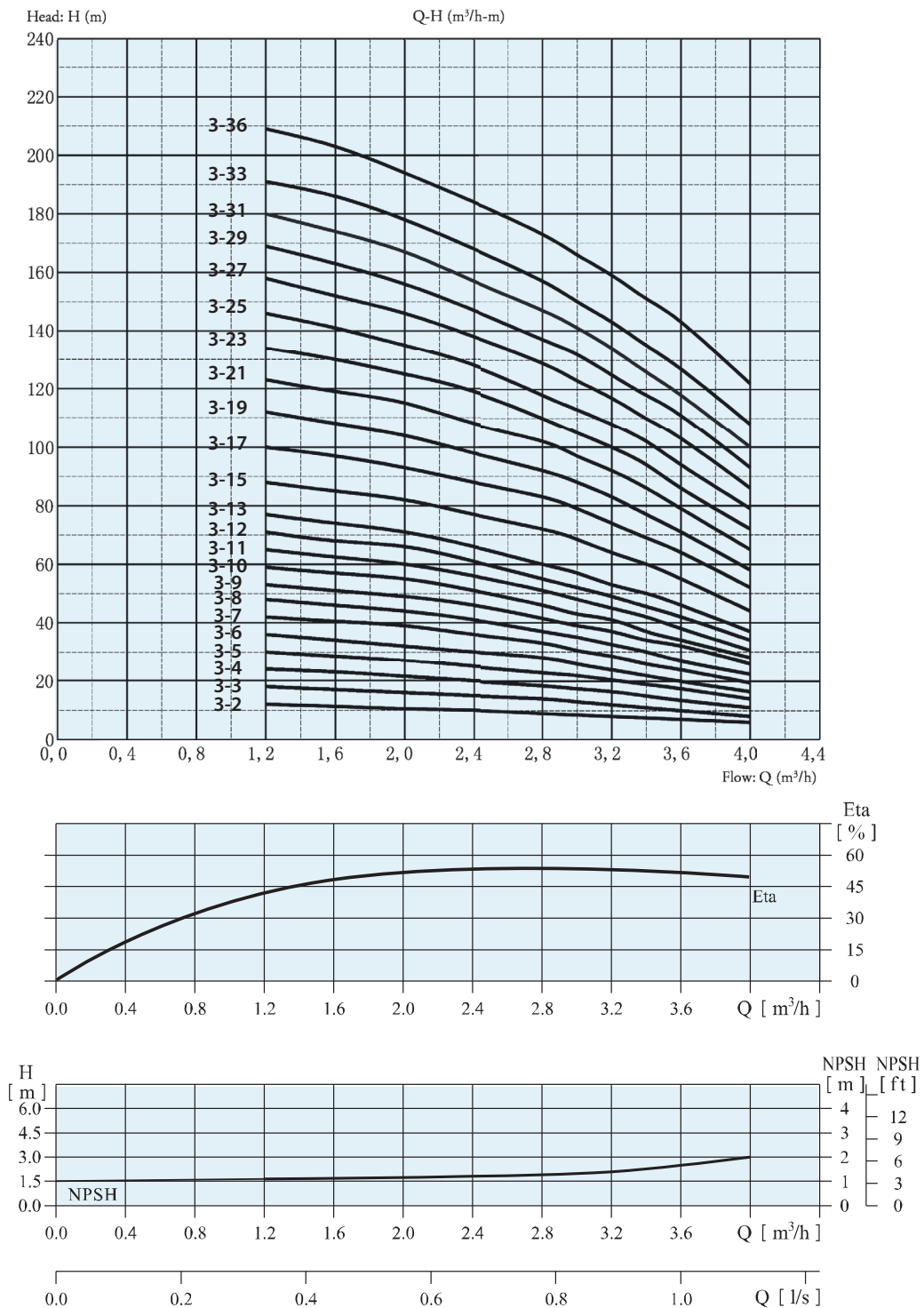

XVM

Vertical, Multi-Stage Stainless Steel Pumps

XVM 5

ISO9906 Annex A 2900rpm

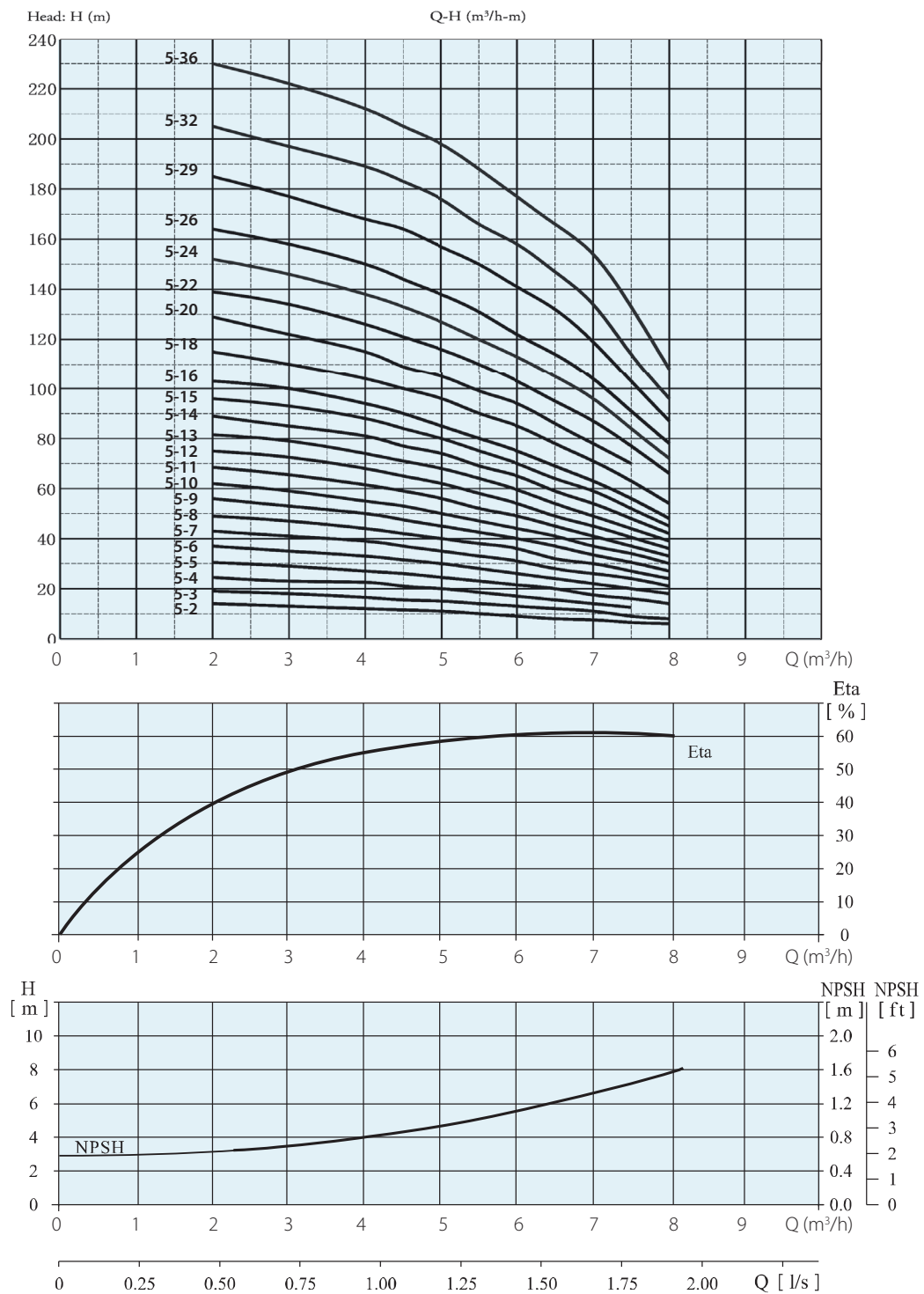

XVM

Vertical, Multi-Staged Stainless Steel Pumps

XVM 10

ISO9906 Annex A 2900rpm

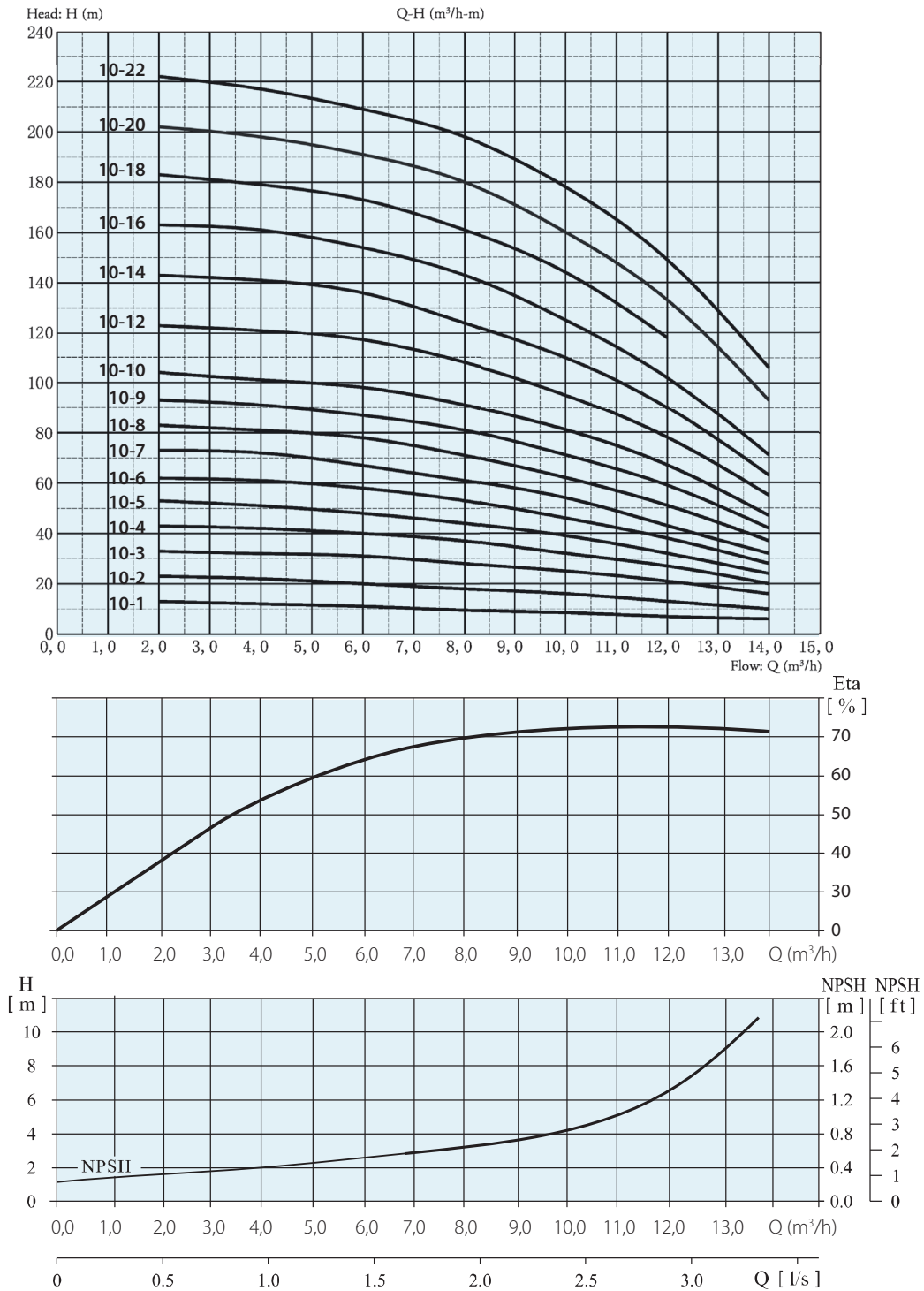

XVM

Vertical, Multi-Staged Stainless Steel Pumps

XVM 15

ISO9906 Annex A 2900rpm

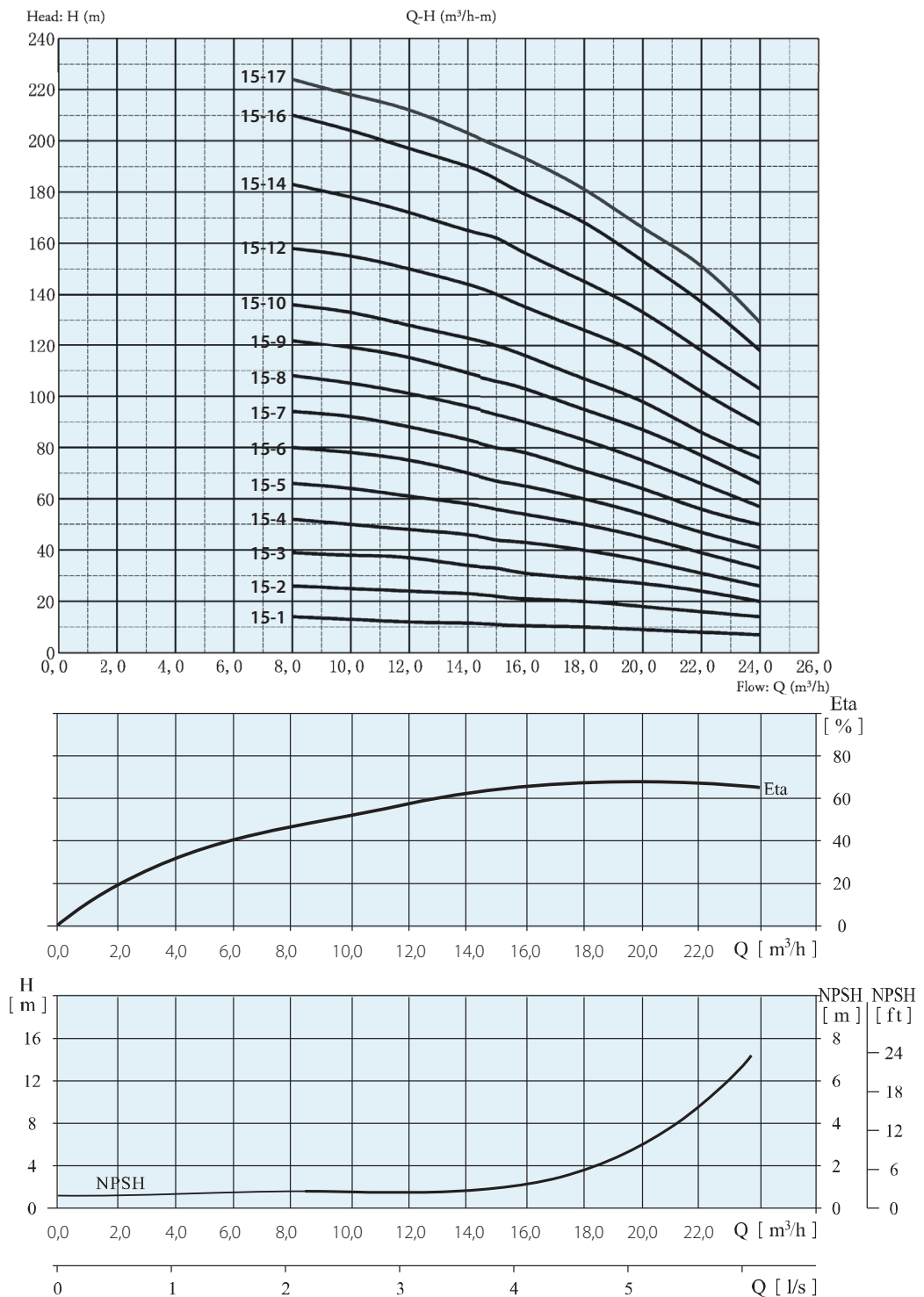

XVM

Vertical, Multi-Staged Stainless Steel Pumps

XVM 20

ISO9906 Annex A 2900rpm

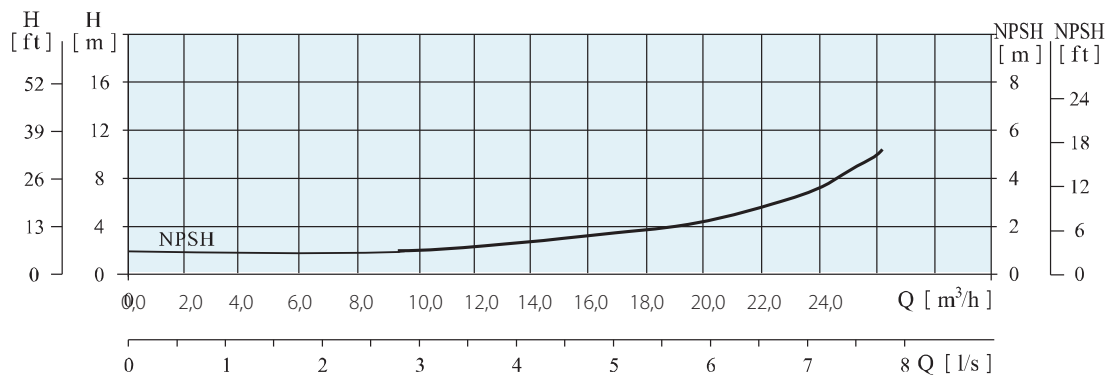
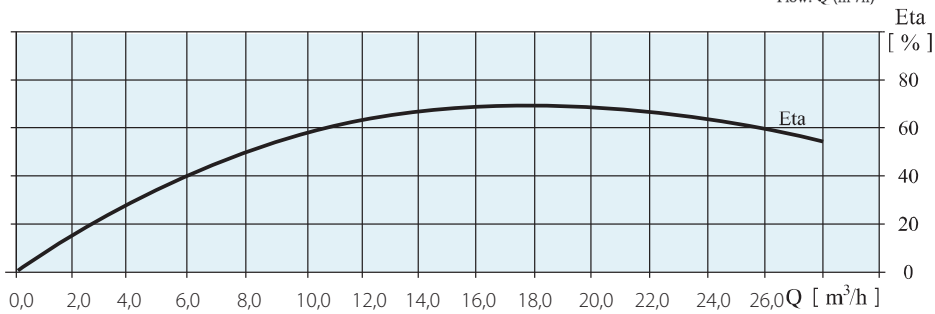
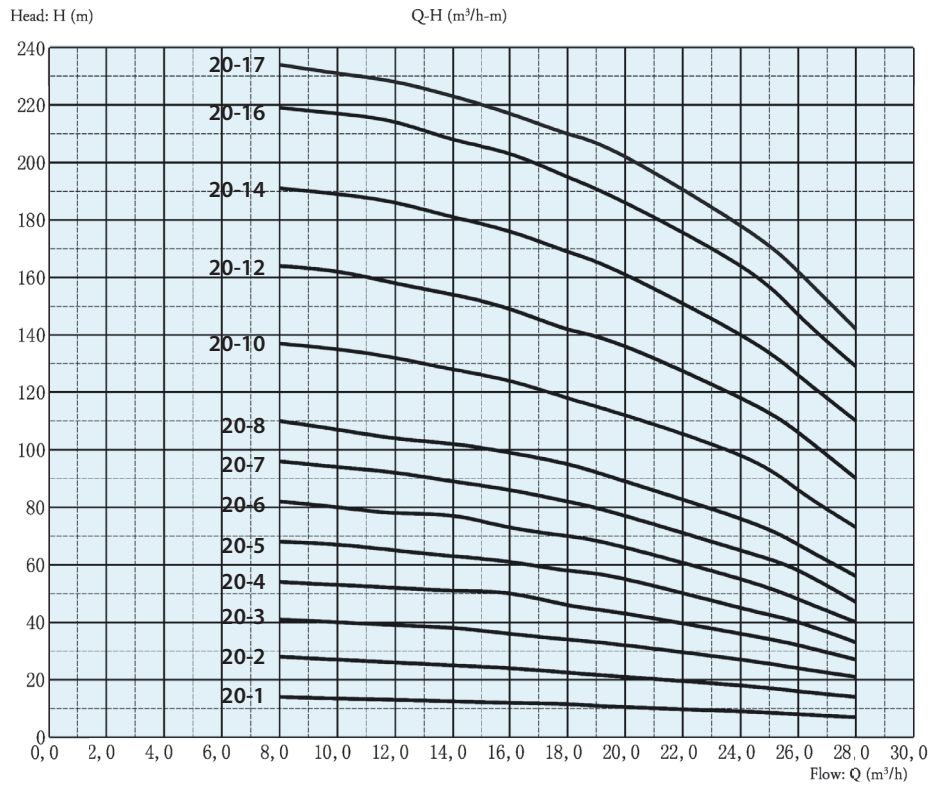

XVM

Vertical, Multi-Stage Stainless Steel Pumps

XVM 32

ISO9906 Annex A 2900rpm

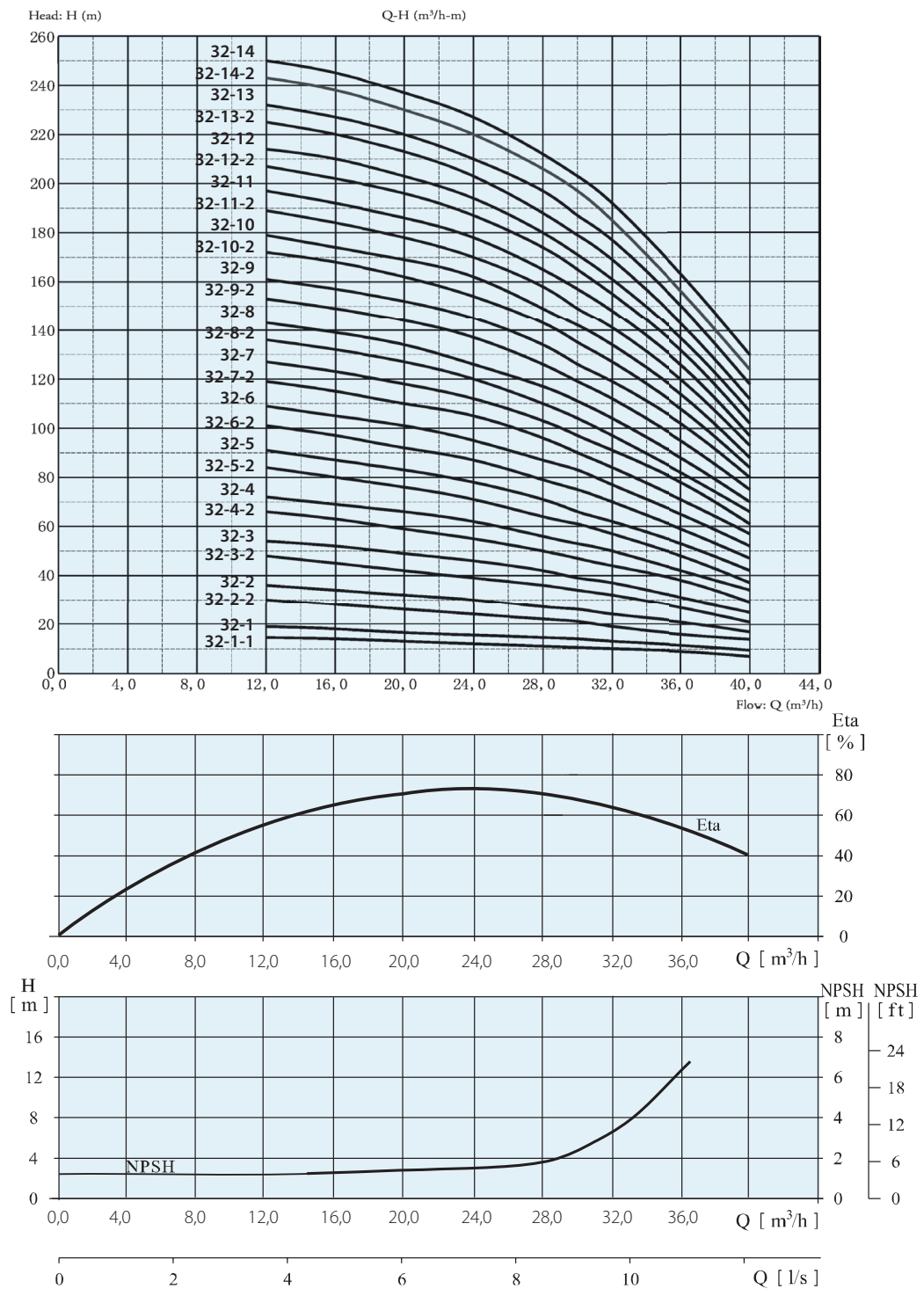

XVM

Vertical, Multi-Staged Stainless Steel Pumps

XVM 45

ISO9906 Annex A 2900rpm

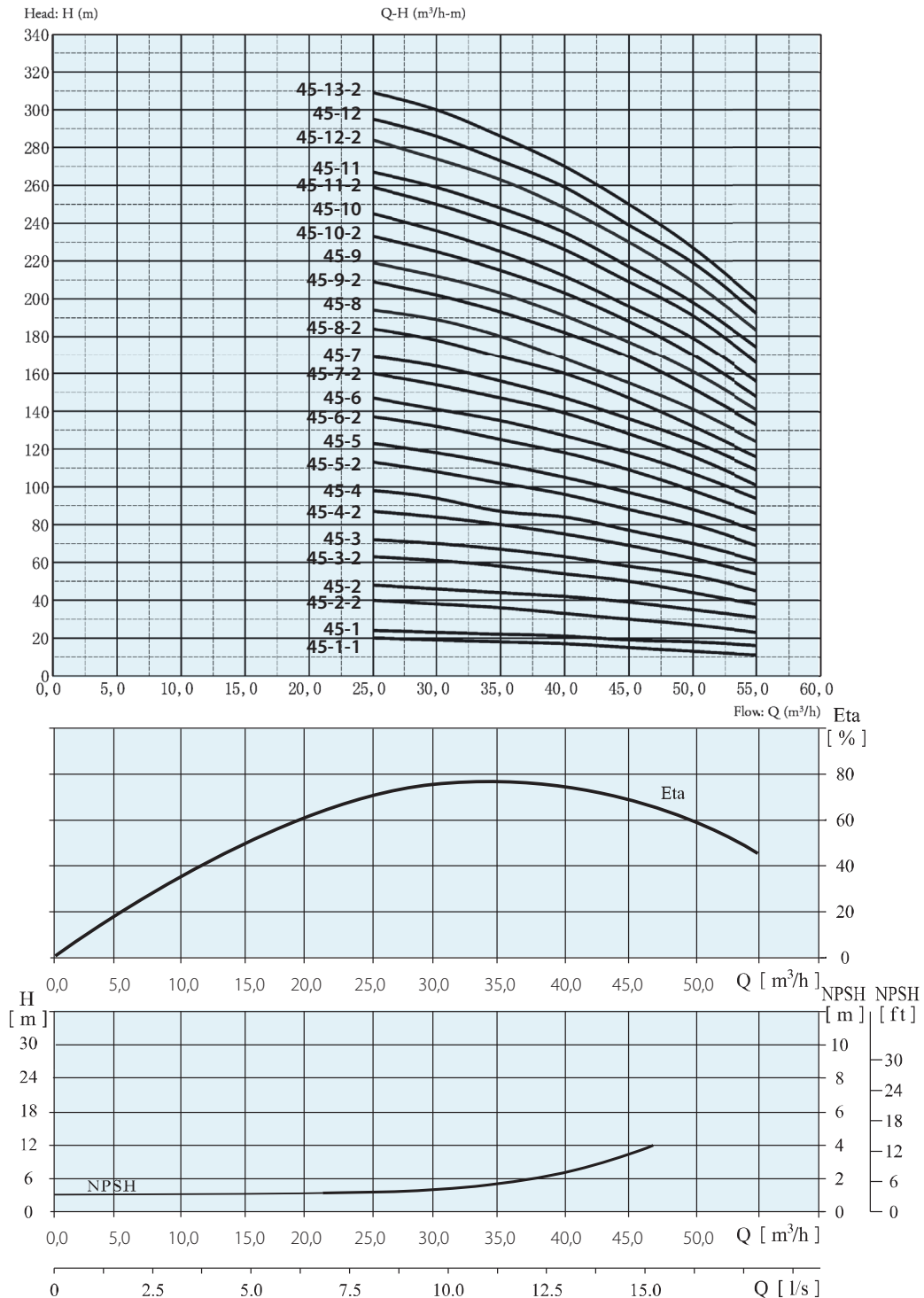

XVM

Vertical, Multi-Stage Stainless Steel Pumps

XVM 64

ISO9906 Annex A 2900rpm

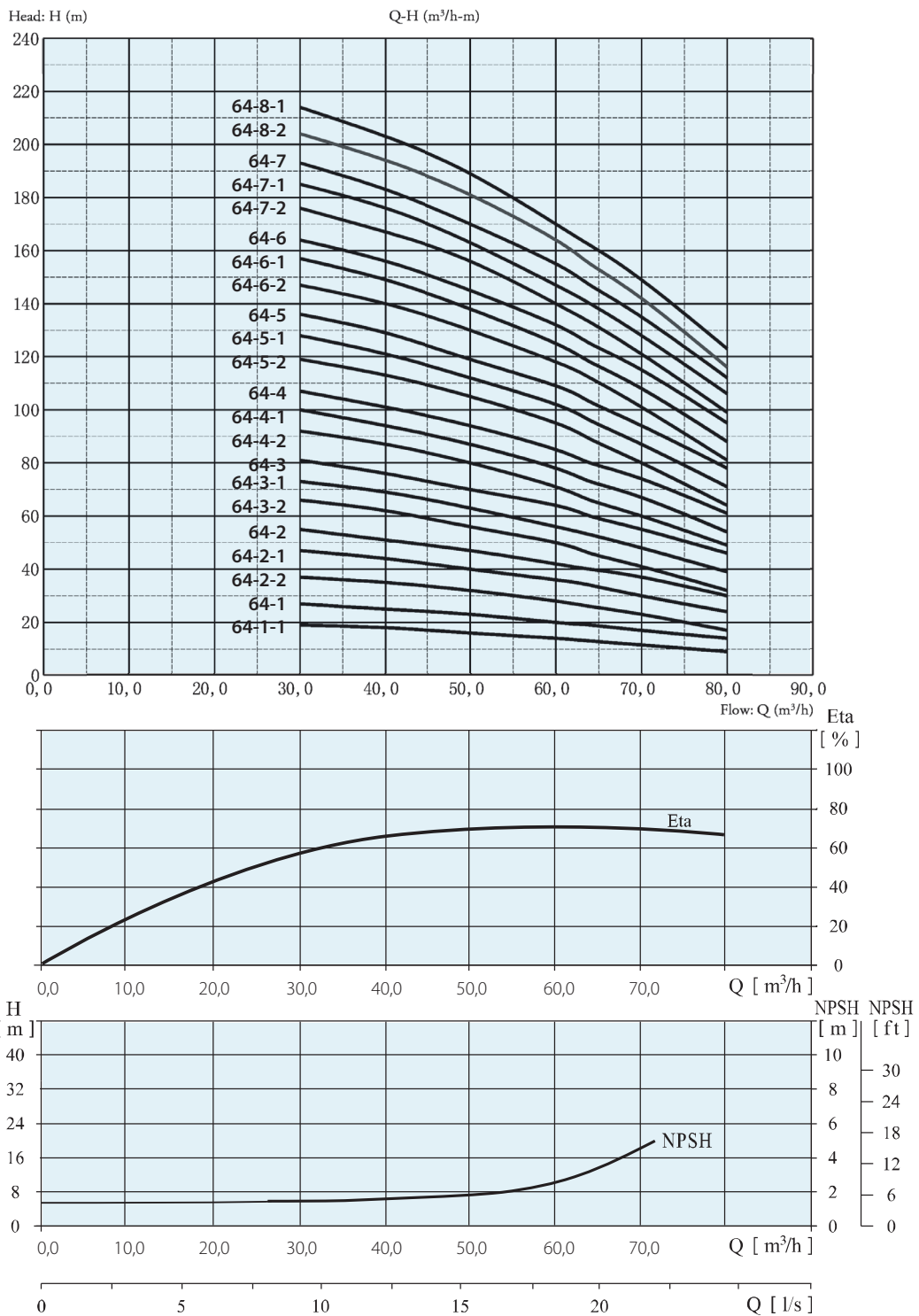

XVM

Vertical, Multi-Staged Stainless Steel Pumps

XVM 90

ISO9906 Annex A 2900rpm

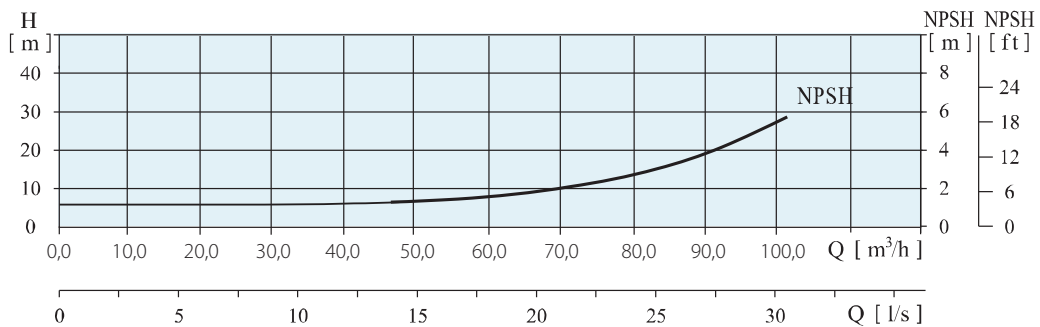
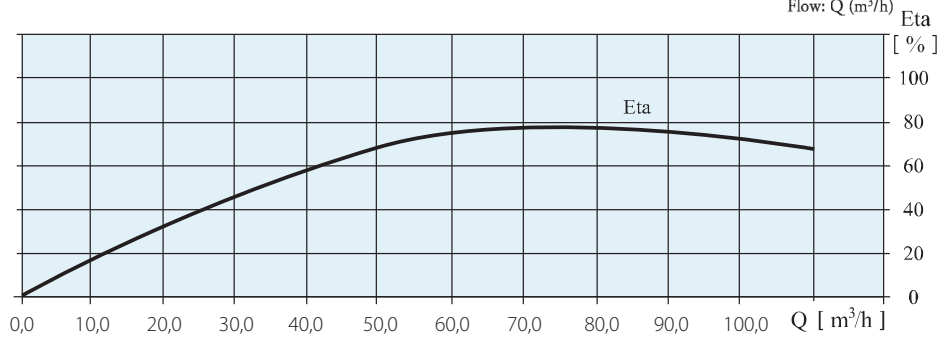
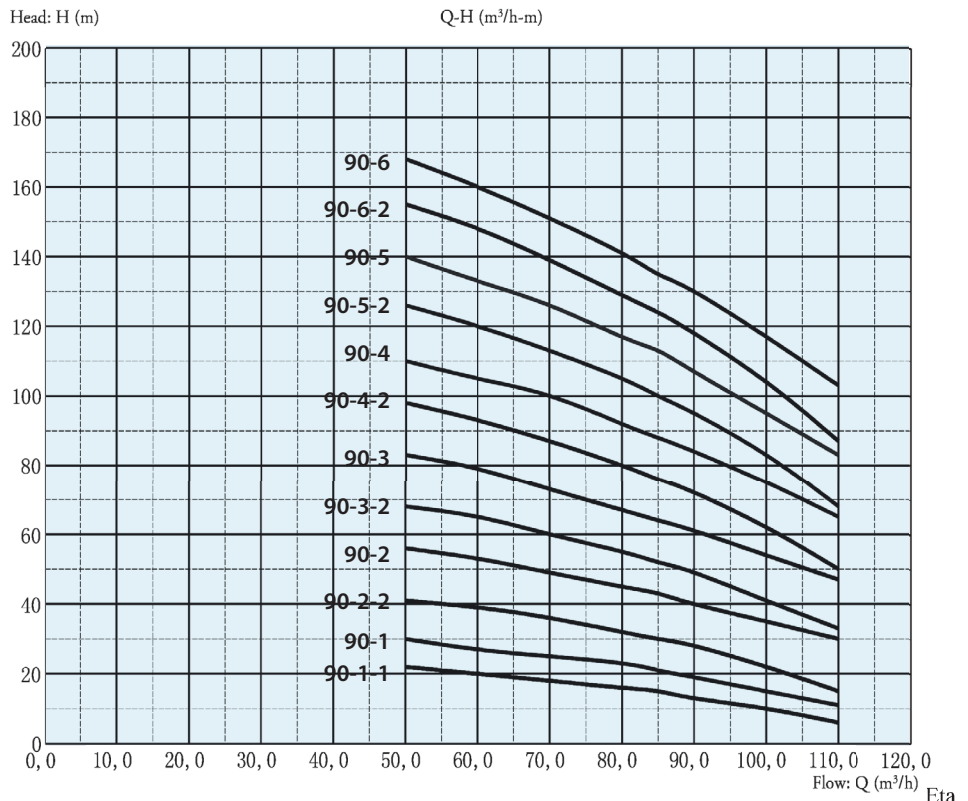

XVM

Vertical, Multi-Staged Stainless Steel Pumps

XVM 1

Model	Size					Weight
	B1	B2	B1+B2	D1	D2	
XVM 1-2	272	205	477	133	126	19
XVM 1-3	290	205	495	133	126	19
XVM 1-4	308	205	513	133	126	20
XVM 1-5	326	205	531	133	126	20
XVM 1-6	344	205	549	133	126	20
XVM 1-7	362	205	567	133	126	21
XVM 1-8	380	205	585	133	126	21
XVM 1-9	398	205	603	133	126	22
XVM 1-10	416	205	621	133	126	23
XVM 1-11	434	205	639	133	126	24
XVM 1-12	452	205	657	133	126	25
XVM 1-13	470	205	675	133	126	26
XVM 1-15	506	205	711	133	126	27
XVM 1-17	550	241	791	154	134	30
XVM 1-19	586	241	827	154	134	1
XVM 1-21	622	241	863	154	134	32
XVM 1-23	658	241	899	154	134	33
XVM 1-25	694	296	990	170	117	39
XVM 1-27	730	296	1026	170	117	40
XVM 1-30	784	296	1080	170	117	41
XVM 1-33	848	296	1144	170	117	44
XVM 1-36	902	296	1198	170	117	45

PART	MATERIAL
Pump Body	AISI 304/AISI 316
Impeller	AISI 304/AISI 316
Shaft	AISI 304/AISI 316
Mechanical Seal	SIC/SIC/EPDM

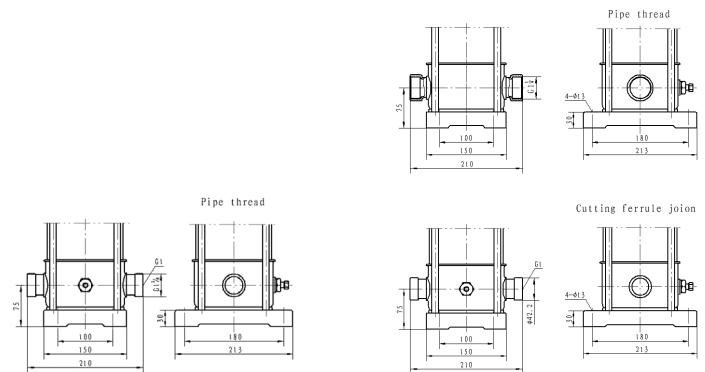

XVM 3

Model	Size					Weight
	B1	B2	B1+B2	D1	D2	
XVM 3-2	272	205	477	133	126	19
XVM 3-3	290	205	495	133	126	19
XVM 3-4	308	205	513	133	126	20
XVM 3-5	326	205	531	133	126	20
XVM 3-6	344	205	549	133	126	21
XVM 3-7	362	205	567	133	126	21
XVM 3-8	380	205	585	133	126	22
XVM 3-9	398	205	603	133	126	23
XVM 3-10	416	205	621	133	126	24
XVM 3-11	442	241	683	154	134	26
XVM 3-12	460	241	701	154	134	26
XVM 3-13	478	241	719	154	134	27
XVM 3-15	514	241	755	154	134	28
XVM 3-17	560	296	856	170	117	33
XVM 3-19	596	296	892	170	117	34
XVM 3-21	632	296	928	170	117	37
XVM 3-23	668	296	964	170	117	38
XVM 3-25	704	296	1000	170	117	39
XVM 3-27	740	296	1036	170	117	40
XVM 3-29	776	296	1072	170	117	41
XVM 3-31	812	296	1108	170	117	46
XVM 3-33	848	296	1144	170	117	47
XVM 3-36	902	296	1198	170	117	49

PART	MATERIAL
Pump Body	AISI 304/AISI 316
Impeller	AISI 304/AISI 316
Shaft	AISI 304/AISI 316
Mechanical Seal	SIC/SIC/EPDM

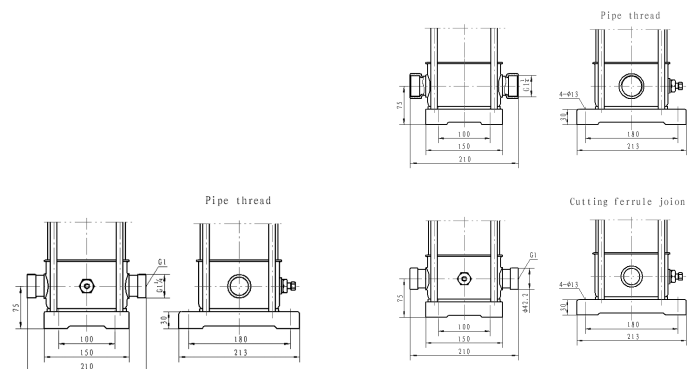

XVM

Vertical, Multi-Staged Stainless Steel Pumps

XVM 5

Model	Size						Weight
	B1	B2	B1+B2	D	D1	D2	
XVM 5-2	290	205	495	/	133	126	20
XVM 5-3	317	205	522	/	133	126	20
XVM 5-4	344	205	549	/	133	126	21
XVM 5-5	371	205	576	/	133	126	23
XVM 5-6	406	241	647	/	154	134	26
XVM 5-7	433	241	674	/	154	134	27
XVM 5-8	460	241	701	/	154	134	28
XVM 5-9	497	296	793	/	170	117	34
XVM 5-10	524	296	820	/	170	117	35
XVM 5-11	551	296	847	/	170	117	36
XVM 5-12	578	296	874	/	170	117	37
XVM 5-13	605	296	901	/	170	117	38
XVM 5-14	632	296	928	/	170	117	40
XVM 5-15	659	296	955	/	170	117	41
XVM 5-16	686	296	982	/	170	117	42
XVM 5-18	740	296	1036	/	170	117	44
XVM 5-20	794	296	1090	/	170	117	45
XVM 5-22	863	323	1186	/	200	117	57
XVM 5-24	917	323	1240	/	200	117	58
XVM 5-26	971	323	1294	/	200	117	60
XVM 5-29	1052	323	1375	/	200	117	62
XVM 5-32	1158	392	1550	300	238	162	77
XVM 5-36	1266	392	1658	300	238	162	79

PART	MATERIAL
Pump Body	AISI 304/AISI 316
Impeller	AISI 304/AISI 316
Shaft	AISI 304/AISI 316
Mechanical Seal	SIC/SIC/EPDM

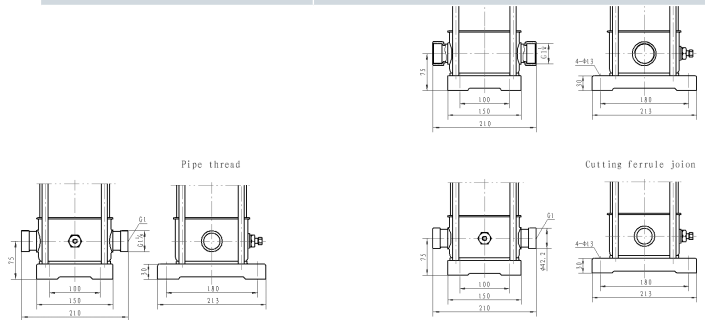

XVM 10

Model	Size						Weight
	B1	B2	B1+B2	D	D1	D2	
XVM 10-1	328	205	533	/	133	126	32
XVM 10-2	358	205	563	/	133	126	34
XVM 10-3	396	241	637	/	154	134	37
XVM 10-4	426	296	722	/	170	117	44
XVM 10-5	466	296	762	/	170	117	47
XVM 10-6	496	296	792	/	170	117	49
XVM 10-7	526	296	822	/	170	117	54
XVM 10-8	556	296	852	/	170	117	55
XVM 10-9	586	296	882	/	170	117	56
XVM 10-10	631	323	954	/	200	142	59
XVM 10-12	691	323	1014	/	200	142	62
XVM 10-14	773	392	1165	300	238	162	92
XVM 10-16	833	392	1225	300	238	162	94
XVM 10-18	893	430	1323	300	238	162	118
XVM 10-20	953	430	1383	300	238	162	122
XVM 10-22	1013	430	1443	300	238	162	124

PART	MATERIAL
Pump Body	AISI 304/AISI 316
Impeller	AISI 304/AISI 316
Shaft	AISI 304/AISI 316
Mechanical Seal	SIC/SIC/EPDM

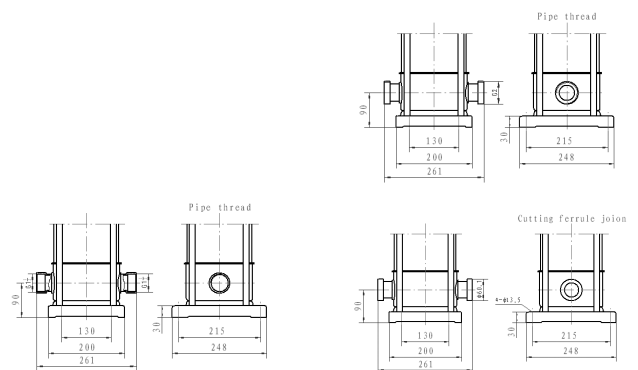

XVM

Vertical, Multi-Staged Stainless Steel Pumps

XVM 15

Model	Size						Weight
	B1	B2	B1+B2	D	D1	D2	
XVM 15-1	350	241	591	/	154	134	39
XVM 15-2	405	296	701	/	170	117	44
XVM 15-3	450	296	746	/	170	117	49
XVM 15-4	510	323	833	/	200	142	54
XVM 15-5	555	326	881	/	200	142	57
XVM 15-6	623	392	1015	300	238	162	88
XVM 15-7	668	392	1060	300	238	162	92
XVM 15-8	713	430	1143	300	238	162	96
XVM 15-9	758	430	1188	300	238	162	97
XVM 15-10	831	456	1287	350	278	180	138
XVM 15-12	921	456	1377	350	278	180	143
XVM 15-14	1011	456	1467	350	278	180	146
XVM 15-16	1101	456	1557	350	278	180	147
XVM 15-17	1146	456	1602	350	278	180	158

PART	MATERIAL
Pump Body	AISI 304/AISI 316
Impeller	AISI 304/AISI 316
Shaft	AISI 304/AISI 316
Mechanical Seal	SIC/SIC/EPDM

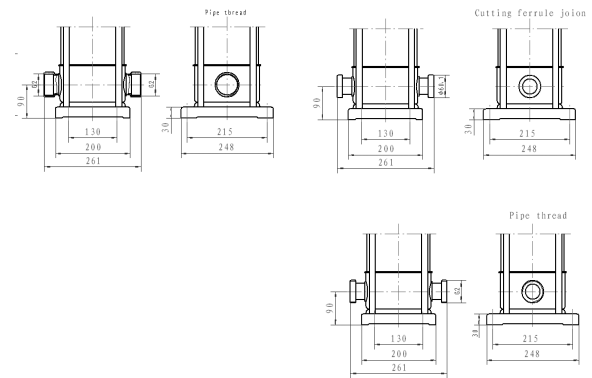

XVM 20

Model	Size						Weight
	B1	B2	B1+B2	D	D1	D2	
XVM 20-1	350	296	646	/	170	117	39
XVM 20-2	405	296	701	/	170	117	44
XVM 20-3	465	323	788	/	200	142	54
XVM 20-4	532	392	924	300	238	162	79
XVM 20-5	578	392	970	300	238	162	82
XVM 20-6	623	430	1053	300	238	162	86
XVM 20-7	668	430	1098	300	238	162	89
XVM 20-8	740	456	1196	350	278	180	129
XVM 20-10	830	456	1286	350	278	180	135
XVM 20-12	921	497	1418	350	278	180	144
XVM 20-14	1011	497	1508	350	278	180	147
XVM 20-16	1101	560	1661	350	313	255	167
XVM 20-17	1146	560	1706	350	313	255	169

PART	MATERIAL
Pump Body	AISI 304/AISI 316
Impeller	AISI 304/AISI 316
Shaft	AISI 304/AISI 316
Mechanical Seal	SIC/SIC/EPDM

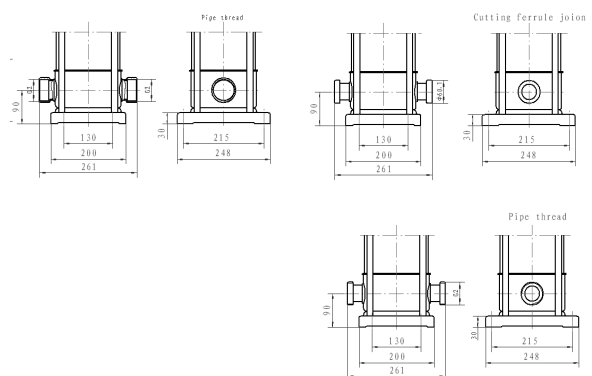

XVM

Vertical, Multi-Staged Stainless Steel Pumps

XVM 32

Model	Size						Weight
	B1	B2	B1+B2	D	D1	D2	
XVM 32-1-1	455	241/293	696/748	-	154	111	60
XVM 32-1	455	275/293	730/748	-	177	116	61
XVM 32-2-2	525	293	800	-	177	116	75
XVM 32-2	525	305	830	-	197	148	86
XVM 32-3-2	595	305	900	-	197	148	105
XVM 32-3	620	390	1010	300	275	210	105
XVM 32-4-2	690	390	1080	300	275	210	116
XVM 32-4	690	390	1080	300	275	210	117
XVM 32-5-2	915	505	1420	350	330	255	170
XVM 32-5	915	505	1420	350	330	255	171
XVM 32-6-2	985	505	1490	350	330	255	176
XVM 32-6	985	505	1490	350	330	255	176
XVM 32-7-2	1055	505	1560	350	330	255	206
XVM 32-7	1055	505	1560	350	330	255	207
XVM 32-8-2	1125	505	1630	350	330	255	208
XVM 32-8	1125	505	1630	350	330	255	209
XVM 32-9-2	1195	560	1750	350	330	255	225
XVM 32-9	1195	560	1750	350	330	255	226
XVM 32-10-2	1265	560	1820	350	330	255	230
XVM 32-10	1265	560	1820	350	330	255	231
XVM 32-11-2	1335	590	1925	350	380	280	270
XVM 32-11	1335	590	1925	350	380	280	271
XVM 32-12-2	1405	590	1995	350	380	280	275
XVM 32-12	1405	590	1995	350	380	280	276
XVM 32-13-2	1475	660	2135	400	420	305	395
XVM 32-13	1475	660	2135	400	420	305	395
XVM 32-14-2	1525	660	2185	400	420	305	400
XVM 32-14	1525	660	2185	400	420	305	400

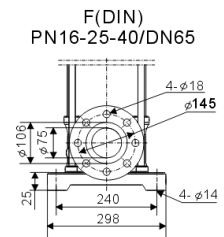
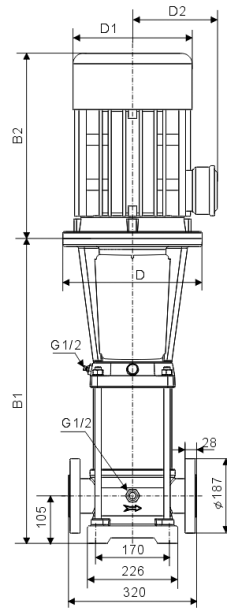

PART	MATERIAL
Pump Body	AISI 304/AISI 316
Impeller	AISI 304/AISI 316
Shaft	AISI 304/AISI 316
Mechanical Seal	SIC/SIC/EPDM

XVM

Vertical, Multi-Staged Stainless Steel Pumps

XVM 45

Model	Size						Weight
	B1	B2	B1+B2	D	D1	D2	
XVM 45-1-1	561	293	876	-	197	165	86
XVM 45-1	561	315	876	-	260	165	86
XVM 45-2-2	641	430	1071	300	260	208	102
XVM 45-2	641	430	1071	300	330	208	102
XVM 45-3-2	826	490	1316	350	330	255	175
XVM 45-3	826	490	1316	350	330	255	175
XVM 45-4-2	906	490	1396	350	330	255	187
XVM 45-4	906	490	1396	350	330	255	187
XVM 45-5-2	986	550	1536	350	330	255	208
XVM 45-5	986	550	1536	350	330	255	208
XVM 45-6-2	1066	590	1656	350	360	285	251
XVM 45-6	1066	590	1656	350	360	285	251
XVM 45-7-2	1146	660	1806	400	420	310	315
XVM 45-7	1146	660	1806	400	420	310	315
XVM 45-8-2	1226	660	1886	400	420	310	319
XVM 45-8	1226	660	1886	400	420	310	319
XVM 45-9-2	1306	660	1966	400	420	310	323
XVM 45-9	1306	660	1966	400	420	310	323
XVM 45-10-2	1386	660	2046	400	420	310	347
XVM 45-10	1386	660	2046	400	420	310	347
XVM 45-11-2	1466	700	2166	450	470	345	413
XVM 45-11	1466	700	2166	450	470	345	413
XVM 45-12-2	1546	700	2246	450	470	345	417
XVM 45-12	1546	700	2246	450	470	345	417
XVM 45-13-2	1626	700	2326	450	470	345	421

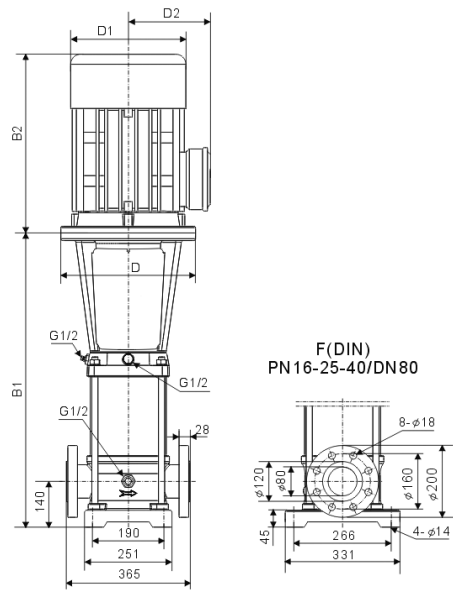

PART	MATERIAL
Pump Body	AISI 304/AISI 316
Impeller	AISI 304/AISI 316
Shaft	AISI 304/AISI 316
Mechanical Seal	SIC/SIC/EPDM

XVM

Vertical, Multi-Staged Stainless Steel Pumps

XVM 64

Model	Size						Weight
	B1	B2	B1+B2	D	D1	D2	
XVM 64-1-1	561	335	896	-	230	188	105
XVM 64-1	561	430	991	300	260	208	110
XVM 64-2-2	644	430	1074	300	260	208	120
XVM 64-2-1	754	490	1244	350	330	255	155
XVM 64-2	754	490	1244	350	330	255	155
XVM 64-3-2	836	490	1326	350	330	255	195
XVM 64-3-1	836	490	1326	350	330	255	195
XVM 64-3	836	550	1386	350	330	255	205
XVM 64-4-2	919	550	1469	350	330	255	208
XVM 64-4-1	919	590	1509	350	360	285	260
XVM 64-4	919	590	1509	350	360	285	260
XVM 64-5-2	1001	660	1661	400	420	310	345
XVM 64-5-1	1001	660	1661	400	420	310	345
XVM 64-5	1001	660	1661	400	420	310	345
XVM 64-6-2	1084	660	1744	400	420	310	350
XVM 64-6-1	1084	660	1744	400	420	310	370
XVM 64-6	1084	660	1744	400	420	310	370
XVM 64-7-2	1166	660	1826	400	420	310	375
XVM 64-7-1	1166	660	1826	400	420	310	375
XVM 64-7	1166	700	1866	450	420	310	435
XVM 64-8-2	1248	700	1948	450	470	345	440
XVM 64-8-1	1248	700	1948	450	470	345	440

PART	MATERIAL
Pump Body	AISI 304/AISI 316
Impeller	AISI 304/AISI 316
Shaft	AISI 304/AISI 316
Mechanical Seal	SIC/SIC/EPDM

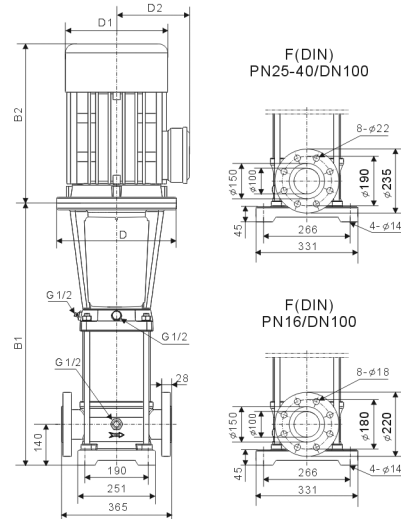

XVM 90

Model	Size						Weight
	B1	B2	B1+B2	D	D1	D2	
XVM 90-1-1	571	430	1001	300	260	208	120
XVM 90-1	571	430	1001	300	260	208	122
XVM 90-2-2	773	490	1263	350	330	255	165
XVM 90-2	773	490	1263	350	330	255	198
XVM 90-3-2	865	550	1415	350	330	255	212
XVM 90-3	865	590	1455	350	360	285	265
XVM 90-4-2	957	660	1417	400	420	310	348
XVM 90-4	957	660	1617	400	420	310	348
XVM 90-5-2	1049	660	1709	400	420	310	375
XVM 90-5	1049	660	1709	400	420	310	375
XVM 90-6-2	1141	700	1841	450	470	345	438
XVM 90-6	1141	700	1841	450	470	345	438

PART	MATERIAL
Pump Body	AISI 304/AISI 316
Impeller	AISI 304/AISI 316
Shaft	AISI 304/AISI 316
Mechanical Seal	SIC/SIC/EPDM

