

Solaris 68 RS



Asia



SOLARIS 68 RS

By JAVIER SOTO ACEBAL & SOLARIS DESIGN TEAM
Interior with LALOSE-VIC & LUCIO MICHELETTI



SOLARIS 68 RS

By JAVIER SOTO ACEBAL & SOLARIS DESIGN TEAM

Interior with LALOSE VIC & LUCIO MICHELETTI

QTR – Quality Time Remaining

GLOBAL WARMING ACT
Limited CO2 emissions
Environmental friendly
Long range voyages

1) Easy Sailing

life at sea discipline

2) Training

Art of Sailing specific method

3) Fast&Easy sailing cruisers

personalization's
furling boom
electric winches rewind
self tacking jib
furled sails



SOLARIS 68 RS

By JAVIER SOTO ACEBAL & SOLARIS DESIGN TEAM

Interior with LALOSE-VIC & LUCIO MICHELETTI



SOLARIS 68 RS

By JAVIER SOTO ACEBAL & SOLARIS DESIGN TEAM
Interior with LALOSE-VIC & LUCIO MICHELETTI



SOLARIS 68 RS

By JAVIER SOTO ACEBAL & SOLARIS DESIGN TEAM
Interior with LALOSE-VIC & LUCIO MICHELETTI



SOLARIS 68 RS

By JAVIER SOTO ACEBAL & SOLARIS DESIGN TEAM
Interior with LALOSE-VIC & LUCIO MICHELETTI



SOLARIS 68 RS

By JAVIER SOTO ACEBAL & SOLARIS DESIGN TEAM
Interior with LALOSE-VIC & LUCIO MICHELETTI



SOLARIS 68 RS

By JAVIER SOTO ACEBAL & SOLARIS DESIGN TEAM
Interior with LALOSE-VIC & LUCIO MICHELETTI



INTERIOR PLANS.

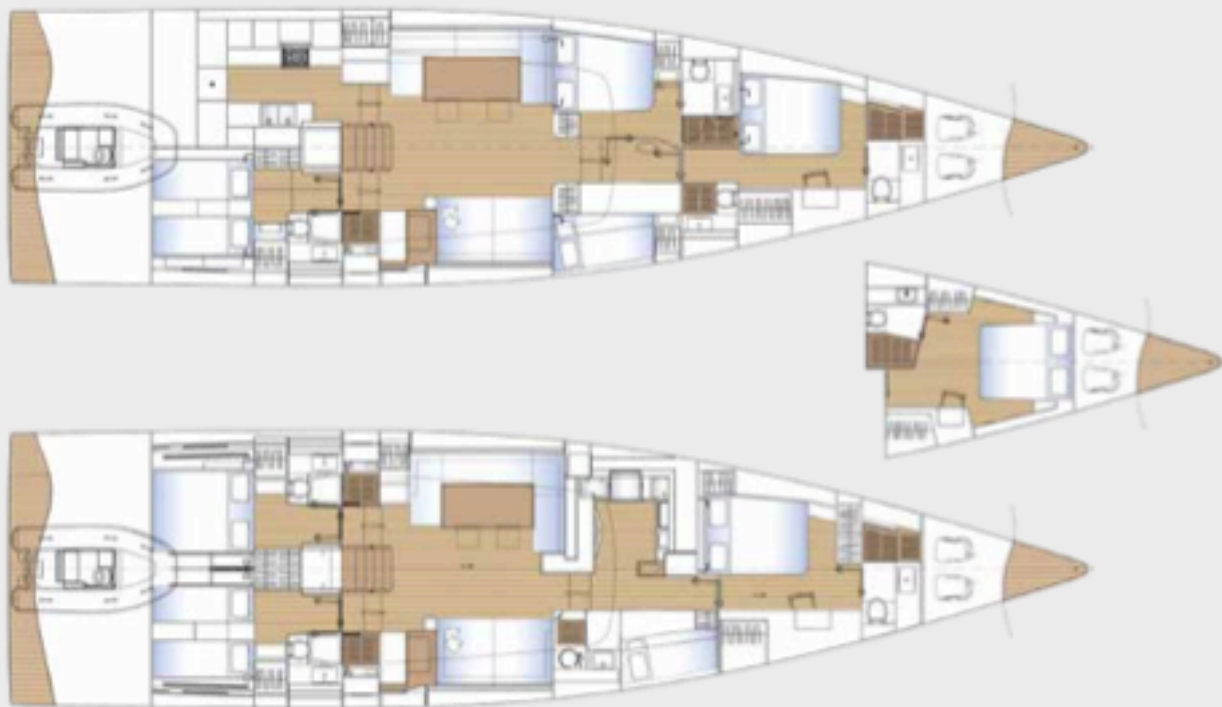

SOLARIS 68' RS

LOA	20.80 M
BEAM	5.50 M
DRAFT	3.40 (3.00 OPTIONAL) M
DISPLACEMENT	LIGHT - 28,800 Kg
BALLAST	10,400 Kg
SAIL AREA	256 M ²
MAINSAIL	146 M ²
JIB 106%	110 M ²
ENGINE	VOLVO PENTA 150 (180 OPTIONAL) HP
WATER TANK	1,000 L
FUEL TANK	930 L
DESIGNER	JAVIER SOTO ACEBAL

Solaris Yachts

sailing fast cruisers

Research&Design

Fast and easy philosophy

Very Hi Quality

Historical production reputation

Limited production

Hand Made in Italy

Yacht Value

Solaris Yachts keeps the value in the pre owned market



SOLARIS 68 RS RTS (Ready To Sail) Price CIF Hong Kong - HK\$ 24.700.000,00

SOLARIS 68 RS - RTS - Ready To Sailing

BASIC BOAT Description

Solaris 58 as per technical building specifications.

The standard version includes:

- sandwich hull with airex-like core, deck built with the vacuum bag and infusion system
- oak interiors
- oak floorboards with transversal grain
- couch on the starboard side of the saloon and linear chart table
- composite main and fore-bulkheads
- composite structure with carbon reinforcements and airex-like core
- all the bulkheads are completely resin bonded to hull and deck without inner mouldings
- cast iron fin and lead bulb (3.2 mt draft) connected to the hull recess through a coupling flange
- automatic fire extinguisher for the engine room
- bronze sea cocks, flush to the hull
- holding tank for each toilet
- no. 2 fixed hull windows in double layer tempered crystal
- flush hatches on deck provided with Oceanair blinds and flyscreens
- 4 winches with the ropes running below the deck
- 24V service batteries and 12V starting battery
- boom light
- 2 Mastervolt battery chargers for starting and service batteries
- LED navigation lights, Lopolight
- top loading fridge on the starboard galley + addition top loading fridge on the portside galley
- Dyneema ropes with splices, shackles and snapshackles where necessary
- hydraulic integral backstay adjuster
- transom door with electrohydraulic opening system
- mooring pack
- recessed track for the self-tacking jib

SOLARIS 68 RS standard OAK INTERIORS

Internal layout with 4 cabins and 4 heads

Bow Thruster model MAX POWER R300

No. 4 additional hull windows, double layer glass

Antifouling (International - Micron grey), including keel lamination

Tender garage with longitudinal access way, with a watertight composite structure and electric winch + rollers to drop and lift out the dinghy (3.20 m) of the water. Twin rudder with stainless steel shafts included

INTERIOR Description

Air conditioning and heating system with fancoil and thermostat in the saloon and in each cabin. The system has a 62,000 BTU cooling capacity and inverter technology in order to reduce the electrical consumptions. (the heating function will work only when the sea water temperature is above 5°C). 220V AC power supply

Split level beds in the starboard aft cabin

Galley's worktop in Corian, with fiddles in Corian and sinks in stainless steel

No. 2 removable chairs for the saloon

Washer-dryer

Dishwasher

Bathrooms' topsides covered in carbon (3 bathrooms)

ENGINE Description

180 hp engine (Volvo Penta)

Feathering propeller, Max Prop

GENERATOR Description

11 kw Onan generator with exhaust water separator

SOLARIS 68 RS - RTS - Ready To Sailing

WATER SYS Description

No. 2 electric toilets model Planus 24v (fresh water flush system)

COOLING Description

Refrigeration set including: fridge with a 350 liters capacity + top loading freezer + wine cooler + icemaker (upgrade to the standard set)

DECK Description

Side decks covered with teak (grey caulking)

Coachroof covered with teak (grey caulking)

Bathing platform covered with teak (grey caulking)

N. 4 verricelli elettrici Harken Performa, size 80

Electric retractable mooring winch, Sanguineti 1000W 24V

Folding gangway in pre-preg carbon fibre, white painted, 2.20 m long, with stainless steel terminals and double fixing socket on deck

Cockpit table with extension teak wings and storage box

Cushions for the cockpit seats (including backrests)

No. 4 stainless steel folding cleats, price difference with the standard ones

No. 2 stainless steel folding cleats amidships

Protection covers for the steering wheels

Protection cover for the cockpit table

Protection covers for the steering consoles

STEERING Description

Carbon steering wheels, in place of the standard ones

Integrated consoles on the steering pedestals for instruments (plotter 9"), compass, different controls and grabrails

Volvo Penta electronic engine control on the starboard console

RIG Description

Hall Spars carbon mast and boom including rod rigging, Quikvang solid vang, Harken mainsail switch track, spreaders and boom lights, running rigging, packaging and transport, instead of the standard one

Hall Spars carbon V-boom. Upgrade to item 10.02

Bamar TD electric jib furler, as price difference with the standard one

Lazy jack

No. 2 bags for halyard in cockpit

Electric code 0 furler by Bamar, combined with swivel by Ubi Maior

Mainsail cover

Gear for Gennaker and Code, including blocks and one set of sheets

ELECTRICAL SYS Description

No. 2 additional 115 Ah (C20) batteries for the services, 24V

NAV.ELECTR. Description

B&G H5000 navigation pack including: 2 display H5000 GFD, H5000 Hydra software, autopilot keypad H5000, H5000 power computer, 24V rotary mechanical drive, Triton-2 display for the analogue wind direction, VHF model V50 including second unit H50 in cockpit

B&G multifunction display model Zeus 3 - 12" touchscreen display with integrated GPS antenna (including Navionics+ chart "Mediterranean and Black sea", NAV+43XG). Installation possible only at chart table. (The external GPS antenna, item 12.13, is advisable)

Broad band radar antenna model B&G 4G (installed at mast)

Access Point WI-FI Simrad Go-Free. It allows to control the Zeus multifunction displays through an APP downloaded on a smartphone or tablet

Simrad Transponder AIS NAIS-500 class B, connected to the multifunction display Zeus-3 series, including splitter model Simrad NSPL-500

SOLARIS 68 RS - RTS - Ready To Sailing

ENTERTAINMENT Description

Music system including: Fusion MS-AV750 unit with AM/FM tuner, CD-DVD player, external USB socket. Saloon and cockpit loudspeakers. The Fusion unit can be controlled via the Raymarine/B&G touchscreen displays. (This device, if connected via access-point wi-fi Raymarine or B&G, can be wi-fi controlled by a specific application IOS or Android). Remote control by App Fusion Link via Bluetooth connection and/or external WiFi, not included

MISCELLANEOUS Description

Launching, mast stepping and tests at sea in Aquileia

Sails

Boat shrink wrapping

Shipping to Hkg

Commissioning in Hong Kong



solaris
yachts



SOLARIS 68 RS EZC (Easy Sailing) Price CIF Hong Kong - HK\$ 29.000.000,00

SOLARIS 68 - EZC - Easy Sailing

Solaris 58 as per technical building specifications.

BASIC BOAT Description

The standard version includes:

- sandwich hull with airex-like core, deck built with the vacuum bag and infusion system
- oak interiors
- oak floorboards with transversal grain
- couch on the starboard side of the saloon and linear chart table
- composite main and fore-bulkheads
- composite structure with carbon reinforcements and airex-like core
- all the bulkheads are completely resin bonded to hull and deck without inner mouldings
- cast iron fin and lead bulb (3.2 mt draft) connected to the hull recess through a coupling flange
- automatic fire extinguisher for the engine room
- bronze sea cocks, flush to the hull
- holding tank for each toilet
- no. 2 fixed hull windows in double layer tempered crystal
- flush hatches on deck provided with Oceanair blinds and flyscreens
- 4 winches with the ropes running below the deck
- 24V service batteries and 12V starting battery
- boom light
- 2 Mastervolt battery chargers for starting and service batteries
- LED navigation lights, Lopolight
- top loading fridge on the starboard galley + addition top loading fridge on the portside galley
- Dyneema ropes with splices, shackles and snapshackles where necessary
- hydraulic integral backstay adjuster
- transom door with electrohydraulic opening system
- mooring pack
- recessed track for the self-tacking jib

SOLARIS 68 RS standard WALNUT OXYGENATED INTERIORS

Bow Thruster model MAX POWER R300

Stern Thruster Mod. MAX POWER R300

No. 4 additional hull windows, double layer glass

Coppercoat antifouling

Tender garage with longitudinal access way, with a watertight composite structure and electric winch + rollers to drop and lift out the dinghy (3.20 m) of the water. Twin rudder with stainless steel shafts included

INTERIOR Description

Air conditioning and heating system with fancoil and thermostat in the saloon and in each cabin. The system has a 62,000 BTU cooling capacity and inverter technology in order to reduce the electrical consumptions. (the heating function will work only

when the sea water temperature is above 5°C). 220V AC power supply

Crew cabin fitted with a 2 mt bed and lockers and separate head. Only possible in the 3-cabins layout

Galley's worktop in Corian, with fiddles in Corian and sinks in stainless steel

No. 2 removable chairs for the saloon

Washer-dryer

Microwave oven

Safe, key locked

ENGINE Description

180 hp engine (Volvo Penta)

3-blades folding propeller, Gori (without overdrive function)

Rope cutter on the propeller shaft

NMEA interface to visualize the Volvo Penta engine data in the plotter

GENERATOR Description

13.5 kw Onan generator with exhaust water separator

SOLARIS 68 - EZC - Easy Sailing

DECK Description

Side decks covered with teak (grey caulking)
Coachroof covered with teak (grey caulking)
Bathing platform ~~teak~~ covered with teak (grey caulking)
No. 4 electric winches model Harken Custom 990.3
NO. 1 additional electric winch model Harken Performa, size 80, complete with dedicated central box for the main sheet
Electric retractable mooring winch, Sanguineti 1000W 24V
Bimini for the guest's cockpit with snood
Bimini for the steering area with snood
Folding gangway in pre-preg carbon fibre, white painted, 2.20 m long, with stainless steel terminals and double fixing socket on deck
Cockpit table with extension teak wings and storage box
Cushions for the cockpit seats (including backrests)
Cushions for the aft sundeck area
No. 4 stainless steel folding cleats, price difference with the standard ones
No. 2 stainless steel folding cleats amidships
Stainless steel gate in the life lines (portside)
Stainless steel gate in the life lines (starboard)
Dyneema lifelines, Gottifredi Maffioli
Additional cockpit control for the windlass
Painting of the hull with high quality polyurethane products, metallic colours, in place of the white-gelcoat standard finish (hull post curing included)
No. 2 additional portholes in the cockpit, for the aft cabins
Protection covers for the steering wheels
Protection cover for the cockpit table
Protection covers for the steering consoles
No. 2 stainless steel grabrails on deck, at the entrance
Folding anchor arm (manually operated). It excludes the possibility to mount the carbon bowsprit
Side swimming ladder, in stainless steel
Removable teak foot rests

WATER SYS Description

No. 2 electric toilets model Planus 24v (fresh water flush system)

COOLING Description

Fridge bottle holder for the cockpit table

STEERING Description

Carbon steering wheels, in place of the standard ones
Integrated consoles on the steering pedestals for instruments (plotter 9"), compass, different controls and grabrails
GRP bracket for the plotter to be placed on the cockpit bottom
Volvo Penta electronic engine control on the starboard console

RIG Description

Hall Spars carbon mast and boom including rod rigging, Quikvang solid vang, Harken mainsail switch track, spreaders and boom lights, running rigging, packaging and transport, instead of the standard one
Carbon furling boom by Hall Spars (electric system), painted finish. Upgrade to item 10.02
Bamar TD electric jib furler, as price difference with the standard one
EC6 carbon rigging (rod headstay and Kevlar backstay)
Staysail equipment including: no. 1 inner forestay (Kevlar) provided with extension and fixing point on deck, no. 2 Kevlar checkstays and hydraulic ram under deck (sail excluded)
No. 2 bags for halyard in cockpit
Electric code 0 furler by Reckmann, combined with swivel by Ubi Maior
Gear for Gennaker and Code, including blocks and one set of sheets
Mainsail halyard 2:1

SOLARIS 68 - EZC - Easy Sailing

ELECTRICAL SYS Description

No. 2 additional 115 Ah (C20) batteries for the services, 24V

No. 6 additional 220V sockets

Electric inflator for the tender, 24V

USB socket (12 Volt), unit price

No. 1 12V socket at the nav. station

Indirect lighting in the master cabin and in the aft cabins

Indirect lighting in the saloon

Indirect lighting in the galley

NAV.ELECTR. Description

B&G H5000 navigation pack including: 2 display H5000 GFD, H5000 Hydra software, autopilot keypad H5000, H5000 power computer, 24V rotary mechanical drive, Triton-2 display for the analogue wind direction, VHF model V50 including second unit H50 in cockpit

Additional H5000 GFD display, B&G

B&G maxy displays: no. 3 30/30 H5000 Triton with aluminium bracket at mast (black anodized)

GPS antenna model ZG100 NK2, B&G with integrated rate compass and 10 Hz Simnet output

Broad band radar antenna model B&G 4G (installed at mast)

Access Point WI-FI Simrad Go-Free. It allows to control the Zeus multifunction displays through an APP downloaded on a smartphone or tablet

Simrad Transponder AIS NAIS-500 class B, connected to the multifunction display Zeus-3 series, including splitter model Simrad NSPL-500

Router WIFI Peplink Br-1 + antennas on the lower spreaders

Carbon bracket by Hall Spars for the displays at mast (recommended for the carbon mast)

ENTERTAINMENT Description

Flat TV with Banten antenna at mast (saloon, starboard)

TV lift mechanism in the saloon

Removable option for the antenna's pole (in addition to item 13.04)

Music system including: Fusion MS-UD755 unit with AM/FM tuner, slot for i-Pod, i-Phone and Android devices, external USB socket. Saloon and cockpit loudspeakers. The Fusion unit can be controlled via the Raymarine/B&G

touchscreen displays. (This device, if connected via access-point wi-fi Raymarine or B&G, can be wi-fi controlled by a specific application IOS or Android). Remote control by App Fusion Link via Bluetooth connection and/or external WiFi, not included

MISCELLANEOUS Description

One week training with a skipper

Export Customs Clearance Fees

Sails

Boat shrink wrapping

Shipping to Hkg

Commissioning in Hong Kong



www.solaristyachts.com

Enrico Zanella egz@solarisyachts.com