

Solaris Yachts. The range



Asia



1977

Solaris 36' - design Frans Maas.
LOA m. 11.06 - beam m. 3.72
Displacement 6,800 Kgs



1978

Rod Stephens (left)
Founder of Sparkman & Stephens Yacht Design
New York, overlooking the two tonner Rupe deck.

1979

Solaris 47' - design Sparkman & Stephens.
LOA m. 14.30 - beam m. 4.10
Displacement 12,000 Kgs



1984

Solaris One - design Doug Peterson.
LOA m. 14.19 - beam m. 4.19
Displacement 14,100 Kgs



1995

Solaris 76' DH - design Doug Peterson.
LOA m. 23.30 - beam m. 5.82
Displacement 49,000 Kgs

2003

Solaris 72' DH - design Doug Peterson.
LOA m. 21.50 - beam m. 5.64
Displacement 40,000 Kgs



2009

Solaris 60' - design Bill Trippl.
LOA m. 18.97 - beam m. 5.15
Displacement 24,000 Kgs



2017

Solaris 68' - design Javier Soto Acobal.
LOA m. 20.80 - beam m. 5.50
Displacement 28,800 Kgs



YACHTING EXCELLENCE SINCE 1974 / 5

1978

Rod Stephens (left)

Founder of Sparkman & Stephens
Yacht Design New York, overlooking
the two tonner Rupe deck.

Fondatore dello studio di progetta-
zione Sparkman & Stephens Yacht
Design di New York, al lavoro
sulla coperta del two tonner Rupe.

Der Gründer der Sparkman &
Stephens Yacht Design New York
inspiziert das Deck des Zweittonners
Rupe.



Solaris Yachts Range

ME



mistermax

SOLARIS 37

By JAVIER SOTO ACEBAL & SOLARIS DESIGN TEAM





BALTAZAR
VALPARAISO

SOLARIS 44

By JAVIER SOTO ACEBAL & SOLARIS DESIGN TEAM





PALUMA
VALLETTA

SOLARIS 47

By JAVIER SOTO ACEBAL & SOLARIS DESIGN TEAM

Interior with LUCIO MICHELETTI





SOLARIS 50

By JAVIER SOTO ACEBAL & SOLARIS DESIGN TEAM

INTERIOR By LUCIO MICHELETTI





SOLARIS 55

By JAVIER SOTO ACEBAL & SOLARIS DESIGN TEAM



SOLARIS 58

By JAVIER SOTO ACEBAL & SOLARIS DESIGN TEAM



SOLARIS 68 RS

By JAVIER SOTO ACEBAL & SOLARIS DESIGN TEAM
Interior with LALOSE-VIC & LUCIO MICHELETTI





Solaris Range Interiors





SOLARIS 37

By JAVIER SOTO ACEBAL & SOLARIS DESIGN TEAM



SOLARIS 44

By JAVIER SOTO ACEBAL & SOLARIS DESIGN TEAM



SOLARIS 47

By JAVIER SOTO ACEBAL & SOLARIS DESIGN TEAM
Interior with LUCIO MICHELETTI





SOLARIS 50

By JAVIER SOTO ACEBAL & SOLARIS DESIGN TEAM

INTERIOR By LUCIO MICHELETTI





SOLARIS 55

By JAVIER SOTO ACEBAL & SOLARIS DESIGN TEAM



SOLARIS 58

By JAVIER SOTO ACEBAL & SOLARIS DESIGN TEAM

Interior by LUCIO MICHELETTI





SOLARIS 68 RS

By JAVIER SOTO ACEBAL & SOLARIS DESIGN TEAM
Interior with LALOSE-VIC & LUCIO MICHELETTI





Solaris Range specifications

MF



DECK PLAN.

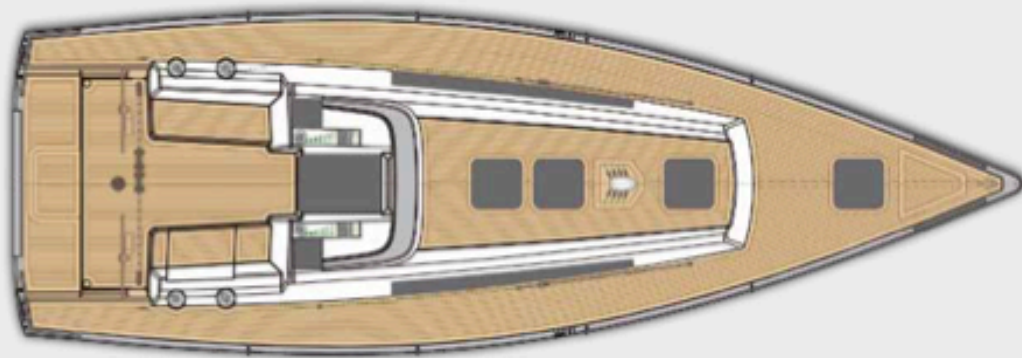

INTERIOR PLAN.

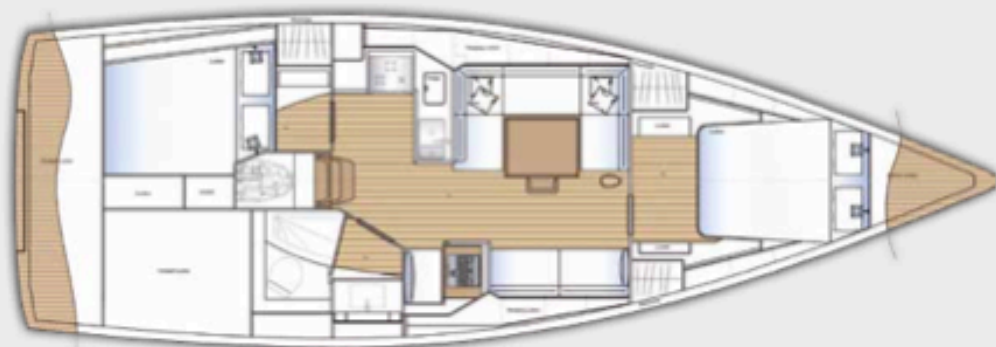

SOLARIS 37'

LOA	11.40 M
LWL	10.45 M
BEAM	3.85 M
DRAFT	2.40 - (2.10 OPTIONAL) M
DISPLACEMENT	7,400 Kg
BALLAST	2,700 Kg
SAIL AREA	82 (OPTIONAL) M ²
MAINSAIL	47 M ²
JIB	35 M ²
I	13.20 M
P	13.40 M
E	5.50 M
J	4.08 M
ENGINE	VOLVO PENTA SAILDRIVE 30 (40 OPTIONAL) HP
WATER TANK	320 L
FUEL TANK	210 L
CE CERTIFICATION	RINA OCEAN CATEGORY A
DESIGNER	JAVIER SOTO ACEBAL
INTERIOR AND STRUCTURAL	SOLARIS DESIGN TEAM



DECK PLAN.

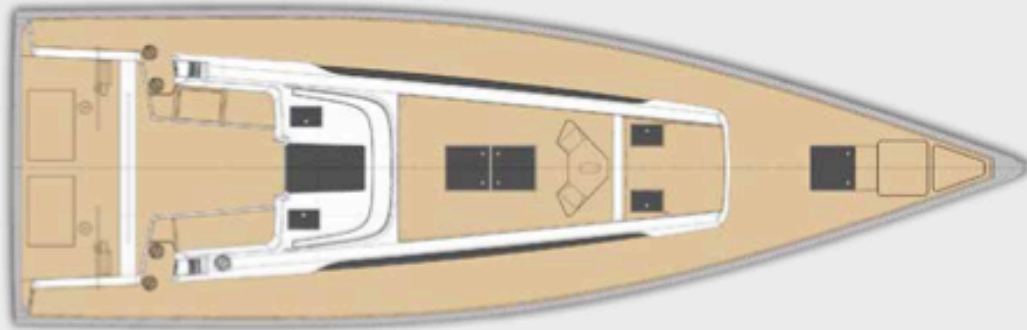

INTERIOR PLAN.



SOLARIS 44'

LOA	13.35 M
LWL	12.71 M
BEAM	4.18 M
DRAFT	2.60 (2.40 OPTIONAL) M
DISPLACEMENT	LIGHT - 9,900 Kg
BALLAST	3,600 Kg
SAIL AREA	118 M ²
MAINSAIL	66 M ²
JIB	53 M ²
P	18.00 M
E	6.10 M
I	18.40 M
J	5.25 M
ENGINE	VOLVO D2 50 (D2-60 D2-75 OPTIONAL) HP
WATER TANK	380 L
FUEL TANK	220 L
CE CERTIFICATION	RINA OCEAN CATEGORY A
DESIGNER	JAVIER SOTO ACEBAL
INTERIOR DESIGNER	SOLARIS DESIGN TEAM
STRUCTURAL	SOLARIS DESIGN TEAM



DECK PLAN.



INTERIOR PLAN.

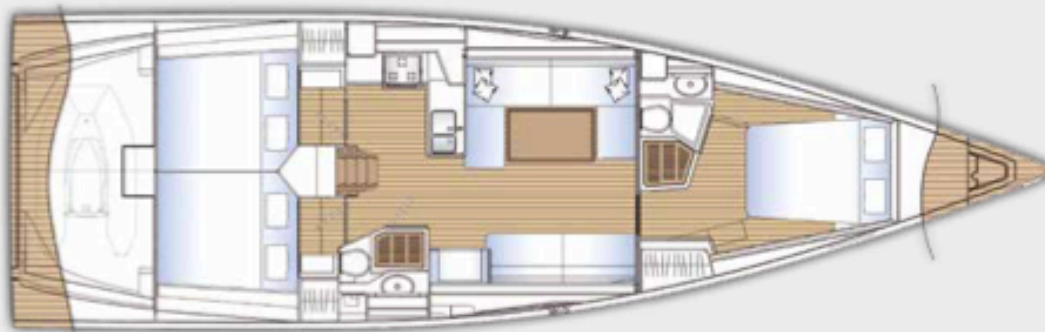

SOLARIS 47'

LOA	14.35 M
LWL	13.40 M
BEAM	4.36 M
DRAFT	2.80 (2.50 OPTIONAL) M
DISPLACEMENT	LIGHT - 12,600 Kg
BALLAST	4,320 Kg
SAIL AREA	129 M ²
MAINSAIL	70 M ²
JIB	59 M ²
P	19.05 M
E	6.50 M
I	19.60 M
J	5.475 M
ENGINE	VOLVO PENTA D2 50 S/SR (75 OPTIONAL) HP
WATER TANK	420 L
FUEL TANK	370 L
CE CERTIFICATION	RINA OCEAN CATEGORY A
DESIGNER	JAVIER SOTO ACEBAL
INTERIOR DESIGNER	SOLARIS DESIGN TEAM
STRUCTURAL	SOLARIS DESIGN TEAM

DECK PLAN.



INTERIOR PLAN.



ALTERNATIVE INTERIOR PLAN.



SOLARIS 50'

LOA	15.40 M
LWL	14.25 M
BEAM	4.55 M
DRAFT	2.80 - 2.60 M
DISPLACEMENT	14,200 Kg
BALLAST	4,900 Kg
SAIL AREA	160 M ²
MAINSAIL	85 M ²
JIB	75 M ²
P	20.48 M
E	7.00 M
I	21.65 M
J	6.05 M
ENGINE	VOLVO PENTA SD 50 (75 OPTIONAL) HP
WATER TANK	460 L
FUEL TANK	370 L
CE CERTIFICATION	RINA OCEAN CATEGORY A
DESIGNER	JAVIER SOTO ACEBAL
INTERIOR DESIGNER	SOLARIS DESIGN TEAM
STRUCTURAL	SOLARIS DESIGN TEAM



DECK PLAN.

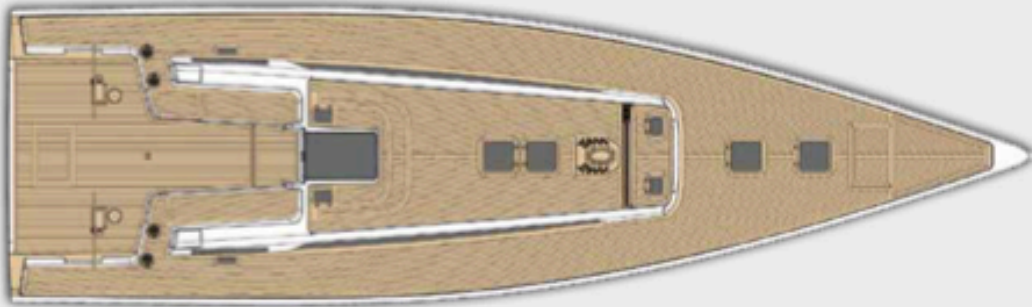

INTERIOR PLAN.



ALTERNATIVE INTERIOR PLAN.



SOLARIS 55'

LOA	16.70 M
LWL	15.78 M
BEAM	4.85 M
DRAFT	3.00 (2.70 OPTIONAL) M
DISPLACEMENT	LIGHT - 17,600 Kg
BALLAST	6,500 Kg
SAIL AREA	176 M ²
MAINSAIL	98 M ²
JIB	78 M ²
P	22.20 M
E	7.60 M
I	23.20 M
J	6.55 M
ENGINE	VOLVO PENTA 75 (110 OPTIONAL) HP
WATER TANK	475 L
FUEL TANK	385 L
CE CERTIFICATION	RINA OCEAN CATEGORY A
DESIGNER	JAVIER SOTO ACEBAL
INTERIOR DESIGNER	SOLARIS DESIGN TEAM
STRUCTURAL	SOLARIS DESIGN TEAM

PROFILE VIEW.

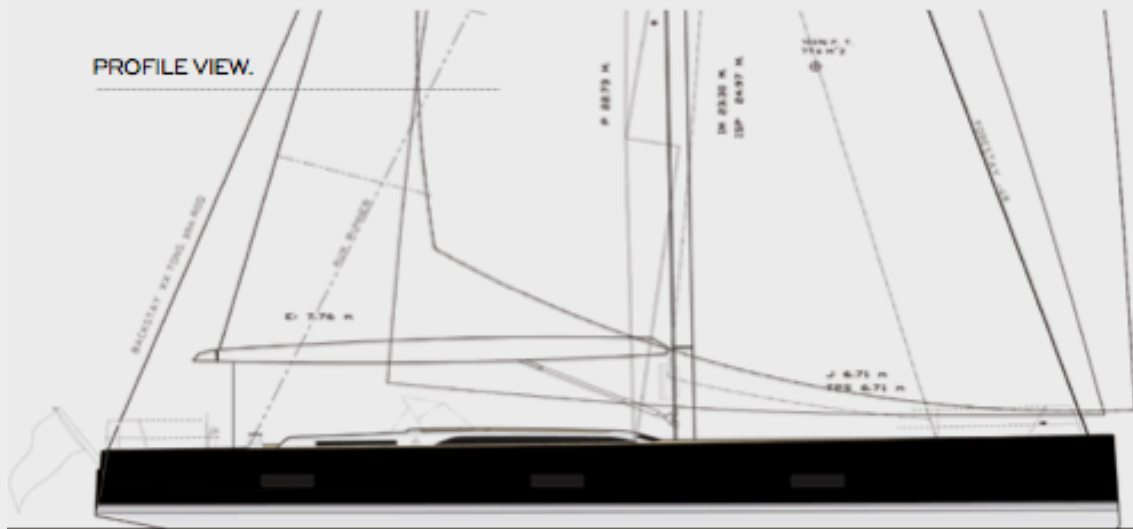

SOLARIS 58'

LOA	17.45 M
LWL	16.06 M
BEAM	5.05 M
DRAFT	3.20 - (2.85 OPTIONAL) M
DISPLACEMENT	19,500 Kg
BALLAST	6,900 Kg
SAIL AREA	189 M ²
MAINSAIL	97 M ²
JIB 106%	92 M ²
ENGINE	VOLVO PENTA SD 75 (110 OR 150 OPTIONAL) HP
WATER TANK	670 L
FUEL TANK	500 L
CE CERTIFICATION	RINA OCEAN CATEGORY A
DESIGNER	JAVIER SOTO ACEBAL
INTERIOR DESIGNER	SOLARIS DESIGN TEAM
STRUCTURAL	SOLARIS DESIGN TEAM

DECK PLAN.



INTERIOR PLAN.



INTERIOR PLANS.

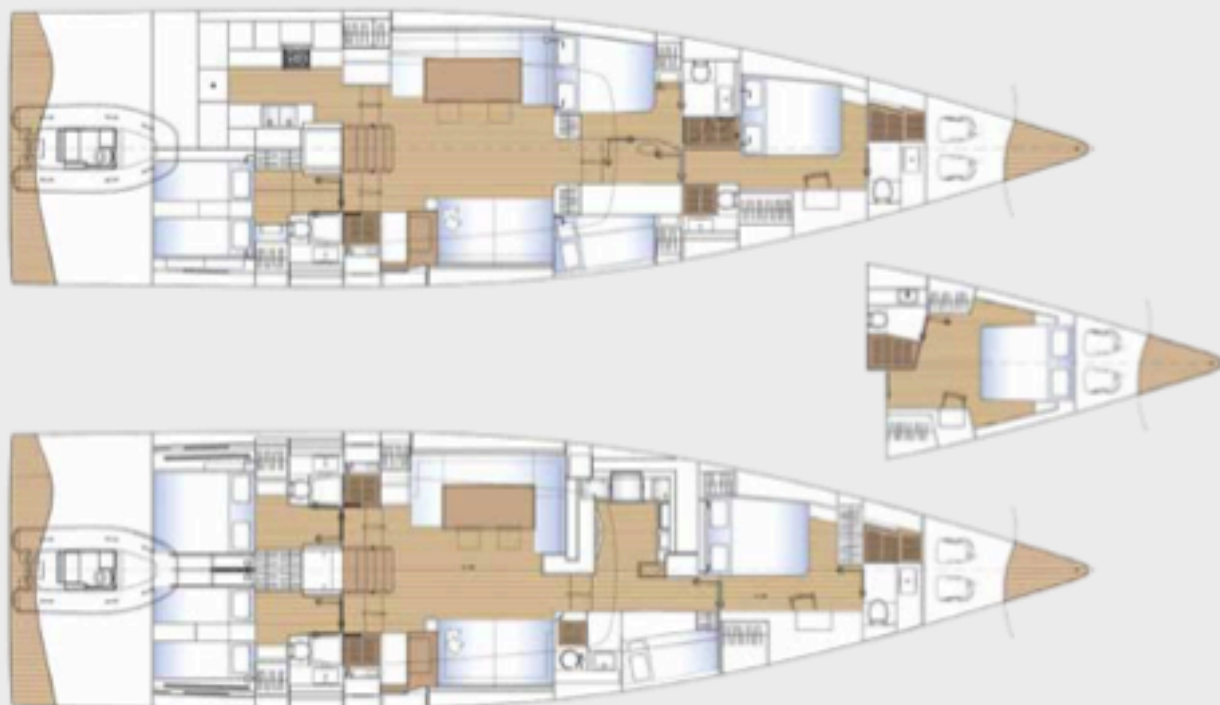

SOLARIS 68' RS

LOA	20.80 M
BEAM	5.50 M
DRAFT	3.40 (3.00 OPTIONAL) M
DISPLACEMENT	LIGHT - 28,800 Kg
BALLAST	10,400 Kg
SAIL AREA	256 M ²
MAINSAIL	146 M ²
JIB 106%	110 M ²
ENGINE	VOLVO PENTA 150 (180 OPTIONAL) HP
WATER TANK	1,000 L
FUEL TANK	930 L
DESIGNER	JAVIER SOTO ACEBAL





Solaris Yachts New Projects



(HULL AND DECK SPRINT PRE-PREG)

THE SOLARIS 64' RS

The new Solaris 64' RS is the smallest of the new exclusive line of Solaris maxi-yachts designed for extended blue water sailing. The Solaris 64' RS will be built to the traditional Solaris "monolithic" methods, which were tested by the Solaris 72' Kamana belonging to Enrico Tettamanti, who has seven years of circumnavigation, including sailing in both the Arctic and Antarctic oceans. The longitudinal access of the tender does not affect the aft cabins' volume. The cockpit layout is such that even when the table is open, a large free passage below deck is assured. It can be built in the Solaris advanced composite materials facility by using the pre-preg Sprint technology, which is the absolutely best technology for the quality of the composite, ensuring maximum longevity and safety.

IL SOLARIS 64' RS

Il nuovo Solaris 64' RS è il più piccolo della nuova serie esclusiva di maxi yachts Solaris per lunghe navigazioni in altura. Realizzata con lo storico metodo costruttivo Solaris "monolitico", testato con il 72' Kamana di Enrico Tettamanti in sette anni di circumnavigazione attorno al globo a tutte le latitudini inclusi e i mari artici ed antartici. Il tender garage è ad accesso longitudinale e non penalizza lo spazio nelle cabine di poppa. La configurazione del pozzetto è tale che anche con il tavolo aperto è possibile il passaggio sottocoperta. E' possibile costruirlo nel reparto compositi avanzati Solaris con tecnologia Sprint "pre-preg", la migliore in assoluto per la qualità del composito, che assicura: peso ridotto e massima longevità e sicurezza.

DIE SOLARIS 64' RS

Die neue Solaris 64' RS ist die kleinste der neuen und exklusiven Reihe von Solaris Maxi-Yachten, die speziell für das Segeln auf hoher See entworfen wurden. Die Solaris 64' RS wird mit der traditionellen monolithischen Bauweise von Solaris realisiert, die sich auf Enrico Tettamantis Solaris 72' Kamana während der siebenjährigen Weltumsegelung, die auch in die hohen und tiefen Breiten von Arktis und Antarktis führte, bestens bewährt hat. Der Tender wird längs im Heck gestaut und beeinträchtigt die Achterkabinen so nicht. Das Layout des Cockpits ist so großzügig, dass eine ungestörte Passage auch bei aufgeklapptem Tisch problemlos möglich ist. Die Yacht kann in der "Solaris Advanced Materials"-Produktionsstätte unter Verwendung der "Pre-Preg-Sprint"-Technologie gebaut werden. Das ist die beste Technik für die Qualität des Komposits und gewährleistet so maximale Langlebigkeit und Sicherheit.

NEW

PROFILE VIEW.

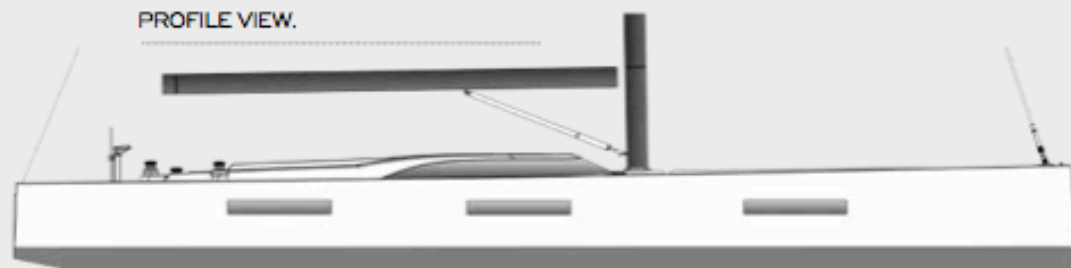

INTERIOR PLANS.A



INTERIOR PLANS.B



SOLARIS 64' RS

LOA	19.40 M
LWL	18.20 M
BEAM	5.40 M
DRAFT	3.30 - (2.90 OPTIONAL) M
DISPLACEMENT	LIGHT - 27,600 KG
BALLAST	8,550 KG
SAIL AREA	222 M ²
MAINSAIL	120 M ²
JIB 106%	102 M ²
P	24.10 M
E	8.40 M
I	25.30 M
J	7.27 M
ENGINE	VOLVO PENTA 110 (150 OR 180 OPTIONAL) HP
WATER TANK	900 L
FUEL TANK	800 L
CE CERTIFICATION	RINA OCEAN CATEGORY A
DESIGNER	JAVIER SOTO ACEBAL
INTERIOR DESIGNER	SOLARIS DESIGN TEAM
STRUCTURAL	SOLARIS DESIGN TEAM





(HULL AND DECK SPRINT PRE-PREG)

LAUNCH JULY 2019



THE SOLARIS 80' RS

The new Solaris 80' represents the top of the range in the Raised Saloon models up to 24 meters and confirms the innovation of Solaris. The boat is designed to circumnavigate the world, and has the characteristics of the maxi ocean yachts like the previous Solaris 72s, but with infinitely more comfort. The new Solaris 80' is built in the Solaris advanced composite materials facility by using the pre-preg Sprint technology, which is the absolutely best technology for the quality of the composite, ensuring maximum safety. Sailing the boat, even with a small crew, is made possible by the technologies used to facilitate the boat handling. Below deck, the interiors are semi-custom in order to meet the requirements of the clients.

IL SOLARIS 80' RS

Il nuovo Solaris 80' è da considerarsi il top nella gamma Raised Saloon sino a 24 metri e conferma la volontà di innovazione Solaris. La barca è progettata con le caratteristiche dei maxi yacht oceanici per girare il mondo come sui precedenti 72', ma con infinite comodità in più. È costruito nel reparto compositi avanzati Solaris con tecnologia Sprint "pre-preg", la migliore in assoluto per la qualità del composito, che assicura la massima sicurezza. La conduzione è semplice anche in equipaggio ridotto grazie a tecnologie che facilitano le manovre. Gli interni sono realizzati semi-custom per assecondare le esigenze dell'armatore.

DIE SOLARIS 80' RS

Die Solaris 80' RS steht für das obere Ende der "Raised Saloon" Modelle bis 24 Meter und verdeutlicht den Willen zur Innovation von Solaris. Das Boot wurde nach den Prinzipien der Maxi-Ozean-Yachten entworfen um die Welt zu umsegeln, wie schon auf den früheren 72-Fuß-Yachten, nur mit unendlich mehr Komfort. Die neue Solaris 80' wird in der "Solaris Advanced Materials"-Produktionsstätte unter Verwendung der "Pre-Preg-Sprint"-Technologie gebaut. Das ist die beste Technik für die Qualität des Komposits und gewährleistet so maximale Sicherheit. Dank der Verwendung diverser Techniken für einfaches Bootshandling, sind auch kleine Crews problemlos in der Lage, das Schiff zu fahren. Unter Deck ist das Innenlayout semi-custom um die Bedürfnisse des Eigners zu erfüllen.

NEW

PROFILE VIEW.

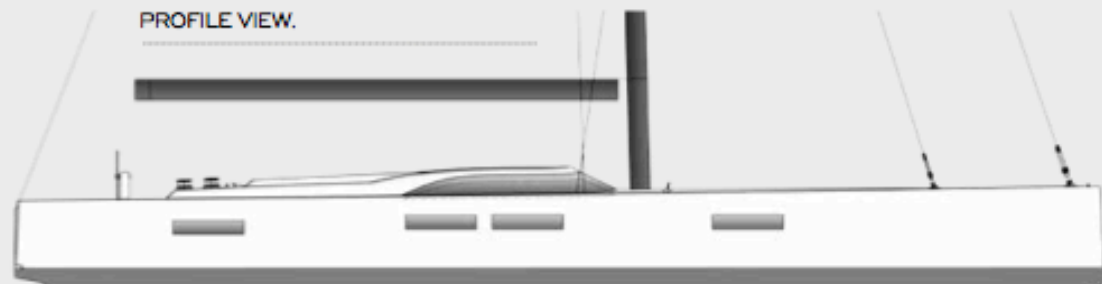

INTERIOR PLANS.



ALTERNATIVE INTERIOR PLANS.



SOLARIS 80' RS

LOA	23.98 M
LWL	22.48 M
BEAM	6.39 M
DRAFT	4.00 M
DISPLACEMENT	43,000 Kg
BALLAST	12,300 Kg
SAIL AREA	317 M ²
MAINSAIL	182 M ²
JIB 106%	135 M ²
P	29.80 M
E	10.50 M
I	31.00 M
J	9.25 M
ENGINE	FPT 270 HP
WATER TANK	1,750 L
FUEL TANK	2,000 L
CE CERTIFICATION	RINA OCEAN CATEGORY A
DESIGNER	JAVIER SOTO ACEBAL
INTERIOR DESIGNER	SOLARIS DESIGN TEAM
STRUCTURAL	ISD - INNOVATIVE STRUCTURAL DESIGN





(HULL AND DECK FULL CARBON)

THE SOLARIS 110'

The Solaris 110' finds the meeting point between performance and comfort onboard. With a lifting keel, which reduces the draft from 6m to 3.80 m, it is possible to combine a high righting moment, which still has stability and performance, with the convenience of a relatively shallow draft. The Solaris 110' is also built in the Solaris advanced composite materials facility and benefits from the evolution of the pre-preg full carbon building technology. Below deck, the interiors are completely custom and built in lightweight composite sandwich materials allowing the combination of light weight, but with interior and shapes to suit the client's requirements.

IL SOLARIS 110'

Il 110' Solaris nasce per trovare il punto di incontro fra prestazioni e comfort di bordo. Grazie ad una lifting keel di 6,00 metri per 3,80 è possibile coniugare un elevato momento raddrizzante che, favorisce la stabilità è la prestazione, con la comodità di un pescaggio contenuto. Anche il 110' è costruito nel reparto compositi avanzati Solaris e beneficia dell'evoluzione della tecnologia costruttiva "pre-preg" full carbon. Gli interni, completamente custom sono realizzati in sandwich composito alleggerito che consente di coniugare peso ridotto ad ambienti e forme richieste dall'armatore.

LAUNCH APRIL 2020

DIE SOLARIS 110'

Die Solaris 110' ist an der Schnittstelle zwischen Komfort und Leistung entstanden. Dank des Liftkiels, der den Tiefgang von 6 auf 3,80 Meter reduziert, ist es möglich, ein großes aufrichtendes Moment für Stabilität und Leistung mit einem relativ geringen Tiefgang zu kombinieren. Auch die Solaris 110' wird in der "Solaris Advanced Materials"-Produktionsstätte gefertigt und profitiert ebenfalls von der Weiterentwicklung der "Pre-Preg-Full-Carbon"-Bauweise. Unter Deck entsteht das Interieur aus leichten aber steifen Sandwichmaterialien vollständig nach Wunsch des Eigners.

NEW

SOLARIS 110'

LOA	33.60	M
LWL	31.96	M
BEAM	7.90	M
DRAFT	3.91 / 6.05	M
DISPLACEMENT	78,000	Kg
BALLAST	31,200	Kg
SAIL AREA	639	M ²
MAINSAIL	357	M ²
JIB	282	M ²
P	42.50	M

E	14.00	M
I	46.60	M
J	13.70	M
ENGINE	CUMMINS QSB 6.7 - 425	HP
WATER TANK	1,700	L
FUEL TANK	4,600	L
CERTIFICATION	RINA PLEASURE YACHTS	
DESIGNER	JAVIER SOTO ACEBAL	
EXTERIOR AND INTERIOR DESIGNER	MYT	
STRUCTURAL	ISD - INNOVATIVE STRUCTURAL DESIGN	



INTERIOR PLANS.







Enrico Zanella

Asia Representative

Mob. +852 52088518

egz@solarisyachts.com

ASIA

Hong Kong

solarisyachts.com