

Laminating Form

Make from 3/4" thick MDF

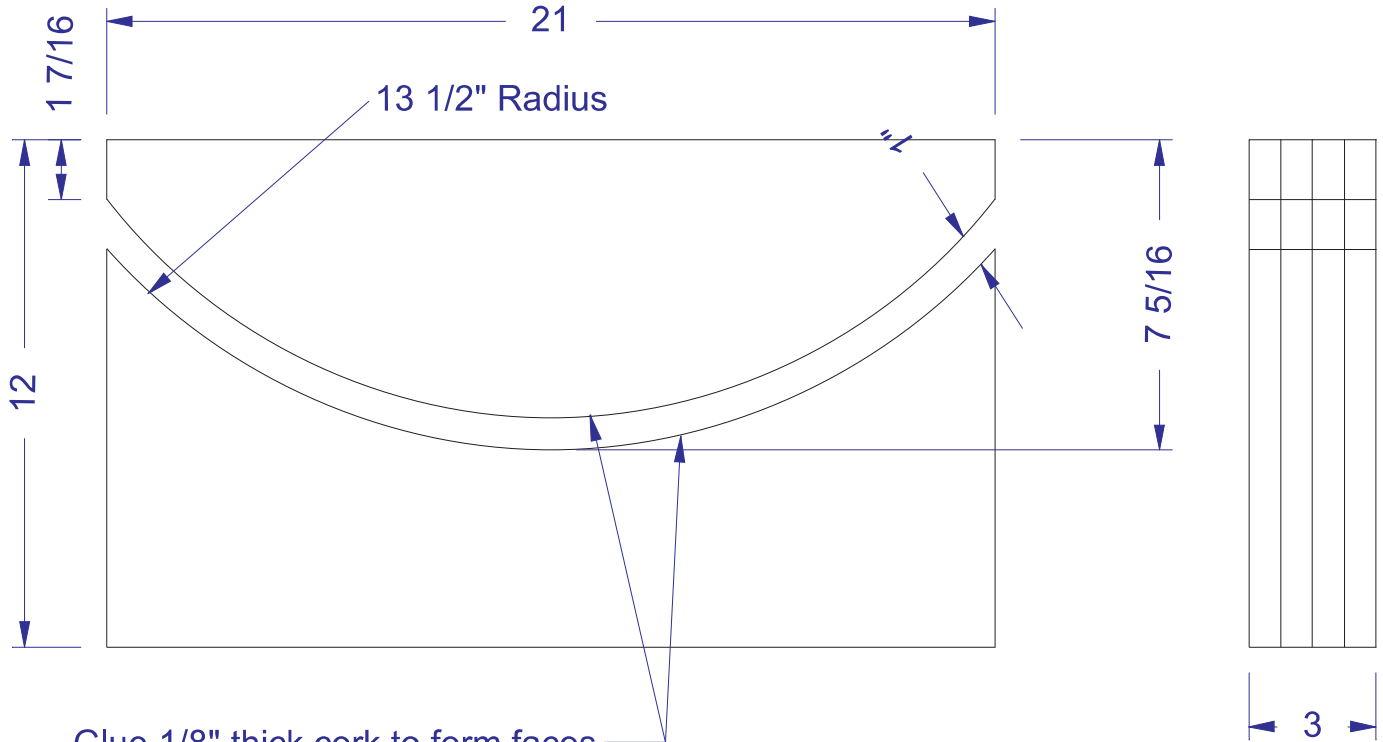

Glue 1/8" thick cork to form faces
Cover cork with packaging tape to prevent glue from sticking.

Rail Stock

(48) 1/8" thick Oak (Rails)
Rough dimensions shown

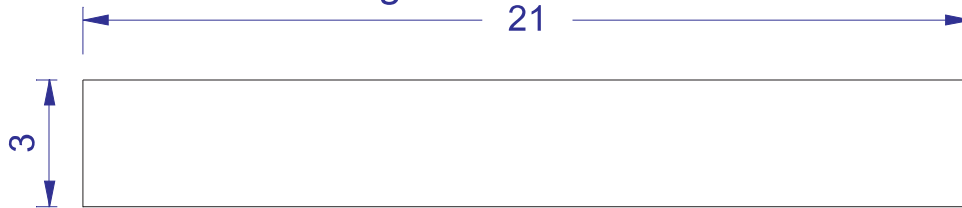

Jig For Rail Cut-off & Groove Milling

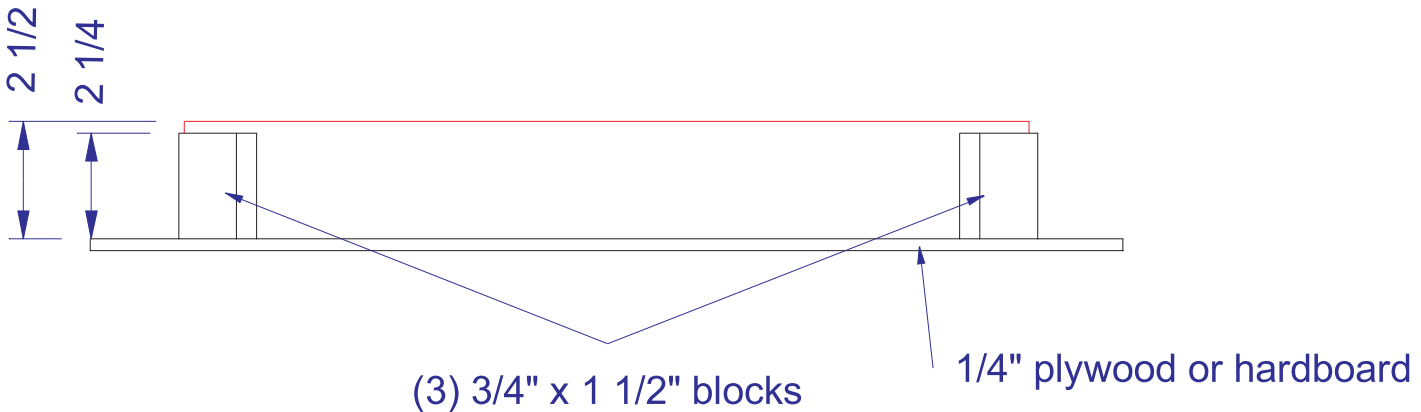
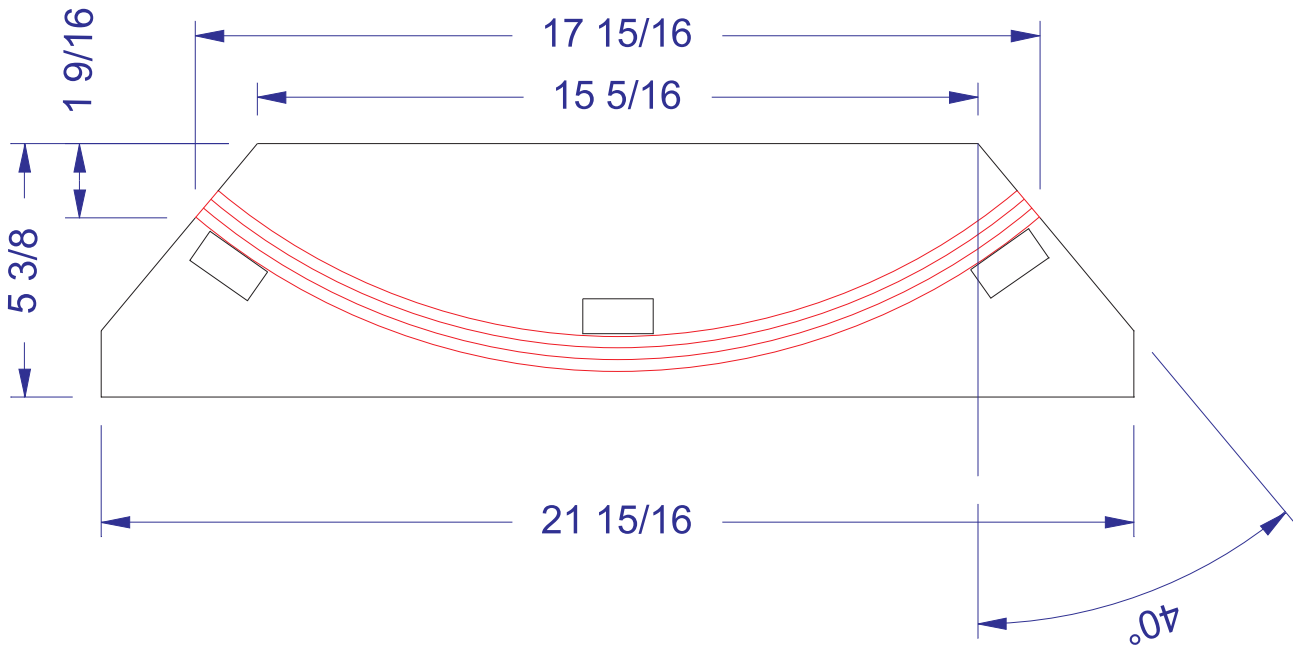

(8) Rails - Oak

Laminate from 1/8" thick Oak strips

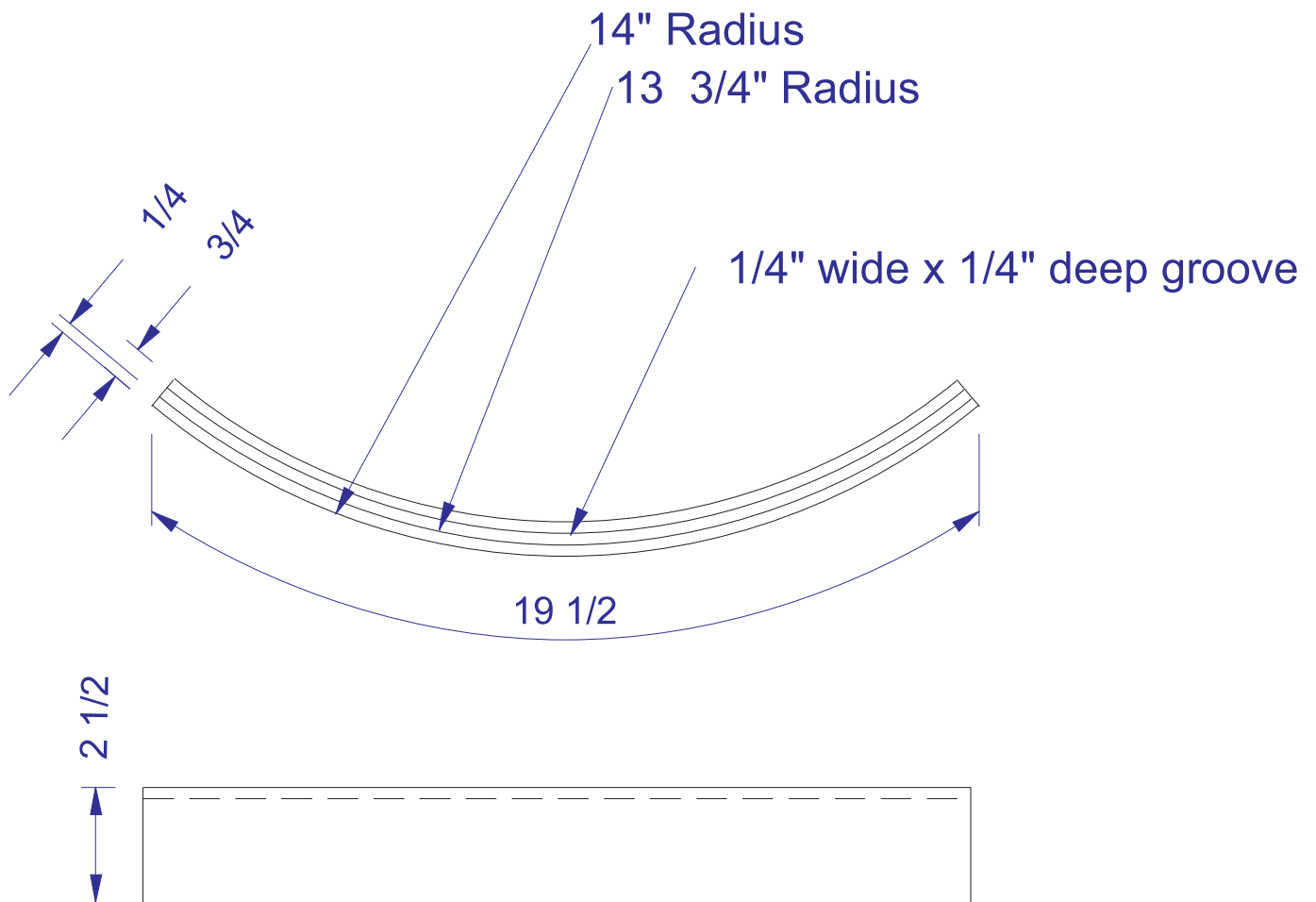

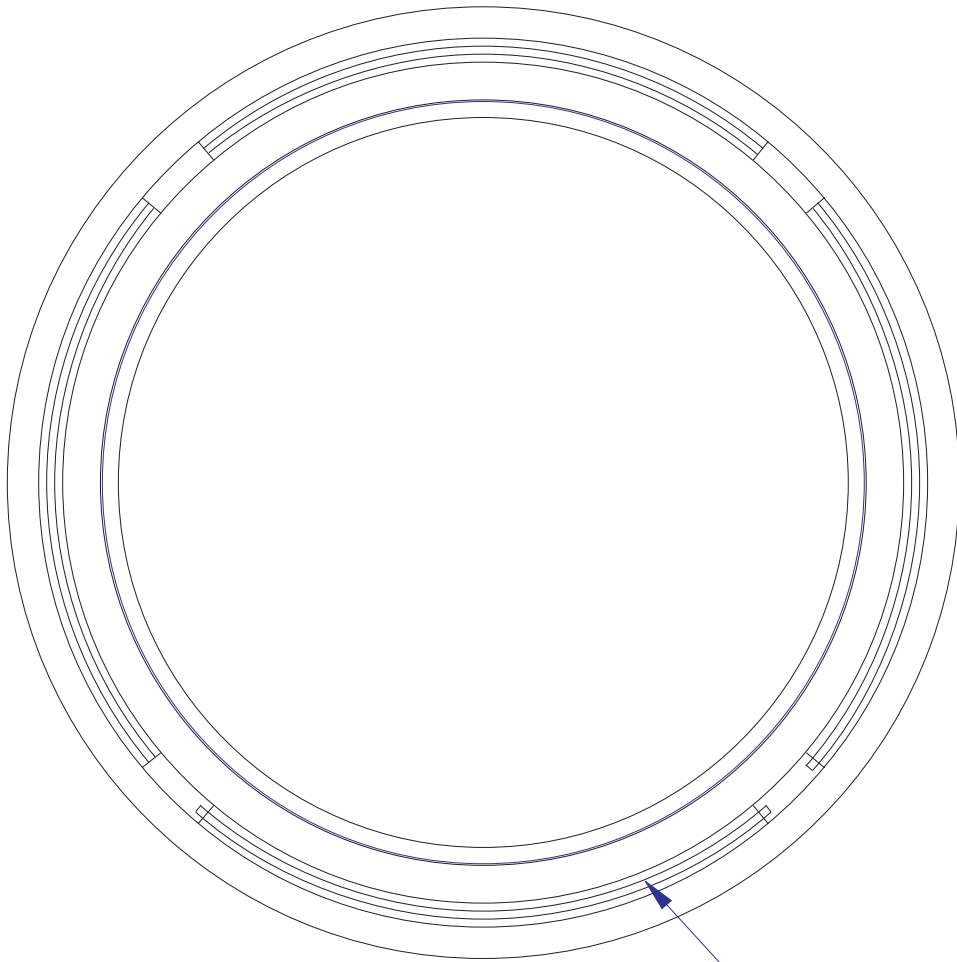

(4) 1/4" Oak Plywood Panels

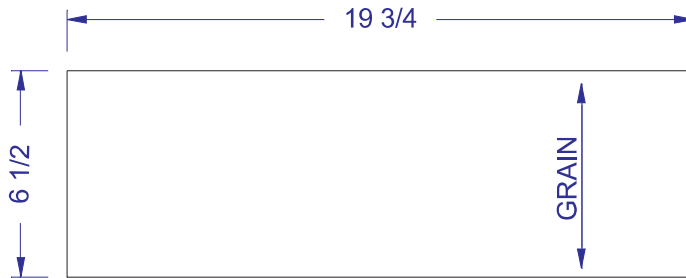

Kerf cut the back side 1/8" wide x 1/8" deep
space 1/8" apart

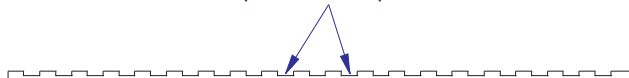

(8) Ribs - 3/4" Birch plywood

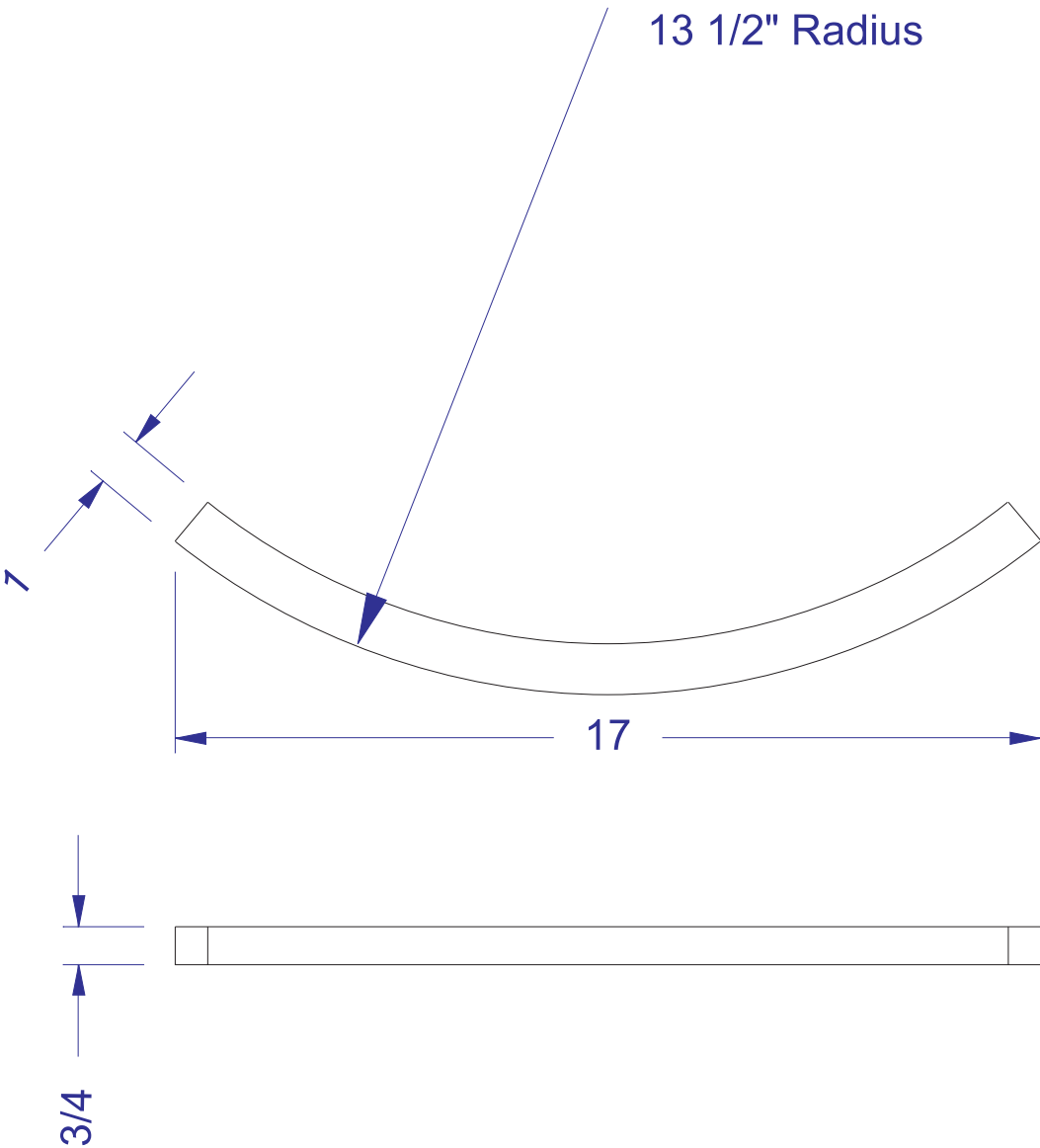

Glue ribs to plywood panels

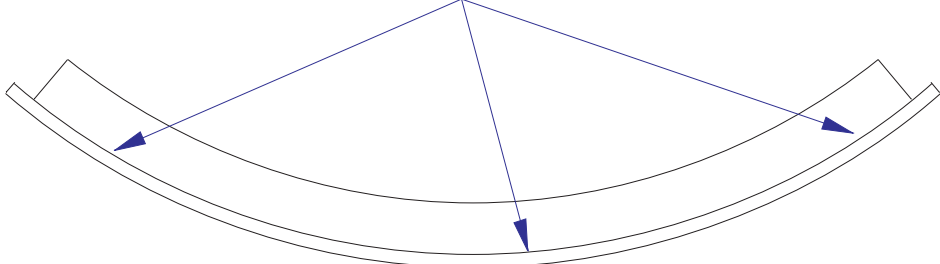

(4) Legs - Oak

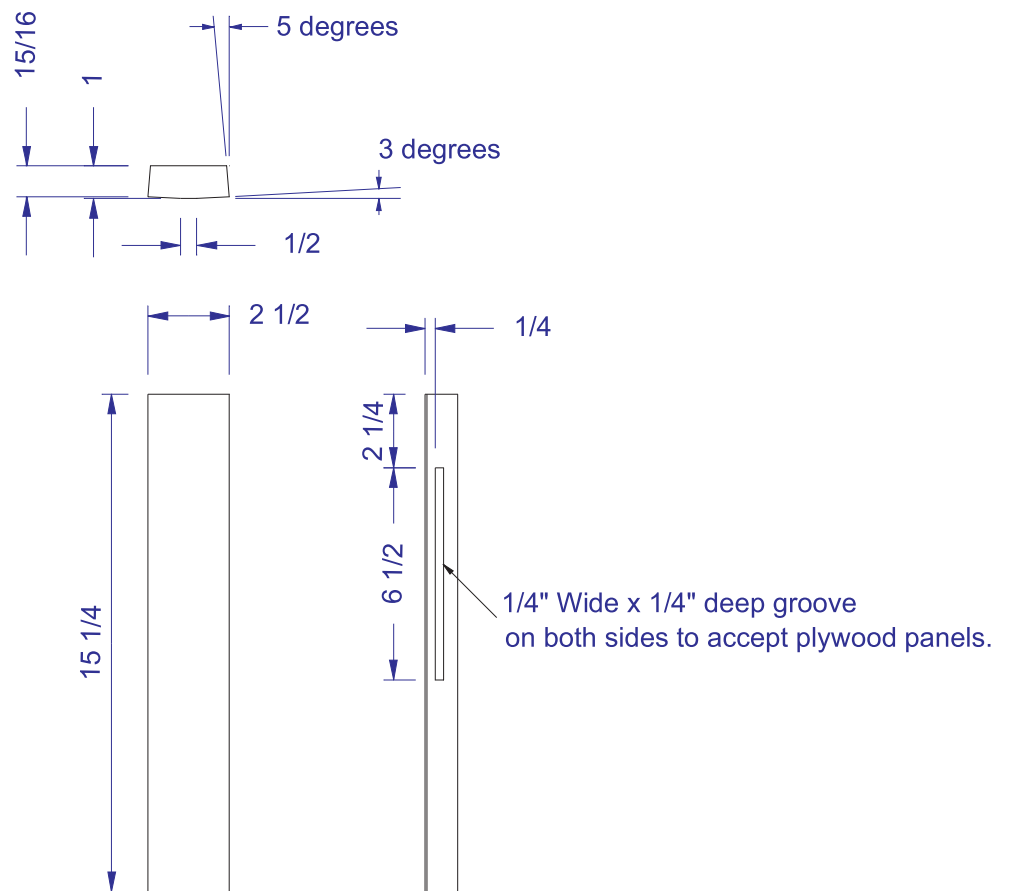

Top - 3/4 Oak

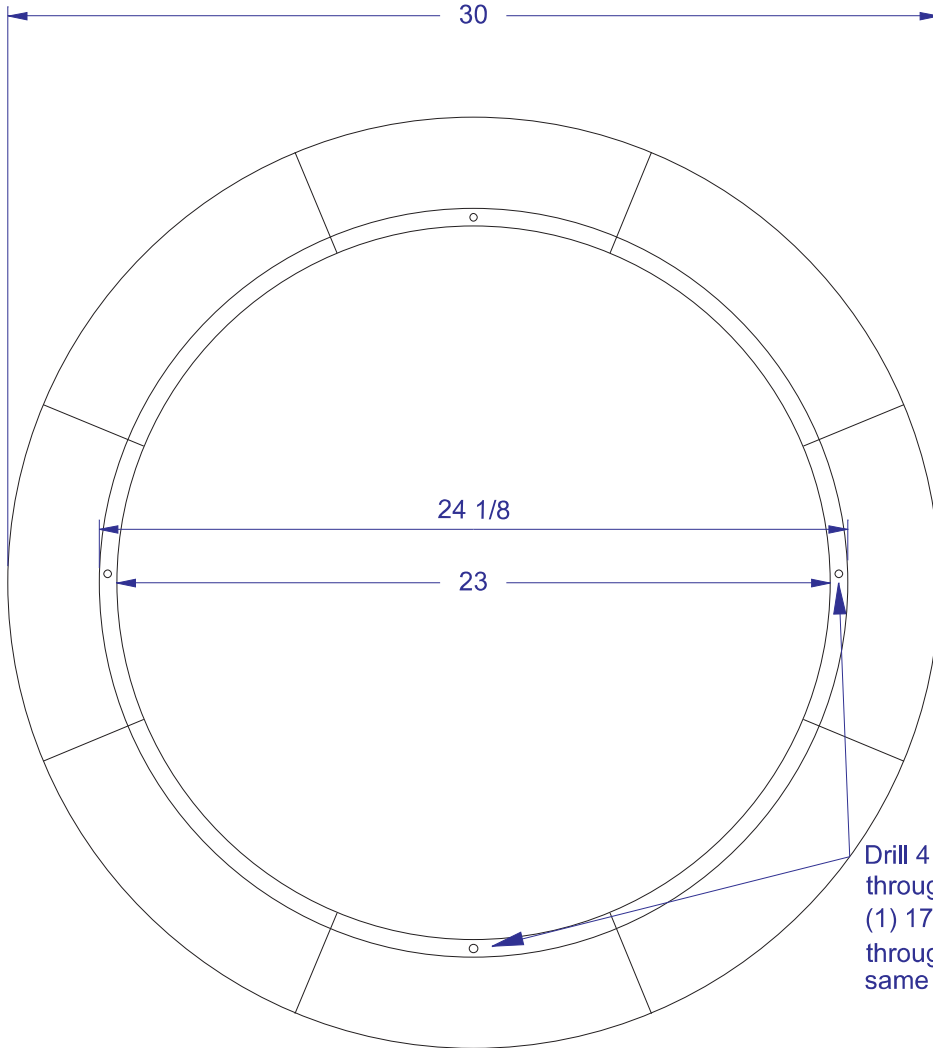

Drill 4 equally spaced holes through rabbet surface. (3) 1/4" diameter (1) 17/64" diameter. Drill these holes through the interior shelf base at the same time to insure accurate positioning.

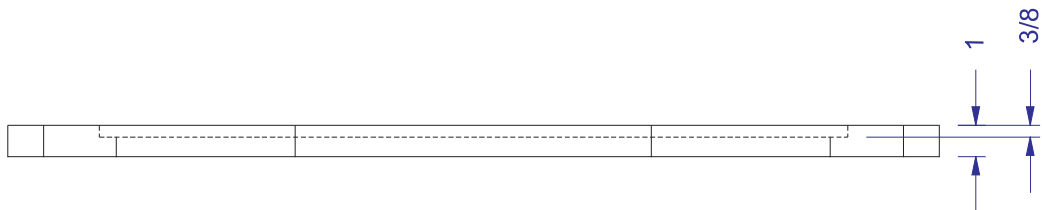

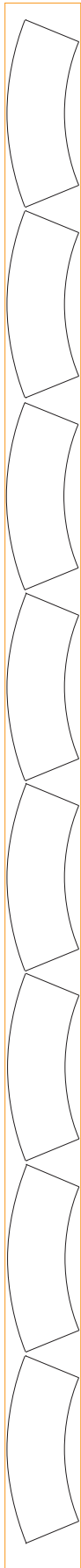

(8) Top Segments

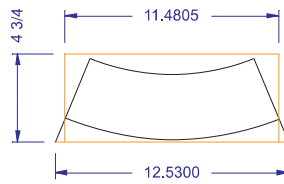
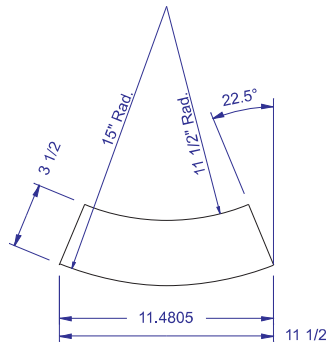

(1) Shelf top ring - 1/2" Birch plywood

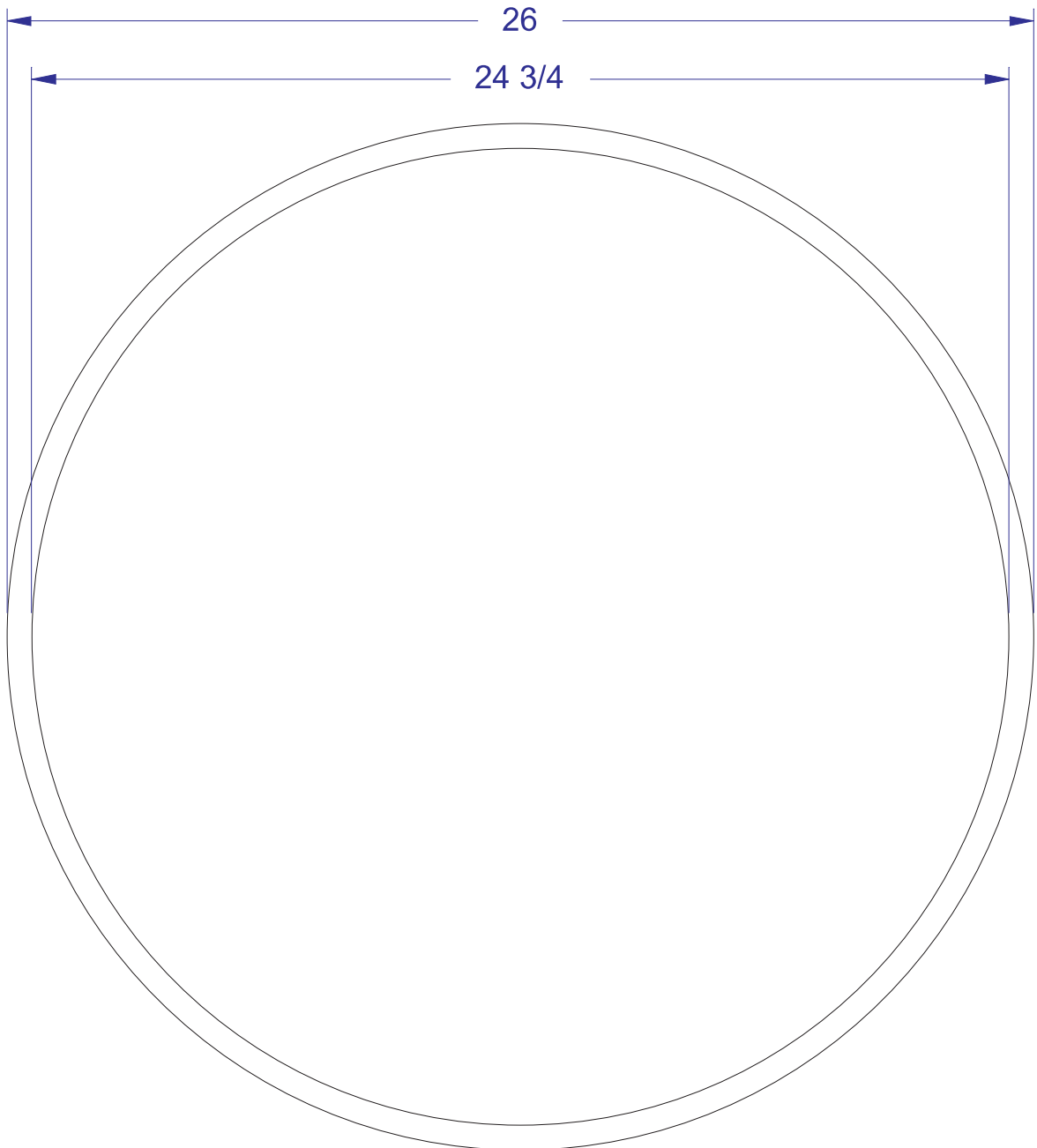
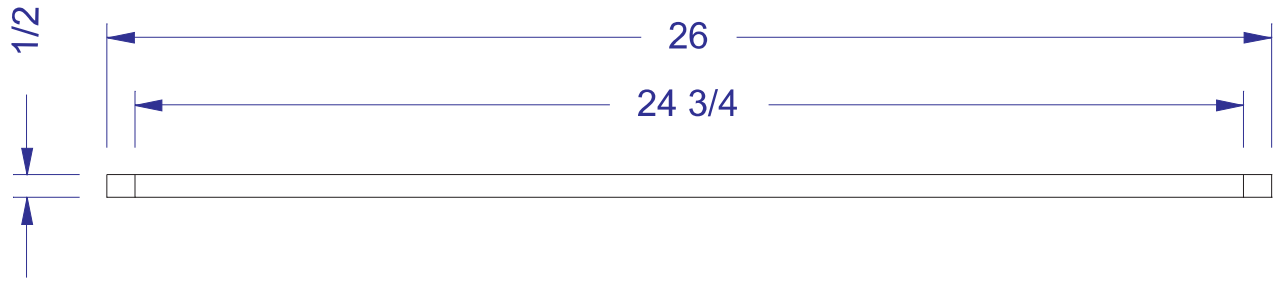

(1) Shelf bottom - 1/2" Birch plywood

1/2

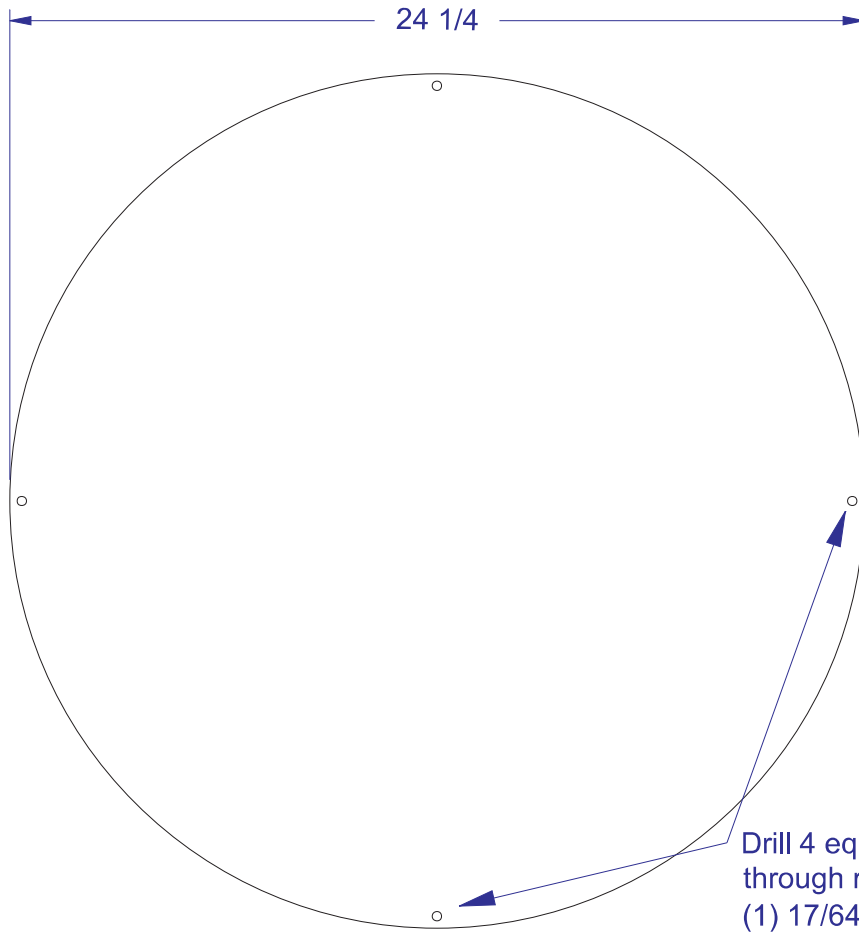
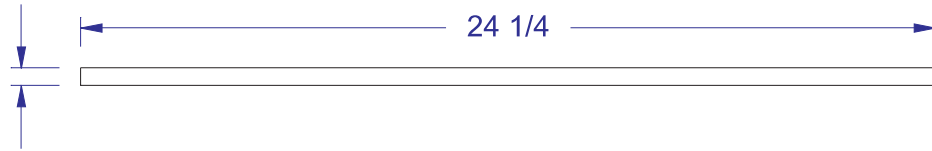

Drill 4 equally spaced holes through rabbet surface. (3) 1/4" diameter (1) 17/64" diameter.

(1) Shelf side - 1/4" Birch plywood

Kerf cut back side (outside) 3/8" -spacing
Cut long to start- fit to length during assembly

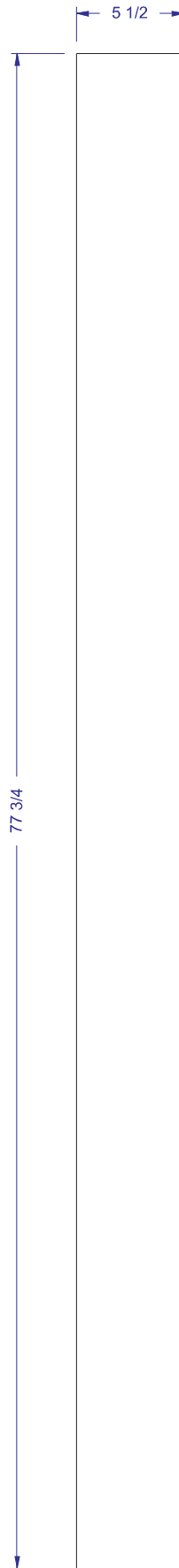

(1) Lifter Handle -Oak

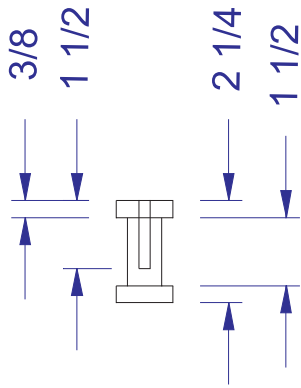
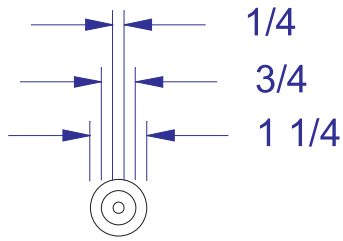

(1) Keeper - Oak

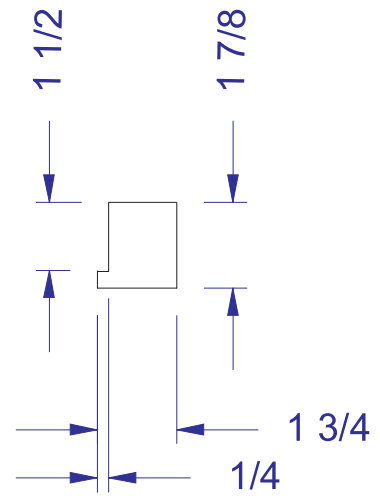
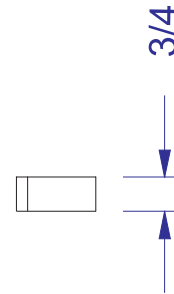

(3) Decorative Rods

1/4" Oak dowel

Cut to length during assembly



(1) Push Rod

1/4" Oak dowel

Cut to length during assembly

Glue in lifter handle



Glass Top - 3/8" thick

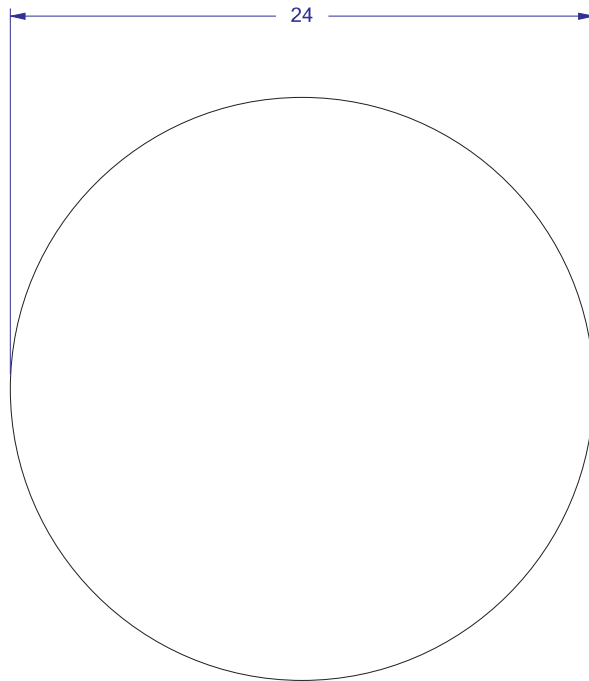

Attach top to frame with
pocket hole screws

Attach top to shelf ring with
(4) #8 x 1" sheet metal screws

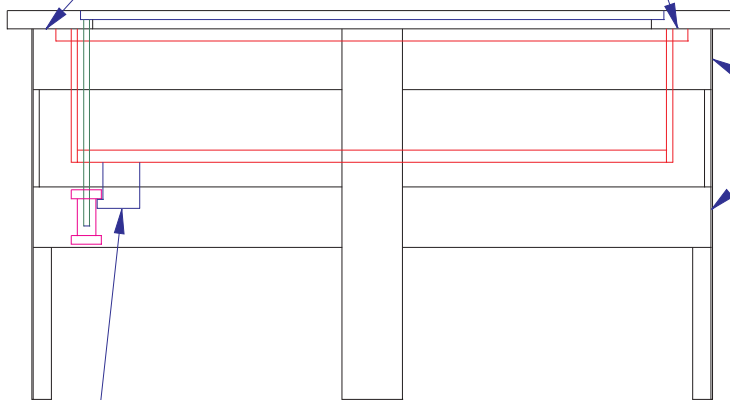

Join legs and rails with
#10 biscuits

Attach Keeper with (1)
#8 x 2" screw

