



WEATHER SHIELD.
WINDOWS & DOORS

THE **CONTEMPORARY** COLLECTION

Timeless landscapes
embraced by
modern aesthetics.



Creativity expressed in smart design.

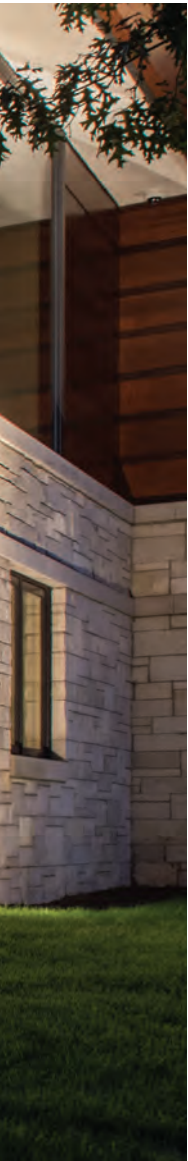

Welcome to our Contemporary Collection™. Windows and Doors with a seamless, modern aesthetic that has been flawlessly engineered and painstakingly crafted for those who reject compromise. This innovative and exceptional collection is intended specifically to enhance the expansive views of custom, high-end homes.

When your goal is to explore the boundaries of design, these windows and doors are up to the challenge.

Sophisticated styling. Sleek lines. Stunning simplicity. From the sightlines to the finishes and hardware, we've considered every element of design to achieve a true contemporary, minimalistic appearance.

Developed in collaboration with architects and interior designers, this collection brings a bold and modern aesthetic to the residential market. It's apparent throughout our extensive offerings that great care has been taken to remain true to architecturally correct contemporary design.

Two distinct frame styles Shadow line frames feature a recessed sash to create depth and dimension. Flush frames include the sash and frame on the same plane for a clean, streamlined look.

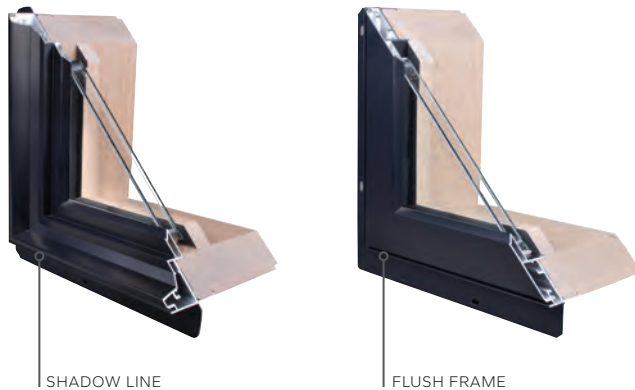

Narrow profiles now extend to our elegant doors with a slimmed-down 3 1/4" stile and rail.

Custom hardware with modern squared-off styling, now available in a wider range of finishes.





Contemporary
perfection in
every detail.



Image Courtesy of Robert M. Gurney Architect

CASEMENT WINDOWS

The views are more expansive. The hardware is more elegant. Your options are seemingly never-ending. Explore the boundaries of modern design with the next generation of casement windows.



Sizes up to 42" x 96" offer unrestricted views that open to the outdoors.

Handle sets and lock levers have clean, right-angle lines for a smart, precise feel.

Polyurethane enamel interior paint is an option for a sleek architectural finish in an array of color choices.

Push-out casements are a beautiful alternative to crank-out style windows, offering the latest technology with unmatched design.



Modern design,
free from
limitations.



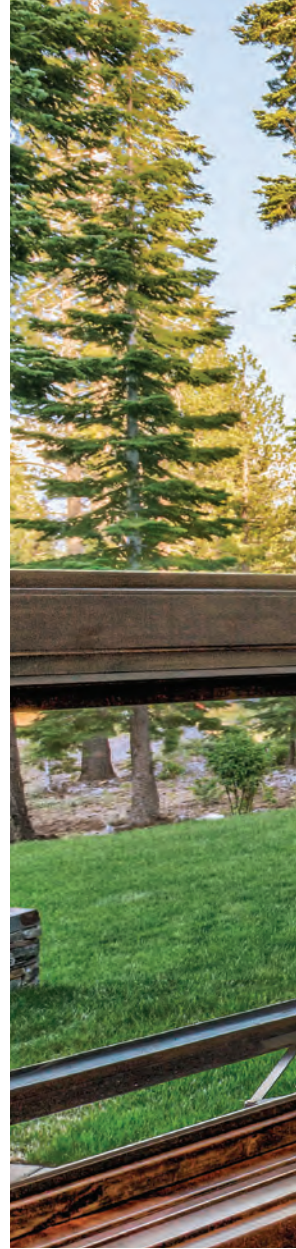

A breath
of fresh air.



Image Courtesy of Erskine Photography

AWNING WINDOWS

Minimal lines welcome daylight into the room. The hinged sash opens outward to beckon the breeze. Alone or combined into a flowing ribbon of glass, awning windows can be the functional building blocks of dramatic effect. Open easily with a push-out awning option allowing greater control of airflow.



Window frames can have a flush sash for a streamlined look, or a recessed sash to add dimension. | **Low-profile cranks** have a smaller footprint and fold neatly out of the way. | **Square glazing beads** provide a visual detail that satisfies a high-end aesthetic. **Sizes up to 60"x 60"** for more design options.



Beauty from
all angles.



Image Courtesy of Erskine Photography

90° CORNER WINDOW

Add drama to the corners of your home design by opening them up to more glass. Our 90° corner windows have a narrow 1-15/16" mullion designed to give you more view and less distraction.



144 standard sizes plus custom capabilities.

Factory glazed and ready to install.

Units can be stacked for stunning design.

Polyurethane enamel interior paint is a great finish option for dramatic interior aesthetics.

SPECIAL SHAPE WINDOWS

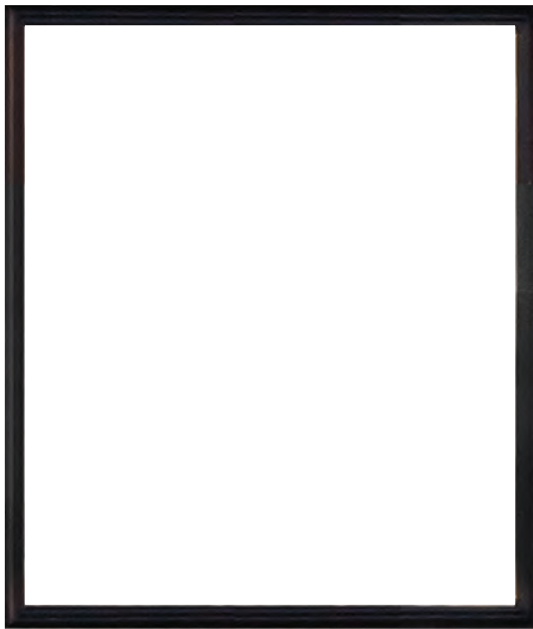

Slim-line appearance maximizes exposed glass and the admission of natural light.

Direct set design adds greater structural integrity.

Flawless craftsmanship ensures that all special shape windows are built to the highest standards.

Experience more expansive views with 70 square feet of glass available in rectangular shapes.

It can be a delicate and graceful curve. Or a sharp and compelling angle. If you can imagine the geometry, chances are we can configure a special shape window to add resounding punctuation to your design.

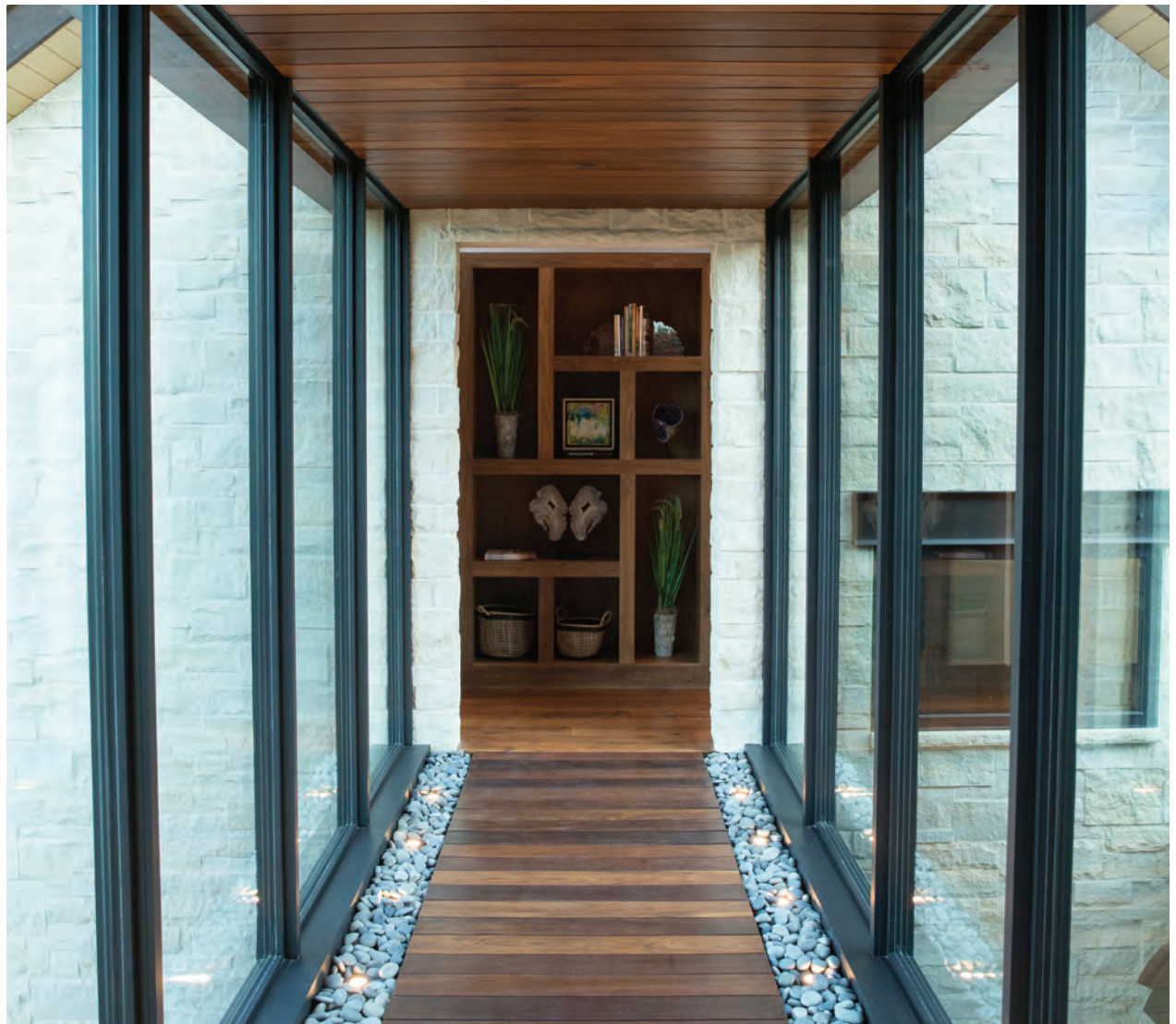

Make a statement
with striking elegance.



A modern outdoor deck with a bar and seating area, overlooking a lush green landscape. The bar features a white countertop with a sink, a glass bottle, and lemons. The deck is furnished with black stools, a white wicker chair, and a white side table. The railing is made of black metal with a wooden handrail. The background shows a dense forest of trees with green and yellow foliage.

An open invitation
to light and air.

A wonderful addition to any contemporary home, our bi-fold and multi-slide windows are a naturally beautiful way to open up to the outdoors or provide a dramatic expansion into adjoining interior spaces.

PASS-THROUGH WINDOW



Available in maximum width of 24' and height of 6'-6" for **expansive views**.

Strong 2 1/4" thick aluminum-clad wood panels provide superior structural integrity and **energy efficiency**.

Narrow 3-1/4" stiles enhance and maximize the view providing more exposed glass.



HINGED PATIO DOORS

Minimalist design meets exceptional engineering. Precise, contemporary handles complement the clean lines of the panels. Square interior profiles extend the modern aesthetic, allowing a seamless marriage of doors and windows.



Thick 2 ¼" core panels strengthen door to allow narrower rails and stiles.

Single or double doors available up to 10' tall.

Secure locking system engages on 5 points of contact for a tight seal.

Narrow 3 ¼" stile and rail maximizes the view.

Expanded hardware options featuring over 11 new designs in multiple finishes.



Clean lines,
curated elegance.





Clever engineering
drives bold exploration.



Image Courtesy of Adam Reynolds Photography

BI-FOLD DOORS

There's not a more stylish way to connect interior and outdoor spaces. With our beautifully slender bi-fold doors, you have flexible options to conceive and create expanded living areas with inspired flair.



Dramatic folding glass walls with up to 8 panels can accommodate openings over 24' x 10'. | **Narrow 3-1/4" stiles** enhance and maximize the view. | **Hinged panels** fold accordion-style to the outside along a fixed track. | **Concealed shoot bolt** system releases the shoot bolts while providing a handle for ease of operation when opening the panels.

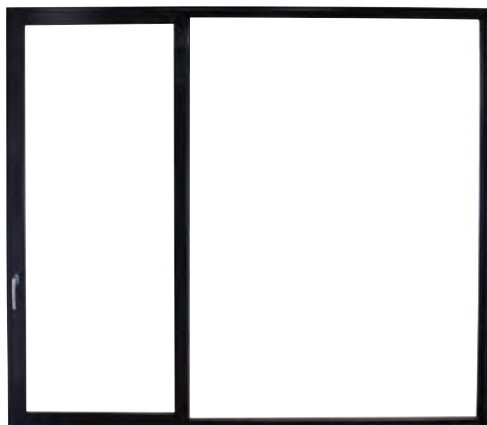

NEXT GEN SLIDING DOORS

Our reimagined Next Gen sliding patio door features narrow profiles, more glass, and a low-profile sill to achieve industry leading performance at sizes that rival the widest and tallest in the industry.

Full perimeter locking system secures the entire perimeter of the panel against a high-performance rubber gasket, providing additional security and industry leading water performance.

Low-profile, high performance sill integrates easily with finished flooring to create a seamless transition from interior to exterior, with a height of 1-1/4".

Precision bearing rollers located on the sill and head offer unmatched operation on even the largest sized doors.





Creativity
without limits.



Embrace seamless
and modern design.



SLIDING DOORS

Embrace the seamless connection between indoor comfort and the natural world outside. Create expansive, light-filled living spaces that transition effortlessly into outdoor retreats.

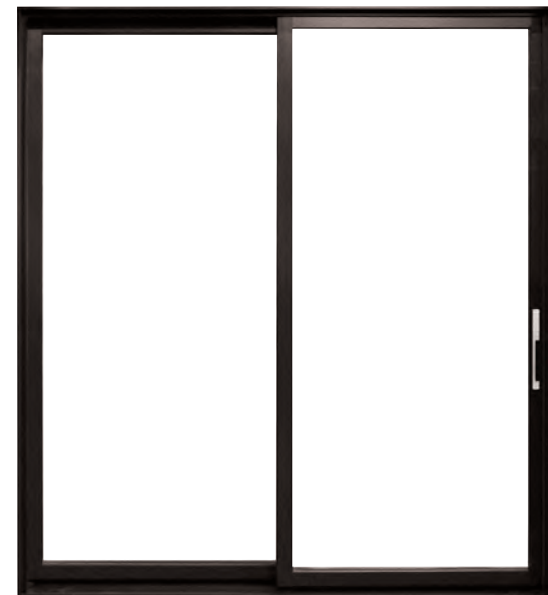

Expansive openings up to 50 feet wide and 10 feet high. | **Slim-line, modern** appearance with more exposed glass to maximize views. Door panels slide along a fixed track, allowing **variable opening widths**. | Quad roller system for **superior performance** and four stylish handle set options: Dallas, Transitional, Modern, Knurled.

MULTI-SLIDE DOORS

Accent the connection between a home and its surroundings. Design light-drenched living spaces that flow effortlessly onto outdoor lounging areas. With massive spans up to 50' wide and 10' high, our sliding and multi-slide doors let imaginations soar.



Slim-line appearance maximizes light for a natural ambiance that's warm and welcoming.

Contemporary hardware offers a clean, sophisticated look.

Multiple configurations from 2-panel slider to 10-panel pocket.

Precision bearing quad rollers are engineered with exacting hardware for effortless motion.





Sleek sightlines,
stunning views.

Five reasons
to consider
Weather Shield.



With hundreds of window and door manufacturers to choose from, it can be difficult to distinguish one company from another. We thought it might be helpful to share a few of the things that set Weather Shield apart from the rest.

Continuous innovation At Weather Shield, we never stop searching for ways to improve both our products and our processes. The goal of discovering new and innovative solutions has always been part of our DNA. That's why we have our own dedicated Research and Development Center and an extensive test lab. Not a day goes by when we aren't working on building a better product.

Trusted warranty protection At Weather Shield, we do more than talk about our dedication to craftsmanship and quality materials. We back our products with a warranty against defects in material or workmanship for a period of 20 years, and against wood rot on all clad products for 30 years.* So you can be confident you're getting an outstanding product from a trustworthy company.

Design flexibility When you design with Weather Shield, you have options. Our casements alone allow you to create more than a billion different configurations.

Choose from an impressive array of wood interiors and finishes, along with a myriad of exterior colors. We also offer some of the industry's largest expanses of glass for framing spectacular views. Whatever the style, whatever the size, Weather Shield provides many options.

Exceptional energy efficiency Through our innovative use of materials and design, we're able to offer robust efficiency with refined appearance. We're very deliberate in our use of energy efficient materials to drive performance where it matters most. We're proud to offer an extensive number of beautifully designed ENERGY STAR® rated products.

More than 70 years of experience Since 1955, Weather Shield has been committed to making windows and doors the right way – by putting our customers first. That philosophy remains at the heart of everything we do today. What began as a small operation in Central Wisconsin has grown into a trusted national window and door manufacturer.

Decades of dedication to quality and continuous improvement have helped us build lasting relationships with homeowners, builders, architects, and distributors across the country. Headquartered in Medford, Wisconsin, we invite you to discover everything Weather Shield has to offer.

WEATHER SHIELD®
WINDOWS & DOORS

*For more specific information regarding our warranty, visit weathershield.com/warranties.

EXTERIOR COLOR OPTIONS

To help you get the exact look you desire, we offer an ever-expanding palette of durable and distinct exterior color options rated to the highest industry standards for color retention.

All at the same price 60 AAMA 2605 Painted Finishes, 6 Anodized Finishes, Color compatibility with all Weather Shield products.

Anodized Aluminum Finishes



Clear



Champagne



Light Bronze



Medium Bronze



Dark Bronze



Black

Finishes and colors shown may not be actual representations. Please visit authorized Weather Shield dealer for color samples.



Image Courtesy of Ausland Interiors



60 Painted Finishes

WHITE	DUNE WHITE MATTE	ALABASTER	CAMEO	PEARL	MODERATE WHITE	LINEN	ACCESSIBLE BEIGE	TAN	SANDSTONE	DRIFTWOOD	DESERT TAN
NATURAL CANVAS	OLYMPUS WHITE	GLACIER GRAY	MIST GRAY	GRAY MATTERS	WALL STREET	GUNPOWDER	IRON MATTE	BURNT SLATE MATTE	OBSIDIAN	BLACK STEEL MATTE	JET BLACK
SUNBEAM YELLOW	SERENGETI GRASS	OATMEAL CREAM	MUSHROOM GRAY	STONE GRAY	PRESTIGE	SHALE	BRONZE GREEN	QUAKER BRONZE	TUDOR HOUSE	CRAFTSMAN BRONZE	TWILIGHT BRONZE
MOSS	ARCADIAN	WOODLAND GREEN	SAGE GREEN	BERCORTIZ GREEN	HARTFORD GREEN	SHORELINE	AEGEAN BLUE	DISTANCE	BLUE STONE	INDIGO	MIDNIGHT BLUE
TIMBERIDGE	SUPERIOR BRONZE	HERITAGE BROWN	ADOBE	APPALACHIAN BROWN	ROYAL BROWN	BOYSENBERRY	FIREBRICK	BRICK RED	ESPRESSO METALLIC	WARM SILVER METALLIC	ANTIQUE SILVER METALLIC

Custom Color Matching If you're looking for a truly original finish, choose from our custom color-match option.

Finishes and colors shown may not be actual representations. Please visit authorized Weather Shield dealer for color samples.



INTERIOR WOOD OPTIONS

Every home is different. So we give you choices to add your own special touch. Choose the wood species and stain finish that complement your design. Then add warmth and beauty with our factory finishes.

Rich wood interiors With nine wood species to choose from, there's sure to be one perfect for your home. For a truly unique look, other wood species are available upon request. All wood on our windows, inside and out, is protected by a 30-year warranty against rotting.*



PINE



ALDER
(CHARACTER)

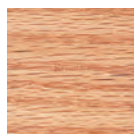

OAK (RED)

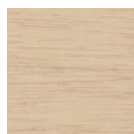

WHITE OAK



MAPLE



VERTICAL
GRAIN FIR



MIXED
GRAIN FIR



CHERRY



MAHOGANY



Finishes and colors shown may not be actual representations.
Please visit authorized Weather Shield dealer for color samples.

30 *For more specific information regarding our warranty, visit weathershield.com/warranties.

Image Courtesy of Workaday Designs



INTERIOR FINISH OPTIONS

Durable factory finishes Save time and money with our factory finishing. The wood is stained and sealed on all surfaces to repel moisture and includes two Clear Satin top coats for durability and easy cleaning.

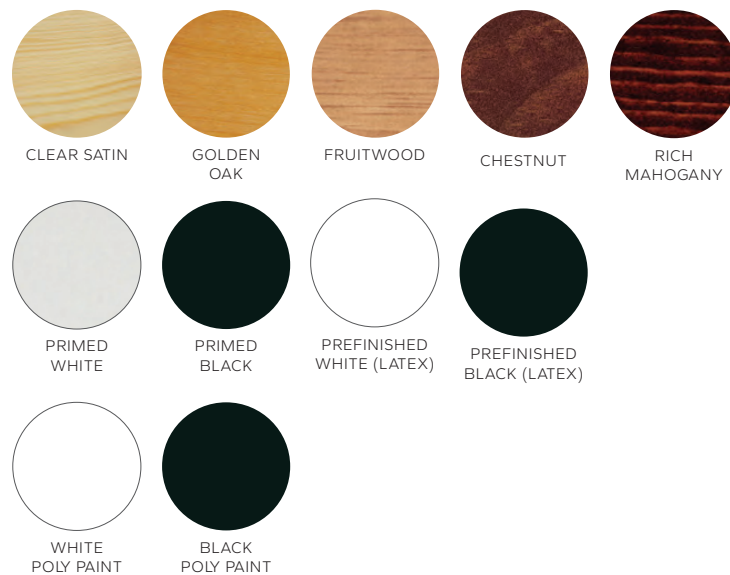

Designer stains Explore our furniture-grade stain offering created in partnership with leading paint and coatings manufacturer, Sherwin-Williams®. These new stains provide clean, vivid colors with high pigmentation for excellent clarity and uniformity.



PROUDLY FINISHED WITH
SHERWIN-WILLIAMS.

Customize interior aesthetics Vary the finish from room to room with factory-applied polyurethane enamel paints. Backed by a 10-year warranty*, our poly paints add a durable, architectural finish in any standard, designer or custom color. Units arrive finished and ready to install.

Finishes and colors shown may not be actual representations. Please visit authorized Weather Shield dealer for color samples.

*For more specific information regarding our warranty, visit weathershield.com/warranties.

GRILLES

We offer grille options to suit any design: grille between the glass (GBG) and simulated divided lite (SDL).

Grille between the glass GBG consists of aluminum muntin bars between two panes of insulating glass, giving you the look of divided lites while making window cleaning easier.

Simulated divided lite Permanently applied to the glass, SDL consists of exterior and interior grille bars, plus an aluminum spacer bar to achieve clean, three-dimensional sightlines that most owners of fine homes prefer.

Square Interior Bar Profile

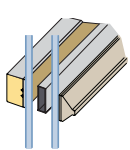

5/8" SDL

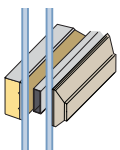

7/8" SDL

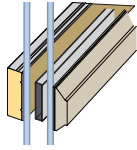

1 1/8" SDL

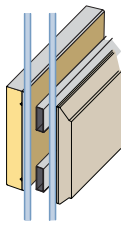

2" SDL





GLAZING

For optimal performance in any climate, we offer the most extensive selection of energy efficient glass options available. The exclusive Zo-e-shield™ glazing systems feature multiple layers of Low-E coating, inert gas-filled insulating airspace*, and ultimate energy efficiency for any climate.

Add color or texture – or privacy and modesty – to your palette of design options. Special finishes and tint can give a project distinction. Specialty glasses include bronze, gray, rain, and obscure.

Glazing Options

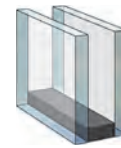

INSULATED LOW-E
All Climate
(Cardinal LoE2-272)

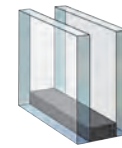

Zo-e-shield 5
Ultimate Solar Control
(Cardinal LoE3-366)

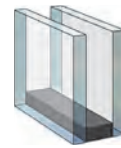

Zo-e-shield SE
Plus Room-Side Low-E
(Cardinal LoE3-366 / LoE-i89)

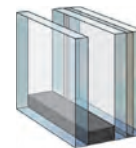

Zo-e-shield 6
Laminated Interior
(Cardinal LoE3-366 w/Lami)

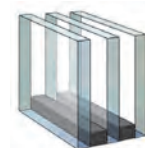

Zo-e-shield 7
Five Coats of Low-E
(Cardinal LoE3-366 w/ LoE2-272)

*Inert airspace gases not available in all states. Please visit an authorized Weather Shield dealer for availability.

SMART HOME TECHNOLOGY

Experience instant privacy at the touch of a button with CLiC™—a breakthrough in smart glass technology. Exclusively from Cardinal®, the industry's leading glass manufacturer, CLiC glass uses liquid crystal technology to switch from crystal-clear to uniformly opaque, maintaining natural light while ensuring privacy. CLiC glass can be controlled via a wall switch or integrated with home automation systems.

How it Works

Private When electricity is off, the liquid crystal forms into a light scatter layer for instant privacy while diffusing the light into a soft even glow.

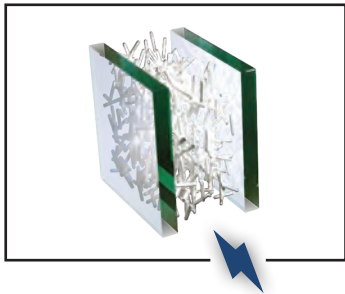

Clear When electricity is applied, the liquid crystal layer aligns itself for a crystal clear view.

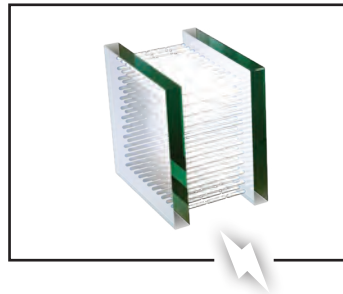



INNOVATIVE LIQUID CRYSTAL TECHNOLOGY

CLiC combines the most advanced liquid crystal science with Cardinal's proven expertise in glass manufacturing and fabrication. When it comes to privacy, clarity, switching speed and durability, CLiC stands alone.

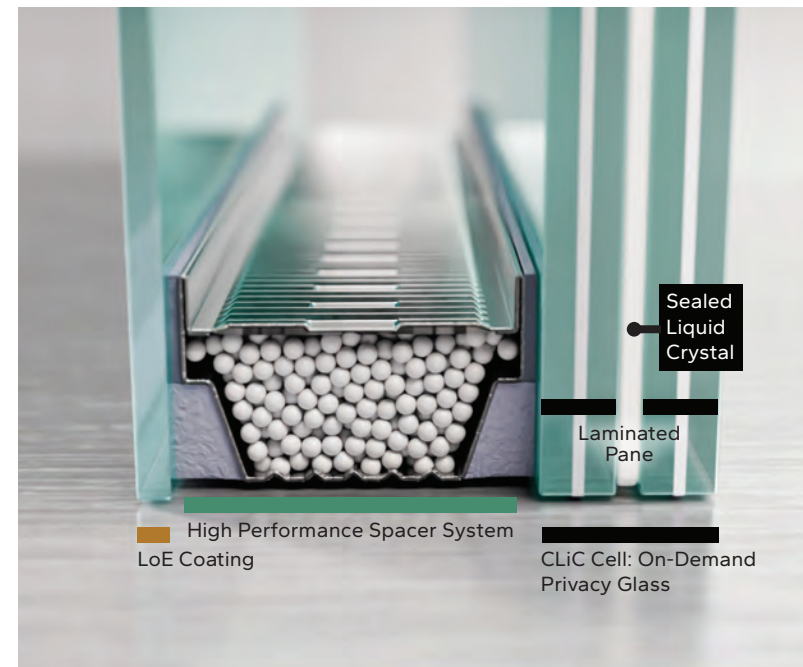

CASEMENT AND AWNING WINDOW HARDWARE

Our exclusive contemporary window handle and lock lever helps you create a consistent, seamless look throughout your interior space. The fold-away design produces a sleeker, smaller footprint that won't damage or interfere with window treatments.

Corrosion resistant hinges We use heavy gauge, stainless steel for our window hardware because this corrosion resistant material is designed to provide a lifetime of effortless operation. It's the perfect complement to expertly engineered windows, designed to last.



NESTED FOLDING CRANK HANDLE

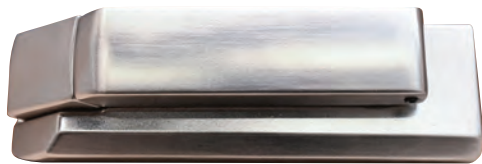

CONTEMPORARY NESTED HANDLE



TRANSITIONAL PUSH-OUT HANDLE



CONTEMPORARY PUSH-OUT HANDLE

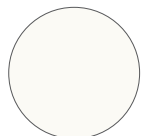

WHITE



TAN

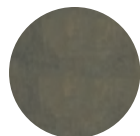

RUSTIC BRONZE**



BRIGHT BRASS



BRUSHED NICKEL**



POLISHED CHROME*



MATTE BLACK**

*Polished Chrome only available for contemporary hardware.

**Push Out hardware only available in Black, Rustic Bronze, and Brushed Nickel.





Image Courtesy of Andrew Giammarco Photography





HINGED DOOR HARDWARE

Our hinged doors benefit from exceptional hardware and unique designs. Choose from several different collections and a variety of finishes in order to achieve precisely the right aesthetic for your home.

Crafted for endurance We use only the finest materials in our hinged door hardware, including corrosion resistant stainless steel. Each piece is tailored to your home, bringing unmatched ease of use and beautiful design to your hinged patio doors.

Ashley Norton Collection



Apollo
Brass Base Finish



LIVING FINISH



Meridian
Bronze Base Finish



Baldwin Collection



Santa Monica

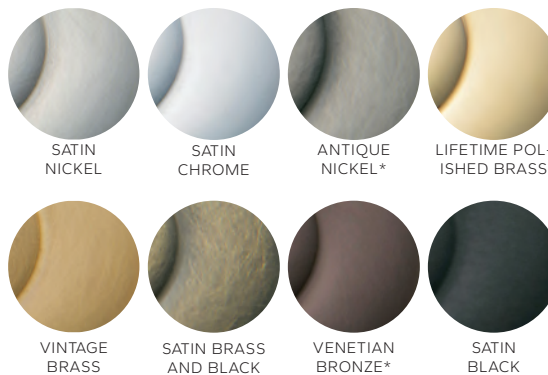

Hoppe Collection



Dallas



*Hand-relieved finish variances. Product finishes which are hand relieved may vary in luster, hue and appearance as a result of handcrafted variances in the final finishing step.

SLIDING DOOR HARDWARE

Flush hardware The narrow contemporary back plate offers a clean and sophisticated look for our multi-slide doors.

Two-point locking handle sets Available in a variety of finishes, these sliding patio door locking handles offer both stylish looks and superior security.



MATTE BLACK



RUSTIC BRONZE



SATIN NICKEL PVD*



MODERN BRASS**

*Sliding door hardware is available in Alpine Frost and Brushed Nickel, which is comparable to Satin Nickel.

**Dallas sliding door hardware is available in Brushed Gold, which is comparable to Modern Brass.

Finishes and colors shown may not be actual representations. Please visit authorized Weather Shield dealer for color samples.





BI-FOLD DOOR HARDWARE

The concealed shoot bolt system released the shoot bolts while providing a handle for ease of operation when opening the panels.

Available in an array of colors and textures to suit any user's tastes. Options range from ultra modern brushed nickel to sleek black, allowing you to achieve any desired look.

**Dallas
Handle**



**Centor Twin-Bolt
Locking System**



MATTE BLACK

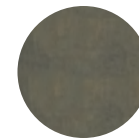

RUSTIC
BRONZE



SATIN NICKEL
PVD

A solid foundation
to build on.





HISTORY

When Edward Lee Schield designed his first window in 1955, he set into motion a company built around an inventive spirit. His enthusiasm for innovation defines Weather Shield to this day. After more than 70 years and 33 patents, Weather Shield remains faithfully focused on creating something better and purposeful.

Our Contemporary Collection of products embraces our founder's vision of combining quality craftsmanship with innovative designs and materials. This comprehensive collection features timeless aesthetics with modern energy efficiency.

ARCHITECTURAL SERVICES

Weather Shield's architectural team is here to help you solve your design challenges. Whether you're dealing with the requirements of an historic renovation, designing a one-of-a-kind configuration, or facing stringent structural or thermal demands, we're ready, willing and able to help you get it right.

To contact a specialist in our architectural consultation group, call 800.538.8836.

Business hours are 8am – 5pm CST, Monday – Friday.

Or email archservices@weathershield.com.

WEATHER SHIELD®
WINDOWS & DOORS



Image Courtesy of Coles Hairston Photography

WEATHER SHIELD®
WINDOWS & DOORS

800.222.2995
weathershield.com