

OVERALL GENERAL DEVELOPMENT PLAN

AMHERST TOWNSHIP, COUNTY OF LORAIN, STATE OF OHIO

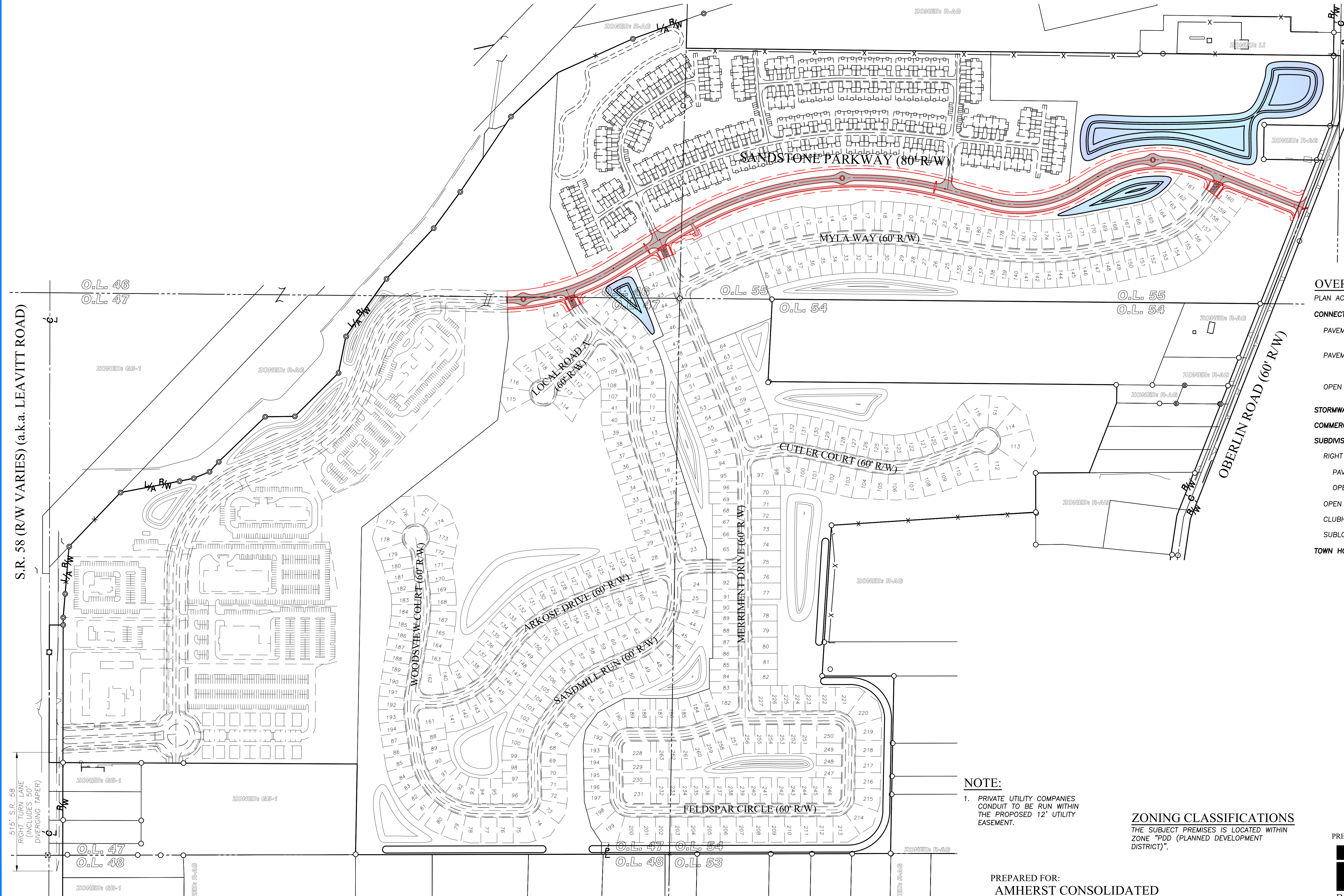
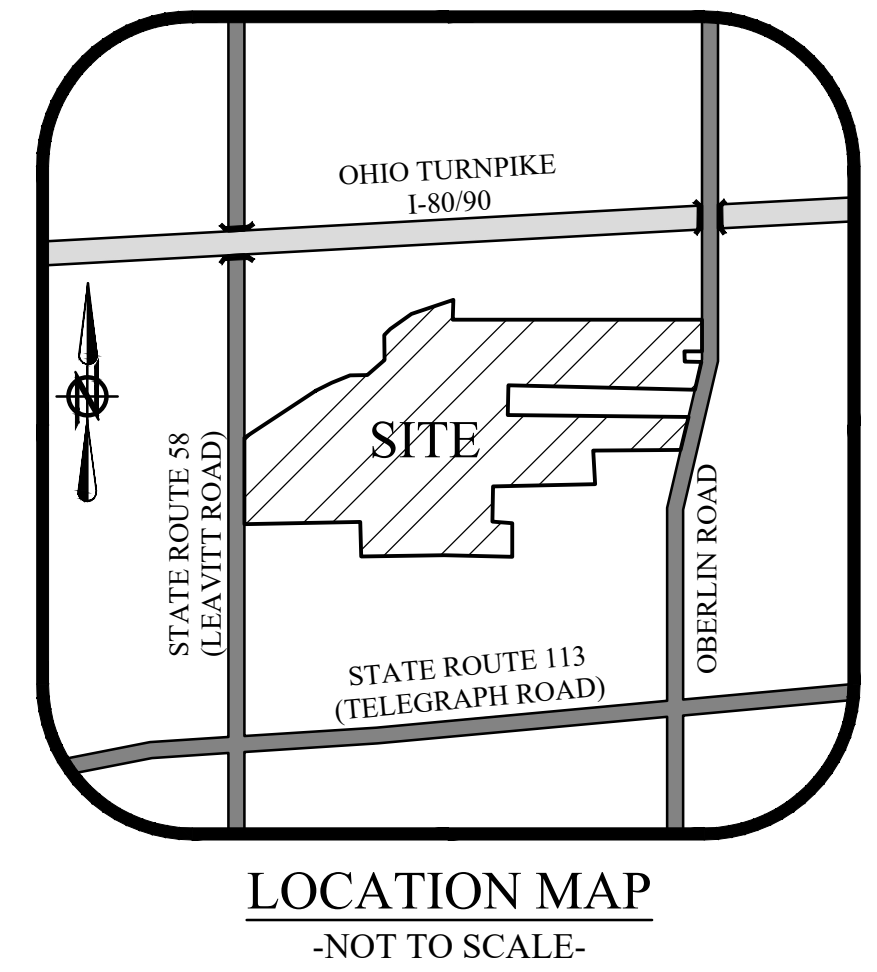

OVERALL BREAKDOWN

PLAN ACREAGE	260.6 ACRES
CONNECTOR ROAD AREA (PHASE 1 & 2)	13.5 ACRES
PAVEMENT/PATH AREA (PHASE 1)	3.2 ACRES
ROADWAY LENGTH (PHASE 1)	3,655 L.F.
PAVEMENT/PATH AREA (PHASE 2)	3.1 ACRES
ROADWAY LENGTH (PHASE 2)	3,399 L.F.
OPEN SPACE AREA	7.2 ACRES
STORMWATER MANAGEMENT BLOCK	13.4 ACRES
COMMERCIAL AREA	54.3 ACRES
SUBDIVISION AREAS	147.5 ACRES
RIGHT OF WAY AREA	20.1 ACRES
PAVEMENT/WALK AREA	12.0 ACRES
OPEN SPACE AREA	8.1 ACRES
OPEN SPACE AREA (BLOCKS)	55.3 ACRES
CLUBHOUSE AREA	1.8 ACRES
SUBLOT AREA	70.3 ACRES
TOWN HOMES AREA (REDWOOD)	31.9 ACRES

NOTE:
1. PRIVATE UTILITY COMPANIES CONDUIT TO BE RUN WITHIN THE PROPOSED 12' UTILITY EASEMENT.

ZONING CLASSIFICATIONS
THE SUBJECT PREMISES IS LOCATED WITHIN ZONE "PDD (PLANNED DEVELOPMENT DISTRICT)".

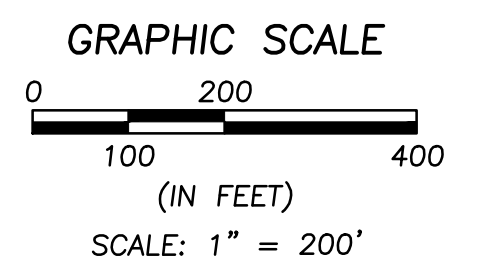

PREPARED FOR:
AMHERST CONSOLIDATED PROPERTIES, LLC

PREPARED BY:
BRAMHALL
ENGINEERING AND SURVEYING COMPANY
801 MOORE ROAD AVON, OHIO 44011
(440) 934 - 7878 (440) 934 - 7879 FAX
DATE PREPARED: 04-01-2022
SHEET: 1 OF 4
JOB NO. 19-5052B

J:\195052B Perpetual Development\DRAWINGS\General Development Plan\2022-03-30 General Development Plan.dwg, Plotted: Apr 01, 2022, - 12:10m