

ROZIER DESIGNER HOMES LLC

The Cliff Hanger 2.0 is a unique design exclusively through Rozier Designer Homes LLC. The total living space of this home is 2,280 square feet of living.

This home features Jeld - Wen Windows which are considered one of the best in the industry.

The front of this home shall feature 5/16" Stucco panels sealed and white vinyl siding on the sides and rear of the home. The front stone is a stacked white stone veneer as seen in photo, bringing value and style to your new home for years to come.

The front of the home includes a 7" H x 63" W x 37" D Palram- Canopia Sophia overhead door awning for the front and rear door of the home. Also included are Therma Tru Doors.

Some features are subject to change based on availability or need.

THE CLIFFHANGER

Contemporary living at its best!

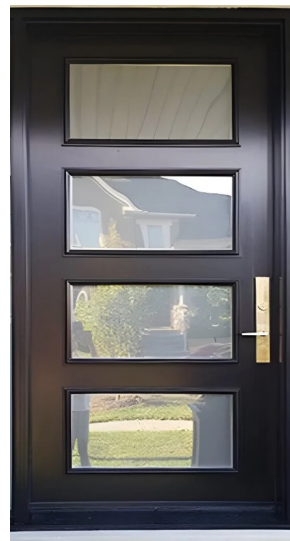

Included 4 Lite Single entry door clean, crisp and utterly sophisticated Front Door



**1872 West 57th Street,
Cleveland, Ohio 44102**

Contemporary style
and flare

CUSTOM ENTRY CUBBY

WE MAKE YOUR HOUSE INTO A HOME WITH OUR STYLISH PIECES.



This custom-made cubby will feature pockets for shoes, gloves and/or knick-knacks for display.



CONTACT

ROZIER DESIGNER HOMES LLC

P.O. BOX 39298

North Ridgeville

Ohio 44039

We have many standard styles of engineered flooring to choose from that are all very durable and waterproof.

The porch shall have cable handrailing as viewed on front elevation. Upgrades are available. The home includes cable handrailing and upgrades are available. The cable handrailing flows from the first floor to the upstairs. Cable handrailing will also be included for the front porch and steps. The rear porch railing will be in vinyl. Upgrade pricing is based on style and material selected.

FAUCETS

Our Standard Bathroom faucets are the Moen Model 6410 Eva Faucet in Chrome.

Our Kitchen Sink Standard for the Cliffhanger is the Moen Model 87194SRS Indi Spot Resist Stainless One Handle Pre Rise Spring High Arc Pulldown Kitchen Faucet in Brush Nickle

All MOEN bathroom showers shall be the Genta Single-Handle 1-Spray Tub and Shower Faucet in Chrome.

MOEN Collections

Bath & Kitchen Collections



MOEN

ALL LED LIGHTING

THE MAIN STAIRCASE CHANDELIER SHOULD MEASURE 25" X 25" WIDE X 85" LONG. THE CUSTOMER HAS A **\$2,000.00** LIGHTING ALLOWANCE FOR:

- (1) STAIRCASE CHANDELIER
- (5) OUTDOOR SCONCES
- (1) CEILING KITCHEN LIGHT
- (5) BATHROOM LIGHTS
- (3) BEDROOM FANS
- (3) OPTIONAL EXTRA INDOOR SCONCE PACKAGE @ \$525.00
- (5) CEILING FLUSHMOUNT LIGHT
- (1) OPEN STAIRCASE UPGRADE @ \$45,000.00 COMES WITH CABLE HANDRAILING

ALL LIGHTING MUST BE LED TO MEET GREEN CERTIFICATION FOR 15 YEAR TAX ABATEMENT.

ALL RECESSED LIGHT CANS ARE INCLUDED ON PLAN AND ARE ALL LED. ADDITIONAL LED RECESSED LIGHT CANS ARE AT AN ADDITIONAL COST OF \$375.00 PER CAN.



15 YEAR TAX ABATEMENT

ROZIER DESIGNER HOMES LLC IS GREEN CERTIFIED AND ENERGYSTAR CERTIFIED, THUS GIVING THE HOMEOWNER A COMPLETE ENERGY EFFICIENT RESIDENCE THAT WILL LOWER YOUR HOME HEATING AND COOLING COST AND YOUR ENERGY FOOTPRINT IN THIS RISING PLANET CLIMATE, BE GREEN FOR THE FUTURE OF OUR KIDS AND OUR PLANET.

CONTACT:

Asia D. Newell at: **Huntington Bank**
located at: 200 Public Square,
Cleveland Ohio 44114 to get started
with your construction loan. 216-755-
1001
Email: Asia.D.Newell@Huntington.com

CONTACT:

Nancy Rozier from ROZIER DESIGNER HOMES LLC for questions about this beautiful home at 216-235-3887

We look forward to your call!
Thank you for considering us as your
builder.



**WE MAKE YOUR
HOUSE INTO A
HOME WITH OUR
STYLISH PIECES.**

**Our standard Countertops
are 3 CM Rhapsody or
Carrara GT Quartz a can be
viewed to the left.**

CABINETS & COUNTERTOPS

The ProCollection Cabinetry is standard with the Cliff Hanger Home. All cabinetry comes with soft close doors and drawers. The base color selection is as follows:

ProWhite
ProGray
ProJava

CONTACT US

Nancy Rozier: nrozier1416@gmail.com
Jeffrey W. Rozier, Sr.: jeffreYROZIER@gmail.com
Or at: info@rozierhomes.com
www.Rozierhomes.com

No backsplashes are included with this home design. The Kitchen sink comes with a 16 Gauge SS UM single bowl at 10" deep. Kitchen Backsplash Upgrade @ \$2,400.00

THE CLIFF HANGER CURB APPEAL AT ITS BEST



TWO STORIES OF WINDOW FLARE

Standard staircase made of Oak wood as viewed in rendering. We feature Jeld-Wen windows. Jeld-Wen windows are one of the best in the industry, energy-efficient and custom designed to give that modern look (front).

Floor allowance will be given of \$2.50 per square foot for engineered flooring. Please be advised that if you upgrade to ¾" tongue & groove hardwood flooring, there shall be at an additional labor cost of \$5.50 per square foot totaling \$11,095.50.

This home features a double stringer open staircase and cable railing with 1-3/4" stair treads providing a modern feel and open design. An upgrade is available to a single metal stringer staircase @ \$45,000.00 with 2" thick treads, with cable handrailing.

INCLUDED APPLIANCES

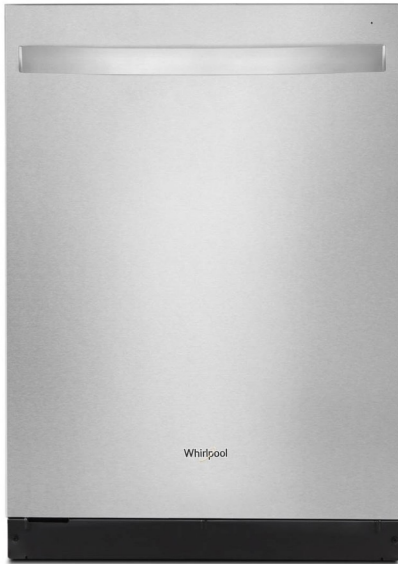

APPLIANCES

Whirlpool® 30" 5.0 cu.ft. Stainless Steel Slide-In Gas Range
Model Number: WEG515S0LS

The Kitchen 30 in. T-Shape Vissani Wall Mount Range Hood in Stainless Steel with LED Lighting and Permanent Filters included. This hood will be vented to the exterior of the home.

Whirlpool 30" 5.0 cu. Ft. Stainless Steel Slide-in Gas Range Model number WEG515S0LS

Samsung - 65" Class U7900 Series UHD 4K Smart Tizen TV (2025)

This home features a 90,000 BTU Carrier furnace and AC unit that provides 95 percent efficiency. This unit is reliable, efficient, and provides cost-effective heating. It is designed for long-lasting use for consistent, whole-home comfort during the winter and summer months.

CLIFFHANGER 2.0 LIGHTING INCLUDED

Arandel 35 1/2" Wide Matte Black LED Bath Bar shall be within the basement half bath, first floor bath and second floor community bathroom & two living room area wall sconces. All dimmable lights



Kitchen Breakfast Bar light: one single Modern Minimalist LED Long Strip indoor Pendant light at 35" in width.



Center living room light



Chandelier light
With 9 LED
white lights
Modern
Chandelier -
Elegant
Lighting for
Grand
Staircases

Lighting allowance of: \$2,000.00

Displayed are the lights chosen for Cliffhanger 2.0 All lighting must be LED for Green certification.

Five outside Modern LED sconces for front door entry, rear door, garage door coach lights, and garage man door.



INCLUDED CABINETS

Master Bath Floating Vanity



THICKENED ITALIAN TECHNOLOGY ROCK PLATE

High temperature resistance, anti-scratch, no radiation, anti-corrosion and other advantages

INTELLIGENT DEFOGGING TECHNOLOGY TEMPERATURE DISPLAY LED SOFT LIGHT ILLUMINATION

Intelligent defogging, no fogging and condensation on the mirror surface
LED natural soft light, linear shadowless lighting



**LARGE STORAGE AREA FOR THE WHOLE FAMILY'S TOILETRIES
DIFFERENT HEIGHTS FOR DIFFERENT TOILETRIES**
Open space underneath for handy items



The Master Bathroom boasts a stunning spa-like feeling with this luxury floating Double Bathroom Vanity that also comes with black faucet hardware. It includes LED Smart Defogging Mirror, cabinet equipped with an advanced soft-closing system, ensuring that the drawer or cabinet door automatically slows down and closes gently each time, and floating open shelf. The hidden storage cabinet combines practicality and aesthetics.

The shower features a full glass sliding door, with a Overhead Rainfall center Shower Head with tile surround to the ceiling.

INTERIOR DOORS AND TRIM



This home shall feature Mastercraft five panel interior doors.

All bedrooms shall have solid core doors and all other doors shall be hollow core. All interior doors shall be painted white to match base trim and door casings throughout the home. This door style matches the front exterior door.

All base trim and casing are the same size for a modern / contemporary style and look.

GARAGE DOOR

Sample Standard Garage Door Model 87802 with top glass window panel 16'-0" Wide X 8'-0" Tall Garage Door.



8587W Elite Series Garage Door Opener ¾ HP with Wi-Fi - Chain rail

Homes Comes with the LiftMaster Model 2420L with MyQ App, backup battery and camera with Wi-Fi features

Standard rear home and Garage entry door painted Black to match garage door



The Garage is setup and wired for Electrical Vehicle Chargers.

Charging stations are at an additional cost

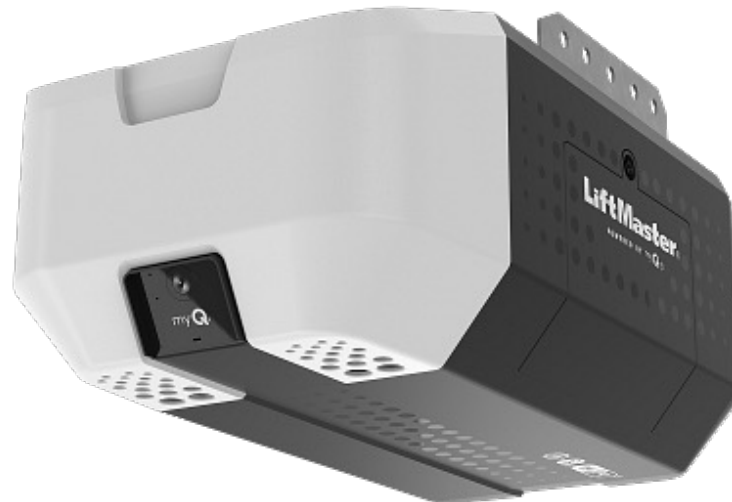

Home Security

Garage and Home Security features an added value and protection. Both garage door opener models are subject to change due to availability; however, we guarantee that we will give you the same quality and assurance as the original or better.

You can visit:

Potter Overhead Door Inc.

27864 Royalton Rd

Columbia Station, OH 44028

For further door styles and details. Please be advised that should you chose another door style and/or model you will be subject to an additional fee for an upgrade of the door and extra installation cost.

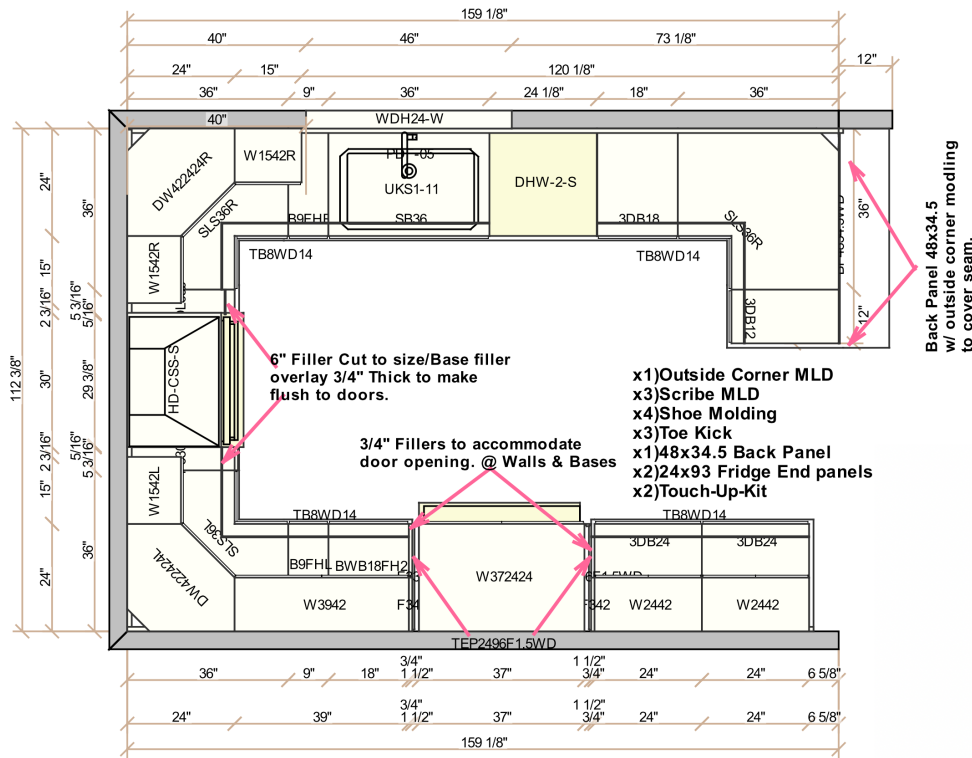

Back Panel 48x34.5 w/ outside corner molding to cover seam.

6" Filler Cut to size/Base filler overlay 3/4" Thick to make flush to doors.

3/4" Fillers to accommodate door opening @ Walls & Bases

- x1) Outside Corner MLD
- x3) Scribe MLD
- x4) Shoe Molding
- x3) Toe Kick
- x1) 48x34.5 Back Panel
- x2) 24x93 Fridge End panels
- x2) Touch-Up-Kit

Kitchen Layouts

Kitchen layout with Pro Collection 1951 Cabinetry Lubbock Flat panel door style Cabinetry see brochures
 All bathrooms shall have matching cabinetry (except the Master bathroom).
 There is an additional charge for raised height bathroom cabinetry.

Laundry Room Cabinetry Shall match the cabinetry to the rest of the home.

All toilets are American Standard Elongated ADA 17" in height

All internal plumbing shall be PEX tubing water supply in red & blue. PEX tubing materials bring long lasting trust without leakage and reduces the sweating of pipes and costly replacement of busted frozen pipes.

The furnace and AC unit shall be by Carrier and be 95% efficiency with direct venting.

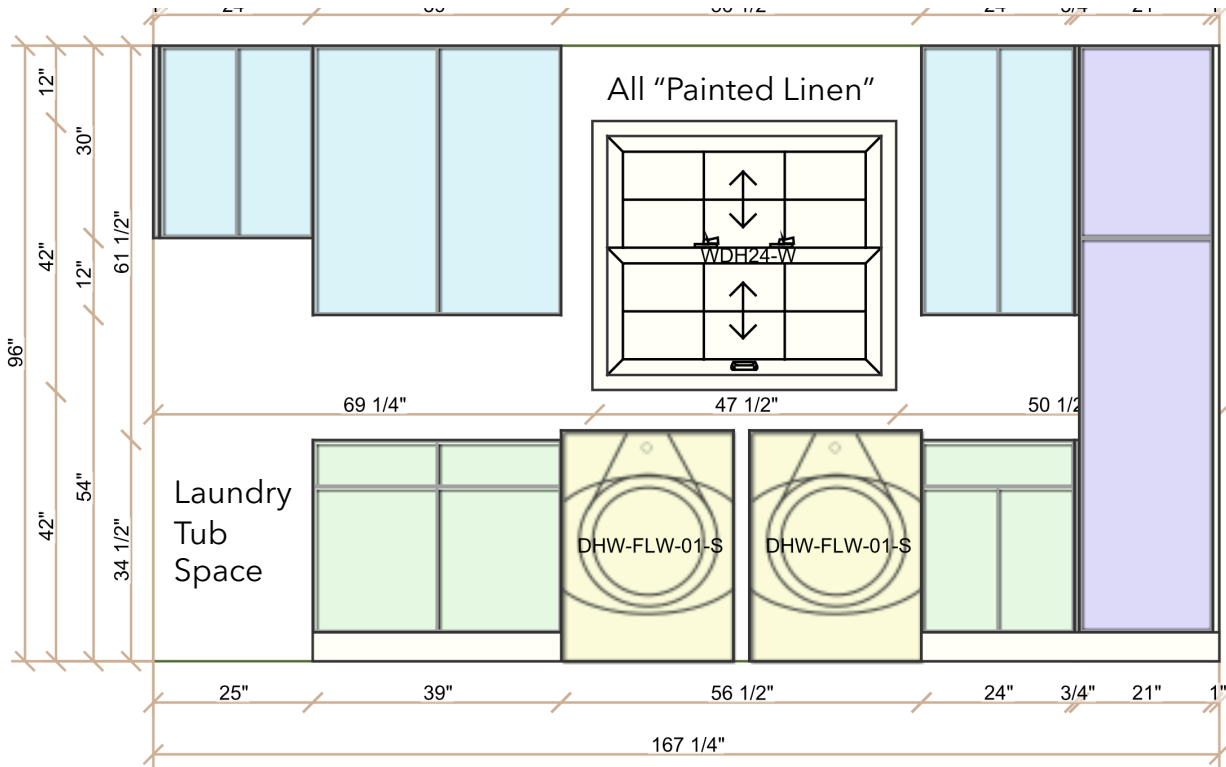

1951 CABINETRY / LUBBOCK STYLE

The Kitchen shall feature Painted Linen upper cabinets and painted Boulder cabinets

Painted Boulder



Lubbock



Slab Drawer

Kitchen Base Cabinets Painted
Boulder

Painted Linen

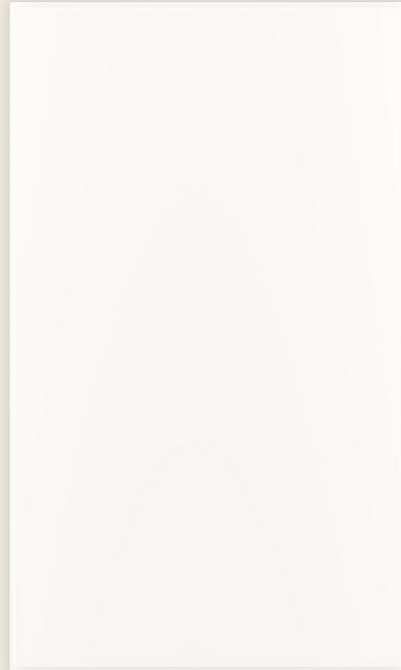

Lubbock



Slab Drawer

Upper Kitchen Cabinets shall be Lubbock Style painted Linen and this color shall be used throughout the rest of the home in all bathrooms and laundry room areas.

Modern Style Flat panel cabinetry

All Cabinetry comes with soft close drawers and doors. All handles and other hardware is at an additional cost to the customer.

Painted Linen



Lubbock



Slab Drawer



Modern Style Kitchen.
White "Painted Linen"
upper cabinets and
"Painted Boulder" Grey
Bottom Cabinetry all
with soft close drawers
and doors

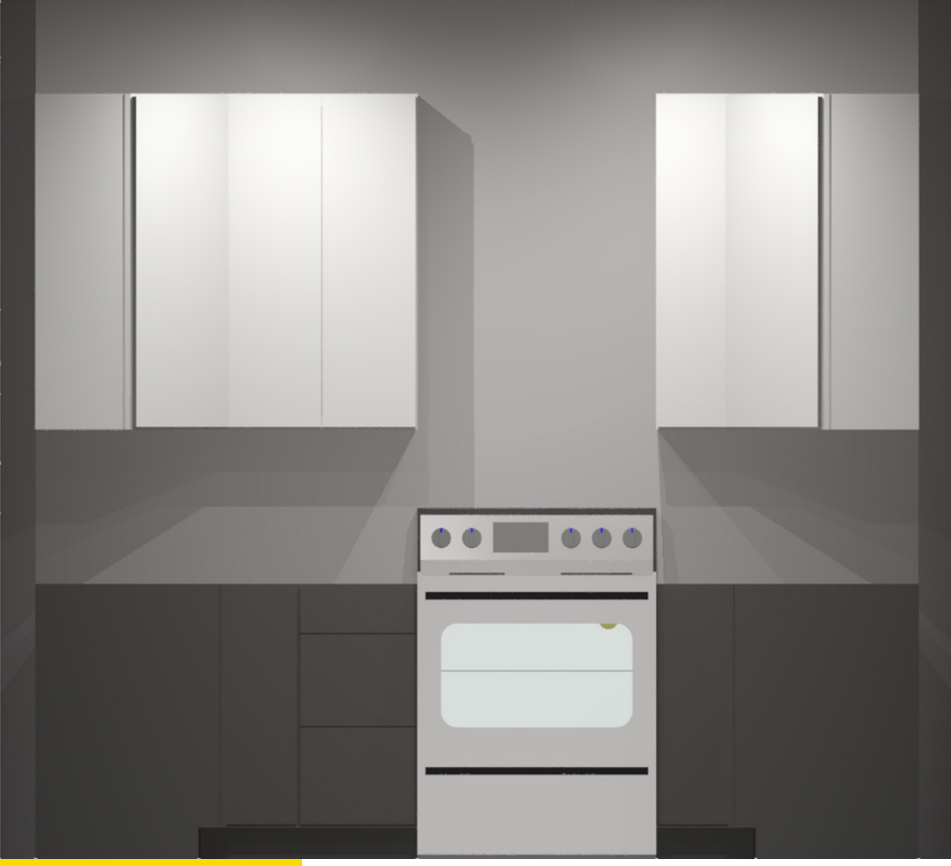

1951 Cabinetry / Lubbock Style Flat Panel cabinetry

ALLOWANCES

Base Price of Home without finished basement:	\$560,900.00
Base Price of Home with finished basement:	\$584,900.00
Land improvements and cost:	\$75,000.00
finished basement OPTION includes Half bathroom.	
Total price:	\$659,900.00

1st & 2nd floor engineered flooring allowance of \$2.50/Sq. Ft. of living space: \$4,200.00

Light fixtures: \$2,000.00

Appliances: DISHWASHER AND GARBAGE DISPOSAL INCLUDED

All bathroom floor tile allowances are: \$2.50 per tile

Master bathroom floor tile and shower wall tile allowances: \$2.50 per tile up to 8'-0" height within shower stall only.

Please be advised that all allowances are non transferrable to other allowances.

Please contact us if you should have any questions about upgrades and other possible material selections. We aim to please, to ensure that we meet your every need within the possibilities of your home design.

All standard counter tops will be **Rhapsody Quartz**. There are variations of Rhapsody. We have an account with Mario Stone located at 13000 York Road North Royton, Ohio 44113 schedule an appointment with Kim. 440-305-9441

The client would have a counter top allowance of: **\$6,500.00** for countertops.

THE CLIFF HANGER

Window Wrap with Sill



Window Cased in with sill



Upgrade of \$325.00 per window painted white. Stained \$425.00 per window

FLOORING CHOICES

Summer Sand



Honeywood



Hawthome Gray



California Pecan

Bellaire Flooring

Water Proof

Wear Layer: 20MIL

Plank Size: 7.2" X 48"

Overall Thickness: 5.0 mm

Thick Padding



Total of: 2,400 square feet

Not Included in price of the home

Kitchen Ceiling Beams

Customer shall have an option of choosing the color and texture of upgrade ceiling beams for the Cliff Hanger Kitchen design. Each of three ceiling beams are: 6" Wide X 6" Tall X 9'-6" Long at an additional cost of \$4,800.00 for beam installation. Extra cost for Rough Swan textures viewed below is: Rough Swan-Espresso Ceiling Beam. This is a premium wood finish texture. An additional \$1,200.00

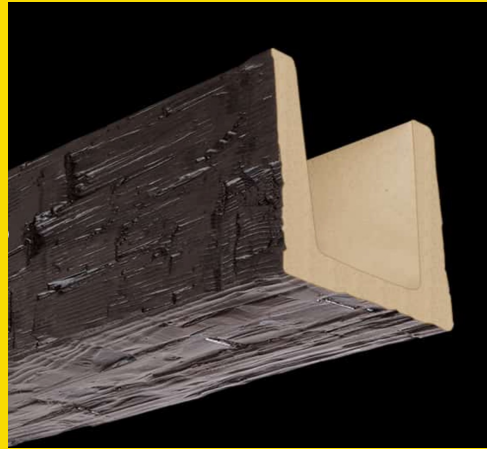
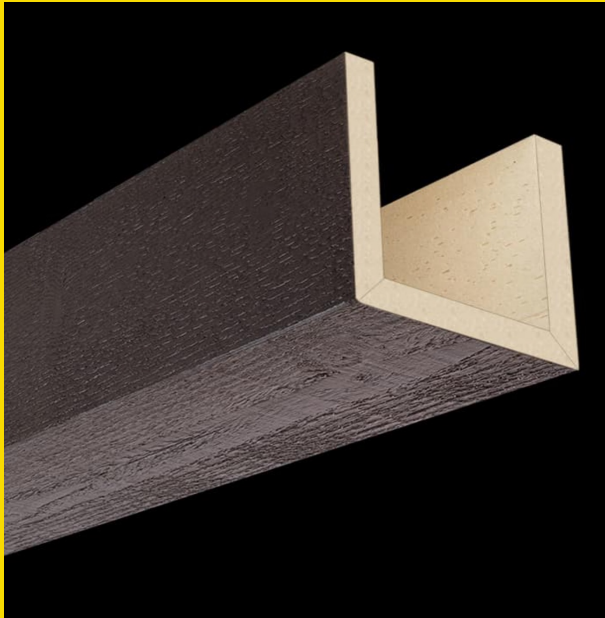

Hand Hewn Espresso



Hand Hewn Driftwood



Douglas Fir Espresso



Hand Hewn Dark Walnut

These beams add style and flare to your home design.

Customer can choose not to have ceiling beams; however, it shall not reduce the price in the cost of the home.

There are a total of three(3) ceiling beams included in Cliff Hanger kitchen layout.



One year Paid Service included with a \$550.00 dollar value. This Package is included with a total value of \$6,500.00 installed.



Included Alarm System

(1) Honeywell Vista 20P Alarm kit with 2 door sensors, (4) IS335 Motion detector, 1 Total Connect Verizon Cell Module, Tuxedow Keypad and 1 747 Siren, (4) Honeywell IS335 Motion Detectors (1) Honeywell FG1625 Glassbreak Detector. (2) Honeywell Tuxedow Touchscreen Keypads one in the Master Bedroom and the other near the rear entry door. (1) LiftMaster Gateway. (1) 4 Channel E Series NVR (NVR- E4L1P8) with (1) 2TB Hard Drive. (2) Alarm.com ADC-V730 Cameras, one located at the front of the home and the other in the rear of the home. (1) 20" LG Monitor.

CAMERAS / GLASS BREAK



Motion Detectors



BATHROOM KITS



1st
floor
bath

**60in x 32in Age In Place Left Hand
Drain Minimalist Tub Kit with 4 Shelves**

SKU: S33A2-6032CTSMIN2LA |

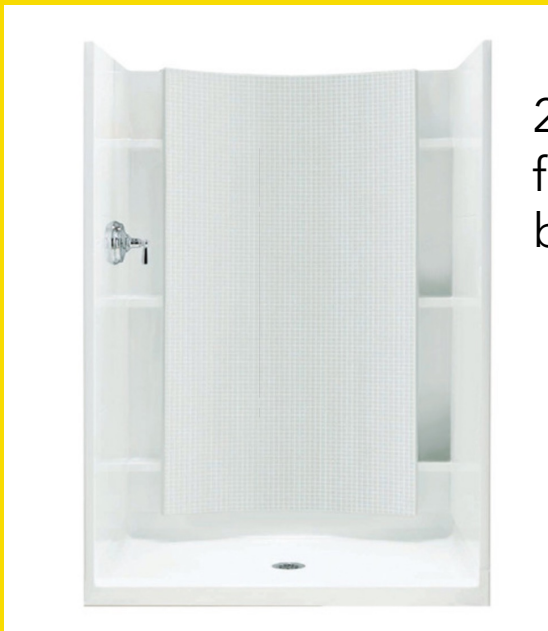

2nd
floor
bath

42" X 36" X 77" Stall

MASTER BATHROOM



The Master Shower comes with a built-in niche, with glass shower door / tempered glass. Customer can choose shower wall tile and floor tile within allowance. It is at an additional cost for a full tile wall as viewed. Shower seat is at an extra cost.

Optional overhead rainfall showerhead included and comes with two waterproof recessed light cans.

Custom tile from the base up 8'-0" with one niche included

Master shower includes a glass shower door.

Some products may change based on availability; however, the quality remains the same.

THE CLIFF HANGER PROFILE



WINDOW SELECTION

JELD - WEN WINDOW IS OUR FIRST OPTION FOR THIS HOME, HOWEVER BECAUSE OF SHORTAGES WE HAVE MADE SEVERAL REQUEST FROM THREE DIFFERENT VENDERS FOR WINDOWS TO STAY ON SCHEDULE SO YOU THE CUSTOMER CAN MOVE IN ON TIME, SAVING YOU TIME AND MONEY, THAT'S HOW WE MAKE SURE THAT WE MEET YOUR DEADLINES.

All exterior siding is vinyl and maintenance free. All stucco finishes are maintenance free. All stone finishes are maintenance free.

PELLA / MARVIN / JELD-WEN

All windows shall be vinyl windows by Jeld-Wen. All other brand windows shall be at an additional cost to the buyer.

BUILDING PERMIT IS READY

Rozier Designer Homes LLC has done the hard part by obtaining the building permit, (see below) which is a long process for the city of Cleveland. This gives the Buyer a peace of mind for a timeline to start building.

Actual Building Permit

CITY OF CLEVELAND DEPARTMENT OF BUILDING AND HOUSING		DATE PRINTED: 7/8/2025
Inspector: DERRICK COOLEY-SITE INSPECTOR NEW Phone No. 2166643665 Email: dcooley@city.cleveland.oh.us	Building Permit Permit No: B25015017	POST THIS PERMIT IN PLAIN VIEW.
CONTACT YOUR INSPECTOR AT LEAST 12 HOURS PRIOR TO REQUESTED INSPECTIONS. PLEASE CALL BETWEEN THE HOURS OF 7:00 A.M. AND 10:00 A.M. APPROVED DRAWINGS MUST BE KEPT ON JOB SITE.		
Location: 1872 W 57th , Cleveland, OH 44102		
Issue Date: 07/08/2025	Plan Process Fee: \$40.00	Site Development Fee: \$0.00
Permit Fee:	Storm Water Process Fee: \$0.00	Additional Const. Cost: \$0.00
Additional Permit Fee: \$0.00	Surcharge: \$33.50	Additional Fee Surcharge: \$0.00
Estimated Cost: \$22,000.00	C.O. Fee: \$60.00	Late Fee:
Floor Covered:	Zoning Fee: \$20.00	Zoning District: B 1
AKA:	Ward: 15	District: 1
Use: One Family	PPN: 00232029	Census Tract: 1975
Constr. Class: Frame	PURSUANT TO FILING THE REQUIRED APPLICATION BY	
Zoning District: B 1	Contractor: JEFFREY W ROZIER, ROZIER DESIGNER HOMES LLC	Phone No. 216-990-0483
District: 1	Address: 6948 FLEDGLING CT, UNDEFINED, NORTH RIDGEVILLE, OH 44039	
Census Tract: 1975	ON BEHALF OF	
	Owner: JEFFREY W. ROZIER SR	Phone No. 216-990-0483
	Address: 6948 FLEDGLING CT, N. RIDGEVILLE, OH 44039	
PERMISSION IS HEREBY GRANTED TO: CONSTRUCT A NEW ONE-STORY 1351 SF WOOD FRAME SINGLE FAMILY RESIDENCE WITH DETACHED GARAGE PER APPROVED PLANS. WORK TO MEET RCO AND CITY CODE. SEPARATE M/E/P 6" DIA CONN / SIDEWALKS / STREETS / PERMITS REQUIRED. SMOKE & CO ALARMS REQUIRED. CERTIFICATE OF OCCUPANCY REQUIRED. REMOVE DEBRIS FROM SITE.		
A CERTIFICATE OF OCCUPANCY IS REQUIRED. THIS PREMISES SHALL NOT BE OCCUPIED UNTIL A CERTIFICATE OF OCCUPANCY HAS BEEN ISSUED.		
THIS PERMIT IS FOR THE WORK SPECIFIED ON THE APPLICATION FILED THEREFORE ANY UNAUTHORIZED CHANGE OR ALTERATION FROM THE AFORESAID APPLICATION OR PLANS WILL RENDER THIS PERMIT NULL AND VOID.		
Sally Martin O' Toole DIRECTOR, DEPARTMENT OF BUILDING AND HOUSING		PAID JUL 08 2025
THE REPRODUCTION OF THIS DOCUMENT IS PROHIBITED BY LAW ANY ALTERATION OR ERASURE VOIDS THIS CERTIFICATION.		

Prints

The Cliffhanger sits right next door to the Belgrade home that was designed and built by Rozier Designer Homes / RJRZ Group. The Belgrade home was sold to a very happy new homeowner.

Its time to start picking out your flooring, cabinetry, paint colors and carpet for the basement, tile for the bathrooms and many other items to add to your new home and / or upgrade your kitchen appliances.

Rozier Designer Homes LLC has built many homes over the years, and we are also an award-winning home designer in the 2003 Cleveland Citirama.



Floor Layouts

INTERIOR BASEMENT CONCRETE MEASUREMENTS ARE 53'-7" X 15'-5" X 4" THICK CONCRETE SLAB RESTING ON 6" X 6" HEAVY WIRE MESH RESTING ON 6 MIL VAPOR BARRIER RESTING ON 4" OF #57 GRAVEL STONE RESTING ON UNDISTURBED SOIL.

TOTAL OF 10.2 CU YARDS OF CONCRETE @ 9,000 PSI

626.0 SQUARE FEET OF CONCRETE

Total Basement Living Space
620 Square Feet
Total Basement Finished Living Space
629 Square Feet

Total Basement Space
820 Square Feet
Total Basement Finished Living Space
629 Square Feet

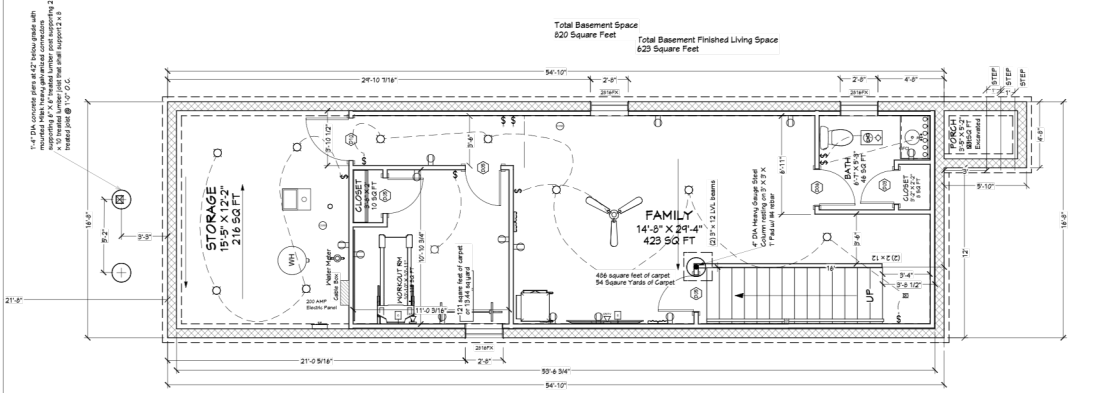

LIVING AREA
49.58 FT

Foundation

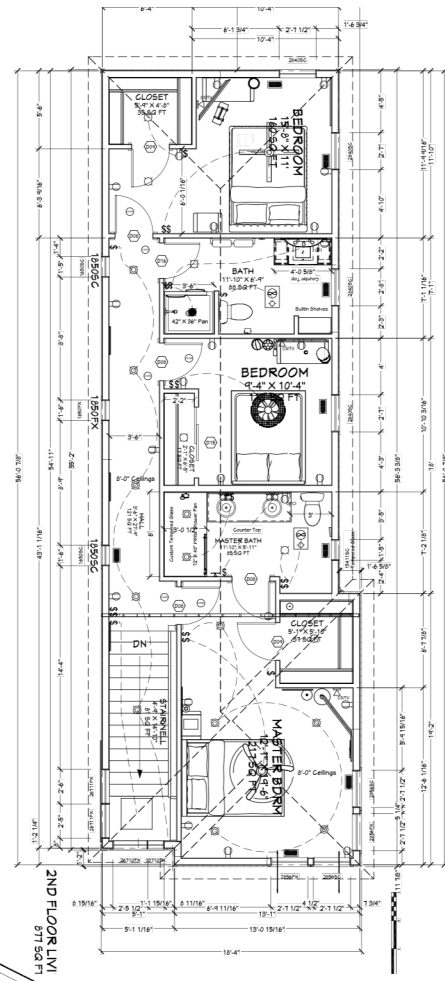

2nd Floor



1st Floor

Contact us at:
Nancy Rozier 216-235-3887
info@Rozierhomes.com
Nrozier1416@gmail.com

Finished Basement is included with the asking price.



REVISION TABLE	REVISION BY	DESCRIPTION
NUMBER	DATE	REVISION BY DESCRIPTION

THE CLIFFHANGER
1872 W. 5TH ST
CLEVELAND, OH 44102

DRAWINGS PROVIDED BY:
ROZIER DESIGNER HOMES LLC
6948 FLEDGLING CT
N. RIDGECVILLE, OH 44034
216-990-0483

DATE:
1/15/26
SCALE:
1/4" = 1'-0"
SHEET:
P-1

Beautiful floor plan with a first-floor open layout, for that contemporary homeowner looking to entertain guest. The Cliffhanger is the perfect home for you.

HUNTINGTON BANK

On the execution of a contract an Initial down payment of \$5,000.00 is required to hold the lot to get started. This is the season for new construction so be the first to hold your future home site.

Rozier Designer Homes LLC or (RDH) will then post on the MLS that a sell is pending for your location. It should take approximately 2 weeks for construction loan approval and to setup scheduling with RDH

The lot is then sold and transferred to the buyer under an agreement for RDH to build that home on that lot.

After final upgrades and/or selections, the buyers shall sign an agreement for the final price and submit a 10% down payment of the final full price, which shall go towards materials and labor.

The Buyer shall then purchase the lot from the builder under an agreement and that the Buyer agrees that Rozier Designer Homes LLC shall build the Cliff Hanger home on the Buyers lot based on the agreed blueprints and material selections.

The Builder shall then commence construction and receive a total of five draws from Huntington Bank based on the amount of construction completed.

Each draw is based on the Banks inspection and appraisal, the city Inspector's sign off and approval and the Buyers sign off and approval to receive each draw. It shall take approximately 6 to 9 months to complete the home unless a unforeseen occurrence should happen out of the control of the Builder (RDH)

ASIA D. NEWELL

HUNTINGTON BANK CONSTRUCTION
LOAN OFFICER SPECIALIST.



Please contact Asia at; 216-755-1001
Email: Asia.D.Newell@Huntington.com
HUNTINGTON BANK
200 Public Square
Cleveland, Ohio 44114

Please contact (RDH) sales department
Nancy Rozier at: 216-235-3887 for any
other questions.

Revised March 11th, 2026