



Plant Select[®]
Smart plants for the right places

CLICK TO SEARCH RIGHT PLANT RIGHT PLACE!

[Learn how to become a Plant Select member: Landscape Professional, Retail, Wholesale, Mail Order or Individual Ambassador \(new!\)](#)

Plant Select's goal is to create smart plant choices for a new American landscape inspired by the Rocky Mountain region

A waterwise maple tree that can handle western soils and drought

Many cold-hardy maples struggle in alkaline soils. But [HOT WINGS[®] Tatarian maple](#) (*Acer tataricum* 'GarAnn') is an exception worth chatting about...

HOT WINGS[®] is a small, ornamental tree reaching 15 to 18 feet tall and wide. This drought-tolerant maple adapts better to alkaline soils than traditional ornamental maples. It's unlikely to develop chlorotic, washed-out leaves. Instead, it has rich, green foliage and a different leaf shape than traditional maples.

HOT WINGS[®] offers beauty from season to season, from its vibrant fall color, to its yellow-white flowers in the spring. But it may win the most hearts in the middle of summer. In July, it's covered with showy, red helicopters (aka, samaras), making the tree look like it's in bloom. It's a showstopper!

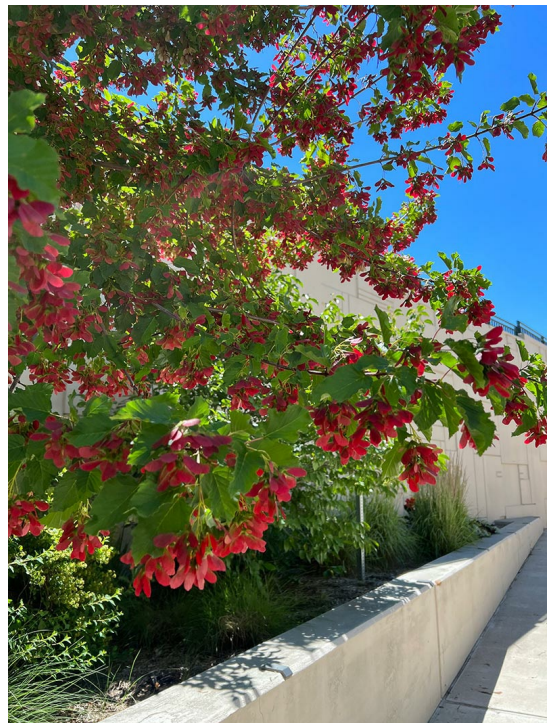

[Learn about its hardiness zones, soil needs and ideal elevations here >>](#)

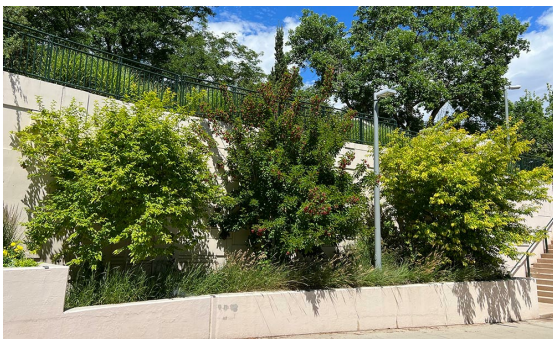

HOT WINGS® Tatarian maple (center) flanked by two chlorotic ginnala maples.



Leaf comparison: HOT WINGS® Tatarian maple (left). Chlorotic leaves of ginnala maple (right).



Success tips for growing HOT WINGS® Tatarian maple

- 1) If you plant this tree in a spot that gets frequent irrigation, like in a traditional Kentucky bluegrass lawn, you may encourage more seedlings than you'd prefer. Instead, set your HOT WINGS® up on its own drip irrigation zone or group it with shrubs.
- 2) Prune your HOT WINGS® in the summer after the samaras ("helicopters") drop. If you prune it in the winter or spring, you may prune off the flowers.

3) HOT WINGS® has strong branch unions, but it can experience some limb damage in snowstorms. The best maintenance practice is to gently brush the snow off your tree during heavy snowstorms, particularly in the spring or fall when it has leaves. Trim back long branches or branches that are vulnerable to snow. And don't plant this tree under the eaves of a house where snow loads can slide off and damage it.

In the garden with Grace Bring on the hummingbirds

ORANGE CARPET® Hummingbird Trumpet (*Epilobium canum* subsp. *garrettii*) is a showy, drought-tolerant perennial that blooms later in the summer. And it's a magnet for hummingbirds! Watch as Horticulturist Grace Johnson of Denver Botanic Gardens Chatfield Farms shares what makes this perennial special, and get an up-close look at how much hummingbirds love this plant. (It's native to the mountains of Idaho, Utah, Wyoming and Arizona.)



Watch this short
video

Introducing a new "Individual Ambassador" membership



You spoke. We listened! A number of you have shared that you'd like to support Plant Select as a member, but you don't have a landscape or gardening business. We've created a new Individual Ambassador membership for master gardeners, garden writers, editors, photographers, self-named "plant nerds" and other individual plant

enthusiasts.

Your membership helps support the research and growth of sustainable plants inspired by the Rocky Mountain region. Please consider joining us!

[Learn more here >>](#)

Kintzley's Ghost® honeysuckle

Get ready to hear: "What is that beautiful silver vine?"

Kintzley's Ghost® honeysuckle is a low-maintenance vine that has so much going for it: It has stunning silver foliage. It can handle drought, growing in dry or moderate water conditions. It thrives in a variety of sun conditions. And Japanese beetles tend to skip it. (Cheers to that!)

INSIDER TIP: If you can't find Kintzley's Ghost® at a local retailer, [Great Garden Plants](#) has had it in stock this summer.



HOAs: Growing new plants in the summer heat? Flag them!

Our scorching summer temps can take a toll on recently-planted perennials, shrubs and trees. You may have a crispy surprise waiting for you if you take your eye off of your new plants for just a day or two.

One best practice is to mark your new plants with small landscape flags for the first four weeks they're in the ground, especially if you're adding them to an established landscape. That way, they don't get overlooked.

Plants that get planted in June, July and August often need more TLC. The landscape flags serve as reminders to frequently check those new plants to see whether they're stressed and need water.

You may hear: "But the flags don't look attractive." Just remember, neither do dead plants! The flags are only temporary, and they're there to help ensure your new plants get the attention they need to get off to a great start.

It could be easy to walk by this garden and only look at the blooming hyssop on the right. The less showy, newly-planted perennials on the left could get overlooked. The landscape flags draw your attention to all your new plants, so you can

make sure they're okay.

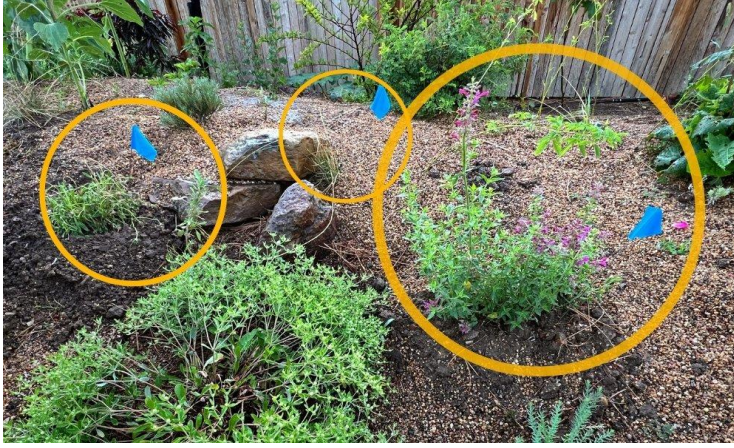

Upcoming garden events

Sat, August 6 | 9 am–noon
Public Evaluation of Flowers
Fort Collins, Colorado

Join other flower enthusiasts, and vote for your favorite annuals and perennials at the Colorado State University **Flower Trial Gardens**.

Short garden tours will be given at 9, 10 and 11 am for free. The garden is located at 1401 Remington Street, Fort Collins, CO 80523. [Get event details here.](#)



Photo credit: CSU Flower Trial Gardens website

Smart plants for the right places Mid-summer stunners



Mojave Sage



UNDAUNTED®
Alpine Plume
Grass



Moroccan
Pincushion Flower

% Colorado State University
1173 Campus Delivery
Fort Collins, CO 80523-1173
PH: (970)-481-3429

DENVER BOTANIC
GARDENS

Colorado
State
University

