



Three Rivers Forestry
PO Box 764
Tappahannock, VA 22560
(804) 445-5774

Date: April 10, 2026
Time: 3:00 PM
Size: 62 Acres

Total Vol: 941.9 MBF
Vol/Acre: 15.19 MBF

**Timber Sale Notice
Clear-Cut
Pine and Hardwood Timber**

Three Rivers Forestry has been contracted to sell the merchantable timber belonging to James and John Rigg by sealed bid on 62 acres, located 0.7 miles south of Wrights Corner, on the west side of RT. 664 (Bath Road) in Caroline County, Virginia (see attached map).

A 10% sample cruise of the standing sawtimber and pulpwood has been made. All pine and hardwood trees 10 inches DBH and larger were tallied as sawtimber. All sawtimber volumes were calculated using the International Log Rule and pulpwood volumes are based on standard cords of 128 cubic feet. An estimate of the timber volume is provided; however, no guarantee is expressed or implied as to the actual timber that may be harvested due to individual utilization practices.

Loblolly Pine	733.9 MBF	Pine Pulpwood - 285 Cords
Yellow Poplar	94.1 MBF	
Red Oak	54.0 MBF	
Misc. Hardwood	35.7 MBF	Hardwood Pulpwood - 108 Cords
White Oak	19.0 MBF	
Virginia Pine	5.2 MBF	
Total	941.9 MBF	International 1/4 inch scale

Bids will be accepted subject to the following conditions:

1. The purchaser will have **two (2) years** to cut and remove the timber from the date the contract is signed.
2. Timber harvesting will be done in accordance to Forestry Best Management Practices (BMP's) as stipulated by guidelines set forth by the Virginia Department of Forestry.
3. The owner requires proof of worker's compensation and liability insurance.
4. Landowner assumes responsibility for the VA. Seed Tree Law.
5. The timber purchase contract will be executed within 30 days of bid opening.
6. Access permitted by Ingress and Egress from RT. 664 (Bath Road) using driveway and existing roads

Lump-sum sealed bids will be accepted **Friday, April 10, 2026** at the office of Three Rivers Forestry (990 Richmond Hwy, Tappahannock, VA) at **3:00 PM** or by mailing to Three Rivers Forestry, PO Box 764, Tappahannock, VA 22560 or calling **(804) 580-1063** or emailing **bid@trfva.com** prior to the sale. Mail bids should be marked **Sealed Bid, Rigg Tract**. Bidder is responsible for verifying receipt of mail bids prior to the sale. Only sealed bids will be accepted and the landowner reserves the right to refuse any or all bids.

Prospective buyers are invited to inspect the timber at any time. Any questions regarding the terms of sale or location of the tract should be directed to Three Rivers Forestry.

Submitted By:

Daniel Deitz
Consulting Forester

VOLUME ANALYSIS

Tract: James & John Rigg
 Cruised By: Daniel Deitz

Acres: 62
 Date: 1/16/2026

Loblolly Pine											
Number of Logs											
DBH	1	1 1/2	2	2 1/2	3	3 1/2	4	Trees	Vol		
10	90	100	440	350	20	0	0	1000	60.9	Avg DBH	
11	20	70	270	670	290	0	0	1320	115.0		12.0
12	0	10	160	500	560	20	0	1250	143.2	Tot Vol	
13	0	0	30	230	470	60	0	790	116.3		435.5
14	0	0	60	110	370	160	10	710	126.7		
15	0	0	30	90	260	90	10	480	100.8		
16	0	0	20	20	90	30	0	160	38.1		
17	0	0	0	10	20	0	0	30	8.2		
18	0	0	0	0	30	20	0	50	16.9		
19	0	0	0	10	0	0	0	10	3.2		
20	0	0	0	0	0	10	0	10	4.6		
21	0	0	0	0	0	0	0	0	0.0		
22	0	0	0	0	0	0	0	0	0.0		
23	0	0	0	0	0	0	0	0	0.0	Tot Vol	
24	0	0	0	0	0	0	0	0	0.0		298.4
25	0	0	0	0	0	0	0	0	0.0		
26	0	0	0	0	0	0	0	0	0.0		
27	0	0	0	0	0	0	0	0	0.0		
28	0	0	0	0	0	0	0	0	0.0		
29	0	0	0	0	0	0	0	0	0.0		
30+	0	0	0	0	0	0	0	0	0.0		
TOTAL	110	180	1010	1990	2110	390	20	5810	733.9		

Virginia Pine											
Number of Logs											
DBH	1	1 1/2	2	2 1/2	3	3 1/2	4	Trees	Vol		
10	0	0	20	20	0	0	0	40	2.6	Avg DBH	
11	0	0	10	20	0	0	0	30	2.6		10.4
12	0	0	0	0	0	0	0	0	0.0	Tot Vol	
13	0	0	0	0	0	0	0	0	0.0		5.2
14	0	0	0	0	0	0	0	0	0.0		
15	0	0	0	0	0	0	0	0	0.0		
16	0	0	0	0	0	0	0	0	0.0		
17	0	0	0	0	0	0	0	0	0.0		
18	0	0	0	0	0	0	0	0	0.0		
19	0	0	0	0	0	0	0	0	0.0		
20	0	0	0	0	0	0	0	0	0.0		
21	0	0	0	0	0	0	0	0	0.0		
22	0	0	0	0	0	0	0	0	0.0		
23	0	0	0	0	0	0	0	0	0.0	Tot Vol	
24	0	0	0	0	0	0	0	0	0.0		0.0
25	0	0	0	0	0	0	0	0	0.0		
26	0	0	0	0	0	0	0	0	0.0		
27	0	0	0	0	0	0	0	0	0.0		
28	0	0	0	0	0	0	0	0	0.0		
29	0	0	0	0	0	0	0	0	0.0		
30+	0	0	0	0	0	0	0	0	0.0		
TOTAL	0	0	30	40	0	0	0	70	5.2		

White Oak											
Number of Logs											
DBH	1	1 1/2	2	2 1/2	3	3 1/2	4	Trees	Vol		
10	0	0	0	0	0	0	0	0	0.0	Avg DBH	
11	10	0	0	0	0	0	0	10	0.5		16.7
12	10	0	0	0	0	0	0	10	0.6	Tot Vol	
13	20	0	0	0	0	0	0	20	1.4		2.5
14	10	20	0	0	0	0	0	30	3.0		
15	0	0	0	0	0	0	0	0	0.0		
16	0	0	0	0	0	0	0	0	0.0		
17	0	0	0	0	0	0	0	0	0.0		
18	0	0	0	0	0	0	0	0	0.0		
19	0	10	0	0	0	0	0	10	2.2		
20	0	0	0	0	0	0	0	0	0.0		
21	0	0	0	0	0	0	0	0	0.0		
22	0	0	0	0	0	0	0	0	0.0		
23	0	0	0	0	0	0	0	0	0.0	Tot Vol	
24	0	0	0	0	0	0	0	0	0.0		16.6
25	0	0	0	0	0	0	0	0	0.0		
26	0	0	0	0	0	0	0	0	0.0		
27	0	10	0	0	0	0	0	10	4.6		
28	0	0	0	0	0	0	0	0	0.0		
29	0	0	0	0	0	0	0	0	0.0		
30+	0	10	0	0	0	0	0	10	6.8		
TOTAL	50	50	0	0	0	0	0	100	19.0		

Red Oak											
Number of Logs											
DBH	1	1 1/2	2	2 1/2	3	3 1/2	4	Trees	Vol		
10	40	0	0	0	0	0	0	40	1.5	Avg DBH	
11	50	0	0	0	0	0	0	50	2.4		15.6
12	10	0	10	0	0	0	0	20	1.5	Tot Vol	
13	20	0	0	0	0	0	0	20	1.4		6.9
14	20	0	0	0	0	0	0	20	1.6		
15	10	20	10	0	0	0	0	40	5.1		
16	0	10	0	0	0	0	0	10	1.5		
17	10	0	0	0	0	0	0	10	1.2		
18	0	10	0	0	0	0	0	10	1.9		
19	0	0	10	0	0	0	0	10	2.7		
20	10	20	0	0	0	0	0	30	6.6		
21	10	0	10	0	0	0	0	20	5.4		
22	0	0	0	0	0	0	0	0	0.0		
23	10	0	10	0	0	0	0	20	6.6	Tot Vol	
24	10	0	0	0	0	0	0	10	2.6		47.1
25	0	0	0	0	0	0	0	0	0.0		
26	0	0	0	0	0	0	0	0	0.0		
27	0	10	0	0	0	0	0	10	4.6		
28	0	0	0	0	0	0	0	0	0.0		
29	0	0	0	0	0	0	0	0	0.0		
30+	0	0	10	0	0	0	0	10	7.4		
TOTAL	200	70	60	0	0	0	0	330	54.0		

Misc Hardwood											
Number of Logs											
DBH	1	1 1/2	2	2 1/2	3	3 1/2	4	Trees	Vol		
10	20	0	0	0	0	0	0	20	0.8	Avg DBH	
11	50	0	0	0	0	0	0	50	2.4		13.8
12	50	0	0	0	0	0	0	50	2.9	Tot Vol	
13	20	0	10	0	0	0	0	30	2.6		8.6
14	10	0	10	0	0	0	0	20	2.2		
15	10	10	10	10	0	0	0	40	5.7		
16	30	10	10	0	0	0	0	50	6.5		
17	20	0	20	0	0	0	0	40	6.7		
18	10	0	0	0	0	0	0	10	1.4		
19	0	0	0	0	0	0	0	0	0.0		
20	0	0	0	0	0	0	0	0	0.0		
21	10	0	0	0	0	0	0	10	2.0		
22	0	0	0	0	0	0	0	0	0.0		
23	0	0	0	0	0	0	0	0	0.0	Tot Vol	
24	10	0	0	0	0	0	0	10	2.6		27.1
25	0	0	0	0	0	0	0	0	0.0		
26	0	0	0	0	0	0	0	0	0.0		
27	0	0	0	0	0	0	0	0	0.0		
28	0	0	0	0	0	0	0	0	0.0		
29	0	0	0	0	0	0	0	0	0.0		
30+	0	0	0	0	0	0	0	0	0.0		
TOTAL	240	20	60	10	0	0	0	330	35.7		



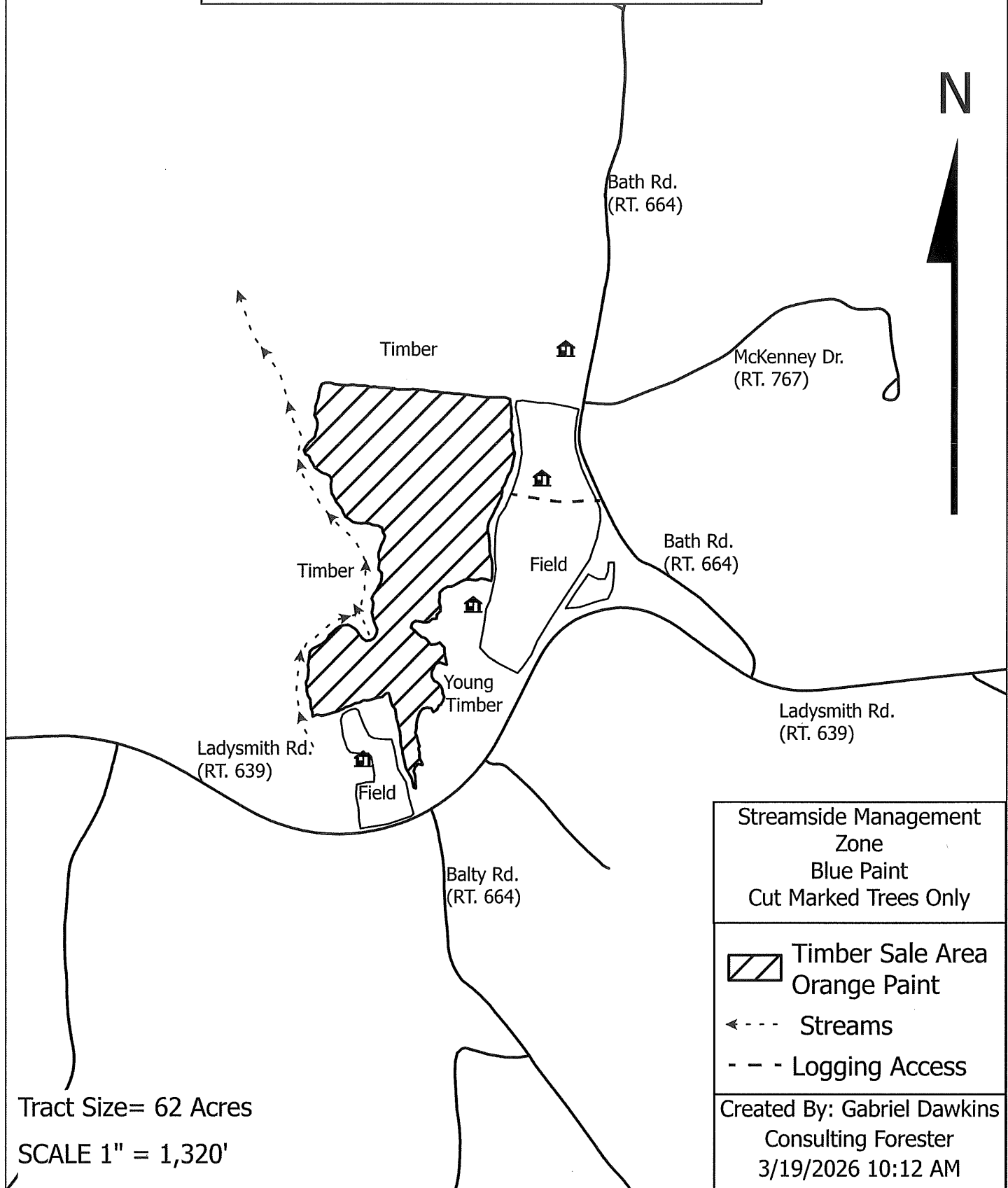

Poplar											
Number of Logs											
DBH	1	1 1/2	2	2 1/2	3	3 1/2	4	Trees	Vol		
10	70	0	0	0	0	0	0	70	2.7	Avg DBH	
11	80	40	10	0	0	0	0	130	7.1		13.4
12	0	20	30	10	0	0	0	60	5.5	Tot Vol	
13	40	10	30	30	0	0	0	110	11.3		26.6
14	10	10	20	40	0	0	0	80	11.1		
15	0	0	20	20	0	0	0	40	6.9		
16	0	0	10	20	0	0	0	30	6.1		
17	0	0	0	10	10	0	0	20	5.3		
18	0	0	10	0	0	0	0	10	2.4		
19	0	0	10	0	0	0	0	10	2.7		
20	0	0	0	20	0	0	0	20	7.2		
21	0	0	10	0	0	0	0	10	3.4		
22	0	0	0	0	0	0	0	0	0.0		
23	0	0	0	0	0	0	0	0	0.0	Tot Vol	
24	0	0	0	0	0	0	0	0	0.0		67.5
25	0	0	0	10	10	0	0	20	12.8		
26	0	0	0	0	0	0	0	0	0.0		
27	0	0	0	0	0	0	0	0	0.0		
28	0	0	0	0	0	0	0	0	0.0		
29	0	0	0								

**Timber Sale Area
James and John Rigg
Caroline County, Virginia**

Longitude: 77°27'4"W
Latitude: 38°1'37"N



Streamside Management Zone
Blue Paint
Cut Marked Trees Only

-  Timber Sale Area
-  Orange Paint
-  Streams
-  Logging Access

Created By: Gabriel Dawkins
Consulting Forester
3/19/2026 10:12 AM

Tract Size= 62 Acres

SCALE 1" = 1,320'

Timber Sale

